

ASS. REC. BY:

REF:

105/

4596/142/3

Kenneth

ASSIGNMENT

From:

Date:

Estimated Cost:

OD / TP / WS / TP RES / OD RES / EVA / INV / MV

To inspect Vehicle No:

at Workshop m/s

of

Insured:

Policy No.

Claims No.

Sum Insured:

Excess:

(Client's Record)

Make of Veh:

(Policy Condition)

Remark: The veh had commenced its repair at the time of inspection.

Bal. or Market Value:

IDAC Accident Report:

GIA / PR Seen:

Est. Repairs:

Lum Sum:

Consistent? : Yes or No

Consistent? : Yes or No

Res.: Yes or No

3 Val.: Yes or No

CA / REV / REP. / 24 HRS

Date:

Person Contacted:

Vehicle: IN / OUT

Veh No:

Type: M.Car / M.Cycle / Bus / Van / Lorry / Taxi / Prime Mover /

Truck / Trailer or

Make:

Colour

Sp. Reading

Eng/No:

C/No:

Gen. Cond: Good / Fair / Poor / Burnt

Steering: In order / Jammed / Leaked / Burnt or

Brake: In order / Jammed / Leaked / Burnt or

Mod: Nil / S/Rim / STD A/Rim or

Tyre Size:

F:

R:

BS / DUN / EXNOVA / GY / FS / LIZA / MIC / OHTSU / PIR / SUMI /
TOYO / YOKO or

Front

R/Bal.

L/Bal.

D.O.A.

Rear

R/Bal.

L/Bal.

D.O.A.

Survey held at

Des. of Damages: Frt / Rear / O/S / N/S / U/C / Rooftop or

The U/C / Chassis frame / Body Structure affected due to collision.

Date / Time

Action / Instruction

Data/Time, File Pass to?

1)

Data/Time, File Return to?

2)

: Prell. Report

: Final Report

Days Of Repair:

Resurvey No. of Trip:

Add Fee:

: Site Insp (\$

: Interview (\$

: Tech Invs (\$

: Weekend (\$

Survey Fee:

Transportation:

) \$ - RS. SI

) Fuel

) Others

TOTAL

Report Format :

Lump Sum / I.B.I: (\$

> Back to OneMotoring

Enquire PARF/COE Rebate for Registered Vehicle

Vehicle Owner Particulars		
Owner ID Type:	Singapore NRIC	
Owner ID:	584J	
Vehicle Details		
Vehicle No.:	SLR2000A	
Vehicle to be Exported:	No	
Intended Deregistration Date:	30 Mar 2020	
Vehicle Make:	TOYOTA	
Vehicle Model:	VELLFIRE 2.5Z EDITION CVT 2WD	
Primary Colour:	White	
Manufacturing Year:	2017	
Engine No.:	2ARH895668	
Chassis No.:	AGH300123538	
Maximum Power Output:	134.0 kW (179 bhp)	
Open Market Value:	\$39,576.00	
Original Registration Date:	27 Jul 2017	
First Registration Date:	27 Jul 2017	
Transfer Count:	0	
Actual ARF Paid:	\$47,407.00	
Intended PARF Rebate Details		
PARF Eligibility:	Yes	
PARF Eligibility Expiry Date:	26 Jul 2027	
PARF Rebate Amount:	\$35,555.00	
Intended COE Rebate Details		
COE Expiry Date:	26 Jul 2027	
COE Category:	B - Car above 1600cc or 97kW (130bhp)	
COE Period(Years):	10	
QP Paid:	\$50,001.00	
COE Rebate Amount:	\$36,600.00	
Total Rebate Amount:	\$72,155.00	

The information contained herein is correct as at 30 Mar 2020

OK

SINGAPORE ACCIDENT STATEMENT

IMPORTANT NOTICE

1. Please report correctly the details of the accident to speed up the claims process.
2. This Form must be completed by the Policyholder and/or the Authorised Driver.
3. Information provided must be as truthful and accurate as possible. Any wilful misrepresentation or withholding of material facts may allow insurance companies to repudiate policy liability.
4. The issue and acceptance of this Form by insurance companies is not an admission of policy liability on the part of the insurance companies.
5. **Any false reporting may be referred to the Police for investigation.**
6. This report will be forwarded by the insurers of the GIA Records Management Centre established by the General Insurance Association of Singapore (GIA) for archiving and that copies of this report will, for a fee, be made available upon application by interested parties.
7. By the lodgement of this report to the insurers, you hereby consent to the archiving of this report at the centre and to copies of the report being made available aforesaid.

ACCIDENT STATEMENT

Date Of Report	25/03/2020 16:26
Date Of Accident	25/03/2020 11:45
Exact Location Of Accident	SENGKANG E ROAD
Country/State of Loss	SINGAPORE

DETAILS OF OWN VEHICLE

Vehicle Registration Number	SLR2000A
Insured/Policyholder	
Name Of Registered Owner	LOW LEE TICK
NRIC No	SXXXX584J
Email Address	NOEMAIL
Mobile Phone No	(LOCAL) +65-83224896
Alternative Phone No	OTHERS-83224896

Vehicle Particulars

Manufacturer	TOYOTA
Model	VELLFIRE

Exact Purpose for which vehicle was being used at time of accident

Are you claiming under your own insurance policy for repair to your vehicle? NO

If No, Please state action to be taken THIRD PARTY

Vehicle Category PRIVATE CAR

Insurance Company

Name of Insurance Company	LIBERTY INSURANCE PTE LTD
Type Of Coverage	COMPREHENSIVE
Fleet Policy	NO
Policy Number	SI19V07979/VPE/R01
Cover Note Number	

Driver

Name of Driver	LOW LEE TICK
NRIC No	SXXXX584J
Date Of Birth	31/07/1974
Occupation	OUTDOOR
Date Of Driving Pass	18/09/2003
Driving Experience	16 YEARS AND 6 MONTHS
Gender	MALE
Mobile Number	(LOCAL) +65-83224896
Fax Number	
Contact Number	OTHERS-83224896
Email Address	NOEMAIL

Address	31 YISHUN STREET 51 #04-23
Postcode	767990
Was driver an employee of the Insured's Company	NO
If No, Relationship of the Driver with the Insured	OWNER
Vehicle Registration Number of Driver's Own Vehicle	-
	-
Insurance Company of Driver's Own Vehicle	-
	-

General Information of the Accident

Type Of Accident	COLLISION - CHANGE/CROSS LANE
Weather Conditions	CLEAR
Road Surface	DRY

Other Information

Was any foreign vehicle involved in this accident?	NO
Number of vehicles (including own vehicle) involved in the accident	2
Was any body injured in the Accident?	NO
Was any injured conveyed to hospital by ambulance?	NO
Was any other material or property damaged?	YES
I have been approached by unknown person(s) soliciting/offering accident claims assistance.	NO
Number of Passengers (Including Driver)	1

Details of Police Action

Was the accident reported to the police?	NO
If Yes, Please state which Police Station	
Was notice of intended Prosecution given?	NO
If Yes, against whom?	

Circumstances of Accident

REFER TO SKETCH PLAN.

Attachment(s)

Are accident photos available for attachment?	YES
Was there any video captured by Car Camera?	YES
Remarks/ Reasons:	WITH WORKSHOP - HC AUTO
Was there any audio recorded?	NO

DETAILS OF OTHER VEHICLE PROPERTY 1

Vehicle Registration Number	SGZ3090A
Vehicle Make/Model/Colour	HONDA CROSSROAD
Details Of Properties	
Vehicle Category	PRIVATE CAR
Name of Driver	NUR ZULFAKAR BIN ABU
NRIC/Passport Number	SXXXX802Z
Contact Number	93297214
Address	
Postcode	
Insurance Company Name	
Nature Of Damage	
No. Of Passenger (Including Driver)	

SKETCH PLAN

IMPORTANT NOTICE

1. Please report correctly the details of the accident to speed up the claims process.
2. This Form must be completed by the Policyholder and/or the Authorised Driver.
3. Information provided must be as truthful and accurate as possible. Any wilful misrepresentation or withholding of material facts may allow insurance companies to repudiate policy liability.
4. The issue and acceptance of this Form by insurance companies is not an admission of policy liability on the part of the Insurance companies.
5. Any false reporting may be referred to the Police for investigation.
6. The report will be forwarded by the insurers of the GIA Records Management Centre established by the General Insurance Association of Singapore (GIA) for archiving and that copies of this report will for a fee be made available upon application by interested parties.
7. By the lodgment of this report to the Insurers, you hereby consent to the archiving of this report at the centre and to copies of the report being made available aforesaid.
8. **Consent under the Personal Data Protection Act (PDPA)**

I understand, acknowledge, agree and consent that:

- (a) My insurer, my workshop and the General Insurance Association of Singapore ("GIA") may/are permitted to collect, use, disclose and/or process my personal data/personal information set out in this [form] and any other personal information provided by me or possessed by my insurer (collectively the "Personal Information") and disclose and transfer such Personal Information to all insurer(s) who have insured vehicle(s) involved in this accident (all insurer(s) who have insured vehicle(s) involved in this accident shall be collectively referred to as the "Insurers"), the insurers' lawyers/law firms, the Monetary Authority of Singapore and any relevant government agency/authority (such as the police), for the purpose(s) of:
 - (i) processing, handling and/or dealing with my claims including the settlement of the claims and any necessary investigations relating to the claims;
 - (ii) investigating the accident and/or my claims;
 - (iii) carrying out and/or dealing with my instructions or responding to any enquiries by me;
 - (iv) administering my claims (including the mailing of correspondence, statements, invoices, reports or notices to me, which could involve disclosure of certain personal data about me to bring about delivery of the same as well as on the external cover of envelopes/mail packages); and/or
 - (v) complying with applicable law in administering, processing, handling and/or dealing with my claims. (collectively the "Purposes")
- (b) all insurer(s) who have insured vehicle(s) involved in this accident and the insurers' lawyers/law firms, may/are permitted to collect, use, disclose and/or process my Personal Information for one or more of the above Purposes; and
- (c) my Personal Information may/can be disclosed by any of the Insurers and/or GIA to their third party service providers or agents (including their lawyers/law firms), which may be sited outside of Singapore, for one or more of the above Purposes.
- (d) my Personal Information will also be collected and used to compile claims history for the purpose of fraud detection, investigation and management in present and all future claims.
- (e) the information so collected under (d) above may be shared / disclosed:
 - (i) to all insurers and/or any other third parties that assist in evaluating, investigating, controlling or managing fraud, regulators, law enforcement and government agencies as reasonably required for the purposes stated, or
 - (ii) for complying with requirements under any regulations, laws or court orders.

Policyholder's Signature

Date & Time:

25 MAR 2020

Driver's Signature

(If driver is not the policyholder)

Date & Time:

25 MAR 2020

Reporting Centre Personnel's Signature

Name:

NRIC/FIN No.:

Jenny Lim

SKETCH PLAN

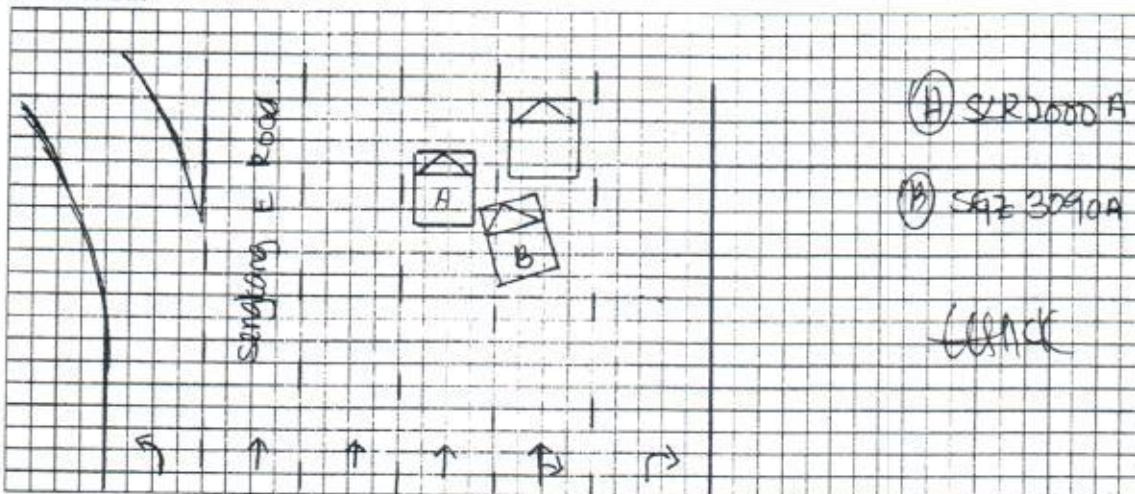

DESCRIBE CIRCUMSTANCES OF THE ACCIDENT

On 25/3/2020 at about 1145 hours, while I was driving my motor vehicle A SRJ2000A along Sengkang E Road at the third lane from my right, keeping within my lane. Green light on my favour. Suddenly, I felt an impact from my right. I realised that was motor vehicle B SGP 3090A which was driving on my right cut into my lane and his front left portion hit onto the rear right portion of my motor vehicle A SRJ2000A. No one was injured. I'm lodging this report to claim against the insurer of SGP 3090A.

CRASH

DECLARATION

I/We declare the foregoing particulars are true in every respect.

Policyholder's Signature

Date & Time: 25 MAR 2020

Driver's Signature

(If driver is not the policyholder)

Date & Time: 25 MAR 2020

Reporting Centre Personnel's Signature

Name: Jenny Lim

NRIC/FIN No.:

H C AUTO PTE LTD

Block 20 Sector A Sin Ming Ind. Est. # 01-20 Singapore 575678

Tel : 6457 0678 Fax : 6457 8287

Co. Reg. GST No. : 20082 0153N

Date : 25 / 03 / 2020

ESTIMATE COSTS OF REPAIR

Mr Low Lee Tick

C/o 160 Sin Ming Drive

05-09 Sin Ming Auto City

Singapore 575722

Dear Sir / Madam ,

Vehicle no. : SLR 2000 A - Toyota Vellfire 2.5

Accident date : 25 / 03 / 2020

Not Notified

11 Days

*Resurvey After Paint
9 days*

Quantity	Descriptions	Amounts
1	1 pc rear bumper	<i>CRW</i> \$ 2,240.00 ✓
2	1 pc o/s rear bumper side retainer 1	\$ <i>DI</i> 176.00 ✓
3	1 pc o/s rear bumper side retainer 2	\$ <i>DI</i> 176.00 ✓
4	1 pc o/s rear bumper side cover	<i>Bul</i> \$ <i>AD</i> 368.00 ✓
5	1 pc o/s rear bumper reflector	\$ <i>BR</i> 128.00 ✓
6	1 pc rear bumper tow cover	\$ <i>IN</i> 64.00 X
7	1 pc o/s rear bumper top cover	\$ <i>ASP</i> 438.75 X
8	2 pcs rear bumper clip 1 @ 4.80	\$ <i>IN</i> 9.60 ✓
9	1 pc rear weather strip	\$ <i>IN</i> 448.00 X
10	1 pc o/s rear fender	<i>DI</i> \$ 1,920.00 ✓
11	1 pc o/s rear fender inner garnish	\$ <i>IN</i> 1,644.00 X
12	1 pc o/s rear fender quarter glass molding	\$ <i>IN</i> 108.00 ✓
13	1 pc o/s rear fender low protector	\$ <i>DI</i> 352.00 ✓
14	1 pc o/s rear sliding door	<i>DI</i> \$ 3,040.00 ✓
15	1 pc o/s rear sliding door inner lock	\$ <i>IN</i> 1,120.00 X
16	1 pc o/s rear sliding door protector	<i>DI/WAG</i> 944.00 ✓
17	1 pc o/s rear sliding door rubber	\$ <i>IN</i> 528.00 X
18	1 pc o/s rear sliding door regulate gear	\$ 304.00 ?
19	1 pc o/s rear sliding door regulate gear motor	\$ 896.00 ?
20	1 pc o/s rear sliding door centre rail	\$ <i>IN</i> 480.00 X
21	1 pc o/s rear sliding door auto motor	\$ 2,640.00 ?
22	1 pc o/s rear sliding door glass outer molding	\$ <i>IN</i> 320.00 X
23	1 pc o/s rear sliding door inner trim	\$ <i>IN</i> 1,216.00 X
24	1 pc o/s rear sliding door top roller	\$ <i>IN</i> 144.00 X
25	1 pc o/s rear sliding door bottom roller	\$ 224.00 ?
26	1 pc o/s rear sliding door centre roller	\$ <i>IN</i> 256.00 X
27	2 pcs o/s rear sliding door rail 1 @ 208.00 (top & bottom)	\$ 416.00 ?
28	2 pcs rear lower arm 1 @ 640.00	\$ 1,280.00 ?
29	1 pc o/s rear upper arm	\$ 688.00 ?
	Balance C/FD	\$ 22,568.35

H C AUTO PTE LTD

Block 20 Sector A Sin Ming Ind. Est. # 01-20 Singapore 575678

Tel : 6457 0678 Fax : 6457 8287

Co. Reg. GST No. : 20082 0153N

Balance B/FD (SLR 2000 A)

\$ 22,568.35

30	1 pc	o/s rear knuckle arm
31	1 pc	o/s rear knuckle arm bearing
32	1 pc	o/s rear trailing arm
33	1 pc	o/s rear wheel hub bearing
34	1 pc	o/s rear shock absorber
35	1 pc	o/s rear bumper lower side garnish

\$	1,056.00	?
\$	637.00	?
\$	480.00	X
\$	960.00	?
\$	256.00	X
\$	83.50	✓
\$	26,040.85	
\$	6,510.21	
\$	19,530.64	

Less 25%

36	1 pc	rear bumper lower lip
37	1 set	rear bumper reverse sensor
38	1 pc	o/s rear quarter glass inner seal
39	1 pc	o/s rear quarter glass inner gum
40	1 pc	o/s rear wheel rim P1?
41	1 pc	o/s rear wheel tyre (Michelin 225/35ZR20)
42	1 pc	rear end panel seal

CM	\$	2,500.00	sn	✓
sm	\$	2,048.00	sn	X
	\$	60.00	sn	30sn
	\$	60.00	sn	40sn
Pd1 set	\$	2,800.00	sn	✓
	\$	580.00	sn	X
	\$	256.00	sn	30sn
\$		27,834.64		

Labour charges
To putty and spray painting
To check wiring
To re-seal anti rust
Remove and refix rear undercarriage
To check wheel alignment
To transfer o/s rear door
Remove and refix rear quarter glass
Remove and refix reverse sensor
Remove and refix cushion seat, garnish, carpet & etc.

\$	2,000.00	900l
\$	1,600.00	1200l
\$	160.00	20l
\$	250.00	60l
\$	450.00	?
\$	100.00	60l
\$	160.00	80l
\$	320.00	80l
\$	100.00	50l
\$	450.00	120l
\$	33,424.64	

Plus : 7% GST

Grand total

\$ 2,339.72
\$ 35,764.36

LKK Auto Consultants hence notify the Repairer of the following:

- To resurvey before/after spray painting
- To display damaged part(s) during resurvey
- Parts prices are subject to confirmation
- Third party survey is on a "Without Prejudice" basis
- No illegal modification(s) is allowed
- Supplementary item(s) must be resurveyed and is subject to final approval from Insurance Company

Acknowledged by Repairer

Signature:

Date:

Work Order: R037291
VIN: SLR2000A
Year: 17
Date: 27.3.20 10:55



SLR2000A

Factory Japan 2019.0.2 : Toyota : Alphard / Vellfire : H30 Series : AGH30W

Front : Left

Actual	Before	Specified Range
-0°16'	-0°16'	-1°00' 0°30'
6°08'	6°08'	5°10' 6°40'
-0°28'	-0°29'	-0°02' 0°08'
11°46'	11°46'	10°50' 12°20'
11°30'	11°30'	9°50' 12°50'

Camber
Caster
Toe
SAI
Included Angle
Turning Angle Diff.

Front : Right

Actual	Before	Specified Range
-0°13'	-0°13'	-1°00' 0°30'
6°20'	6°20'	5°10' 6°40'
-0°24'	-0°25'	-0°02' 0°08'
11°31'	11°31'	10°50' 12°20'
11°18'	11°18'	9°50' 12°50'

Front

Cross Camber
Cross Caster
Cross SAI
Total Toe
Cross Turn Diff.

Actual	Before	Specified Range
-0°03'	-0°02'	-0°45' 0°45'
-0°12'	-0°12'	-0°45' 0°45'
0°15'	0°14'	
-0°53'	-0°53'	-0°05' 0°15'

Rear : Left

Actual	Before	Specified Range
-1°13'	-1°13'	-1°30' 0°00'
0°03'	0°03'	0°03' 0°12'

Camber
Toe

Rear : Right

Actual	Before	Specified Range
-3°25'	-3°25'	-1°30' 0°00'
-0°22'	-0°23'	0°03' 0°12'

Rear

Cross Camber
Total Toe
Thrust Angle
Axle Offset

Actual	Before	Specified Range
2°12'	2°12'	-0°45' 0°45'
-0°19'	-0°20'	0°05' 0°25'
0°13'	0°13'	
0mm	0mm	