

SINGAPORE ACCIDENT STATEMENT

IMPORTANT NOTICE

1. Please report correctly the details of the accident to speed up the claims process.
2. This Form must be completed by the Policyholder and/or the Authorised Driver.
3. Information provided must be as truthful and accurate as possible. Any wilful misrepresentation or withholding of material facts may allow insurance companies to repudiate policy liability.
4. The issue and acceptance of this Form by insurance companies is not an admission of policy liability on the part of the insurance companies.
5. Any false reporting may be referred to the Police for investigation.
6. This report will be forwarded by the insurers of the GIA Records Management Centre established by the General Insurance Association of Singapore (GIA) for archiving and that copies of this report will, for a fee, be made available upon application by interested parties.
7. By the lodgement of this report to the insurers, you hereby consent to the archiving of this report at the centre and to copies of the report being made available aforesaid.

ACCIDENT STATEMENT

Date Of Report	10/02/2020 15:14
Date Of Accident	16/01/2020 18:55
Exact Location Of Accident	ALONG JALAN MEMBINA STOPPED @ TRAFFIC LIGHT
Country/State of Loss	SINGAPORE

DETAILS OF OWN VEHICLE

Vehicle Registration Number	SGZ1527X
Insured/Policyholder	
Name Of Registered Owner	SEE GEOK SEK
NRIC No	SXXXX269D
Email Address	KELLYSEE708@YAHOO.COM.SG
Mobile Phone No	(LOCAL) +65-90053589
Alternative Phone No	OFFICE-90053589

Vehicle Particulars

Manufacturer	HONDA
Model	STREAM-1.8 (A)
Exact Purpose for which vehicle was being used at time of accident	
Are you claiming under your own insurance policy for repair to your vehicle?	NO
If No, Please state action to be taken	THIRD PARTY
Vehicle Category	PRIVATE CAR

Insurance Company

Name of Insurance Company	DIRECT ASIA INSURANCE (SINGAPORE) PTE LTD
Type Of Coverage	COMPREHENSIVE
Fleet Policy	NO
Policy Number	MT/00708711
Cover Note Number	

Driver

Name of Driver	SEE GEOK SEK
NRIC No	SXXXX269D
Date Of Birth	03/03/1972
Occupation	INDOOR
Date Of Driving Pass	04/10/2002
Driving Experience	17 YEARS AND 3 MONTHS
Gender	FEMALE
Mobile Number	(LOCAL) +65-90053589
Fax Number	
Contact Number	OFFICE 90053589

Address	26 B JALAN MEMBINA #18-200 SINGAPORE
Postcode	165026
Was driver an employee of the Insured's Company	NO
If No, Relationship of the Driver with the Insured	OWNER
Vehicle Registration Number of Driver's Own Vehicle	-
	-
	-
Insurance Company of Driver's Own Vehicle	-
	-
	-

General Information of the Accident

Type Of Accident	COLLISION - HEAD TO REAR
Weather Conditions	CLEAR
Road Surface	DRY

Other Information

Was any foreign vehicle involved in this accident?	NO
Number of vehicles (including own vehicle) involved in the accident	2
Was any body injured in the Accident?	NO
Was any injured conveyed to hospital by ambulance?	NO
Was any other material or property damaged?	YES
I have been approached by unknown person(s) soliciting/offering accident claims assistance.	NO
Number of Passengers (Including Driver)	1

Details of Police Action

Was the accident reported to the police?	NO
If Yes, Please state which Police Station	
Was notice of intended Prosecution given?	NO
If Yes, against whom?	

Circumstances of Accident

PLEASE REFER TO ATTACHED

Attachment(s)

Are accident photos available for attachment?	YES
Was there any video captured by Car Camera?	NO
Was there any audio recorded?	NO

DETAILS OF OTHER VEHICLE PROPERTY 1

Vehicle Registration Number	SLQ5943P
Vehicle Make/Model/Colour	
Details Of Properties	
Vehicle Category	PRIVATE CAR
Name of Driver	
NRIC/Passport Number	
Contact Number	
Address	
Postcode	
Insurance Company Name	
Nature Of Damage	
No. Of Passenger (Including Driver)	

SKETCH PLAN**IMPORTANT NOTICE**

1. Please report correctly the details of the accident to speed up the claims process.
2. This Form must be completed by the Policyholder and/or the Authorised Driver.
3. Information provided must be as truthful and accurate as possible. Any wilful misrepresentation or withholding of material facts may allow insurance companies to repudiate policy liability.
4. The issue and acceptance of this Form by insurance companies is not an admission of policy liability on the part of the insurance companies.
5. Any false reporting may be referred to the Police for investigation.
6. The report will be forwarded by the insurers of the GIA Records Management Centre established by the General Insurance Association of Singapore (GIA) for archiving and that copies of this report will for a fee be made available upon application by interested parties.
7. By the lodgment of this report to the insurers, you hereby consent to the archiving of this report at the centre and to copies of the report being made available aforesaid.
8. **Consent under the Personal Data Protection Act (PDPA)**

I understand, acknowledge, agree and consent that:

- (a) My insurer, my workshop and the General Insurance Association of Singapore ("GIA") may/are permitted to collect, use, disclose and/or process my personal data/personal information set out in this [form] and any other personal information provided by me or possessed by my insurer (collectively the "Personal Information") and disclose and transfer such Personal Information to all insurer(s) who have insured vehicle(s) involved in this accident (all insurer(s) who have insured vehicle(s) involved in this accident shall be collectively referred to as the "Insurers"), the Insurers' lawyers/law firms, the Monetary Authority of Singapore and any relevant government agency/authority (such as the police), for the purpose(s) of:
 - (i) processing, handling and/or dealing with my claims including the settlement of the claims and any necessary investigations relating to the claims;
 - (ii) investigating the accident and/or my claims;
 - (iii) carrying out and/or dealing with my instructions or responding to any enquiries by me;
 - (iv) administering my claims (including the mailing of correspondence, statements, invoices, reports or notices to me, which could involve disclosure of certain personal data about me to bring about delivery of the same as well as on the external cover of envelopes/mail packages); and/or
 - (v) complying with applicable law in administering, processing, handling and/or dealing with my claims. (collectively the "Purposes")
- (b) all insurer(s) who have insured vehicle(s) involved in this accident and the insurers' lawyers/law firms, may/are permitted to collect, use, disclose and/or process my Personal Information for one or more of the above Purposes; and
- (c) my Personal Information may/can be disclosed by any of the Insurers and/or GIA to their third party service providers or agents (including their lawyers/law firms), which may be sited outside of Singapore, for one or more of the above Purposes.
- (d) my Personal Information will also be collected and used to compile claims history for the purpose of fraud detection, investigation and management in present and all future claims.
- (e) the information so collected under (d) above may be shared / disclosed:
 - (i) to all insurers and/or any other third parties that assist in evaluating, investigating, controlling or managing fraud, regulators, law enforcement and government agencies as reasonably required for the purposes stated, or
 - (ii) for complying with requirements under any regulations, laws or court orders.

Policyholder's Signature
Date & Time:

10/2/2020

... hrc

Driver's Signature
(If driver is not the policyholder)
Date & Time:

Reporting Centre Personnel's Signature
Name:
NRIC/FIN No.:

Accident Toolkit

Sketch plan

Sketch of accident scene:

Please illustrate the layout of roads with arrows showing the direction and position of vehicles at the time of impact. Also please note the road names, road signs and vehicle registration numbers.

If safe, please take photos or videos from all angles.

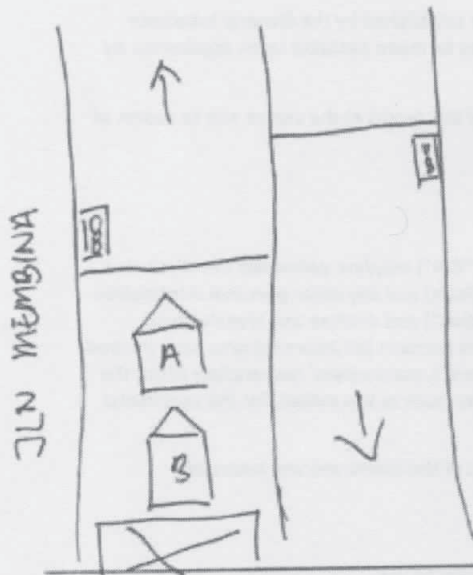

I was driving veh A along Jalan Membina on 16th Jan 2020 at about 18:55 hrs. I was stop at the traffic light as it turns red. Suddenly I felt an impact from the rear. Veh B collided on to me. Owner of Veh B came down and shouted at me. There fore i was loss at that moment. Veh B proposed to private settle and I did not thing much as it was a small damage and I do not want more hassle. I agreed. But after a few weeks Veh B

Please indicate on vehicle A (your vehicle) and, vehicle B (third party vehicle), the point of impact and area(s) of visible damage with an arrow.

decided to do an insurance claim and it wasn't my fault so I agreed.

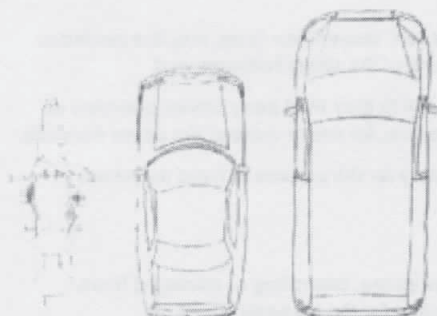

Vehicle A
(SGZ1527X)

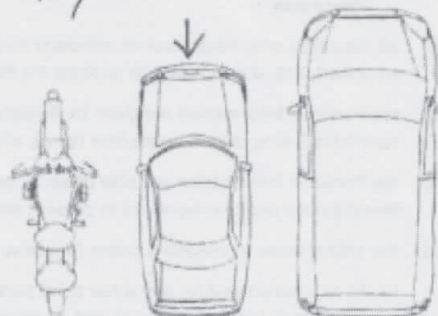

Vehicle B
(SLQ5943P)

direct
asia
• insurance

[Signature]

10/2/2020

Call us direct

Customer Care
6665 5555

Claims Support 24/7 Hotline
6532 1818

*85 8003 1889 (from overseas)