

SINGAPORE ACCIDENT STATEMENT

IMPORTANT NOTICE

1. Please report correctly the details of the accident to speed up the claims process.
2. This Form must be completed by the Policyholder and/or the Authorised Driver.
3. Information provided must be as truthful and accurate as possible. Any wilful misrepresentation or withholding of material facts may allow insurance companies to repudiate policy liability.
4. The issue and acceptance of this Form by insurance companies is not an admission of policy liability on the part of the insurance companies.
5. Any false reporting may be referred to the Police for investigation.
6. This report will be forwarded by the insurers of the GIA Records Management Centre established by the General Insurance Association of Singapore (GIA) for archiving and that copies of this report will, for a fee, be made available upon application by interested parties.
7. By the lodgement of this report to the insurers, you hereby consent to the archiving of this report at the centre and to copies of the report being made available aforesaid.

ACCIDENT STATEMENT

Date Of Report	02/01/2020 15:34
Date Of Accident	31/12/2019 15:55
Exact Location Of Accident	LORONG 23 GEYLANG
Country/State of Loss	SINGAPORE

DETAILS OF OWN VEHICLE

Vehicle Registration Number	SMQ4902C
Insured/Policyholder	
Name Of Registered Owner	AUTO ALLIANCE LEASING PTE. LTD.
Co Reg No	2XXXXX807W
Email Address	NOEMAIL
Mobile Phone No	
Alternative Phone No	OFFICE-97552383

Vehicle Particulars

Manufacturer	HYUNDAI
Model	AVANTE
Exact Purpose for which vehicle was being used at time of accident	PRIVATE USE
Are you claiming under your own insurance policy for repair to your vehicle?	NO
If No, Please state action to be taken	THIRD PARTY
Vehicle Category	PRIVATE CAR

Insurance Company

Name of Insurance Company	NTUC INCOME INSURANCE CO-OPERATIVE LTD
Type Of Coverage	COMPREHENSIVE
Fleet Policy	YES
Policy Number	5108785749
Cover Note Number	

Driver

Name of Driver	WONG WEI CNHONG SAMUEL
NRIC No	SXXXX694G
Date Of Birth	17/07/1957
Occupation	OUTDOOR
Date Of Driving Pass	31/12/2014
Driving Experience	5 YEARS AND 0 MONTHS
Gender	MALE
Mobile Number	(LOCAL) +65-93290787
Fax Number	
Contact Number	
EEmail Address	SAMWONGWC@GMAIL.COM

Address	446A JALAN KAYU #07-308
Postcode	791446
Was driver an employee of the Insured's Company	NO
If No, Relationship of the Driver with the Insured	OTHER - HIRER
Vehicle Registration Number of Driver's Own Vehicle	-
	-
	-
Insurance Company of Driver's Own Vehicle	-
	-
	-

General Information of the Accident

Type Of Accident	SIDE SWIPE
Weather Conditions	CLEAR
Road Surface	DRY

Other Information

Was any foreign vehicle involved in this accident?	NO
Number of vehicles (including own vehicle) involved in the accident	2
Was any body injured in the Accident?	NO
Was any injured conveyed to hospital by ambulance?	NO
Was any other material or property damaged?	YES
I have been approached by unknown person(s) soliciting/offering accident claims assistance.	NO
Number of Passengers (Including Driver)	2
Passenger 1	NAME: : SURANAD GENDER: : MALE

Details of Police Action

Was the accident reported to the police?	NO
If Yes, Please state which Police Station	
Was notice of intended Prosecution given?	NO
If Yes, against whom?	

Circumstances of Accident

I WAS TRAVELLING STRAIGHT ALONG GEYLANG LOR 23 TWDS SIMS AVE. SUDDENLY VEH B FROM MY LEFT MAKE A RIGHT TURN AND COLLIDED ONTO MY VEH.

Attachment(s)

Are accident photos available for attachment?	YES
Was there any video captured by Car Camera?	YES
Remarks/ Reasons:	WITH WORKSHOP
Was there any audio recorded?	NO

DETAILS OF OTHER VEHICLE PROPERTY 1

Vehicle Registration Number	SLD9633B
Vehicle Make/Model/Colour	
Details Of Properties	
Vehicle Category	PRIVATE CAR
Name of Driver	CHERN SOON BENG
NRIC/Passport Number	SXXXX465D
Contact Number	82669857
Address	
Postcode	

Insurance Company Name
Nature Of Damage
No. Of Passenger (Including Driver)

Accident Sketch Plan

SKETCH PLAN

IMPORTANT NOTICE

1. Please report correctly the details of the accident to speed up the claims process.
2. This Form must be completed by the Policyholder and/or the Authorised Driver.
3. Information provided must be as truthful and accurate as possible. Any wilful misrepresentation or withholding of material facts may allow insurance companies to repudiate policy liability.
4. The issue and acceptance of this Form by insurance companies is not an admission of policy liability on the part of the insurance companies.
5. Any false reporting may be referred to the Police for investigation.
6. The report will be forwarded by the insurers of the GIA Records Management Centre established by the General Insurance Association of Singapore (GIA) for archiving and that copies of this report will for a fee be made available upon application by interested parties.
7. By the lodgment of this report to the insurers, you hereby consent to the archiving of this report at the centre and to copies of the report being made available aforesaid.

8. Consent under the Personal Data Protection Act (PDPA)

I understand, acknowledge, agree and consent that:

- (a) My insurer, my workshop and the General Insurance Association of Singapore ("GIA") may/are permitted to collect, use, disclose and/or process my personal data/personal information set out in this [form] and any other personal information provided by me or possessed by my insurer (collectively the "Personal Information") and disclose and transfer such Personal Information to all insurer(s) who have insured vehicle(s) involved in this accident (all insurer(s) who have insured vehicle(s) involved in this accident shall be collectively referred to as the "Insurers"), the Insurers' lawyers/law firms, the Monetary Authority of Singapore and any relevant government agency/authority (such as the police), for the purpose(s) of:
 - (i) processing, handling and/or dealing with my claims including the settlement of the claims and any necessary investigations relating to the claims;
 - (ii) investigating the accident and/or my claims;
 - (iii) carrying out and/or dealing with my instructions or responding to any enquiries by me;
 - (iv) administering my claims (including the mailing of correspondence, statements, invoices, reports or notices to me, which could involve disclosure of certain personal data about me to bring about delivery of the same as well as on the external cover of envelopes/mail packages); and/or
 - (v) complying with applicable law in administering, processing, handling and/or dealing with my claims. (collectively the "Purposes")
- (b) all insurer(s) who have insured vehicle(s) involved in this accident and the Insurers' lawyers/law firms, may/are permitted to collect, use, disclose and/or process my Personal Information for one or more of the above Purposes; and
- (c) my Personal Information may/can be disclosed by any of the Insurers and/or GIA to their third party service providers or agents (including their lawyers/law firms), which may be sited outside of Singapore, for one or more of the above Purposes.
- (d) my Personal Information will also be collected and used to compile claims history for the purpose of fraud detection, investigation and management in present and all future claims.
- (e) the information so collected under (d) above may be shared / disclosed:
 - (i) to all insurers and/or any other third parties that assist in evaluating, investigating, controlling or managing fraud, regulators, law enforcement and government agencies as reasonably required for the purposes stated, or
 - (ii) for complying with requirements under any regulations, laws or court orders.



Policyholder's Signature
Date & Time:

Driver's Signature
(if driver is not the policyholder)
Date & Time:

2/1/2020

Reporting Centre Personnel's Signature
Name:
NRIC/FIN No.:

2/1/2020

Accident Sketch Plan

SKETCH PLAN

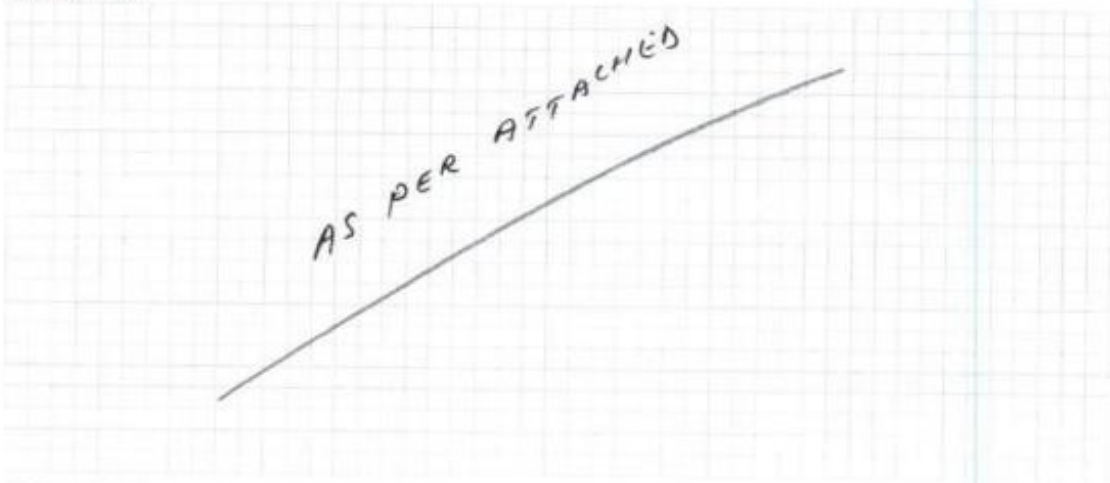

DESCRIBE CIRCUMSTANCES OF THE ACCIDENT

P/s refer to the statement.

DECLARATION

I/We declare the foregoing particulars are true in every respect.

Policyholder's Signature
Date & Time:



Driver's Signature
(If driver is not the policyholder)
Date & Time:

2/1/2020

Reporting Centre Personnel's Signature
Name:
NRIC/FIN No.:

[Signature] *02/01/20*

Accident Sketch Plan

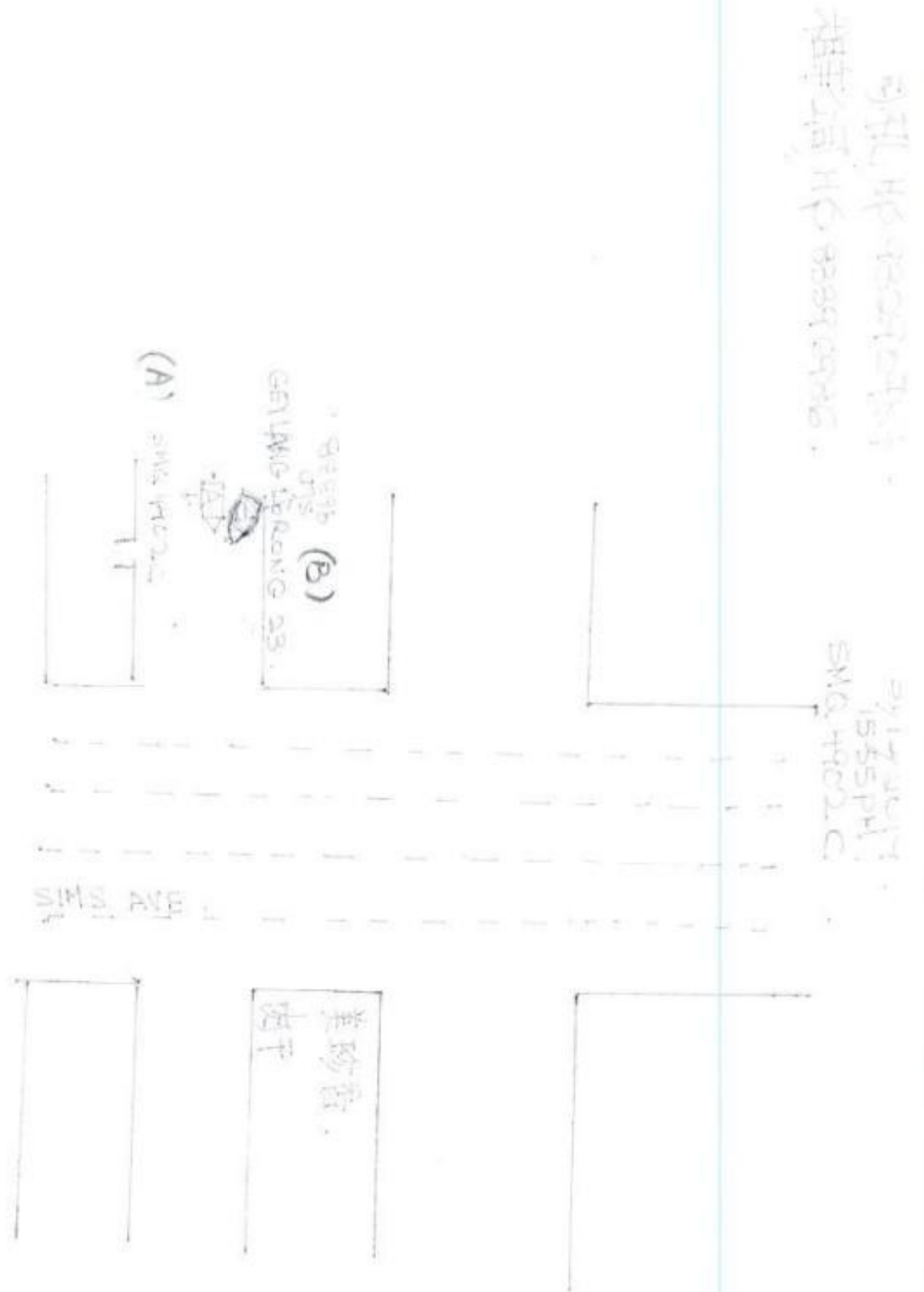

Accident Photo



Accident Photo



Accident Photo



Accident Photo



Accident Photo



Accident Photo



Accident Photo



Accident Photo



Accident Photo



Accident Photo



Accident Photo



Accident Photo



Accident Photo



Accident Photo



Accident Photo



Accident Photo



Accident Photo



Accident Photo



Accident Photo



Accident Photo



Accident Photo



Accident Photo



Accident Photo



Accident Photo



Accident Photo



Accident Photo

