

2205/200

REF: CS310 19017631 Q+ 134-1 Special Instruction

ISS REL BY:

Sun Pin

ASSIGNMENT (Office)

17/12/19

Surveyor
MUMMEN
From (Person):

Gabriel Wee

of

TH

Date/Time:

Estimated Cost:

Bill to:

OD / TP / WS / TP RES / OD RES / EVA / INV / MV / CS

To Inspect Vehicle No:

SLW 4031X

Insured:

SIC 1114M

at Workshop n/s:

365 Automotive

Tel:

916 9 0825

of

25 Kaki Bukit Rd 4 #01-55 synergy

Policy No

MCOM0015

Claim No:

MCT19100098

Sum Insured:

Excess:

D.O.A 5.10.19

Make of Veh:

(Client's Record)

CA / REV / REP. / REV 24 HRS

Date/Time: 8.10.19 10/10 a.m

Person Contracted

Rei Jie

H.O.D. Appointment

Vehicle IN/OUT

Date/Time	Action/Instruction (X) Estimate
	SLW 4031X - X
	SIC 1114M - N/S IN L13021196 / L14122 DOA - 04/12/2019
	Diamond: 9/10/2019 1.17pm
	After repair: 11/10/2019 4.17pm
	lump sum \$2100 (Red. 1600) 43% 4 days

23/12 File pass to typist

23/12/2019

ASSIGNED BY: Sun Pin.

REF: TH

ASSIGNMENT

From:

Date:

9.10.2019

Veh No:

SLW 4031X

Yr Regn 09/Feb/2018

Type: ☒ M Car

M.Cycle / Bus / Van / Lorry / Taxi / Prime Mover /

Truck / Trailer or

Make:

Toyota C-HR HYBRID

C.G 1797

Colour:

Blue.

A/C: Insured / Std / NI / NA

Sp. Reading:

156882

T/Radio: Insured / Std / NI / NA

Eng No:

-

C/No:

ZYX102087495

Gen. Cond: Good / ☒ Fair / Poor / Burnt

Steering: ☒ In order / Jammed / Leaked / Burnt or

Brake: ☒ In order / Jammed / Leaked / Burnt or

Modi: Nil / ☒ S/Rim / STD A/Rim or

Tyre Size:

F: 215/60 R17

R: 215/60 R17

BS / DUN / EXNOVA / GY / FS / LIZA / MIC / OHTSU / PIR / SUMI /

TOYO / YOKO or

Kapsen

Front

Rear

R/Bal. 6 mm

R/Bal. 6 mm

L/Bal. 6 mm

L/Bal. 6 mm

D.O.A. 05/10/2019

D.O.I. 08/10/2019 2-26pm

Survey held at

365 Automotive.

Des. of Damages: Frt / Rear / ☒ O/S / N/S / U/C / Rooftop or

The U/C / Chassis frame / Body Structure affected due to collision.

Estimated Cost:

OD / IP / WS / TP RES / OD RES / EVA / INV / MV

To inspect Vehicle No: SLW 4031X

at Workshop m/s 365 Automotive

of 25 kaki Bukit Rd 4 #01-55 synergy

Insured

Policy No.

Claims No.

Sum Insured:

Excess:

(Client's Record)

Make of Veh:

(Policy Condition)

Remark: The veh had commenced its repair at the time of inspection.

N/S	O/S

Bal. or Market Value:

IDAC Accident Report:

Consistent? : Yes or No

GIA / PR Seen:

Consistent? : Yes or No

Est. Repairs:

4 days

Res.: Yes or No

Lum Sum:

%

3 Val: Yes or No

CA / REV / REP. / 24 HRS

Vehicle: IN / OUT

Date:

Person Contacted:

Date / Time

Action / Instruction

PRS Case.

MV: 93,000

PV: 41,890

NV: 51,150

MV - 92-9310

Repair Range: 3k-4k

Repair Days: 3 days

Date/Time, File Pass in?

☐

: Prel. Report

1)

☐

: Final Report

Date/Time, File Return in?

2)

Req. Form:

PRS.

Comp. Sum / Rep. Fee:

Days Of Repair:

Resurvey No. of Trip: 2

Add Fee:

☐

Site Insp (\$

☐

Interview (\$

☐

Tech. Insp (\$

☐

Week end (\$

Survey Fee:

Transportation:

3 + PG. 01

Phone:

Notes:

Page 1

Summer Lee (LKK Auto)

From: Stanley Lai <stanley.lai@iii.com.sg>
Sent: Monday, 16 December, 2019 5:42 PM
To: Nivitha (LKK Auto); 'sur@lkkauto.com'
Cc: Mekavathanan Sarangapani; Pooi Chin Han Daniel
Subject: III REF: MCT19100098 | REQUEST PAPER SURVEY TP VEH SLW4031X

Dear Sir/Mdm,

Please conduct paper survey for the below TP vehicle and let us have your report urgently. LOD uploaded and rights granted to you in Merimen.

TP Veh No. : SLW4031X

Thank you.

Warmest regards,

Stanley Lai

Motor & Work Injury Claims Department

India International Insurance Pte Ltd

64 Cecil Street, IOB Building, Level 5

Singapore 049711

Tel: 6347 6100 Ext 206 Fax: 6224 4174

S&P 'A-' rated Company



This email is intended solely for the person to whom it has been addressed. It may contain confidential and/or legally privileged information. If you are not the person for whom this e-mail was intended, or if this e-mail has reached you by mistake, please delete it immediately and inform us of the error and also be hereby notified that any use, distribution, transmission, printing, copying or dissemination of this information in any way or in any manner is strictly prohibited and may be unlawful. Internet communications may not be entirely secure or accurate as information could be intercepted, corrupted, lost, delayed or contain viruses. Therefore, we do not accept liability for any errors or omissions in the content of this message or any delay in delivery which may arise as a result of Internet transmission or any modification.

54
SE 131.00 Paid
2017 Veh.

CATHERINE LIM LLC

林 365
An & mclw
ADVOCATES & SOLICITORS
NOTARY PUBLIC - 公证官
玲 COMMISSIONER FOR OATHS - 宣誓官
律
師 CATHERINE C.L.LIM
館 DIRECTOR
LL.B (HONS) SINGAPORE-法律系-律師
M.B.A. (BUSINESS LAW)-商业系-硕士

Our Ref: CL/191143/T/APEX.sg

21 November 2019

India International Insurance Pte Ltd
64 Cecil Street #04-05
IOB Building
Singapore 049711
Attn: Motor Claims Dept

Comfort Transportation Pte Ltd
383 Sin Ming Drive
GAS Building
Singapore 575717

Dear Sir

ACCIDENT INVOLVING SLW 4031X / SHC 1114M ON 5.10.2019 ALONG ANG MO KIO HUB PICK UP POINT

We act for Asia Express Car Rental Pte Ltd, the owner of motor vehicle No. SLW 4031X, which was involved in the above accident.

Our client has suffered loss and damage as a result of your Insured's negligence in the driving of motor vehicle No. SHC 1114M.

We quantify our client's claim as follows:-

1. Cost of Repair	\$3,700.00
2. Loss of use (4 days x \$150)	\$ 600.00
3. Loss of income (4 days x \$305)	\$1,220.00
4. Survey fee	\$ 520.00
5. LTA search fee	\$ 16.00
6. Incidentals, transport & photocopying etc	\$ 53.50
7. Cost contribution	\$ 749.00

\$6,858.50

We enclose herewith photocopies of our client's accident report, LTA search, weekly statement, final repair bill, survey fee, survey report and colour photographs of our client's damaged vehicle for your immediate attention.

Please let us know within the next 14 days from the receipt of this letter, whether you are prepared to admit liability and revert with a settlement proposal, failing which our clients shall have no alternative but to commence legal proceedings against your insured.

Yours faithfully

Encs
cc: clients

(Please note that if your motor vehicle was not driven by you, there is a presumption in law that the said driver was driving as your agent/ servant unless you let us know the particulars of your driver if your motor vehicle was not driven by you.)



20 Havelock Road #03-01
Central Square Singapore 059765
UEN No. 201310922K

Tel: (65) 6438 5500
Fax: (65) 6438 0111
www.catherinelimllc.com
Email: info@catherinelimllc.com
CATHERINE LIM LLC is a law
corporation with limited liability

WITHOUT PREJUDICE

(to the personal injury claim)

BY HAND

CERTIFICATE OF POSTING

(Please be informed that all supporting documents
have been forwarded to your insurer.)

We are in receipt of your letter, which is receiving our attention. We shall revert shortly. Kindly note that we are preserving our right to conduct a full investigation if necessary.

Our Ref: MC7/19100098
Name :
Date : Denise
India International Insurance P.L.

25/11/2019

MC 11141008-18/01/25

Apex ✓
Vine - P.S.

RESERVES		
TPPD	PRESERVE	2
TPPI	PRESERVE	No this reported TPSAs.
UNINSURED LOSS	PRESERVE	
SUBRO	PRESERVE	
LPPN		
INVESTIGATION FEE		
SURVEY FEES		P.S.
LEGAL FEES		
OTHERS		
FRAUD CHECK		
UPLOAD TO MERIMEN		
GRANT RIGHTS		

383 SIN MING DRIVE, SINGAPORE

Ref.. SHC3445U DOL 28.08.2013

Total Payments Released, Gross 6,200.00
Total Payments Released, Net 2,945.00

Reserves		Tran.	Amount (SGD)	Entry by	Entry	Time
Item	Cat					
01/01	M01 LOSS	04/09/2013	5,000.00	HARIS	06/09/2013	08:19
01/01	M01 LOSS	19/06/2014	3,700.00	izzis	19/06/2014	10:25
01/01	M01 LOSS	23/06/2014	3.00-	JONIS	23/06/2014	12:26
01/01	M01 LOSS	08/09/2014	497.00-	haris	08/09/2014	09:32
01/01	M09 EXCESS /INSURED LIAB	08/09/2014	2,000.00-	haris	08/09/2014	09:32
02/01	M01 LOSS	09/09/2014	8,700.00	JONIS	09/09/2014	12:13
03/01	M01 LOSS	06/10/2014	8,700.00	JONIS	06/10/2014	16:59

Total Reserves Entries 23,600.00
Reserves O/S, Gross 17,400.00
Reserves O/S, Net (of all RI) 8,265.00

Summary of Payments & Reserves (SGD)			
Tran.	Payments	Reserves Adjustments	O/S Reserves
Year			
2013		5,000.00	5,000.00
2014	6,200.00	18,600.00	17,400.00

Reinsurance (% share and O/S reserve amount)							
Type	RI Co.	V C.yr	Ces.No.	Recip Policy & Claim	RI%	Entry by	Date Term
STAT	STAT	0	2013	0000662 N Statutory	5.000000	CDGE4	29/08/2013 NO
					SGD870.00		
QUOTA MQ2013	0	2013	0000001 N	MOTOR QUOTA SHARE - 2013	50.000000	CDGE4	29/08/2013 NO
					SGD8,265.00		
Total RI Share of O/S Reserve					SGD9,135.00		

RI Recoveries							
Item	Cat	Orig.trn	Type	RI Co.	Recy.trn	Date	Amount
001/01	M01	Z0545888	STAT	STAT	N/A83030	26/09/2014	410.00
001/01	M01	Z0545888	QUOTA	MQ2013	N/A83031	26/09/2014	3,895.00
001/01	M01	Z0545888	Total recoveries				4,305.00
001/01	M09	W0399700	STAT	STAT	N/A83380	08/09/2014	100.00-
001/01	M09	W0399700	QUOTA	MQ2013	N/A83381	08/09/2014	950.00-
001/01	M09	W0399700	Total recoveries				1,050.00-
Total recoveries grand total							3,255.00

Summary of Payments and Reserves - Gross, RI and Net (SGD)		
	Payments	Reserves
Total Payments Released - Gross.....	6,200.00	
Total Reserve O/S - Gross.....		17,400.00
O/S Reserves, Auto - Stat.....		870.00
O/S Reserves, Auto - QS.....		8,265.00
Recoveries, Auto - Stat.....	310.00	
Recoveries, Auto - QS.....	2,945.00	
Net Total.....	2,945.00	8,265.00

END

 *** TX REPORT ***

TRANSMISSION OK

TX/RX NO 2396
 RECIPIENT ADDRESS 64380111
 DESTINATION ID
 ST. TIME 26/11 18:03
 TIME USE 00'33
 PAGES SENT 2
 RESULT OK

FAXED
 26 NOV 2019
 MOTCLM DEPT.

CATHERINE LIM LLC

林 ADVOCATES & SOLICITORS
 翠 NOTARY PUBLIC - 公证官
 玲 COMMISSIONER FOR OATHS - 宣誓官
 律
 師 CATHERINE C.L.LIM
 館 DIRECTOR
 LL.B (HONS) SINGAPORE - 法律系 - 律師
 M.B.A. (BUSINESS LAW) - 商业系 - 硕士

Our Ref: CL/191143/T/APEX.sg

21 November 2019

India International Insurance Pte Ltd
 64 Cecil Street #04-05
 IOB Building
 Singapore 049711
 Attn: Motor Claims Dept

Comfort Transportation Pte Ltd
 383 Sin Ming Drive
 GAS Building
 Singapore 575717

Dear Sir

ACCIDENT INVOLVING SLW 4031X / SHC 1114M ON 5.10.2019 ALONG ANG MO KIO HUB PICK UP POINT

We act for Asia Express Car Rental Pte Ltd, the owner of motor vehicle No. SLW 4031X, which was involved in the above accident.

Our client has suffered loss and damage as a result of your Insured's negligence in the driving of motor vehicle No. SHC 1114M.

We quantify our client's claim as follows:-

1. Cost of Repair	\$3,700.00
2. Loss of use (4 days x \$150)	\$ 600.00
3. Loss of income (4 days x \$305)	\$1,220.00



20 Havelock Road #03-01
 Central Square Singapore 059765
 UEN No. 201310922K

Tel: (65) 6438 5500
 Fax: (65) 6438 0111
 www.catherinelimllc.com
 Email: info@catherinelimllc.com
 CATHERINE LIM LLC is a law corporation with limited liability

WITHOUT PREJUDICE

(to the personal injury claim)

BY HAND

CERTIFICATE OF POSTING

(Please be informed that all supporting documents have been forwarded to your insurer.)

We are in receipt of your letter, which is receiving our attention. We shall respond shortly. Kindly note that we are preserving our rights to defend our insured.

Our Ref: MC7/19/00098
 Name: Denise
 Date: 26/11/2019
 India International Insurance Pte Ltd

SINGAPORE ACCIDENT STATEMENT

IMPORTANT NOTICE

1. Please report correctly the details of the accident to speed up the claims process.
2. This Form must be completed by the Policyholder and/or the Authorised Driver.
3. Information provided must be as truthful and accurate as possible. Any wilful misrepresentation or withholding of material facts may allow insurance companies to repudiate policy liability.
4. The issue and acceptance of this Form by insurance companies is not an admission of policy liability on the part of the insurance companies.
5. Any false reporting may be referred to the Police for investigation.
6. This report will be forwarded by the insurers of the GIA Records Management Centre established by the General Insurance Association of Singapore (GIA) for archiving and that copies of this report will, for a fee, be made available upon application by interested parties.
7. By the lodgement of this report to the insurers, you hereby consent to the archiving of this report at the centre and to copies of the report being made available aforesaid.

ACCIDENT STATEMENT

Date Of Report	07/10/2019 20:28
Date Of Accident	05/10/2019 17:20
Exact Location Of Accident	AMK HUB PICK UP POINT
Country/State of Loss	SINGAPORE

DETAILS OF OWN VEHICLE

Vehicle Registration Number	SLW4031X
Insured/Policyholder	
Name Of Registered Owner	ASIA EXPRESS CAR RENTAL PTE LTD
Co Reg No	201117597D
Email Address	NOEMAIL
Mobile Phone No	(LOCAL) +65-83216316
Alternative Phone No	OFFICE-83216316

Vehicle Particulars

Manufacturer	TOYOTA
Model	CHR
Exact Purpose for which vehicle was being used at time of accident	PRIVATE HIRER USE
Are you claiming under your own insurance policy for repair to your vehicle?	NO
If No, Please state action to be taken	THIRD PARTY
Vehicle Category	PRIVATE HIRE

Insurance Company

Name of Insurance Company	MSIG INSURANCE (SINGAPORE) PTE. LTD.
Type Of Coverage	THIRD PARTY FIRE AND/OR THEFT
Fleet Policy	NO
Policy Number	B29119902MCX
Cover Note Number	

Driver

Name of Driver	HUANG XIAOLING
NRIC No	S8741479E
Date Of Birth	18/12/1987
Occupation	OUTDOOR
Date Of Driving Pass	24/05/2010
Driving Experience	9 YEARS AND 4 MONTHS
Gender	FEMALE
Mobile Number	(LOCAL) +65-83216316
Fax Number	
Contact Number	
Email Address	



Address	APT BLK 155 ANG MO KIO AVE 4 #10-748
Postcode	560155
Was driver an employee of the Insured's Company	NO
If No, Relationship of the Driver with the Insured	OTHER - HIRER
Vehicle Registration Number of Driver's Own Vehicle	-
	-
Insurance Company of Driver's Own Vehicle	-
	-
	-

General Information of the Accident

Type Of Accident	COLLISION - OPENING DOOR OF VEHICLE
Weather Conditions	CLEAR
Road Surface	DRY

Other Information

Was any foreign vehicle involved in this accident?	NO
Number of vehicles (including own vehicle) involved in the accident	2
Was any body injured in the Accident?	NO
Was any injured conveyed to hospital by ambulance?	NO
Was any other material or property damaged?	YES
I have been approached by unknown person(s) soliciting/offering accident claims assistance.	NO
Number of Passengers (Including Driver)	1

Details of Police Action

Was the accident reported to the police?	NO
If Yes, Please state which Police Station	
Was notice of intended Prosecution given?	NO
If Yes, against whom?	

Circumstances of Accident

REFER TO ATTACHED

Attachment(s)

Are accident photos available for attachment?	YES
Was there any video captured by Car Camera?	YES
Remarks/ Reasons:	WITH OWNER
Was there any audio recorded?	NO

DETAILS OF OTHER VEHICLE PROPERTY 1

Vehicle Registration Number	SHC1114M
Vehicle Make/Model/Colour	
Details Of Properties	
Vehicle Category	TAXI
Name of Driver	
NRIC/Passport Number	
Contact Number	
Address	
Postcode	
Insurance Company Name	
Nature Of Damage	
No. Of Passenger (Including Driver)	

Sketch Plan

SKETCH PLAN

IMPORTANT NOTICE

1. Please report correctly the details of the accident to speed up the claims process.
2. This Form must be completed by the Policyholder and/or the Authorised Driver.
3. Information provided must be as truthful and accurate as possible. Any willful misrepresentation or withholding of material facts may allow insurance companies to repudiate policy liability.
4. The issue and acceptance of this Form by insurance companies is not an admission of policy liability on the part of the insurance companies.
5. Any false reporting may be referred to the Police for investigation.
6. The report will be forwarded by the insurers of the GIA Records Management Centre established by the General Insurance Association of Singapore (GIA) for archiving and that copies of this report will for a fee be made available upon application by interested parties.
7. By the lodgment of this report to the insurers, you hereby consent to the archiving of this report at the centre and to copies of the report being made available aforesaid.
8. Consent under the Personal Data Protection Act (PDPA)

I understand, acknowledge, agree and consent that:

- (a) My Insurer, my workshop and the General Insurance Association of Singapore ("GIA") may/are permitted to collect, use, disclose and/or process my personal data/personal information set out in this (form) and any other personal information provided by me or possessed by my Insurer (collectively the "Personal Information") and disclose and transfer such Personal Information to all Insurer(s) who have insured vehicle(s) involved in this accident (all Insurer(s) who have insured vehicle(s) involved in this accident shall be collectively referred to as the "Insurers"), the Insurers' lawyers/law firms, the Monetary Authority of Singapore and any relevant government agency/authority (such as the police), for the purpose(s) of:
 - (i) processing, handling and/or dealing with my claims including the settlement of the claims and any necessary investigations relating to the claims;
 - (ii) investigating the accident and/or my claims;
 - (iii) carrying out and/or dealing with my instructions or responding to any enquiries by me;
 - (iv) administering my claims (including the mailing of correspondence, statements, invoices, reports or notices to me, which could involve disclosure of certain personal data about me to bring about delivery of the same as well as on the external cover of envelopes/mail packages); and/or
 - (v) complying with applicable law in administering, processing, handling and/or dealing with my claims (collectively the "Purposes")
- (b) all Insurer(s) who have insured vehicle(s) involved in this accident and the Insurers' lawyers/law firms, may/are permitted to collect, use, disclose and/or process my Personal Information for one or more of the above Purposes; and
- (c) my Personal Information may/can be disclosed by any of the Insurers and/or GIA to their third party service providers or agents (including their lawyers/law firms), which may be sited outside of Singapore, for one or more of the above Purposes;
- (d) my Personal Information will also be collected and used to compile claims history for the purpose of fraud detection, investigation and management in present and all future claims;
- (e) the information so collected under (d) above may be shared / disclosed:
 - (i) to all Insurers and/or any other third parties that assist in evaluating, investigating, controlling or managing fraud, regulatory, law enforcement and government agencies as reasonably required for the purposes stated; or
 - (ii) for complying with requirements under any regulations, laws or court orders.



Policyholder's Signature

Date & Time: 07/10/19

12:27pm

Driver's Signature

(If driver is not the policyholder)

Date & Time: 07/10/19

12:27pm

Reporting Centre Personnel's Signature

Name:

NRIC/IN No.:

Sketch Plan #2

SKETCH PLAN

A) CHE 1114m

B) SLW 4031X

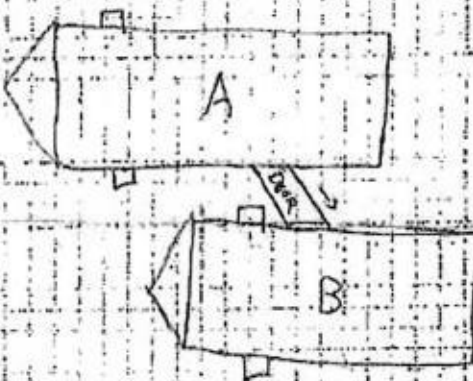

DESCRIBE CIRCUMSTANCES OF THE ACCIDENT

On 5th of Oct 195.19pm after dropping passenger at Amk HUB drop off point, while exiting the drop off point pass by a taxi Car A taxi passenger open the taxi door fully and Hit my side of the door Car B Scratch all the way to the back passenger seat door.

DECLARATION

I/We declare the foregoing particulars are true in every respect.

Policyholder's Signature

Date & Time: 07/10/19

12:27pm

Driver's Signature

(If driver is not the policyholder)

Date & Time: 07/10/19

12:27pm

Reporting Centre Personnel's Signature

Name:

NRIC/TIN No.:

Enquire Vehicle & Owner Information (Vehicle No. SHC1114M As At 05 Oct 2019 / 17:20:00)

Law Firm Search Details

Search Reason: Insurance claim in relation to traffic accident

Law Firm Case No.: 191143

Current Owner Details

Owner ID Type: Company

Owner ID: 199303821R

Owner Name: COMFORT TRANSPORTATION PTE LTD

Registered Address Type: Private Residential (Condo Apt or House) / Shopping / Office Complexes

Registered Block/House No.: 383

Registered Street Name: SIN MING DRIVE

Registered Unit No.: -

Registered Building Name: GAS BUILDING

Registered Postal Code: 575717

Current Vehicle Details

Vehicle No.: SHC1114M

Make Description/Model: HYUNDAI / I40 1.7 CRDI F/L AT ABS AIRBAG 4DR

Insurance Company Name: INDIA INT'L INS PTE LTD

Enquire Vehicle & Owner Information (Vehicle No. SHC1114M As At 05 Oct 2019 / 17:20:00)

Law Firm Search Details

Search Reason: Insurance claim in relation to traffic accident

Law Firm Case No.: 191143

Current Owner Details

Owner ID Type: Company

Owner ID: 199303821R

Owner Name: COMFORT TRANSPORTATION PTE LTD

Registered Address Type: Private Residential (Condo Apt or House) / Shopping / Office Complexes

Registered Block/House No.: 383

Registered Street Name: SIN MING DRIVE

Registered Unit No.: -

Registered Building Name: GAS BUILDING

Registered Postal Code: 575717

Current Vehicle Details

Vehicle No.: SHC1114M

Make Description/Model: HYUNDAI / I40 1.7 CRDI F/L AT ABS AIRBAG 4DR

Insurance Company Name: INDIA INT'L INS PTE LTD

Driver Earnings Summary

GOJEK

04 September, 2019

Driver Details:

From 26 August, 2019 Till 01 September, 2019

Name: Huang xiaoling

Bank Name: DBS BANK/ POST OFFICE SAVING BANK

Bank Account No: *****1523

Performance Summary:

Completed Trips	Acceptance Rate	Performance	Cancellation Rate	Net Earnings*
180	93.79%	90.92%	1.5%	S\$1,921.68

On each day*:

Date	Completed Trips	Acceptance Rate	Performance	Cancellation Rate	Net Earnings*
2019-08-26	16	100.0%	100.0%	0.0%	S\$184.00
2019-08-27	31	95.0%	93.94%	0.0%	S\$340.00
2019-08-28	30	94.44%	90.91%	2.94%	S\$340.00
2019-08-29	30	93.18%	82.86%	4.88%	S\$344.80
2019-08-30	32	90.24%	86.49%	2.7%	S\$340.00
2019-08-31	21	91.67%	91.3%	0.0%	S\$188.88
2019-09-01	20	92.0%	90.91%	0.0%	S\$184.00

*Daily summary only includes dates where at least 1 trip was made. For other incentives and payouts, refer to the sections below.

Driver Earnings Summary

GOJEK

18 September, 2019

Driver Details:

From 09 September, 2019 Till 15 September, 2019

Name: Huang xiaoling

Bank Name: DBS BANK/ POST OFFICE SAVING BANK

Bank Account No: *****1523

Performance Summary:

Completed Trips	Acceptance Rate	Performance	Cancellation Rate	Net Earnings*
79	97.98%	95.4%	1.85%	S\$2,148.20

On each day*:

Date	Completed Trips	Acceptance Rate	Performance	Cancellation Rate	Net Earnings*
2019-09-10	25	100.0%	100.0%	0.0%	S\$1,310.76
2019-09-13	27	100.0%	93.1%	5.56%	S\$437.00
2019-09-15	27	93.94%	93.1%	0.0%	S\$400.44

*Daily summary only includes dates where at least 1 trip was made. For other incentives and payouts, refer to the sections below.

Earnings Summary:

Trip Earnings (+)

Total Earnings from Cash Trips*	S\$254.30
Total Earnings from Credit Card Trips*	S\$540.10
Promo Reimbursed	S\$52.10

Bonus (+)

Incentives	S\$1,471.00
------------	-------------

Driver Earnings Summary

GOJEK

25 September, 2019

Driver Details:

From 16 September, 2019 Till 22 September, 2019

Name: Huang xiaoling

Bank Name: DBS BANK/ POST OFFICE SAVING BANK

Bank Account No: *****1523

Performance Summary:

Completed Trips	Acceptance Rate	Performance	Cancellation Rate	Net Earnings*
135	93.15%	88.96%	3.0%	S\$2,109.80

On each day*:

Date	Completed Trips	Acceptance Rate	Performance	Cancellation Rate	Net Earnings*
2019-09-16	26	90.91%	83.87%	6.67%	S\$414.20
2019-09-17	27	93.94%	93.1%	0.0%	S\$435.08
2019-09-18	27	88.89%	87.1%	0.0%	S\$410.20
2019-09-19	26	96.88%	92.86%	3.23%	S\$411.40
2019-09-20	29	95.12%	87.88%	5.13%	S\$438.92

*Daily summary only includes dates where at least 1 trip was made. For other incentives and payouts, refer to the sections below.

Earnings Summary:

Trip Earnings (+)

Total Earnings from Cash Trips*	S\$372.60
Total Earnings from Credit Card Trips*	S\$921.00

Driver Earnings Summary

02 October, 2019

GOJEK

Driver Details:

From 23 September, 2019 Till 29 September, 2019

Name: Huang xiaoling

Bank Name: DBS BANK/ POST OFFICE SAVING
BANK

Bank Account No: *****1523

Performance Summary:

Completed Trips	Acceptance Rate	Performance	Cancellation Rate	Net Earnings*
180	92.71%	91.13%	1.13%	S\$1,847.44

On each day*:

Date	Completed Trips	Acceptance Rate	Performance	Cancellation Rate	Net Earnings*
2019-09-23	9	100.0%	100.0%	0.0%	S\$79.44
2019-09-24	24	89.66%	88.89%	0.0%	S\$280.00
2019-09-25	35	83.72%	81.4%	2.78%	S\$340.00
2019-09-26	32	95.12%	94.12%	0.0%	S\$340.00
2019-09-27	36	82.98%	81.82%	0.0%	S\$340.00
2019-09-28	33	97.5%	91.67%	5.13%	S\$340.00
2019-09-29	11	100.0%	100.0%	0.0%	S\$128.00

*Daily summary only includes dates where at least 1 trip was made. For other incentives and payouts, refer to the sections below.

Driver Earnings Summary

GOJEK

09 October, 2019

Driver Details:

From 30 September, 2019 **Till** 06 October, 2019

Name: Huang xiaoling

Bank Name: DBS BANK/ POST OFFICE SAVING BANK

Bank Account No: *****1523

Performance Summary:

Completed Trips	Acceptance Rate	Performance	Cancellation Rate	Net Earnings*
180	93.33%	89.97%	2.06%	S\$2,632.78

On each day*:

Date	Completed Trips	Acceptance Rate	Performance	Cancellation Rate	Net Earnings*
2019-09-30	30	97.14%	96.77%	0.0%	S\$339.50
2019-10-01	28	91.89%	90.32%	0.0%	S\$1,089.28
2019-10-02	28	86.84%	82.35%	0.0%	S\$340.00
2019-10-03	16	90.91%	80.0%	10.0%	S\$184.00
2019-10-05	39	100.0%	97.5%	2.38%	S\$340.00
2019-10-06	39	93.18%	92.86%	0.0%	S\$340.00

*Daily summary only includes dates where at least 1 trip was made. For other incentives and payouts, refer to the sections below.

Earnings Summary:

Trip Earnings (+)



25 Kaki Bukit Road 4 #01-55 S417800

S/no AX-5729

S/no	Description	Amount
1	Parts and labour for repair of Toyota C-HR Hybrid SLW4031X (Lump Sum)	\$3,700
Total:		\$3,700

Vehicle No:

SLW4031

Date:

Apex Motoring



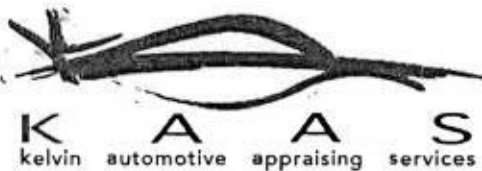

6 tampines st 73, #01-03, singapore 528825
tel: 6746 2118 fax: 6746 1148
reg no: 53058468m

Claim Reference : -
Insured Vehicle No. : -
Thirty Party Veh No. : -
Officer-In-Charge : -

Our Reference : KAAS/TA/5728/4031/TP/10.19
Invoice No. : 5728
Date : 03 November 2019

To: Asia Express Car Rental Pte Ltd
c/o 25 Kaki Bukit Road 4
#01-55, Synergy @ Kaki Bukit
Singapore 417800

INVOICE	
PARTICULARS	AMOUNT
Vehicle No. : SLW 4031X Make/Model : Toyota C-HR Hybrid 1.8S (A) <input checked="" type="checkbox"/> Inspection of Vehicle <input checked="" type="checkbox"/> Appraisal Report <input checked="" type="checkbox"/> 40 Colored Photographs <input checked="" type="checkbox"/> Transport charges <input checked="" type="checkbox"/> Re-inspection <input type="checkbox"/> Others (Specify)	SGD 520.00
Total	SGD 520.00

Dollars: Five Hundred and Twenty Only

(Cheque should be crossed and make payable to " Kelvin Automotive Appraising Services ")



Kelvin Automotive Appraising Services



6 tampines st 73, #01-03, singapore 528825
tel: 6746 2118 fax: 6746 1148
reg no: 53058468m

Claim Reference : -
Insured Vehicle No. : -
Thirty Party Veh No. : -
Officer-In-Charge : -

Our Reference : KAAS/TA/5728/4031/TP/10.19
Date : 03 November 2019

To: Asia Express Car Rental Pte Ltd
c/o 25 Kaki Bukit Road 4
#01-55, Synergy @ Kaki Bukit
Singapore 417800

VEHICLE APPRAISAL REPORT

Name of Workshop : Apex Motoring
Place of inspection : 25 Kaki Bukit Road 4 #01-55, Synergy @ Kaki Bukit, Singapore 417800
Date of Assignment : 07 October 2019
Date of Accident : 05 October 2019
Date of Inspection : 07 October 2019

PARTICULARS OF INSPECTED VEHICLE

Registration No.	: SLW 4031X	Chassis Frame No.	: ZYX10-2087495
Make / Model	: Toyota C-HR Hybrid 1.8S (A)	Engine No. (Logcard)	: 2ZR8251060
Year of Manufacture/Reg	: 2018	Odometer Reading	: 156,882 KM
Colour	: Blue		
Class / Type	: SUV		

CONDITION OF VEHICLE DURING SURVEY (Visual & Static Check Only)

General Condition : Excellent
Paintwork : Excellent
Market Value : -
Scrap Value : -

CONDITION OF TYRES ON VEHICLE

		<u>Make/Size</u>	<u>Thread Balance</u>
Front	L	KAPSEN 215 / 60 R17	7 mm
Front	L	KAPSEN 215 / 60 R17	7 mm
Rear	R	KAPSEN 215 / 60 R17	7 mm
Rear	R	KAPSEN 215 / 60 R17	7 mm

*The above is an estimate of the remaining life of the tyre thread in millimeters

The information contained in these documents may be privileged and confidential, and is intended for the exclusive use of the addressee designation.
If you are not the addressee, any enclosure, reproduction, distribution or other dissemination or use of this communication is strictly prohibited. If you

APPRAISEMENT SCHEDULE

S/N	Qty	Descriptions	Conditions	Repairer's Estimate	Revised Amount
LIST ITEMS:-					
1	1 pc	r/h front door / PP	buckled	\$ 1,295.00	\$ 1109 1,295.00
2	1 pc	r/h front door outer handle / SCR	damaged	\$ 274.10	\$ / 274.10
3	1 pc	r/h front door inner lock X SVC	shifted	\$ 509.10	realign
4	1 pc	r/h front door lock cylinder X SVC	damaged	\$ 65.70	\$ 65.70
5	1 pc	r/h front door inner trim board X SVC	deformed	\$ 877.60	\$ 877.60
6	1 set	r/h front door inner trim board clips X SVC	necessary	\$ 35.00	\$ 35.00
7	1 pc	r/h front door window regulator w/ motor X SVC	unconfirmed	\$ 477.00	not affected
8	1 pc	r/h rear door / OD	buckled	\$ 1,004.95	\$ / 1,004.95
Less 25%				\$ 4,538.45	\$ 3,552.35
					\$ 888.09
				\$ 4,538.45	\$ 2,664.26

2388.05

- 25%

1791.04

APPRAISEMENT SCHEDULE

S/N	Qty	Descriptions	Conditions	Repairer's Estimate	Revised Amount
		B/F		\$ 4,538.45	\$ 2,664.26
		LABOUR & OTHER CHARGES:-			
1		To panel beat and renewal of all necessary damaged body parts		\$ 1,200.00	\$ 900.00 400
2		To check wiring and rewire		\$ 60.00	\$ 50.00 30
3		To remove and reinstall front door components		\$ 80.00	\$ 60.00 ✓
4		To remove and reinstall rear door components		\$ 80.00	\$ 60.00 ✓
5		To apply anti-rust		\$ 100.00	\$ 80.00 X
6		To putty and spray-paint of affected areas		\$ 1,000.00	\$ 800.00 400
				\$ 2,520.00	\$ 1,950.00
		$ \begin{array}{r} 2388.05 \\ - \quad 25\% \\ \hline P = 1,791.04 \\ L = 830 \\ \hline 2,621.04 \\ - \quad 20\% \\ \hline 2,096.83 \\ \hline L / 5 = 2,100 \\ 4 \text{ days} \end{array} $		2058.45	

ASSESSMENT SUMMARY

Damages sustained were consistent with the accident reported.

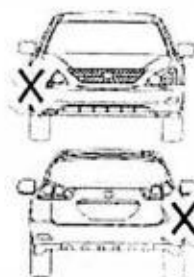
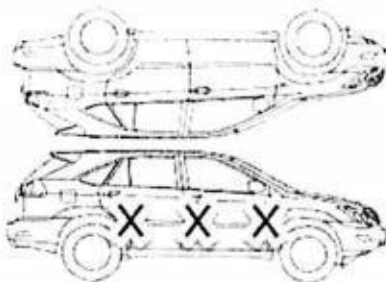
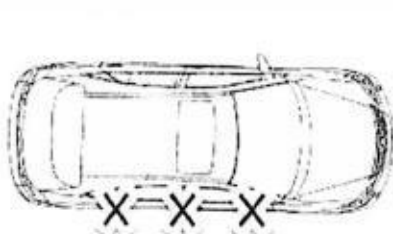

The general area of damages is at the **RH Side portion**
(Please refer to the parts list and photographs as attached for more information)

ASSESSOR'S RECOMMENDATIONS

The estimated repair costs submitted by Messrs **Apex Motoring** is \$ 7,058.45 .
We have adjusted the cost to \$ 4,614.26 and the repairer has agreed to undertake the repairs at a
Contract Lump Sum of \$ 3,700.00 to a acceptable quality and standards.
However, we have not given authorization and instruction to the repairer to proceed with the repairs.

The repairs should be completed within a reasonable period of **4** working days.

40 photographs were taken at the time of static inspection.

This report is strictly done in a **Without Prejudice Basis**.

We are reverting the matter to you a decision.

We enclose herewith our Invoice No. **5728** for our services rendered and
we thank you for engaging our services.

Conducted By :

TERRENCE HONG
Dip Engineering / DECC (SP)
Certs Automotive Technology (NP)
Cert. Crash Investigation & Reconstruction
Cert SCI (General Insurance)
AMSAAA, AM SAE-A

Approved By :

KELVIN TEO
Licensed Automotive Appraiser
Nitec in Automotive Technology
Cert. Crash Investigation & Reconstruction
Dip MS
MSAAA, AM SAE-A



LKK Auto Consultants Pte Ltd

51 Ubi Ave 1 #01-25 Paya Ubi Industrial Park, Singapore 408933

TEL: 6256 3561 FAX: 6256 4315

Reg. No: 199607198R GST Reg. No. 19-9607198-R

Affiliated to Federation Internationale Des Experts En Automobile

INDIA INTERNATIONAL INSURANCE PL

Ref : CS3/III19017683/Qtf3s2-1

64 CECIL STREET

#05-02 IOB BUILDING SINGAPORE 049711

Date : 24-12-2019



Code : III2

1. Policy Particulars :- THIRD PARTY CLAIM

Insured Veh.	SHC 1114M	Veh. Inspected	SLW 4031X
Policy No.	MCOM0015	Coverage (\$)	0.00
Claim No.	MCT19100098	Excess (\$)	0.00
Assign From	GABRIEL WEE	Assign Date	17/12/2019

2. Vehicle Particulars & Condition

Make & Model	TOYOTA C-HR HYBRID	c.c	1797
Engine No.	HIDDEN	Year of Reg.	2018
Chassis No.	ZYX102087495	Colour	BLUE
Odometer	156882	Steering	IN ORDER
Brakes	IN ORDER	Modification	SPORTS RIM
General	FAIR		

3. Conditions of Tyres

	Size	Make	Balance
R/H Front Tyre	215/60 R17	KAPSEN	6 mm
L/H Front Tyre	215/60 R17	KAPSEN	6 mm
R/H Rear Tyre	215/60 R17	KAPSEN	6 mm
L/H Rear Tyre	215/60 R17	KAPSEN	6 mm

4. Description of Damages

THE VEHICLE SUSTAINED DAMAGES AT THE O/S BODY.
DAMAGES SEE DETAILS.

5. General Information

Accident Date	05/10/2019	Inspection Date	08/10/2019
Survey held at	365 AUTOMOTIVE PTE LTD 25 KAKI BUKIT ROAD 4 #01-55 SYNERGY @KB SINGAPORE 417800		

5a. Remarks

A)THE INSPECTION WAS CONDUCTED ON A"WITHOUT PREJUDICE" BASIS. B)IN ACCORDANCE TO YOUR INSTRUCTIONS, WE HAVE NOT AUTHORISED REPAIRS.
--

5b. Estimate Days of Repair

ESTIMATED NORMAL PERIOD FOR REPAIR:	4 Working Days
-------------------------------------	----------------

**LKK Auto Consultants Pte Ltd**

51 Ubi Ave 1 #01-25 Paya Ubi Industrial Park, Singapore 408933

TEL: 6256 3561 FAX: 6256 4315

Reg. No: 199607198R GST Reg. No. 19-9607198-R

Page No.:1 of 1

ADJUSTMENT ON REPAIR COST FOR VEHICLE NO. SLW 4031X

Qty	Description of Parts	Condition	Estimate By Workshop (\$)	Our Adjusted (\$)
	<u>REPLACEMENT OF PARTS</u>			
1	R/H FRONT DOOR	DENTED	1,295.00	1,109.00
1	R/H FRONT DOOR OUTER HANDLE	SCRATCHED	274.10	274.10
1	R/H FRONT DOOR INNER LOCK	SERVICEABLE	509.10	-
1	R/H FRONT DOOR LOCK CYLINDER	SERVICEABLE	65.70	-
1	R/H FRONT DOOR INNER TRIM BOARD	SERVICEABLE	877.60	-
1	SET R/H FRONT DOOR INNER TRIM BOARD CLIPS	SERVICEABLE	35.00	-
1	R/H FRONT DOOR WINDOW REGULATOR W/ MOTOR	SERVICEABLE	477.00	-
1	R/H REAR DOOR	DENTED	1,004.95	1,004.95
	LESS 25% DISCOUNT		-	-597.02
			4,538.45	1,791.03
	<u>LABOUR</u>			
	TO PANEL BEAT AND RENEWAL OF ALL NECESSARY DAMAGED BODY PARTS.		1,200.00	400.00
	TO CHECK WIRING AND REWIRE.		60.00	30.00
	TO REMOVE AND REINSTALL FRONT DOOR COMPONENTS.		80.00	60.00
	TO REMOVE AND REINSTALL REAR DOOR COMPONENTS.		80.00	60.00
	TO APPLY ANTI-RUST.	NOT NECESSARY	100.00	-
	TO PUTTY AND SPRAY-PAINT OF AFFECTED AREAS.		1,000.00	400.00
			2,520.00	950.00
	GRAND TOTAL		7,058.45	2,741.03
	RECOMMENDED COST OF LUMP SUM REPAIRS (TO ITS PRE-ACCIDENT CONDITION)			2,100.00

Report Ref No. CS3/III19017683/Qtf3s2-1

OI SUN PIN

Asst. Automotive Assessor

ADRIAN LING WAI PING

B.Eng,AMSOE,AMIRTE,AMSAE-A,M.MATAI

Licensed Appraiser

DISCLAIMER OF LIABILITY TO THIRD PARTIES:- This Report is made solely for the use and benefit of the Client named on the front page of this Report.
 No liability of responsibility whatsoever, in contract or tort, is accepted to any third party who may rely on the Report wholly or in part. Any third party acting or relying on this Report, in whole or in part, does so at his or her own risk.