

# NATIONAL Assessment Centre Services

[ver 1 Jan09]

MMA 119165925

Date In: 17/12/19 13:23	Job description	Date & Time Completed	Done by
Ref No: NAI TMZ 19022153/64	SAS e-filing		
Veh No: SJR 4175 P	E-mail (within 3hrs, AIC 2hrs)		
DDA: 16/12/19 16:00	I-Motor Claim Form		
OD: <input checked="" type="radio"/> Reporting Only	I-Motor W/O (Within: OD 2hrs, TP 4hrs)		
TP Insurer:	I-Photo Uploaded		
	Assessment/Survey Report		
	Ass't Report by Fax / Hand to Owner/Wksp		

Preferred Wksp / INC Assign Wksp / QW: (	Tel:	Fax:
TP Particulars:	Veh No: SFH 9337 G	INC ( ) / Non-INC ( )
Owner / Driver: (	Tel:	
Policy No: (	Period: (	Cover Type: (
Confirmed by: (	Date:	Time:
Insured/Driver Liability: (	% [Note-Est. Status (WO): N: 0-20%; P: 21-79%; P: 80-100%]	
Year of Registration: (	Warranty: YES ( ) / NO ( )	
Excess: (\$	Loading: \$1,000 ( ) / \$2,000 ( )	

General Remarks:
( ) Walk-In Customer: Customer's Information strictly Confidential & Strictly NO refer of repairer.
( ) Total Loss Case: to e-mail Insurer URGENTLY.
Drive-In ( ) / Towed-In ( ); Invoice: YES ( ) / NO ( ); Towing Co: ( )

Remarks: (INC hotline: 6788 6616)	Date & Time Completed	Done by
1) Apply for Transport Allowance ( ) / Courtesy Car ( )		
2) QC Check / Post Repair Inspection ( )		
3) Upload Resurvey Photo [Repair Cost > \$3000] ( )		

Injury: \_\_\_\_\_

Date/Time	Actions

NAI 1909302	Invoice Preparation Checklist	Am (\$)	SA Am (\$)
Claimant's Particulars:	1) AR: Accident Reporting (\$30);	30.00	
Driver/Owner:	2) DA: Damage Assessment (\$100); INC (\$10)		
Contact No:	3) TP: Towing Fee \$40/\$45		
Damaged Portion:	4) FT: Follow-Through Survey \$120		
QC Checked by (Engr-In-Charge):	5) PT: Follow-Through Survey (Resurvey) \$30		
Auditors' Comments:	For claiming against INC Only (wef 10 Jan 2009)		
	6) TR: Re-Inspection \$75		
	7) NI: Idao DA + SMRT Survey \$160		
	8) NTUC Additional Services:-		
	ON:		
	*N5: Courtesy Car / Tpt Allowance \$5		
	*N6: Repair Coordination \$10		
	*N7: Post Repair Inspection \$25		
	*N8: DV / Collect Excess Coordination \$5		
	TP (N11): TP (Non INC) against INC \$20		
	9) N12: Idao Mobile \$0		
	Invoice dated	Fee Charged	
	Invoice dated	Fee Charged	



## SINGAPORE ACCIDENT STATEMENT

### IMPORTANT NOTICE

1. Please report correctly the details of the accident to speed up the claims process.
2. This Form must be completed by the Policyholder and/or the Authorised Driver.
3. Information provided must be as truthful and accurate as possible. Any wilful misrepresentation or withholding of material facts may allow insurance companies to repudiate policy liability.
4. The issue and acceptance of this Form by insurance companies is not an admission of policy liability on the part of the insurance companies.
5. Any false reporting may be referred to the Police for investigation.
6. This report will be forwarded by the insurers of the GIA Records Management Centre established by the General Insurance Association of Singapore (GIA) for archiving and that copies of this report will, for a fee, be made available upon application by interested parties.
7. By the lodgement of this report to the insurers, you hereby consent to the archiving of this report at the centre and to copies of the report being made available aforesaid.

### ACCIDENT STATEMENT

Date Of Report	17/12/2019 13:23
Date Of Accident	16/12/2019 16:00
Exact Location Of Accident	JOO CHIAT COMMUNITY CENTRE CARPARK
Country/State of Loss	SINGAPORE

### DETAILS OF OWN VEHICLE

Vehicle Registration Number	SJR4175P
<b>Insured/Policyholder</b>	
Name Of Registered Owner	OSCR PTE LTD
Co Reg No	201806082N
Email Address	NOEMAIL
Mobile Phone No	
Alternative Phone No	OFFICE-90302139

### Vehicle Particulars

Manufacturer	TOYOTA
Model	COROLLA ALTIS
Exact Purpose for which vehicle was being used at time of accident	WORK
Are you claiming under your own insurance policy for repair to your vehicle?	NO
If No, Please state action to be taken	THIRD PARTY
Vehicle Category	PRIVATE HIRE

### Insurance Company

Name of Insurance Company	TOKIO MARINE INSURANCE SINGAPORE LTD
Type Of Coverage	THIRD PARTY
Fleet Policy	NO
Policy Number	19-MK000564-R00
Cover Note Number	

### Driver

Name of Driver	TAN JUN WEI
NRIC No	S9504104C
Date Of Birth	29/01/1995
Occupation	OUTDOOR
Date Of Driving Pass	20/02/2014
Driving Experience	5 YEARS AND 9 MONTHS
Gender	MALE
Mobile Number	(LOCAL) +65-90302139
Fax Number	
Contact Number	
Email Address	NOEMAIL

Address	BLK 170 YISHUN AVE 7 #08-871
Postcode	760170
Was driver an employee of the Insured's Company	NO
If No, Relationship of the Driver with the Insured	OTHER - HIRER
Vehicle Registration Number of Driver's Own Vehicle	-
	-
Insurance Company of Driver's Own Vehicle	-
	-
	-

#### General Information of the Accident

Type Of Accident	SIDE SWIPE
Weather Conditions	CLEAR
Road Surface	DRY

#### Other Information

Was any foreign vehicle involved in this accident?	NO
Number of vehicles (including own vehicle) involved in the accident	2
Was any body injured in the Accident?	NO
Was any injured conveyed to hospital by ambulance?	
Was any other material or property damaged?	YES
I have been approached by unknown person(s) soliciting/offering accident claims assistance.	NO
Number of Passengers (Including Driver)	1

#### Details of Police Action

Was the accident reported to the police?	NO
If Yes, Please state which Police Station	
Was notice of intended Prosecution given?	NO
If Yes, against whom?	

#### Circumstances of Accident

REFER TO STATEMENT.

#### Attachment(s)

Are accident photos available for attachment?	YES
Was there any video captured by Car Camera?	NO
Was there any audio recorded?	NO

#### DETAILS OF OTHER VEHICLE PROPERTY 1

Vehicle Registration Number	SFH9337G
Vehicle Make/Model/Colour	
Details Of Properties	
Vehicle Category	PRIVATE CAR
Name of Driver	
NRIC/Passport Number	
Contact Number	
Address	
Postcode	
Insurance Company Name	
Nature Of Damage	
No. Of Passenger (Including Driver)	



## SKETCH PLAN

### IMPORTANT NOTICE

1. Please report correctly the details of the accident to speed up the claims process.
2. This Form must be completed by the Policyholder and/or the Authorised Driver.
3. Information provided must be as truthful and accurate as possible. Any wilful misrepresentation or withholding of material facts may allow insurance companies to repudiate policy liability.
4. The issue and acceptance of this Form by insurance companies is not an admission of policy liability on the part of the insurance companies.
5. Any false reporting may be referred to the Police for investigation.
6. The report will be forwarded by the insurers of the GIA Records Management Centre established by the General Insurance Association of Singapore (GIA) for archiving and that copies of this report will for a fee be made available upon application by interested parties.
7. By the lodgment of this report to the insurers, you hereby consent to the archiving of this report at the centre and to copies of the report being made available aforesaid.

#### 8. Consent under the Personal Data Protection Act (PDPA)

I understand, acknowledge, agree and consent that:

- (a) My insurer, my workshop and the General Insurance Association of Singapore ("GIA") may/are permitted to collect, use, disclose and/or process my personal data/personal information set out in this [form] and any other personal information provided by me or possessed by my insurer (collectively the "Personal Information") and disclose and transfer such Personal Information to all insurer(s) who have insured vehicle(s) involved in this accident (all insurer(s) who have insured vehicle(s) involved in this accident shall be collectively referred to as the "Insurers"), the Insurers' lawyers/law firms, the Monetary Authority of Singapore and any relevant government agency/authority (such as the police), for the purpose(s) of:
  - (i) processing, handling and/or dealing with my claims including the settlement of the claims and any necessary investigations relating to the claims;
  - (ii) investigating the accident and/or my claims;
  - (iii) carrying out and/or dealing with my instructions or responding to any enquiries by me;
  - (iv) administering my claims (including the mailing of correspondence, statements, invoices, reports or notices to me, which could involve disclosure of certain personal data about me to bring about delivery of the same as well as on the external cover of envelopes/mail packages); and/or
  - (v) complying with applicable law in administering, processing, handling and/or dealing with my claims (collectively the "Purposes")
- (b) all insurer(s) who have insured vehicle(s) involved in this accident and the Insurers' lawyers/law firms; may/are permitted to collect, use, disclose and/or process my Personal Information for one or more of the above Purposes; and
- (c) my Personal Information may/can be disclosed by any of the Insurers and/or GIA to their third party service providers or agents (including their lawyers/law firms), which may be sited outside of Singapore, for one or more of the above Purposes.
- (d) my Personal Information will also be collected and used to compile claims history for the purpose of fraud detection, investigation and management in present and all future claims.
- (e) the information so collected under (d) above may be shared / disclosed:
  - (i) to all insurers and/or any other third parties that assist in evaluating, investigating, controlling or managing fraud, regulators, law enforcement and government agencies as reasonably required for the purposes stated; or
  - (ii) for complying with requirements under any regulations, laws or court orders.

Policyholder's Signature  
Date & Time:

Driver's Signature  
(If driver is not the policyholder)  
Date & Time:

Reporting Centre Personnel's Signature  
Name:  
NRIC/FIN No.:

SKETCH PLAN

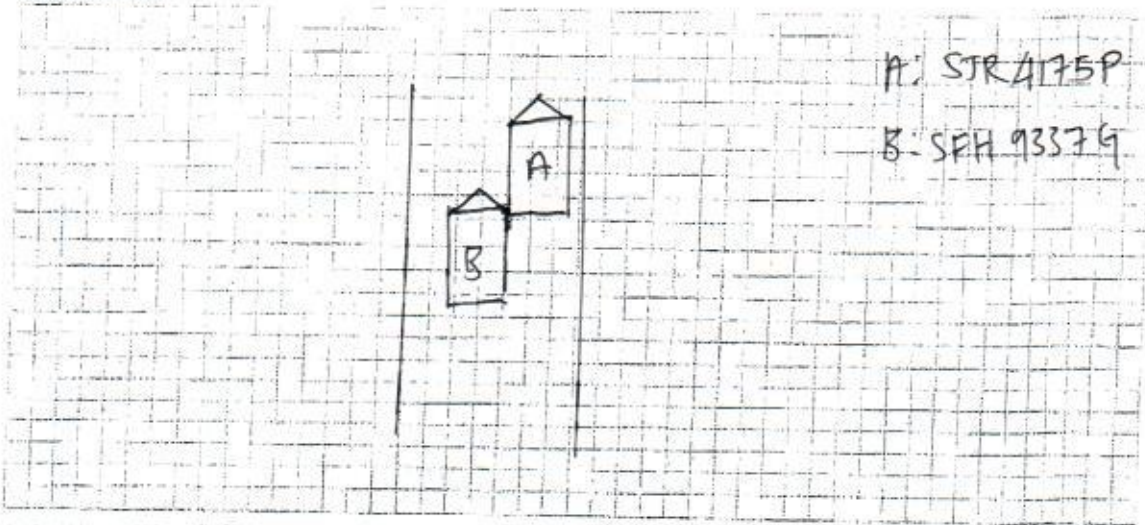

DESCRIBE CIRCUMSTANCES OF THE ACCIDENT

lot

I was stationary in the carpark, alighting my passenger. Suddenly, I felt an impact on the rear left side of my vehicle. I got down and realised ~~a~~ vehicle B actually ~~crashed~~ ~~the~~ collided into my vehicle while she was trying to park into a carpark lot.

DECLARATION

I/We declare the foregoing particulars are true in every respect.

Policyholder's Signature  
Date & Time:

Driver's Signature  
(If driver is not the policyholder)  
Date & Time:

Reporting Centre Personnel's Signature  
Name:  
NRIC/FIN No.:



# SINGAPORE ACCIDENT STATEMENT

## IMPORTANT NOTICE

- ❖ Complete and submit this form to the individual insurance authorised reporting centre.
- ❖ Please report correctly on the details of the accident to speed up the claim process.
- ❖ This form must be filled up by the policy holder and/or authorised driver.
- ❖ Information provided must be as fruitful and accurate as possible. Any wilful misrepresentation or withholding of material facts may allow insurance companies to repudiate policy liability.
- ❖ The issue and acceptance of this form by insurance companies is not an admission of policy liability on the part of the insurance companies.
- ❖ Any false reporting may be referred to the traffic police department for investigation.

## Accident details

Date and time of accident	Date: <del>16/10</del> 16/12/19 (DD/MM/YY) Time: 16:00 (HH:MM)
Exact location of accident	700 CHIAT COMMUNITY CENTRE CARPARK

## Details of vehicle

Vehicle registration number	SJR 4175 P		
Vehicle make and model	TOYOTA ALTIS		
Type of vehicle	Saloon <input checked="" type="checkbox"/>	MPV <input type="checkbox"/>	CRV <input type="checkbox"/> Van <input type="checkbox"/>
	Lorry <input type="checkbox"/>	Bus <input type="checkbox"/>	Motorcycle <input type="checkbox"/> Others: _____
Vehicle category	Private <input type="checkbox"/>	Commercial <input checked="" type="checkbox"/>	Motorcycle <input type="checkbox"/>
Purpose of using at said time	WORK		
Are you claiming under your own insurance company?	Yes <input type="checkbox"/>	No <input type="checkbox"/>	if no, please select:
	Third part claim <input checked="" type="checkbox"/>	Reporting only <input type="checkbox"/>	

## Insurance information

Insurance company	TOKIO MARINE		
Policy number			
Type of policy	Comprehensive <input checked="" type="checkbox"/>	Third party fire & theft <input type="checkbox"/>	TP only <input type="checkbox"/>

## Insured / Policy holder

Name	OSCR PTE LTD		Male <input type="checkbox"/>	Female <input type="checkbox"/>
NRIC / Fin / Passport number	201806082N			
Contact				
Address				

## Driver

Same as insured above ☐ (skip to D.O.B)

Name	TAN JUN WEI		Male <input checked="" type="checkbox"/>	Female <input type="checkbox"/>
NRIC / Fin / Passport number	S9504104C			
Contact	90302139			
Address	BLK 170 HISHUN AVENUE 7 #08-871 S760170			
Email address				
Date of birth	29/01/1995			
Occupation	Indoor <input type="checkbox"/>	Outdoor <input checked="" type="checkbox"/>		
Driving date pass	20/02/2014			

### General information of the accident

Was driver an employee of the insured's company?	Yes <input type="checkbox"/> No <input checked="" type="checkbox"/>
Accident captured by camera?	Yes <input type="checkbox"/> No <input checked="" type="checkbox"/>
Weather condition	Clear <input checked="" type="checkbox"/> Raining <input type="checkbox"/> Others: _____
Road surface	Dry <input checked="" type="checkbox"/> Wet <input type="checkbox"/>
No of passenger	1 (Inclusive of driver)

### Passenger 1

Name	_____
Gender	Male <input type="checkbox"/> Female <input type="checkbox"/>

### Passenger 2

Name	_____
Gender	Male <input type="checkbox"/> Female <input type="checkbox"/>

### Passenger 3

Name	_____
Gender	Male <input type="checkbox"/> Female <input type="checkbox"/>

### Passenger 4

Name	_____
Gender	Male <input type="checkbox"/> Female <input type="checkbox"/>

### Passenger 5

Name	_____
Gender	Male <input type="checkbox"/> Female <input type="checkbox"/>

### Passenger 6

Name	_____
Gender	Male <input type="checkbox"/> Female <input type="checkbox"/>

### Other information

Was anybody injured?	Yes <input type="checkbox"/> No <input type="checkbox"/>
Was other vehicle damaged?	Yes <input type="checkbox"/> No <input type="checkbox"/>

### Details of police action

Reported to police?	Yes <input type="checkbox"/> No <input type="checkbox"/> If yes, please state which police station.
Police station name	_____



Third party vehicle 1

Name	SFH 9337 G
Contact number	
NRIC / Fin / Passport number	
Vehicle registration number	
Vehicle make model	

Third party vehicle 2

Name	
Contact number	
NRIC / Fin / Passport number	
Vehicle registration number	
Vehicle make model	

Third party vehicle 3

Name	
Contact number	
NRIC / Fin / Passport number	
Vehicle registration number	
Vehicle make model	

Third party vehicle 4

Name	
Contact number	
NRIC / Fin / Passport number	
Vehicle registration number	
Vehicle make model	

Third party vehicle 5

Name	
Contact number	
NRIC / Fin / Passport number	
Vehicle registration number	
Vehicle make model	

Third party vehicle 6

Name	
Contact number	
NRIC / Fin / Passport number	
Vehicle registration number	
Vehicle make model	



Witness 1

Name	
------	--

Witness 2

Name	
------	--

Injured person 1

Name		
Injuries sustained		
Which vehicle person in?		
Were seat belts worn?	Yes <input type="checkbox"/>	No <input type="checkbox"/>
Was injured conveyed to hospital by ambulance?	Yes <input type="checkbox"/>	No <input type="checkbox"/>

Injured person 2

Name		
Injuries sustained		
Which vehicle person in?		
Were seat belts worn?	Yes <input type="checkbox"/>	No <input type="checkbox"/>
Was injured conveyed to hospital by ambulance?	Yes <input type="checkbox"/>	No <input type="checkbox"/>

Injured person 3

Name		
Injuries sustained		
Which vehicle person in?		
Were seat belts worn?	Yes <input type="checkbox"/>	No <input type="checkbox"/>
Was injured conveyed to hospital by ambulance?	Yes <input type="checkbox"/>	No <input type="checkbox"/>

Injured person 4

Name		
Injuries sustained		
Which vehicle person in?		
Were seat belts worn?	Yes <input type="checkbox"/>	No <input type="checkbox"/>
Was injured conveyed to hospital by ambulance?	Yes <input type="checkbox"/>	No <input type="checkbox"/>



**TOKIO MARINE**  
INSURANCE GROUP  
FORM MX1 H

Tokio Marine Group

## Certificate of Insurance

**MOTOR VEHICLES (THIRD-PARTY RISKS AND COMPENSATION) ACT (CHAPTER 189)**  
**MOTOR VEHICLES (THIRD-PARTY RISKS AND COMPENSATION) RULES, 1960**  
**ROAD TRANSPORT ACT, 1987 (MALAYSIA)**  
**MOTOR VEHICLES (THIRD-PARTY RISKS) RULES, 1959 (MALAYSIA)**

Policy No.: 19-MK000564-R00 (Private Motor Car)

- |  |  |                                |
|--|--|--------------------------------|
| 1. Index Mark and Registration Number of Vehicle   | SJR4175P   | Chassis No.: MR053ZEE106148303 |
| 2. Name of Policyholder  | OSCR PTE LTD   |                                |
| 3. Effective date of the Commencement of Insurance for the purposes of the Act   | 24/07/2019   |                                |
| 4. Date of Expiry of Insurance   | 23/07/2020   |                                |
| 5. Persons or Class of Persons entitled to drive*  | <p>Any person who is driving on the Policyholder's order or with their permission.<br/>The hirer.<br/>Any other person who is driving on the hirer's order or with his/ their permission.</p>  |                                |
| <p>* Provided that the Person driving is permitted in accordance with the licensing or other laws or regulations to drive the Motor Vehicle or has been so permitted and is not disqualified by order of a Court of Law or by reason of any enactment or regulation in that behalf from driving the Motor Vehicle. And provided further that the Motor Vehicle is registered under the Road Traffic Act and its registration under the Road Traffic Act has not been cancelled at the time of the accident loss or damage.</p> |  |                                |
| 6. Limitations as to use*  | <p>Use for the carriage of passengers or goods in connection with the Policyholder's business or the hirer's business.<br/>Use for social domestic and pleasure purpose and business purposes of the Policyholder or of any person to whom the vehicle is hired.<br/>The Policy does not cover:-<br/>1) Use for racing, pace-making, reliability trial or speed-testing.<br/>2) Use whilst drawing a trailer except the towing (other than for reward) of any one disabled mechanically propelled vehicle.</p> |                                |

\* Limitations rendered inoperative by Section 8 of the Motor Vehicles (Third-Party Risks and Compensation) Act (Chapter 189) and Section 95 of the Road Transport Act, 1987 (Malaysia), are not to be included under these headings.

We hereby certify that the Policy to which this Certificate relates is issued in accordance with the provision of the Motor Vehicles (Third-Party Risks and Compensation) Act (Chapter 189) and Part IV of the Road Transport Act, 1987 (Malaysia).

Please refer to the Policy Schedule for full details, terms and conditions of the insurance.

**IMPORTANT NOTICE**

This Certificate is not transferable. During its currency, if the insurance is cancelled for whatsoever reason, you must return the Certificate to Tokio Marine Insurance Singapore Ltd. within 7 days thereof or, if the Certificate has been lost/destroyed, you must make a statutory declaration to that effect. Failure to comply with this duty is an offence under Motor Vehicle (Third-Party Risks and Compensation) Act (Chapter 189).

**ADDITIONAL INFORMATION**

Account: 2793DDA

Insurance Plan:	Third Party Cover Only
Policy Excess:	Excess-Third Party (Sect II) SGD 2,500

Tokio Marine Insurance Singapore Ltd.

Authorised Signature