

SINGAPORE ACCIDENT STATEMENT

IMPORTANT NOTICE

1. Please report correctly the details of the accident to speed up the claims process.
2. This Form must be completed by the Policyholder and/or the Authorised Driver.
3. Information provided must be as truthful and accurate as possible. Any wilful misrepresentation or withholding of material facts may allow insurance companies to repudiate policy liability.
4. The issue and acceptance of this Form by insurance companies is not an admission of policy liability on the part of the insurance companies.
5. **Any false reporting may be referred to the Police for investigation.**
6. This report will be forwarded by the insurers of the GIA Records Management Centre established by the General Insurance Association of Singapore (GIA) for archiving and that copies of this report will, for a fee, be made available upon application by interested parties.
7. By the lodgement of this report to the insurers, you hereby consent to the archiving of this report at the centre and to copies of the report being made available aforesaid.

ACCIDENT STATEMENT

| | |
|----------------------------|--|
| Date Of Report | 10/12/2019 10:54 |
| Date Of Accident | 09/12/2019 14:30 |
| Exact Location Of Accident | PARK ROYAL HOTEL BASEMENT CARPARK ENTRANCE L/P 2R3 |
| Country/State of Loss | SINGAPORE |

DETAILS OF OWN VEHICLE

| | |
|-----------------------------|-----------------------|
| Vehicle Registration Number | XD4712Y |
| Insured/Policyholder | |
| Name Of Registered Owner | BUILDMATE (S) PTE LTD |
| Co Reg No | - |
| Email Address | NOEMAIL |
| Mobile Phone No | |
| Alternative Phone No | OFFICE-65895388 |

Vehicle Particulars

| | |
|--|--------------------|
| Manufacturer | ISUZU |
| Model | CYZ52R |
| Exact Purpose for which vehicle was being used at time of accident | WORKING |
| Are you claiming under your own insurance policy for repair to your vehicle? | NO |
| If No, Please state action to be taken | REPORTING ONLY |
| Vehicle Category | COMMERCIAL VEHICLE |

Insurance Company

| | |
|---------------------------|----------------------|
| Name of Insurance Company | LONPAC INSURANCE BHD |
| Type Of Coverage | THIRD PARTY |
| Fleet Policy | NO |
| Policy Number | Z19VC05002797 |
| Cover Note Number | |

Driver

| | |
|----------------------|------------------------|
| Name of Driver | QUEK CHOON KEE |
| NRIC No | S1672824A |
| Date Of Birth | 27/09/1964 |
| Occupation | OUTDOOR |
| Date Of Driving Pass | 27/12/1995 |
| Driving Experience | 23 YEARS AND 11 MONTHS |
| Gender | MALE |
| Mobile Number | (LOCAL) +65-86687128 |
| Fax Number | |
| Contact Number | |
| EEmail Address | NOEMAIL |

| | |
|---|-------------------------------|
| Address | BLK 449 TAMPINES ST 42 #11-88 |
| Postcode | 520449 |
| Was driver an employee of the Insured's Company | YES |
| If No, Relationship of the Driver with the Insured | |
| Vehicle Registration Number of Driver's Own Vehicle | - |
| | - |
| | - |
| Insurance Company of Driver's Own Vehicle | - |
| | - |
| | - |

General Information of the Accident

| | |
|--------------------|------------------------|
| Type Of Accident | COLLIDED INTO PROPERTY |
| Weather Conditions | CLEAR |
| Road Surface | DRY |

Other Information

| | |
|---|-----|
| Was any foreign vehicle involved in this accident? | NO |
| Number of vehicles (including own vehicle) involved in the accident | 1 |
| Was any body injured in the Accident? | NO |
| Was any injured conveyed to hospital by ambulance? | |
| Was any other material or property damaged? | YES |
| I have been approached by unknown person(s) soliciting/offering accident claims assistance. | NO |
| Number of Passengers (Including Driver) | 1 |

Details of Police Action

| | |
|---|----|
| Was the accident reported to the police? | NO |
| If Yes, Please state which Police Station | |
| Was notice of intended Prosecution given? | NO |
| If Yes, against whom? | |

Circumstances of Accident

I WAS DELIVERY TO THE PARK ROYAL KITCHENER HOTEL, WHILE I REVERSING MY LORRY, MY LORRY REAR LEFT ACCIDENTALLY HIT ONTO A LAMP POST(2R3) NEAR THE PARK ROYAL HOTEL BASEMENT CARPARK ENTRANCE.

Attachment(s)

| | |
|---|-----|
| Are accident photos available for attachment? | YES |
| Was there any video captured by Car Camera? | NO |
| Was there any audio recorded? | NO |

DETAILS OF OTHER VEHICLE PROPERTY 1

| | |
|-------------------------------------|-----------------|
| Vehicle Registration Number | |
| Vehicle Make/Model/Colour | LAMP POST (2R3) |
| Details Of Properties | |
| Vehicle Category | GOVERNMENT |
| Name of Driver | |
| NRIC/Passport Number | |
| Contact Number | |
| Address | |
| Postcode | |
| Insurance Company Name | |
| Nature Of Damage | |
| No. Of Passenger (Including Driver) | |

Accident Sketch Plan

SKETCH PLAN

IMPORTANT NOTICE

1. Please report **correctly** the details of the accident to speed up the claims process.
2. This Form must be **completed by the Policyholder and/or the Authorised Driver**.
3. Information provided must be as **truthful and accurate as possible**. Any wilful misrepresentation or withholding of material facts may allow insurance companies to **repudiate policy liability**.
4. The issue and acceptance of this Form by insurance companies is not an admission of policy liability on the part of the insurance companies.
5. **Any false reporting may be referred to the Police for investigation.**
6. The report will be forwarded by the insurers of the GIA Records Management Centre established by the General Insurance Association of Singapore (GIA) for archiving and that copies of this report will for a fee be made available upon application by interested parties.
7. By the lodgment of this report to the insurers, you hereby consent to the archiving of this report at the centre and to copies of the report being made available aforesaid.
8. **Consent under the Personal Data Protection Act (PDPA)**

I understand, acknowledge, agree and consent that:

- (a) My insurer, my workshop and the General Insurance Association of Singapore ("GIA") may/are permitted to collect, use, disclose and/or process my personal data/personal information set out in this (form) and any other personal information provided by me or possessed by my insurer (collectively the "Personal Information") and disclose and transfer such Personal Information to all insurer(s) who have insured vehicle(s) involved in this accident (all insurer(s) who have insured vehicle(s) involved in this accident shall be collectively referred to as the "Insurers"), the Insurers' lawyers/law firms, the Monetary Authority of Singapore and any relevant government agency/authority (such as the police), for the purpose(s) of:
 - (i) processing, handling and/or dealing with my claims including the settlement of the claims and any necessary investigations relating to the claims;
 - (ii) investigating the accident and/or my claims;
 - (iii) carrying out and/or dealing with my instructions or responding to any enquiries by me;
 - (iv) administering my claims (including the mailing of correspondence, statements, invoices, reports or notices to me, which could involve disclosure of certain personal data about me to bring about delivery of the same as well as on the external cover of envelopes/mail packages); and/or
 - (v) complying with applicable law in administering, processing, handling and/or dealing with my claims (collectively the "Purposes")
- (b) all insurer(s) who have insured vehicle(s) involved in this accident and the Insurers' lawyers/law firms, may/are permitted to collect, use, disclose and/or process my Personal Information for one or more of the above Purposes; and
- (c) my Personal Information may/can be disclosed by any of the Insurers and/or GIA to their third party service providers or agents (including their lawyers/law firms), which may be sited outside of Singapore, for one or more of the above Purposes.
- (d) my Personal Information will also be collected and used to compile claims history for the purpose of fraud detection, investigation and management in present and all future claims.
- (e) the information so collected under (d) above may be shared / disclosed:
 - (i) to all insurers and/or any other third parties that assist in evaluating, investigating, controlling or managing fraud, regulators, law enforcement and government agencies as reasonably required for the purposes stated, or
 - (ii) for complying with requirements under any regulations, laws or court orders.



Policyholder's Signature
Date & Time:

Driver's Signature
(If driver is not the policyholder)
Date & Time:

Reporting Centre Personnel's Signature
Name:
NRIC/FIN No.:

Accident Sketch Plan

SKETCH PLAN

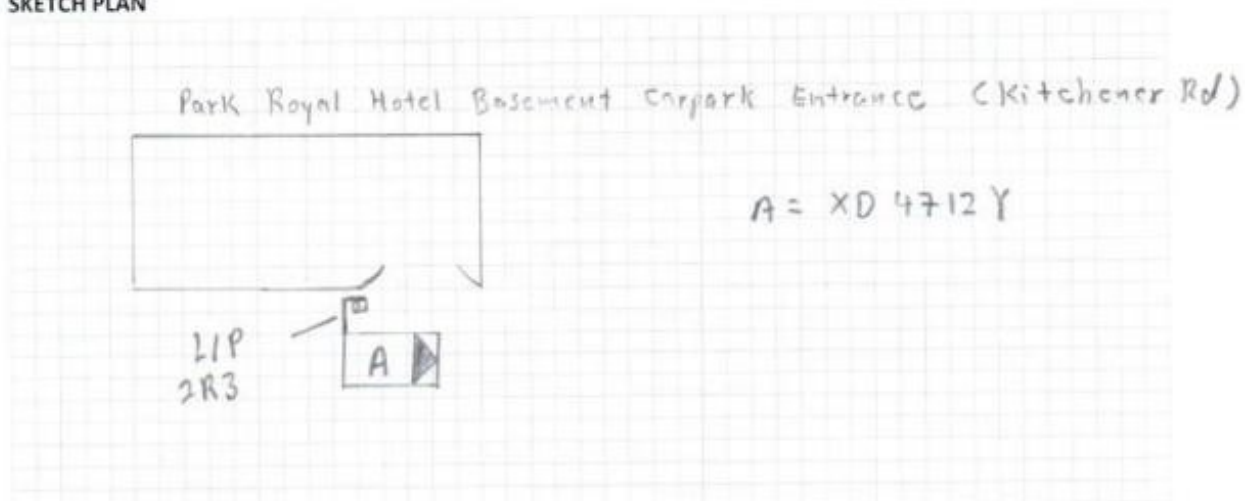

DESCRIBE CIRCUMSTANCES OF THE ACCIDENT

Refer to statement

DECLARATION

I/We declare the foregoing particulars are true in every respect.

Policyholder's Signature: _____
Date & Time: _____



Driver's Signature
(If driver is not the policyholder)
Date & Time:

Reporting Centre Personnel's Signature
Name:
NRIC/FIN No.:

Accident Photo



Accident Photo



Accident Photo



Accident Photo



Accident Photo



Accident Photo



Accident Photo



Accident Photo



Accident Photo



IS NO : JALCYZ52 RB7000037

U/W : 13700 KG

L/W : 28000KG

CAP : 02

SIZE : F 295-80R22-5(S)

: R 295-80R22-5(D)x2