

SINGAPORE ACCIDENT STATEMENT

IMPORTANT NOTICE

1. Please report correctly the details of the accident to speed up the claims process.
2. This Form must be completed by the Policyholder and/or the Authorised Driver.
3. Information provided must be as truthful and accurate as possible. Any wilful misrepresentation or withholding of material facts may allow insurance companies to repudiate policy liability.
4. The issue and acceptance of this Form by insurance companies is not an admission of policy liability on the part of the insurance companies.
5. **Any false reporting may be referred to the Police for investigation.**
6. This report will be forwarded by the insurers of the GIA Records Management Centre established by the General Insurance Association of Singapore (GIA) for archiving and that copies of this report will, for a fee, be made available upon application by interested parties.
7. By the lodgement of this report to the insurers, you hereby consent to the archiving of this report at the centre and to copies of the report being made available aforesaid.

ACCIDENT STATEMENT

Date Of Report	30/11/2019 13:17
Date Of Accident	29/11/2019 13:50
Exact Location Of Accident	OUTSIDE WHEELER'S ESTATE
Country/State of Loss	SINGAPORE

DETAILS OF OWN VEHICLE

Vehicle Registration Number	GP9116Z
Insured/Policyholder	
Name Of Registered Owner	M/S SWEE LEONG EGGS DISTRIBUTOR
Co Reg No	-
Email Address	NOEMAIL
Mobile Phone No	
Alternative Phone No	OFFICE-64820837

Vehicle Particulars

Manufacturer	TOYOTA
Model	DYNA
Exact Purpose for which vehicle was being used at time of accident	WORK
Are you claiming under your own insurance policy for repair to your vehicle?	NO
If No, Please state action to be taken	THIRD PARTY
Vehicle Category	COMMERCIAL VEHICLE

Insurance Company

Name of Insurance Company	CHINA TAIPING INSURANCE (SINGAPORE) PTE. LTD.
Type Of Coverage	THIRD PARTY FIRE AND/OR THEFT
Fleet Policy	NO
Policy Number	DMCVSN0034481914
Cover Note Number	

Driver

Name of Driver	ZHU JIANHUA
NRIC No	G5143308X
Date Of Birth	04/12/1980
Occupation	OUTDOOR
Date Of Driving Pass	18/02/2013
Driving Experience	6 YEARS AND 9 MONTHS
Gender	MALE
Mobile Number	(LOCAL) +65-91115201
Fax Number	
Contact Number	
EEmail Address	NOEMAIL

Address	221 JALAN KAYU
Postcode	799445
Was driver an employee of the Insured's Company	YES
If No, Relationship of the Driver with the Insured	
Vehicle Registration Number of Driver's Own Vehicle	-
	-
	-
Insurance Company of Driver's Own Vehicle	-
	-
	-

General Information of the Accident

Type Of Accident	HIT AND RUN / VANDALISM / DAMAGED WHILST PARKED
Weather Conditions	RAINING
Road Surface	WET

Other Information

Was any foreign vehicle involved in this accident?	NO
Number of vehicles (including own vehicle) involved in the accident	3
Was any body injured in the Accident?	NO
Was any injured conveyed to hospital by ambulance?	
Was any other material or property damaged?	YES
I have been approached by unknown person(s) soliciting/offering accident claims assistance.	NO
Number of Passengers (Including Driver)	0

Details of Police Action

Was the accident reported to the police?	NO
If Yes, Please state which Police Station	
Was notice of intended Prosecution given?	NO
If Yes, against whom?	

Circumstances of Accident

REFER TO STATEMENT.

Attachment(s)

Are accident photos available for attachment?	YES
Was there any video captured by Car Camera?	NO
Was there any audio recorded?	NO

DETAILS OF OTHER VEHICLE PROPERTY 1

Vehicle Registration Number	YN1686U
Vehicle Make/Model/Colour	
Details Of Properties	
Vehicle Category	COMMERCIAL VEHICLE
Name of Driver	CHUAI CHENXI
NRIC/Passport Number	G870886W
Contact Number	91918964
Address	
Postcode	
Insurance Company Name	
Nature Of Damage	
No. Of Passenger (Including Driver)	

DETAILS OF OTHER VEHICLE PROPERTY 2

Vehicle Registration Number	SMK5924P
-----------------------------	----------

Vehicle Make/Model/Colour	
Details Of Properties	
Vehicle Category	PRIVATE CAR
Name of Driver	
NRIC/Passport Number	
Contact Number	
Address	
Postcode	
Insurance Company Name	
Nature Of Damage	
No. Of Passenger (Including Driver)	

Accident Sketch Plan

SKETCH PLAN

IMPORTANT NOTICE

- 1) Please report correctly on the details of the accident to speed up the claims process.
- 2) This form must be completed by the policy holder and/or the authorised driver.
- 3) Information provided must be as truthful and accurate as possible. Any wilful misrepresentation or withholding of material facts may allow insurance companies to repudiate policy liability.
- 4) The issue and acceptance of this form by insurance companies is not an admission of policy liability on the part of the insurance companies.
- 5) Any false reporting may be referred to the police for investigation.
- 6) The report will be forwarded by the insurers of the GIA Records Management Centre established by the General Insurance Association of Singapore (GIA) for archiving and that copies of this report will for a fee be made available upon application by interested parties.
- 7) By the lodgement of this report to the insurers, you hereby consent to the archiving of this report at the centre and to copies of the report being made available aforesaid.
- 8) **Consent under the Personal Data Protection Act (PDPA)**

I understand, acknowledge, agree and consent that:

- (a) My insurer, my workshop and the General Insurance Association of Singapore ("GIA") may/are permitted to collect, use, disclose and/or process my personal data/personal information set out in the [form] and any other personal information provided by me or possessed by my insurer (collectively the "Personal Information") and disclose and transfer such personal information to all insurer(s) who have insured vehicle(s) involved in this accident (all insurer(s) who have insured vehicle(s) involved in this accident shall be collectively referred to as the "insurers"), the insurers' lawyers/law firm, the Monetary Authority of Singapore and any relevant government agency/authority (such as police), for the purpose(s) of:
 - (I) Processing, handling and/or dealing with my claims including the settlement of the claims and any necessary investigations relating to the claims;
 - (II) Investigations the accident and/or my claims;
 - (III) Carrying out and/or dealing with my instructions or responding to any enquiries by me;
 - (IV) Administering my claims (including the mailing of correspondence, statement, invoices, reports or notices to me, which could involve disclosure of certain personal data about me to bring about delivery of the same as well as on the external cover of envelopes/mail packages); and/or
 - (V) Complying with applicable law in administering, processing, handling and/or dealing with my claims.(collectively the "purposes")
- (b) All insurer(s) who have insured vehicle(s) involved in this accident and the Insurers' lawyer/law firms, may/are permitted to collect, use, disclose and/or process my personal information for one or more of the above purposes; and
- (c) My personal information may/can be disclosed by any of the insurer and/or GIA to their third party service providers or agents (including their lawyer/law firms), which may be sited outside of Singapore, for one or more of the above purposes.
- (d) My personal information will also be collected and used to compile claims history for the purpose of fraud detection, investigation and management in present and all future claims.
- (e) The information so collected under (d) above may be shared / disclosed:
 - (I) To all insurers and/or any other third parties that assist in evaluating, investigation, controlling or managing fraud, regulators, law enforcement and government agencies as reasonably required for the purposed stated, or
 - (II) For complying with requirements under my regulations, laws or court orders.

.....
221, JALAN KAYU
TEL: 63420007

Policy holder's signature
Date / time:

Driver's signature
(if driver is not policy holder)
Date / time:

reporting centre personnel's Signature
Date / time:

Accident Sketch Plan

SKETCH PLAN

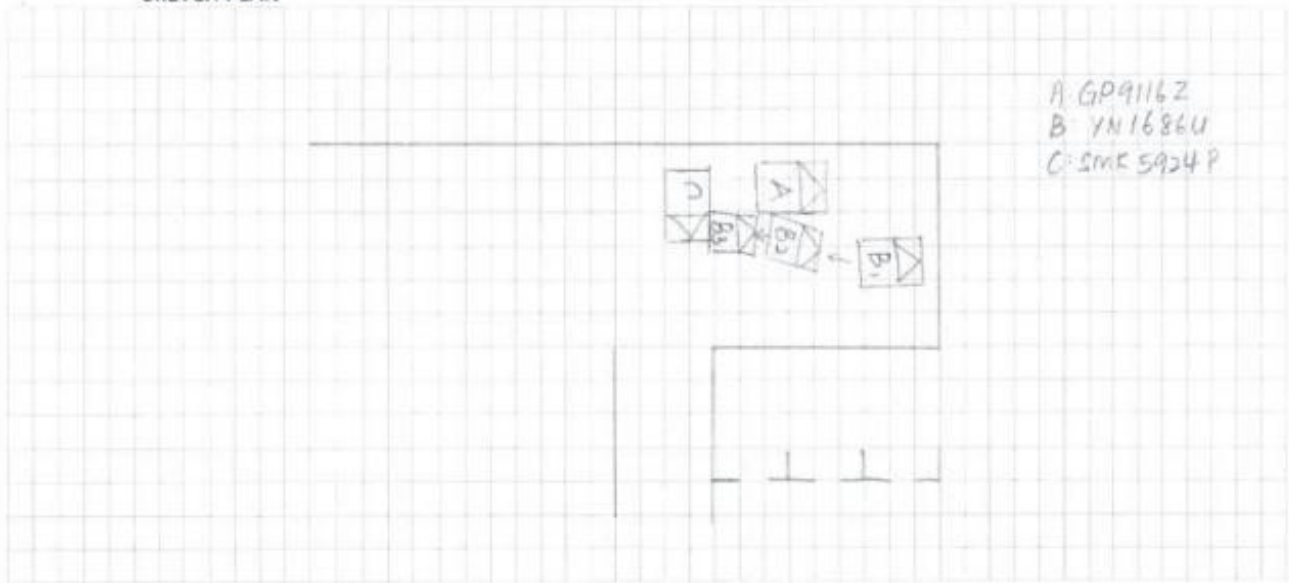

DESCRIBE CIRCUMSTANCES OF THE ACCIDENT

My vehicle was parked outside the Wheeler's Estate to unload my goods. When I came back to my vehicle, I realised that my vehicle was hit by my vehicle B when vehicle B was reversing. I noticed that vehicle B also collided with vehicle C which was parked behind my vehicle.

DECLARATION

I/We declare the foregoing particulars are true in every respect.

Policy holder's signature
Date & time:

Driver's signature
(if driver is not policy holder)
Date & time:

reporting centre personnel's Signature
NRIC/FIN No.:

Accident Photo



Accident Photo



Accident Photo



Accident Photo



Accident Photo



Accident Photo



Accident Photo



Accident Photo

