

NATIONAL Assessment Centre Services.

[ver 1 Jan'03]

MMA 119158059

Date In: 30/11/19 13:17	Job description	Date & Time Completed	Done by
Ref No: MA1CTZ19021151164	SAS e-filing		
Veh No: GP 91162	E-mail (within 3hrs, AIC 2hrs)		
DDA: 29/11/19 13:50	I-Motor Claim Form		
OD: <input checked="" type="radio"/> Reporting Only	I-Motor W/O (within: OD 2hrs, TP 4hrs)		
TP Insurer:	I-Photo Uploaded		
	Assessment/Survey Report		
	Ass't Report by Fax / Hand to Owner/Whse		

Preferred Wksp / INC Assign Wksp / GW: (Tel:	Fax:
TP Particulars:	Veh No: YN 1686 U	INC () / Non-INC ()
Owner / Driver: (Tel:	
Policy No: ()	Period: ()	Cover Type: ()
Confirmed by: (Date:	Time:
Insured/Driver Liability: ()	% [Note-Est. Status (WO): N: 0-20%; P: 21-79%; P: 80-100%]	
Year of Registration: ()	Warranty: YBS () / NO ()	
Excess: (\$)	Loading: \$1,000 () / \$2,000 ()	

() Walk-In Customer: Customer's Information strictly Confidential & Strictly NO refer of rapolier.

() Total Loss Case: to e-mail Insurer URGENTLY.

Drive-In () / Towed-In (); Invoice: YES () / NO (); Towing Co: ()

1) Apply for Transport Allowance () / Courtesy Car ()	
2) QC Check / Post Repair Inspection ()	
3) Upload Resurvey Photo [Repair Cost > \$3000] ()	

Injury: _____

Date/Time	Action

MA1909014	Invoice No: ()	Am't (\$)	PAID (\$)
1) AR: Accident Reporting (\$30)		30.00	
2) DA: Damage Assessment (\$100)	INC (\$80)		
3) TP: Towing Fee	\$40/\$45		
4) PT: Follow-Through Survey	\$120		
5) PT: Follow-Through Survey (Resurvey)	\$30		
For retaining against INC Only (over 10 Jan 2003)			
6) TR: Re-Inspection	\$75		
7) NI: Ideal DA + SMRT Survey	\$160		
8) NTUC Additional Services:-			
ON:			
*N5: Courtesy Car / Tpt Allowance	\$5		
*N6: Repair Co-ordination	\$10		
*N7: Post Repair Inspection	\$25		
*N8: DV / Collect Excess Coordination	\$5		
TP (N11): TP (ISN INC) against INC	\$20		
9) N12: Ideal Mobile	\$0		
Invoice dated	Fee Charged		
Invoice dated	Fee Charged		

SINGAPORE ACCIDENT STATEMENT

IMPORTANT NOTICE

1. Please report correctly the details of the accident to speed up the claims process.
2. This Form must be completed by the Policyholder and/or the Authorised Driver.
3. Information provided must be as truthful and accurate as possible. Any wilful misrepresentation or withholding of material facts may allow insurance companies to repudiate policy liability.
4. The issue and acceptance of this Form by insurance companies is not an admission of policy liability on the part of the insurance companies.
5. Any false reporting may be referred to the Police for investigation.
6. This report will be forwarded by the insurers of the GIA Records Management Centre established by the General Insurance Association of Singapore (GIA) for archiving and that copies of this report will, for a fee, be made available upon application by interested parties.
7. By the lodgement of this report to the insurers, you hereby consent to the archiving of this report at the centre and to copies of the report being made available aforesaid.

ACCIDENT STATEMENT

Date Of Report	30/11/2019 13:17
Date Of Accident	29/11/2019 13:50
Exact Location Of Accident	OUTSIDE WHEELER'S ESTATE
Country/State of Loss	SINGAPORE

DETAILS OF OWN VEHICLE

Vehicle Registration Number	GP9116Z
Insured/Policyholder	
Name Of Registered Owner	M/S SWEE LEONG EGGS DISTRIBUTOR
Co Reg No	-
Email Address	NOEMAIL
Mobile Phone No	
Alternative Phone No	OFFICE-64820837

Vehicle Particulars

Manufacturer	TOYOTA
Model	DYNA
Exact Purpose for which vehicle was being used at time of accident	WORK
Are you claiming under your own insurance policy for repair to your vehicle?	NO
If No, Please state action to be taken	THIRD PARTY
Vehicle Category	COMMERCIAL VEHICLE

Insurance Company

Name of Insurance Company	CHINA TAIPING INSURANCE (SINGAPORE) PTE. LTD.
Type Of Coverage	THIRD PARTY FIRE AND/OR THEFT
Fleet Policy	NO
Policy Number	DMCVSN0034481914
Cover Note Number	

Driver

Name of Driver	ZHU JIANHUA
NRIC No	G5143308X
Date Of Birth	04/12/1980
Occupation	OUTDOOR
Date Of Driving Pass	18/02/2013
Driving Experience	6 YEARS AND 9 MONTHS
Gender	MALE
Mobile Number	(LOCAL) +65-91115201
Fax Number	
Contact Number	
Email Address	NOEMAIL

Address	221 JALAN KAYU
Postcode	799445
Was driver an employee of the Insured's Company	YES
If No, Relationship of the Driver with the Insured	
Vehicle Registration Number of Driver's Own Vehicle	-
	-
	-
Insurance Company of Driver's Own Vehicle	-
	-
	-

General Information of the Accident

Type Of Accident	HIT AND RUN / VANDALISM / DAMAGED WHILST PARKED
Weather Conditions	RAINING
Road Surface	WET

Other Information

Was any foreign vehicle involved in this accident?	NO
Number of vehicles (including own vehicle) involved in the accident	3
Was any body injured in the Accident?	NO
Was any injured conveyed to hospital by ambulance?	
Was any other material or property damaged?	YES
I have been approached by unknown person(s) soliciting/offering accident claims assistance.	NO
Number of Passengers (Including Driver)	0

Details of Police Action

Was the accident reported to the police?	NO
If Yes, Please state which Police Station	
Was notice of intended Prosecution given?	NO
If Yes, against whom?	

Circumstances of Accident

REFER TO STATEMENT.

Attachment(s)

Are accident photos available for attachment?	YES
Was there any video captured by Car Camera?	NO
Was there any audio recorded?	NO

DETAILS OF OTHER VEHICLE PROPERTY 1

Vehicle Registration Number	YN1686U
Vehicle Make/Model/Colour	
Details Of Properties	
Vehicle Category	COMMERCIAL VEHICLE
Name of Driver	CHUAI CHENXI
NRIC/Passport Number	G870886W
Contact Number	91918964
Address	
Postcode	
Insurance Company Name	
Nature Of Damage	
No. Of Passenger (Including Driver)	

DETAILS OF OTHER VEHICLE PROPERTY 2

Vehicle Registration Number	SMK5924P
-----------------------------	----------

Vehicle Make/Model/Colour

Details Of Properties

Vehicle Category

PRIVATE CAR

Name of Driver

NRIC/Passport Number

Contact Number

Address

Postcode

Insurance Company Name

Nature Of Damage

No. Of Passenger (Including Driver)

SKETCH PLAN

IMPORTANT NOTICE

- 1) Please report **correctly** on the details of the accident to speed up the claims process.
- 2) This form must **be completed by the policy holder and/or the authorised driver.**
- 3) Information provided must be as **truthful and accurate as possible.** Any wilful misrepresentation or withholding of material facts may allow insurance companies to **repudiate policy liability.**
- 4) The issue and acceptance of this form by insurance companies is not an admission of policy liability on the part of the insurance companies.
- 5) **Any false reporting may be referred to the police for investigation.**
- 6) The report will be forwarded by the insurers of the GIA Records Management Centre established by the General Insurance Association of Singapore (GIA) for archiving and that copies of this report will for a fee be made available upon application by interested parties.
- 7) By the lodgement of this report to the insurers, you hereby consent to the archiving of this report at the centre and to copies of the report being made available aforesaid.
- 8) **Consent under the Personal Data Protection Act (PDPA)**

I understand, acknowledge, agree and consent that:

- (a) My insurer, my workshop and the General Insurance Association of Singapore ("GIA") may/are permitted to collect, use, disclose and/or process my personal data/personal information set out in the [form] and any other personal information provided by me or possessed by my insurer (collectively the "Personal Information") and disclose and transfer such personal information to all insurer(s) who have insured vehicle(s) involved in this accident (all insurer(s) who have insured vehicle(s) involved in this accident shall be collectively referred to as the "Insurers"), the insurers' lawyers/law firm, the Monetary Authority of Singapore and any relevant government agency/authority (such as police), for the purpose(s) of :
- (I) Processing, handling and/or dealing with my claims including the settlement of the claims and any necessary investigations relating to the claims;
 - (II) Investigations the accident and/or my claims;
 - (III) Carrying out and/or dealing with my instructions or responding to any enquiries by me;
 - (IV) Administering my claims (including the mailing of correspondence, statement, invoices, reports or notices to me, which could involve disclosure of certain personal data about me to bring about delivery of the same as well as on the external cover of envelops/mail packages); and/or
 - (V) Complying with applicable law in administering, processing, handling and/or dealing with my claims.(collectively the "purposes")
- (b) All insurer(s) who have insured vehicle(s) involved in this accident and the Insurers' lawyer/law firms, may/are permitted to collect, use, disclose and/or process my personal information for one or more of the above purposes; and
- (c) My personal information may/can be disclosed by any of the insurer and/or GIA to their third party service providers or agents (including their lawyer/law firms), which may be sited outside of Singapore, for one or more of the above purposes.
- (d) My personal information will also be collected and used to compile claims history for the purpose of fraud detection, investigation and management in present and all future claims.
- (e) The information so collected under (d) above may be shared / disclosed:
- (I) To all insurers and/or any other third parties that assist in evaluating, investigation, controlling or managing fraud, regulators, law enforcement and government agencies as reasonably required for the purposed stated, or
 - (II) For complying with requirements under my regulations, laws or court orders.

221, JALAN KAYU
TEL: 64623337

Policy holder's signature
Date / time:

Driver's signature
(if driver is not policy holder)
Date / time:

reporting centre personnel's Signature
Date / time:

SKETCH PLAN

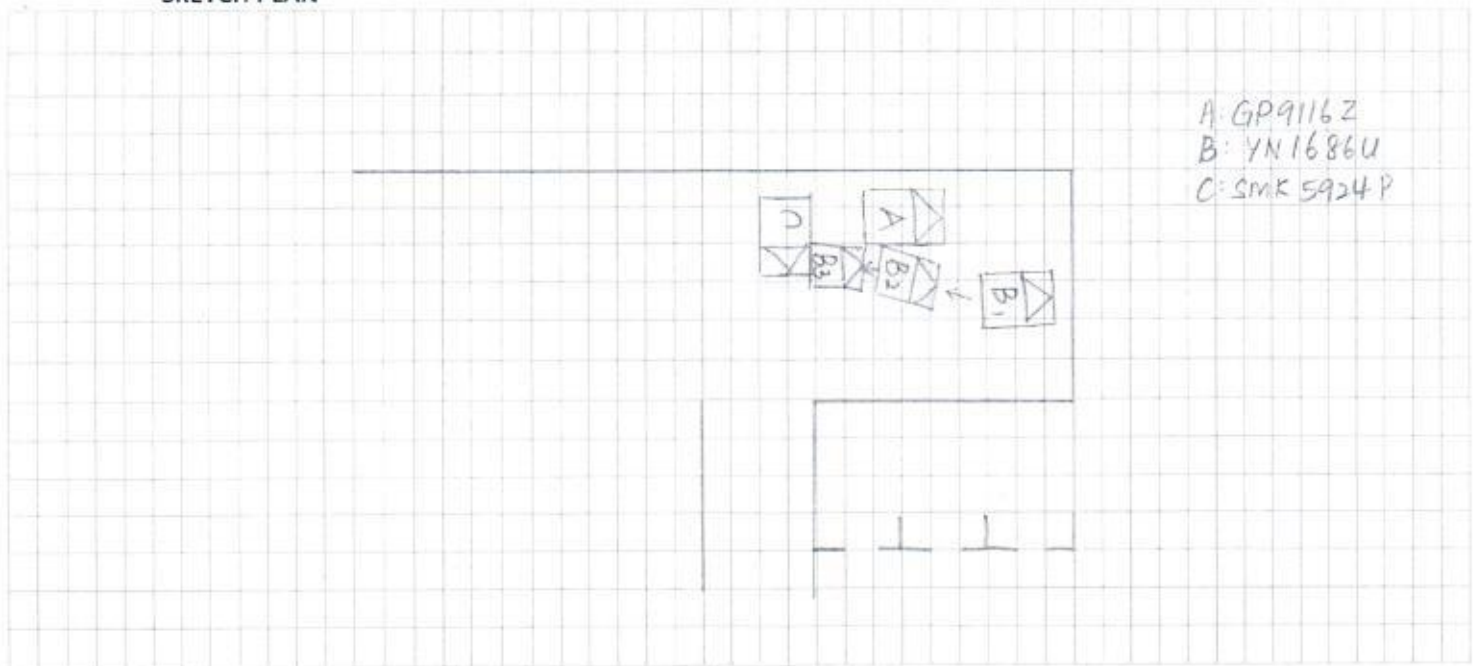

DESCRIBE CIRCUMSTANCES OF THE ACCIDENT

My vehicle was parked outside the Wheeler's Estate to unload my goods. When I came back to my vehicle, I realised that my vehicle was hit my vehicle B when vehicle B was reversing. I noticed that vehicle B also collided vehicle C which was parked behind my vehicle.

DECLARATION

I/We declare the foregoing particulars are true in every respect.

221, 001 116 700
TEL: 6-121137

[Signature]

[Signature]

Policy holder's signature
Date & time:

Driver's signature
(if driver is not policy holder)
Date & time:

reporting centre personnel's Signature
NRIC/FIN No.:

SINGAPORE ACCIDENT STATEMENT

IMPORTANT NOTICE

- ❖ Complete and submit this form to the individual insurance authorised reporting centre.
- ❖ Please report correctly on the details of the accident to speed up the claim process.
- ❖ This form must be filled up by the policy holder and/or authorised driver.
- ❖ Information provided must be as fruitful and accurate as possible. Any wilful misrepresentation or withholding of material facts may allow insurance companies to repudiate policy liability.
- ❖ The issue and acceptance of this form by insurance companies is not an admission of policy liability on the part of the insurance companies.
- ❖ Any false reporting may be referred to the traffic police department for investigation.

ACCIDENT DETAILS

Date of accident	29/11/2019	(DD/MM/YY)
Time of accident	1350	(HH:MM)
Exact location of accident	Outside Wheeler's Estate	

DETAILS OF VEHICLE

Vehicle registration number	GP9116Z		
Vehicle make and model	Toyota Dyna		
Type of vehicle	Saloon <input type="checkbox"/>	MPV <input type="checkbox"/>	CRV <input type="checkbox"/> Van <input type="checkbox"/>
	Lorry <input checked="" type="checkbox"/>	Bus <input type="checkbox"/>	Motorcycle <input type="checkbox"/> Others: _____
Vehicle category	Private <input type="checkbox"/>	Commercial <input checked="" type="checkbox"/>	Motorcycle <input type="checkbox"/>
Purpose of using at said time			
Are you claiming under your own insurance company?	Yes <input type="checkbox"/>	No <input checked="" type="checkbox"/>	if no, please select:
	Third part claim <input checked="" type="checkbox"/>	Reporting only <input type="checkbox"/>	

INSURANCE INFORMATION

Insurance company	China Taiping		
Policy number			
Type of policy	Comprehensive <input type="checkbox"/>	Third party fire & theft <input type="checkbox"/>	TP only <input type="checkbox"/>

INSURED / POLICY HOLDER

Name	Swee Leong Eggs Distributor	Male <input type="checkbox"/>	Female <input type="checkbox"/>
NRIC / Fin / Passport number			
Contact	6482 0837		
Address	221, Jalan Kayu		

DRIVER

SAME AS INSURED ABOVE ☐ (SKIP TO D.O.B)

Name	Zhu JianHua	Male <input checked="" type="checkbox"/>	Female <input type="checkbox"/>
NRIC / Fin / Passport number	G5143308X		
Contact	9111 5201		
Address			
Email address			
Date of birth	04/12/1980		
Occupation	Indoor <input type="checkbox"/>	Outdoor <input checked="" type="checkbox"/>	
Driving date pass	18/02/2013		

GENERAL INFORMATION OF THE ACCIDENT	
Was driver an employee of the insured's company?	Yes <input checked="" type="checkbox"/> No <input type="checkbox"/> If no, relationship of the driver and insured: _____
Accident captured by camera?	Yes <input type="checkbox"/> No <input checked="" type="checkbox"/>
Weather condition	Clear <input type="checkbox"/> Raining <input checked="" type="checkbox"/> Others: _____
Road surface	Dry <input type="checkbox"/> Wet <input checked="" type="checkbox"/>
No of passenger	0 (Inclusive of driver)

PASSENGER 1	
Name	
Gender	Male <input type="checkbox"/> Female <input type="checkbox"/>

PASSENGER 2	
Name	
Gender	Male <input type="checkbox"/> Female <input type="checkbox"/>

PASSENGER 3	
Name	
Gender	Male <input type="checkbox"/> Female <input type="checkbox"/>

PASSENGER 4	
Name	
Gender	Male <input type="checkbox"/> Female <input type="checkbox"/>

PASSENGER 5	
Name	
Gender	Male <input type="checkbox"/> Female <input type="checkbox"/>

PASSENGER 6	
Name	
Gender	Male <input type="checkbox"/> Female <input type="checkbox"/>

OTHER INFORMATION	
Was anybody injured?	Yes <input type="checkbox"/> No <input checked="" type="checkbox"/>
Was other vehicle damaged?	Yes <input checked="" type="checkbox"/> No <input type="checkbox"/>

DETAILS OF POLICE STATION ACTION	
Reported to police?	Yes <input type="checkbox"/> No <input checked="" type="checkbox"/> If yes, please state which police station.
Police station name	

WITNESS 1	
Name	

WITNESS 2	
Name	

THIRD PARTY VEHICLE 1	
Vehicle registration number	YN 1686 U
Vehicle make model	
Name	Chuai Chen Xi
NRIC / Fin / Passport number	G 8708886 W
Contact	9191 8964

THIRD PARTY VEHICLE 2	
Vehicle registration number	SMK 5924 P
Vehicle make model	
Name	
NRIC / Fin / Passport number	
Contact	

THIRD PARTY VEHICLE 3	
Vehicle registration number	
Vehicle make model	
Name	
NRIC / Fin / Passport number	
Contact	

THIRD PARTY VEHICLE 4	
Vehicle registration number	
Vehicle make model	
Name	
NRIC / Fin / Passport number	
Contact	

THIRD PARTY VEHICLE 5	
Vehicle registration number	
Vehicle make model	
Name	
NRIC / Fin / Passport number	
Contact	

THIRD PARTY VEHICLE 6	
Vehicle registration number	
Vehicle make model	
Name	
NRIC / Fin / Passport number	
Contact	

THIRD PARTY VEHICLE 7	
Vehicle registration number	
Vehicle make model	
Name	
NRIC / Fin / Passport number	
Contact	

INJURED PERSON 1	
Name	
Injuries sustained	
Which vehicle person in?	
Were seat belts worn?	Yes <input type="checkbox"/> No <input type="checkbox"/>
Was injured conveyed to hospital by ambulance?	Yes <input type="checkbox"/> No <input type="checkbox"/>

INJURED PERSON 2	
Name	
Injuries sustained	
Which vehicle person in?	
Were seat belts worn?	Yes <input type="checkbox"/> No <input type="checkbox"/>
Was injured conveyed to hospital by ambulance?	Yes <input type="checkbox"/> No <input type="checkbox"/>

INJURED PERSON 3	
Name	
Injuries sustained	
Which vehicle person in?	
Were seat belts worn?	Yes <input type="checkbox"/> No <input type="checkbox"/>
Was injured conveyed to hospital by ambulance?	Yes <input type="checkbox"/> No <input type="checkbox"/>

INJURED PERSON 4	
Name	
Injuries sustained	
Which vehicle person in?	
Were seat belts worn?	Yes <input type="checkbox"/> No <input type="checkbox"/>
Was injured conveyed to hospital by ambulance?	Yes <input type="checkbox"/> No <input type="checkbox"/>

INJURED PERSON 5	
Name	
Injuries sustained	
Which vehicle person in?	
Were seat belts worn?	Yes <input type="checkbox"/> No <input type="checkbox"/>
Was injured conveyed to hospital by ambulance?	Yes <input type="checkbox"/> No <input type="checkbox"/>

INJURED PERSON 6	
Name	
Injuries sustained	
Which vehicle person in?	
Were seat belts worn?	Yes <input type="checkbox"/> No <input type="checkbox"/>
Was injured conveyed to hospital by ambulance?	Yes <input type="checkbox"/> No <input type="checkbox"/>

MOTOR COMMERCIAL VEHICLE

CERTIFICATE OF INSURANCE

Motor Vehicles (Third-Party Risks and Compensation) Act (Chapter 189)
Motor Vehicles (Third-Party Risks and Compensation) Rules, 1960
Road Transport Act, 1987 (Malaysia)
Motor Vehicles (Third-Party Risks) Rules, 1959 (Malaysia)

ORIGINAL

CERTIFICATE No.

DMCVSN0034481914

Engine No : 5L5569861

ChaN: JTFUP34YX03010218

1. Index Mark and Registration
Number of Vehicle

GP9116Z

2. Name of Policy Holder

M/S SWEET LEONG EGGS DISTRIBUTOR

3. Effective date of the Commencement of
Insurance for the purposes of the Regulations, Ordinance or Enactment

15 March 2019

4. Date of Expiry of Insurance

14 March 2020

5. Persons or Classes of Persons entitled to drive*

Any person who is driving on the Policyholder's order or with their permission.

Provided that the person driving is permitted in accordance with the licensing or other laws or regulations to drive the Motor Vehicle or has been so permitted and is not disqualified by order of a Court of Law or by reason of any enactment or regulation in that behalf from driving the Motor Vehicle.

6. Limitations as to use:

(1) Use in connection with the Policyholder's business.

(2) Use for the carriage of passengers (other than for hire or reward) in connection with the Policyholder's business.

(3) Use for social, domestic or pleasure purposes.

The Policy does not cover.

(1) Use for hire or reward or racing, pace-making, reliability trial or speed testing.

(2) Use whilst drawing a trailer except the towing of any one disabled mechanically propelled vehicle.

* Limitations rendered inoperative by Section 8 of the Motor Vehicles (Third-Party Risks and Compensation) Act (Chapter 189) and Section 95 of the Road Transport Act 1987 (Malaysia), are not to be included under these headings.

I/We hereby Certify that the policy to which this Certificate relates is issued in accordance with the provisions of the Motor Vehicles (Third-Party Risks and Compensation) Act (Chapter 189) and Part IV of the Road Transport Act, 1987 (Malaysia).

Please see reverse

For CHINA TAIPING INSURANCE (SINGAPORE) PTE. LTD.

Issued By:

Authorised Officer

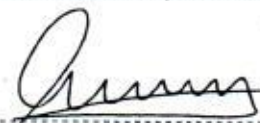
Authorised Signatory