

NATIONAL Assessment Centre Services.

[ver 1 Jan 2003]

MMA 119153315

Date In: 20/11/19 13:45

Ref No: NAI/TMZ19020565144

Veh No: GBC 2715T

DOA: 19/11/19 13:45

OT: ☒ Reporting Only

TP Insurer:

Job description

SAS e-filing

E-mail (within 8hrs, AIG 2hrs)

I-Motor Claim Form

I-Motor W/O (Within: OD 2hrs, TP 4hrs)

I-Photo Uploaded

Assessment/Survey Report

Ass't Report by Fax / Hand to Owner/Wksn

Date & Time Completed

Done by

Preferred Wksp / INC Assgn Wksp / GW: (

TP Particulars:

Veh No: SJQ 8981H

INC () / Non-INC ()

Owner / Driver: (

Tel: ()

Policy No: (

Period: (

Cover Type: (

Confirmed by: (

Date: (

Time: (

Insured/Driver Liability: (

% [Note-Est. Status (WO): N: 0-20%; P: 21-79%; P: 80-100%]

Year of Registration: (

Warranty: YES () / NO ()

Excess: (\$

Loading: \$1,000 () / \$2,000 ()

General Remarks: () Walk-In Customer: Customer's information strictly Confidential & Strictly NO refer of repairer.

() Total Loss Case : to e-mail Insurer URGENTLY.

Drive-In () / Towed-In () ; Invoice: YES () / NO () ; Towing Co: (

Remarks: (INC from 19/11/2003)

1) Apply for Transport Allowance () / Courtesy Car ()

2) QC Check / Post Repair Inspection ()

3) Upload Resurvey Photo [Repair Cost > \$3000] ()

Injury: ()

Date/Time

Action

Claimants Particulars:

Driver/Owner:

Contact No:

Damaged Portion:

QC Checked by (Engr-In-Charge):

Auditors Comments:

Ref. 1:

Ref. 2:

NA 1908678

Invoice Item	Amount (\$)	Ref. Amt (\$)
1) AR: Accident Reporting (\$30)		
2) DA: Damage Assessment (\$100)	INC (\$80)	
3) TP: Towing Fee	\$40/\$45	
4) PT: Follow-Through Survey	\$120	
5) PT: Follow-Through Survey (Resurvey)	\$30	
For claiming against INC Only (ver 10 Jan 2003)		
6) TR: Re-inspection	\$75	
7) NI: Idas DA + SMRT Survey	\$160	
8) NTUC Additional Services:-		
ON:		
*N5: Courtesy Car / Tpt Allowance	\$5	
*N6: Repair Co-ordination	\$10	
*N7: Post Repair Inspection	\$25	
*N8: DV / Collect Excess Coordination	\$5	
TP (N11): TP (Non INC) against INC	\$20	
9) N12: Idas Mobile	\$0	
Invoice dated	Fee Charged	
Invoice dated	Fee Charged	

SINGAPORE ACCIDENT STATEMENT

IMPORTANT NOTICE

1. Please report correctly the details of the accident to speed up the claims process.
2. This Form must be completed by the Policyholder and/or the Authorised Driver.
3. Information provided must be as truthful and accurate as possible. Any wilful misrepresentation or withholding of material facts may allow insurance companies to repudiate policy liability.
4. The issue and acceptance of this Form by insurance companies is not an admission of policy liability on the part of the insurance companies.
5. Any false reporting may be referred to the Police for investigation.
6. This report will be forwarded by the insurers of the GIA Records Management Centre established by the General Insurance Association of Singapore (GIA) for archiving and that copies of this report will, for a fee, be made available upon application by interested parties.
7. By the lodgement of this report to the insurers, you hereby consent to the archiving of this report at the centre and to copies of the report being made available aforesaid.

ACCIDENT STATEMENT

Date Of Report	20/11/2019 13:45
Date Of Accident	19/11/2019 13:45
Exact Location Of Accident	TOA PAYOH LOR 7 INFRONT TOA PAYOH POLYCLINIC
Country/State of Loss	SINGAPORE

DETAILS OF OWN VEHICLE

Vehicle Registration Number	GBC2715T
Insured/Policyholder	
Name Of Registered Owner	U-GRADE PAPER PRODUCTS PTE LTD
Co Reg No	199504803A
Email Address	NOEMAIL
Mobile Phone No	
Alternative Phone No	OFFICE-65600900

Vehicle Particulars

Manufacturer	TOYOTA
Model	HIACE
Exact Purpose for which vehicle was being used at time of accident	COMMERCIAL
Are you claiming under your own insurance policy for repair to your vehicle?	NO
If No, Please state action to be taken	THIRD PARTY
Vehicle Category	COMMERCIAL VEHICLE

Insurance Company

Name of Insurance Company	TOKIO MARINE INSURANCE SINGAPORE LTD
Type Of Coverage	COMPREHENSIVE
Fleet Policy	NO
Policy Number	19-MT000692-R01
Cover Note Number	

Driver

Name of Driver	CHEN GUODONG
NRIC No	G2745521U
Date Of Birth	06/03/1990
Occupation	OUTDOOR
Date Of Driving Pass	20/05/2016
Driving Experience	3 YEARS AND 5 MONTHS
Gender	MALE
Mobile Number	(LOCAL) +65-91175465
Fax Number	
Contact Number	
Email Address	NOEMAIL

Address	BLK 2020 BUKIT BATOK IND PARK A ST 23 #03-246
Postcode	659525
Was driver an employee of the Insured's Company	YES
If No, Relationship of the Driver with the Insured	
Vehicle Registration Number of Driver's Own Vehicle	-
	-
	-
Insurance Company of Driver's Own Vehicle	-
	-
	-

General Information of the Accident

Type Of Accident	COLLISION - MAJOR/MINOR RD
Weather Conditions	CLEAR
Road Surface	DRY

Other Information

Was any foreign vehicle involved in this accident?	NO
Number of vehicles (including own vehicle) involved in the accident	2
Was any body injured in the Accident?	NO
Was any injured conveyed to hospital by ambulance?	
Was any other material or property damaged?	YES
I have been approached by unknown person(s) soliciting/offering accident claims assistance.	NO
Number of Passengers (Including Driver)	1

Details of Police Action

Was the accident reported to the police?	NO
If Yes, Please state which Police Station	
Was notice of intended Prosecution given?	NO
If Yes, against whom?	

Circumstances of Accident

REFER TO STATEMENT.

Attachment(s)

Are accident photos available for attachment?	YES
Was there any video captured by Car Camera?	NO
Was there any audio recorded?	NO

DETAILS OF OTHER VEHICLE PROPERTY 1

Vehicle Registration Number	SJQ8981H
Vehicle Make/Model/Colour	
Details Of Properties	
Vehicle Category	PRIVATE CAR
Name of Driver	
NRIC/Passport Number	
Contact Number	
Address	
Postcode	
Insurance Company Name	
Nature Of Damage	
No. Of Passenger (Including Driver)	

SKETCH PLAN

IMPORTANT NOTICE

1. Please report correctly the details of the accident to speed up the claims process.
2. This Form must be completed by the Policyholder and/or the Authorised Driver.
3. Information provided must be as truthful and accurate as possible. Any wilful misrepresentation or withholding of material facts may allow insurance companies to repudiate policy liability.
4. The issue and acceptance of this Form by Insurance companies is not an admission of policy liability on the part of the Insurance companies.
5. Any false reporting may be referred to the Police for investigation.
6. The report will be forwarded by the insurers of the GIA Records Management Centre established by the General Insurance Association of Singapore (GIA) for archiving and that copies of this report will for a fee be made available upon application by Interested parties.
7. By the lodgment of this report to the insurers, you hereby consent to the archiving of this report at the centre and to copies of the report being made available aforesaid.
8. Consent under the Personal Data Protection Act (PDPA)

I understand, acknowledge, agree and consent that:

- (a) My insurer, my workshop and the General Insurance Association of Singapore ("GIA") may/are permitted to collect, use, disclose and/or process my personal data/personal information set out in this [form] and any other personal information provided by me or possessed by my insurer (collectively the "Personal Information") and disclose and transfer such Personal Information to all insurer(s) who have insured vehicle(s) involved in this accident (all insurer(s) who have insured vehicle(s) involved in this accident shall be collectively referred to as the "Insurers"), the Insurers' lawyers/law firms, the Monetary Authority of Singapore and any relevant government agency/authority (such as the police), for the purpose(s) of:
- (i) processing, handling and/or dealing with my claims including the settlement of the claims and any necessary investigations relating to the claims;
 - (ii) investigating the accident and/or my claims;
 - (iii) carrying out and/or dealing with my instructions or responding to any enquiries by me;
 - (iv) administering my claims (including the mailing of correspondence, statements, invoices, reports or notices to me, which could involve disclosure of certain personal data about me to bring about delivery of the same as well as on the external cover of envelopes/mail packages); and/or
 - (v) complying with applicable law in administering, processing, handling and/or dealing with my claims (collectively the "Purposes")
- (b) all insurer(s) who have insured vehicle(s) involved in this accident and the Insurers' lawyers/law firms, may/are permitted to collect, use, disclose and/or process my Personal Information for one or more of the above Purposes; and
- (c) my Personal Information may/can be disclosed by any of the Insurers and/or GIA to their third party service providers or agents (including their lawyers/law firms), which may be sited outside of Singapore, for one or more of the above Purposes.
- (d) my Personal Information will also be collected and used to compile claims history for the purpose of fraud detection, investigation and management in present and all future claims.
- (e) the information so collected under (d) above may be shared / disclosed:
- (i) to all insurers and/or any other third parties that assist in evaluating, investigating, controlling or managing fraud, regulators, law enforcement and government agencies as reasonably required for the purposes stated, or
 - (ii) for complying with requirements under any regulations, laws or court orders.

PAPER PRODUCTS PTE LTD

Policyholder's Signature
Date & Time:

Driver's Signature
(If driver is not the policyholder)
Date & Time:

Reporting Centre Personnel's Signature
Name:
NRIC/FIN No.:

SKETCH PLAN

A = GBC 2715 T

B = SJQ 8981 H

Tou Payon

Lot 7

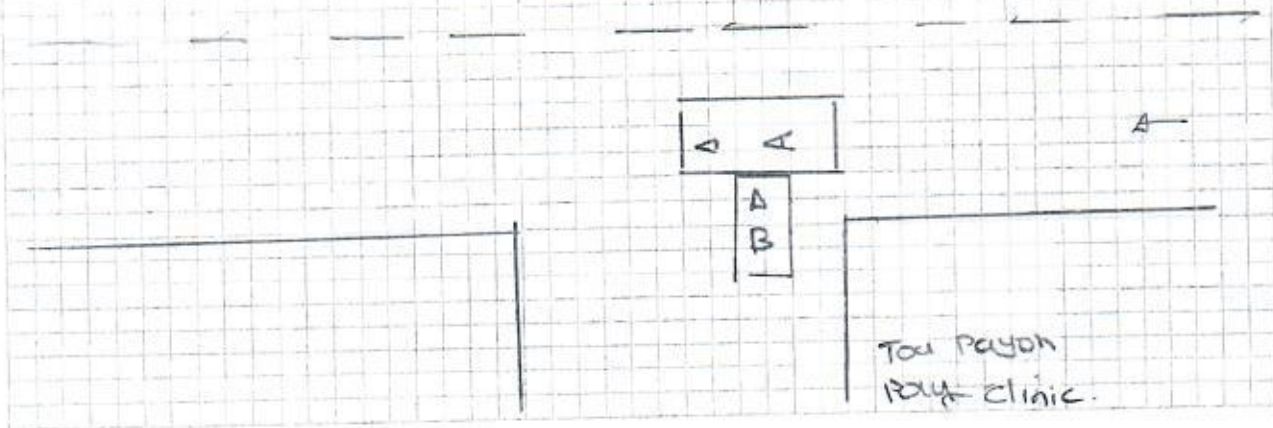

DESCRIBE CIRCUMSTANCES OF THE ACCIDENT

On 19/11/19 at about 1:45pm. I was ~~at~~ traveling along Tou Payon Lot 7 (major). Suddenly vehicle B was dashed out from minor road without check for traffic and hit my vehicle.

DECLARATION

I/We declare the foregoing particulars are true in every respect.

Policyholder's Signature

Date & Time:

Driver's Signature

(If driver is not the policyholder)

Date & Time:

Reporting Centre Personnel's Signature

Name:

NRIC/FIN No.:

10/11/19.
Date of Accident : 6T Accident Time: 1:45 PM (24-HR-Format)
Accident Place : Toa Payoh Lor 7 in front of Toa Payoh Poly Clinics
Vehicle No. (Car Plate No.) : GBC 2715 T Make/Model: Toyota Hiace.
Insurance Company : TM Policy No: 19-MT000692-R01
Owner or Company Name / IC No. : 199504803A U-Grade Paper Products Pte Ltd
Owner or Company Contact No. : 65600900 Owner's Hp Company Tel
DRIVER'S Name / IC No. : G27455210 Chen GuoDong
DRIVER'S Date Of Birth : 06/03/1940 DRIVER'S License Pass Date 20/05/2016
Relationship of Owner & Driver : Spouse | Parents | Children | Sibling | Employee | Others:
DRIVER'S Address : Blk 2020 H03-246 Bukit Merah Ind Park A A 51 23
5654525
DRIVER'S Contact No./ Alt No. : 1) 91175465 2)
DRIVER'S Occupation : INDOOR | OUTDOOR (e.g. working inside or outside office)
Email Address :
Weather & Road Surface : CLEAR & DRY | RAINING & WET | AFTER RAIN & WET
Reporting Type : Reporting Only | Claim Other Party | Claim Own Insurance
Number of Passengers (Including Driver): Driver only
Was there any video Captured by car camera: YES \ NO
Exact purpose for which vehicle was being used at the time of accident: Private use \ Work purpose
Any Injury (If YES, Pls state): NO

Other Party Driver's Particular (if any)

Vehicle No: <u>SJA 8481 H</u>	Vehicle No: _____
Vehicle Make/Model: _____	Vehicle Make/Model: _____
Name Driver: _____	Name Driver: _____
IC No. Driver/Contact: _____	IC No. Driver/Contact: _____

* NEW - Passenger's name & gender:

 PAPER PRODUCTS PTE LTD
13



TOKIOMARINE
INSURANCE GROUP
FORM MZ300

Certificate of Insurance

MOTOR VEHICLES (THIRD-PARTY RISKS AND COMPENSATION) ACT (CHAPTER 189)
MOTOR VEHICLES (THIRD-PARTY RISKS AND COMPENSATION) RULES, 1960
ROAD TRANSPORT ACT, 1987 (MALAYSIA)
MOTOR VEHICLES (THIRD-PARTY RISKS) RULES, 1959 (MALAYSIA)

Policy No.: 19-MT000692-R01 (Comm Vehicle Carry Own Goods)

1. **Index Mark and Registration Number of Vehicle** GBC2715T **Chassis No.:** JTFHT02P300082690
2. **Name of Policyholder** U-GRADE PAPER PRODUCTS PTE LTD
3. **Effective date of the Commencement of Insurance for the purposes of the Act** 20/02/2019
4. **Date of Expiry of Insurance** 19/02/2020

5. **Persons or Class of Persons entitled to drive***

Any person who is driving on the policyholder's order or with their permission.

* Provided that the Person driving is permitted in accordance with the licensing or other laws or regulations to drive the Motor Vehicle or has been so permitted and is not disqualified by order of a Court of Law or by reason of any enactment or regulation in that behalf from driving the Motor Vehicle. And provided further that the Motor Vehicle is registered under the Road Traffic Act and its registration under the Road Traffic Act has not been cancelled at the time of the accident loss or damage.

6. **Limitations as to use***

- 1) Use in connection with the policyholder's business.
 - 2) Use for the carriage of passengers (other than for hire or reward) in connection with the Policyholders' business.
 - 3) Use for social domestic and pleasure purposes.
- The policy does not cover:-
- 1) Use for hire or reward or for racing, pace-making, reliability trial or speed-testing.
 - 2) Use whilst drawing a trailer except the towing of any one disabled mechanically propelled vehicle.

* Limitations rendered inoperative by Section 8 of the Motor Vehicles (Third-Party Risks and Compensation) Act (Chapter 189) and Section 95 of the Road Transport Act, 1987 (Malaysia), are not to be included under these headings.

We hereby certify that the Policy to which this Certificate relates is issued in accordance with the provision of the Motor Vehicles (Third-Party Risks and Compensation) Act (Chapter 189) and Part IV of the Road Transport Act, 1987 (Malaysia).

Please refer to the Policy Schedule for full details, terms and conditions of the insurance.

IMPORTANT NOTICE

This Certificate is not transferable. During its currency, if the insurance is cancelled for whatsoever reason, you must return the Certificate to Tokio Marine Insurance Singapore Ltd. within 7 days thereof or, if the Certificate has been lost destroyed, you must make a statutory declaration to that effect. Failure to comply with this duty is an offence under Motor Vehicle (Third-Party Risks and Compensation) Act (Chapter 189).

ADDITIONAL INFORMATION

Account: 1000DDA

Insurance Plan:	Comprehensive Approved Workshop Plan
Limit for total loss or theft:	Prevailing Market Value
Policy Excess:	Excess - All Claims SGD 1,500
	Windscreen Excess SGD 100

Tokio Marine Insurance Singapore Ltd.

Authorised Signature