

# NATIONAL Assessment Centre Services.

[Ref: J2400]

MNA49139070

Date In: 21/10/19 1153

Ref No: NBA/LPC19018504F

Veh No: 5808733X

DOA 18/10/19 14:00

OD TP Reporting Only

TP Insurer:

Job description

Date & Time Completed

Done by

SAS e-Milling

E-mail (3 days, AIC 2 hrs)

I-Motor Claim Form

I-Motor W/O (Within OD 2 hrs, TP 4 hrs)

I-Photo Uploaded

Assessment/Survey Report

Ass't Report by Fax / Hand to Owner/Wksp

Preferred Wksp / INC Assign Wksp / QW: (

Tel:

Fax:

TP Particulars:

Veh No:

YP 8633R

INC ( ) / Non-INC ( )

Owner / Driver: (

Tel:

Policy No: (

Period: (

Cover Type: (

Confirmed by: (

Date:

Time:

Insured/Driver Liability: (

%) [Note-Est Status (WO): N: 0-20%; P: 21-79%. P: 80-100%]

Year of Registration: (

Warranty: YES ( ) / NO ( )

Excess: (\$

Loading: \$1,000 ( ) / \$2,000 ( )

General Remarks:

( ) Walk-In Customer: Customer's Information strictly Confidential & Strictly NO refer of repair.

( ) Total Loss Case: to e-mail Insurer URGENTLY.

Drive-In ( ) / Towed-In ( ) ; Invoice: YES ( ) / NO ( ) ; Towing Co: ( )

1) Apply for Transport Allowance ( ) / Courtesy Car ( )

2) QC Check / Post Repair Inspection ( )

3) Upload Resurvey Photo [Repair Cost > \$3000] ( )

Injury:

NA 1907856

Driver/Owner:

Contact No:

Damaged Portion:

QC Checked by (Engr-In-Charge):

Anchor's Comments:

Ref: 1:

1) AR: Accident Reporting (\$30)

2) DA: Damage Assessment (\$100) INC (\$10)

3) TP: Towing Fee \$40/\$45

4) PT: Follow-Through Survey \$120

5) PT: Follow-Through Survey (Resurvey) \$30

For claim against INC Only (over 10 Jan 2003)

6) TR: Re-inspection \$75

7) NI: Idao DA + SMRT Survey \$160

8) NTUC Additional Services:

OR:

\*N5: Courtesy Car / Tpl Allowance \$5

\*N6: Repair Coordination \$10

\*N7: Post Repair Inspection \$25

\*N8: DV / Collect Excess Coordination \$5

\*N9: TP (NI) : TP (N+INC) against DRG \$20

\*N12: Idao Mobile \$0

Invoice dated

Fee Charged

Invoice dated

Fee Charged

Stamp

## SINGAPORE ACCIDENT STATEMENT

### IMPORTANT NOTICE

1. Please report correctly the details of the accident to speed up the claims process.
2. This Form must be completed by the Policyholder and/or the Authorised Driver.
3. Information provided must be as truthful and accurate as possible. Any wilful misrepresentation or withholding of material facts may allow insurance companies to repudiate policy liability.
4. The issue and acceptance of this Form by insurance companies is not an admission of policy liability on the part of the insurance companies.
5. **Any false reporting may be referred to the Police for investigation.**
6. This report will be forwarded by the insurers of the GIA Records Management Centre established by the General Insurance Association of Singapore (GIA) for archiving and that copies of this report will, for a fee, be made available upon application by interested parties.
7. By the lodgement of this report to the insurers, you hereby consent to the archiving of this report at the centre and to copies of the report being made available aforesaid.

### ACCIDENT STATEMENT

Date Of Report	21/10/2019 11:53
Date Of Accident	18/10/2019 14:00
Exact Location Of Accident	REDHILL IND EST BLK 1002 CARPARK LOT 108
Country/State of Loss	SINGAPORE

### DETAILS OF OWN VEHICLE

Vehicle Registration Number	GBD8733X
<b>Insured/Policyholder</b>	
Name Of Registered Owner	DIAMOND SKY OIL PTE. LTD
Co Reg No	201523840N
Email Address	NOEMAIL
Mobile Phone No	
Alternative Phone No	OFFICE-94896576

### Vehicle Particulars

Manufacturer	PEUGEOT
Model	PARNTER 1.6
Exact Purpose for which vehicle was being used at time of accident	COMMERCIAL USE
Are you claiming under your own insurance policy for repair to your vehicle?	NO
If No, Please state action to be taken	THIRD PARTY
Vehicle Category	COMMERCIAL VEHICLE

### Insurance Company

Name of Insurance Company	LONPAC INSURANCE BHD
Type Of Coverage	THIRD PARTY
Fleet Policy	NO
Policy Number	Z19VC05002795
Cover Note Number	

### Driver

Name of Driver	TAN TAU JIN
NRIC No	S7101852J
Date Of Birth	10/01/1971
Occupation	OUTDOOR
Date Of Driving Pass	18/03/1994
Driving Experience	25 YEARS AND 7 MONTHS
Gender	MALE
Mobile Number	(LOCAL) +65-94896576
Fax Number	
Contact Number	
Email Address	NOEMAIL

Address	BLK 55 HAVELOCK ROAD #15-136 SINGAPORE
Postcode	161055
Was driver an employee of the Insured's Company	YES
If No, Relationship of the Driver with the Insured	
Vehicle Registration Number of Driver's Own Vehicle	-
	-
Insurance Company of Driver's Own Vehicle	-
	-
	-

#### General Information of the Accident

Type Of Accident	COLLISION - OPENING DOOR OF VEHICLE
Weather Conditions	CLEAR
Road Surface	DRY

#### Other Information

Was any foreign vehicle involved in this accident?	NO
Number of vehicles (including own vehicle) involved in the accident	2
Was any body injured in the Accident?	NO
Was any injured conveyed to hospital by ambulance?	NO
Was any other material or property damaged?	YES
I have been approached by unknown person(s) soliciting/offering accident claims assistance.	NO
Number of Passengers (Including Driver)	0

#### Details of Police Action

Was the accident reported to the police?	NO
If Yes, Please state which Police Station	
Was notice of intended Prosecution given?	NO
If Yes, against whom?	

#### Circumstances of Accident

REFER TO SKETCH PLAN

#### Attachment(s)

Are accident photos available for attachment?	YES
Was there any video captured by Car Camera?	NO
Was there any audio recorded?	NO

#### DETAILS OF OTHER VEHICLE PROPERTY 1

Vehicle Registration Number	YP8633R
Vehicle Make/Model/Colour	
Details Of Properties	
Vehicle Category	COMMERCIAL VEHICLE
Name of Driver	
NRIC/Passport Number	
Contact Number	
Address	
Postcode	
Insurance Company Name	
Nature Of Damage	
No. Of Passenger (Including Driver)	



**LONPAC INSURANCE BHD** (S98FC5635C)

(Incorporated in Malaysia)

Singapore Office: 300, Beach Road #17-04/07, The Concourse, Singapore 199555.

Tel: (65) 6250 7388 Fax: (65) 6296 3767 Website: www.lonpac.com.sg

GST Reg No.: F0-0005635-C

MZ300

**CERTIFICATE OF INSURANCE**

MOTOR VEHICLES (THIRD PARTY RISKS AND COMPENSATION) ACT (CAP 189) REPUBLIC OF SINGAPORE.  
MOTOR VEHICLES (THIRD PARTY RISKS AND COMPENSATION) RULES 1960 (REPUBLIC OF SINGAPORE).  
ROAD TRANSPORT ACT 1987 (MALAYSIA).  
ROAD TRANSPORT (AMENDMENT) ACT 2019 (MALAYSIA).  
THE MOTOR VEHICLES (THIRD PARTY RISKS) RULES, 1959 (MALAYSIA).

Certificate No. : Z19VC05002795

Type of Cover : THIRD PARTY

1. Index Mark and Vehicle Registration Number

PEUGEOT PARTNER 1.6 HDI ETG LWB  
- GBD8733X

2. Name of Policy Holder

DIAMOND SKY OIL PTE. LTD

3. Effective Date of the Commencement of Insurance  
for the purpose of the Act

07/07/2019

4. Date of Expiry of the Insurance

06/07/2020

5. Person To Drive

(A) THE POLICYHOLDER.

(B) ANY OTHER PERSON WHO IS DRIVING ON THE POLICYHOLDER'S ORDER OR WITH HIS/THEIR PERMISSION.

Provided that the person driving is permitted in accordance with the licensing or other laws or regulations to drive the Motor Vehicle or has been so permitted and is not disqualified by order of a Court of Law or by reason of any enactment or regulation in that behalf from driving the Motor Vehicle.

6. Limitations as to use

USE IN CONNECTION WITH THE POLICYHOLDER'S BUSINESS.

USE FOR THE CARRIAGE OF PASSENGERS (OTHER THAN FOR HIRE OR REWARD) IN CONNECTION WITH THE POLICYHOLDER'S BUSINESS.

USE FOR SOCIAL, DOMESTIC AND PLEASURE PURPOSES.

THE POLICY DOES NOT COVER:-

USE FOR HIRE OR REWARD OR FOR RACING, PACEMAKING, RELIABILITY TRIAL OR SPEED TESTING.

USE WHILE DRAWING A TRAILER EXCEPT THE TOWING OF ANY ONE DISABLED MECHANICALLY PROPELLED VEHICLE.

\* Limitations rendered inoperative by Section 95 of the Road Transport Act 1987 (Malaysia) or Section 8 of the Motor Vehicles (Third Party Risks and Compensation) Act (Cap 189) Republic of Singapore are not included under heading.

I/WE hereby certify that this covering Note is issued in accordance with the provisions of Part IV of the Road Transport Act 1987 (Malaysia) and Motor Vehicles (Third-Party Risks and Compensation) Act (Cap 189) Republic of Singapore.

CHIEF EXECUTIVE  
(Singapore Branch)

User ID: ELAINELEE

Date Issued: 27/06/2019

## SKETCH PLAN

### IMPORTANT NOTICE

1. Please report **correctly** the details of the accident to speed up the claims process.
2. This Form must be **completed by the Policyholder and/or the Authorised Driver**.
3. Information provided must be as **truthful and accurate as possible**. Any wilful misrepresentation or withholding of material facts may allow insurance companies to **repudiate policy liability**.
4. The issue and acceptance of this Form by insurance companies is not an admission of policy liability on the part of the insurance companies.
5. **Any false reporting may be referred to the Police for investigation.**
6. The report will be forwarded by the insurers of the GIA Records Management Centre established by the General Insurance Association of Singapore (GIA) for archiving and that copies of this report will for a fee be made available upon application by interested parties.
7. By the lodgment of this report to the insurers, you hereby consent to the archiving of this report at the centre and to copies of the report being made available aforesaid.
8. **Consent under the Personal Data Protection Act (PDPA)**

I understand, acknowledge, agree and consent that:

- (a) My insurer, my workshop and the General Insurance Association of Singapore ("GIA") may/are permitted to collect, use, disclose and/or process my personal data/personal information set out in this [form] and any other personal information provided by me or possessed by my insurer (collectively the "Personal Information") and disclose and transfer such Personal Information to all insurer(s) who have insured vehicle(s) involved in this accident (all insurer(s) who have insured vehicle(s) involved in this accident shall be collectively referred to as the "Insurers"), the Insurers' lawyers/law firms, the Monetary Authority of Singapore and any relevant government agency/authority (such as the police), for the purpose(s) of:
  - (i) processing, handling and/or dealing with my claims including the settlement of the claims and any necessary investigations relating to the claims;
  - (ii) investigating the accident and/or my claims;
  - (iii) carrying out and/or dealing with my instructions or responding to any enquiries by me;
  - (iv) administering my claims (including the mailing of correspondence, statements, invoices, reports or notices to me, which could involve disclosure of certain personal data about me to bring about delivery of the same as well as on the external cover of envelopes/mail packages); and/or
  - (v) complying with applicable law in administering, processing, handling and/or dealing with my claims.(collectively the "Purposes")
- (b) all insurer(s) who have insured vehicle(s) involved in this accident and the Insurers' lawyers/law firms, may/are permitted to collect, use, disclose and/or process my Personal Information for one or more of the above Purposes; and
- (c) my Personal Information may/can be disclosed by any of the Insurers and/or GIA to their third party service providers or agents(including their lawyers/law firms), which may be sited outside of Singapore, for one or more of the above Purposes.
- (d) my Personal Information will also be collected and used to compile claims history for the purpose of fraud detection, investigation and management in present and all future claims.
- (e) the information so collected under (d) above may be shared / disclosed:
  - (i) to all insurers and/or any other third parties that assist in evaluating, investigating, controlling or managing fraud, regulators, law enforcement and government agencies as reasonably required for the purposes stated, or
  - (ii) for complying with requirements under any regulations, laws or court orders.



Policyholder's Signature  
Date & Time:

Driver's Signature  
(If driver is not the policyholder)  
Date & Time:

Reporting Centre Personnel's Signature  
Name:  
NRIC/FIN No.:

# SKETCH PLAN

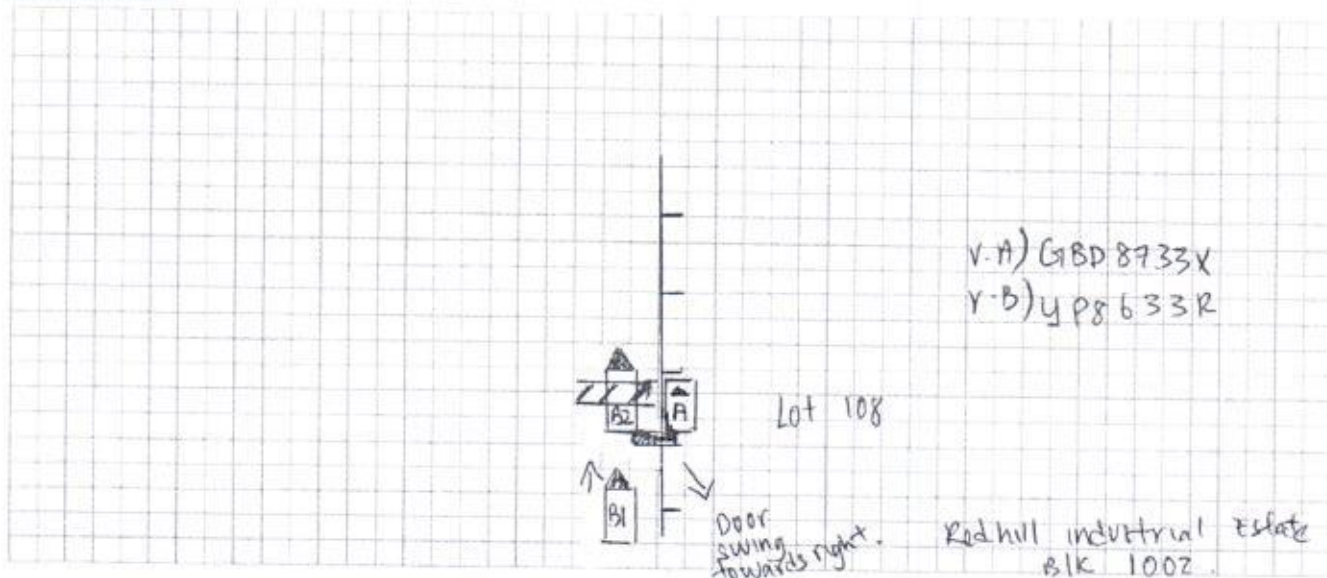

## DESCRIBE CIRCUMSTANCES OF THE ACCIDENT

On the stated date and time, I vehicle 'A' was parked stationary on lot 108. I left my vehicle and everything was intact, no damages found. Just when I cross the road I heard a bang, I turned and noticed vehicle 'B' YP8633R rear door swing open and collided against my vehicle rear right door. I went over to my vehicle and I also noticed my tail lamp was damaged too. vehicle 'B' driver mentioned that his rear door lock was faulty and apologised to me about this incident.

## DECLARATION

I/We declare the foregoing particulars are true in every respect.



Policyholder's Signature  
Date & Time:

Driver's Signature  
(If driver is not the policyholder)  
Date & Time:

Reporting Centre Personnel's Signature  
Name:  
NRIC/FIN No.:

Email: [sm@idac.com.sg](mailto:sm@idac.com.sg)

Tel no: 6555 6888 Fax no: 6454 3279

### **Personal Particulars of Owner & Driver (Vehicle A)**

Date of Accident: 18/10/2019 (dd/mm/yy) Time of Accident: 14:00 (24-HR-FORMAT)  
Vehicle No.: GBD 8733 X Vehicle Make & Model: PEUGEOT PARTNER 1.6 HDI ETG LWB  
Exact location of Accident: REDHILL INDUSTRIAL ESTATE BLK 1002 CAR PARK LOT 108  
Policyholder's Name / IC No.: DIAMOND SKY OIL PTE. LTD 201523840N  
Driver's Name / IC No.: TAN TAU JIN S7101852J (As Above) ☐  
Driver's Contact No.: 9489 6576 Company Contact No.: \_\_\_\_\_  
Driver's Address: 160 ROBINSON ROAD #23-10 SINGAPORE (068914)  
Insurance Company: LONPAC Email address (if any): \_\_\_\_\_

**Relationship between Owner & Driver:** EMPLOYEE

or Others specify: \_\_\_\_\_

**What do you wish to claim? (Please TICK one only)**

☐ Own Insurance / ☒ Other Vehicle (The one you want to claim against) / ☐ Reporting (For Record Purpose)

**Exact purpose for which the vehicle  
Was being used at time of accident?**

**Occupation (nature of job)** ☐ Indoor/ ☒ Outdoor

☐ Private use / ☒ Work purpose

**No. of Passengers (Including Driver):** 00

**Passenger Name :** \_\_\_\_\_

**Gender :** \_\_\_\_\_

**Passenger Name :** \_\_\_\_\_

**Gender :** \_\_\_\_\_

**Weather condition & Road conditions? (On the day of accident)**

☒ Clear & Dry / ☐ Raining & Wet / ☐ After-Rain & Wet / ☐ Drizzling & Wet / Others: \_\_\_\_\_

**Was there any video captured by your Car Camera?** ☐ Yes / ☒ No

**Any Injuries:** ☐ Yes / ☒ No (If YES) Injured Person's Name: \_\_\_\_\_

Injuries Sustain: \_\_\_\_\_ Injured Person in Which Vehicle: \_\_\_\_\_

**Police Report filed:** ☐ Yes / ☒ No (If YES) Which Police Station: \_\_\_\_\_

### **The Other Party(s) Details:**

1. Driver's Name / IC No: \_\_\_\_\_ Vehicle No: YP 8633 R

Driver's Contact No: \_\_\_\_\_ Insurance Company (If any): \_\_\_\_\_

2. Driver's Name / IC No: \_\_\_\_\_ Vehicle No: \_\_\_\_\_

Driver's Contact No: \_\_\_\_\_ Insurance Company (If any): \_\_\_\_\_

\*Independent Witness (If Any): \_\_\_\_\_ Contact No: \_\_\_\_\_

Preferred Workshop Name: \_\_\_\_\_ Contact No: \_\_\_\_\_

\*If no proper documents are produced, IDAC should not file the report. Information will be discarded after one week.