

SINGAPORE ACCIDENT STATEMENT

IMPORTANT NOTICE

1. Please report correctly the details of the accident to speed up the claims process.
2. This Form must be completed by the Policyholder and/or the Authorised Driver.
3. Information provided must be as truthful and accurate as possible. Any wilful misrepresentation or withholding of material facts may allow insurance companies to repudiate policy liability.
4. The issue and acceptance of this Form by insurance companies is not an admission of policy liability on the part of the insurance companies.
5. **Any false reporting may be referred to the Police for investigation.**
6. This report will be forwarded by the insurers of the GIA Records Management Centre established by the General Insurance Association of Singapore (GIA) for archiving and that copies of this report will, for a fee, be made available upon application by interested parties.
7. By the lodgement of this report to the insurers, you hereby consent to the archiving of this report at the centre and to copies of the report being made available aforesaid.

ACCIDENT STATEMENT

Date Of Report	21/10/2019 09:19
Date Of Accident	19/10/2019 13:50
Exact Location Of Accident	BLK 22 JLN MEMBINA (DRIVEWAY)
Country/State of Loss	SINGAPORE

DETAILS OF OWN VEHICLE

Vehicle Registration Number	GBJ5865L
Insured/Policyholder	
Name Of Registered Owner	NOBLE ADVANCE PTE LTD
Co Reg No	200304578B
Email Address	NOEMAIL
Mobile Phone No	
Alternative Phone No	OFFICE-96827185

Vehicle Particulars

Manufacturer	TOYOTA
Model	HIACE
Exact Purpose for which vehicle was being used at time of accident	COMMERCIAL
Are you claiming under your own insurance policy for repair to your vehicle?	NO
If No, Please state action to be taken	THIRD PARTY
Vehicle Category	COMMERCIAL VEHICLE

Insurance Company

Name of Insurance Company	NTUC INCOME INSURANCE CO-OPERATIVE LTD
Type Of Coverage	COMPREHENSIVE
Fleet Policy	NO
Policy Number	5110109580
Cover Note Number	

Driver

Name of Driver	PHEH BOON SENG
NRIC No	S7216413Z
Date Of Birth	16/05/1972
Occupation	OUTDOOR
Date Of Driving Pass	24/10/1998
Driving Experience	20 YEARS AND 11 MONTHS
Gender	MALE
Mobile Number	(LOCAL) +65-82999910
Fax Number	
Contact Number	
Email Address	NOEMAIL

Address	BLK 297 PUNGGOL CENTRAL #09-489
Postcode	820297
Was driver an employee of the Insured's Company	YES
If No, Relationship of the Driver with the Insured	
Vehicle Registration Number of Driver's Own Vehicle	-
	-
	-
Insurance Company of Driver's Own Vehicle	-
	-
	-

General Information of the Accident

Type Of Accident	COLLISION - MAJOR/MINOR RD
Weather Conditions	CLEAR
Road Surface	DRY

Other Information

Was any foreign vehicle involved in this accident?	NO
Number of vehicles (including own vehicle) involved in the accident	2
Was any body injured in the Accident?	YES
Was any injured conveyed to hospital by ambulance?	NO
Was any other material or property damaged?	YES
I have been approached by unknown person(s) soliciting/offering accident claims assistance.	NO
Number of Passengers (Including Driver)	1

Details of Police Action

Was the accident reported to the police?	NO
If Yes, Please state which Police Station	
Was notice of intended Prosecution given?	NO
If Yes, against whom?	

Circumstances of Accident

REFER TO STATEMENT.

Attachment(s)

Are accident photos available for attachment?	YES
Was there any video captured by Car Camera?	YES
Remarks/ Reasons:	WITH DRIVER
Was there any audio recorded?	NO

DETAILS OF OTHER VEHICLE PROPERTY 1

Vehicle Registration Number	GBC7007X
Vehicle Make/Model/Colour	
Details Of Properties	
Vehicle Category	COMMERCIAL VEHICLE
Name of Driver	
NRIC/Passport Number	
Contact Number	82651600
Address	
Postcode	
Insurance Company Name	
Nature Of Damage	
No. Of Passenger (Including Driver)	

DETAILS OF INJURED PERSON 1

Name	PHEH BOON SENG
Approximate Age	
Injuries Sustain	BODY
Injured person in which vehicle?	GBJ5865L
Were seat belts worn?	YES
Was this injured conveyed to hospital by ambulance?	NO
Address	
Postcode	

Accident Sketch Plan

SKETCH PLAN

IMPORTANT NOTICE

1. Please report correctly the details of the accident to speed up the claims process.
2. This Form must be completed by the Policyholder and/or the Authorised Driver.
3. Information provided must be as truthful and accurate as possible. Any wilful misrepresentation or withholding of material facts may allow insurance companies to repudiate policy liability.
4. The issue and acceptance of this Form by insurance companies is not an admission of policy liability on the part of the insurance companies.
5. Any false reporting may be referred to the Police for investigation.
6. The report will be forwarded by the insurers of the GIA Records Management Centre established by the General Insurance Association of Singapore (GIA) for archiving and that copies of this report will for a fee be made available upon application by interested parties.
7. By the lodgment of this report to the insurers, you hereby consent to the archiving of this report at the centre and to copies of the report being made available aforesaid.
8. **Consent under the Personal Data Protection Act (PDPA)**

I understand, acknowledge, agree and consent that:

- (a) My insurer, my workshop and the General Insurance Association of Singapore ("GIA") may/are permitted to collect, use, disclose and/or process my personal data/personal information set out in this [form] and any other personal information provided by me or possessed by my insurer (collectively the "Personal Information") and disclose and transfer such Personal Information to all insurer(s) who have insured vehicle(s) involved in this accident (all insurer(s) who have insured vehicle(s) involved in this accident shall be collectively referred to as the "Insurers"), the Insurers' lawyers/law firms, the Monetary Authority of Singapore and any relevant government agency/authority (such as the police), for the purpose(s) of:
 - (i) processing, handling and/or dealing with my claims including the settlement of the claims and any necessary investigations relating to the claims;
 - (ii) investigating the accident and/or my claims;
 - (iii) carrying out and/or dealing with my instructions or responding to any enquiries by me;
 - (iv) administering my claims (including the mailing of correspondence, statements, invoices, reports or notices to me, which could involve disclosure of certain personal data about me to bring about delivery of the same as well as on the external cover of envelopes/mail packages); and/or
 - (v) complying with applicable law in administering, processing, handling and/or dealing with my claims (collectively the "Purposes")
- (b) all insurer(s) who have insured vehicle(s) involved in this accident and the Insurers' lawyers/law firms, may/are permitted to collect, use, disclose and/or process my Personal Information for one or more of the above Purposes; and
- (c) my Personal Information may/can be disclosed by any of the Insurers and/or GIA to their third party service providers or agents (including their lawyers/law firms), which may be sited outside of Singapore, for one or more of the above Purposes.
- (d) my Personal Information will also be collected and used to compile claims history for the purpose of fraud detection, investigation and management in present and all future claims.
- (e) the information so collected under (d) above may be shared / disclosed:
 - (i) to all insurers and/or any other third parties that assist in evaluating, investigating, controlling or managing fraud, regulators, law enforcement and government agencies as reasonably required for the purposes stated, or
 - (ii) for complying with requirements under any regulations, laws or court orders.

NOBLE ADVANCE PTE LTD

No. 5, Molling Lane Block C #03-00
Singapore 739145

Tel: 65-6367 7666 Fax: 65-6366 2679

Email: sales@noble-advance.com

Policyholder's Signature

Date & Time:

Driver's Signature
(if driver is not the policyholder)
Date & Time:

Reporting Centre Personnel's Signature
Name:
NRIC/FIN No.:

Accident Sketch Plan

SKETCH PLAN

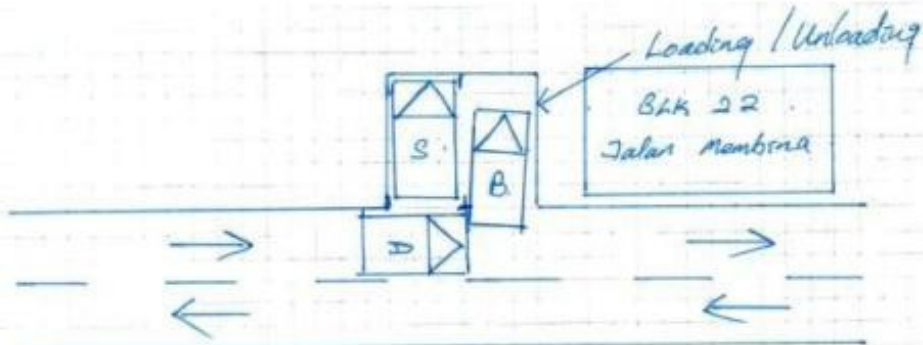

(A) GBJ 5865L

(B) GBC 7007X

DESCRIBE CIRCUMSTANCES OF THE ACCIDENT

On 19/10/19 at @ 1350 hrs, I was travelling in my vehicle along the driveway of BLK 22, Jalan Membina travelling straight. Suddenly, a lorry (GBC 7007X) on my left, reversed out from the loading/unloading lot and collided with my vehicle front left portion.

DECLARATION

I/We declare the foregoing particulars are true in every respect.

NOBLE ADVANCE PTE LTD
No. 5, The Siling Lane Block C #03-00
Singapore 739145
Tel: 65-6367 7668 Fax: 65-6366 2679
Email: info@noble-advance.com

Date & Time:

Driver's Signature
(if driver is not the policyholder)
Date & Time:

Reporting Centre Personnel's Signature
Name:
NRIC/FIN No.:

Accident Photo



Accident Photo



Accident Photo



Accident Photo



Accident Photo



Accident Photo



Accident Photo



Accident Photo

