

12345678

ASS. REC. BY:

REF: CSMC419018302/Red3m2

Special Instructions:

Surveyor: GA

ASSIGNMENT (Office)

From (Person): Crystal Lee

of M81G

Date/Time: 16/10/2019 @ 4:36pm

Estimated Cost:

Bill to:

OD ^① TP WS / TP RES / OD RES / EVA / INV / MV / CS

To Inspect Vehicle No:

FS 6611M

Insured:

SLG 30J

at Workshop m/s

Cycle & Carriage Fulco

Tel:

9179 2566

of

330 Ubi Road 3

Policy No:

Claim No:

Sum Insured:

Excess:

Make of Veh:

(Client's Record)

D.O.A. 14/10/2019

CA / REV / REP. / REV 24 HRS

H.O.D. Endorsement:

Date/Time: 4:54pm @ 16/10/19

Person Contacted:

Mars

Vehicle IN ^① OUT

Date/Time	Action/Instruction
	1 should ✓
	FS 6611M-X
	SLG 30J - CSMC419018302 / R/H/da
21/10	Revised via menimen preli advise
	Part by Part \$7969/- (Red: 6523; 45%)

19/11/2019

ASS. REC. BY:

Grl.

REF: MSIG

ASSIGNMENT

ES 6611M

Yr Regn: 18 Apr 2018

From:

Date:

18/10/2019

Estimated Cost:

OD / TP / WS / TP RES / OD RES / EVA / INV / MV

To inspect Vehicle No:

ES 6611M

at Workshop m/s

cycle & carriage Fulco

of

330 ubi Road 3

Insured:

Policy No.

Claims No.

Sum Insured:

Excess:

(Client's Record)

Make of Veh:

10-30um (writing)

pic: MARS

(Policy Condition)

Remark: The veh had commenced its
repair at the time of inspection.

Bal. or Market Value:

IDAC Accident Rpt:

Consistent? : Yes or No

GIA / PR Seen:

Consistent? : Yes or No

Est. Repairs:

7A

days

Res.: Yes or No

Lum Sum:

%

3 Val: Yes or No

CA / REV / REP. / 24 HRS ^{1up}

Vehicle: IN / OUT

Date:

Person Contacted:

Veh No:

Type: M.Car / M.Cycle / Bus / Van / Lorry / Taxi / Prime Mover /

Truck / Trailer or

Make:

KIA carens 1.7 c.c 1685

Colour:

Brown

A/C:

Insured / Std / NI / NA

Sp Reading

3045

T/Radio:

Insured / Std / NI / NA

Eng/No:

C/No:

KNAHU 815 VJ7193577

Gen. Cond: Good / Fair / Poor / Burnt

Steering: In order / Jammed / Leaked / Burnt or

Brake: In order / Jammed / Leaked / Burnt or

Mod: Nil / S/Rim / STD A/Rim or

Tyre Size:

F:

225/45 R17

R:

11

BS / DUN / EXNOVA / GY / FS / LIZA / MIC / OHTSU / PIR / SUMI /

TOYO / YOKO or

Front

Rear

R/Bal.

6

mm

R/Bal.

6

mm

L/Bal.

6

mm

L/Bal.

6

mm

D.O.A.

D.O.I.

18-10-19

Survey held at

w/s

10:30

Des. of Damages: Frt / Rear / O/S / N/S / UIC / Rooftop or

The UIC / Chassis frame / Body Structure affected due to collision.

Date / Time

Action / Instruction

RECEIVED 20 NOV 2019

Date/Time, File Pass to?



Preli. Report

1/20/11 Typist



Final Report

Date/Time, File Return to?

3)

Days Of Repair: 7

Resurvey No. of Trip: 1

Add Fee:



Site Insp (\$



Interview (\$



Tech. Invs (\$



Wheel end (\$

Survey Fee:

Transportation:

B + PS: \$

Phone

Others

TOTAL

Report Format:

TP

Lump Sum / Hk: (\$

7969

200

11

211

Note: This document has not been finalised.
LKK Auto Consultants Pte Ltd (Co.Reg.No:199607198R)

51 Ubi Ave 1 #01-25, Paya Ubi Industrial Park
Singapore 408933
Tel: 6256-3561 Fax: 6844-8805 Email: sur@lkkauto.com; assignments@lkkauto.com

To: MSIG Insurance (Singapore) Pte. Ltd.
4 Shenton Way
#21-01 SGX Centre 2
Singapore 068807

From: LKK Auto Consultants Pte Ltd
51 Ubi Ave 1 #01-25
Paya Ubi Industrial Park
Singapore 408933

Attn: Katherine Wong

Date: 21 Oct 2019

Preliminary Advice

Insured Vehicle No	: SLG30J	Accident Date	: 14/10/2019
TP Vehicle No	: ES6611M	Assignment Date	: 18/10/2019
Make	: KIA CARENS	Est. Duration of Repair	: 6.00
Date of Inspection	: 18/10/2019		
Inspection At	: CYCLE & CARRIAGE FULCO MOTOR DEALER PTE LTD (HQ) 330 UBI ROAD 3 SINGAPORE 408650		

Point of Impact / General Description of Damages

The vehicle sustained impact / damages rear portion and parts claimed are consistent to the accident.

Repairer's Estimate (Gross)	:S\$	14,492.00
Revised Amount	:S\$	7,733.00
Check Items (Estimated)	:S\$	1,428.00
Total	:S\$	9,161.00
Lump Sum Repair	:S\$	

Total Loss Consideration

New for Old Value	:S\$
Pre-Accident Value	:S\$
COE / PARF Rebate	:S\$
Salvage Value	:S\$
Margin for Repair	:S\$

Remarks

- () The vehicle is economical/not economical for repair.
- (x) The above survey was conducted on a 'without prejudice' basis.

Denise Tay (LKKAuto)

From: Denise Tay (LKKAuto)
Sent: Wednesday, 20 November 2019 10:04 AM
To: Mars Ler; Guo Qiang (LKKAuto)
Cc: Chris Bulaclac; Renemer Bagang
Subject: RE: Accident On 14/10/2019 Involving Our Insured ES6611M And Your Insured SLG30J (MSIG) car in and liability? Before Paint & Finalization

Dear Mars,

Confirm part by part \$7969, 7days.(before GST)

Please submit all your relevant documents to MSIG directly.

Best Regards,

Denise Tay | Case Handler

LKK Auto Consultants Pte Ltd

Phone: 6256-3561 | email: sur@lkkauto.com | fax: 6256-4315

Blk 51, Paya Ubi Industrial Park, Ubi Avenue 1, #02-25 | S(408933)

From: Mars Ler <mars.ler@ccfulco.com.sg>
Sent: Friday, 15 November 2019 3:18 PM
To: Guo Qiang (LKKAuto) <GuoQiang@lkkauto.com>
Cc: Chris Bulaclac <chris.bulaclac@ccfulco.com.sg>; Renemer Bagang <renemer.bagang@ccfulco.com.sg>
Subject: Re:Accident On 14/10/2019 Involving Our Insured ES6611M And Your Insured SLG30J (MSIG) car in and liability? Before Paint & Finalization

Dear Guo Qiang ,

As per attach for your reference , please help to finalize (7 working days) .

Thank you,

Best regards

Mars Ler
Senior Advisor - Motor Claims
Cycle & Carriage Fulco Motor Dealer Pte Ltd
330 Ubi Road 3 Singapore 408650
D/D 65949163 H/P 91792566

From: Katherine Wong [mailto:katherine_wong@sg.msig-asia.com]
Sent: Wednesday, 16 October 2019 6:15 PM
To: Winnie Chua; Mars Ler
Subject: RE: Re:Accident On 14/10/2019 Involving Our Insured ES6611M And Your Insured SLG30J (MSIG) car in and liability?

Dear Mars

Denise Tay (LKKAUTO)

From: Mars Ler <mars.ler@ccfulco.com.sg>
Sent: Wednesday, 6 November 2019 2:15 PM
To: Denise Tay (LKKAUTO)
Subject: RE: ES 6611M / TP / MSIG / DOA: 14/10/2019

Dear Denise ,

This vehicle currently process the repairing .

Thank you,

Best regards

Mars Ler
Senior Advisor - Motor Claims
Cycle & Carriage Fulco Motor Dealer Pte Ltd
330 Ubi Road 3 Singapore 408650
D/D 65949163 H/P 91792566

From: Denise Tay (LKKAUTO) [mailto:denisetay@lkkauto.com]
Sent: Wednesday, 6 November 2019 2:09 PM
To: Mars Ler
Subject: ES 6611M / TP / MSIG / DOA: 14/10/2019

Dear Mars,

Would like to check on this case, any repair done?

Best Regards,

Denise Tay | Case Handler

LKK Auto Consultants Pte Ltd

Phone: 6256-3561 | email: sur@lkkauto.com | fax: 6256-4315

Blk 51, Paya Ubi Industrial Park, Ubi Avenue 1, #02-25 | S(408933)

Nivitha (LKK Auto)

From: Crystal Lee <crystal_lee@sg.msig-asia.com>
Sent: Wednesday, 16 October 2019 4:36 PM
To: Admin-D (LKKAuto); assignments
Cc: Ong Zi Hui
Subject: Survey Request - Manual Assigned
Importance: High

Accident On 14/10/2019 Involving Our Insured ES6611M And Your Insured SLG30J (MSIG)

Manual Assigned

Dear LKK,

Refer to the email below, please arrange survey the vehicle.

We'll assign via Merimen once we receive the assignment from Motor Team.

Please contact us ASAP if you cannot attend this assignment

Thank you & Best regards,
Crystal Lee
Admin Officer, Claims Services (In-House Survey)
D: +65 6594 2535 | F: +65 6643 1349 | crystal_lee@sg.msig-asia.com



MSIG

MSIG Insurance (Singapore) Pte Ltd 16 Raffles Quay, #24-01 Hong Leong Building, Singapore 048581 | T: +65 6220

9644 | F: +65 6225 6371 | Co. Reg. No. 200412212G | msig.com.sg



A Member of **MS&AD** INSURANCE GROUP

From: Mars Ler [mailto:mars.ler@ccfulco.com.sg]
Sent: Wednesday, 16 October, 2019 2:18 PM
To: Winnie Chua <pingping_chua@sg.msig-asia.com>
Cc: Crystal Lee <crystal_lee@sg.msig-asia.com>; Ong Zi Hui <zihui_ong@sg.msig-asia.com>; Helene Phua <helene_phua@sg.msig-asia.com>; Chris Bulaclac <chris.bulaclac@ccfulco.com.sg>; Renemer Bagang <renemer.bagang@ccfulco.com.sg>
Subject: Re:Accident On 14/10/2019 Involving Our Insured ES6611M And Your Insured SLG30J (MSIG) car in and liability?

EXTERNAL EMAIL: Be careful when you click any links or open any attachment(s).

Dear Winnie ,

Please arrange survey on **18/10/2019 Friday 10.00 am (Customer waiting)** .

Thank you,

Best regards

Mars Ler
Senior Advisor - Motor Claims
Cycle & Carriage Fulco Motor Dealer Pte Ltd
330 Ubi Road 3 Singapore 408650
D/D 65949163 H/P 91792566

From: Winnie Chua [mailto:pingping_chua@sg.msig-asia.com]
Sent: Wednesday, 16 October 2019 1:52 PM
To: Katherine Wong; Mars Ler
Cc: Crystal Lee; Ong Zi Hui; Helene Phua
Subject: FW: Re:Accident On 14/10/2019 Involving Our Insured ES6611M And Your Insured SLG30J (MSIG) car in and liability?

Best Regards

Winnie Chua
Senior Admin Officer, Claims Services (In-House Survey)
Direct line +65 6594 2556 | Direct fax +65 6225 7402 | pingping_chua@sg.msig-asia.com



MSIG Insurance (Singapore) Pte Ltd 16 Raffles Quay, #24-01 Hong Leong Building, Singapore 048581 | T: +65 6220 9644 | F: +65 6225 6371 | Co. Reg. No. 200412212G | msig.com.sg



A Member of **MS&AD** INSURANCE GROUP

From: Mars Ler [<mailto:mars.ler@ccfulco.com.sg>]
Sent: Wednesday, 16 October 2019 1:33 PM
To: Claims <claims@sg.msig-asia.com>; Motor Survey <motorsurvey@sg.msig-asia.com>
Cc: Chris Bulaclac <chris.bulaclac@ccfulco.com.sg>; Renemer Bagang <renemer.bagang@ccfulco.com.sg>
Subject: Re:Accident On 14/10/2019 Involving Our Insured ES6611M And Your Insured SLG30J

EXTERNAL EMAIL: Be careful when you click any links or open any attachment(s).

Dear Motor Claims ,

Our client is looking to make a claim against your insurer for property damage caused to her vehicle.

Please confirm if your insurance company is prepared to engage in a direct settlement for property damage only.

This settlement excludes out client's right to recover further loss arising from rental of alternative / replacement vehicle.

As our client requires the use of a vehicle during this period that her vehicle is in our workshop, our client has will rented a vehicle and will be looking towards your company to make good her loss/rental cost.

Please confirm that you understand that any direct settlement reached for the cost of repairs to our client's vehicle does not prejudice her rights to recover any other damages he has suffered.

Please arrange for Pre-survey (Advance notice required 1 day ,vehicle with customer)

Thank you,

Best regards

Mars Ler
Senior Advisor - Motor Claims
Cycle & Carriage Fulco Motor Dealer Pte Ltd
330 Ubi Road 3 Singapore 408650
D/D 65949163 H/P 91792566

CONFIDENTIALITY NOTICE

This e-mail (including any attachments) may contain information that is privileged or confidential. The sending of this e-mail to any person other than the intended recipient is not a waiver of the privilege or confidentiality that attaches to it. If you are not the intended recipient, please notify the sender immediately, delete the email and do not copy, distribute or disclose its contents.

> Back to OneMotoring

Enquire PARF/COE Rebate for Registered Vehicle

Owner ID Type:	Singapore NRIC
Owner ID:	840B
Vehicle No.:	ES6611M
Vehicle to be Exported:	No
Intended Deregistration Date:	20 Oct 2019
Vehicle Make:	KIA
Vehicle Model:	CARENS 1.7 DCT DIESEL 5DR FWD
Primary Colour:	Brown
Manufacturing Year:	2017
Engine No.:	D4FDHH109602
Chassis No.:	KNAHU815VJ7193577
Maximum Power Output:	104.0 kW (139 bhp)
Open Market Value:	\$22,288.00
Original Registration Date:	18 Apr 2018
First Registration Date:	18 Apr 2018
Transfer Count:	0
Actual ARF Paid:	\$23,204.00
PARF Eligibility:	Yes
PARF Eligibility Expiry Date:	17 Apr 2028
PARF Rebate Amount:	\$17,403.00
COE Expiry Date:	17 Apr 2028
COE Category:	E - Open - all except motorcycle
COE Period(Years):	10
QP Paid:	\$38,801.00
COE Rebate Amount:	\$32,955.00
Total Rebate Amount:	\$50,358.00

The information contained herein is correct as at 20 Oct 2019

OK

SINGAPORE ACCIDENT STATEMENT

IMPORTANT NOTICE

1. Please report correctly the details of the accident to speed up the claims process.
2. This Form must be completed by the Policyholder and/or the Authorised Driver.
3. Information provided must be as truthful and accurate as possible. Any wilful misrepresentation or withholding of material facts may allow insurance companies to repudiate policy liability.
4. The issue and acceptance of this Form by insurance companies is not an admission of policy liability on the part of the insurance companies.
5. Any false reporting may be referred to the Police for investigation.
6. This report will be forwarded by the insurers of the GIA Records Management Centre established by the General Insurance Association of Singapore (GIA) for archiving and that copies of this report will, for a fee, be made available upon application by interested parties.
7. By the lodgement of this report to the insurers, you hereby consent to the archiving of this report at the centre and to copies of the report being made available aforesaid.

ACCIDENT STATEMENT

Date Of Report	15/10/2019 07:36
Date Of Accident	14/10/2019 19:00
Exact Location Of Accident	SLIP ROAD FROM BRADELL RD TO THOMSON RD, NEXT TO MT
Country/State Of Loss	SINGAPORE

DETAILS OF OWN VEHICLE

Vehicle Registration Number	ES6611M
Insured/Policyholder	
Name Of Registered Owner	TAN EN LAI KEVIN (CHEN ENLAI KEVIN)
NRIC No	S7525840B
Email Address	NOEMAIL
Mobile Phone No	(LOCAL) +65-98451245
Alternative Phone No	OTHERS-64576747

Vehicle Particulars

Manufacturer	KIA
Model	CARENS-1.7 (A)
Exact Purpose for which vehicle was being used at time of accident	ON ROUTE TO BUY SOMETHING
Are you claiming under your own insurance policy for repair to your vehicle?	NO
If No, Please state action to be taken	THIRD PARTY
Vehicle Category	PRIVATE CAR

Insurance Company

Name of Insurance Company	AIG ASIA PACIFIC INSURANCE PTE. LTD.
Type Of Coverage	COMPREHENSIVE
Fleet Policy	NO
Policy Number	1800037392-01
Cover Note Number	

Driver

Name of Driver	TSANG WENG LOKE
NRIC No	S7510079E
Date Of Birth	24/03/1975
Occupation	INDOOR
Date Of Driving Pass	28/12/1998
Driving Experience	20 YEARS AND 9 MONTHS
Gender	FEMALE
Mobile Number	(LOCAL) +65-97604258
Fax Number	
Contact Number	OTHERS-64576747
Email Address	WENGLOKE@GMAIL.COM

Address	400 BALESTIER ROAD BALESTIER PLAZA #10-05 SINGAPORE
Postcode	329802
Was driver an employee of the Insured's Company	NO
If No, Relationship of the Driver with the Insured	SPOUSE
Vehicle Registration Number of Driver's Own Vehicle	-
	-
Insurance Company of Driver's Own Vehicle	-
	-
	-

General Information of the Accident

Type Of Accident	COLLISION - HEAD TO REAR
Weather Conditions	CLEAR
Road Surface	DRY

Other Information

Was any foreign vehicle involved in this accident?	NO
Number of vehicles (including own vehicle) involved in the accident	2
Was any body injured in the Accident?	NO
Was any injured conveyed to hospital by ambulance?	NO
Was any other material or property damaged?	YES
I have been approached by unknown person(s) soliciting/offering accident claims assistance.	NO
Number of Passengers (Including Driver)	1

Details of Police Action

Was the accident reported to the police?	NO
If Yes, Please state which Police Station	
Was notice of intended Prosecution given?	NO
If Yes, against whom?	

Circumstances of Accident

REFER TO ATTACHMENT

Attachment(s)

Are accident photos available for attachment?	YES
Was there any video captured by Car Camera?	YES
Was there any audio recorded?	NO

DETAILS OF OTHER VEHICLE PROPERTY 1

Vehicle Registration Number	SLG30J
Vehicle Make/Model/Colour	VW/WHITE
Details Of Properties	
Vehicle Category	PRIVATE CAR
Name of Driver	VICTOR KUAH CHUAN CHEE
NRIC/Passport Number	
Contact Number	94230969
Address	
Postcode	
Insurance Company Name	
Nature Of Damage	FRONT BUMPER & RADIATOR
No. Of Passenger (Including Driver)	

Sketch Plan

SKETCH PLAN

IMPORTANT NOTICE

1. Please report correctly the details of the accident to speed up the claims process.
2. This Form must be completed by the Policyholder and/or the Authorized Driver.
3. Information provided must be as truthful and accurate as possible. Any wilful misrepresentation or withholding of material facts may allow insurance companies to repudiate policy liability.
4. The issue and acceptance of this Form by insurance companies is not an admission of policy liability on the part of the insurance companies.
5. Any false reporting may be referred to the Police for investigation.
6. The report will be forwarded by the insurers of the GIA Records Management Centre established by the General Insurance Association of Singapore (GIA) for archiving and that copies of this report will for a fee be made available upon application by interested parties.
7. By the lodgment of this report to the insurers, you hereby consent to the archiving of this report at the centre and to copies of the report being made available aforesaid.

3. Consent under the Personal Data Protection Act (PDPA)

I understand, acknowledge, agree and consent that:

- (a) My insurer, my workshop and the General Insurance Association of Singapore ("GIA") may/are permitted to collect, use, disclose and/or process my personal data/personal information set out in this [form] and any other personal information provided by me or possessed by my insurer (collectively the "Personal Information") and disclose and transfer such Personal Information to all insurer(s) who have insured vehicle(s) involved in this accident (all insurer(s) who have insured vehicle(s) involved in this accident shall be collectively referred to as the "Insurers"), the insurers' lawyers/law firms, the Monetary Authority of Singapore and any relevant government agency/authority (such as the police), for the purpose(s) of:
 - (i) processing, handling and/or dealing with my claims including the settlement of the claims and any necessary investigations relating to the claims;
 - (ii) investigating the accident and/or my claims;
 - (iii) carrying out and/or dealing with my instructions or responding to any enquiries by me;
 - (iv) administering my claims (including the mailing of correspondence, statements, invoices, reports or notices to me, which could involve disclosure of certain personal data about me to bring about delivery of the same as well as on the external cover of envelopes/mail packages); and/or
 - (v) complying with applicable law in administering, processing, handling and/or dealing with my claims, (collectively the "Purposes")
- (b) All insurer(s) who have insured vehicle(s) involved in this accident and the insurers' lawyers/law firms, may/are permitted to collect, use, disclose and/or process my Personal Information for one or more of the above Purposes; and
- (c) my Personal Information may/can be disclosed by any of the insurers and/or GIA to their third party service providers or agents (including their lawyers/law firms), which may be sited outside of Singapore, for one or more of the above Purposes.
- (d) my Personal Information will also be collected and used to compile claims history for the purpose of fraud detection, investigation and management in present and all future claims.
- (e) The information so collected under (d) above may be shared / disclosed:
 - (i) to all insurers and/or any other third parties that assist in evaluating, investigating, controlling or managing fraud, regulators, law enforcement and government agencies as reasonably required for the purposes stated, or
 - (ii) for complying with requirements under any regulations, laws or court orders.

Policyholder's Signature
Date & Time:

Driver's Signature
(If driver is not the policyholder)
Date & Time:

Reporting Centre Personnel's Signature
Name:
NRIC/FIN No.:

Sketch Plan #2

SKETCH PLAN

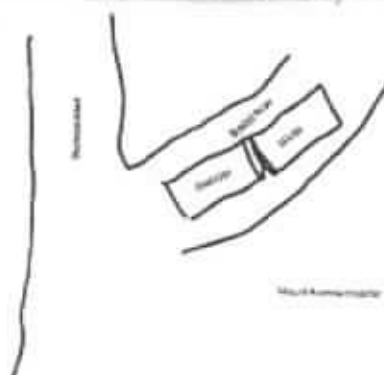

DESCRIBE CIRCUMSTANCES OF THE ACCIDENT

I was en route via Bradell Road to go into Thomson Road. I stopped my vehicle to await traffic to clear along Thomson Road. I came to a full stop and shortly after, the vehicle behind me crashed into my car. The impact was great enough to cause my phone to come off the holder on the dashboard, cracked the bumper as well as damaged the rear sensor. I was not injured.

DECLARATION

I/We declare the foregoing particulars are true in every respect.

Policyholder's Signature
Date & Time:

Driver's Signature
(If driver is not the policyholder)
Date & Time:

Reporting Centre Personnel's Signature
Name:
NIC/PIN No.:

Addendum Sheet



GENERAL INSURANCE ASSOCIATION OF SINGAPORE RECORDS MANAGEMENT CENTRE
 5 Raffles Quay #18-00 Singapore 048580
 Tel (65) 6724 0010 Fax (65) 6724 0010
 Operating Hours: Monday to Friday, 09:00 – 17:00
 UEN: S66500006 / GST Reg. No: M60017795

IMPORTANT NOTE: Please submit the completed Addendum form to the same Authorised Reporting Centre with whom you submitted the Original Report.

ADDENDUM

(A) PARTICULARS OF PERSON MAKING THE AMENDMENTS:

Original Report No: MIC 619136778 Vehicle Registration No: ES 6611 M
 Name (as shown in NRIC): Tsang Weng Lake NRIC/FIN/Passport No: _____
 (*Vehicle Driver / ~~Vehicle Owner~~) (*) Please delete as appropriate
 Address: _____ Singapore ()
 Contact (Tel): _____ Mobile No.: 9760 4258
 Email Address: _____
 Date of Accident: 14/10/2019 Time of Accident: 19:00
 Place of Accident: Slip Road from Braddell Rd To Thomson Rd, Next to MT Hospital
 Insurance Company: AIU

(B) ADDITIONAL INFORMATION / AMENDMENTS:

I have made a report on the above mentioned accident and would like to include additional information or make the following amendments:

Submit Video footage

Policyholder / Driver's Signature
 Date: _____

Reporting Centre Personnel's Signature
 Name: _____
 NRIC/FIN No.: _____
 Date: 14/10/19



CYCLE & CARRIAGE

CYCLE & CARRIAGE-FULCO MOTOR DEALER PTE LTD

EUNOS LINK SERVICE CENTRE

330 Ubi Road 3 Singapore 408650 Tel: 67461000 Fax: 64875857



ESTIMATE

Invoice Name & Address	Owner Name & Vehicle Info														
MSIG INSURANCE (SINGAPORE) PTE LTD 16 RAFFLES QUAY #24-01 HONG LEONG BUILDING SINGAPORE 048581 Contact No 62209644	<table> <tr> <td>Cust No/Name</td><td>/Mr Tan En Lai Kevin (chen Enlai)</td></tr> <tr> <td>Reg No/Reg Date</td><td>ES6611M / 18/04/2018</td></tr> <tr> <td>Date In/Mileage</td><td>16/10/2019/ 0</td></tr> <tr> <td>Chassis No</td><td>KNAHU815VJ7193577</td></tr> <tr> <td>Engine No</td><td>D4FDHH109602</td></tr> <tr> <td>Make/Model</td><td>KIA/CARENS 1.7 A D SX FL DY6</td></tr> <tr> <td>Colour/Trim</td><td>K7N / WK</td></tr> </table>	Cust No/Name	/Mr Tan En Lai Kevin (chen Enlai)	Reg No/Reg Date	ES6611M / 18/04/2018	Date In/Mileage	16/10/2019/ 0	Chassis No	KNAHU815VJ7193577	Engine No	D4FDHH109602	Make/Model	KIA/CARENS 1.7 A D SX FL DY6	Colour/Trim	K7N / WK
Cust No/Name	/Mr Tan En Lai Kevin (chen Enlai)														
Reg No/Reg Date	ES6611M / 18/04/2018														
Date In/Mileage	16/10/2019/ 0														
Chassis No	KNAHU815VJ7193577														
Engine No	D4FDHH109602														
Make/Model	KIA/CARENS 1.7 A D SX FL DY6														
Colour/Trim	K7N / WK														

Account No	Terms	Date/Time Printed	CSE	Operator	WIP No
F0000017	Credit	16/10/2019/ 13:30	DS	218 / MarsLer	34739
Description of Goods / Services		Qty	Unit Price	Disc%	Amount
S MIPNT88088	DIAGNOSTIC / SCANNING				250.00
S MIPNT88088	TO CHECK LIGHTING AND WIRING SYSTEM ON REAR ACCIDENT AFFECTED AREAS				80 100.00
S MIPNT88088	TO REPLACE TAILGATE GLASS				300.00
M SUNDRY	SEALANT KIT ON TAILGATE GLASS				100.00
S MIPNT88088	TO INSTALL RIKE COOL SOLAR FILM ON TAILGATE GLASS				220.00
S MIPNT88088	TO REMOVE AND RE-INSTALL TRIMMING AND CAPERTING TO GIVE WAY ACCESS REPAIR ON REAR ACCIDENT AFFECTED AREAS				300 600.00
S MIPNT88088	TO REPLACE TAILGATE PNL,RR BUMPER,REINFORCEMENT,ETC -CUT & RE-WELD REAR END PANEL -REPAIR REAR FLOORING STRAIGHTEN,REFORM,ALIGN ON REAR ACCIDENT AFFECTED AREAS				2100 4200.00
S MIPNT88088	TO APPLY SEALANT KIT ON NEW PANEL				100 300.00
S MIPNT88088	TO REPLACE REAR EXHAUST MUFFLER ASSY				NN X 600.00
S MIPNT98088	SPRAY PAINTING ON REAR ACCIDENT AFFECTED AREAS				1260 2100.00
P KS 86611 A4 010	COVER - REAR BUMPER, - re	1.00	576.00	0.00	576.00
P KS 86612 A4 810	COVER - REAR BUMPER, - CRA	1.00	201.00	0.00	201.00
P KS 86617 A4 800	CAP-RR HOOK - cut	1.00	4.00	0.00	4.00
M KS 86682 A4 010	HOLDER - BACK WARNIN - 5 mcl	2.00	4.00	0.00	8.00
M KS 86682 A4 020	HOLDER - BACK WARNIN - cut	2.00	4.00	0.00	8.00
P KS 86665 A4 800	SKID PLATE-RR BUMPER - cut	1.00	179.00	0.00	179.00
M KS 95720 A4 100K 7N	ULTRASONIC SENSOR AS - DM	1.00	162.00	0.00	162 486.00
M KS 91885 A4 070	WIRING HARNESS-R.P.A - X NN	1.00	251.00	0.00	X 251.00

Confirm & accepted by

Authorized signatory and company stamp

Validity of this estimate is 14 days from date of quote. This is a computer generated document, no signature is required. Estimated costs quoted are excluding GST. We would mention that the above estimate is based on our initial inspection and does not include any additional parts or labour which may be required after repair work has commenced. Occasionally worn or damaged parts are discovered after work has started and needed for repairs or replacement. However, should this occur, we would advise you. Please be informed that a deposit of 50% of the above estimate is payable before commencement of the work. Payment for this may be made in cash, credit card or cheque. You must also agree to pay full amount for renewal of the windscreen in the event of inadvertent breakage in the course of renewing the rubber seal or other repair requiring the removal of the windscreen.



CYCLE & CARRIAGE-FULCO MOTOR DEALER PTE LTD
EUNOS LINK SERVICE CENTRE



CYCLE & CARRIAGE

330 Ubi Road 3 Singapore 408650 Tel: 67461000 Fax: 64875857

ESTIMATE

Invoice Name & Address	Owner Name & Vehicle Info
MSIG INSURANCE (SINGAPORE) PTE LTD 16 RAFFLES QUAY #24-01 HONG LEONG BUILDING SINGAPORE 048581 Contact No 62209644	Cust No/Name /Mr Tan En Lai Kevin (chen Enlai) Reg No/Reg Date ES6611M / 18/04/2018 Date In/Mileage 16/10/2019/ 0 Chassis No KNAHU815VJ7193577 Engine No D4FDHH109602 Make/Model KIA/CARENS 1.7 A D SX FL DY6 Colour/Trim K7N / WK

Account No	Terms	Date/Time Printed	CSE	Operator	WIP No
F0000017	Credit	16/10/2019/ 13:30	DS	218 / MarsLer	34739

Description of Goods / Services	Qty	Unit Price	Disc%	Amount
M KS 86672 A4 000 RH LWR SIDE BRACKET- <i>X NN</i>	1.00	21.00	0.00	<i>X</i> 21.00
M KS 92406 A4 100 REAR FOG, RH LAMP ASS <i>X NN</i>	1.00	116.00	0.00	<i>X</i> 116.00
P KS 86631 A4 010 BEAM - REAR BUMPER <i>X CFA</i>	1.00	367.00	0.00	<i>/</i> 367.00
M KS 86633 A4 010 BRACKET-RR BUMPER RA <i>/</i>	2.00	5.00	0.00	<i>/</i> 10.00
M KS 86636 A4 010 BRACKET-RR BUMPER LW <i>/</i>	1.00	5.00	0.00	<i>/</i> 5.00
M KS 86634 A4 010 BRACKET-RR BUMPER RA <i>/</i>	2.00	5.00	0.00	<i>/</i> 10.00
P KS 86641 A4 010 LH STAY-RR BUMPER <i>X</i>	1.00	159.00	0.00	<i>X</i> 159.00
P KS 86642 A4 010 RH STAY - RR BUMPER <i>X NN</i>	1.00	159.00	0.00	<i>X</i> 159.00
M KS 86613 A4 000 LH SIDE BRACKET ASSY <i>X</i>	1.00	25.00	0.00	<i>X</i> 25.00
M KS 86614 A4 000 RH SIDE BRACKET ASSY <i>X</i>	1.00	25.00	0.00	<i>X</i> 25.00
M KS 65910 A4 000 CROSSMEMBER ASSY-RR <i>X repair</i>	1.00	453.00	0.00	<i>X</i> 453.00
M KS 73700 A4 040 TAILGATE PANEL ASSY <i>X</i>	1.00	1088.00	0.00	<i>/</i> 1088.00
M KS 81230 2W 000 LATCH ASSY-TAIL GATE <i>X</i>	1.00	109.00	0.00	<i>X</i> 109.00
M KS 87321 A4 000 WEATHERSTRIP - TAILG <i>X NN</i>	1.00	131.00	0.00	<i>X</i> 131.00
M KS 86310 A4 000 EMBLEM - CARENS <i>/</i>	1.00	36.00	0.00	<i>/</i> 36.00
P KS 86312 A4 000 EMBLEM - CRDI <i>/</i>	1.00	29.00	0.00	<i>/</i> 29.00
M KS 87110 A4 000 TAILGATE GLASS ASSY <i>/</i>	1.00	490.00	0.00	<i>/</i> 490.00
M KS 87115 A4 000 STOPPER-RR WINDOW GL <i>/</i>	2.00	15.00	0.00	<i>/</i> 30.00
M KS 86114 3D 000 PAD-W/SHLD GLASS <i>/</i>	8.00	2.00	0.00	<i>/</i> 16.00
M KS 28710 A4 350 MUFFLER ASSY-REAR <i>X repair</i>	1.00	710.00	0.00	<i>X</i> 710.00
P KS 06032 50 037A CLIP - BUMPER <i>/</i>	10.00	2.00	0.00	<i>/</i> 20.00

Z NOTES

ACCIDENT ON 14/10/2019 ALONG SLIP ROAD FROM BRADELL RD TO THOMSON RD
OWNER CLAIMING THIRD PARTY
REQUIRED REPLACEMENT CAR
TP # SLG30J TP INS : MSIG

*7 Days. 16/10/19
before paint photos.
Eno Q.ing - 8288082
18/10/19*

LKK Auto Consultants hence notify
the Repairer of the following:

* To resurvey before/after spray painting

- Confirm & accepted by
- * Parts prices are subject to confirmation
 - * Third party survey is on a "Without Prejudice" basis
 - * No illegal modification(s) is allowed
 - * Supplementary item(s) must be resurveyed and is subject to final approval from Insurance Company

Authorized signatory and company stamp

Parts	5,722.00
Labour	0.00
Standard Menu	0.00
Specialist Job	8,670.00
Others(Lub,etc)	0.00
Sundry	100.00
Total(w/o GST)	14,492.00

Validity of this estimate is 14 days from date of quote. This is a computer generated document, no signature is required.
Estimated costs quoted are excluding GST. We would mention that the above estimate is based on our initial inspection and does not include any additional parts or labour which may be required after repair work has commenced. Occasionally worn or damaged parts are discovered after work has started and needed for repairs or replacement. However, should this occur, we would advise you. Please be informed that a deposit of 50% of the above estimate is payable before commencement of the work. Payment for this may be made in cash, credit card or cheque. You must also agree to pay full amount for renewal of the windscreen in the event of inadvertent breakage in the course of renewing the rubber seal or other repair requiring the removal of the windscreen.



CYCLE & CARRIAGE

CYCLE & CARRIAGE-FULCO MOTOR DEALER PTE LTD
EUNOS LINK SERVICE CENTRE

330 Ubi Road 3 Singapore 408650 Tel: 67461000 Fax: 64875857



ESTIMATE

Invoice Name & Address	Owner Name & Vehicle Info														
MSIG INSURANCE (SINGAPORE) PTE LTD 16 RAFFLES QUAY #24-01 HONG LEONG BUILDING SINGAPORE 048581 Contact No 62209644	<table> <tr> <td>Cust No/Name</td><td>/Mr Tan En Lai Kevin (chen Enlai)</td></tr> <tr> <td>Reg No/Reg Date</td><td>ES6611M / 18/04/2018</td></tr> <tr> <td>Date In/Mileage</td><td>04/11/2019/ 43923</td></tr> <tr> <td>Chassis No</td><td>KNAHUB15VJ7193577</td></tr> <tr> <td>Engine No</td><td>D4FDHH109602</td></tr> <tr> <td>Make/Model</td><td>KIA/CARENS 1.7 A D SX FL DY6</td></tr> <tr> <td>Colour/Trim</td><td>K7N / WK</td></tr> </table>	Cust No/Name	/Mr Tan En Lai Kevin (chen Enlai)	Reg No/Reg Date	ES6611M / 18/04/2018	Date In/Mileage	04/11/2019/ 43923	Chassis No	KNAHUB15VJ7193577	Engine No	D4FDHH109602	Make/Model	KIA/CARENS 1.7 A D SX FL DY6	Colour/Trim	K7N / WK
Cust No/Name	/Mr Tan En Lai Kevin (chen Enlai)														
Reg No/Reg Date	ES6611M / 18/04/2018														
Date In/Mileage	04/11/2019/ 43923														
Chassis No	KNAHUB15VJ7193577														
Engine No	D4FDHH109602														
Make/Model	KIA/CARENS 1.7 A D SX FL DY6														
Colour/Trim	K7N / WK														

Account No	Terms	Date/Time Printed	CSE	Operator	WIP No			
F0000017	Credit	15/11/2019/ 14:07	DS	21B / MarsLer	34739			
Description of Goods / Services				Qty	Unit Price	Disc%	Amount	
S	MIPNT88088							250.00
	DIAGNOSTIC / SCANNING							
S	MIPNT88088							80.00
	TO CHECK LIGHTING AND WIRING SYSTEM ON REAR ACCIDENT AFFECTED AREAS							
S	MIPNT88088							300.00
	TO REPLACE TAILGATE GLASS							
M	SUNDRY							100.00
	SEALANT KIT ON TAILGATE GLASS							
S	MIPNT88088							220.00
	TO INSTALL RIKE COOL SOLAR FILM ON TAILGATE GLASS							
S	MIPNT88088							300.00
	TO REMOVE AND RE-INSTALL TRIMMING AND CAPERTING TO GIVE WAY ACCESS REPAIR ON REAR ACCIDENT AFFECTED AREAS							
S	MIPNT88088							2100.00
	TO REPLACE TAILGATE PNL,RR BUMPER,REINFORCEMENT,ETC -INCLUDE TRANSFER TAILGATE COMPONENT & MECHANISM PARTS -REPAIR REAR END PANEL STRAIGHTEN,REFORM,ALIGN ON REAR ACCIDENT AFFECTED AREAS							
S	MIPNT88088							100.00
	TO APPLY SEALANT KIT ON NEW PANEL							
S	MIPNT98088							1260.00
	SPRAY PAINTING ON REAR ACCIDENT AFFECTED AREAS							
S	MIPNT88088							(A) 20.00
	APPLY PRIVATE-HIRE CAR DECAL INSTALLATION / AC. (AFTER REPLACEMENT TAILGATE GLASS)							
X	KS 86611 A4 010	COVER - REAR BUMPER,	1.00	576.00	0.00		576.00	
X	KS 86612 A4 810	COVER - REAR BUMPER	1.00	201.00	0.00		201.00	
X	KS 86617 A4 800	CAP-RR HOOK	1.00	4.00	0.00		4.00	
X	KS 86682 A4 010	HOLDER - BACK WARNIN	2.00	4.00	0.00		8.00	
X	KS 86682 A4 020	HOLDER - BACK WARNIN	2.00	4.00	0.00		8.00	
X	KS 86665 A4 800	SKID PLATE-RR BUMPER	1.00	179.00	0.00		179.00	
X	KS 95720 A4 100K 7N	ULTRASONIC SENSOR AS	1.00	162.00	0.00		162.00	

Confirm & accepted by

Finalization

Authorized signatory and company stamp

Validity of this estimate is 14 days from date of quote. This is a computer generated document, no signature is required. Estimated costs quoted are excluding GST. We would mention that the above estimate is based on our initial inspection and does not include any additional parts or labour which may be required after repair work has commenced. Occasionally worn or damaged parts are discovered after work has started and needed for repairs or replacement. However, should this occur, we would advise you. Please be informed that a deposit of 50% of the above estimate is payable before commencement of the work. Payment for this may be made in cash, credit card or cheque. You must also agree to pay full amount for renewal of the windscreen in the event of inadvertent breakage in the course of renewing the rubber seal or other repair requiring the removal of the windscreen.



CYCLE & CARRIAGE

CYCLE & CARRIAGE FULCO MOTOR DEALER PTE LTD
EUNOS LINK SERVICE CENTRE

330 Ubi Road 3 Singapore 408650 Tel: 67461000 Fax: 64875857



ESTIMATE

Invoice Name & Address	Owner Name & Vehicle Info
MSIG INSURANCE (SINGAPORE) PTE LTD 16 RAFFLES QUAY #24-01 HONG LEONG BUILDING SINGAPORE 048581 Contact No 62209644	Cust No/Name /Mr Tan En Lai Kevin (chen Enlai) Reg No/Reg Date ES6611M / 18/04/2018 Date In/Mileage 04/11/2019/ 43923 Chassis No KNAHU815VJ7193577 Engine No D4FDHH109602 Make/Model KIA/CARENS 1.7 A D SX FL DY6 Colour/Trim K7N / WK

Account No	Terms	Date/Time Printed	CSE	Operator	WIP No	
F0000017	Credit	15/11/2019/ 14:07	DS	218 / Marsler	34739	
		Description of Goods / Services	Qty	Unit Price	Disc%	Amount
X	KS 86631 A4 010	BEAM - REAR BUMPER	1.00	367.00	0.00	367.00
X	KS 86633 A4 010	BRACKET-RR BUMPER RA	2.00	5.00	0.00	10.00
X	KS 86636 A4 010	BRACKET-RR BUMPER LW	1.00	5.00	0.00	5.00
X	KS 86634 A4 010	BRACKET-RR BUMPER RA	2.00	5.00	0.00	10.00
X	KS 73700 A4 040	TAILGATE PANEL ASSY	1.00	1088.00	0.00	1088.00
X	KS 86310 A4 000	EMBLEM - CARENS	1.00	36.00	0.00	36.00
X	KS 86312 A4 000	EMBLEM - CRDI	1.00	29.00	0.00	29.00
X	KS 87110 A4 000	TAILGATE GLASS ASSY	1.00	490.00	0.00	490.00
M	KS 87115 A4 000	STOPPER-RR WINDOW GL	2.00	15.00	0.00	30.00
M	KS 86114 3D 000	PAD-W/SHLD GLASS	8.00	2.00	0.00	16.00
X	KS 06032 50 037A	CLIP - BUMPER	10.00	2.00	0.00	20.00
Z	NOTES					
ACCIDENT ON 14/10/2019 ALONG SLIP ROAD FROM BRADELL RD TO THOMSON RD						
OWNER CLAIMING THIRD PARTY						
REQUIRED REPLACEMENT CAR (CHAN'S)						
TP # SLG30J TP INS : MSIG						

Confirm & accepted by

Parts	3,239.00
Labour	0.00
Standard Menu	0.00
Specialist Job	4,630.00
Others(Lub,etc)	0.00
Sundry	100.00
Total(w/o GST)	7,969.00

Authorized signatory and company stamp

Validity of this estimate is 14 days from date of quote. This is a computer generated document, no signature is required. Estimated costs quoted are excluding GST. We would mention that the above estimate is based on our initial inspection and does not include any additional parts or labour which may be required after repair work has commenced. Occasionally worn or damaged parts are discovered after work has started and needed for repairs or replacement. However, should this occur, we would advise you. Please be informed that a deposit of 50% of the above estimate is payable before commencement of the work. Payment for this may be made in cash, credit card or cheque. You must also agree to pay full amount for renewal of the windscreen in the event of inadvertent breakage in the course of renewing the rubber seal or other repair requiring the removal of the windscreen.

LKK Auto Consultants Pte Ltd (Co.Reg.No:199607198R)

51 Ubi Ave 1 #01-25, Paya Ubi Industrial Park

Singapore 408933

Tel: 6256-3561 Fax: 6844-8805 Email: sur@lkkauto.com; assignments@lkkauto.com

VEHICLE DAMAGE INSPECTION REPORT

Our File No: CS/MSG19018302/GTD3N2

Date: 25/11/2019

REFERENCE

Handling Insurer:	MSIG Insurance (Singapore) Pte. Ltd.	Policy No:	28736267AVW
Claimant Vehicle No :	ES6611M	Insured Vehicle No :	SLG30J
Date of Loss:	14/10/2019	Nature of Claim:	TP
		Claim No:	608539

DESCRIPTION & IDENTIFICATION OF VEHICLE

Reg No:	ES6611M	Engine No:	D4FDHH109602
Make & Model:	KIA CARENS, 1.7 (A)	Chassis No:	KNAHU815VJ7193577
Reg. Date:	18/04/2018 (Man. Year: 2017)	Odometer:	43045 km
Colour:	Brown		
Engine Capacity:	1685 cc		
Market Value/New Car Price:	N/A		
Sum Insured (S\$):	Market Value/New Car Price		

CONDITION OF VEHICLE AT THE TIME OF SURVEY

General Condition:	Steering (Serviceable):	Yes	Footbrake (Serviceable):	Yes
Handbrake (Serviceable):	Yes	Engine Modification:	No	Pre-accident Condition:

CONDITION OF TYRES

Front Tyre Size:	225/45R17	Rear Tyre Size:	225/45R17
Front Left Side:	Yokohama 6 mm	Rear Left Side:	Yokohama 6 mm
Front Right Side:	Yokohama 6 mm	Rear Right Side:	Yokohama 6 mm

The above values represent the remaining tyre treads depth

COST OF CLAIMS	Repairer's	Adjuster's	Difference	Diff %
Parts	5,722.00	3,239.00	2,483.00	43.39
Miscellaneous Items	0.00	0.00	0.00	
Labour	8,790.00	4,730.00	4,060.00	46.19
Paintwork Labour	0.00	0.00	0.00	
Towing	0.00	0.00	0.00	
Gross Total (S\$)	14,512.00	7,969.00	6,543.00	45.09
+ GST 7.00/7.00% (S\$)	1,015.84	557.83	458.01	45.09
Nett Amount (S\$)	15,527.84	8,526.83	7,001.01	45.09

INSPECTION

Date of Assignment:	18/10/2019	
Date Inspected:	18/10/2019 Inspected At:	Cycle & Carriage Fulco Motor Dealer Pte Ltd (HQ) 330 Ubi Road 3 Singapore 408650
Estimated Period of Repair:	7.0 days	

Adjuster: XING GUO QIANG

Manager: DENISE TAY KWEE CHENG

NOTE: This report represents our findings at the time and place of inspection stated herein. Such inspection has been carried out to the best of our knowledge and ability but any other liability under any other circumstances is hereby expressly excluded.

REPAIR DETAILS

Reference

Part Source:	MRM-SG	Version: 1.0 (Last Synchronised: 25 Nov 2019)
Parts:	M1-MPV	KIA CARENS 1.7 (A) (Catalogue:Merimen Singapore 1.0)
Labour:	Repairer's	(Price-denominated Standard List)
Print Code:	(Unsubmitted, no print-code for ES6611M)	
Validity:	These estimates are valid only if they contain the print code (above) on all estimate pages, running page numbers with the END OF ESTIMATES marker on the last estimate page	
Further Info:	Items/values not in reference catalogue are prefixed with an asterisk *.	

Recommended Parts

No.	Qty	Part No.	Particulars	Condition	Repairer's	Amount
1	1		*COVER-REAR BUMPER	Deformed	576.00 FS	*576.00 FS
2	1		*COVER-REAR BUMPER	Cracked	201.00 FS	*201.00 FS
3	1		*CAP-RR HOOK	Cut	4.00 FS	*4.00 FS
4	2		*HOLDER-BACK WARNIN	Necessary	8.00 FS	*8.00 FS
5	2		*HOLDER-BACK WARNIN	Necessary	8.00 FS	*8.00 FS
6	1		*SKID PLATE-RR BUMPER	Cut	179.00 FS	*179.00 FS
7	1		*ULTRASONIC SENSOR AS (3 Pcs)	Damaged (1 Pc only)	486.00 FS	*162.00 FS
8	1		*WIRING HARNESS-R.P.A	Not Necessary	251.00 FS	*- FS
9	1		*RH LWR SIDE BRACKET	Not Necessary	21.00 FS	*- FS
10	1		*REAR FOG,R LAMP ASS	Not Necessary	116.00 FS	*- FS
11	1		*BEAM-REAR BUMPER	Cracked	367.00 FS	*367.00 FS
12	2		*BRACKET-RR BUMPER RA	Necessary	10.00 FS	*10.00 FS
13	1		*BRACKET-RR BUMPER LW	Necessary	5.00 FS	*5.00 FS
14	2		*BRACKET-RR BUMPER RA	Necessary	10.00 FS	*10.00 FS
15	1		*LH STAY-RR BUMPER	Not Necessary	159.00 FS	*- FS
16	1		*RH STAY-RR BUMPER	Not Necessary	159.00 FS	*- FS
17	1		*LH SIDE BRACKET ASSY	Not Necessary	25.00 FS	*- FS
18	1		*RH SIDE BRACKET ASSY	Not Necessary	25.00 FS	*- FS
19	1		*CROSSMEMBER ASSY-RR	Repair	453.00 FS	*- FS
20	1		*TAILGATE PANEL ASSY	Bent	1,088.00 FS	*1,088.00 FS
21	1		*LATCH ASSY-TAIL GATE	Not Necessary	109.00 FS	*- FS
22	1		*WEATHERSTRIP-TAILG	Not Necessary	131.00 FS	*- FS
23	1		*EMBLEM-CARENS	Necessary	36.00 FS	*36.00 FS
24	1		*EMBLEM-CRDI	Necessary	29.00 FS	*29.00 FS
25	1		*TAILGATE GLASS ASSY	Necessary	490.00 FS	*490.00 FS
26	2		*STOPPER-RR WINDOW GL	Necessary	30.00 FS	*30.00 FS
27	8		*PAD-W/SHLD GLASS	Necessary	16.00 FS	*16.00 FS
28	1		*MUFFLER ASSY-REAR	Repair	710.00 FS	*- FS
29	10		*CLIP-BUMPER	Necessary	20.00 FS	*20.00 FS

F=Franchise part, S=SpcNett.

Total Parts (S\$)	5,722.00	3,239.00
--------------------------	-----------------	-----------------

Report was unsubmitted during this print-out.

Recommended Miscellaneous Items

There are no new miscellaneous items selected.

Recommended Labour

No	Particulars	Lab.Type	Repairer's	Amount
Labour Items				
1	DIAGNOSTIC/SCANNING	New	250.00	250.00
2	TO CHECK LIGHTING AND WIRING SYSTEM ON REAR ACCIDENT AFFECTED AREAS	New	100.00	80.00
3	TO REPLACE TAILGATE GLASS	New	300.00	300.00
4	SEALANT KIT ON TAILGATE GLASS	New	100.00	100.00
5	TO INSTALL RIKE COOL SOLAR FILM ON TAILGATE GLASS	New	220.00	220.00
6	TO REMOVE AND RE-INSTALL TRIMMING ABD CAPERTING TO GIVE WAY ACCESS REPAIR ON REAR ACCIDENT AFFECTED AREAS	New	600.00	300.00
7	TO REPLACE TAILGATE PNL,RR BUMPER,REINFORCEMENT,ETC-CUT & RE-WELD REAR END PANEL.-REPAIR REAR FLOORING STRAIGHTEN,REFORM,ALIGN ON REAR ACCIDENT AFFECTED AREAS	New	4,200.00	2,100.00
8	TO APPLY SEALANT KIT ON NEW PANEL	New	300.00	100.00
9	TO REPLACE REAR EXHAUST MUFFLER ASSY	New	600.00	0.00
10	SPRAY PAINTING ON REAR ACCIDENT AFFECTED AREAS	New	2,100.00	1,260.00
11	APPLY PRIVATE-HIRE CAR DECAL INSTALLATION (AFTER REPLACEMENT TAILGATE GLASS)	New	20.00	20.00
Gross Labour Cost (S\$)			8,790.00	4,730.00

Report was unsubmitted during this print-out.

< END OF ESTIMATES >