

ASS. REC. BY:

REF: CS

MSIG19017575/Mgd3m

Special Instruction:

Surveyor

Marcus

ASSIGNMENT (Office)

From (Person):

Muhd Ashik

of

MSIG

Date/Time: 07/10/2019 @ 10:46am

Estimated Cost:

Bill to:

OD / TP RES / OD RES / EVA / INV / MV / CS

To Inspect Vehicle No:

FBF 3576E

Insured:

SKE 609M

at Workshop m/s

Enfia Motor

Tel:

6752 7740

of

1 Kalki Bukit Ave 6 # 02-62

Policy No:

1000890428

Claim No:

731709

Sum Insured:

Excess:

Make of Veh:

D.O.A.

29/9/2019

(Client's Record)

CA / REV / REP. / REV 24 HRS

H.O.D. Endorsement:

Date/Time:

10:07am 7/10/19

Person Contacted:

Lee Lee

Vehicle

IN OUT

Date/Time

Action/Instruction (/ Estimate

FBF 3576E - X

SKE 609M - NBR/INC/4018899/01

DUA: 5/10/2019

08/10/19 @ 2.44pm moved to Muhd Ashik on mainmen.

(08/11/13) wef

ASS. REC. BY: *Maxcus*

REF:

MS16/

ASSIGNMENT

From:

Date:

Estimated Cost:

OD / TP / WS / TP RES / OD RES / EVA / INV / MV

To Inspect Vehicle No:

at Workshop m/s

of

Insured:

Policy No.

Claims No.

Sum Insured:

Excess:

(Client's Record)

Make of Veh:

(Policy Condition)

Remark: The veh had commenced its repair at the time of inspection.

Bal. or Market Value:

IDAC Accident Rpt:

GIA / PR Seen:

Est. Repairs:

days

Res.: Yes or No

Lum Sum:

%

3 Val.: Yes or No

CA / REV / REP. / 24 HRS

Date:

Person Contacted:

Date / Time

Action / Instruction

*7-6-2021 1yr3 den**10/10/19 4/5 @ 1500 confirmed with rec'd (Red B3987.10, 73%)*

RECEIVED 10 OCT 2019

Date/Time, File Pass to?

☐

: Prel. Report

1) *60/10 train*☐

: Final Report

Date/Time, File Return to?

2)

Days Of Repair:

Resurvey No. of Trip:

Add Fee:

☐

: Site Insp (\$

☐

: Interview (\$

☐

: Tech. Invs (\$

☐

: Weekend (\$

Report Format :

Lump Sum / I.B.I. (\$

1500

Survey Fee:

Transportation:

S + RS \$

Photos

Others

TOTAL

Veh No:

FBF 3876E

Yr Regn:

6 11

Type: M.Car / M.Cycle / Bus / Van / Lorry / Taxi / Prime Mover /

Truck / Trailer or

Make:

*Yamaha FZ16*C.C. *153*

Colour:

Green

A/C: Insured / Std / NI / NA

Sp. Reading

33033

T/Radio: Insured / Std / NI / NA

Eng/No:

C/No:

ME 121054B 2033868

Gen. Cond: Good / Fair / Poor / Burnt

Steering: Inorder / Jammed / Leaked / Burnt or

Brake: Inorder / Jammed / Leaked / Burnt or

Modi: Nil / S/Rim / STD A/Rim or

Tyre Size:

F:

110-70-17

R:

140-70-17

BS / DUN / EXNOVA / GY / FS / LIZA / MIC / OHTSU / PIR / SUMI /

TOYO / YOKO or

Front

R/Bal.

6

mm

Rear

R/Bal.

6

mm

L/Bal.

mm

L/Bal.

mm

D.O.A.

29/9/19

D.O.I.

7/10/19

Survey held at

Des. of Damages: Frt / Rear / O/S / N/S / U/C / Rooftop or

Rd. o/s Body.

The U/C / Chassis frame / Body Structure affected due to collision.

Date/Time, File Pass to?

☐

: Prel. Report

1) *60/10 train*☐

: Final Report

Date/Time, File Return to?

2)

Days Of Repair:

Resurvey No. of Trip:

Add Fee:

☐

: Site Insp (\$

☐

: Interview (\$

☐

: Tech. Invs (\$

☐

: Weekend (\$

Report Format :

Lump Sum / I.B.I. (\$

1500

Survey Fee:

Transportation:

S + RS \$

Photos

Others

TOTAL

150
11
161

Note: This document has not been finalised.**LKK Auto Consultants Pte Ltd** (Co.Reg.No:199607198R)

51 Ubi Ave 1 #01-25, Paya Ubi Industrial Park

Singapore 408933

Tel: 6256-3561 Fax: 6844-8805 Email: sur@lkkauto.com; assignments@lkkauto.com

To: MSIG Insurance (Singapore) Pte. Ltd.
4 Shenton Way
#21-01 SGX Centre 2
Singapore 068807

From: LKK Auto Consultants Pte Ltd
51 Ubi Ave 1 #01-25
Paya Ubi Industrial Park
Singapore 408933

Attn: Muhd Ashik B Madi

Date: 08 Oct 2019

Preliminary Advice

Insured Vehicle No	: SKE609M	Accident Date	: 29/09/2019
TP Vehicle No	: FBF3576E	Assignment Date	: 07/10/2019
Make	: HYUNDAI ELANTRA	Est. Duration of Repair	: 4.00
Date of Inspection	: 07/10/2019		
Inspection At	: EROFIA MOTOR TRADING PTE LTD (KAKI BUKIT) 1 KAKI BUKIT AVE 6 #02-62 SINGAPORE 417883		

Point of Impact / General Description of Damages

The vehicle sustained impact / damages front portion, o/s body and parts claimed are consistent to the accident.

Repairer's Estimate (Gross)	:S\$	5,489.10
Revised Amount	:S\$	1,438.50
Check Items (Estimated)	:S\$	1,096.20
Total	:S\$	2,534.70

Lump Sum Repair	:S\$	
-----------------	------	--

Total Loss Consideration

New for Old Value	:S\$
Pre-Accident Value	:S\$
COE / PARF Rebate	:S\$
Salvage Value	:S\$
Margin for Repair	:S\$

Remarks

- () The vehicle is economical/not economical for repair.
- (X) The above survey was conducted on a 'without prejudice' basis.

...CLAIM SUBFOLDER...(New Assignment)

CLAIM SUBFOLDER TRACKING

Case	Notified	Est Submitted	Adj Assigned	Adj Rpt	Adj Submitted	Ins Auth'd	Status
Main	02 Oct 2019		07 Oct 2019 10:46 Assign				New Assignment Cancel Case

Main	Reference	Claim Details	Documents	Show All
----------------------	---------------------------	-------------------------------	---------------------------	--------------------------

CLAIM SUBFOLDER DETAILS

[Created by insurer]

Insured:	SRINIVASAN SURESH KUMAR, ID: S7664573F		
Main Claimant:	MUHAMMAD SHALIHAN BIN OTHMAN, ID: S9615810F		
Vehicle Reg. No.:	FBF3576E	Date of Loss:	29/09/2019 18:00 - :59 [92 Months and 28 Days From LTA Reg Date (Man Yr)]
Claim Type:	TP	Policy/Cover Note No.:	1000890428 (Comprehensive) Coverage: 01/02/2019 - 01/02/2020
Vehicle Reg. No. (Insured):	SKE609M	Policy No. (Claimant):	
		Excess:	
Repairer:	Erofia Motor Trading Pte Ltd (KAKI BUKIT) 1 KAKI BUKIT AVE 6 #02-62, 417883 Kaki Bukit - Tel:		
Handling Insurer:	MSIG Insurance (Singapore) Pte. Ltd. (HQ) - Tel: +65 6827 7888 ... [Handled by Muhd Ashik B Madi - 6594 2548]		
Adjuster:	LKK Auto Consultants Pte Ltd (HQ) - Tel: 6256-3561 ... [Imm.Advice due 08/10/2019]		
Driver/Custodian (Insured):	SRINIVASAN SURESH KUMAR (), NRIC: S7664573F Email:		
Adj Asg. Remarks:	on WP, Manual assigned to LKK via email on 04/10/19. (Manual Assign). Car In, Liab: NA, Assign: LKK Auto Consultants Pte Ltd. Contact: Mr Teo @ 9069 6165.		

ASSOCIATED MAIL RECEIVED

[View All](#)

[Compose Case Mail](#)

There are no mail for this case.

ALL ASSOCIATED TASKS

[View All](#)

[Search Tasks](#)

[Create New Task](#)

[Complete](#)

Due Date	Priority	Type	Task Group	Subject	Handler	Assigned By	Completed On	Created On	Done?
----------	----------	------	------------	---------	---------	-------------	--------------	------------	-------

No results.

Nivitha (LKK Auto)

From: Crystal Lee <crystal_lee@sg.msig-asia.com>
Sent: Friday, 4 October 2019 5:24 PM
To: Admin-D (LKKAuto); assignments
Cc: Ong Zi Hui; Helene Phua; Winnie Chua
Subject: Survey Request - Manual Assigned
Attachments: 04102019172013.pdf

Accident Involving FBF3576E with SKE 609M on 29/09/2019

Manual Assigned

Dear LKK,

Refer to the email below, please arrange survey the vehicle.

We'll assign via Merimen once we receive the assignment from Motor Team.

Please contact us ASAP if you cannot attend this assignment

Thank you & Best regards,

Crystal Lee

Admin Officer, Claims Services (In-House Survey)

D: +65 6594 2535 | F: +65 6643 1349 | crystal_lee@sg.msig-asia.com



MSIG

MSIG Insurance (Singapore) Pte Ltd 16 Raffles Quay, #24-01 Hong Leong Building, Singapore 048581 | T: +65 6220

9644 | F: +65 6225 6371 | Co. Reg. No. 200412212G | msig.com.sg



A Member of **MS&AD** INSURANCE GROUP

CONFIDENTIALITY NOTICE

This e-mail (including any attachments) may contain information that is privileged or confidential. The sending of this e-mail to any person other than the intended recipient is not a waiver of the privilege or confidentiality that attaches to it. If you are not the intended recipient, please notify the sender immediately, delete the email and do not copy, distribute or disclose its contents.

Enquire Vehicle & Owner Information (Vehicle No. SKE609M As At 29 Sep 2019 / 00:00:00)**Law Firm Search Details**

Search Reason: Insurance claim in relation to traffic accident

Law Firm Case No.: NEW *FBF 3576 E***Current Owner Details**

Owner ID Type: Singapore NRIC

Owner ID: S7664573F

Owner Name: SRINIVASAN SURESH KUMAR

Registered Address Type: HDB / HUDC

Registered Block/House No.: 22

Registered Street Name: BUKIT BATOK STREET 52

Registered Unit No.: # 03 - 04

Registered Building Name: -

Registered Postal Code: 659245

Current Vehicle Details

Vehicle No.: SKE609M

Make Description/Model: HYUNDAI / ELANTRA 1.6 AT ABS D/AB 2WD 4DR

Insurance Company Name: MSIG INSURANCE (SINGAPORE) PTE LTD

REG / CS / PAY / FA

04 OCT 2019

EROFIA MOTOR TRADING PTE LTD**1 Kaki Bukit Avenue 6 #02-62****AutoBay @ Kaki Bukit****Singapore 417883****E-Mail: erofia@singnet.com.sg / erofia2@gmail.com****Tel: 67527740 Fax: 67528669****TO ARRANGE PRE-REPAIR SURVEY****BIKE IS IN / NOT IN WORKSHOP****TEL: 90696165 – MR TEO**

4/10/19 @ 5pm:
Mr TEO confirmed
bike in.

JS
4/10/19

[REPORT ERROR > \(/LISTING/LISTING/ERROR/USEDBIKE/14364/\)](#)[+ ADD TO SHORTLIST](#)[Like 0](#)[Share](#)[SHARE \(WHATSAPP://SEND?TEXT=HTTPS://WWW.SGBIKEMART.COM.SG/LISTING/USEDBIKE/YAMAHA-YAMAHA-FZ16/14364/\)](#)

Yamaha FZ16

Listing Type	Paid Ad
Brand	Yamaha (/listing/usedbike/brand/yamaha/)
Model	Yamaha FZ16 (/listing/usedbike/model/yamaha-fz16/)
Engine Capacity	153cc
Classification	Class 2B (/listing/usedbike/model/motorcycle-for-sale/class/class-2b/)
Registration Date	28/02/2012
COE Expiry Date	27/02/2022 (2 years 4 months left)
Mileage	-
No. of owners	1
Type of Vehicle	Street Bikes (/listing/usedbike/model/motorcycle-for-sale/street-bikes/)

Price: SGD\$4000

DETAILS

Yamaha FZ16 For Sale. Interested Parties Are Welcome To Neg. Trade/Loan Available. Do Visit Us At Wing Fuat @ Sims Place. No Early Settlement Fee.

Renew Your COE At Only 1.88% - Lowest Interest Rate in Sg

Flexible Repayment Options Up To 7 Years with Lowest Interest Rate. Talk To Us!
coefinancespecialist.com

[i](#) [x](#)[OPEN](#)

SIMILAR BIKES

[VIEW ALL \(/LISTING/USEDBIKES/LISTING/\)](#)

> **Back to OneMotoring**

Enquire PARF/COE Rebate for Registered Vehicle

Vehicle Owner Particulars	
Owner ID Type:	Singapore NRIC
Owner ID:	810F
Vehicle Details	
Vehicle No.:	FBF3576E
Vehicle to be Exported:	No
Intended Deregistration Date:	07 Oct 2019
Vehicle Make:	YAMAHA
Vehicle Model:	FZ 16
Primary Colour:	Black
Manufacturing Year:	2011
Engine No.:	21C5033780
Chassis No.:	ME121C054B2033868
Maximum Power Output:	-
Open Market Value:	\$1,967.00
Original Registration Date:	08 Jun 2011
First Registration Date:	08 Jun 2011
Transfer Count:	7
Actual ARF Paid:	\$296.00
Intended PARF Rebate Details	
PARF Eligibility:	No
PARF Eligibility Expiry Date:	-
PARF Rebate Amount:	\$0.00
Intended COE Rebate Details	
COE Expiry Date:	07 Jun 2021
COE Category:	D - Motorcycle
COE Period(Years):	10
QP Paid:	\$2,253.00
COE Rebate Amount:	\$375.00
Total Rebate Amount:	\$375.00

The information contained herein is correct as at 07 Oct 2019

OK

SINGAPORE ACCIDENT STATEMENT

IMPORTANT NOTICE

1. Please report correctly the details of the accident to speed up the claims process.
2. This Form must be completed by the Policyholder and/or the Authorised Driver.
3. Information provided must be as truthful and accurate as possible. Any wilful misrepresentation or withholding of material facts may allow insurance companies to repudiate policy liability.
4. The issue and acceptance of this Form by insurance companies is not an admission of policy liability on the part of the insurance companies.
5. Any false reporting may be referred to the Police for investigation.
6. This report will be forwarded by the insurers of the GIA Records Management Centre established by the General Insurance Association of Singapore (GIA) for archiving and that copies of this report will, for a fee, be made available upon application by interested parties.
7. By the lodgement of this report to the insurers, you hereby consent to the archiving of this report at the centre and to copies of the report being made available aforesaid.

ACCIDENT STATEMENT

Date Of Report	30/09/2019 14:52
Date Of Accident	29/09/2019 18:40
Exact Location Of Accident	TAMPINES ST 22 BLK 288 OPEN CARPARK
Country/State of Loss	SINGAPORE

DETAILS OF OWN VEHICLE

Vehicle Registration Number	FBF3576E
Insured/Policyholder	
Name Of Registered Owner	MUHAMMAD SHALIHAN BIN OTHMAN
NRIC No	S9615810F
Email Address	NOEMAIL
Mobile Phone No	(LOCAL) +65-90302061
Alternative Phone No	OTHERS-90302061

Vehicle Particulars

Manufacturer	YAMAHA
Model	FZ 16
Exact Purpose for which vehicle was being used at time of accident	PERSONAL USE
Are you claiming under your own insurance policy for repair to your vehicle?	NO
If No, Please state action to be taken	THIRD PARTY
Vehicle Category	MOTORCYCLE

Insurance Company

Name of Insurance Company	NTUC INCOME INSURANCE CO-OPERATIVE LTD
Type Of Coverage	THIRD PARTY FIRE AND/OR THEFT
Fleet Policy	NO
Policy Number	5107159503
Cover Note Number	21/01/2019-07/12/2019

Driver

Name of Driver	MUHAMMAD SHALIHAN BIN OTHMAN
NRIC No	S9615810F
Date Of Birth	11/05/1996
Occupation	INDOOR
Date Of Driving Pass	17/01/2019
Driving Experience	0 YEAR AND 8 MONTH
Gender	MALE
Mobile Number	(LOCAL) +65-90302061
Fax Number	
Contact Number	OTHERS-90302061
Email Address	NOEMAIL

Address	BLK 290 TAMPINES ST 22 #03-400
Postcode	520290
Was driver an employee of the Insured's Company	NO
If No, Relationship of the Driver with the Insured	OWNER
Vehicle Registration Number of Driver's Own Vehicle	-
	-
Insurance Company of Driver's Own Vehicle	-
	-
	-

General Information of the Accident

Type Of Accident	COLLISION - HEAD TO REAR
Weather Conditions	CLEAR
Road Surface	WET

Other Information

Was any foreign vehicle involved in this accident?	NO
Number of vehicles (including own vehicle) involved in the accident	2
Was any body injured in the Accident?	NO
Was any injured conveyed to hospital by ambulance?	NO
Was any other material or property damaged?	YES
I have been approached by unknown person(s) soliciting/offering accident claims assistance.	NO
Number of Passengers (Including Driver)	1

Details of Police Action

Was the accident reported to the police?	NO
If Yes, Please state which Police Station	
Was notice of intended Prosecution given?	NO
If Yes, against whom?	

Circumstances of Accident

ON THE STATED DATE & TIME, I WAS DRIVING ALONG THE OPEN CARPARK AT TAMPINES ST 22 BLK 288. VEHICLE B IN FRONT OF ME SUDDENLY REVERSE AND COLLIDED WITH MY BIKE. THERE WERE NO INJURIES INVOLVED. 1 PAX ON VEHICLE A AND 1 PAX ON VEHICLE B.

Attachment(s)

Are accident photos available for attachment?	YES
Was there any video captured by Car Camera?	NO
Was there any audio recorded?	NO

DETAILS OF OTHER VEHICLE PROPERTY 1

Vehicle Registration Number	SKE609M
Vehicle Make/Model/Colour	
Details Of Properties	
Vehicle Category	PRIVATE CAR
Name of Driver	
NRIC/Passport Number	
Contact Number	
Address	
Postcode	
Insurance Company Name	
Nature Of Damage	
No. Of Passenger (Including Driver)	

Sketch Plan

SKETCH PLAN

IMPORTANT NOTICE

1. Please report **correctly** the details of the accident to speed up the claims process.
2. This Form must be **completed by the Policyholder and/or the Authorised Driver**.
3. Information provided must be as **truthful and accurate as possible**. Any wilful misrepresentation or withholding of material facts may allow insurance companies to **repudiate policy liability**.
4. The issue and acceptance of this Form by insurance companies is not an admission of policy liability on the part of the insurance companies.
5. **Any false reporting may be referred to the Police for investigation.**
6. The report will be forwarded by the insurers of the GIA Records Management Centre established by the General Insurance Association of Singapore (GIA) for archiving and that copies of this report will for a fee be made available upon application by interested parties.
7. By the lodgment of this report to the insurers, you hereby consent to the archiving of this report at the centre and to copies of the report being made available aforesaid.
8. **Consent under the Personal Data Protection Act (PDPA)**

I understand, acknowledge, agree and consent that:

- (a) My insurer, my workshop and the General Insurance Association of Singapore ("GIA") may/are permitted to collect, use, disclose and/or process my personal data/personal information set out in this [form] and any other personal information provided by me or possessed by my insurer (collectively the "Personal Information") and disclose and transfer such Personal Information to all insurer(s) who have insured vehicle(s) involved in this accident (all insurer(s) who have insured vehicle(s) involved in this accident shall be collectively referred to as the "Insurers"), the Insurers' lawyers/law firms, the Monetary Authority of Singapore and any relevant government agency/authority (such as the police), for the purpose(s) of:
 - (i) processing, handling and/or dealing with my claims including the settlement of the claims and any necessary investigations relating to the claims;
 - (ii) investigating the accident and/or my claims;
 - (iii) carrying out and/or dealing with my instructions or responding to any enquiries by me;
 - (iv) administering my claims (including the mailing of correspondence, statements, invoices, reports or notices to me, which could involve disclosure of certain personal data about me to bring about delivery of the same as well as on the external cover of envelopes/mail packages); and/or
 - (v) complying with applicable law in administering, processing, handling and/or dealing with my claims (collectively the "Purposes")
- (b) all insurer(s) who have insured vehicle(s) involved in this accident and the Insurers' lawyers/law firms, may/are permitted to collect, use, disclose and/or process my Personal Information for one or more of the above Purposes; and
- (c) my Personal Information may/can be disclosed by any of the Insurers and/or GIA to their third party service providers or agents (including their lawyers/law firms), which may be sited outside of Singapore, for one or more of the above Purposes.
- (d) my Personal Information will also be collected and used to compile claims history for the purpose of fraud detection, investigation and management in present and all future claims.
- (e) the information so collected under (d) above may be shared / disclosed:
 - (i) to all insurers and/or any other third parties that assist in evaluating, investigating, controlling or managing fraud, regulators, law enforcement and government agencies as reasonably required for the purposes stated, or
 - (ii) for complying with requirements under any regulations, laws or court orders.

Policyholder's Signature

Date & Time: 30/09/19

15:04

Driver's Signature

(If driver is not the policyholder)

Date & Time:

Reporting Centre Personnel's Signature

Name:

NRIC/FIN No.:

Sketch Plan #2

SKETCH PLAN

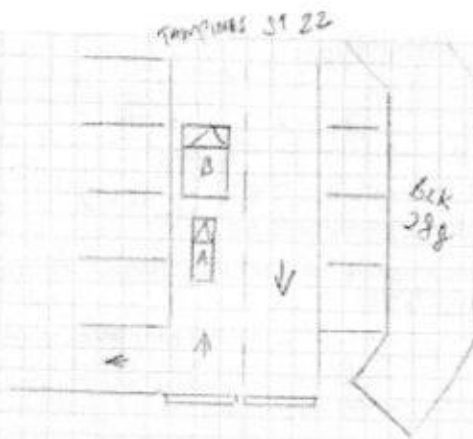

A: F8F3576E
B: SKE609M

DESCRIBE CIRCUMSTANCES OF THE ACCIDENT

REFER TO GIA REPORT

DECLARATION

(We declare the foregoing particulars are true in every respect.)

Policyholder's Signature

Date & Time: 30/09/19
15:09

Driver's Signature

(If driver is not the policyholder)

Date & Time:

Reporting Centre Personnel's Signature

Name:

NRIC/FIN No.:



SINGAPORE POLICE FORCE



T/20191001/2048

1 of 4

Police Station Of Origin:
Marine Parade N.P.C
300 Marine Parade Road SINGAPORE
449296
Tel No: 1800-4428999

Report No. T/20191001/2048

REPORT OF A TRAFFIC ACCIDENT

Date/Time Report Made: 01/10/2019 11:42		Vide Report No.:		Station Diary No.: 32	
Informant's Particulars					
Name of Informant: MUHAMMAD SHALIHAN BIN OTHMAN			Address: APT BLK 290 TAMPINES STREET 22 #03-400 SINGAPORE 520290		
ID Type / ID No.: NRIC NO / S9615810F			Contact No.: Home/Office: Mobile: 90302061		
Nationality: SINGAPORE CITIZEN			Email:		
Sex: Male	Age: 23	Date of Birth: 11/05/1996	Type of Informant: Rider		
Race: Malay			Language: English		Institution / School Name:
Occupation: Student			Driving Licence Information: Class: 2B,3A Date of Expiry:		

General Information of the Accident

Type of Accident:	Injury Others	Drink Drive: No	Date/Time of Accident: 29/09/2019 18:40	Type of Location: Car Park
Location: Along Road 1 TAMPINES STREET 22				
Opened Spaced Car Park of B/288 Tampines st 22				
Weather: Cloudy		Road Surface: Wet		Road Speed Limit:
Traffic Flow: Two Way		Traffic Control: Not Controlled		Traffic Volume: Light
Type of Collision: Between Moving Vehicles - Head To Rear				Anyone conveyed by ambulance: No

Details of Vehicle Involved

Vehicle No.	Type	Make	Model	Color	Condition	No of Passenger
FBF3576E	Motorcycle	YAMAHA	FZ 16	Green	Slightly Damaged	0
SKE609M	Car	HYUNDAI	ELANTRA 1.6 AT ABS D/AB 2WD 4DR	Silver	Slightly Damaged	0

Details of Vehicle Insurance

Vehicle No.	Insurance Company	Insurance No	Effective	Expiry Date
-------------	-------------------	--------------	-----------	-------------



**SINGAPORE
POLICE FORCE**



T/20191001/2048

Police Station Of Origin:
Marine Parade N.P.C
300 Marine Parade Road SINGAPORE
449296
Tel No: 1800-4428999

2 of 4

Report No. T/20191001/2048

CONTINUATION OF REPORT

Details of Vehicle Insurance				
Vehicle No.	Insurance Company	Insurance No	Effective	Expiry Date
FBF3576E	NTUC Income Insurance Co-Operative Limited	5107159503	21/01/2019	07/12/2019

Details of Person Involved				
Any Pedestrian Involved: No				
No. of Pedestrians Injured: NIL			Use of Pedestrian Crossing: NA	
Rider				
Name	MUHAMMAD SHALIHAN BIN OTHMAN		ID No.	S9615810F
Related Vehicle	FBF3576E (Motorcycle)		Contact No.	90302061
Hospital/Clinic	INSYNC MEDICAL		Class of Driving Licence & Expiry Date	Class: 2B,3A Date of Expiry: NIL
Date Treatment	NIL		Date Discharge	NIL
No. of Days granted Medical Leave	04		Degree of Injury	NIL
Driver				
Name	SRINIVASAN SURESH KUMAR		ID No.	S7664573F
Related Vehicle	SKE609M (Car)		Contact No.	NIL
Hospital/Clinic	NIL		Class of Driving Licence & Expiry Date	Class: NIL Date of Expiry: NIL
Date Treatment	NIL		Date Discharge	NIL
No. of Days granted Medical Leave	NIL		Degree of Injury	NIL

Brief Details.

On 29/09/2019 at about 1840hrs, I was at the carpark and there was a vehicle in front of me bearing plate number SKE609M. I observed that the vehicle in front me starting to reverse. I started to honk at the driver. However, the driver still continue to reverse and collided into my vehicle. Both of our vehicle were damaged.

I would like to state that I suffered some pain my back. I went to see a doctor at Insync Medical and was given 4 days MC. There were no camera on my bike.

There was a witness at the point of time however I did not took down his particulars. The witness name is Muhammad Kidir Bn Abdul Wahab and his contact number is 90678924.



**SINGAPORE
POLICE FORCE**



T/20191001/2048

3 of 4

Police Station Of Origin:
Marine Parade N.P.C
300 Marine Parade Road SINGAPORE
449296
Tel No: 1800-4428999

Report No. T/20191001/2048

CONTINUATION OF REPORT



**SINGAPORE
POLICE FORCE**



T/20191001/2048

4 of 4

Police Station Of Origin:
Marine Parade N.P.C
300 Marine Parade Road SINGAPORE
449296
Tel No: 1800-4428999

Report No: T/20191001/2048

CONTINUATION OF REPORT

Sketch Plan

Informant is not able to provide sketch plan

IMPORTANT: Please attach a copy of your vehicle's Insurance Certificate to this report. If you don't have the certificate with you now, please fax a copy to 65474885 stating the report number as reference.

Signature Of Officer Recording The Report:

G /

Staff Sgt MOHAMMAD FADIL BIN JAMIL

Signature Of Interpreter:

Not applicable

Officer In Charge Of Case:

TP / AEIT /

Sr Staff Sgt ONG YONG HOCK

Contact No.: 65476436

Signature Of Informant:

Date/Time:

01/10/2019 11:42

Classification Of Case:

Authentication Stamp
NP168



**SINGAPORE
POLICE FORCE**

Certificate of Insurance

MOTOR VEHICLES (THIRD PARTY RISKS AND COMPENSATION) ACT (CHAPTER 189)
MOTOR VEHICLES (THIRD PARTY RISKS AND COMPENSATION) RULES, 1960
ROAD TRANSPORT ACT, 1987 (MALAYSIA)
MOTOR VEHICLES (THIRD PARTY RISKS) RULES, 1959 (MALAYSIA)

Certificate Number : 5107159503

Cover : Third Party, Fire & Theft

- | | |
|-----------------------------------------------------|--------------------------------|
| 1. Index mark and Registration Number of Vehicle | : FBF3576E |
| Chassis Number | : ME121C054B2033868 |
| 2. Name of Policyholder | : MUHAMMAD SHALIHAN BIN OTHMAN |
| 3. Effective Date of Insurance | : 21 Jan 2019 |
| 4. Expiry Date of Insurance | : 07 Dec 2019 |
| 5. Persons or Classes of Persons entitled to drive# | |
| (a) Named Driver(s) Only. | |

Provided that the person driving is permitted in accordance with the licensing or other laws or regulations to drive the Motor Vehicle or has been so permitted and is not disqualified by order of a Court of Law or by reason of any enactment or regulation in that behalf from driving the Motor Vehicle.

6. Limitations as to Use#

- (a) Use for social domestic and pleasure purposes and in connection with the Policyholder's business or profession.

This Policy does not cover

- (a) Use for hire or reward.
(b) Use for racing, pace-making, reliability trial or speed-testing.
(c) Use for the carriage of goods (other than samples) in connection with any trade or business.
(d) Use for any purpose in connection with the Motor Trade.

Limitations rendered inoperative by Section 8 of the Motor Vehicle (Third Party Risks and Compensation) Act (Chapter 189) and Section 95 of the Road Transport Act, 1987 (Malaysia), are not to be included under these headings.

EXCESS (SECTION 1)	: N/A
EXCESS (SECTION 2)	: N/A
EXCESS (THEFT OUTSIDE SINGAPORE)	: PLEASE REFER OVERLEAF
INSURE WITH COE	: YES
NAMED DRIVER (1)	: MUHAMMAD SHALIHAN BIN OTHMAN
NAMED DRIVER (2)	: MUHAMMAD SHALIHIN BIN OTHMAN
HIRE PURCHASE COMPANY	: N/A
SUM INSURED	: MARKET VALUE OF INSURED VEHICLE AT TIME OF LOSS

I/We hereby Certify that the Policy to which this Certificate relates is issued in accordance with the provisions of the Motor Vehicles (Third Party Risks and Compensation) Act (Chapter 189) and Part IV of the Road Transport Act, 1987 (Malaysia)

Agency : TELESALLES-DIRECT MARKETING (00000601661)
Date of Issue : 21 Jan 2019 12:29 hrs

For NTUC INCOME INSURANCE CO-OPERATIVE LIMITED

Countersigned By:



Authorised Officer



Chief Executive

EROFIA MOTOR TRADING PTE LTD

No 1 Kaki Bukit Avenue 6 #02-62 AutoBay @ Kaki Bukit Singapore 417883

Tel : 67527740 Fax : 67528669

Co. Reg No. 201202259N

MSIG

Owner : Muhammad Shalihan Bin Othman

Accident Date : 29-Sep-19

Vehicle No : FBF 3576 E

Vehicle Model : Yamaha FZ16

Estimated Repair Costs

Qty	Description	Amount S(\$)
	<u>List Items</u>	
1	Front fender	\$ CNE 70.00 ✓
2	Fork inner tubes	\$ 0/5 set 440.00 P.C
2	Fork outer tubes	\$ 0/5 M 460.00 PC
1	Fork under bracket	\$ 3rd 245.00 ✓
1	Front sport rim	\$ R 450.00 X
1	Front brake disc	\$ 11 155.00 ✓
1	Front rim shaft	\$ 3rd 45.00 ✓
1	Front rim bearing	\$ 11 38.00 X
1	Side mirror (1 set)	\$ SN 120.00 X
1	Handle-bar	\$ 3rd 135.00 ✓
2	Handle-bar balancers	\$ SUR 56.00 1/c
1	Hand-grip (1 set)	\$ R 60.00 ✓
1	Clutch lever	\$ SVE 35.00 X
1	Brake lever	\$ SER 35.00 ✓
2	Front signals	\$ SN 100.00 X
1	Front footrest	\$ SN 38.00 X
1	Front footrest bracket	\$ 11 90.00 X
1	Brake pedal	\$ SN 45.00 X
1	Rear footrest	\$ C11 42.00 ✓
1	Rear signal	\$ 11 50.00 X
1	Exhaust protector	\$ SER 65.00 ✓
1	Rear fender	\$ M 85.00 X
1	Radiator side cover	\$ SCR 80.00 ✓
		\$ 2,939.00
	Less 10%	\$ 293.90
		\$ 2,645.10

Not Authorized
Date

7/10/19
take photo after repair
4 day.

1/5 \$1500

LKK Auto Consultants hereby notify the Repairer of the following:

- To re-survey before/after spray painting
- To display damaged part(s) during re-survey
- Parts prices are subject to confirmation
- Third party survey is on a "Without Prejudice" basis
- No illegal modification(s) is allowed
- Supplementary item(s) must be re-surveyed and is subject to final approval from Insurance Company

Acknowledged by Repairer
Signature:
Date:

P-1255

c/f: \$ 2,645.10

Special Nett Items

1	Number plate (1 set)	\$ 11	28.00	✓
2	Fork oils	\$ rec	30.00	✓ s.d
2	Fork oil seals	\$ rec	56.00	1pc
1	Steering cone (1 set)	\$ rec	95.00	✓
1	Rear box	\$ gnd	180.00	✓
1	Rear box bracket	\$ 11	100.00	✓
1	Fork slider (1 set)	\$ can	95.00	✓
1	"YOSHIMURA" exhaust pipe	\$	1,650.00	✓
1	Side slider (1 set)	\$ can	100.00	✓
		\$	<u>2,334.00</u>	

<u>S/No.</u>	<u>Labour</u>		
1	To provide towing service.	\$ 35	50.00
2	To check wiring and reset headlamp focusing	\$ 11x	80.00
3	To provide labour.	\$ 220	380.00
		\$	<u>510.00</u>

Grand Total \$ 5,489.10

1797.5

EROFIA MOTOR TRADING PTE LTD

LKK Auto Consultants Pte Ltd (Co.Reg.No:199607198R)

51 Ubi Ave 1 #01-25, Paya Ubi Industrial Park

Singapore 408933

Tel: 6256-3561 Fax: 6844-8805 Email: sur@lkkauto.com;assignments@lkkauto.com

VEHICLE DAMAGE INSPECTION REPORT

Our File No: CS/MSG19017575/UQD3N2

Date: 11/10/2019

REFERENCE

Handling Insurer:	MSIG Insurance (Singapore) Pte. Ltd.	Policy No:	1000890428
Claimant Vehicle No :	FBF3576E	Insured Vehicle No :	SKE609M
Date of Loss:	29/09/2019	Nature of Claim:	TP
		Claim No:	231709

DESCRIPTION & IDENTIFICATION OF VEHICLE

Reg No:	FBF3576E	Engine No:	21C5033780
Make & Model:	YAMAHA FZ16, 153cc (M)	Chassis No:	ME121C054B2033868
Reg. Date:	08/06/2011 (Man. Year: 2011)	Odometer:	33033 km
Colour:	Green		
Engine Capacity:	153 cc		
Market Value/New Car Price:	N/A		
Sum Insured (S\$):	Market Value/New Car Price		

CONDITION OF VEHICLE AT THE TIME OF SURVEY

General Condition:	Steering (Serviceable):	Yes	Footbrake (Serviceable):	Yes
Handbrake (Serviceable):	Yes	Engine Modification:	No	Pre-accident Condition:

CONDITION OF TYRES

Front Tyre Size:	110-70-17	Rear Tyre Size:	140-70 R17
Front Left Side:	Bridgestone 6 mm	Rear Left Side:	Bridgestone 6 mm
Front Right Side:	0 mm	Rear Right Side:	0 mm

The above values represent the remaining tyre treads depth

COST OF CLAIMS

	Repairer's	Adjuster's	Difference	Diff %
Parts	4,979.10	1,642.50	3,336.60	67.01
Miscellaneous Items	0.00	0.00	0.00	
Labour	510.00	255.00	255.00	50.00
Paintwork Labour	0.00	0.00	0.00	
Towing	0.00	0.00	0.00	
Calculated Gross Total (S\$)	5,489.10	1,897.50	3,591.60	65.43
Approved Total (Overridden) (S\$)		1,500.00		
Nett Amount (S\$)	5,489.10	1,500.00	3,989.10	72.67

INSPECTION

Date of Assignment: 07/10/2019

Date Inspected: 07/10/2019 Inspected At:

Erofia Motor Trading Pte Ltd (KAKI BUKIT)
1 KAKI BUKIT AVE 6 #02-62
Singapore 417883

Estimated Period of Repair: 4.0 days

Adjuster: MARCUS CHUA

Manager: SHIAU CHAN

NOTE: This report represents our findings at the time and place of inspection stated herein. Such inspection has been carried out to the best of our knowledge and ability but any other liability under any other circumstances is hereby expressly excluded.

REPAIR DETAILS

Reference		
Part Source:	(Last Synchronised: 11 Oct 2019)	
Parts:	N/A	YAMAHA FZ16 153cc (M) (Model not available in database)
Labour:	Repairer's	(Price-denominated Standard List)
Print Code:	(Unsubmitted, no print-code for FBF3576E)	
Validity:	These estimates are valid only if they contain the print code (above) on all estimate pages, running page numbers with the END OF ESTIMATES marker on the last estimate page	
Further Info:	Items/values not in reference catalogue are prefixed with an asterisk *.	

Recommended Parts

No.	Qty	Part No.	Particulars	Condition	Repairer's	Amount
1	1		*FRONT FENDER	Cracked	70.00 FL	*70.00 FL
2	1		*FORK INNER TUBES	O/s Bent	440.00 FL	*220.00 FL
3	1		*FORK OUTER TUBES	O/s Dented	460.00 FL	*230.00 FL
4	1		*FORK UNDER BRACKET	Bent	245.00 FL	*245.00 FL
5	1		*FRONT SPORT RIM	Repair	450.00 FL	*- FL
6	1		*FRONT BRAKE DISC	Not Necessary	155.00 FL	*- FL
7	1		*FRONT RIM SHAFT	Bent	45.00 FL	*45.00 FL
8	1		*FRONT RIM BEARING	Not Necessary	38.00 FL	*- FL
9	1		*SET SIDE MIRROR	Serviceable	120.00 FL	*- FL
10	1		*HANDLE-BAR	Bent	135.00 FL	*135.00 FL
11	1		*SET HAND-GRIP	Necessary	60.00 FL	*60.00 FL
12	1		*HANDLE-BAR BALANCERS (2 Pcs)	Scratched (1 Pc only)	56.00 FL	*28.00 FL
13	1		*CLUTCH LEVER	Serviceable	35.00 FL	*- FL
14	1		*BRAKE LEVER	Scratched	35.00 FL	*35.00 FL
15	2		*FRONT SIGNALS	Serviceable	100.00 FL	*- FL
16	1		*FRONT FOOTREST	Serviceable	38.00 FL	*- FL
17	1		*FRONT FOOTREST BRACKET	Not Necessary	90.00 FL	*- FL
18	1		*BRAKE PEDAL	Serviceable	45.00 FL	*- FL
19	1		*REAR FOOTREST	Cut	42.00 FL	*42.00 FL
20	1		*REAR SIGNAL	Not Necessary	50.00 FL	*- FL
21	1		*EXHAUST PROTECTOR	Scratched	65.00 FL	*65.00 FL
22	1		*REAR FENDER	Not Necessary	85.00 FL	*- FL
23	1		*RADIATOR SIDE COVER	Scratched	80.00 FL	*80.00 FL
24	1		*SET NUMBER PLATE	Not Necessary	28.00 FS	*- FS
25	1		*FORK OILS (2 Pcs)	Necessary (1 Side only)	30.00 FS	*15.00 FS
26	1		*FORK OIL SEALS (2 Pcs)	Necessary (1 Pc only)	56.00 FS	*28.00 FS
27	1		*SET STEERING CONE	Necessary	95.00 FS	*95.00 FS
28	1		*REAR BOX	Grazed	180.00 FS	*180.00 FS
29	1		*REAR BOX BRACKET	Not Necessary	100.00 FS	*- FS
30	1		*SET FORK SLIDER	Cut	95.00 FS	*95.00 FS
31	1		*YOSHIMURA EXHAUST PIPE	Repair	1,650.00 FS	*- FS
32	1		*SET SIDE SLIDER	Cut	100.00 FS	*100.00 FS

F=Franchise part. S=SpcNett. L=ListItemDisc.

Sub Total (\$\$)	5,273.00	1,768.00
- List Item Discount on L Items 10.00/10.00% (\$\$)	293.90	125.50
Total Parts (\$\$)	4,979.10	1,642.50

Report was unsubmitted during this print-out.

Recommended Miscellaneous Items

There are no new miscellaneous items selected.

Recommended Labour

No	Particulars	Lab.Type	Repairer's	Amount
Labour Items				
1	TO PROVIDE TOWING SERVICE	New	50.00	35.00
2	TO CHECK WIRING AND RESET HEADLAMP FOCUSING	New	80.00	0.00
3	TO PROVIDE LABOUR	New	380.00	220.00
Gross Labour Cost (\$\$)			510.00	255.00

Report was unsubmitted during this print-out.

< END OF ESTIMATES >