

SINGAPORE ACCIDENT STATEMENT

IMPORTANT NOTICE

1. Please report correctly the details of the accident to speed up the claims process.
2. This Form must be completed by the Policyholder and/or the Authorised Driver.
3. Information provided must be as truthful and accurate as possible. Any wilful misrepresentation or withholding of material facts may allow insurance companies to repudiate policy liability.
4. The issue and acceptance of this Form by insurance companies is not an admission of policy liability on the part of the insurance companies.
5. **Any false reporting may be referred to the Police for investigation.**
6. This report will be forwarded by the insurers of the GIA Records Management Centre established by the General Insurance Association of Singapore (GIA) for archiving and that copies of this report will, for a fee, be made available upon application by interested parties.
7. By the lodgement of this report to the insurers, you hereby consent to the archiving of this report at the centre and to copies of the report being made available aforesaid.

ACCIDENT STATEMENT

Date Of Report	26/09/2019 14:05
Date Of Accident	25/09/2019 13:30
Exact Location Of Accident	JUNCTION BETWEEN TAI HWAN HEIGHTS & JALAN PACHELI
Country/State of Loss	SINGAPORE

DETAILS OF OWN VEHICLE

Vehicle Registration Number	SLZ7916H
Insured/Policyholder	
Name Of Registered Owner	HOO SHU YEE
NRIC No	S7046220F
Email Address	SHUYEE_SG@YAHOO.COM
Mobile Phone No	(LOCAL) +65-92984563
Alternative Phone No	Office-NOPHONE

Vehicle Particulars

Manufacturer	SUBARU
Model	XV-1.6 I-S AWD CVT (A)
Exact Purpose for which vehicle was being used at time of accident	PERSONAL/LEISURE
Are you claiming under your own insurance policy for repair to your vehicle?	NO
If No, Please state action to be taken	REPORTING ONLY
Vehicle Category	PRIVATE CAR

Insurance Company

Name of Insurance Company	AIG ASIA PACIFIC INSURANCE PTE. LTD.
Type Of Coverage	COMPREHENSIVE
Fleet Policy	NO
Policy Number	1800056018
Cover Note Number	

Driver

Name of Driver	HOO SHU YEE
NRIC No	S7046220F
Date Of Birth	20/12/1970
Occupation	INDOOR
Date Of Driving Pass	13/03/1995
Driving Experience	24 YEARS AND 6 MONTHS

Gender	FEMALE
Mobile Number	(LOCAL) +65-92984563
Fax Number	
Contact Number	OFFICE-NOPHONE
EEmail Address	SHUYEE_SG@YAHOO.COM
Address	12 CHUAN CLOSE
Postcode	554887
Was driver an employee of the Insured's Company	NO
If No, Relationship of the Driver with the Insured	OWNER
Vehicle Registration Number of Driver's Own Vehicle	-
	-
	-
Insurance Company of Driver's Own Vehicle	-
	-
	-

General Information of the Accident

Type Of Accident	COLLISION - HEAD TO REAR
Weather Conditions	RAINING
Road Surface	WET

Other Information

Was any foreign vehicle involved in this accident?	NO
Number of vehicles (including own vehicle) involved in the accident	2
Was any body injured in the Accident?	NO
Was any injured conveyed to hospital by ambulance?	NO
Was any other material or property damaged?	YES
I have been approached by unknown person(s) soliciting/offering accident claims assistance.	NO
Number of Passengers (Including Driver)	1

Details of Police Action

Was the accident reported to the police?	NO
If Yes,Please state which Police Station	
Was notice of intended Prosecution given?	NO
If Yes,against whom?	

Circumstances of Accident

PLEASE REFER ATTACHED - REVERSE INTO VEH B

Attachment(s)

Are accident photos available for attachment?	YES
Was there any video captured by Car Camera?	NO
Was there any audio recorded?	NO

DETAILS OF OTHER VEHICLE PROPERTY 1

Vehicle Registration Number	SJV7544S
Vehicle Make/Model/Colour	SUBARU
Details Of Properties	FRONT PORTION
Vehicle Category	PRIVATE CAR
Name of Driver	
NRIC/Passport Number	
Contact Number	90906110

Address

Postcode

Insurance Company Name

Nature Of Damage

No. Of Passenger (Including Driver)

Accident Sketch Plan

SKETCH PLAN

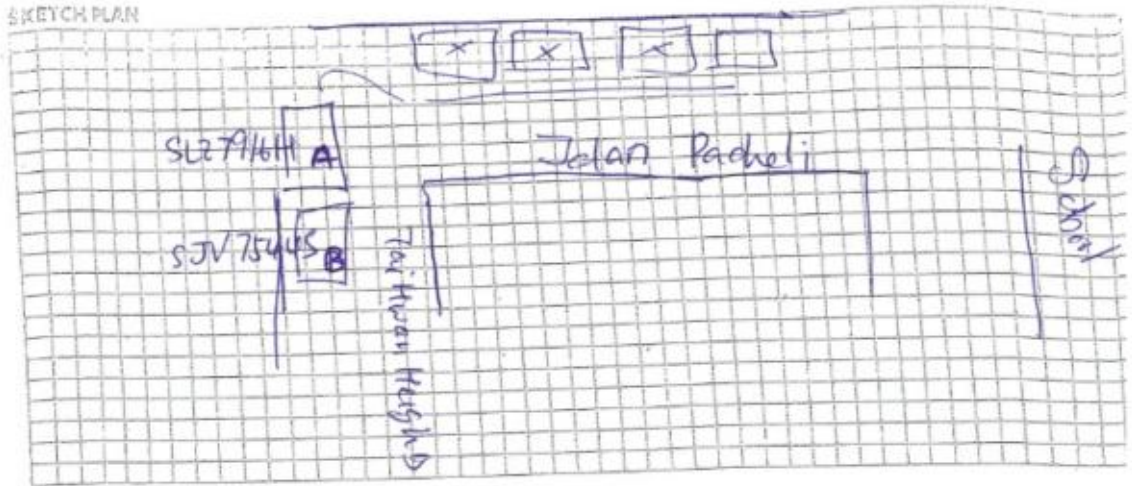

DESCRIBE CIRCUMSTANCES OF THE ACCIDENT

On 25 sept 2019 around 1:30pm, I was driving the vehicle SL27916H along Liluyan Heights and turning into Jalan Pacheli.

As there were many cars parked along the left side of Jalan Pacheli, I suppose parents waiting to pick up their kids from CHIJ OEGC, I attempted to manoeuvre the car a little before turning right.

The car (SJV7544S) behind was too close and my car brushed against it, causing some paint to come off. Visibility was poor and the car behind was too close.

DECLARATION

I/We declare the foregoing particulars are true in every respect.

 Policyholder's Signature
 Date & Time: 26/9

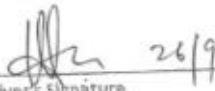
 Driver's Signature
 (if driver is not the policyholder)
 Date & Time: 26/9

 Reporting Centre Personnel's Sign
 Name:
 NRIC/FIN No.:

6IAAMC SketchPlanForm_V3

SKETCH PLAN

IMPORTANT NOTICE

1. Please report correctly the details of the accident to speed up the claims process.
2. This Form must be completed by the Policyholder and/or the Authorised Driver.
3. Information provided must be as truthful and accurate as possible. Any wilful misrepresentation or withholding of material facts may allow insurance companies to repudiate policy liability.
4. The issue and acceptance of this Form by insurance companies is not an admission of policy liability on the part of the insurance companies.
5. Any false reports may be referred to the Police for investigation.
6. The report will be forwarded by the Insurers of the GIA Records Management Centre established by the General Insurance Association of Singapore (GIA) for archiving and that copies of this report will for a fee be made available upon application by interested parties.
7. By the lodgment of this report to the Insurers, you hereby consent to the archiving of this report at the centre and to copies of the report being made available elsewhere.
8. Consent under the Personal Data Protection Act (PDPA)

I understand, acknowledge, agree and consent that:

- (a) My insurer, my workshop and the General Insurance Association of Singapore ("GIA") may/are permitted to collect, use, disclose and/or process my personal data/personal information set out in this [form] and any other personal information provided by me or possessed by my insurer (collectively the "Personal Information") and disclose and transfer such Personal Information to all insurer(s) who have insured vehicle(s) involved in this accident (all insurer(s) who have insured vehicle(s) involved in this accident shall be collectively referred to as the "Insurers"), the insurers' lawyers/law firms, the Monetary Authority of Singapore and any relevant government agency/authority (such as the police), for the purpose(s) of:
 - (i) processing, handling and/or dealing with my claims including the settlement of the claims and any necessary investigations relating to the claims;
 - (ii) investigating the accident and/or my claims;
 - (iii) carrying out and/or dealing with my instructions or responding to any enquiries by me;
 - (iv) administering my claims (including the mailing of correspondence, statements, invoices, reports or notices to me, which could involve disclosure of certain personal data about me to bring about delivery of the same as well as on external cover of envelopes/mail packages); and/or
 - (v) complying with applicable law in administering, processing, handling and/or dealing with my claims. (collectively the "Purposes")
- (b) all insurer(s) who have insured vehicle(s) involved in this accident and the Insurers' lawyers/law firms, may/are permitted to collect, use, disclose and/or process my Personal Information for one or more of the above Purposes; and
- (c) my Personal Information may/can be disclosed by any of the insurers and/or GIA to their third party service provider agents (including their lawyers/law firms), which may be sited outside of Singapore, for one or more of the above Purposes;
- (d) my Personal Information will also be collected and used to compile claims history for the purpose of fraud detection investigation and management in present and all future claims.
- (e) the information so collected under (d) above may be shared / disclosed:
 - (i) to all insurers and/or any other third parties that assist in evaluating, investigating, controlling or managing fraud; regulators, law enforcement and government agencies as reasonably required for the purposes stated, or
 - (ii) for complying with requirements under any regulations, laws or court orders.

Policyholder's Signature
Date & Time: 26/9/19

Driver's Signature
(If driver is not the policyholder)
Date & Time: 26/9/19

Reporting Centre Personnel's Signature
Name:
NRIC/FIN No.:



YOU ARE LICENSED TO DRIVE VEHICLES IN THE FOLLOWING CLASSES

Class	Description	PASS DATE
Class 3	Motor Cars and Motor Tractors the weight of which unladen does not exceed 2500 kilograms	13 Mar 1995

NP 428A



INSURANCE CERT



CERTIFICATE OF INSURANCE

SUBARU AUTO PROTECTOR PRIVATE VEHICLE

Name of Policyholder : Hoo Shu Yee
Period of Insurance : 18 May 2019 To 17 May 2020
Engine No. : FB20YC65313
Chassis No. : JF1GT7KL5JG030332

Vehicle No. : SLZ7916H
Policy No. : 1800056018-01
Endorsement No. :
Issued Date : 05 Apr 2019

ABOUT THE COVER

Make/Model : SUBARU XV 2.0I-S EYESIGHT AWD CVT
Engine Capacity/Tonnage : 1,995.00 CC **Sum Insured** : Market Value **First Year of Registration** : 2018
Driver Restriction : NA **Off Peak Car** : No **Insuring with COE/PARF** : Yes
Person or Classes of Persons Entitled to Drive* :

a) The Policyholder
b) Any other person who is driving on the Policyholder's order or with his/her permission.
This Policy will indemnify the Policyholder or any authorised driver only if he/she meets the specified age condition.

You have to pay an additional sum of \$3,000 as "Inexperienced Driver Excess" ("IDR") if You are or Your Authorised Driver (named or unnamed) has less than 2 years' driving experience.

Age Condition : 40 years old and above

Limitation as to use* :

Use only for social, domestic and pleasure purposes and for the Policyholder's business.
This Policy does not cover use for hire or reward, driving tuition, driving test, racing, pace-making, reliability trial or speed-testing, the carriage of goods other than samples in connection with any trade or business or use for any purpose in connection with Motor Trade.

Loss of Use 1500cc - 1600cc

* Limitations rendered inoperative by Section 8 of the Motor Vehicles (Third-Party Risks and Compensation) Act (Cap. 189) and Section 90 of the Road Transport Act, 1987 (Malaysia), are not to be included under these headings.

EXCESS

Section 1

Fire - \$0 Own Damage - \$800 Theft - \$0 Flood Cover - \$0

Section 2

Property Damage - \$0

Windscreen : \$100

Named Driver and Excess (where applicable)

Hoo Shu Yee - \$800 (Own Damage)

APPROVED REPORTING CENTRES/AUTHORISED REPAIRERS (FOR CLAIMS RELATED REPAIRS)

1. Motor Image Enterprises Pte Ltd. Add: 19 Lorong 8 Toa Payoh Singapore 319255 64170100

For other Approved Reporting Centres/AIG Authorised Repairers, please contact our 24-hour accident emergency hotline at +65 6338 6200. Alternatively, you may refer to AIG website www.aig.com.sg or AIG SG Mobile App. Simply search and download 'AIG SG' from iTunes or Google Play.

IMPORTANT NOTES

Hire Purchase Company/Employer's Loan: MayBank

We hereby certify that the policy to which this Certificate of Insurance relates is issued in accordance with the provisions of the Motor Vehicles (Third Party Risks and Compensation) Act (Cap. 189), Part IV of the Road Transport Act, 1987 (Malaysia) and Motor Vehicles (Third Party Risks) Rules, 1993 (Malaysia).

0500519221

TAN CHONG CREDIT SUBARU-SJT
911 BUKIT TIMAH ROAD TAN CHONG MOTOR CENTRE
SINGAPORE 589622

Underwritten by AIG Asia Pacific Insurance Pte. Ltd.

AIG Asia Pacific Insurance Pte. Ltd.

AUTHORISED REPRESENTATIVE

SEPOCC

Accident Photo



Accident Photo



Accident Photo



Accident Photo



Accident Photo



Accident Photo



Accident Photo



Accident Photo



Accident Photo



Accident Photo

