

22/03/2012

ASS. REC. BY:

REF: CS/SMO 1906987 / UV f3 n2

Special Instruction:

Survivor: Marcus

ASSIGNMENT (Office)

From (Person): Ruth chua Get Tiang of SMO

Date/Time: 26.9.19 16.10p.m

Estimated Cost:

Bill to:

OD / TP / WS / TP RES / OD RES / EVA / INV / MV / CS

To Inspect Vehicle No: SLP 6099A

Insured: GBH 23786

at Workshop m/s Ssang Hui motor

Tel: 67444605

of 3006 ch road 1 101-338

Policy No: D19MHC VG 000173

Claim No: CMTD 1904500

Sum Insured:

Excess:

Make of Veh:

(Client's Record)

D.O.A 18.9.2019

CA / REV / REP. / REV 24 HRS

Date/Time: 26.9.19 4.14p.m

Person Contacted:

Ssang Hui

H.O.D. Endorsement:

Vehicle IN/OUT

Date/Time	Action/Instruction (✓) Estimate
	SLP 6099A - X
	GBH 23786 - X
30/9/19	Send preli revised via merimen

SMD

ASSIGNMENT

27.9.2019

SLP6099A

6 17

From:

Date:

Below Cost:

C/T/MS/TP RES/OD RES/EVA/INV/MV

To Inspect Vehicle No: SLP 6099A

At Workshop/ins: Siang Hui Motor

At 306 Ubi road 1 #01-338

Insured:

Policy No:

Claims No:

Sum Insured:

Excess:

(Client's Record)

Make of Veh:

(Policy Condition)

Remark: The veh had commenced its repair at the time of inspection.

Est. or Market Value

IDC Accident Report:

Consistent? : Yes or No

Est. Repairs:

Consistent? : Yes or No

Est. Repairs:

days

Resd: Yes or No

Lum Sum:

%

3 Val: Yes or No

CA / REV / REP: 24 HRS

"np"

Date:

Person Contacted:

Vehicle: IN / OUT

Veh No:

Type: M Car / M Cycle / Bus / Van / Lorry / Taxi / Prime Mover /

Truck / Trailer

Make:

Colour:

Sp. Reading:

Eng/No:

C/No:

Gen. Cond: Good / Fair / Poor / Burnt

Steering: In order / Jammed / Leaked / Burnt or

Brake: In order / Jammed / Leaked / Burnt or

Modi: Nil / S/Rim / STD A/Rim or

Tyre Size:

R:

BS / DUN / EXNOVA / GY / FS / LIZA / MIC / OHTSU / PIR / SUMI /

TOYO / YOKO or

Front

R/Bal:

L/Bal:

D.O.A:

Survey held at

Des. of Damages: Frt / Rear / O/S / N/S / U/C / Rooftop or

The U/C / Chassis frame / Body Structure affected due to collision.

Date / Time

Action / Instruction

1/10/19 LTA 50283
 4/5 #3350 conf. with AH hui (Red 2020-77, 389)

RECEIVED 02 OCT 2019

Total Fee Paid:

☐

Prel. Report

At

☐

Final Report

One-Time Fee Return:

Days Of Repair:

4

Resurvey No. of Trip:

1

>110 - typist

Add Fee:

☐

Site Insp: \$

☐

Interview: \$

☐

Tech. Insp: \$

☐

Material: \$

Survey Fee:

Transportation:

\$ - FE: \$

Phone:

Other:

250

11

261

merimen

L/S \$3350+

LKK Auto Consultants Pte Ltd (Co.Reg.No:199607198R)

51 Ubi Ave 1 #01-25, Paya Ubi Industrial Park

Singapore 408933

Tel: 6256-3561 Fax: 6844-8805 Email: sur@lkkauto.com; assignments@lkkauto.com

To: Sompoo Insurance Singapore Pte. Ltd.
50 Raffles Place
#05-01/06, Singapore Land Tower
Singapore 048623

From: LKK Auto Consultants Pte Ltd
51 Ubi Ave 1 #01-25
Paya Ubi Industrial Park
Singapore 408933

Attn: Ruth Chua Gek Tiang

Date: 30 Sep 2019

Preliminary Advice

Insured Vehicle No : GBH2378G

TP Vehicle No : SLP6099A

Make : OPEL MOKKA X

Date of Inspection : 27/9/2019

Inspection At : SIANG HUI MOTOR WORKS

Accident Date : 18/09/2019

Assignment Date : 26/09/2019

Est. Duration of Repair : 4

Point of Impact / General Description of Damages

The vehicle sustained impact / damages o/s front portion and parts claimed are consistent to the accident.

Repairer's Estimate (Gross)	:S\$	5,370.77
Revised Amount	:S\$	4,309.20
Check Items (Estimated)	:S\$	0.00
Total	:S\$	4,309.20
Lump Sum Repair	:S\$	

Total Loss Consideration

New for Old Value

:S\$

Pre-Accident Value

:S\$

COE / PARF Rebate

:S\$

Salvage Value

:S\$

Margin for Repair

:S\$

Remarks

() The vehicle is repairable at our adjusted amount. We have also confirmed excess and policy coverage. Kindly let us have your authorisation.

() The vehicle is uneconomical to be repaired, you are advised to invite tender for the wreck.

(X) Other comments :The above survey was conducted on a 'Without Prejudice' basis.

...CLAIM SUBFOLDER...(New Assignment)

CLAIM SUBFOLDER TRACKING

Case	Notified	Est Submitted	Adj Assigned	Adj Rpt	Adj Submitted	Ins Auth'd	Status
Main	19 Sep 2019		26 Sep 2019 16:10 Assign				New Assignment Cancel Case

Main	Reference	Claim Details	Documents	Show All					
CLAIM SUBFOLDER DETAILS		[Created by insurer]							
Insured:	ETHOZ GROUP LTD, Co. Reg. No.: 198104531H								
Main Claimant:	NATIONAL CAR RENTALS (PRIVATE) LIMITED, Co. Reg. No.: 196100157E								
Vehicle Reg. No.:	SLP6099A	Date of Loss:	18/09/2019 09:00 - :59						
Claim Type:	TP / CMTD1904500	Policy/Cover Note No.:	D19MTHCVE000173 (Third Party Only)						
Vehicle Reg. No. (Insured):	GBH2378G	Policy No. (Claimant):							
		Excess:							
Repairer:	Siang Hui Motor Works (HQ) 3006 Ubi Road 1, #01-338, 408700 Ubi - Tel: 67444605								
Handling Insurer:	Sompo Insurance Singapore Pte. Ltd. (HQ) - Tel: 6461 6555 ... [Handled by Ruth Chua Gek Tiang - 6329 5153]								
Adjuster:	LKK Auto Consultants Pte Ltd (HQ) - Tel: 6256-3561 ... [Final Rpt due 07/10/2019]								
Driver/Custodian (Insured):	ONG WEN XIANG (), NRIC: S8224881A, Tel: +6590585175 Email:								
Adj Asg. Remarks:	Siang Hui Motor Works at 6744 4605								
ASSOCIATED MAIL RECEIVED		View All Compose Case Mail							
There are no mail for this case.									
ALL ASSOCIATED TASKS									
View All Search Tasks Create New Task Complete									
Due Date	Priority	Type	Task Group	Subject	Handler	Assigned By	Completed On	Created On	Done?
No results.									

> **Back to OneMotoring**

Enquire PARF/COE Rebate for Registered Vehicle

Vehicle Owner Particulars

Owner ID Type:	Company
Owner ID:	157E

Vehicle Details

Vehicle No.:	SLP6099A
Vehicle to be Exported:	No
Intended Deregistration Date:	27 Sep 2019
Vehicle Make:	OPEL
Vehicle Model:	MOKKA X 1.6 CDTI 6AT
Primary Colour:	Grey
Manufacturing Year:	2017
Engine No.:	A1170165GU7X0219
Chassis No.:	W0LJD7EC3HB180934
Maximum Power Output:	100.0 kW (134 bhp)
Open Market Value:	\$20,376.00
Original Registration Date:	13 Jun 2017
First Registration Date:	13 Jun 2017
Transfer Count:	0
Actual ARF Paid:	\$15,527.00

Intended PARF Rebate Details

PARF Eligibility:	Yes
PARF Eligibility Expiry Date:	12 Jun 2027
PARF Rebate Amount:	\$11,645.00

Intended COE Rebate Details

COE Expiry Date:	12 Jun 2027
COE Category:	E - Open - all except motorcycle
COE Period(Years):	10
QP Paid:	\$50,526.00
COE Rebate Amount:	\$38,638.00
Total Rebate Amount:	\$50,283.00

The information contained herein is correct as at 27 Sep 2019

OK

26-09-19 12:30
 MKPS10123808 / Kan Fook Sing Motor Workshop - Delu
 ENTRY DATE & TIME: 18/09/2019 16:22
 SUBMITTED BY: Yan Boq

SINGAPORE ACCIDENT STATEMENT

IMPORTANT NOTICE

1. Please report correctly the details of the accident to speed up the claims process.
2. This Form must be completed by the Policyholder and/or the Authorised Driver.
3. Information provided must be as truthful and accurate as possible. Any wilful misrepresentation or withholding of material facts may allow insurance companies to repudiate policy liability.
4. The issue and acceptance of this Form by insurance companies is not an admission of policy liability on the part of the insurance companies.
5. Any false reporting may be referred to the Police for investigation.
6. This report will be forwarded by the Insurers of the GIA Records Management Centre established by the General Insurance Association of Singapore (GIA) for archiving and that copies of this report will, for a fee, be made available upon application by interested parties.
7. By the lodgement of this report to the insurers, you hereby consent to the archiving of this report at the centre and to copies of the report being made available aforesaid.

ACCIDENT STATEMENT

Date Of Report 18/09/2019 16:22
 Date Of Accident 18/09/2019 09:05
 Exact Location Of Accident 22 CHANGI SOUTH AVE 2
 Country/State of Loss SINGAPORE

DETAILS OF OWN VEHICLE

Vehicle Registration Number SLP6099A
 Insured/Policyholder NATIONAL CAR RENTALS (PRIVATE) LIMITED
 Name Of Registered Owner 196100157E
 Co Reg No JAMES.CHUA@AVIS.COM.SG
 Email Address OFFICE-91051111
 Mobile Phone No
 Alternative Phone No
 Vehicle Particulars
 Manufacturer OPEL
 Model MOKKA X-1.6 CDTi 6AT (LED) (A)
 Exact Purpose for which vehicle was being used at time of accident
 Are you claiming under your own insurance policy for repair to your vehicle? NO
 If No, Please state action to be taken THIRD PARTY
 Vehicle Category PRIVATE HIRE
 Insurance Company NTUC INCOME INSURANCE CO-OPERATIVE LTD
 Name of Insurance Company THIRD PARTY FIRE AND/OR THEFT
 Type Of Coverage YES
 Fleet Policy 5059475530-06
 Policy Number 01/01/2019 TO 31/12/2019
 Cover Note Number
 Driver GOH HUA KEONG (WU HUAQIANG)
 Name of Driver S8031959B
 NRIC No 12/10/1980
 Date Of Birth OUTDOOR
 Occupation 11/11/2011
 Date Of Driving Pass 7 YEARS AND 10 MONTHS
 Driving Experience MALE
 Gender (LOCAL) +65-91051111
 Mobile Number
 Fax Number
 Contact Number
 Email Address HEATV80@GMAIL.COM

26-09-19:12:30

APT BLK 40 SIMS DRIVE #08-219 (S) 380040

Address

Postcode

Was driver an employee of the Insured's Company NO

If No, Relationship of the Driver with the Insured OTHER - HIRER

Vehicle Registration Number of Driver's Own Vehicle

Insurance Company of Driver's Own Vehicle

General Information of the Accident

Type Of Accident

Weather Conditions

Road Surface

SIDE SWIPE

CLEAR

DRY

Other Information

Was any foreign vehicle involved in this accident? NO

Number of vehicles (Including own vehicle) involved in the accident 2

Was any body injured in the Accident? NO

Was any injured conveyed to hospital by ambulance?

Was any other material or property damaged? YES

I have been approached by unknown person(s) soliciting/offering accident claims assistance. NO

Number of Passengers (Including Driver) 1

Details of Police Action

Was the accident reported to the police? NO

If Yes, Please state which Police Station

Was notice of intended Prosecution given? NO

If Yes, against whom?

Circumstances of Accident

refer with attach.

Attachment(s)

Are accident photos available for attachment? YES

Was there any video captured by Car Camera? NO

Was there any audio recorded? NO

DETAILS OF OTHER VEHICLE PROPERTY 1

GBH2378G

Vehicle Registration Number

Vehicle Make/Model/Colour

Details Of Properties

Vehicle Category

COMMERCIAL VEHICLE

Name of Driver

NRIC/Passport Number

Contact Number

Address

Postcode

Insurance Company Name

Nature Of Damage

No. Of Passenger (Including Driver)

26-09-19; 12:30

Accident Sketch Plan Pg. 1

SKETCH PLANIMPORTANT NOTICE

1. Please report correctly the details of the accident to speed up the claims process.
2. This Form must be completed by the Policyholder and/or the Authorised Driver.
3. Information provided must be as truthful and accurate as possible. Any wilful misrepresentation or withholding of material facts may allow insurance companies to repudiate policy liability.
4. The issue and acceptance of this Form by insurance companies is not an admission of policy liability on the part of the insurance companies.
5. Any false reporting may be referred to the Police for investigation.
6. The report will be forwarded by the Insurers of the GIA Records Management Centre established by the General Insurance Association of Singapore (GIA) for archiving and that copies of this report will for a fee be made available upon application by interested parties.
7. By the lodgment of this report to the insurers, you hereby consent to the archiving of this report at the centre and to copies of the report being made available aforesaid.
8. Consent under the Personal Data Protection Act (PDPA)

I understand, acknowledge, agree and consent that:

- (a) My Insurer, my workshop and the General Insurance Association of Singapore ("GIA") may/are permitted to collect, use, disclose and/or process my personal data/personal information set out in this (form) and any other personal information provided by me or possessed by my Insurer (collectively the "Personal Information") and disclose and transfer such Personal Information to all Insurer(s) who have insured vehicle(s) involved in this accident (all Insurer(s) who have insured vehicle(s) involved in this accident shall be collectively referred to as the "Insurers"), the Insurers' lawyers/law firms, the Monetary Authority of Singapore and any relevant government agency/authority (such as the police), for the purpose(s) of:
 - (i) processing, handling and/or dealing with my claims including the settlement of the claims and any necessary investigations relating to the claims;
 - (ii) investigating the accident and/or my claims;
 - (iii) carrying out and/or dealing with my instructions or responding to any enquiries by me;
 - (iv) administering my claims (including the mailing of correspondence, statements, invoices, reports or notices to me, which could involve disclosure of certain personal data about me to bring about delivery of the same as well as on the external cover of envelopes/mail packages); and/or
 - (v) complying with applicable law in administering, processing, handling and/or dealing with my claims (collectively the "Purposes")
- (b) all Insurer(s) who have insured vehicle(s) involved in this accident and the Insurers' lawyers/law firms, may/are permitted to collect, use, disclose and/or process my Personal Information for one or more of the above Purposes; and
- (c) my Personal Information may/can be disclosed by any of the Insurers and/or GIA to their third party service providers or agents (including their lawyers/law firms), which may be sited outside of Singapore, for one or more of the above Purposes.
- (d) my Personal Information will also be collected and used to compile claims history for the purpose of fraud detection, investigation and management in present and all future claims.
- (e) the information so collected under (d) above may be shared / disclosed:
 - (i) to all Insurers and/or any other third parties that assist in evaluating, investigating, controlling or managing fraud, regulators, law enforcement and government agencies as reasonably required for the purposes stated, or
 - (ii) for complying with requirements under any regulations, laws or court orders.



Policyholder's Signature
Date & Time:

Driver's Signature
(if driver is not the policyholder)
Date & Time: 18/9/2019



Reporting Centre Personnel's Signature
Name:
NRIC/FIN No.:

Accident Sketch Plan Pg. 1

SKETCH PLAN

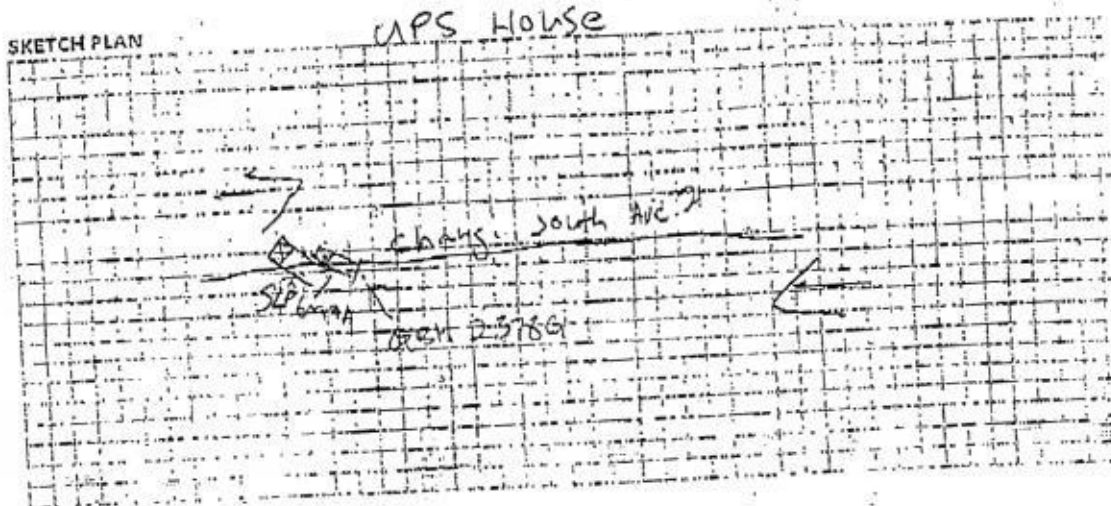

DESCRIBE CIRCUMSTANCES OF THE ACCIDENT

Trying to turn into UPS house and the other vehicle bang me by the side.

DECLARATION

I/We declare the foregoing particulars are true in every respect.

Policyholder's Signature
Date & Time:

GIARAC Sketch Plan Form V3

Driver's Signature
(If driver is not the policyholder)
Date & Time:

Reporting Centre Personnel's Signature
Name:
NRIC/FIN No.:

祥輝汽車修理 SIANG HUI MOTOR WORKS

Blk 3006, Ubi Road 1 #01-338, Singapore 408700.
Tel: 67444605 Fax: 67440726
REG. No. 322208/00M

Not Book
27/9/19 + 1/5 #3350
Hdy.
The/for/All/sg.

Vehicle No SLP 6099A

Date,

26/9/19

Opel Mokka

1	IPC Front door o/s	sedan	#1973.60	
2	IPC Front door protector o/s	295	\$ 387.50	295
3	IPC Front fender o/s	s-15m	\$ 473.60	
4	IPC Front fender garnish o/s	gnd	\$ 273.30	
5	IPC Front fender lamp o/s	11	\$ 53.50	X
6	IPC Front fender inner shield o/s	11	\$ 103.80	X
			\$ 3745.30	
Less 10%			\$ 374.53	
			\$ 3370.77	

Labour charges:-

LR 120

1)	To repair front wheel rim	147	\$ 280.00
2)	To check wheel alignment	60	\$ 80.00
3)	To spray painting	600	\$ 720.00
4)	To remove, replace front door + front fender	300	\$ 950.00

Total:-

\$ 5370.77

LKK Auto Consultants hence notify the Repairer of the following:
 • To resurvey before/after spray painting
 • To display damaged part(s) during resurvey
 • Parts prices are subject to confirmation
 • Third party survey is on a "Visual Evidence" basis
 • No PPS or valuation(s) is allowed
 • Supplement(s) must be resurveyed and is subject to final approval from Insurance Company

Acknowledged by Repairer
Signature:
Date:

P-3497-20

102

3147.48
4227.48
3381

LKK Auto Consultants Pte Ltd (Co.Reg.No:199607198R)

51 Ubi Ave 1 #01-25, Paya Ubi Industrial Park
Singapore 408933

Tel: 6256-3561 Fax: 6844-8805 Email: sur@lkkauto.com;assignments@lkkauto.com

VEHICLE DAMAGE INSPECTION REPORT

Our File No: CS/SMO19016987/UVF3N2
Date: 03/10/2019

REFERENCE

Handling Insurer:	Sompo Insurance Singapore Pte. Ltd.	Policy No:	D19MTHCVE000173
Claimant Vehicle No :	SLP6099A	Insured Vehicle No :	GBH2378G
Date of Loss:	18/09/2019	Nature of Claim:	TP
		Claim No:	CMTD1904500

DESCRIPTION & IDENTIFICATION OF VEHICLE

Reg No:	SLP6099A	Engine No:	A1170165GU7X0219
Make & Model:	OPEL MOKKA X, 1.6 CDTI 6AT (LED) (A)	Chassis No:	W0LJD7EC3HB180934
Reg. Date:	13/06/2017 (Man. Year: 2017)	Odometer:	171863 km
Colour:	Grey		
Engine Capacity:	1598 cc		
Market Value/New Car Price:	N/A		
Sum Insured (\$\$):	Market Value/New Car Price		

CONDITION OF VEHICLE AT THE TIME OF SURVEY

General Condition:	Steering (Serviceable):	Yes	Footbrake (Serviceable):	Yes
Handbrake (Serviceable):	Yes	Engine Modification:	No	Pre-accident Condition:

CONDITION OF TYRES

Front Tyre Size:	215/55R18	Rear Tyre Size:	215/55R18
Front Left Side:	Firenza 6 mm	Rear Left Side:	Firenza 6 mm
Front Right Side:	Firenza 6 mm	Rear Right Side:	Firenza 6 mm

The above values represent the remaining tyre treads depth

COST OF CLAIMS

	Repairer's	Adjuster's	Difference	Diff %
Parts	3,620.77	3,267.48	353.29	9.76
Miscellaneous Items	0.00	0.00	0.00	
Labour	1,750.00	960.00	790.00	45.14
Paintwork Labour	0.00	0.00	0.00	
Towing	0.00	0.00	0.00	
Calculated Gross Total (\$\$)	5,370.77	4,227.48	1,143.29	21.29
Approved Total (Overridden) (\$\$)		3,350.00		
Nett Amount (\$\$)	5,370.77	3,350.00	2,020.77	37.63

INSPECTION

Date of Assignment:	26/09/2019	Inspected At:	Siang Hui Motor Works (HQ)
Date Inspected:	27/09/2019		3006 Ubi Road 1, #01-338
			Singapore 408700

Estimated Period of Repair: 4.0 days

Adjuster: MARCUS CHUA

Manager: VERON CHEN

NOTE: This report represents our findings at the time and place of inspection stated herein. Such inspection has been carried out to the best of our knowledge and ability but any other liability under any other circumstances is hereby expressly excluded.

REPAIR DETAILS

Reference		
Part Source:	MRM-SG	Version: 1.0 (Last Synchronised: 03 Oct 2019)
Parts:	143	OPEL MOKKA X 1.6 CDTI 6AT (LED) (A) (Catalogue:Merimen Singapore 1.0)
Labour:	Repairer's	(Price-denominated Standard List)
Print Code:	(Unsubmitted, no print-code for SLP6099A)	
Validity:	These estimates are valid only if they contain the print code (above) on all estimate pages, running page numbers with the END OF ESTIMATES marker on the last estimate page	
Further Info:	Items/values not in reference catalogue are prefixed with an asterisk *.	

Recommended Parts

No.	Qty	Part No.	Particulars	Condition	Repairer's	Amount
1	1		*FRONT DOOR O/S	Badly Dented	1,973.60 FL	*1,973.60 FL
2	1		*FRONT DOOR PROTECTOR O/S	Bent	367.50 FL	*295.00 FL
3	1		*FRONT FENDER O/S	Badly Dented	973.60 FL	*973.60 FL
4	1		*FRONT FENDER GARNISH O/S	Grazed	273.30 FL	*255.00 FL
5	1		*FRONT FENDER LAMP O/S	Not Necessary	53.50 FL	*- FL
6	1		*FRONT FENDER INNER SHIELD O/S	Not Necessary	103.80 FL	*- FL
7	1		*FRONT WHEEL RIM (LOCAL REPAIR)	Cut	250.00 FS	*120.00 FS
					Sub Total (S\$)	3,995.30
					- List Item Discount on L Items 10.00/10.00% (S\$)	374.53
					Total Parts (S\$)	3,620.77

F=Franchise part. S=SpcNett. L=ListItemDisc.

Report was unsubmitted during this print-out.

Recommended Miscellaneous Items

There are no new miscellaneous items selected.

Recommended Labour

No	Particulars	Lab.Type	Repairer's	Amount
Labour Items				
1	TO CHECK WHEEL ALIGNMENT	New	80.00	60.00
2	TO SPRAY PAINTING	New	720.00	600.00
3	TO REMOVE/REPLACE FRONT DOOR & FRONT FENDER	New	950.00	300.00
Gross Labour Cost (\$\$)			1,750.00	960.00

Report was unsubmitted during this print-out.

< END OF ESTIMATES >