

# NATIONAL Assessment Centre Services

Date In: 10/09/19	Job description	Date & Time Completed	Done by
Ref No: NA/TMI/19016021/13	SAS e-filing		
Veh No: XD3183E	E-mail (within 8hrs, AIC 2hrs)		
DOA: 09/09/19 0645	i-Motor Claim Form		
OD: (TP) Reporting Only	i-Motor W/O (Within: OD 2hrs, TP 4hrs)		
	i-Photo Uploaded		
TP Insurer:	Assessment/Survey Report		
	Ass't Report by Fax / Hand to Owner/Wksp		

Preferred Wksp / INC Assign Wksp / QW: (	Tel: (	Fax: (
TP Particulars:	Veh No: GBH9878J	INC ( ) / Non-INC ( )
Owner / Driver: (	Tel: (	
Policy No: (	Period: (	Cover Type: (
Confirmed by: (	Date: (	Time: (
Insured/Driver Liability: (	[Note-Est. Status (WO): N: 0-20%; P: 21-79%; F: 80-100%]	
Year of Registration: (	Warranty: YES ( ) / NO ( )	
Excess: (\$	Loading: \$1,000 ( ) / \$2,000 ( )	

**General Remarks:-**

( ) Walk-In Customer : Customer's information strictly Confidential & Strictly NO refer of repairer.

( ) Total Loss Case : to e-mail Insurer URGENTLY.

Drive-In ( ) / Towed-In ( ) ; Invoice: YES ( ) / NO ( ) ; Towing Co. ( )

Remarks:- (INC hotline: 6788 6616)	Date & Time Completed	Done by
1) Apply for Transport Allowance ( ) / Courtesy Car ( )		
2) QC Check / Post Repair Inspection ( )		
3) Upload Resurvey Photo [Repair Cost > \$3000] ( )		

**Injury :**

Date/Time	Actions

NA1906981	<b>Invoice Preparation Checklist</b>	Ant (\$) 1st Bill	Ant (\$) Add Bill
Claimant's Particulars :-	1) AR : Accident Reporting (\$30);		
Driver/Owner:	2) DA : Damage Assessment (\$100); INC (\$80)		
Contact No:	3) TF : Towing Fee \$40/\$45		
Damaged Portion:	4) FT : Follow-Through Survey \$120		
	5) FT : Follow-Through Survey (Resurvey) \$30		
	For claiming against INC Only (wef 10 Jan 2005)		
	6) TR : Re-inspection \$75		
	7) N1 : Idac DA + SMRT Survey \$160		
	8) NTUC Additional Services:-		
QC Checked by (Engr-In-Charge):	ON*		
	*N5: Courtesy Car / Tpt Allowance \$5		
	*N6: Repair Co-ordination \$10		
	*N7: Post Repair Inspection \$25		
	*N8: DV / Collect Excess Coordination \$5		
	TP (N11) : TP (Non INC) against INC \$20		
	9) N12: Idac Mobile \$0		
Cat. 1:	Invoice dated	Fee Charged	
Cat. 2 / 3:			



SINGAPORE ACCIDENT STATEMENT

IMPORTANT NOTICE

- 1. Please report correctly the details of the accident to speed up the claims process.
- 2. This Form must be completed by the Policyholder and/or the Authorised Driver.
- 3. Information provided must be as truthful and accurate as possible. Any wilful misrepresentation or withholding of material facts may allow insurance companies to repudiate policy liability.
- 4. The issue and acceptance of this Form by insurance companies is not an admission of policy liability on the part of the insurance companies.
- 5. **Any false reporting may be referred to the Police for investigation.**
- 6. This report will be forwarded by the insurers of the GIA Records Management Centre established by the General Insurance Association of Singapore (GIA) for archiving and that copies of this report will, for a fee, be made available upon application by interested parties.
- 7. By the lodgement of this report to the insurers, you hereby consent to the archiving of this report at the centre and to copies of the report being made available aforesaid.

ACCIDENT STATEMENT	
Date Of Report	10/09/2019 14:21
Date Of Accident	09/09/2019 06:45
Exact Location Of Accident	YISHUN INDUSTRIAL PARK A URA CARPARK
Country/State of Loss	SINGAPORE
DETAILS OF OWN VEHICLE	
Vehicle Registration Number	XD3183E
Insured/Policyholder	
Name Of Registered Owner	TAKENAKA CORPORATION
Co Reg No	-
Email Address	NOEMAIL
Mobile Phone No	
Alternative Phone No	OFFICE-92778918
Vehicle Particulars	
Manufacturer	ISUZU
Model	-
Exact Purpose for which vehicle was being used at time of accident	PARKED VEH
Are you claiming under your own insurance policy for repair to your vehicle?	NO
If No, Please state action to be taken	THIRD PARTY
Vehicle Category	COMMERCIAL VEHICLE
Insurance Company	
Name of Insurance Company	TOKIO MARINE INSURANCE SINGAPORE LTD
Type Of Coverage	THIRD PARTY
Fleet Policy	NO
Policy Number	18-08028981-R10
Cover Note Number	
Driver	
Name of Driver	FOO FANG WOEI
NRIC No	S1212914I
Date Of Birth	06/06/1956
Occupation	OUTDOOR
Date Of Driving Pass	25/06/1979
Driving Experience	40 YEARS AND 2 MONTHS
Gender	MALE
Mobile Number	(LOCAL) +65-98155027
Fax Number	
Contact Number	
EMail Address	NOEMAIL

Address	BLK 745 YISHUN ST 72 #07-157
Postcode	760745
Was driver an employee of the Insured's Company	YES
If No, Relationship of the Driver with the Insured	
Vehicle Registration Number of Driver's Own Vehicle	- - -
Insurance Company of Driver's Own Vehicle	- - -

#### General Information of the Accident

Type Of Accident	COLLIDED INTO PARKED VEHICLE
Weather Conditions	CLEAR
Road Surface	DRY

#### Other Information

Was any foreign vehicle involved in this accident?	NO
Number of vehicles (including own vehicle) involved in the accident	2
Was any body injured in the Accident?	NO
Was any injured conveyed to hospital by ambulance?	NO
Was any other material or property damaged?	YES
I have been approached by unknown person(s) soliciting/offering accident claims assistance.	NO
Number of Passengers (Including Driver)	0

#### Details of Police Action

Was the accident reported to the police?	NO
If Yes, Please state which Police Station	
Was notice of intended Prosecution given?	NO
If Yes, against whom?	

#### Circumstances of Accident

MY VEH WAS PARKED OVERNIGHT AT YISHUN INDUSTRIAL PARK A URA CARPARK ON THE 08/09/2019. ON THE NEXT DAY 10/09/2019 (MONDAY) WHEN I WANTED TO COLLECT MY VEH AT THE CARPARK, I SAW MY VEH WAS DAMAGED AND I SAW A NOTE AT MY WINDSCREEN. THE NOTE INDICATE THAT MY VEH WAS HIT BY VEH NO GBH9878J.

#### Attachment(s)

Are accident photos available for attachment?	YES
Was there any video captured by Car Camera?	NO
Was there any audio recorded?	NO

#### DETAILS OF OTHER VEHICLE PROPERTY 1

Vehicle Registration Number	GBH9878J
Vehicle Make/Model/Colour	
Details Of Properties	
Vehicle Category	COMMERCIAL VEHICLE
Name of Driver	
NRIC/Passport Number	
Contact Number	
Address	
Postcode	
Insurance Company Name	
Nature Of Damage	
No. Of Passenger (Including Driver)	



## SKETCH PLAN

### IMPORTANT NOTICE

1. Please report **correctly** the details of the accident to speed up the claims process.
2. This Form must be **completed by the Policyholder and/or the Authorised Driver**.
3. Information provided must be as **truthful and accurate as possible**. Any wilful misrepresentation or withholding of material facts may allow insurance companies to **repudiate policy liability**.
4. The issue and acceptance of this Form by insurance companies is not an admission of policy liability on the part of the insurance companies.
5. **Any false reporting may be referred to the Police for investigation.**
6. The report will be forwarded by the insurers of the GIA Records Management Centre established by the General Insurance Association of Singapore (GIA) for archiving and that copies of this report will for a fee be made available upon application by interested parties.
7. By the lodgment of this report to the insurers, you hereby consent to the archiving of this report at the centre and to copies of the report being made available aforesaid.
8. **Consent under the Personal Data Protection Act (PDPA)**

I understand, acknowledge, agree and consent that:

- (a) My insurer, my workshop and the General Insurance Association of Singapore ("GIA") may/are permitted to collect, use, disclose and/or process my personal data/personal information set out in this [form] and any other personal information provided by me or possessed by my insurer (collectively the "Personal Information") and disclose and transfer such Personal Information to all insurer(s) who have insured vehicle(s) involved in this accident (all insurer(s) who have insured vehicle(s) involved in this accident shall be collectively referred to as the "Insurers"), the Insurers' lawyers/law firms, the Monetary Authority of Singapore and any relevant government agency/authority (such as the police), for the purpose(s) of:
  - (i) processing, handling and/or dealing with my claims including the settlement of the claims and any necessary investigations relating to the claims;
  - (ii) investigating the accident and/or my claims;
  - (iii) carrying out and/or dealing with my instructions or responding to any enquiries by me;
  - (iv) administering my claims (including the mailing of correspondence, statements, invoices, reports or notices to me, which could involve disclosure of certain personal data about me to bring about delivery of the same as well as on the external cover of envelopes/mail packages); and/or
  - (v) complying with applicable law in administering, processing, handling and/or dealing with my claims.(collectively the "Purposes")
- (b) all insurer(s) who have insured vehicle(s) involved in this accident and the Insurers' lawyers/law firms, may/are permitted to collect, use, disclose and/or process my Personal Information for one or more of the above Purposes; and
- (c) my Personal Information may/can be disclosed by any of the Insurers and/or GIA to their third party service providers or agents(including their lawyers/law firms), which may be sited outside of Singapore, for one or more of the above Purposes.
- (d) my Personal Information will also be collected and used to compile claims history for the purpose of fraud detection, investigation and management in present and all future claims.
- (e) the information so collected under (d) above may be shared / disclosed:
  - (i) to all insurers and/or any other third parties that assist in evaluating, investigating, controlling or managing fraud, regulators, law enforcement and government agencies as reasonably required for the purposes stated, or
  - (ii) for complying with requirements under any regulations, laws or court orders.



Policyholder's Signature  
Date & Time:

Driver's Signature  
(If driver is not the policyholder)  
Date & Time:

Reporting Centre Personnel's Signature  
Name:  
NRIC/FIN No.:

SKETCH PLAN

YISHUN INDUSTRIAL PARK A

A-XD3183E

B-GBH9878J

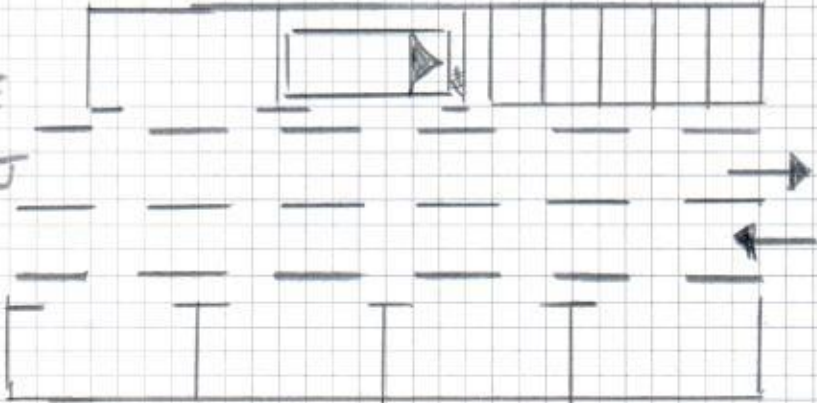

DESCRIBE CIRCUMSTANCES OF THE ACCIDENT

P/s refer to the statement.

DECLARATION

I/We declare the foregoing particulars are true in every respect.

Policyholder's Signature  
Date & Time:

Driver's Signature  
(If driver is not the policyholder)  
Date & Time:

Reporting Centre Personnel's Signature  
Name:  
NRIC/FIN No.:

POLICE DEPARTMENT

OFFICE NOTES

Your vehicle was hit  
by GBH 98785. You  
may proceed with your  
insurance claim.

Traffic Police  
SS T120174  
Wei Siong  





## Certificate of Insurance

**MOTOR VEHICLES (THIRD-PARTY RISKS AND COMPENSATION) ACT (CHAPTER 189)**  
**MOTOR VEHICLES (THIRD-PARTY RISKS AND COMPENSATION) RULES, 1960**  
**ROAD TRANSPORT ACT, 1987 (MALAYSIA)**  
**MOTOR VEHICLES (THIRD-PARTY RISKS) RULES, 1959 (MALAYSIA)**

**Policy No.:** 18-08028981-R10 (Motor SpecialType/Cranes/Ambul)

1. **Index Mark and Registration Number of Vehicle** XD3183E **Chassis No.:** JALCYH52T87000070
2. **Name of Policyholder** TAKENAKA CORPORATION
3. **Effective date of the Commencement of Insurance for the purposes of the Act** 12/11/2018
4. **Date of Expiry of Insurance** 11/11/2019

5. **Persons or Class of Persons entitled to drive\***

Any person provided he is in the Policyholder's employ and is driving on their order or with their permission.

\* Provided that the Person driving is permitted in accordance with the licensing or other laws or regulations to drive the Motor Vehicle or has been so permitted and is not disqualified by order of a Court of Law or by reason of any enactment or regulation in that behalf from driving the Motor Vehicle. And provided further that the Motor Vehicle is registered under the Road Traffic Act and its registration under the Road Traffic Act has not been cancelled at the time of the accident loss or damage.

6. **Limitations as to use\***

1) Use in connection with the Policyholder's business

2) Whilst the Motor Vehicle is being so used the carriage of passengers is permitted.

The Policy does not cover:-

1) Use for racing, pacemaking, reliability trial or speed-testing.

2) Use for the carriage of passengers for hire or reward.

3) Use whilst drawing a trailer except the towing (other than for reward) of any one disabled mechanically propelled vehicle.

\* Limitations rendered inoperative by Section 8 of the Motor Vehicles (Third-Party Risks and Compensation) Act (Chapter 189) and Section 95 of the Road Transport Act, 1987 (Malaysia), are not to be included under these headings.

We hereby certify that the Policy to which this Certificate relates is issued in accordance with the provision of the Motor Vehicles (Third-Party Risks and Compensation) Act (Chapter 189) and Part IV of the Road Transport Act, 1987 (Malaysia).

Please refer to the Policy Schedule for full details, terms and conditions of the insurance.

**IMPORTANT NOTICE**

This Certificate is not transferable. During its currency, if the insurance is cancelled for whatsoever reason, you must return the Certificate to Tokio Marine Insurance Singapore Ltd. within 7 days thereof or, if the Certificate has been lost destroyed, you must make a statutory declaration to that effect. Failure to comply with this duty is an offence under Motor Vehicle (Third-Party Risks and Compensation) Act (Chapter 189).

**ADDITIONAL INFORMATION**

**Account:** 12045DDZ

**Insurance Plan:** Third Party Cover Only

Tokio Marine Insurance Singapore Ltd.

Authorised Signature