

22/05/2000

ASS. REC. BY:

REF: CS/IAS19013483/T11d31 Special Instruction:

Surveyor: Taufik

ASSIGNMENT (Office)

From (Person): Tan wee chian of IAS

Date/Time: 1/8/19 @ 10.45am

Estimated Cost: Bill to:

OD/TP/WS/TP RES / OD RES / EVA / INV / MV / CS

To Inspect Vehicle No: YP 7490S

Insured: Forklift

at Workshop in/s ASM Automotive

Tel: 9799 3771

of No. 13 pioneer sector 1

Policy No: 1A2019-39052/TWC

Claim No:

Sum Insured:

Excess:

Make of Veh:

D.O.A. 9/7/19

(Client's Record)

CA / REV / REP. / REV 24 HRS

H.O.D. Endorsement:

Date/Time: 12.17pm 8/8/19

Person Contacted: David

Vehicle IN/OUT

Date/Time

Action/Instruction

Tel: 9799 3771

22/8-11:24am revise via email

Part by Part \$8242, Used: 1538 (15%)

ASS. REC. BY:

Taufik

REF:

IAS

ASSIGNMENT

From:

Date:

20/08/19

Estimated Cost:

Veh No:

YP7490S

Yr Regn:

2017 Oct.

Type: M.Car / M.Cycle / Bus / Van / Truck / Taxi / Prime Mover /OD / TP / WS / TP RES / OD RES / EVA / INV / MV

Truck / Trailer or

To Inspect Vehicle No:

YP7490S

Make:

Mitsubishi Canter FES21

c.c.

2498

at Workshop m/s

Hwee San

Colour

white

A/C:

Insured / Std / NI / NA

of

82 Joo Koon Circle

Sp. Reading

42960

T/Radio: Insured / Std / NI / NA

Insured:

Eng/No:

Policy No:

C/No:

FES21FA21585

Claims No:

Gen. Cond: Good / Fair / Poor / Burnt

Sum Insured:

Excess:

Steering: Inorder / Jammed / Leaked / Burnt or

(Client's Record)

Brake: Inorder / Jammed / Leaked / Burnt or

Make of Veh:

David @ 9799 3771

Modi: Nil / S/Rim / STD A/Rim or

(Policy Condition)

Remark: The veh had commenced its repair at the time of inspection.

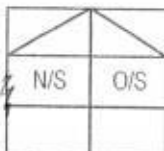

Tyre Size:

F:

195/55R15

R:

7-7

BS / DUN / EXNOVA / GY / FS / LIZA / MIC / OHTSU / PIR / SUMI / TOYO / YOKO or

Bal. or Market Value:

Front

Rear

IDAC Accident Rpt:

Consistent? : Yes or No

R/Bal.

6

mm

R/Bal.

1/6

mm

GIA / PR. Seen:

Consistent? : Yes or No

L/Bal.

6

mm

L/Bal.

6/6

mm

Est. Repairs:

days

Res.: Yes or No

D.O.A.

D.O.I.

20/8/19 12pm

Lum Sum:

%

3 Val.: Yes or No

Survey held at

Asm. Auto.

CA / REV / REP. / 24 HRS

Des. of Damages: Frt / Rear / O/S W/S / UIC / Rooftop or

Date:

Person Contacted:

Vehicle: IN / OUT

The UIC / Chassis frame / Body Structure affected due to collision.

Date / Time

Action / Instruction

98830, 8 days.

RECEIVED 11 SEP 2019

Date/Time, File Pass to?



Preli. Report

1) 11/9 Typist



Final Report

Date/Time, File Return to?

2)

Days Of Repair:

8

Resurvey No. of Trip:

2

Add Fee:



Site Insp. (\$)



Interview (\$)



Tech. Invs (\$)



Week end (\$)

Survey Fee:

Transportation:

S + RS: \$

Photos

Others

TOTAL

170
50
50 + 50
64
80
464

Report Format:

TP

Lump Sum / Fee: 8242

Nivitha (LKK Auto)

From: Tan Wee Chiau <tanweechiau@insightadjusters.com>
Sent: Thursday, 1 August 2019 10:45 AM
To: 'bryanang@lkkauto.com'
Cc: 'assignments@lkkauto.com'
Subject: [IA2019-39052]/TWC- Insured: Angliss Singapore Pte Ltd; Impact damage to Third Party' vehicle caused by forklift on 9 July 2019
Attachments: angliss photo.docx; YP7490S - Q.PDF
Importance: High

claim against TMI

Our Ref: IA2019-39052/TWC

Dear Mr Bryan,

The above matter refers.

We have our Principal's Insurers' instruction to appoint you in carrying out an assessment on the damage sustained to the Third Party's vehicle bearing registration No. YP 7490S.

Please conduct the damage assessment on a "Without Prejudice" basis and appreciate that you could contact Mr David Yap of ASM Automotive Services Pte Ltd at 9799 3771 for the inspection.

We herein attach the photographs or repair estimate of the affected Third Party's vehicle for your perusal.

We shall now await your further advice and assessment report on the repair cost of the affected Third Party's vehicle.

Best regards,
Tan Wee Chiau
E-Mail : tanweechiau@insightadjusters.com

Insight Adjusters and Surveyors Pte Ltd
133 Cecil Street, #14-02
Keck Seng Tower
Singapore 069535
(65) 6223 2008 • Fax : (65) 6226 2356

<http://www.insightadjusters.com>

- Loss Adjuster of the Year, Asia Insurance Industry Award
- A Singapore SME 1000 Company 2019
- CESAM Average Agents, AIMU Correspondents

*CONFIDENTIAL NOTE: The information contained in this email is intended only for the use of the individual or entity named above and may contain information that is privileged, confidential and exempt from disclosure under applicable law.

If the reader of this message is not the intended recipient, you are hereby notified that any dissemination, distribution or copying of this communication is strictly prohibited.

If you have received this message in error, please immediately notify the sender and delete the mail. Thank you.

Denise Tay (LKKAuto)

From: ASM Jaclyn <jaclynlai@asmauto.com.sg>
Sent: Wednesday, 11 September 2019 11:35 AM
To: Denise Tay (LKKAuto); Taufikh (LKKAuto)
Cc: ASM Yandy
Subject: RE: YP7490S

Dear Denise,

Any contact number?

Best Regards,

Jaclyn Lai

Assistant Manager

Claims & Operation

ASM Automotive Services Pte Ltd

No. 13, Pioneer Sector 1, Singapore 628424.

Hp: 9236 8218 | DID: 6265 0026 | Fax: 6265 6068

Web: www.asmauto.com.sg

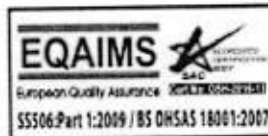

From: Denise Tay (LKKAuto) [mailto:denisetay@lkkauto.com]
Sent: Wednesday, 11 September 2019 11:33 AM
To: ASM Jaclyn; Taufikh (LKKAuto)
Cc: ASM Yandy
Subject: RE: YP7490S

Dear Jaclyn,

Thanks for your acceptance.

Please liaise with Tan Wee Chiau

E-Mail : tanweechiau@insightadjusters.com

Best Regards,

Denise Tay | Case Handler

LKK Auto Consultants Pte Ltd

Phone: 6256-3561 | email: sur@lkkauto.com | fax: 6256-4315

Blk 51, Paya Ubi Industrial Park, Ubi Avenue 1, #02-25 | S(408933)

From: ASM Jaclyn <jaclynlai@asmauto.com.sg>
Sent: Wednesday, 11 September 2019 11:22 AM
To: Taufikh (LKKAUTO) <Taufikh@lkkauto.com>
Cc: Denise Tay (LKKAUTO) <denisetay@lkkauto.com>; ASM Yandy <yandy@asmauto.com.sg>
Subject: RE: YP7490S

Dear Taufikh,

COR confirmed at PBP \$8242/- and 8 days.

Dear Denise,

Kindly advise who can we liaise for settlement.

Thank you.

Best Regards,

Jaclyn Lai

Assistant Manager

Claims & Operation

ASM Automotive Services Pte Ltd

No. 13, Pioneer Sector 1, Singapore 628424.

Hp: 9236 8218 | DID: 6265 0026 | Fax: 6265 6068

Web: www.asmauto.com.sg



From: Taufikh (LKKAUTO) [<mailto:Taufikh@lkkauto.com>]
Sent: Monday, 9 September 2019 11:14 AM
To: ASM Jaclyn
Cc: Denise Tay (LKKAUTO)
Subject: RE: YP7490S

Hi Jaclyn,

Refer attached, COR \$8242 , 8 days.

Regards

Taufikh

Lkk Auto

From: ASM Jaclyn [<mailto:jaclynlai@asmauto.com.sg>]
Sent: Wednesday, 21 August 2019 9:17 AM
To: taufikh@lkkauto.com
Subject: YP7490S

Dear Taufikh

Kindly refer attached SAS report.

Thank you

Best Regards,

Jaclyn Lai

Assistant Manager

Claims & Operation

ASM Automotive Services Pte Ltd

No. 13, Pioneer Sector 1, Singapore 628424.

Hp: 9236 8218 | DID: 6265 0026 | Fax: 6265 6068

Web: www.asmauto.com.sg

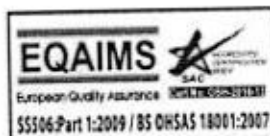

This email has been checked for viruses by AVG antivirus software.
www.avg.com



Auto
Consultants
Pte Ltd

51 UBI AVE 1, #01-25 PAYA UBI INDUSTRIAL PARK, SINGAPORE 408933 TEL : (065) 62563561 FAX : (065) 62564315

Your Ref: TBA

Date: 22/8/2019

Our Ref: CS/IAS19013483/T1td3

INSIGHT ADJUSTERS AND SURVEYORS PL
Without Prejudice

Dear Sirs/Mdm

PRELIMINARY ADVICE OF VEHICLE NO. YP 7490S

Please be informed that we had conducted the inspection of the above mentioned vehicle on 22/08/2019 at the premises of M/s ASM Automotive and have the following to report:-

Workshop Estimate Amount	: S\$ 9,780.00
Revised Estimate Amount	: S\$ 7,980.00
"Check" Items Amount	: S\$ 500.00
Market Value	: S\$ -
LTA Reimbursement Value	: S\$ -
Nett Value	: S\$ -

Description of Damage:

The vehicle sustained damages at the N/S portion.

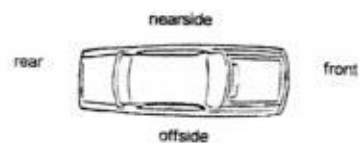

Comments/ Present Status:

Damages Consistent.
Estimated normal period of repair 8 Days

Yours faithfully
Taufikh
Licensed Appraiser

Denise Tay (LKKAUTO)

From: Denise Tay (LKKAUTO)
Sent: Thursday, 22 August 2019 11:24 AM
To: Admin-D (LKKAUTO); 'Tan Wee Chiau'; Bryan Ang (LKKAUTO)
Cc: assignments; SUR
Subject: RE: [IA2019-39052]/TWC- Insured: Angliss Singapore Pte Ltd; Impact damage to Third Party' vehicle caused by forklift on 9 July 2019
Attachments: PRELI ADVISED OF YP 7490S.pdf

Dear Sir/Madam,

Enclosed preliminary revised of vehicle **YP 7490S**

Best Regards,

Denise Tay | Case Handler

LKK Auto Consultants Pte Ltd

Phone: 6256-3561 | email: denisetay@lkkauto.com | fax: 6256-4315

Blk 51, Paya Ubi Industrial Park, Ubi Avenue 1, #02-25 | S(408933)

From: Admin-D (LKKAUTO) <admin-d@lkkauto.com>
Sent: Thursday, 1 August 2019 11:45 AM
To: 'Tan Wee Chiau' <tanweechiau@insightadjusters.com>; Bryan Ang (LKKAUTO) <bryanang@lkkauto.com>
Cc: assignments <assignments@lkkauto.com>; SUR <sur@lkkauto.com>
Subject: RE: [IA2019-39052]/TWC- Insured: Angliss Singapore Pte Ltd; Impact damage to Third Party' vehicle caused by forklift on 9 July 2019

Dear Sir/Mdm,

Thank you for the assignment.

Please be informed that vehicle is not in the workshop, repairer will arrange.

Best Regards

G.NIVITHA

LKK Auto Consultants Pte Ltd

Phone: 6841-1972 | email: assignments@lkkauto.com | fax: 6256-4315

Blk 51, Paya Ubi Industrial Park, Ubi Avenue 1, #02-25 | S(408933)

From: Tan Wee Chiau [<mailto:tanweechiau@insightadjusters.com>]
Sent: Thursday, 1 August 2019 10:45 AM
To: 'bryanang@lkkauto.com' <bryanang@lkkauto.com>
Cc: 'assignments@lkkauto.com' <assignments@lkkauto.com>
Subject: [IA2019-39052]/TWC- Insured: Angliss Singapore Pte Ltd; Impact damage to Third Party' vehicle caused by

SINGAPORE ACCIDENT STATEMENT

IMPORTANT NOTICE

1. Please report correctly the details of the accident to speed up the claims process.
2. This Form must be completed by the Policyholder and/or the Authorised Driver.
3. Information provided must be as truthful and accurate as possible. Any wilful misrepresentation or withholding of material facts may allow insurance companies to repudiate policy liability.
4. The issue and acceptance of this Form by insurance companies is not an admission of policy liability on the part of the insurance companies.
5. Any false reporting may be referred to the Police for investigation.
6. This report will be forwarded by the insurers of the GIA Records Management Centre established by the General Insurance Association of Singapore (GIA) for archiving and that copies of this report will, for a fee, be made available upon application by interested parties.
7. By the lodgement of this report to the insurers, you hereby consent to the archiving of this report at the centre and to copies of the report being made available aforesaid.

ACCIDENT STATEMENT

Date Of Report 10/07/2019 14:15
 Date Of Accident 09/07/2019 10:25
 Exact Location Of Accident 232 PANDAN LOOP
 Country/State of Loss SINGAPORE

DETAILS OF OWN VEHICLE

Vehicle Registration Number YP7490S
Insured/Policyholder
 Name Of Registered Owner OMNI AQUATIC SUPPLIES PTE LTD
 Co Reg No 200801642D
 Email Address SALES@OMNIFROZENFOOD.COM.SG
 Mobile Phone No (LOCAL) +65-83818781
 Alternative Phone No OFFICE-67743059

Vehicle Particulars

Manufacturer MITSUBISHI
 Model CANTER-3.0 D FEB21ER4SDEB (CBU) (M)
 Exact Purpose for which vehicle was being used at time of accident GOODS DELIVERY
 Are you claiming under your own insurance policy for repair to your vehicle? NO
 If No, Please state action to be taken THIRD PARTY
 Vehicle Category COMMERCIAL VEHICLE

Insurance Company

Name of Insurance Company AXA INSURANCE PTE LTD
 Type Of Coverage COMPREHENSIVE
 Fleet Policy NO
 Policy Number VCA/P2176784
 Cover Note Number

Driver

Name of Driver NAING LINN OO
 Passport No/FIN G6331238Q
 Date Of Birth 06/02/1987
 Occupation OUTDOOR
 Date Of Driving Pass 19/04/2018
 Driving Experience 1 YEAR AND 2 MONTHS
 Gender MALE
 Mobile Number (LOCAL) +65-83818781
 Fax Number
 Contact Number
 Email Address NOEMAIL

Address	149 PANDAN LOOP SINGAPORE
Postcode	128347
Was driver an employee of the Insured's Company	YES
If No, Relationship of the Driver with the Insured	
Vehicle Registration Number of Driver's Own Vehicle	-
	-
Insurance Company of Driver's Own Vehicle	-
	-

General Information of the Accident

Type Of Accident	HIT AND RUN / VANDALISM / DAMAGED WHILST PARKED
Weather Conditions	CLEAR
Road Surface	DRY

Other Information

Was any foreign vehicle involved in this accident?	NO
Number of vehicles (including own vehicle) involved in the accident	2
Was any body injured in the Accident?	NO
Was any injured conveyed to hospital by ambulance?	NO
Was any other material or property damaged?	YES
I have been approached by unknown person(s) soliciting/offering accident claims assistance.	NO
Number of Passengers (Including Driver)	0

Details of Police Action

Was the accident reported to the police?	NO
If Yes, Please state which Police Station	
Was notice of intended Prosecution given?	NO
If Yes, against whom?	

Circumstances of Accident

REFER TO ATTACHED SKETCH PLAN

Attachment(s)

Are accident photos available for attachment?	YES
Was there any video captured by Car Camera?	YES
Was there any audio recorded?	NO

DETAILS OF OTHER VEHICLE PROPERTY 1

Vehicle Registration Number	NIL
Vehicle Make/Model/Colour	FORKLIT
Details Of Properties	
Vehicle Category	MOBILE EQUIPMENT
Name of Driver	NIL
NRIC/Passport Number	
Contact Number	67788787
Address	232 PANDAN LOOP SINGAPORE
Postcode	
Insurance Company Name	
Nature Of Damage	
No. Of Passenger (Including Driver)	1

Sketch Plan

IMPORTANT NOTICE

1. Please report correctly the details of the accident to speed up the claims process.
2. This Form must be completed by the Policyholder and/or the Authorized Driver.
3. Information provided must be as truthful and accurate as possible. Any willful misrepresentation or withholding of material facts may allow insurance companies to repudiate policy liability.
4. The issue and acceptance of this Form by insurance companies is not an admission of policy liability on the part of the insurance companies.
5. Any false reporting may be referred to the Police for investigation.
6. This report will be forwarded by the insurers to the GIA Records Management Centre established by the General Insurance Association of Singapore (GIA) for archiving and that copies of this report will for a fee be made available upon application by interested parties.
7. By the lodgement of this report to the insurers, you hereby consent to the archiving of this report at the centre and to copies of the report being made available aforesaid.

6. Consent under the Personal Data Protection Act (PDPA)

I understand, acknowledge, agree and consent that:

- (a) My insurer, my workshop and the General Insurance Association of Singapore ("GIA") may/are permitted to collect, use, disclose and/or process my personal data/personal information set out in this form and any other personal information provided by me or possessed by my insurer (collectively the "Personal Information") and disclose and transfer such Personal Information to all insurer(s) who have insured vehicle(s) involved in this accident (all insurer(s) who have insured vehicle(s) involved in this accident shall be collectively referred to as the "Insurers"), the Insurers' lawyers/law firms, the Monetary Authority of Singapore and any relevant government agency/authority (such as the police), for the purpose(s) of:
- (i) processing, handling and/or dealing with my claims including the settlement of the claims and any necessary investigations relating to the claims;
 - (ii) investigating the accident and/or my claims;
 - (iii) carrying out and/or dealing with my instructions or responding to any enquiries by me;
 - (iv) administering my claims (including the mailing of correspondence, statements, invoices, reports or notices to me, which could involve disclosure of certain personal data about me to bring about delivery of the same as well as on the external cover of envelopes/mail packages); and/or
 - (v) complying with applicable law in administering, processing, handling and/or dealing with my claims, (collectively the "Purposes")
- (b) all insurer(s) who have insured vehicle(s) involved in this accident and the Insurers' lawyers/law firms, may/are permitted to collect, use, disclose and/or process my Personal Information for one or more of the above Purposes; and
- (c) my Personal Information may/can be disclosed by any of the Insurers and/or GIA to their third party service providers or agents (including their lawyers/law firms), which may be sited outside of Singapore, for one or more of the above Purposes.
- (d) my Personal Information will also be collected and used to compile claims history for the purpose of fraud detection, investigation and management in present and all future claims.
- (e) the information so collected under (d) above may be shared / disclosed:
- (i) to all insurers and/or any other third parties that assist in evaluating, investigating, controlling or managing fraud, regulators, law enforcement and government agencies as reasonably required for the purposes stated; or
 - (ii) for complying with requirements under any regulations, laws or court orders.



Policyholder's Signature
Date & Time

10/7/19

Driver's Signature
(If other than the policyholder)
Date & Time

[Signature]

THAYNTON HOLDINGS PTE LTD
EXTERNAL INSURANCE DEPARTMENT
NAME & DESIGNATION
DESIGNATION: *[Signature]* DATE: 10/7/19

Reporting Centre Personnel's Signature
Name: *[Signature]*
Munir / WONG CHEE WEE
uPIC / Pin No: 6721809911

Sketch Plan #2

SKETCH PLAN

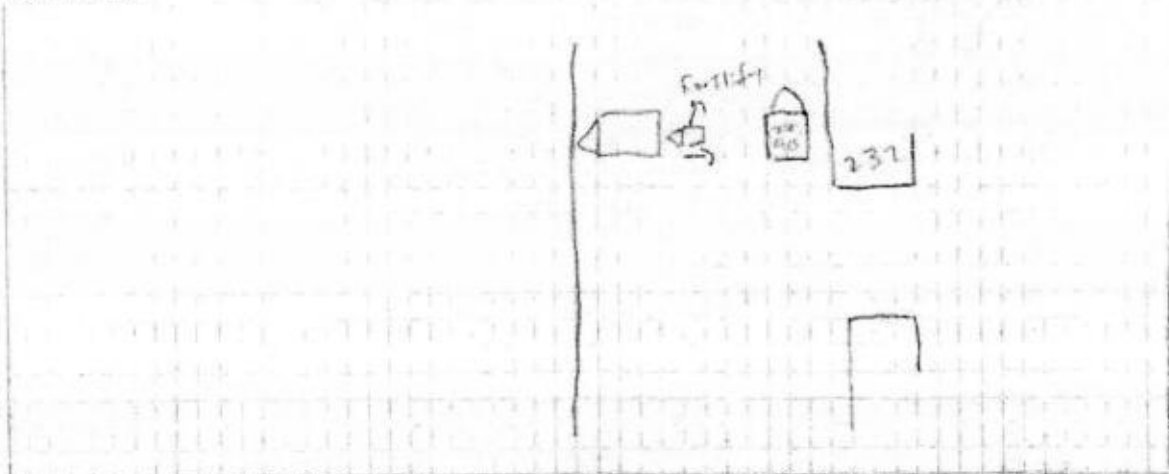

DESCRIBE CIRCUMSTANCES OF THE ACCIDENT

My lorry, VP 74903 was stationary at the side. ~~Suddenly~~ suddenly a
 forklift whereby the goods came crushing into the side of my lorry.
 As a result, the side of the lorry was dented in.

IMPORTANT NOTE

Under General Condition - Conduct of Claim of the Motor Policy, you have to decide within 21 days of occurrence or discovery of damage whether or not to claim under the policy. Please check your policy for more information.

DECLARATION

I/We declare the foregoing particulars are true in every respect.



Policyholder's Signature
 Date & Time

10/7/19

Driver's Signature
 (if driver is not the policyholder)
 Date & Time

[Signature]

COMPTON DELTA ENGINEERING PTY LTD
 EXTERNAL BUSINESS DIV. FRANK BARNICH
 NAME & SIGNATURE
 DESIGNATION: DATE 10/7/19

Reporting Clerk/Personnel's Signature
 Name:
 NPIC / File No. 47780996

Page 8



ASM Automotive Services Pte Ltd

No 13, Pioneer Sector 1, Singapore 628424
Main Line: 6265 0980 Fax: 6265 6068
Email: enquiry@asmauto.com.sg
Co. / GST Reg. No.: 201203813C



FROM : Jaclyn Lai
TEL. NO. : 6265-0026 / 9236-8218
EMAIL : jaclynlai@asmauto.com.sg
TO : Omni Aquatic Supplies Pte Ltd

DATE : 18/7/2019
VEHICLE NO. : YP 7490 S
MODEL NO. : MIT CANTER FEB21ER4SDEB
CHASSIS NO. : FEB21EA21585
ENGINE NO. : 4P10C75640
LTA REG DATE : 13/10/2017
CLAIM TYPE : Third Party
D.O.A : 9/7/2019
CLAIM REF NO. : asm/AC19061/JL

Quotation for Accident Repair

S/N	SPARE PARTS (SPECIAL NETT)	QUANTITY	UNIT PRICE	AMOUNT	
1	Side panel, left	1	\$ 4,800.00	\$ 4,800.00	4200.00
2	Alum. corner guard with bitting, LH (top & bottom)	2	\$ 450.00	\$ 900.00	900.00
3	Fiber end cap, LH (top & bottom)	2	\$ 40.00	\$ 80.00	80.00
4	Alum. checker plate 1.5mm, 4ft x 8ft, LH interior	2	\$ 350.00	\$ 700.00	700.00
SUB-TOTAL :				\$ 6,480.00	5880.00
					loss 10% 5242
					2100
LABOUR CHARGES					
1	To dismantle rear door panel, stainless steel frame to enable remove and replace left side whole panel. Reconseal box with sikaflex on interior and exterior. Including final touch-up and cleaning.			\$ 2,800.00	
2	Logo writing on left side panel.			\$ 850.00	
TOTAL LABOUR :				\$ 3,300.00	2950.00
GRAND TOTAL :				\$ 9,780.00	8242.00

Tanfik 97495749
20/8/19 @ 12pm. WP
* Resurvey new parts & old parts.
sur@lkkauto.com
8 days

LKK Auto Consultants hence notify the Repairer of the following:

- To resurvey before/after spray painting
- To display damaged part(s) during resurvey
- Parts prices are subject to confirmation
- Third party survey is on a "Without Prejudice" basis
- No illegal modification(s) is allowed
- Supplementary item(s) must be resurveyed and is subject to final approval from Insurance Company

Acknowledged by Repairer
Signature:
Date:



QUOTE

ASM Automotive
No: 13 Pioneer Sector 1, Singapore 628424

Date
28 Aug 2019

Expiry
29 Aug 2019

Quote Number
QU-1970

YOUPRINT
PRODUCTIONS PTE LTD
Blk 30 Kallang Place
#03-12
SINGAPORE 339159
GST REG: 201414227M

Description	Quantity	Unit Price	Tax	Amount SGD
Vehicle no: YP7490S - to dismantle , clean , supply install and print on the left panel of the box truck @ \$850.00 *full payment upon collection of truck * parking charges applies * lead time 2-3 working day	1.00	850.00	7%	850.00
Contact person: Jaslyn Contact number: 9236 8218				
			Subtotal	850.00
			TOTAL LOCAL SUPPLY OF GOODS AND SERVICES 7%	59.50
			TOTAL SGD	909.50

Terms

- Client to provide working file with min 300 dpi
 - Cut off time for artwork confirmation at 12 pm daily
 - ** For orders delivered within 48 hours, Preview will not be provided
- Disclaimer: Please check all artwork before confirmation. Youprint will not take responsibility for any errors once artwork is confirmed by customer.

**LKK Auto Consultants Pte Ltd**

51 Ubi Ave 1 #01-25 Paya Ubi Industrial Park, Singapore 408933

TEL: 6256 3561 FAX: 6256 4315

Reg. No: 199607198R GST Reg. No. 19-9607198-R

Affiliated to Federation Internationale Des Experts En Automobile

INSIGHT ADJUSTERS AND SURVEYORS PL

Ref : CS/IAS19013483/T1td3s2

133 CECIL STREET
#14-02 KECK SENG TOWER
SINGAPORE 069535

Date : 11-09-2019



Code : IAS

1. Policy Particulars :- THIRD PARTY CLAIM

Insured Veh.	FORKLIFT	Veh. Inspected	YP 7490S
Policy No.		Coverage (\$)	0.00
Claim No.	IA2019-39052/TWC	Excess (\$)	0.00
Assign From	TAN WEE CHIAU	Assign Date	01/08/2019

2. Vehicle Particulars & Condition

Make & Model	mitsubishi canter feb21	c.c	2998
Engine No.	HIDDEN	Year of Reg.	2017
Chassis No.	FEB21EA21585	Colour	WHITE
Odometer	42960	Steering	IN ORDER
Brakes	IN ORDER	Modification	NIL
General	GOOD		

3. Conditions of Tyres

	Size	Make	Balance
R/H Front Tyre	195/55 R15	BRIDGESTONE	6 mm
L/H Front Tyre	195/55 R15	BRIDGESTONE	6 mm
R/H Rear Tyre	195/55 R15	BRIDGESTONE	6/6 mm
L/H Rear Tyre	195/55 R15	BRIDGESTONE	6/6 mm

4. Description of Damages

THE VEHICLE SUSTAINED DAMAGES AT THE N/S BODY. DAMAGES SEE DETAILS.
--

5. General Information

Accident Date	09/07/2019	Inspection Date	20/08/2019
Survey held at	HWEE JAN - 82 JOO KOON CIRCLE		
Repairer	ASM AUTOMOTIVE SERVICES PTE LTD		

5a. Remarks

A)THE INSPECTION WAS CONDUCTED ON A"WITHOUT PREJUDICE" BASIS. B)IN ACCORDANCE TO YOUR INSTRUCTIONS, WE HAVE NOT AUTHORISED REPAIRS.
--

5b. Estimate Days of Repair

ESTIMATED NORMAL PERIOD FOR REPAIR:	8 Working Days
-------------------------------------	-----------------------



LKK Auto Consultants Pte Ltd

51 Ubi Ave 1 #01-25 Paya Ubi Industrial Park, Singapore 408933

TEL: 6256 3561 FAX: 6256 4315

Reg. No: 199607198R GST Reg. No. 19-9607198-R

Page No.:1 of 1

ADJUSTMENT ON REPAIR COST FOR VEHICLE NO. YP 7490S

Qty	Description of Parts	Condition	Estimate By Workshop (\$)	Our Adjusted (\$)
REPLACEMENT OF PARTS				
1	SIDE PANEL, LEFT	CRACKED	4,800.00	4,200.00
2	ALUM, CORNER GUARD WITH BITTING, LH (TOP & BOTTOM) @ \$450.00	NECESSARY	900.00	900.00
2	FIBER END CAP, LH (TOP & BOTTOM) @ \$40.00	NECESSARY	80.00	80.00
2	ALUM, CHECKER PLATE 1.5MM, 4FT X 8FT, LH INTERIOR @ \$350.00	NECESSARY	700.00	700.00
	LESS 10% DISCOUNT		-	-588.00
			6,480.00	5,292.00
SPECIAL NETT ITEMS				
1	LOGO WRITING ON LEFT SIDE PANEL (SN)	NECESSARY	850.00	850.00
			850.00	850.00
LABOUR				
	TO DISMANTLE REAR DOOR PANEL, STAINLESS STEEL FRAME TO ENABLE REMOVE AND REPLACE LEFT SIDE WHOLE PANEL. RECONSEAL BOX WITH SIKAFLEX ON INTERIOR AND EXTRIOR. INCLUDING FINAL TOUCH-UP AND CLEANING.		2,800.00	2,100.00
			2,800.00	2,100.00
GRAND TOTAL			10,130.00	8,242.00
RECOMMENDED COST OF REPAIRS				8,242.00

Report Ref No. CS/IAS19013483/T1td3s2

MOHAMAD TAUFIKH

M.MATAI, AMSAE-A

Automotive Assessor

ADRIAN LING WAI PING

B.Eng,AMSOE,AMIRTE,AMSAE-A,M.MATAI

Licensed Appraiser

DISCLAIMER OF LIABILITY TO THIRD PARTIES:- This Report is made solely for the use and benefit of the Client named on the front page of this Report.

No liability of responsibility whatsoever, in contract or tort, is accepted to any third party who may rely on the Report wholly or in part. Any third party acting or relying on this Report, in whole or in part, does so at his or her own risk.