

SINGAPORE ACCIDENT STATEMENT

IMPORTANT NOTICE

1. Please report correctly the details of the accident to speed up the claims process.
2. This Form must be completed by the Policyholder and/or the Authorised Driver.
3. Information provided must be as truthful and accurate as possible. Any wilful misrepresentation or withholding of material facts may allow insurance companies to repudiate policy liability.
4. The issue and acceptance of this Form by insurance companies is not an admission of policy liability on the part of the insurance companies.
5. **Any false reporting may be referred to the Police for investigation.**
6. This report will be forwarded by the insurers of the GIA Records Management Centre established by the General Insurance Association of Singapore (GIA) for archiving and that copies of this report will, for a fee, be made available upon application by interested parties.
7. By the lodgement of this report to the insurers, you hereby consent to the archiving of this report at the centre and to copies of the report being made available aforesaid.

ACCIDENT STATEMENT	
Date Of Report	26/07/2019 15:30
Date Of Accident	22/07/2019 20:45
Exact Location Of Accident	BALESTIER RD B4 ENTERING TO CTE
Country/State of Loss	SINGAPORE
DETAILS OF OWN VEHICLE	
Vehicle Registration Number	SJU5248R
Insured/Policyholder	
Name Of Registered Owner	BLAZE MOTORING PTE LTD
Co Reg No	-
Email Address	NOEMAIL
Mobile Phone No	
Alternative Phone No	OFFICE-91449265
Vehicle Particulars	
Manufacturer	HYUNDAI
Model	AVANTE
Exact Purpose for which vehicle was being used at time of accident	COMMERCIAL
Are you claiming under your own insurance policy for repair to your vehicle?	NO
If No, Please state action to be taken	REPORTING ONLY
Vehicle Category	PRIVATE HIRE
Insurance Company	
Name of Insurance Company	TOKIO MARINE INSURANCE SINGAPORE LTD
Type Of Coverage	THIRD PARTY FIRE AND/OR THEFT
Fleet Policy	NO
Policy Number	MI001412
Cover Note Number	-
Driver	
Name of Driver	MEERA LABBAI MARICAR
NRIC No	S8671579A
Date Of Birth	04/06/1986
Occupation	OUTDOOR
Date Of Driving Pass	25/10/2006
Driving Experience	12 YEARS AND 8 MONTHS
Gender	MALE
Mobile Number	(LOCAL) +65-91301220
Fax Number	
Contact Number	
EMail Address	NOEMAIL

Address	BLK 74 WHAMPOA DR #09-312
Postcode	320074
Was driver an employee of the Insured's Company	NO
If No, Relationship of the Driver with the Insured	OTHER - HIRER
Vehicle Registration Number of Driver's Own Vehicle	-
	-
Insurance Company of Driver's Own Vehicle	-
	-
	-

General Information of the Accident

Type Of Accident	COLLISION - HEAD TO REAR
Weather Conditions	CLEAR
Road Surface	DRY

Other Information

Was any foreign vehicle involved in this accident?	NO
Number of vehicles (including own vehicle) involved in the accident	2
Was any body injured in the Accident?	NO
Was any injured conveyed to hospital by ambulance?	
Was any other material or property damaged?	YES
I have been approached by unknown person(s) soliciting/offering accident claims assistance.	NO
Number of Passengers (Including Driver)	4
Passenger 1	NAME: : UNKNOWN GENDER: : MALE
Passenger 2	NAME: : UNKNOWN GENDER: : MALE
Passenger 3	NAME: : UNKNOWN GENDER: : FEMALE

Details of Police Action

Was the accident reported to the police?	NO
If Yes, Please state which Police Station	
Was notice of intended Prosecution given?	NO
If Yes, against whom?	

Circumstances of Accident

I WAS TRAVELLING ALONG BALESTIER RD TWDS CTE, I WAS QUEUING BEHIND VEH B ENTERING TO CTE, SUDDENLY VEH B STOP , I MANAGE TO STOP BUT CANNOT STOP IN TIME, AS THE RESULT, MY VEH LIGHTLY HIT ONTO VEH B REAR PORTION.

Attachment(s)

Are accident photos available for attachment?	YES
Was there any video captured by Car Camera?	NO
Was there any audio recorded?	NO

DETAILS OF OTHER VEHICLE PROPERTY 1

Vehicle Registration Number	SMJ7748Z
Vehicle Make/Model/Colour	
Details Of Properties	
Vehicle Category	PRIVATE CAR
Name of Driver	

NRIC/Passport Number

Contact Number

Address

Postcode

Insurance Company Name

Nature Of Damage

No. Of Passenger (Including Driver)

SKETCH PLAN

IMPORTANT NOTICE

1. Please report **correctly** the details of the accident to speed up the claims process.
2. This Form must be **completed by the Policyholder and/or the Authorised Driver**.
3. Information provided must be as **truthful and accurate as possible**. Any wilful misrepresentation or withholding of material facts may allow insurance companies to **repudiate policy liability**.
4. The issue and acceptance of this Form by insurance companies is not an admission of policy liability on the part of the insurance companies.
5. **Any false reporting may be referred to the Police for investigation.**
6. The report will be forwarded by the insurers of the GIA Records Management Centre established by the General Insurance Association of Singapore (GIA) for archiving and that copies of this report will for a fee be made available upon application by interested parties.
7. By the lodgment of this report to the insurers, you hereby consent to the archiving of this report at the centre and to copies of the report being made available aforesaid.
8. **Consent under the Personal Data Protection Act (PDPA)**

I understand, acknowledge, agree and consent that:

- (a) My insurer, my workshop and the General Insurance Association of Singapore ("GIA") may/are permitted to collect, use, disclose and/or process my personal data/personal information set out in this [form] and any other personal information provided by me or possessed by my insurer (collectively the "Personal Information") and disclose and transfer such Personal Information to all insurer(s) who have insured vehicle(s) involved in this accident (all insurer(s) who have insured vehicle(s) involved in this accident shall be collectively referred to as the "Insurers"), the Insurers' lawyers/law firms, the Monetary Authority of Singapore and any relevant government agency/authority (such as the police), for the purpose(s) of:
 - (i) processing, handling and/or dealing with my claims including the settlement of the claims and any necessary investigations relating to the claims;
 - (ii) investigating the accident and/or my claims;
 - (iii) carrying out and/or dealing with my instructions or responding to any enquiries by me;
 - (iv) administering my claims (including the mailing of correspondence, statements, invoices, reports or notices to me, which could involve disclosure of certain personal data about me to bring about delivery of the same as well as on the external cover of envelopes/mail packages); and/or
 - (v) complying with applicable law in administering, processing, handling and/or dealing with my claims.(collectively the "Purposes")
- (b) all insurer(s) who have insured vehicle(s) involved in this accident and the Insurers' lawyers/law firms, may/are permitted to collect, use, disclose and/or process my Personal Information for one or more of the above Purposes; and
- (c) my Personal Information may/can be disclosed by any of the Insurers and/or GIA to their third party service providers or agents(including their lawyers/law firms), which may be sited outside of Singapore, for one or more of the above Purposes.
- (d) my Personal Information will also be collected and used to compile claims history for the purpose of fraud detection, investigation and management in present and all future claims.
- (e) the information so collected under (d) above may be shared / disclosed:
 - (i) to all insurers and/or any other third parties that assist in evaluating, investigating, controlling or managing fraud, regulators, law enforcement and government agencies as reasonably required for the purposes stated, or
 - (ii) for complying with requirements under any regulations, laws or court orders.



Policyholder's Signature
Date & Time:

Driver's Signature
(If driver is not the policyholder)
Date & Time:

Reporting Centre Personnel's Signature
Name:
NRIC/FIN No.:

SKETCH PLAN

CTE

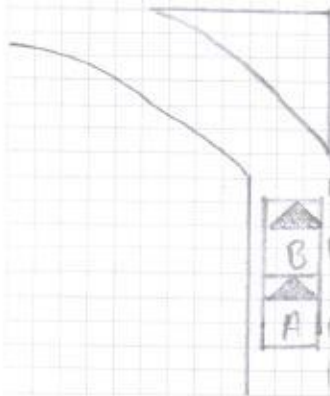

A = SJU 5248 R

B = SHJ 7748 Z

Balestien Rd

DESCRIBE CIRCUMSTANCES OF THE ACCIDENT

Please Refer to Statement

DECLARATION

We declare the foregoing particulars are true in every respect.



Policyholder's Signature
Date & Time:

[Signature]

Driver's Signature
(If driver is not the policyholder)
Date & Time:

[Signature]

Reporting Centre Personnel's Signature
Name:
NRIC/FIN No.:

REPUBLIC OF SINGAPORE
IDENTITY CARD NO. S8671579A



Name
MEERA LABBAI MARICAR

நீரா லெப்பை மரைக்கார்

Race
INDIAN

Date of birth
04-06-1986

Sex
M

Country of birth
INDIA



REPUBLIC OF SINGAPORE DRIVING LICENCE

Licence Number S8671579A

Name
MEERA LABBAI MARICAR

Birth Date: 04 Jun 1986

Issue Date: 25 Oct 2006



001454449K

4273874



NRIC No. S8671579A



Date of issue
03-09-2008

APT BLK 74 WHAMPOA DRIVE #09-312
SINGAPORE 320074

NRIC No: S8671579A Date: 18/03/2018

YOU ARE LICENSED TO DRIVE VEHICLES IN THE FOLLOWING CLASS(ES)

PASS DATE

Class 3 Motor Cars=< 3000kg with =<7 passengers, exclusive of the driver; and other motor vehicles =< 2500kg 25 Oct 2006



Licence No: S8671579A

MP 428A

Tokio Marine Insurance Singapore Ltd.

(Company Reg. No.: 192300014M) (GST Reg No.: M2-0000023-4)

20 McCallum Street #09-01 Tokio Marine Centre Singapore 069046

T: (65) 6221 6111 F: (65) 6221 4355 / (65) 6224 0895 E: tmls@tokiomarine.com.sg W: www.tokiomarine.com

A member of the
Tokio Marine Group



TOKIO MARINE
INSURANCE GROUP

Certificate of Insurance

FORM MX1 H

MOTOR VEHICLES (THIRD-PARTY RISKS AND COMPENSATION) ACT (CHAPTER 189)

MOTOR VEHICLES (THIRD-PARTY RISKS AND COMPENSATION) RULES, 1960

ROAD TRANSPORT ACT, 1987 (MALAYSIA)

MOTOR VEHICLES (THIRD-PARTY RISKS) RULES, 1959 (MALAYSIA)

Policy No.: MI001412 (Private Car)

- | | | |
|---|---|---------------------------------------|
| 1. Index Mark and Registration Number of Vehicle | SJU5248R | Chassis No.: KMHDU41BMAU902602 |
| 2. Name of Policyholder | BLAZE MOTORING PTE. LTD. | |
| 3. Effective date of the Commencement of Insurance for the purposes of the Act | 13/09/2018 (00:00:00) | |
| 4. Date of Expiry of Insurance | 14/12/2019 | |
| 5. Persons or Class of Persons entitled to drive* | Use for the carriage of passengers or goods in connection with the Policyholder's business or the hirer's business.
Use for social domestic and pleasure purpose and business purposes of the Policyholder or of any person to whom the vehicle is hired.
The Policy does not cover:-
1) Use for racing, pace-making, reliability trial or speed-testing.
2) Use whilst drawing a trailer except the towing (other than for reward) of any one disabled mechanically propelled vehicle. | |

* Provided that the Person driving is permitted in accordance with the licensing or other laws or regulations to drive the Motor Vehicle or has been so permitted and is not disqualified by order of a Court of Law or by reason of any enactment or regulation in that behalf from driving the Motor Vehicle. And provided further that the Motor Vehicle is registered under the Road Traffic Act and its registration under the Road Traffic Act has not been cancelled at the time of the accident loss or damage.

6. Limitations as to use*

* Limitations rendered inoperative by Section 8 of the Motor Vehicles (Third-Party Risks and Compensation) Act (Chapter 189) and Section 95 of the Road Transport Act, 1987 (Malaysia), are not to be included under these headings.

We hereby certify that the Policy to which this Certificate relates is issued in accordance with the provision of the Motor Vehicles (Third-Party Risks and Compensation) Act (Chapter 189) and Part IV of the Road Transport Act, 1987 (Malaysia).

Please refer to the Policy Schedule for full details, terms and conditions of the insurance.

IMPORTANT NOTICE

This Certificate is not transferable. During its currency, if the insurance is cancelled for whatsoever reason, you must return the Certificate to Tokio Marine Insurance Singapore Ltd. within 7 days thereof or, if the Certificate has been lost destroyed, you must make a statutory declaration to that effect. Failure to comply with this duty is an offence under Motor Vehicle (Third-Party Risks and Compensation) Act (Chapter 189).

ADDITIONAL INFORMATION

Account No: 1141DDB

Insurance Plan:	Third Party Fire & Theft
Limit for total loss or theft:	Prevailing Market Value
Policy Excess:	Excess-Third Party (Sect II) SGD 1,500.00
Financial Interest:	GENIE FINANCIAL SERVICES PTE. LTD.

TOKIO MARINE INSURANCE SINGAPORE LTD.

Authorised Signature