

(08/11/13) wef

REF:

ASS. REC. BY: Marcus

ASSIGNMENT

From:

Date:

Estimated Cost:

OD / TP / WS / TP RES / OD RES / EVA / INV / MV

To Inspect Vehicle No:

at Workshop m/s

of

Insured:

Policy No.

Claims No.

Sum Insured:

Excess:

(Client's Record)

Make of Veh:

(Policy Condition)

Remark: The veh had commenced its repair at the time of inspection.

Bal. or Market Value:

IDAC Accident Rpt:

Consistent? : Yes or No

GIA / PR Seen:

Consistent? : Yes or No

Est. Repairs:

days

Res.: Yes or No

Lum Sum:

%

3 Val.: Yes or No

CA / REV / REP. / 24 HRS

Date:

Person Contacted:

Vehicle: IN / OUT

Date / Time

Action / Instruction

Veh No:

Yr Regn:

Type: M.Car / M.Cycle / Bus / Van / Lorry / Taxi / Prime Mover /

Truck / Trailer or

Make:

Colour:

Sp. Reading

Eng/No:

C/No:

Gen. Cond: Good / Fair / Poor / Burnt

Steering: In order / Jammed / Leaked / Burnt or

Brake: In order / Jammed / Leaked / Burnt or

Modi: Nil / S/Rim / STD A/Rim or

Tyre Size:

F:

R:

BS / DUN / EXNOVA / GY / FS / LIZA / MIC / OHTSU / PIR / SUMI / TOYO / YOKO or

Front

Rear

R/Bal.

R/Bal.

L/Bal.

L/Bal.

D.O.A.

D.O.I.

Survey held at

Des. of Damages: Frt / Rear / O/S / N/S / U/C / Rooftop or

The U/C / Chassis frame / Body Structure affected due to collision.

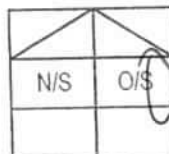

26/6/19 @ 10.23am Email GIA report to NIS/CC
 03/7/19 @ 4.34pm revised to Elaine Ng in Mennan.
 3/7/19 P/P 2400 confirmed with Au. (Red B 2300, 49%)

RECEIVED 04 JUL 2019

Date/Time, File Pass to?

☐

: Preli. Report

1) 03/7/19

☐

: Final Report

Date/Time, File Return to?

2)

Days Of Repair:

Resurvey No. of Trip:

Survey Fee:

Transportation:

Add Fee:

☐

: Site Insp (\$

☐

: Interview (\$

☐

: Tech. Invs (\$

☐

: Weekend (\$

) \$ + RS. \$

) Photos

) Others

TOTAL

Report Format:

Lump Sum / I.B.I. (\$

MER-TP

2400

150

11

161

Note: This document has not been finalised.**LKK Auto Consultants Pte Ltd** (Co.Reg.No:199607198R)51 Ubi Ave 1 #01-25, Paya Ubi Industrial Park
Singapore 408933

Tel: 6256-3561 Fax: 6844-8805 Email: sur@lkkauto.com; assignments@lkkauto.com

To: MSIG Insurance (Singapore) Pte. Ltd.
4 Shenton Way
#21-01 SGX Centre 2
Singapore 068807From: LKK Auto Consultants Pte Ltd
51 Ubi Ave 1 #01-25
Paya Ubi Industrial Park
Singapore 408933

Attn: Elaine Ngu Siau Mei

Date: 03 Jul 2019

Preliminary Advice

Insured Vehicle No	: YN2755Y	Accident Date	: 20/06/2019
TP Vehicle No	: YP6906S	Assignment Date	: 26/06/2019
Make	: ISUZU NQR75UL5A	Est. Duration of Repair	: 3.00
Date of Inspection	: 25/06/2019		
Inspection At	: FASTECH AUTO PTE LTD (HQ) 1 KAKI BUKIT AVE 6, #01-46/48/50 AUTOBAY SINGAPORE 417883		

Point of Impact / General Description of Damages

The vehicle sustained impact / damages o/s rear portion and parts claimed are consistent to the accident.

Repairer's Estimate (Gross)	:S\$	4,700.00
Revised Amount	:S\$	2,400.00
Check Items (Estimated)	:S\$	0.00
Total	:S\$	2,400.00

Lump Sum Repair	:S\$	
-----------------	------	--

Total Loss Consideration

New for Old Value	:S\$	
Pre-Accident Value	:S\$	
COE / PARF Rebate	:S\$	
Salvage Value	:S\$	
Margin for Repair	:S\$	

Remarks

() The vehicle is economical/not economical for repair.

(C) The above survey was conducted on a 'without prejudice' basis.

Shiau Chan (LKKAuto)

From: Shiau Chan (LKKAuto)
Sent: Wednesday, 26 June 2019 10:23 AM
To: Motor Survey
Cc: KKLau; SUR; Accounts (LKKAuto)
Subject: DIRECT SURVEY INSPECTION ON WORKSHOP - FASTECH AUTO PTE LTD, DOA: 20/06/2019, YP 6906S (TP VEHICLE), YN2755Y (OI VEHICLE)
Attachments: YP6906 GIA.pdf

Dear Sir/Madam,

Please be informed that we had inspected the vehicle YP 6906S at M/s: FASTECH AUTO PTE LTD, 1 KAKI BUKIT AVENUE 6 #01-46/48/50 AUTOBAY SINGAPORE 417883.

Enclosed herewith a copy of TP's GIA report. The estimated cost of repair will forward to you shortly.

Meanwhile, kindly provide us the claim reference number for our necessary action.

Best Regards,

Shiau Chan (Ms) | Case Handler

LKK Auto Consultants Pte Ltd

Phone: 6256-3561 | email: siewsc@lkkauto.com | fax: 6256-4315

Blk 51, Paya Ubi Industrial Park, Ubi Avenue 1, #02-25 | S(408933)

[> Back to OneMotoring](#)**Enquire PARF/COE Rebate for Registered Vehicle**

Vehicle Owner Particulars	
Owner ID Type:	Business
Owner ID:	3529E
Vehicle Details	
Vehicle No.:	YP6906S
Vehicle to be Exported:	No
Intended Deregistration Date:	25 Jun 2019
Vehicle Make:	ISUZU
Vehicle Model:	NQR75UL5A
Primary Colour:	White
Manufacturing Year:	2017
Engine No.:	4HK1577293
Chassis No.:	JAAN1R75LH7100245
Maximum Power Output:	-
Open Market Value:	\$37,063.00
Original Registration Date:	02 Aug 2017
First Registration Date:	02 Aug 2017
Transfer Count:	0
Actual ARF Paid:	\$1,854.00
Intended PARF Rebate Details	
PARF Eligibility:	No
PARF Eligibility Expiry Date:	-
PARF Rebate Amount:	\$0.00
Intended COE Rebate Details	
COE Expiry Date:	01 Aug 2027
COE Category:	C - Goods Vehicle & Bus
COE Period(Years):	10
PQP Paid:	\$18,958.00
COE Rebate Amount:	\$15,360.00
Total Rebate Amount:	\$15,360.00

The information contained herein is correct as at 25 Jun 2019

OK

SINGAPORE ACCIDENT STATEMENT

IMPORTANT NOTICE

1. Please report correctly the details of the accident to speed up the claims process.
2. This Form must be completed by the Policyholder and/or the Authorised Driver.
3. Information provided must be as truthful and accurate as possible. Any wilful misrepresentation or withholding of material facts may allow insurance companies to repudiate policy liability.
4. The issue and acceptance of this Form by insurance companies is not an admission of policy liability on the part of the insurance companies.
5. **Any false reporting may be referred to the Police for investigation.**
6. This report will be forwarded by the Insurers of the GIA Records Management Centre established by the General Insurance Association of Singapore (GIA) for archiving and that copies of this report will, for a fee, be made available upon application by interested parties.
7. By the lodgement of this report to the insurers, you hereby consent to the archiving of this report at the centre and to copies of the report being made available aforesaid.

ACCIDENT STATEMENT	
Date Of Report	24/06/2019 13:30
Date Of Accident	20/06/2019 11:45
Exact Location Of Accident	BEDOK CENTRAL (BEHIND KFC)
Country/State of Loss	SINGAPORE

DETAILS OF OWN VEHICLE	
Vehicle Registration Number	YP6906S
Insured/Policyholder	
Name Of Registered Owner	KIM LONG TRADING
Co Reg No	53093529E
Email Address	NOEMAIL
Mobile Phone No	
Alternative Phone No	OFFICE-96265237
Vehicle Particulars	
Manufacturer	ISUZU
Model	NQR 75ULA
Exact Purpose for which vehicle was being used at time of accident	WORK
Are you claiming under your own insurance policy for repair to your vehicle?	NO
If No, Please state action to be taken	THIRD PARTY
Vehicle Category	COMMERCIAL VEHICLE
Insurance Company	
Name of Insurance Company	SOMPO INSURANCE SINGAPORE PTE. LTD.
Type Of Coverage	COMPREHENSIVE
Fleet Policy	NO
Policy Number	D18MTHCVE002192
Cover Note Number	
Driver	
Name of Driver	DENNIS YAP TECK LEONG
NRIC No	S1673926Z
Date Of Birth	28/09/1964
Occupation	OUTDOOR
Date Of Driving Pass	04/04/1986
Driving Experience	33 YEARS AND 2 MONTHS
Gender	MALE
Mobile Number	(LOCAL) +65-96265237
Fax Number	
Contact Number	
Email Address	NOEMAIL

Address	BLK 899 TAMPINES ST 81 #08-736
Postcode	520899
Was driver an employee of the Insured's Company	YES
If No, Relationship of the Driver with the Insured	
Vehicle Registration Number of Driver's Own Vehicle	-
	-
	-
Insurance Company of Driver's Own Vehicle	-
	-
	-

General Information of the Accident

Type Of Accident	SIDE SWIPE
Weather Conditions	CLEAR
Road Surface	DRY

Other Information

Was any foreign vehicle involved in this accident?	NO
Number of vehicles (including own vehicle) involved in the accident	2
Was any body injured in the Accident?	NO
Was any injured conveyed to hospital by ambulance?	NO
Was any other material or property damaged?	YES
I have been approached by unknown person(s) soliciting/offering accident claims assistance.	NO
Number of Passengers (Including Driver)	1

Details of Police Action

Was the accident reported to the police?	NO
If Yes, Please state which Police Station	
Was notice of intended Prosecution given?	NO
If Yes, against whom?	

Circumstances of Accident

PLEASE SEE ATTACHED.

Attachment(s)

Are accident photos available for attachment?	YES
Was there any video captured by Car Camera?	NO
Was there any audio recorded?	NO

DETAILS OF OTHER VEHICLE PROPERTY 1

Vehicle Registration Number	YN2755Y
Vehicle Make/Model/Colour	
Details Of Properties	
Vehicle Category	COMMERCIAL VEHICLE
Name of Driver	UNKNOWN
NRIC/Passport Number	
Contact Number	NA
Address	NA
	NA
Postcode	NA
Insurance Company Name	
Nature Of Damage	NA
No. Of Passenger (Including Driver)	

Accident Sketch Plan

SKETCH PLAN

IMPORTANT NOTICE

1. Please report correctly the details of the accident to speed up the claims process.
2. This form must be completed by the Policyholder and/or the Authorized Driver.
3. Information provided must be as truthful and accurate as possible. Any verbal misrepresentation or withholding of material facts may allow insurance companies to repudiate policy liability.
4. The issue and acceptance of this form by insurance companies is not an admission of policy liability on the part of the insurance companies.
5. Any false reporting may be referred to the Police for investigation.
6. The report will be forwarded by the insurer to the Risk Policy Management Centre established by the General Insurance Association of Singapore (GIAS) for archiving and that copies of this report will be available available upon application by interested parties.
7. By the signing of this form to the insurers, you hereby consent to the archiving of this report at the centre and to copies of the report being made available thereafter.
8. Consent under the Personal Data Protection Act (PDPA)

I understand, acknowledge, agree and consent that:

- (a) My insurer, my workshop and the General Insurance Association of Singapore ("GIAS") may be permitted to collect, use, disclose and/or process my personal data/personal information set out in this form and any other personal information provided by me or provided by my insurer (collectively the "Personal Information") and disclose and transfer such personal information to all insurers who have insured vehicles involved in this accident (all insurers who have insured vehicle(s) involved in this accident shall be collectively referred to as the "Insurers"), the Insurers' lawyers/law firms, the Insurers' company of Singapore and any relevant government agency/department with or without my consent;
- (b) collecting, handling and/or dealing with my claims relating to the occurrence of the event and any necessary investigations relating to the claims;
- (c) investigating the accident and/or claims;
- (d) carrying out and/or dealing with my obligations in responding to any enquiries by me;
- (e) administering my claims (including the making of correspondence, statements, invoices, reports or notices to me which could involve disclosure of my life, personal data, health status and/or details of the claim as well as any other personal or confidential information); and/or
- (f) complying with applicable law in administering, processing, handling and/or dealing with my claims (collectively the "Purposes").
- (g) all Insurers who have insured vehicle(s) involved in the accident and the Insurers' lawyers/law firms, may be permitted to collect, use, disclose and/or process my Personal Information for one or more of the above Purposes; and
- (h) my Personal Information may also be disclosed by any of the Insurers and/or GIAS to their third party service providers or agents (including their lawyers/law firms, which may be based outside of Singapore, for one or more of the above Purposes;
- (i) my Personal Information will also be collected and used to compile claims history for the purpose of fraud detection, investigation and management in present and all future claims;
- (j) my information so collected under (d) above may be shared or disclosed:
 - (i) to all Insurers and/or any other third parties that need to evaluate, investigate, controlling or managing fraud, regulation, law enforcement and government agencies or as reasonably required for the purposes stated, or
 - (ii) for complying with requirements under any regulations, laws or court orders.



Policyholder's Signature
Date & Time:

Driver's Signature
(or Other Insured Policyholder)
Date & Time:



Reporting Centre Personnel's Signature
Name:
NPS/PPN No.:

Return to: 100, North Bridge Road, #10-01, Singapore 078296

Individual Statement

SKETCH PLAN

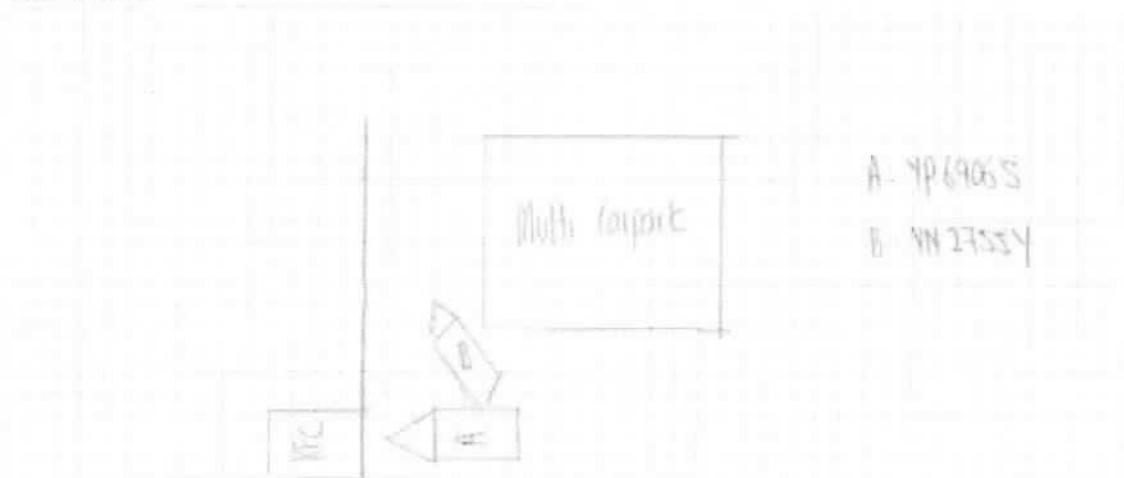

DESCRIBE CIRCUMSTANCES OF THE ACCIDENT

On 20.06.2019 at about 11:45am, I stop my Vehicle A behind KFC.

Suddenly Vehicle B hit on my rear right side portion.

DECLARATION

I/We declare the above particulars are true in every respect

Policyholder's Signature
Date & Time:



Driver's Signature
(If driver is not the policyholder)
Date & Time:

24/6/19
13:25

Reporting Centre Personnel's Signature
Name:
NRIC/FIN No.:

[Signature]

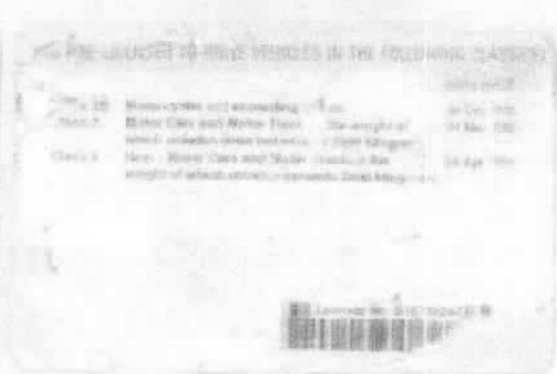



50 Raffles Place, #05-01/06 Singapore Land Tower, Singapore 048633
Tel: 6461 6555 | Fax: 6221 3302 | Website: www.sompo.com.sg
Co. Reg. No.: 198905490E | GST Reg. No.: M200903196

Certificate of Insurance

MOTOR VEHICLES (THIRD-PARTY RISKS AND COMPENSATION) ACT (CHAPTER 189)
MOTOR VEHICLES (THIRD-PARTY RISKS AND COMPENSATION) RULES, 1960
ROAD TRANSPORT ACT, 1987 (MALAYSIA)
MOTOR VEHICLES (THIRD-PARTY RISKS) RULES, 1959 (MALAYSIA)

- Cert No./Policy No. : D18MTHCVE002192
1. Registration No. : YP6906S
2. Insured Name : KIM LONG TRADING
3. Commencement Date : 02 AUGUST 2018 00:00
4. Expiry Date : 01 AUGUST 2019 23:59
5. Coverage : Market value at time of loss - Comprehensive
6. Excess : \$750 - Section I
7. Persons or Classes of Persons entitled to drive*
- Whilst the vehicle is being used in connection with the Insured's business -
 - Any person provided he is in the Insured's employ and is driving on their order or with their permission.
 - Whilst the vehicle is being used for social, domestic or pleasure purposes -
 - Any person who is driving on the Insured's order or with their permission.
- Provided that the person driving is permitted in accordance with the licensing or other laws or regulations to drive the Motor vehicle or has been so permitted and is not disqualified by order of a Court of Law or by reason of any enactment or regulation in that behalf from driving the Motor Vehicle.
- And provided further that the Motor Vehicle is registered under the Road Traffic Act and its registration under the Road Traffic Act has not been cancelled at the time of the accident loss or damage.
8. Limitations as to use*
- Use in connection with the Insured's business.
 - Use for the carriage of passengers (other than for hire or reward) in connection with the Insured's business.
 - Use for social, domestic or pleasure purposes.
- The Policy does not cover
- Use for racing, pacemaking, reliability trial or speed-testing.
 - Use whilst drawing a trailer except the towing of any one disabled mechanically propelled vehicle.
 - Use for the carriage of passengers for hire or reward.
9. ExcelDrive Workshops & Accident Reporting
- It is a condition precedent to liability that the Policyholder shall, together with the Motor Vehicle, call at the Company's Accident Reporting Center and report the accident within 24 hours of the accident or by the next working day thereof.
- It is compulsory to have the accident repairs to the insured vehicle carried out at ExcelDrive Workshops, otherwise claim is not payable.
- In an emergency and for directions to the Company's Accident Reporting Centers, please contact our Emergency Hotline : (65) 6461 6555
- Visit www.sompo.com.sg for list of ExcelDrive Workshops and Accident Reporting Centers.

I/We HEREBY CERTIFY that the policy to which this certificate relates is issued in accordance with the provisions of the Motor Vehicles (Third-Party Risks and Compensation) Act (Chapter 189) and Part IV of the Road Transport Act, 1987 (Malaysia).

Sompo Insurance Singapore Pte. Ltd.

Date/Time of Issue : 26 JULY 2018 14:16

*Limitation rendered inoperative by section 8 of the Motor Vehicles (Third-Party Risks and Compensation) Act (Chapter 189 and section 95 of the Road Transport Act, 1987 (Malaysia), are not to be included under these headings.

IMPORTANT NOTICE

- Insureds are hereby warned that under the Motor Vehicles (Third-Party Risks and Compensation) Act (Cap.189), it shall be unlawful for any person to use or cause or permit any other person to use a motor vehicles without a valid policy of insurance under the Act.
- Insureds are further warned that on the sale of a motor vehicle or if for any reason the insurance is terminated during its currency, they must surrender the Certificate of Insurance and the Policy to the insurance company. If the Certificate of Insurance has been lost or destroyed a Statutory Declaration to that effect must be made. Failure to comply with this obligation is an offence under the Motor Vehicles (Third-Party Risks and Compensation) Act (Cap.189).
- The Policy will cease to be valid once the motor vehicle has been sold to another person. It is not transferable to a new owner of the Vehicle.
- Please note that this insurance is subject to the premium being paid and received in full by the Company (a) before the inception date where the Policy is to be issued to an individual; or (b) within the period specified in the Premium Payment Warranty applied to the Policy in all other instances.
- Insurance coverage under this Policy is subject to the terms and conditions as stipulated in the Motor Insurance Policy.

Intermediary Code & Name : 11G05800 & GREAT EASTERN FINANCIAL ADVISERS PTE LTD CI Code: 29C 4JDB5Z4JJL0YJZA0

Date of Accident : 20.06.2019 Accident Time: 11:45am (24-HR-Format)
 Accident Place : Bedok central (Behind KFC)
 Vehicle No. (Car Plate No.) : YP 6906 S Make/Model: ISUZU NQR 75UL5A
 Insurance Company : Sompo Policy No: D18MTHC4E002192
 Owner or Company Name /IC No. : Kim long Trading (53093529E)
 Owner or Company Contact No. : - Owner's Hp - Company Tel -
 DRIVER'S Name / IC No. : Dennis Yap Teck leong (S1673926Z)
 DRIVER'S Date Of Birth : 28 Sep 1964 DRIVER'S License Pass Date 04 Apr 1986
 Relationship of Owner & Driver : Spouse \ Parents \ Children \ Sibling \ Employee \ Others: -
 DRIVER'S Address : Blk 899 Tampines Street 81 #08-736 (S) 520899
 DRIVER'S Contact No. / Alt No. : 1) 96265237 2) -
 DRIVER'S Occupation : INDOOR \ OUTDOOR (e.g. working inside or outside office)
 Email Address : -
 Weather & Road Surface : CLEAR & DRY \ RAINING & WET \ AFTER RAIN & WET
 Reporting Type : Reporting Only \ Claim Other Party \ Claim Own Insurance
 Number of Passengers (Including Driver): 1 person (Driver)
 Was there any video Captured by car camera: YES \ NO
 Exact purpose for which vehicle was being used at the time of accident: Private use \ Work purpose
 Any Injury (If YES, Pls state): NO

Other Party Driver's Particular (if any)

Vehicle No: <u>IN 27554</u>	Vehicle No: _____
Vehicle Make/Model: _____	Vehicle Make/Model: _____
Name Driver: _____	Name Driver: _____
IC No. Driver/Contact: _____	IC No. Driver/Contact: _____

*** NEW - Passenger's name & gender:**



[Handwritten signature]

SKETCH PLAN

IMPORTANT NOTICE

1. Please report correctly the details of the accident to speed up the claims process.
2. This Form must be completed by the Policyholder and/or the Authorised Driver.
3. Information provided must be as truthful and accurate as possible. Any wilful misrepresentation or withholding of material facts may allow insurance companies to repudiate policy liability.
4. The issue and acceptance of this Form by insurance companies is not an admission of policy liability on the part of the insurance companies.
5. Any false reporting may be referred to the Police for investigation.
6. The report will be forwarded by the insurers of the GIA Records Management Centre established by the General Insurance Association of Singapore (GIA) for archiving and that copies of this report will for a fee be made available upon application by interested parties.
7. By the lodgment of this report to the insurers, you hereby consent to the archiving of this report at the centre and to copies of the report being made available aforesaid.
8. **Consent under the Personal Data Protection Act (PDPA)**

I understand, acknowledge, agree and consent that:

- (a) My insurer, my workshop and the General Insurance Association of Singapore ("GIA") may/are permitted to collect, use, disclose and/or process my personal data/personal information set out in this [form] and any other personal information provided by me or possessed by my insurer (collectively the "Personal Information") and disclose and transfer such Personal Information to all insurer(s) who have insured vehicle(s) involved in this accident (all insurer(s) who have insured vehicle(s) involved in this accident shall be collectively referred to as the "Insurers"), the Insurers' lawyers/law firms, the Monetary Authority of Singapore and any relevant government agency/authority (such as the police), for the purpose(s) of:
 - (i) processing, handling and/or dealing with my claims including the settlement of the claims and any necessary investigations relating to the claims;
 - (ii) investigating the accident and/or my claims;
 - (iii) carrying out and/or dealing with my instructions or responding to any enquiries by me;
 - (iv) administering my claims (including the mailing of correspondence, statements, invoices, reports or notices to me, which could involve disclosure of certain personal data about me to bring about delivery of the same as well as on the external cover of envelopes/mail packages); and/or
 - (v) complying with applicable law in administering, processing, handling and/or dealing with my claims.(collectively the "Purposes")
- (b) all insurer(s) who have insured vehicle(s) involved in this accident and the Insurers' lawyers/law firms, may/are permitted to collect, use, disclose and/or process my Personal Information for one or more of the above Purposes; and
- (c) my Personal Information may/can be disclosed by any of the Insurers and/or GIA to their third party service providers or agents(including their lawyers/law firms), which may be sited outside of Singapore, for one or more of the above Purposes.
- (d) my Personal Information will also be collected and used to compile claims history for the purpose of fraud detection, investigation and management in present and all future claims.
- (e) the information so collected under (d) above may be shared / disclosed:
 - (i) to all insurers and/or any other third parties that assist in evaluating, investigating, controlling or managing fraud, regulators, law enforcement and government agencies as reasonably required for the purposes stated, or
 - (ii) for complying with requirements under any regulations, laws or court orders.



Policyholder's Signature
Date & Time:

Driver's Signature
(If driver is not the policyholder)
Date & Time:

Reporting Centre Personnel's Signature
Name:
NRIC/FIN No.:

SKETCH PLAN

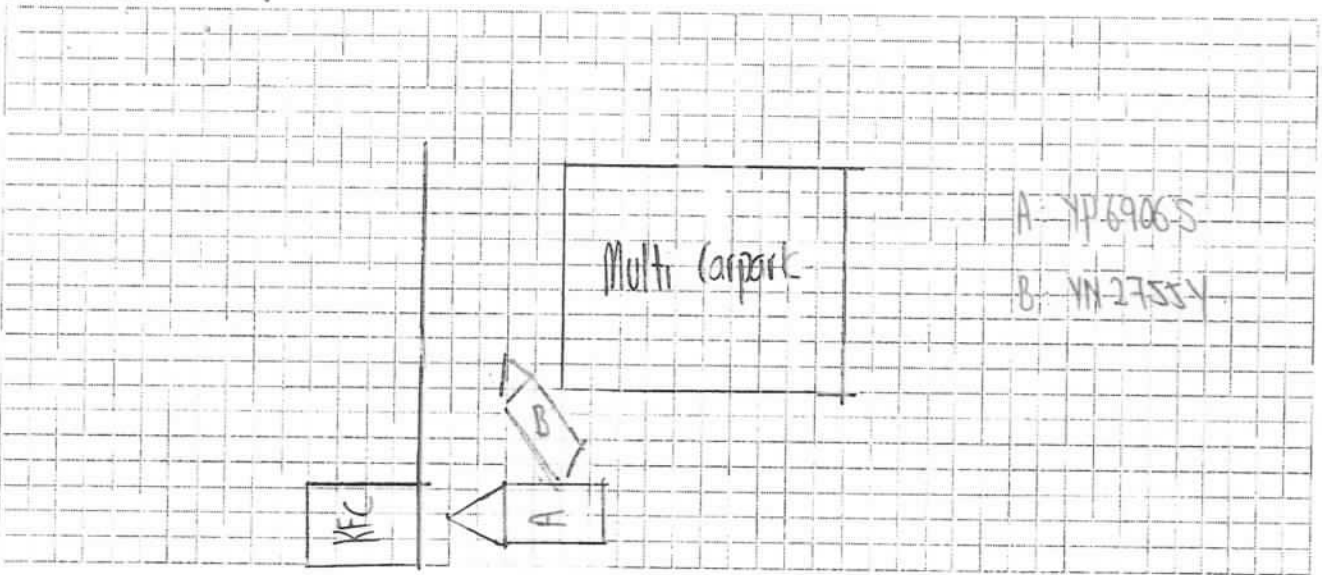

DESCRIBE CIRCUMSTANCES OF THE ACCIDENT

On 20.06.2019 at about 11.45am, I stop my Vehicle A behind KFC.

Suddenly Vehicle B hit on my rear right side portion.

DECLARATION

I/We declare the foregoing particulars are true in every respect.

Policyholder's Signature

Date & Time:

Driver's Signature

(If driver is not the policyholder)

Date & Time:

Reporting Centre Personnel's Signature

Name:

NRIC/FIN No.:

Not Added
HAR
TOTAL P/P \$ 2400
327.

S. NETT

REAR CARGO BOX PANEL REAR 'I' & structure pillar v/s

REAR CARGO BOX PANEL REAR **2** 015

DRS ua	\$1,800.00	1200	\$
	\$1,800.00	800	\$
	\$3,600.00		

\$500.00 400

\$600.00

TOTAL	\$4,700.00
-------	------------

Date: _____

...CLAIM SUBFOLDER...(Pending for Survey Report)

CLAIM SUBFOLDER TRACKING							
Case	Notified	Est Submitted	Adj Assigned	Adj Rpt	Adj Submitted	Ins Auth'ed	Status
Main	24 Jun 2019		26 Jun 2019 14:39 Edit Adj Rpt	S\$2,400.00 Edit Estimates	S\$2,400.00 View Rpt		Pending for Survey Report Cancel Case

Main	Reference	Claim Details	Documents	Show All					
CLAIM SUBFOLDER DETAILS [Created by insurer]									
Insured:	GOLDBELL LEASING PTE LTD , Co. Reg. No.: 199001196N								
Main Claimant:	KIM LONG TRADING , Co. Reg. No.: 53093529E								
Vehicle Reg. No.:	YP6906S	Date of Loss:	20/06/2019 11:00 - :59 [22 Months and 18 Days From LTA Reg Date (Man Yr)]						
Claim Type:	TP / 597281	Policy/Cover Note No.:	29090793 (Third Party Only) Coverage: 01/09/2018 - 31/08/2019						
Vehicle Reg. No. (Insured):	YN2755Y	Policy No. (Claimant):							
		Excess:							
Repairer:	Fastech Auto Pte Ltd (HQ) 1 Kaki Bukit Ave 6, #01-46/48/50 Autobay, 417883 Kaki Bukit - Tel: 67465405								
Handling Insurer:	MSIG Insurance (Singapore) Pte. Ltd. (HQ) - Tel: +65 6827 7888 ... [Handled by Elaine Ngu Siau Mei - 6594 2540]								
Adjuster:	LKK Auto Consultants Pte Ltd (HQ) - Tel: 6256-3561 ... [Handled by MARCUS CHUA] ... [Final Rpt due 26/07/2019]								
Driver/Custodian (Insured):	LIANG YU (), NRIC: G2404915P, Tel: +6591456610 Email:								
Adj Asg. Remarks:	direct survey done.								
ASSOCIATED MAIL RECEIVED View All Compose Case Mail									
There are no mail for this case.									
ALL ASSOCIATED TASKS View All Search Tasks Create New Task Complete									
Due Date	Priority	Type	Task Group	Subject	Handler	Assigned By	Completed On	Created On	Done?
No results.									

Claim Documents

*YP6906S (597281)
[YN2755Y]
TP
KIM LONG TRADING
Jun 20 2019 11:00AM
[GOLDBELL LEASING PTE LTD]
Fastech Auto Pte Ltd

Upload Documents			Upload Photos			Compose New Letter			View		View in Browser	
Assessment Reports									1 per page		<input checked="" type="checkbox"/>	
No	Finalized On	LKK Auto Consultants Pte Ltd (HQ)								Thumbnail	Print	
1	03/07/19 16:39	Adjuster Immediate Advice							1	Load HTM		
Photos/Images									3 per page		<input checked="" type="checkbox"/>	
No	Relabel/Reorder	LKK Auto Consultants Pte Ltd (HQ)								Thumbnail	Print	
1	26/06/19 15:55	Chassis Number							1	Load JPG	<input checked="" type="checkbox"/>	
2	26/06/19 15:55	Odometer Reading							1	Load JPG	<input checked="" type="checkbox"/>	
3	26/06/19 15:55	General View							1	Load JPG	<input checked="" type="checkbox"/>	
4	26/06/19 15:55	General View							1	Load JPG	<input checked="" type="checkbox"/>	
5	26/06/19 15:55	General View							1	Load JPG	<input checked="" type="checkbox"/>	
6	26/06/19 15:55	General View							1	Load JPG	<input checked="" type="checkbox"/>	
7	26/06/19 15:55	General View							1	Load JPG	<input checked="" type="checkbox"/>	
8	26/06/19 15:55	General View							1	Load JPG	<input checked="" type="checkbox"/>	
9	26/06/19 15:55	General View							1	Load JPG	<input checked="" type="checkbox"/>	
10	26/06/19 15:55	General View							1	Load JPG	<input checked="" type="checkbox"/>	
11	26/06/19 15:55	General View							1	Load JPG	<input checked="" type="checkbox"/>	
12	26/06/19 15:55	General View							1	Load JPG	<input checked="" type="checkbox"/>	
13	26/06/19 15:55	General View							1	Load JPG	<input checked="" type="checkbox"/>	
14	26/06/19 15:55	General View							1	Load JPG	<input checked="" type="checkbox"/>	
15	26/06/19 15:55	General View							1	Load JPG	<input checked="" type="checkbox"/>	
16	26/06/19 15:55	General View							1	Load JPG	<input checked="" type="checkbox"/>	
17	26/06/19 15:55	General View							1	Load JPG	<input checked="" type="checkbox"/>	
18	26/06/19 15:55	General View							1	Load JPG	<input checked="" type="checkbox"/>	
19	26/06/19 15:55	Reinspection Photo							1	Load JPG	<input checked="" type="checkbox"/>	
20	26/06/19 15:55	Reinspection Photo							1	Load JPG	<input checked="" type="checkbox"/>	
21	26/06/19 15:55	Reinspection Photo							1	Load JPG	<input checked="" type="checkbox"/>	
22	26/06/19 15:55	Reinspection Photo							1	Load JPG	<input checked="" type="checkbox"/>	
23	26/06/19 15:55	Reinspection Photo							1	Load JPG	<input checked="" type="checkbox"/>	
24	26/06/19 15:55	Reinspection Photo							1	Load JPG	<input checked="" type="checkbox"/>	
25	26/06/19 15:55	Reinspection Photo							1	Load JPG	<input checked="" type="checkbox"/>	
26	26/06/19 15:55	Reinspection Photo							1	Load JPG	<input checked="" type="checkbox"/>	
Documentation									1 per page		<input checked="" type="checkbox"/>	
No	Finalized On	MSIG Insurance (Singapore) Pte. Ltd. (HQ)								Thumbnail	Print	
1	26/06/19 14:41	direct survey done by LKK							1	Load PDF		
2	26/06/19 14:41	TP - YP6906S E FILE REPORT							1	Load PDF		

Documents Checklist

DOCUMENTS CHECKLIST

Reset

Save

Print

There are no document checklists configured.

Our Checklist Remarks - LKK Auto Consultants Pte Ltd (HQ)**Show Remarks To:** ☐ Handling Insurer

Note: Remarks are private unless you show it to other parties.

LKK Auto Consultants Pte Ltd (Co.Reg.No:199607198R)

51 Ubi Ave 1 #01-25, Paya Ubi Industrial Park

Singapore 408933

Tel: 6256-3561 Fax: 6844-8805 Email: sur@lkkauto.com; assignments@lkkauto.com

VEHICLE DAMAGE INSPECTION REPORT

Our File No: CC3/MSG19011224/UQD3E2

Date: 09/07/2019

REFERENCE

Handling Insurer: MSIG Insurance (Singapore) Pte. Ltd.

Policy No: 29090793

Claimant Vehicle No : YP6906S

Insured Vehicle No : YN2755Y

Date of Loss: 20/06/2019

Nature of Claim: TP

Claim No: 597281

DESCRIPTION & IDENTIFICATION OF VEHICLE

Reg No: YP6906S

Make & Model: ISUZU NQR75UL5A, 5.2 D (M)

Engine No: 4HK1577293

Reg. Date: 02/08/2017 (Man. Year: 2017)

Chassis No: JAAN1R75LH7100245

Colour: White

Odometer: 60599 km

Engine Capacity: 5193 cc

Market Value/New Car Price: N/A

Sum Insured (S\$): Market Value/New Car Price

CONDITION OF VEHICLE AT THE TIME OF SURVEY

General Condition: Steering (Serviceable):

Yes Footbrake (Serviceable): Yes

Handbrake (Serviceable): Yes Engine Modification:

No Pre-accident Condition:

CONDITION OF TYRES

Front Tyre Size: 215/75 R17.5

Rear Tyre Size: 215/75 R17.5 (D)

Front Left Side: Bridgestone 6 mm

Rear Left Side: Bridgestone 6/6 mm

Front Right Side: Bridgestone 6 mm

Rear Right Side: Bridgestone 6/6 mm

The above values represent the remaining tyre treads depth

COST OF CLAIMS	Repairer's	Adjuster's	Difference	Diff %
Parts	3,600.00	2,000.00	1,600.00	44.44
Miscellaneous Items	0.00	0.00	0.00	
Labour	1,100.00	400.00	700.00	63.64
Paintwork Labour	0.00	0.00	0.00	
Towing	0.00	0.00	0.00	
Gross Total (S\$)	4,700.00	2,400.00	2,300.00	48.94
+ GST 7.00/7.00% (S\$)	329.00	168.00	161.00	48.94
Nett Amount (S\$)	5,029.00	2,568.00	2,461.00	48.94

INSPECTION

Date of Assignment: 26/06/2019

Date Inspected: 25/06/2019 Inspected At:

Fastech Auto Pte Ltd (HQ)
1 Kaki Bukit Ave 6, #01-46/48/50 Autobay
Singapore 417883

Estimated Period of Repair: 3.0 days

Adjuster: MARCUS CHUA

Manager: SHIAU CHAN

NOTE: This report represents our findings at the time and place of inspection stated herein. Such inspection has been carried out to the best of our knowledge and ability but any other liability under any other circumstances is hereby expressly excluded.

REPAIR DETAILS

Reference		
Part Source:	(Last Synchronised: 09 Jul 2019)	
Parts:	N/A	ISUZU NQR75UL5A 5.2 D (M) (Model not available in database)
Labour:	Repairer's	(Price-denominated Standard List)
Print Code:	(Unsubmitted, no print-code for YP6906S)	
Validity:	These estimates are valid only if they contain the print code (above) on all estimate pages, running page numbers with the END OF ESTIMATES marker on the last estimate page	
Further Info:	Items/values not in reference catalogue are prefixed with an asterisk *.	

Recommended Parts

No.	Qty	Part No.	Particulars	Condition	Repairer's	Amount
1	1		*REAR CARGO BOX PANEL REAR I & STRUCTURE PILLAR O/S	Distorted/Cracked	1,800.00 FS	*1,200.00 FS
2	1		*REAR CARGO BOX PANEL REAR I O/S	Distorted/Cracked	1,800.00 FS	*800.00 FS
					Total Parts (S\$)	3,600.00 2,000.00

F=Franchise part. S=SpcNett.

Report was unsubmitted during this print-out.

Recommended Miscellaneous Items

There are no new miscellaneous items selected.

Recommended Labour

No	Particulars	Lab.Type	Repairer's	Amount
Labour Items				
1	LABOUR FOR PANEL BEATING & REPLACING PARTS	New	500.00	400.00
2	TO PUTTY & SPRAY PAINTING	New	600.00	0.00
Gross Labour Cost (\$\$)			1,100.00	400.00

Report was unsubmitted during this print-out.

< END OF ESTIMATES >