

**DING AUTO PTE LTD**

Blk 10 #01-20 Sin Ming  
Industrial Est Sec C  
Singapore 575645

Without Prejudice  
to our driver's Injury claim

OUR REF: 7000395/TP/SGK9799D/AD/29/05/2019/DD  
YOUR REF: PC6565S/--  
2 July 2019

To: MOTOR CLAIMS DEPARTMENT  
AXA INSURANCE  
8 SHENTON WAY  
#24-01 AXA TOWER  
SINGAPORE 068811

ACCIDENT INVOLVING : SGK9799D AGAINST PC6565S ON 29/05/2019  
LOCATION ALONG : JALAN MATA AIR TRAFFIC LIGHT JUNCTION TOWARDS SEMBAWANG  
We refer to the above matter:

	Rate Per Day	Repair/ Claims Day	Amount Before GST	GST 7%	Amount After GST
Cost of Repair	\$ -	16	\$ 3,000.00	\$ 210.00	\$ 3,210.00
Loss Of Rental /Use	\$ 120.00	16	\$ 1,920.00	\$ -	\$ 1,920.00
Loss Of Income	\$ -	16	\$ -	\$ -	\$ -
LTA/GIA Search Fee	\$ -	0	\$ 1.87	\$ 0.13	\$ 2.00
Towing Fee	\$ -	0	\$ -	\$ -	\$ -
Surveyor Fee	\$ -	0	\$ -	\$ -	\$ -
Total	\$ 120.00	16	\$ 4,921.87	\$ 210.13	\$ 5,132.00

The accident was caused solely by the negligence of your insured and as a results ,We had incurred the following costs of repair and losses of our insurer:

Enclosed are copies of the following documents for your perusal:

☺	Repair Estimate	☺	Letter Of Authority
☺	GIA Report/Accident Police Report	☺	Discharge Voucher
☺	LTA 3 <sup>rd</sup> Party Search Fee	☺	Certificate Of Insurance
☺	Mileage Record	☺	Final Bill/Repair Tax Invoice
☺	Rental Invoice	☺	Confirmation Finalize/Liability Email Copy
☺	Income Statement/Income tax (if any)	☺	Letter Of Demand

Our insurer has authorized DING AUTO PTE LTD to deal with the claim in this accident case and also to receive and deal/negotiate with all payment as stated above.  
Please look into our client's claim and revert soonest as possible.

Your Sincerely,  
DD HASHIM  
DING AUTO PTE LTD  
HP:81160811  
FAX:64520614

Steve (LKK) w/2 Prevalire 30/5/19, 1:45pm

83228813

5 days

L/S

Ry Af spy

DING AUTO PTE LTD

Blk 10, #01-20

Sin Ming Industrial Est. Sec C

Singapore 575645

Tel: 6452 1208

Fax: 6452 0614

Vehicle: SGK9799D

Model: MADZA 3

Chassis:

NO	DESCRIPTION	QTY	LIST	DISC	PRICE	SURVEYORS MARKING
1	FRONT DOOR LH / DD	1	\$			
2	FRONT DOOR LH CHROME MLDG / (RY (UPPER)	1	\$	1,919.20	20%	\$ 1,535.36
3	FRONT DOOR LH RUBBER BEADING	1	\$	155.20	20%	\$ 124.16
4	FRONT DOOR LH REGULATOR / PD	1	\$	198.20	20%	\$ 158.56
5	FRONT DOOR LH REGULATOR MOTOR X	1	\$	179.60	20%	\$ 143.68
6	FRONT DOOR LH LOCK	1	\$	358.00	20%	\$ 286.40
7	FRONT DOOR LH LOCK CABLE X	1	\$	265.60	20%	\$ 212.48
8	FRONT DOOR LH FRAME GARNISH (stick) NCC	1	\$	165.20	20%	\$ 132.16
9	FRONT DOOR LH PROTECTOR MLDG (lower) / CRV	1	\$	152.00	20%	\$ 121.60
10	FRONT DOOR LH HANDLE	1	\$	85.58	20%	\$ 68.46
11	FRONT DOOR LH TRIM	1	\$	180.20	20%	\$ 144.16
12	FRONT DOOR LH WINDOW SWITCH X	1	\$	1,705.00	20%	\$ 1,364.00
13	FRONT FENDER LH X R	1	\$	165.50	20%	\$ 132.40
14	ROCKER PANEL LH X	1	\$	808.70	20%	\$ 646.96
15	REAR DOOR LH / DD	1	\$	858.00	20%	\$ 686.40
16	REAR DOOR LH PROTECTOR MLDG X	1	\$	1,070.30	20%	\$ 856.24
17	B PILLAR LH X R	1	\$	85.50	20%	\$ 68.40
18	A PILLAR LH X R	1	\$	850.70	20%	\$ 680.56
19	FRONT DOOR LH HINGE UPPER	1	\$	1,020.20	20%	\$ 816.16
20	FRONT DOOR LH HINGE LOWER	1	\$	85.50	20%	\$ 68.40
20	FRONT DOOR LH HATCH X	1	\$	85.50	20%	\$ 68.40
20	FRONT DOOR LH GLASS X	1	\$	198.00	20%	\$ 158.40
TOTAL:					\$	9,206.12

SPECIAL NETT

	QTY	PRICE	SURVEYOR MARKING
1 FRONT FENDER INNER S. HILLING X		\$	25.00
2 FRONT DOOR LH TRIM X		\$	35.00 20
FRONT WINDSCREEN SEALANT X		\$	50.00
FRONT WINDSCREEN WIPER X		\$	15.00
FRONT WINDSCREEN WIPER X		\$	100.00
SPECIAL NETT			225.00

LABOUR

	PRICE	SURVEYOR MARKING
1 STRAIGHTEN AND PAINT FRONT ACCIDENT AREAS	2,400.00	600
2 TRANSFER FRONT AND REAR DOOR LH COMPONENTS	250.00	50
3 REAR FENDER WIPER SCREEN	150.00	X
4 REAR FENDER WIPER SCREEN	150.00	30
5 MOUNT WORKBENCH TO ASSIST REPAIR	250.00	70
6 TO DISMANTLE FRONT SEAT, SEAT BELT AND TRIM TO ASSIST REPAIR	250.00	X
7 TO DISMANTLE DASH BOARD TO ASSIST REPAIR A PILLAR	300.00	X
8 TO SPRAY PAINTING ON FRONT FENDER LH, FRONT DOOR LH INTER/OUTER, A PILLAR, B PILLAR, REAR DOOR	250.00	X
TOTAL:		800

PARTS

9,206.12

## SINGAPORE ACCIDENT STATEMENT

### IMPORTANT NOTICE

1. Please report correctly the details of the accident to speed up the claims process.
2. This Form must be completed by the Policyholder and/or the Authorised Driver.
3. Information provided must be truthful and accurate as possible. Any wilful misrepresentation or withholding of material facts may allow insurance companies to repudiate policy liability.
4. The issue and acceptance of this Form by insurance companies is not an admission of policy liability on the part of the insurance companies.
5. **Any false reporting may be referred to the Police for investigation.**
6. This report will be forwarded by the insurers of the GIA Records Management Centre established by the General Insurance Association of Singapore (GIA) for archiving and that copies of this report will, for a fee, be made available upon application by interested parties.
7. By the lodgement of this report to the insurers, you hereby consent to the archiving of this report at the centre and to copies of the report being made available aforesaid.

### ACCIDENT STATEMENT

Date Of Report	29/05/2019 13:54
Date Of Accident	29/05/2019 12:00
Exact Location Of Accident	JALAN MATA AIR TRAFFIC LIGHT JUNCTION TO SEMBAWANG
Country/State of Loss	SINGAPORE

### DETAILS OF OWN VEHICLE

Vehicle Registration Number	SGK9799D
<b>Insured/Policyholder</b>	
Name Of Registered Owner	GREGORY TAN EK LEONG
NRIC No	S7339313B
Email Address	NOEMAIL
Mobile Phone No	(LOCAL) +65-96919478
Alternative Phone No	OTHERS-96919477

### Vehicle Particulars

Manufacturer	MAZDA
Model	M3-1.6 (A)

Exact Purpose for which vehicle was being used at time of accident

Are you claiming under your own insurance policy for repair to your vehicle? NO

If No, Please state action to be taken THIRD PARTY

Vehicle Category PRIVATE CAR

### Insurance Company

Name of Insurance Company	AVIVA LTD
Type Of Coverage	COMPREHENSIVE
Fleet Policy	YES
Policy Number	10673406
Cover Note Number	

### Driver

Name of Driver	TAN EE LIM JEFFREY
NRIC No	S0578486G
Date Of Birth	21/04/1941
Occupation	INDOOR
Date Of Driving Pass	25/07/1983
Driving Experience	35 YEARS AND 10 MONTHS
Gender	MALE
Mobile Number	(LOCAL) +65-97612324
Fax Number	
Contact Number	
Email Address	NOEMAIL

Address

JALAN MATA AYER

Postcode

Was driver an employee of the Insured's Company NO

If No, Relationship of the Driver with the Insured PARENT

Vehicle Registration Number of Driver's Own Vehicle -

-

-

Insurance Company of Driver's Own Vehicle -

-

### General Information of the Accident

Type Of Accident

COLLISION - CHANGE/CROSS LANE

Weather Conditions

CLEAR

Road Surface

DRY

### Other Information

Was any foreign vehicle involved in this accident? NO

Number of vehicles (including own vehicle) involved in the accident 2

Was any body injured in the Accident? NO

Was any injured conveyed to hospital by ambulance? NO

Was any other material or property damaged? YES

I have been approached by unknown person(s) soliciting/offering accident claims assistance. NO

Number of Passengers (Including Driver) 2

Passenger 1

NAME: WIFE

GENDER: FEMALE

### Details of Police Action

Was the accident reported to the police? NO

If Yes, Please state which Police Station

Was notice of intended Prosecution given? NO

If Yes, against whom?

### Circumstances of Accident

REFER TO THE ATTACHMENT.

### Attachment(s)

Are accident photos available for attachment? YES

Was there any video captured by Car Camera? YES

Was there any audio recorded? NO

### DETAILS OF OTHER VEHICLE PROPERTY 1

Vehicle Registration Number

PC6565S

Vehicle Make/Model/Colour

MERCEDES

Details Of Properties

Vehicle Category

PRIVATE HIRE

Name of Driver

NEO JIAN XIN ALOYSIUS

NRIC/Passport Number

S1596489H

Contact Number

91392212

Address

Postcode

Insurance Company Name

Nature Of Damage

No. Of Passenger (Including Driver)

REPUBLIC OF SINGAPORE DRIVING LICENCE

Portrait photo of a man

License Number: S0578486G

Name: TAN EE LIM JEFFREY

Birth Date: 21 Apr 1941

Renew Date: 02 Mar 2004

Barcode: 001148654F

YOU ARE LICENSED TO DRIVE VEHICLES IN THE FOLLOWING CLASS(ES)

Class	Description	Pass Date
Class 3	Motor Cars and Motor Tractors the weight of which unladen does not exceed 2500 kilograms	25 Jul 1983

NP 478A

License No: S0578486G

Barcode

Driver

REPUBLIC OF SINGAPORE DRIVING LICENCE

Portrait photo of a man

License Number: S7339313B

Name: GREGORY TAN EK LEONG

Birth Date: 10 Nov 1973

Valid Date: 28 Jan 2003

Barcode: 1000155985F

YOU ARE LICENSED TO DRIVE VEHICLES IN THE FOLLOWING CLASS(S)

Class 3 Motor Cars and Motor Tractors the weight of which unladen does not exceed 2500 kilograms

PASS DATE: 08 Feb 1994

NP 428A

Barcode: License No: S7339313B

owner

## SKETCH PLAN

### IMPORTANT NOTICE

1. Please report correctly the details of the accident to speed up the claims process.
2. This Form must be completed by the Policyholder and/or the Authorised Driver.
3. Information provided must be as truthful and accurate as possible. Any wilful misrepresentation or withholding of material facts may allow insurance companies to repudiate policy liability.
4. The issue and acceptance of this Form by insurance companies is not an admission of policy liability on the part of the insurance companies.
5. Any false reporting may be referred to the Police for investigation.
6. The report will be forwarded by the insurers of the GIA Records Management Centre established by the General Insurance Association of Singapore (GIA) for archiving and that copies of this report will for a fee be made available upon application by interested parties.
7. By the lodgment of this report to the insurers, you hereby consent to the archiving of this report at the centre and to copies of the report being made available aforesaid.
8. **Consent under the Personal Data Protection Act (PDPA)**

I understand, acknowledge, agree and consent that:

- (a) My insurer, my workshop and the General Insurance Association of Singapore ("GIA") may/are permitted to collect, use, disclose and/or process my personal data/personal information set out in this form and any other personal information provided by me or possessed by my insurer (collectively the "Personal Information") and disclose and transfer such Personal Information to all insurer(s) who have insured vehicle(s) involved in this accident (all insurer(s) who have insured vehicle(s) involved in this accident shall be collectively referred to as the "Insurers"), the Insurers' lawyers/law firms, the Monetary Authority of Singapore and any relevant government agency/authority (such as the police), for the purpose(s) of:
  - (i) processing, handling and/or dealing with my claims including the settlement of the claims and any necessary investigations relating to the claims;
  - (ii) investigating the accident and/or my claims;
  - (iii) carrying out and/or dealing with my instructions or responding to any enquiries by me;
  - (iv) administering my claims (including the mailing of correspondence, statements, invoices, reports or notices to me, which could involve disclosure of certain personal data about me to bring about delivery of the same as well as on the external cover of envelopes/mail packages); and/or
  - (v) complying with applicable law in administering, processing, handling and/or dealing with my claims, (collectively the "Purposes")
- (b) all insurer(s) who have insured vehicle(s) involved in this accident and the Insurers' lawyers/law firms, may/are permitted to collect, use, disclose and/or process my Personal Information for one or more of the above Purposes; and
- (c) my Personal Information may/can be disclosed by any of the Insurers and/or GIA to their third party service providers or agents (including their lawyers/law firms), which may be sited outside of Singapore, for one or more of the above Purposes.
- (d) my Personal Information will also be collected and used to compile claims history for the purpose of fraud detection, investigation and management in present and all future claims.
- (e) the information so collected under (d) above may be shared / disclosed:
  - (i) to all insurers and/or any other third parties that assist in evaluating, investigating, controlling or managing fraud, regulators, law enforcement and government agencies as reasonably required for the purposes stated, or
  - (ii) for complying with requirements under any regulations, laws or court orders.

Policyholder's Signature  
Date & Time:

Driver's Signature  
(If driver is not the policyholder)  
Date & Time:

Reporting Centre Personnel's Signature  
Name:  
NRIC/FIN No.:

# SKETCH PLAN

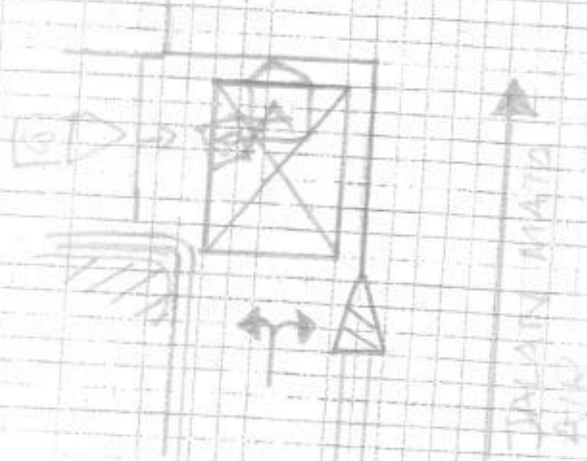

A - SKK979AD  
B - PC6565S

## DESCRIBE CIRCUMSTANCES OF THE ACCIDENT

29/05/2019 I drove out from my residents and stop at traffic light at the Jalan Mata air turn to Pembawang. The vehicle PC6565S without stop at his stop line he came out from the junction and hit onto my vehicle on left side portion and cause damage on my vehicle. We both exchange particular and confirmed nobody injured.

## DECLARATION

I/We declare the foregoing particulars are true in every respect.

Policyholder's Signature  
Date & Time:

Driver's Signature  
(if driver is not the policyholder)  
Date & Time:

Reporting Centre Personnel's Signature  
Name:  
NRIC/FIN No.:





RECORDS MANAGEMENT CENTRE

GENERAL INSURANCE ASSOCIATION OF SINGAPORE  
RECORDS MANAGEMENT CENTRE6 Raffles Quay #18-00, Singapore 048580  
Phone: +65 6224 0010 Fax: +65 6224 0030  
Operating Hours: Monday to Friday 9am to 5pm  
GST Registration No: M400017735

## Third Party Insurer Enquiry

Our Ref No: GR-19-085085  
Date of Request: 29/05/2019

Your Ref No: Online Purchase

Ding Auto Pte Ltd  
Blk 10, #01-20  
Sin Ming Industrial Estate Sector C  
Singapore 575645

Dear Sir/Madam,

Enquiry Date: 29/05/2019  
Enquiry By: Noor Hadiana Hereini Binti Hashim  
Vehicle No.: PC6565S  
Accident Date: 29/05/2019

## Enquiry Result

TP Vehicle No.	Insurer	Period of Insurance	Insurer Tel. No.
PC6565S	AXA Insurance Pte Ltd	25/08/2018-24/08/2019	6338 7288

Thank You,

The images provided to you are taken from the original reports forwarded to the centre by the members of the General Insurance Association of Singapore and we take no responsibility for their accuracy or contents and shall be under no liability whatsoever for any loss or damage arising out of or in connection with the reports or their images.

This is a computer generated document and requires no signature.



RECORDS MANAGEMENT CENTRE

**GENERAL INSURANCE ASSOCIATION OF SINGAPORE  
RECORDS MANAGEMENT CENTRE**

6 Raffles Quay #18-00, Singapore 048580  
Phone: +65 6224 0010 Fax: +65 6224 0030  
Operating Hours: Monday to Friday 9am to 5pm  
GST Registration No: M400017735

**TAX INVOICE**

Our Ref No: GR-19-085085  
Date of Request: 29/05/2019

Your Ref No: Online Purchase

Ding Auto Pte Ltd  
Blk 10, #01-20  
Sin Ming Industrial Estate Sector C  
Singapore 575645

Dear Sir/Madam,

Enquiry Date: 29/05/2019  
Enquiry By: Noor Hadiana Hereini Binti Hashim  
Vehicle No: PC6565S  
Accident Date: 29/05/2019

DESCRIPTION	AMOUNT (S\$)
TP Insurer Enquiry	1.87
GST Amount	0.13
Total Amount Due (GST Inclusive)	2.00

Thank You.

This is a computer generated document and requires no signature.

For GIARMC Official use:

Date:

☒ GIRO ☐ Cash ☐ Cheque

**DING AUTO PTE LTD**  
BLK 10 SING MING IND  
EST SEC C #01-20  
SINGAPORE 575645  
TEL:64589523 FAX:64534227

**LETTER OF AUTHORIZATION**

Claimant Vehicle Number : SGK 9799D  
Third Party Vehicle Number : PC 6565S  
Date&Time Of Accident : 29/5/2019  
Date&Time Authorize : 29/5/2019  
Location Of Accident Along : JALAN MATA AIR

In consideration of my motor accident claim against the third party resulting from the above accident details, I Gregory Tan Ek Leong (the third party claimant) with address at Serangoon, owner of SGK 9799D (claimant veh no.) hereby authorized DING AUTO PTE LTD (the workshop) to act for me with respect to my claim of Cost of Repair, Lost of Rental or Loss of Use.

I further authorized the workshop to settle my above mentioned claim in a manner that they deem fit and the workshop is further authorized to receive payment further to settlement of my claim with payment Cheque being made in favour of the workshop.

I further understand that DING AUTO PTE LTD does not guarantee and never represented that insurer/Third party will fully indemnify me for the damage or the Cost of Repair, and that I shall be and continued to be liable to DING AUTO PTE LTD for the whole of repair cost if the claim is unsuccessful.

.....  
Signed/Chop by Claimant

.....  
Signed&Chop by Ding Auto Pte Ltd



**DING AUTO PTE LTD**

BLK 10 SING MING IND

EST SEC C #01-20

SINGAPORE 575645

TEL:64589523 FAX:64534227

**DISCHARGE VOUCHER**

Name: Gregory

Vehicle Number: SLK 9799D

Date&Time: 13/6/2019

This is certify the vehicle on details above has repaired in DING AUTO PTE LTD to my satisfaction and authorized.I had collect the vehicle on the date and time as above.

[Signature]  
.....  
Customer Signature/Co.Stamp

We DING AUTO PTE LTD hereby warranty the workmanship of the repairs carried out on the accident portion of our clients as above.The warranty is valid for a period of 6month from the date of the discharge and it is non-transferable.We will promptly carry out any necessary rectification work.

[Signature]   
.....  
Ding Auto Pte Ltd

DING AUTO PTE LTD  
BLK 10, #01-20 SIN MING IND EST, SEC C, SINGAPORE 575645  
Tel : 6452 1208 Fax : 6452 0614

FINAL BILL

M/S: AXA INSURANCE

ACCIDENT DATE: 29/05/2019

REF: --

OIC: MR HSIAO TONG

OUR REF: SGK9799D

DATE: 2/7/2019

ITEM NO.	DESCRIPTION	UNIT PRICE	AMOUNT
1	Repair Cost	\$ 3,000.00	\$ 3,000.00
2	LTA/Merimen Search Fee	\$ 1.87	\$ 1.87
3	Loss of Rental/Use (w/o GST) [\$120.00X16]	\$ 1,920.00	\$ 1,920.00
4	Loss of Income (w/o GST) [\$00X00]	\$ -	\$ -
5	Towing Fee	\$ -	\$ -
6	Surveyor Fee	\$ -	\$ -
REMARKS :		SUB TOTAL :	\$ 4,921.87
		7% GST	\$ 210.13
		GRAND TOTAL :	\$ 5,132.00

Yours faithfully,



Authorise Signature of Ding Auto Pte Ltd