

22/03/2019

ASS. REC. BY:

REF: 53/FCI 19009536 / Gcd 52

Special Instruction:

Surveyor: GQ

ASSIGNMENT (Office)

From (Person): Joanne Yong

of FCI

Date/Time: 4:24pm 28/5/19

Estimated Cost:

Bill to:

OD (TP) / WS / TP RES / OD RES / EVA / INV / MV / CS

To Inspect Vehicle No:

SLB 8623Y

Insured:

SHA 7317R

at Workshop m/s

J-L Auto Services

Tel:

91885495

of

Blk 3006 Ubi Road / #01-346

Policy No:

Claim No:

D19003477MFSH

Sum Insured:

Excess:

Make of Veh:

D.O.A.

24/05/2019

(Client's Record)

CA / REV / REP. / REV 24 HRS

(up)

H.O.D. Endorsement:

Date/Time:

9:38am 28/5/19

Person Contacted:

Mr. Jay

Vehicle IN / OUT

Date/Time

Action/Instruction

Echomote (X)

SLB 8623Y - MA / INC 19009161 / 24

D.O.A - 24/05/2019

SHA 7317R - MA / INC 19009161 / 24

D.O.A - 24/05/2019

Dismantle: 2/7/2019

After repair: 3/7/2019

(08/11/13)

ASS. REC. BY:

REF F-1

ASSIGNMENT

(-2021)

From:

Date:

1.7.2019

Veh No:

SB 8623Y

Yr Regn:

29 Aug 2006

Estimated Cost:

Type: ☒ Car / ☐ M.Cycle / ☐ Bus / ☐ Van / ☐ Lorry / ☐ Taxi / ☐ Prime Mover /

OD / TP / WS / TP RES / OD RES / EVA / INV / MV

Truck / Trailer or

To Inspect Vehicle No:

SB 8623Y

Make:

Toyota wish

c.c.

1794

at Workshop n/s

J-L Auto Service

Colour:

Blue

A/C:

Insured / Std / NI / NA

of

Blk 3006 ubi road 1 # 01-346

Sp. Reading

T/Radio: Insured / Std / NI / NA

Insured:

Eng/No:

Policy No.

C/No:

ZNE 100325057

Claims No.

Gen. Cond: ☒ Good / ☐ Fair / ☐ Poor / ☐ Burnt

Sum Insured:

Excess:

Steering: ☒ In order / ☐ Jammed / ☐ Leaked / ☐ Burnt or

(Client's Record)

Brake: ☒ In order / ☐ Jammed / ☐ Leaked / ☐ Burnt or

Make of Veh:

Modi: Nil / S/Rim / STD A/Rim or

Tyre Size:

F:

195/65 R/S

R:

11

(Policy Condition)

Remark: The veh had commenced its repair at the time of inspection.

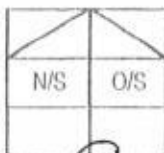

Bal. or Market Value:

\$19k

IDAC Accident Rpt:

Consistent? : Yes or No

Front

R/Bal.

6

mm

Rear

R/Bal.

6

mm

GIA / PR Seen:

Consistent? : Yes or No

L/Bal.

6

mm

L/Bal.

6

mm

Est. Repairs:

days

Res.: Yes or No

D.O.A.

D.O.I.

01-07-19

Lum Sum:

%

3 Val.: Yes or No

Survey held at

W/S

1230pm

CA / REV / REP. / 24 HRS

Vehicle: IN / OUT

Date:

Person Contacted:

Des. of Damages: ☒ Frt / ☒ Rear / ☐ O/S / ☐ N/S / ☐ U/C / ☐ Rooftop or

The U/C / Chassis frame / Body Structure affected due to collision.

Date / Time

Action / Instruction

Date/Time, File Pass to?

☐

Preli. Report

1)

☐

Final Report

Date/Time, File Return to?

2)

Days Of Repair:

Resurvey No. of Trip:

2

Survey Fee:

Transportation:

S + RS, \$

Photos

Others

TOTAL

Report Format:

PR

Lump Sum / I.B.I. (\$))

Add Fee:

☐

Site Insp (\$

☐

Interview (\$

☐

Tech. Invs (\$

☐

Weekend (\$

MOTOR SURVEY ASSIGNMENT

Date	27-05-2019	Our Ref No. D19003477MFSH
Accident Date	24-05-2019	Claim Type. Third Party
Insured Vehicle	SHA7317R	Third Party Vehicle. SLB8623Y
Survey Location	BLK 3006 UBI ROAD 1 #01-346	
Contact Person.	MR TAY	
Contact No.	91885495/ 91885495	Fax No. 0
Survey Type	WITHOUT PREJUDICE:	
Appointed Surveyor	LKK AUTO CONSULTANTS PTE LTD	
Contact Person	NA	Fax No. 68416315
Contact Number.	NA	

FOR DIRECT SETTLEMENT

Please submit to us the Tax Invoice together with letter of claim for Rental OR Loss of use (based on NIMA Benchmark rates) together with your survey report.

THIRD PARTY SURVEY REQUEST

Cc : Workshop	JL AUTO SERVICES PTE LTD	Attention. NIL
Cc : TP Solicitor	KSCGP JURIS LLP	TP Solicitor Fax No. NA
Officer Incharge	JOANNEY	

IMPORTANT NOTE

Kindly submit the survey report via CWS within 14 days for survey assignment and 7 days for re-inspection.
This is a computer generated letter, no signature required.

SINGAPORE ACCIDENT STATEMENT

IMPORTANT NOTICE

1. Please report correctly the details of the accident to speed up the claims process.
2. This Form must be completed by the Policyholder and/or the Authorised Driver.
3. Information provided must be as truthful and accurate as possible. Any wilful misrepresentation or withholding of material facts may allow insurance companies to repudiate policy liability.
4. The issue and acceptance of this Form by insurance companies is not an admission of policy liability on the part of the insurance companies.
5. Any false reporting may be referred to the Police for investigation.
6. This report will be forwarded by the insurers of the GIA Records Management Centre established by the General Insurance Association of Singapore (GIA) for archiving and that copies of this report will, for a fee, be made available upon application by interested parties.
7. By the lodgement of this report to the insurers, you hereby consent to the archiving of this report at the centre and to copies of the report being made available aforesaid.

ACCIDENT STATEMENT

Date Of Report	24/05/2019 14:04
Date Of Accident	24/05/2019 13:05
Exact Location Of Accident	JUNC AYE (TUAS) & SOUTH BUONA VISTA RD
Country/State of Loss	SINGAPORE

DETAILS OF OWN VEHICLE

Vehicle Registration Number	SLB8623Y
Insured/Policyholder	
Name Of Registered Owner	VASRO RENTALS
Co Reg No	53367446L
Email Address	NOEMAIL
Mobile Phone No	(LOCAL) +65-91885495
Alternative Phone No	OFFICE-91885495

Vehicle Particulars

Manufacturer	TOYOTA
Model	WISH 1.8 A
Exact Purpose for which vehicle was being used at time of accident	COMMERCIAL USE
Are you claiming under your own insurance policy for repair to your vehicle?	NO
If No, Please state action to be taken	THIRD PARTY
Vehicle Category	PRIVATE HIRE

Insurance Company

Name of Insurance Company	NTUC INCOME INSURANCE CO-OPERATIVE LTD
Type Of Coverage	COMPREHENSIVE
Fleet Policy	YES
Policy Number	5093371571-01
Cover Note Number	

Driver

Name of Driver	HAFIZAH BINTE JAMIL
NRIC No	S8032454E
Date Of Birth	12/10/1980
Occupation	OUTDOOR
Date Of Driving Pass	05/12/2002
Driving Experience	16 YEARS AND 5 MONTHS
Gender	FEMALE
Mobile Number	(LOCAL) +65-98440210
Fax Number	
Contact Number	OFFICE-98440210
E-Mail Address	NOEMAIL

Address	BLK 162 JALAN TECK WHYE #08-202
Postcode	680162
Was driver an employee of the Insured's Company	NO
If No, Relationship of the Driver with the Insured	OTHER - HIRER
Vehicle Registration Number of Driver's Own Vehicle	-
Insurance Company of Driver's Own Vehicle	-

General Information of the Accident

Type Of Accident	COLLISION - HEAD TO REAR
Weather Conditions	CLEAR
Road Surface	DRY

Other Information

Was any foreign vehicle involved in this accident?	NO
Number of vehicles (including own vehicle) involved in the accident	2
Was any body injured in the Accident?	NO
Was any injured conveyed to hospital by ambulance?	
Was any other material or property damaged?	YES
I have been approached by unknown person(s) soliciting/offering accident claims assistance.	NO
Number of Passengers (Including Driver)	2
Passenger 1	NAME: : - GENDER: : MALE

Details of Police Action

Was the accident reported to the police?	NO
If Yes, Please state which Police Station	
Was notice of intended Prosecution given?	NO
If Yes, against whom?	

Circumstances of Accident

ON STATED DATE AND TIME, MY VEHICLE WAS STATIONARY STOPPED ALONG THE STATED VENUE AS TRAFFIC JUNCTION WAS RED. SUDDENLY I FELT AN IMPACT OF MY VEHICLE AND REALIZE THAT VEHICLE B HIT ONTO MY VEHICLE REAR PORTION.

Attachment(s)

Are accident photos available for attachment?	YES
Was there any video captured by Car Camera?	NO
Was there any audio recorded?	NO

DETAILS OF OTHER VEHICLE PROPERTY 1

Vehicle Registration Number	SHA7317R
Vehicle Make/Model/Colour	
Details Of Properties	
Vehicle Category	TAXI
Name of Driver	LIM ENG GUAN
NRIC/Passport Number	S1627862I
Contact Number	
Address	
Postcode	
Insurance Company Name	

Nature Of Damage

No. Of Passenger (Including Driver)

1

Accident Sketch Plan

SKETCH PLAN

IMPORTANT NOTICE

1. Please report correctly the details of the accident to speed up the claims process.
2. This Form must be completed by the Policyholder and/or the Authorised Driver.
3. Information provided must be as truthful and accurate as possible. Any wilful misrepresentation or withholding of material facts may allow insurance companies to repudiate policy liability.
4. The issue and acceptance of this Form by insurance companies is not an admission of policy liability on the part of the insurance companies.
5. Any false reporting may be referred to the Police for investigation.
6. The report will be forwarded by the insurers of the GIA Records Management Centre established by the General Insurance Association of Singapore (GIA) for archiving and that copies of this report will for a fee be made available upon application by interested parties.
7. By the lodgment of this report to the insurers, you hereby consent to the archiving of this report at the centre and to copies of the report being made available aforesaid.
8. **Consent under the Personal Data Protection Act (PDPA)**

I understand, acknowledge, agree and consent that:

- (a) My insurer, my workshop and the General Insurance Association of Singapore ("GIA") may/are permitted to collect, use, disclose and/or process my personal data/personal information set out in this [form] and any other personal information provided by me or possessed by my insurer (collectively the "Personal Information") and disclose and transfer such Personal Information to all insurer(s) who have insured vehicle(s) involved in this accident (all insurer(s) who have insured vehicle(s) involved in this accident shall be collectively referred to as the "Insurers"), the Insurers' lawyers/law firms, the Monetary Authority of Singapore and any relevant government agency/authority (such as the police), for the purpose(s) of:
 - (i) processing, handling and/or dealing with my claims including the settlement of the claims and any necessary investigations relating to the claims;
 - (ii) investigating the accident and/or my claims;
 - (iii) carrying out and/or dealing with my instructions or responding to any enquiries by me;
 - (iv) administering my claims (including the mailing of correspondence, statements, invoices, reports or notices to me, which could involve disclosure of certain personal data about me to bring about delivery of the same as well as on the external cover of envelopes/mail packages); and/or
 - (v) complying with applicable law in administering, processing, handling and/or dealing with my claims (collectively the "Purposes")
- (b) all insurer(s) who have insured vehicle(s) involved in this accident and the Insurers' lawyers/law firms, may/are permitted to collect, use, disclose and/or process my Personal Information for one or more of the above Purposes; and
- (c) my Personal Information may/can be disclosed by any of the Insurers and/or GIA to their third party service providers or agents (including their lawyers/law firms), which may be sited outside of Singapore, for one or more of the above Purposes.
- (d) my Personal Information will also be collected and used to compile claims history for the purpose of fraud detection, investigation and management in present and all future claims.
- (e) the information so collected under (d) above may be shared / disclosed:
 - (i) to all insurers and/or any other third parties that assist in evaluating, investigating, controlling or managing fraud, regulators, law enforcement and government agencies as reasonably required for the purposes stated, or
 - (ii) for complying with requirements under any regulations, laws or court orders.



Policyholder's Signature
Date & Time:

Driver's Signature
(If driver is not the policyholder)
Date & Time:

Reporting Centre Personnel's Signature
Name:
NRIC/FIN No.:

Accident Sketch Plan

SKETCH PLAN

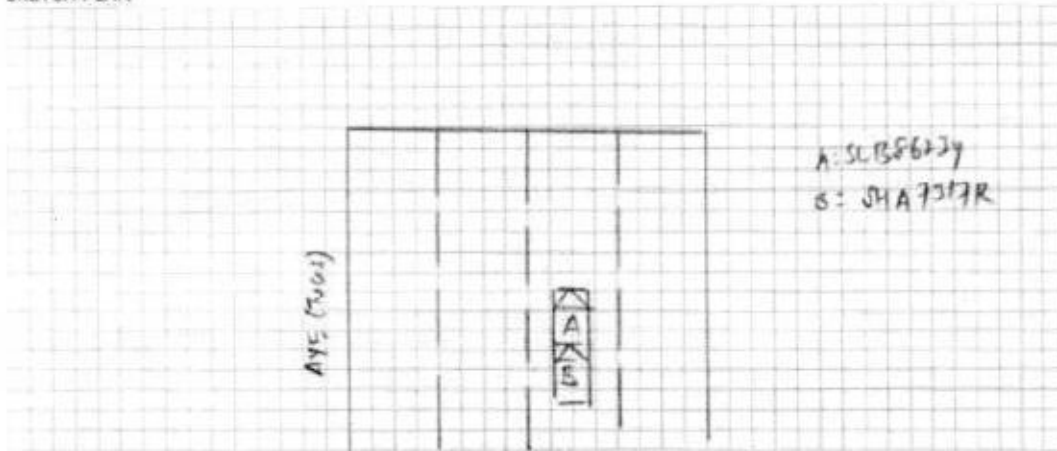

DESCRIBE CIRCUMSTANCES OF THE ACCIDENT

Reck 42 Stuttering.

[A large, loopy handwritten signature is written across the middle of the section.]

DECLARATION

I/We declare that the particulars are true in every respect.



Policyholder's Signature
Date & Time:

Driver's Signature
(If driver is not the policyholder)
Date & Time:

Reporting Centre Personnel's Signature
Name:
NRIC/FIN No.:

10/1/2018 10:10:10 AM

> Back to OneMotoring

Enquire PARF/COE Rebate for Registered Vehicle

Owner ID Type:	Business
Owner ID:	7446L
Vehicle No.:	SLB8623Y
Vehicle to be Exported:	No
Intended Deregistration Date:	01 Jul 2019
Vehicle Make:	TOYOTA
Vehicle Model:	WISH 1.8 A
Primary Colour:	Blue
Manufacturing Year:	2006
Engine No.:	1ZZ2690617
Chassis No.:	ZNE100325057
Maximum Power Output:	97.0 kW (130 bhp)
Open Market Value:	\$19,298.00
Original Registration Date:	29 Aug 2006
First Registration Date:	29 Aug 2006
Transfer Count:	2
Actual ARF Paid:	\$21,228.00
PARF Eligibility:	Forfeited
PARF Eligibility Expiry Date:	-
PARF Rebate Amount:	\$0.00
COE Expiry Date:	31 May 2021
COE Category:	B - Car (1601cc & above)
COE Period(Years):	5
PQP Paid:	\$23,024.00
COE Rebate Amount:	\$8,813.00
Total Rebate Amount:	\$8,813.00

Please note that the 5-year COE for this vehicle cannot be further renewed. The vehicle must be de-registered upon COE expiry or when the vehicle reaches its statutory lifespan (if applicable), whichever is earlier.

The information contained herein is correct as at 01 Jul 2019

OK

▶ Wish Used Vehicle List (19 vehicles)

Car Model	Price	Depreciation	Reg Date	Eng Cap	Mileage	Company	Availability
Toyota Wish 1.8A X (New 10-yr COE) Office No. - 63443344 Mave - 90099586 3.18% P.A. \$788 Monthly. \$0 Admin Fees For All GV Purchase. Extra Add On Items: New 2 Years Warranty For Engine And Gearbox. New 2k Metallic Paint. New Pure Leather. New Rims 16" Tyres. New Pioneer D...	\$61,800	\$6,170 /yr	01-Jul-2009	1,797 cc	-	GV Credit Pte Ltd	Available
Toyota Wish 1.8A (COE till 06/2020) Grantee Buy Back End Of Day Body 1k, Get Full Loan, Full Reconditioned Engine, Transmission And Aircon. Worn Parts Replaced And Repaired. We Provide In House Loans And Other Financial Services To Meet... Office No. - 63443344 Eric - 97795888 Jimmy Chan - 97789888	\$11,800	\$12,130 /yr	21-Jun-2005	1,794 cc	-	GV Credit Pte Ltd	Available
Toyota Wish 1.8A (COE till 02/2021) Weekend Promo! Don't Take The Risk! Buy From A Case Trust Co! Beautiful TOYOTA WISH Looking For New Owner! Too Good For De-Registration. Preciously Taken Care And Well Maintained By Previous Owner Mdm Yat... Office No. - 64666220 Frankie Chen - 97281121 Shah - 97308666 Darren Yeo - 86088466 Nanda - 84374929	\$16,800	\$10,240 /yr	20-Feb-2006	1,794 cc	127,452 km	Car House Pte Ltd	Available
Toyota Wish 1.8A (COE till 03/2021) Engine, Gearbox And Undercarriage Are All In Good Running Condition, No Repairs Is Needed. Owner Registering Existing Car Plate Numbers To New Car. A New Car Plate Numbers Will Be Allocated. Office No. - - James - 81170055	\$16,800	\$9,890 /yr	13-Mar-2006	1,794 cc	-		Available
Toyota Wish 1.8A (COE till 04/2021) Powerful, Fuel Economical, Well Maintained MPV. Recently Changed 4 Tyres. Spacious And Comfort, Good For Families. Selling As I Am Relocating To Another Country For Couple Of Years. Office No. - - Sara - 91132600	\$15,500	\$8,810 /yr	04-Apr-2006	1,794 cc	169,312 km		Available
Toyota Wish 1.8A (COE till 05/2021) 1 Owner, One Year In-House Warranty, High Loan Available, Price Above Stated Is Actual Selling Price, Fully Refurbished, New Paintwork Done, Wear And Tear Replaced, Accident Free, STA Or VICOM Evaluat... Office No. - 68440777 Peter Quek - 84840777 Tanisha - 88665777 Addy Ho - 88330777	\$17,800	\$9,680 /yr	03-May-2006	1,794 cc	165,000 km	Carway	Available
Toyota Wish 1.8A (COE till 05/2021) Car In Tip Top Condition, View To Appreciate. Office No. - - John - 91075758	\$19,500	\$10,610 /yr	03-May-2006	1,794 cc	179,107 km		Available
Toyota Wish 1.8A (COE till 05/2021) One Year In-House Warranty, High Loan Available, Price Above Stated Is Actual Selling Price, Fully Refurbished, New Paintwork Done, Wear And Tear Replaced, Accident Free, STA Or VICOM Evaluation Are W... Office No. - - Angel Chai - 83831777 Sam Ong - 86660777	\$17,800	\$9,480 /yr	17-May-2006	1,794 cc	155,000 km	Carway	Available
Toyota Wish 1.8A (COE till 05/2021) Get Full Loan, Full Reconditioned Engine, Transmission And Aircon. Worn Parts Replaced And Repaired. We Provide In House Loans And Other Financial Services To Meet Your Budget. Call Us Or Even Better,...	\$19,800	\$10,470 /yr	22-May-2006	1,794 cc	-	First Auto Car Pte Ltd	Available

Office No. - 69043988
Jimmy - 97789888 | John - 81455555

Toyota Wish 1.8A (COE till 05/2026) \$42,800 \$6,180 /yr 06-Jun-2006 1,794 cc 165,133 km Lake View Credit Pte Ltd Available

Cheapest/Safest Buy, Wish 1.8A With Low \$6K Depreciation With High Paper Value, Don't Miss! Low Mileage Clocked Of 13000km Annually. No Further Repairs Needed. 1 Owner. 100% Accident Free. Call Now!

Office No. - 67499895
Francis - 96778690 | Kelvin - 98789995 | Tong Hoe - 96433160

Toyota Wish 1.8A (COE till 06/2021) \$16,800 \$8,590 /yr 15-Jun-2006 1,794 cc 199,000 km Available

Very Comfortable Drive And I Have Maintained It Very Well. See It To Believe It.

Office No. - -
Muzaffar - 91682407

Toyota Wish 1.8A (COE till 05/2021) \$16,888 \$8,810 /yr 21-Jun-2006 1,794 cc 129,846 km ABS Auto Capital Pte Ltd Available

We Are The COE Specialist, No Gimmicks, Honest Dealing, 2 Owners With Low Mileage Clocked, Car In Very Good Condition, Full Loan Available! 100% Approval. Trade In Welcome, Bank Loan Available. Please...

Office No. - 64753423
Kenny - 98259995 | Roy - 83158315 | Alex - 82298229 | Ken - 91196006

Toyota Wish 1.8A (COE till 06/2021) \$16,888 \$8,440 /yr 06-Jul-2006 1,794 cc 184,000 km 360 VR Cars Available

Best Buy With Assurance And With A Peace Of Mind From Us. High Loan Available. Whatsapp To View Now! By Appointment Only!

Office No. - 69310005
Anson - 83121019 | James Tan - 90700005

Toyota Wish 1.8A (COE till 05/2021) \$15,300 \$7,980 /yr 07-Jul-2006 1,794 cc 228,607 km Quality Auto Hub Available

Nice Number Plate, Excellent Condition. Very Well Maintained By Previous Owner. View To Believe. Bank Loan/Loan/In-House Loan Available! Trade-In Most Welcome! Call/SMS/WhatsApp Our Friendly Sales Reps...

Office No. - -
Yap - 90662292 | Ng - 97387757

Toyota Wish 1.8A (COE till 06/2021) \$17,900 \$8,950 /yr 12-Jul-2006 1,794 cc 160,279 km CarQuotz Singapore Available

Drive With Assurance! 1 Yr Warranty On Major Engine And Gearbox! Genuine And Transparent Deal! Selling \$17.9k, Bank/In-House Loan Up To 100% Monthly Installment At \$658 Easy Approval! All Our Quality ...

Office No. - -
Mr Koh - 81147777 | Kelvin Tan - 84568822

Toyota Wish 1.8A X Limited (COE till 06/2021) \$17,500 \$8,750 /yr 17-Jul-2006 1,794 cc - Karz Enterprise Available

2 Owner Unit. Rare Limited Edition Model. Absolutely Well Taken Care Both Interior And Exterior By Previous Owner Without Any Touch Up From Us. Meticulously And Diligently Maintained. Drive Away With ...

Office No. - -
Alan - 82778188 | Kelvin - 82000108

Toyota Wish 1.8A (COE till 07/2021) \$19,800 \$9,600 /yr 24-Jul-2006 1,794 cc - Mutual Concept Motoring Pte Ltd Available

Hot Model Selling Again! Small Capital Can Run A Rental Business Or GRAB Business. Viewing Available Till 9pm Daily. Call Now!

Office No. - -
Benny - 82003243

Toyota Wish 1.8A (COE till 10/2026) \$50,000 \$6,840 /yr 20-Oct-2006 1,794 cc - Autobahn Motors (S) Pte Ltd Available

High Loan Available. High Paper Value Of \$44k. Able To Get Back About \$5k Of Unused COE Value At The End Of COE When Deregistered. Call Now To Make An Appointment To View!

Office No. - 68354800
Krez - 91525757

Toyota Wish 1.8A (COE till 08/2021) \$19,800 \$9,130 /yr 10-Nov-2006 1,794 cc - BB Cars Pte Ltd Available

Well Kept And Low Maintenance MPV, Worry Free For Next Owner. Flexible Loan Package Available. Call Now To Enquire And Arrange For A

Test Drive!

Office No. - -

Adam Tan - 91818747

Toyota Wish 1.8A (COE till 07/2026) **\$42,800** **\$6,040 /yr** **13-Nov-2006** **1,794 cc** **194,473 km** **Lake View Credit Pte Ltd** **Available**

Confirm Cheapest/Best Condition Wish 1.8A! High \$37,500 Paper. Low Mileage Clocked Of 15500km Annually. Mint Condition. 1 Owner. New Car Number. 100% Accident Free. Price Slight Negotiable. Call Now!

Office No. - 67459995

Cindy - 97955756 | Kelvin - 98789995 | Jason - 97643266

sgCarMart is the number one car classifieds for parallel import cars, Toyota, Honda, Nissan, Mitsubishi & BMW. There are plenty of cars for sale, even for COE cars, OPC cars, vans, trucks, hybrid cars, sports cars or stationwagons. You can also buy from a car auction, look up car loans, financial services, low mileage cars, car brands, carpark rates & car insurance. We have new car dealers comprising parallel importers, authorised car dealers, and used car dealers on our site. Find new car price lists, new car launches and new car promotions, and also motoring advice, car reviews & car news on the latest models. Visit our partner sites for job openings for Singapore jobs, real estate properties for sale, mover, car performance parts, car discussion, forum discussion, commercial vehicle leasing & COE results.

© 2004-2019 sgCarMart. All rights reserved.

**LKK Auto Consultants Pte Ltd**

51 Ubi Ave 1 #01-25 Paya Ubi Industrial Park, Singapore 408933

TEL: 6256 3561 FAX: 6256 4315

Reg. No: 199607198R GST Reg. No. 19-9607198-R

Page No.:1 of 1

PRE-REPAIR INSPECTION REPORT

MS FIRST CAPITAL INSURANCE LTD
36 ROBINSON ROAD
#16-01 CITY HOUSESINGAPORE 068877

Ref: CS3/FCI19009536/Gcd3s2

Date: 15-07-2019



Code: FCI2

1. Policy Particulars :- (THIRD PARTY CLAIM)

Insured Veh.	SHA 7317R	Veh. Inspected	SLB 8623Y
Policy No.		Coverage (\$)	0.00
Claim No.	D19003477MFSH	Excess (\$)	0.00
Assign From	JOANNE YONG	Assign Date	28/05/2019

2. Vehicle Particulars & Condition

Make & Model	TOYOTA WISH	c.c	1794
Engine No.	HIDDEN	Year of Reg.	2006
Chassis No.	ZNE100325057	Colour	BLUE
Odometer	-	Steering	IN ORDER
Brakes	IN ORDER	Modification	STANDARD ALLOY RIM
General	GOOD		

3. Conditions of Tyres

	Size	Make	Balance
R/H Front Tyre	195/65R15	FIRESTONE	6 mm
L/H Front Tyre	195/65R15	FIRESTONE	6 mm
R/H Rear Tyre	195/65R15	FIRESTONE	6 mm
L/H Rear Tyre	195/65R15	FIRESTONE	6 mm

4. Description of Damages

THE VEHICLE SUSTAINED DAMAGES AT THE REAR PORTION.

**5. General Information**

Accident Date	24/05/2019	Inspect Date / Time	01/07/2019 (01:30 PM)
Survey held at	JL AUTO SERVICES PTE LTD BLK 3006 UBI ROAD 1 #01-346 KAMPONG UBI INDUSTRIAL ESTATE SINGAPORE 408700		

5a. Remarks

A) THE INSPECTION WAS CONDUCTED ON A "WITHOUT PREJUDICE" BASIS.
B) THE REPAIR ESTIMATE WAS NOT PRESENTED AT THE TIME OF INSPECTION.
THE REPAIRER WAS TOLD TO PREPARE THE ESTIMATE.
C) ENCLOSED PLEASE FIND DAMAGED VEHICLE PHOTOGRAPHS.
D) MARKET VALUE: \$19,000.00

Report Ref No. CS3/FCI19009536/Gcd3s2

Inspected By

XING GUO QIANG

M.MATAI, AMSAE-A

Automotive Assessor

K.K. LAU CPT(RET)

BEng(Hons), B.Bus, MBA, PEng, PE, MInstAEE, MASME, MIRTE

REGD Auto Consultant-SAE, Licensed Appraiser

DISCLAIMER OF LIABILITY TO THIRD PARTIES:- This Report is made solely for the use and benefit of the Client named on the front page of this Report.
No liability of responsibility whatsoever in contact or tort is accepted to any third party who may rely on the Report wholly or in part. Any third party acting or
relying on this Report, in whole or in part, does so at his or her own risk.