

(08/11/13) vwpf

ASS. REC. BY: MAR 26

REF:

vvinh

ASSIGNMENT

From: _____ Date: _____

Estimated Cost: _____

OD / TP / WS / TP RES / OD RES / EVA / INV / MV

To Inspect Vehicle No: SLL1634Jat Workshop m/s Choo note -

of _____

Insured: SLK5156B

Policy No. _____

Claims No. _____

Sum Insured: _____ Excess: _____

(Client's Record)

Make of Veh: _____

(Policy Condition)

Remark: The veh had commenced its
repair at the time of inspection.

| | |
|-----|-----|
| | |
| N/S | O/S |
| | |

Bal. or Market Value: 98

IDAC Accident Rpt: _____ Consistent? : Yes or No

GIA / PR Seen: _____ Consistent? : Yes or No

Est. Repairs: 3 days Res.: Yes or NoLum Sum: 2 % 3 Val.: Yes or No

CA / REV / REP. / 24 HRS

LTAS9800

Vehicle: IN / OUT

Date: _____ Person Contacted: _____

Veh No: SLL1634J Yr Regn: 2117Type: M.Car / M.Cycle / Bus / Van / Lorry / Taxi / Prime Mover /Truck / Trailer or CA /Make: Mer Benz CLA 180 coupe 1595Colour: Cy A/C: Insured / Std / NI / NASp. Reading: 43921 T/Radio: Insured / Std / NI / NA

Eng/No: _____

C/No: WDD 1173422N 445604Gen. Cond: Good / Fair / Poor / BurntSteering: In order / Jammed / Leaked / Burnt orBrake: In order / Jammed / Leaked / Burnt or

Modi: Nil / S/Rim / STD A/Rim or

Tyre Size: F: 225/40 R18

R: _____

BS / DUN / EXNOVA / GY / FS / LIZA / MIC / OHTSU / PIR / SUMI /

TOYO / YOKO or

Front

Rear

R/Bal. 6 mm R/Bal. 6 mmL/Bal. 6 mm L/Bal. 6 mmD.O.A. 28/5/19 D.O.I. 29/5/19

Survey held at _____

Des. of Damages: Frt / Rear / O/S / N/S / U/C / Rooftop or

015 M.

The U/C / Chassis frame / Body Structure affected due to collision.

Date / Time

Action / Instruction

10/6/19 L/S 5300 confirmed with Alan.

Date/Time, File Pass to?

☐

Preli. Report

1)

☐

Final Report

Date/Time, File Return to?

2)

Days Of Repair: _____

Resurvey No. of Trip: _____

Add Fee: ☐ : Site Insp (\$☐ : Interview (\$☐ : Tech. Invs (\$☐ : Weekend (\$

Survey Fee:

Transportation:

) \$ + RS. \$

) Photos

) Others

TOTAL

Report Format :

Lump Sum / I.B.I: (\$ _____)

CHOO MOTOR SPRAY PAINTER
BLK1 KAKI BUKIT AVE 6
#01-39 AUTOBAY
SINGAPORE 417883

Not Attached
Haha
4/5 \$5300
3dy 28/5/19

VEHICLE NO: SLL 1634Y

| QTY | PARTICULAR |
|-------|---|
| 1 PCS | FRONT BUMPER 1534.30 |
| 1 SET | FRONT BUMPER CLIPS |
| 1 PCS | FRONT BUMPER REINFORCEMENT |
| 1 PCS | FRONT BUMPER LOWER CHROME MOULDING 288.43 |
| 1 PCS | FRONT BUMPER PDC SENSOR O/S |
| 1 PCS | FRONT BUMPER SPONGE |
| 1 PCS | HEADLAMP ASSY O/S 3126.28 |
| 1 PCS | FRONT SUPPORT PANEL 805.30 |
| 1 PCS | FRONT FENDER O/S |
| 1 PCS | FRONT SPORT RIM O/S |

| | |
|------|-------------|
| Depo | \$1,866.02 |
| re | \$60.00 |
| re | \$715.00 |
| re | \$311.00 |
| re | \$265.00 |
| re | \$199.00 |
| re | \$4,850.00 |
| re | \$1,016.00 |
| re | \$1,266.00 |
| re | \$1,200.00 |
| | \$11,748.02 |

102

LABOUR CHARGES:

| |
|--|
| TO CHECK WIRING |
| TO DISMANTLE & REFIX FRONT PDC SENSOR |
| TO REFILL AIR CON GAS |
| TO CONDUCT WHEEL ALIGNMENT |
| TO SPRAY RUST PROOFING |
| LABOUR FOR PANEL BEATING & REPLACING PARTS |
| TO PUTTY & SPRAY PAINTING |

| | |
|-------|-------------|
| | \$80.00 |
| | \$80.00 |
| | \$120.00 |
| | \$120.00 |
| | \$50.00 |
| | \$580.00 |
| | \$800.00 |
| TOTAL | \$13,578.02 |

LKK Auto Consultants hence notify the Repairer of the following:

- To remedy before/after spray painting
- To display damaged part(s) during remedy
- Parts prices are subject to confirmation
- Third party survey is on a "Without Prejudice" basis
- No legal mediation(s) is allowed
- Supplementary item(s) must be remedied and is subject to final approval from Insurance Company

Acknowledged by Repairer

Signature:

Date:

6013.28
5411.95
6661.55
8329

> Back to OneMotoring

Enquire PARF/COE Rebate for Registered Vehicle

| | |
|-------------------------------------|--------------------------------------|
| Vehicle Owner Particulars | |
| Owner ID Type: | Singapore NRIC |
| Owner ID: | 8292I |
| Vehicle Details | |
| Vehicle No.: | SLL1634J |
| Vehicle to be Exported: | No |
| Intended Deregistration Date: | 29 May 2019 |
| Vehicle Make: | MERCEDES BENZ |
| Vehicle Model: | CLA180 COUPE URBAN (R18 LED) |
| Primary Colour: | Grey |
| Manufacturing Year: | 2016 |
| Engine No.: | 27091031137639 |
| Chassis No.: | WDD1173422N445604 |
| Maximum Power Output: | 90.0 kW (120 bhp) |
| Open Market Value: | \$28,839.00 |
| Original Registration Date: | 16 Feb 2017 |
| First Registration Date: | 16 Feb 2017 |
| Transfer Count: | 0 |
| Actual ARF Paid: | \$27,375.00 |
| Intended PARF Rebate Details | |
| PARF Eligibility: | Yes |
| PARF Eligibility Expiry Date: | 15 Feb 2027 |
| PARF Rebate Amount: | \$20,531.00 |
| Intended COE Rebate Details | |
| COE Expiry Date: | 15 Feb 2027 |
| COE Category: | A - Car up to 1600cc & 97kW (130bhp) |
| COE Period(Years): | 10 |
| QP Paid: | \$50,889.00 |
| COE Rebate Amount: | \$39,269.00 |
| Total Rebate Amount: | \$59,800.00 |

The information contained herein is correct as at 29 May 2019

OK

FREE VALUATION

Let us tell you how much your car can sell for!

No obligations and it's FREE!

How much is my car worth?



Post an Advertisement

Sell it yourself! Advertise it at just
\$58 until it's SOLD!

Post an Ad

Advertiser Login

Ways of Selling

As Good As New CLS450 AMG Line 4MATIC For Sale!

New Generation CLS450 AMG
With EQ Boost, 3 Years
Warranty By Cycle And Carriage!
Seng Hup Auto Stand

HIN LUNG AUTO
Ho Bee Group
One Stop Car Hub
Finance, Insurance, Workshop
New and Used Cars

Browse by Category

« Back (1 2 3) Next »





Sort by Date Posted

20 results/page

49 vehicles

cla 180

Advanced Search Submit

| Make | Model | Price | Depreciation | Reg Date | Eng Cap | Mileage | Veh Type | Status |
|---|--|------------------|--------------|-------------|----------|-----------|-----------|-----------|
| Search Selection | cla 180 | Any | Any | 2017 | Any | Any | Any | Available |
|  | Mercedes-Benz CLA-Class CLA180 Urban | \$120,500 | \$12,920 /yr | 18-Sep-2017 | 1,595 cc | 14,000 km | Luxury | Available |
| New Arrival! Most Valued Buy! Beautiful White Unit With Pristine Condition! Peace Of Mind! Fully Serviced By Agent And Still Under 3 Years Warranty! Accident Free! Lowest Genuine Mileage At Only 14000... | | | | | | | | |
| Posted: 29-May-2019 Tags: 2017 Mercedes-Benz CLA180, 2017 mercedes-benz cla180, Mercedes-Benz CLA180, mercedes-benz cla180, Mercedes-Benz, CLA180, cla180, Used Mercedes-Benz | | | | | | | | |
|  | Mercedes-Benz C-Class C180 Avantgarde | \$146,800 | \$15,030 /yr | 14-Sep-2017 | 1,595 cc | 26,000 km | Luxury | Available |
| 1 Owner, Full C&C Agent History, Beautiful Diamond Silver With Gorgeous Black Interior, Immaculate Condition, Warranty Till Oct 2020, Call Our Sales Consultants Or Drop By Showroom To View This Pristi... | | | | | | | | |
| Orchard Credit Pte Ltd | | | | | | | | |
| Posted: 29-May-2019 Tags: 2017 Mercedes-Benz C180, 2017 mercedes-benz c180, Mercedes-Benz C180, mercedes-benz c180, Mercedes-Benz, C180, c180, Used Mercedes-Benz | | | | | | | | |
|  | Mercedes-Benz B-Class B180 Style | \$103,000 | \$11,780 /yr | 28-Feb-2017 | 1,595 cc | 14,805 km | Hatchback | Available |
| Agent Warranty Till Feb 2020. 160-Point Quality Assurance Check Done. Beautiful Paintwork. | | | | | | | | |
| Inchape Pre-Owned | | | | | | | | |
| Posted: 29-May-2019 Tags: 2017 Mercedes-Benz B180, 2017 mercedes-benz b180, Mercedes-Benz B180, mercedes-benz b180, Mercedes-Benz, B180, b180, Used Mercedes-Benz | | | | | | | | |
|  | Mercedes-Benz C-Class C180 Avantgarde | \$135,500 | \$14,620 /yr | 02-May-2017 | 1,595 cc | 36,761 km | Luxury | Available |
| 1 Owner, Full Servicing By C&C, Warranty Under C&C, Brand New Condition. | | | | | | | | |
| Posted: 29-May-2019 Tags: 2017 Mercedes-Benz C180, 2017 mercedes-benz c180, Mercedes-Benz C180, mercedes-benz c180, Mercedes-Benz, C180, c180, Used Mercedes-Benz | | | | | | | | |

Car Buying

Car Selling

Car Ownership

Car Aftermarket

On The Move

Lifestyle

[Buy Tyres Online!](#)
[Latest Special Offers from Tympac!](#)
**Mercedes-Benz A-Class A180 Style****\$98,800**

\$11,540 /yr

20-Feb-2017

1,595 cc

31,000 km

Hatchback

Available

Best Price With 2.28% Interest Rate, Full Maintained And Warranty By C&C, Service Just Done, Next Service Due Feb-2020! As Good As New Car Condition, But Save You Lots Of Money And Waiting Time! New N...

Auto Zoom Enterprise Pte Ltd

Posted: 29-May-2019

Tags: 2017 Mercedes-Benz A180, 2017 mercedes-benz a180, Mercedes-Benz A180, mercedes-benz a180, Mercedes-Benz, A180, a180, Used Mercedes-Benz

**Mercedes-Benz C-Class C180 Avantgarde****\$143,800**

\$14,920 /yr

10-Aug-2017

1,595 cc

19,000 km

Luxury

Available

100% Loan Approval To Drive Away! SLS3000 Nice Number Plate Tag Along On This Beautiful Black On White Beast! Best Selling Mercedes Model! Optional Accessories Upgrades Available! Test Drive Welcome! ...

Compare

Don Motoring

CHOO MOTOR SPRAY PAINTER

1 Kaki Bukit Ave 6 #01-39 Autobay

Singapore 417883

Co. Reg No: 22736900M

Tel No: 67452063 / 67467158 Fax No: 67458520

Date 24.06.2019

India International Insurance Pte Ltd

64 Cecil Street

#04-05 IOB Building

Singapore 049711

Attn: Motor Claims Department

Dear Sirs,

ACCIDENT INVOLVING VEHICLE: SLL 1634J AND SHC 8361U ON 14.05.2019

We are the authorized repair workshop for the owner of motor vehicle no: **SLL1634J**, which was involved in the captioned accident with your insured vehicle: **SHC8361U**. The vehicle owner has requested and authorized us to assist him in presenting his/her claim against the party responsible for the damage to the vehicle.

As the accident was caused by the negligent act of your insured driving, we are submitting these claims for your consideration on behalf of the owner/claimant.

| | | |
|---------------------------------|-----------|-----------------|
| 01) Cost of Repair | \$ | 5,300.00 |
| 02) Loss Of Use (3 day x \$120) | \$ | 360.00 |
| | <u>\$</u> | <u>5,660.00</u> |

We enclosed herewith the following documents to support the claims:-

- | | |
|------------------------------------|----------------------------------|
| a) Final Repair Bill | b) Vehicle Registration Log Card |
| c) GIA Report | d) I/C & Driving Licence |
| e) Insurance Certificate | |
| g) Letter of Authorisation, etc... | |

Kindly look into the matter and let us hear from you on the settlement of our customer's claims as soon as possible.

Please note that it is a condition of any settlement reached that it shall be without prejudice to any personal injury claim (if any) of the owner/claimant.

Thank you.

Yours faithfully,

For Choo Motor Spray Painter
Jason Tang

TAX INVOICE

CHOO MOTOR SPRAY PAINTER

1 Kaki Bukit Ave 6 #01-39 Autobay

Singapore 417883

Co. Reg No: 22736900M

Tel No: 67452063 / 67467158 Fax No: 67458520

India International Insurance Pte Ltd

64 Cecil Street

#04-05 IOB Building

Singapore 049711

Attn : Motor Claim Department

Invoice : 21121

Date: 24.06.2019

Vehicle No: SLL1634J

Make/Model: MERCEDES BENZ

Chassis/Eng# :

Accident Date: 28.05.2019

Claim No : 0519-21121

Reference :

Policy No :

| | Amount |
|-------------------------------|-------------|
| To proceed on lump sum repair | SS 5,300.00 |

E. & O. E.

Total : SS 5,300.00

Amount Due : SS 5,300.00



CHOO MOTOR SPRAY PAINTER

DATE : 24th June 2019

TO : India International Insurance Pte Ltd

RE : ACCIDENT INVOLVING VEHICLE NO. SLL1634J & SLK5156B

ALONG Layang Port Carpark

ON 28/5/2019

I/We, Chua Chee Yon. Alvin

of (NRIC No./ROC No.) S7838295I

of 89 Yishun Street 81 #06-10 S768449

owner of vehicle no. SLL1634J in consideration of M/s CHOO MOTOR SPRAY PAINTER repairing my/our vehicle SLL1634J at my/our instruction and hereby authorise M/s CHOO MOTOR SPRAY PAINTER to demand claim settlement whatever amount settled/payable by the Insurance Company and/or third party or to commence legal proceedings, if necessary, under my name, for the cost of repairs, car rental and/or loss of use, etc. and to their appointing solicitor to act for me/us in respect of the said accident/claim and all claimed and/or settled shall belong to them absolutely.

I/We further agree and undertake to indemnify them against the above-mentioned claim cost which may arisen therewith.

Signature of Owner :



Name of Owner :

SINGAPORE ACCIDENT STATEMENT

IMPORTANT NOTICE

1. Please report correctly the details of the accident to speed up the claims process.
2. This Form must be completed by the Policyholder and/or the Authorised Driver.
3. Information provided must be as truthful and accurate as possible. Any wilful misrepresentation or withholding of material facts may allow insurance companies to repudiate policy liability.
4. The issue and acceptance of this Form by insurance companies is not an admission of policy liability on the part of the insurance companies.
5. Any false reporting may be referred to the Police for investigation.
6. This report will be forwarded by the insurers of the GIA Records Management Centre established by the General Insurance Association of Singapore (GIA) for archiving and that copies of this report will, for a fee, be made available upon application by interested parties.
7. By the lodgement of this report to the insurers, you hereby consent to the archiving of this report at the centre and to copies of the report being made available aforesaid.

ACCIDENT STATEMENT

| | |
|----------------------------|---------------------|
| Date Of Report | 29/05/2019 15:38 |
| Date Of Accident | 28/05/2019 19:00 |
| Exact Location Of Accident | LOYANG PORT CARPARK |
| Country/State of Loss | SINGAPORE |

DETAILS OF OWN VEHICLE

| | |
|-----------------------------|----------------------|
| Vehicle Registration Number | SLL1634J |
| Insured/Policyholder | |
| Name Of Registered Owner | CHUA CHEE YON,ALVIN |
| NRIC No | S7838292I |
| Email Address | NOEMAIL |
| Mobile Phone No | (LOCAL) +65-90492881 |
| Alternative Phone No | OTHERS-90492881 |

Vehicle Particulars

| | |
|--|------------------------------|
| Manufacturer | MERCEDES-BENZ |
| Model | CLA180 COUPE URBAN (R18 LED) |
| Exact Purpose for which vehicle was being used at time of accident | PRIVATE USE |
| Are you claiming under your own insurance policy for repair to your vehicle? | NO |
| If No, Please state action to be taken | THIRD PARTY |
| Vehicle Category | PRIVATE CAR |

Insurance Company

| | |
|---------------------------|---|
| Name of Insurance Company | DIRECT ASIA INSURANCE (SINGAPORE) PTE LTD |
| Type Of Coverage | COMPREHENSIVE |
| Fleet Policy | NO |
| Policy Number | |
| Cover Note Number | |

Driver

| | |
|----------------------|-----------------------|
| Name of Driver | CHUA CHEE YON,ALVIN |
| NRIC No | S7838292I |
| Date Of Birth | 21/12/1978 |
| Occupation | INDOOR |
| Date Of Driving Pass | 07/11/2005 |
| Driving Experience | 13 YEARS AND 6 MONTHS |
| Gender | MALE |
| Mobile Number | (LOCAL) +65-90492881 |
| Fax Number | |
| Contact Number | OTHERS-90492881 |
| Email Address | NOEMAIL |

| | |
|---|---|
| Address | 89 YISHUN STREET 81 #06-10 SPORE 768449 |
| Postcode | |
| Was driver an employee of the Insured's Company | NO |
| If No, Relationship of the Driver with the Insured | OWNER |
| Vehicle Registration Number of Driver's Own Vehicle | - |
| | - |
| | - |
| Insurance Company of Driver's Own Vehicle | - |
| | - |
| | - |

General Information of the Accident

| | |
|--------------------|---|
| Type Of Accident | HIT AND RUN / VANDALISM / DAMAGED WHILST PARKED |
| Weather Conditions | CLEAR |
| Road Surface | DRY |

Other Information

| | |
|---|-----|
| Was any foreign vehicle involved in this accident? | NO |
| Number of vehicles (including own vehicle) involved in the accident | 2 |
| Was any body injured in the Accident? | NO |
| Was any injured conveyed to hospital by ambulance? | NO |
| Was any other material or property damaged? | YES |
| I have been approached by unknown person(s) soliciting/offering accident claims assistance. | NO |
| Number of Passengers (Including Driver) | 0 |

Details of Police Action

| | |
|---|----|
| Was the accident reported to the police? | NO |
| If Yes, Please state which Police Station | |
| Was notice of intended Prosecution given? | NO |
| If Yes, against whom? | |

Circumstances of Accident

REFER TO SKETCH PLAN

Attachment(s)

| | |
|---|-----|
| Are accident photos available for attachment? | YES |
| Was there any video captured by Car Camera? | NO |
| Was there any audio recorded? | NO |

DETAILS OF OTHER VEHICLE PROPERTY 1

| | |
|-------------------------------------|-------------------------------------|
| Vehicle Registration Number | SLK5156B |
| Vehicle Make/Model/Colour | TOYOTA ESTIMA AERAS PREMIUM 2.4 CVT |
| Details Of Properties | |
| Vehicle Category | PRIVATE CAR |
| Name of Driver | |
| NRIC/Passport Number | |
| Contact Number | |
| Address | |
| Postcode | |
| Insurance Company Name | |
| Nature Of Damage | |
| No. Of Passenger (Including Driver) | |

Sketch Plan

SKETCH PLAN

IMPORTANT NOTICE

1. Please report correctly the details of the accident to speed up the claims process.
2. This Form must be completed by the Policyholder and/or the Authorized Driver.
3. Information provided must be as truthful and accurate as possible. Any wilful misrepresentation or withholding of material facts may allow insurance companies to repudiate policy liability.
4. The issue and acceptance of this Form by insurance companies is not an admission of policy liability on the part of the insurance companies.
5. Any false reporting may be referred to the Police for investigation.
6. The report will be forwarded by the insurers of the GIA Records Management Centre established by the General Insurance Association of Singapore (GIA) for archiving and that copies of this report will for a fee be made available upon application by interested parties.
7. By the lodgment of this report to the insurers, you hereby consent to the archiving of this report at the centre and to copies of the report being made available aforesaid.

B. Consent under the Personal Data Protection Act (PDPA)

I understand, acknowledge, agree and consent that:

- (a) My insurer, my workshop and the General Insurance Association of Singapore ("GIA") may/are permitted to collect, use, disclose and/or process my personal data/personal information set out in this [form] and any other personal information provided by me or possessed by my insurer (collectively the "Personal Information") and disclose and transfer such Personal Information to all insurer(s) who have insured vehicle(s) involved in this accident (all insurer(s) who have insured vehicle(s) involved in this accident shall be collectively referred to as the "Insurers"), the Insurers' lawyers/law firms, the Monetary Authority of Singapore and any relevant government agency/authority (such as the police), for the purpose(s) of:
 - (i) processing, handling and/or dealing with my claims including the settlement of the claims and any necessary investigations relating to the claims;
 - (ii) investigating the accident and/or my claims;
 - (iii) carrying out and/or dealing with my instructions or responding to any enquiries by me;
 - (iv) administering my claims (including the mailing of correspondence, statements, invoices, reports or notices to me, which could involve disclosure of certain personal data about me to bring about delivery of the same as well as on the external cover of envelopes/mail packages); and/or
 - (v) complying with applicable law in administering, processing, handling and/or dealing with my claims (collectively the "Purposes")
- (b) all insurer(s) who have insured vehicle(s) involved in this accident and the Insurers' lawyers/law firms, may/are permitted to collect, use, disclose and/or process my Personal Information for one or more of the above Purposes; and
- (c) my Personal Information may/can be disclosed by any of the Insurers and/or GIA to their third party service providers or agents (including their lawyers/law firms), which may be sited outside of Singapore, for one or more of the above Purposes.
- (d) my Personal Information will also be collected and used to compile claims history for the purpose of fraud detection, investigation and management in present and all future claims.
- (e) the information so collected under (d) above may be shared / disclosed:
 - (i) to all insurers and/or any other third parties that assist in evaluating, investigating, controlling or managing fraud, regulators, law enforcement and government agencies as reasonably required for the purposes stated, or
 - (ii) for complying with requirements under any regulations, laws or court orders.

Policyholder's Signature
Date & Time:

Driver's Signature
(If driver is not the policyholder)
Date & Time:

Reporting Centre Personnel's Signature
Name: S. L. N. I.
NRIC/FIN No.: S80507710

Sketch Plan #2

SKETCH PLAN

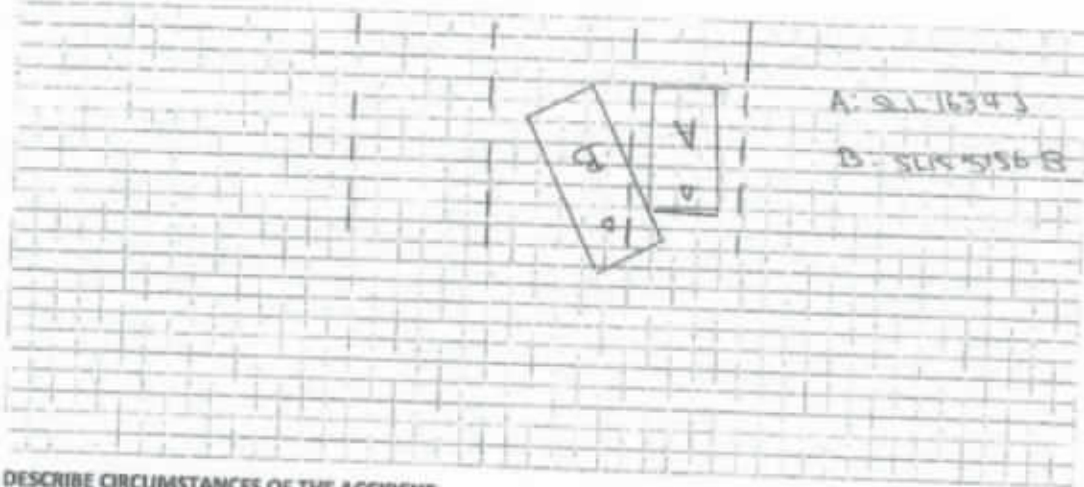

DESCRIBE CIRCUMSTANCES OF THE ACCIDENT

On 28/11/19 at about 7 PM. My vehicle was parked at Longway Court, Gullbark. I was informed by the driver of 5LR556B that he hit my vehicle.

DECLARATION

I/We declare the foregoing particulars are true in every respect.

Policyholder's Signature
Date & Time:

Gullbark, 28/11/2019, 19:18

Driver's Signature
(If driver is not the policyholder)
Date & Time:

Reporting Centre Personnel's Signature
Name: John
NRIC/ID No: 510102778

REPUBLIC OF SINGAPORE
IDENTITY CARD NO. S78382921



Name
CHUA CHEE YON, ALVIN
(CAI ZHIRONG)
蔡志榮

Race
CHINESE

Date of birth
21-12-1978

Country of birth
SINGAPORE

Sex
M

NRIC No. S78382921



REPUBLIC OF SINGAPORE DRIVING LICENCE

Licence Number: S78382921

Name
CHUA CHEE YON, ALVIN
(CAI ZHIRONG, ALVIN)

Issue Date: 21 Dec 1978

Valid Until: 07 Nov 2005



NRIC No. S78382921



Date of issue
04-08-2009

88 YISHUN STREET #1 #08-10
SINGAPORE 788449

NRIC No: S78382921 Date: 13/08/2015

YOU ARE LICENSED TO DRIVE VEHICLES IN THE FOLLOWING CLASSIES!

Class 1. Motor cars < 3000 kg with < 7 passengers, exclusive of the driver, and motor trailers / vehicles < 2500 kg

VALID DATE
07 Nov 2005

NP 428A

Licence No: S78382921



CERTIFICATE OF INSURANCE

Motor Vehicles (Third-Party Risks and Compensation) Act (Chapter 189) (Singapore) (the "Act")
Motor Vehicles (Third-Party Risks and Compensation) Rules, 1960 (Singapore)
Road Transport Act, 1987 (Malaysia)
Motor Vehicles (Third-Party Risks) Rules, 1959 (Malaysia)

This document forms part of your contract with us and should be read together with your Policy Schedule and your Policy Details. Do let us know if any of the details shown here need to be amended or updated.

| | |
|---|--|
| Certificate No. | : MT/00586340 |
| Type of Coverage / Driver Plan | : Car Comprehensive (Value Plus Plan) |
| 1) Vehicle Registration No. | : SLL1634J |
| Chassis No. | : WDD1173422N445604 |
| 2) Name of Policy Holder | : CHUA CHEE YON ALVIN |
| 3) Effective Date / Time of Commencement of Insurance for the Purpose of the Act | : 16/02/2019 00:00 |
| 4) Date/Time of Expiry of Insurance | : 15/02/2020 23:59 |
| 5) Persons or Classes of Persons Entitled to Drive | |
| (a) Any named person under the policy who is driving on the Policyholder's permission. | |
| (b) Any authorised person, provided such person is aged 30 and above and holds a valid driving licence of 2 years or more, who is driving on the Policyholder's permission | |
| The person driving must have a valid driving licence to drive in Singapore and must not be under suspension or disqualification from driving. | |
| 6) Limitations as to use* | |
| Use only for private purposes, in accordance with the declared car usage stated on your Policy Schedule. The policy does not cover use for hire or reward, tuition, driving test, racing, pace-making, reliability trials, speed tests, the carriage of goods for payment or for any purpose in connection with the motor trade business. | |
| *Limitations rendered inoperative by Section 8 of the Act and Section 95 of the Road Transport Act, 1987 (Malaysia), are not to be included under this heading. | |
| Sum Insured | : Market Value |
| Own Damage Excess | : S\$ 500.00 (before any applicable GST) |
| Windscreen Excess | : S\$ 100.00 (before any applicable GST) |
| Choice of workshop | : DirectAsia approved workshops |
| Finance company / Hire Purchase | : MAYBANK |
| Main driver | : CHUA CHEE YON ALVIN |
| Named driver | : None |
| Important Note: This policy does not cover the Policyholder/drivers below the age of 30 and Policyholder/drivers who hold a valid driving licence of less than 2 years with the exception of the main/named drivers above. | |

I/We hereby certify that the Policy to which this Certificate relates is issued in accordance with the provisions of the Motor Vehicles (Third-Party Risks and Compensation) Act (Chapter 189) and the Road Transport Act, 1987 (Malaysia).

Issued on: 07/02/2019

Direct Asia Insurance (Singapore) Pte. Ltd.



Edip Okur
Chief Underwriting Officer

[> Back to OneMotoring](#)

Enquire PARF/COE Rebate for Registered Vehicle

Vehicle Owner Particulars

| | |
|----------------|----------------|
| Owner ID Type: | Singapore NRIC |
| Owner ID: | 8292I |

Vehicle Details

| | |
|-------------------------------|------------------------------|
| Vehicle No.: | SLL1634J |
| Vehicle to be Exported: | Yes |
| Intended Deregistration Date: | 29 May 2019 |
| Vehicle Make: | MERCEDES BENZ |
| Vehicle Model: | CLA180 COUPE URBAN (R18 LED) |
| Primary Colour: | Grey |
| Manufacturing Year: | 2016 |
| Engine No.: | 27091031137639 |
| Chassis No.: | WDD1173422N445604 |
| Maximum Power Output: | 90.0 kW (120 bhp) |
| Open Market Value: | \$28,839.00 |
| Original Registration Date: | 16 Feb 2017 |
| First Registration Date: | 16 Feb 2017 |
| Transfer Count: | 0 |
| Actual ARF Paid: | \$27,375.00 |

Intended PARF Rebate Details

| | |
|-------------------------------|-------------|
| PARF Eligibility: | Yes |
| PARF Eligibility Expiry Date: | 15 Feb 2027 |
| PARF Rebate Amount: | \$20,531.00 |

Intended COE Rebate Details

| | |
|-----------------------------|--------------------------------------|
| COE Expiry Date: | 15 Feb 2027 |
| COE Category: | A - Car up to 1600cc & 97kW (130bhp) |
| COE Period(Years): | 10 |
| QP Paid: | \$50,889.00 |
| COE Rebate Amount: | \$39,269.00 |
| Total Rebate Amount: | \$59,800.00 |

The information contained herein is correct as at 29 May 2019

OK