

# NATIONAL Assessment Centre Services

Date In 28/05/2019 15:49  
Ref No NA/CTI/9009386/K4  
Veh No SLW 418R  
DOA 26/05/2019 03:20

OD TP Reporting Only

TP Insurer:

Job description	Date & Time Completed	Done by
SAS e-filing		
E-mail (within 8hrs, AIC 2hrs)		
i-Motor Claim Form		
i-Motor W/O (Within: OD 2hrs, TP 4hrs)		
i-Photo Uploaded		
Assessment/Survey Report		
Ass't Report by Fax / Hand to Owner/Wksp		

Preferred Wksp / INC Assign Wksp / QW: ( )

Tel:

Fax:

TP Particulars:

Veh No:

SMG 8284D. INC ( ) / Non-INC ( )

Owner / Driver: ( )

Tel:

Policy No: ( )

Period: ( )

Cover Type: ( )

Confirmed by: ( )

Date:

Time:

Insured/Driver Liability: ( )

(%) [Note-Est. Status (WO): N: 0-20%; P: 21-79%; F: 80-100%]

Year of Registration: ( )

Warranty: YES ( ) / NO ( )

Excess: (\$ )

Loading: \$1,000 ( ) / \$2,000 ( )

General Remarks:-

( ) Walk-In Customer: Customer's information strictly Confidential & Strictly NO refer of repairer.

( ) Total Loss Case : to e-mail Insurer URGENTLY.

Drive-In ( ) / Towed-In ( ) ; Invoice: YES ( ) / NO ( ) ; Towing Co. ( )

Remarks:- (INC hotline: 6788 6616)

1) Apply for Transport Allowance ( ) / Courtesy Car ( )

2) QC Check / Post Repair Inspection ( )

3) Upload Resurvey Photo [Repair Cost > \$3000] ( )

Injury:

Date/Time

Actions

## Invoice Preparation Checklist

Amt (\$)

Amt (\$)

1st Bill

Add Bill

- 1) AR: Accident Reporting (\$30);
- 2) DA: Damage Assessment (\$100); INC (\$80)
- 3) TF: Towing Fee \$40/\$45
- 4) FT: Follow-Through Survey \$120
- 5) iT: Follow-Through Survey (Resurvey) \$30
- For claiming against INC Only (wef 10 Jan 2005)
- 6) TR: Re-inspection \$75
- 7) N1: Idac DA + SMRT Survey \$160
- 8) NTUC Additional Services:-
- ON\*
- \*N5: Courtesy Car / Tpt Allowance \$5
- \*N6: Repair Co-ordination \$10
- \*N7: Post Repair Inspection \$25
- \*N8: DV / Collect Excess Coordination \$5
- TP (N11): TP (Non INC) against INC \$20
- 9) N12: Idac Mobile \$0

Invoice dated

Fee Charged

Claimant's Particulars:-

Driver/Owner:

Contact No:

Damaged Portion:

QC Checked by (Engr-In-Charge):

Auditors' Comments:-

Cat. 1:

Cat. 2 / 3:



## SINGAPORE ACCIDENT STATEMENT

### IMPORTANT NOTICE

1. Please report correctly the details of the accident to speed up the claims process.
2. This Form must be completed by the Policyholder and/or the Authorised Driver.
3. Information provided must be as truthful and accurate as possible. Any wilful misrepresentation or withholding of material facts may allow insurance companies to repudiate policy liability.
4. The issue and acceptance of this Form by insurance companies is not an admission of policy liability on the part of the insurance companies.
5. Any false reporting may be referred to the Police for investigation.
6. This report will be forwarded by the insurers of the GIA Records Management Centre established by the General Insurance Association of Singapore (GIA) for archiving and that copies of this report will, for a fee, be made available upon application by interested parties.
7. By the lodgement of this report to the insurers, you hereby consent to the archiving of this report at the centre and to copies of the report being made available aforesaid.

### ACCIDENT STATEMENT

Date Of Report	28/05/2019 15:49
Date Of Accident	26/05/2019 03:20
Exact Location Of Accident	GOING TO NEAR JOHOR CUSTOM
Country/State of Loss	SINGAPORE

### DETAILS OF OWN VEHICLE

Vehicle Registration Number	SLW418R
<b>Insured/Policyholder</b>	
Name Of Registered Owner	MUHAMMAD AZHAR BIN MAT' ODI
NRIC No	S8305299F
Email Address	NOEMAIL
Mobile Phone No	(LOCAL) +65-81838645
Alternative Phone No	OTHERS-81838645

### Vehicle Particulars

Manufacturer	HONDA
Model	SHUTTLE 1.5G CVT
Exact Purpose for which vehicle was being used at time of accident	PRIVATE USE
Are you claiming under your own insurance policy for repair to your vehicle?	NO
If No, Please state action to be taken	REPORTING ONLY
Vehicle Category	PRIVATE CAR

### Insurance Company

Name of Insurance Company	CHINA TAIPING INSURANCE (SINGAPORE) PTE. LTD.
Type Of Coverage	COMPREHENSIVE
Fleet Policy	NO
Policy Number	DMPCSN3008071901
Cover Note Number	

### Driver

Name of Driver	MUHAMMAD AZHAR BIN MAT' ODI
NRIC No	S8305299F
Date Of Birth	06/02/1983
Occupation	OUTDOOR
Date Of Driving Pass	18/09/2001
Driving Experience	17 YEARS AND 8 MONTHS
Gender	MALE
Mobile Number	(LOCAL) +65-81838645
Fax Number	
Contact Number	OTHERS-81838645
Email Address	NOEMAIL

Address	BLK 323A SUMANG WALK #13-943
Postcode	821323
Was driver an employee of the Insured's Company	NO
If No, Relationship of the Driver with the Insured	OWNER
Vehicle Registration Number of Driver's Own Vehicle	- - -
Insurance Company of Driver's Own Vehicle	- - -

#### General Information of the Accident

Type Of Accident	COLLISION - HEAD TO REAR
Weather Conditions	CLEAR
Road Surface	DRY

#### Other Information

Was any foreign vehicle involved in this accident?	NO
Number of vehicles (including own vehicle) involved in the accident	2
Was any body injured in the Accident?	NO
Was any injured conveyed to hospital by ambulance?	NO
Was any other material or property damaged?	YES
I have been approached by unknown person(s) soliciting/offering accident claims assistance.	NO
Number of Passengers (Including Driver)	6
Passenger 1	NAME: : NIL GENDER: : MALE
Passenger 2	NAME: : NIL GENDER: : FEMALE
Passenger 3	NAME: : NIL GENDER: : FEMALE
Passenger 4	NAME: : NIL GENDER: : FEMALE
Passenger 5	NAME: : NIL GENDER: : FEMALE

#### Details of Police Action

Was the accident reported to the police?	NO
If Yes, Please state which Police Station	
Was notice of intended Prosecution given?	NO
If Yes, against whom?	

#### Circumstances of Accident

PLS REFER TO THE ATTACHED STATEMENT.

#### Attachment(s)

Are accident photos available for attachment?	YES
Was there any video captured by Car Camera?	NO
Was there any audio recorded?	NO

#### DETAILS OF OTHER VEHICLE PROPERTY 1

Vehicle Registration Number	SMG8284D
-----------------------------	----------

Vehicle Make/Model/Colour

Details Of Properties

Vehicle Category

PRIVATE CAR

Name of Driver

EUGENE

NRIC/Passport Number

Contact Number

93837576

Address

Postcode

Insurance Company Name

Nature Of Damage

No. Of Passenger (Including Driver)



## SKETCH PLAN

### IMPORTANT NOTICE

1. Please report **correctly** the details of the accident to speed up the claims process.
2. This Form must be **completed by the Policyholder and/or the Authorised Driver**.
3. Information provided must be as **truthful and accurate as possible**. Any wilful misrepresentation or withholding of material facts may allow insurance companies to **repudiate policy liability**.
4. The issue and acceptance of this Form by insurance companies is not an admission of policy liability on the part of the insurance companies.
5. **Any false reporting may be referred to the Police for investigation.**
6. The report will be forwarded by the insurers of the GIA Records Management Centre established by the General Insurance Association of Singapore (GIA) for archiving and that copies of this report will for a fee be made available upon application by interested parties.
7. By the lodgment of this report to the insurers, you hereby consent to the archiving of this report at the centre and to copies of the report being made available aforesaid.
8. **Consent under the Personal Data Protection Act (PDPA)**

I understand, acknowledge, agree and consent that:

- (a) My insurer, my workshop and the General Insurance Association of Singapore ("GIA") may/are permitted to collect, use, disclose and/or process my personal data/personal information set out in this [form] and any other personal information provided by me or possessed by my insurer (collectively the "Personal Information") and disclose and transfer such Personal Information to all insurer(s) who have insured vehicle(s) involved in this accident (all insurer(s) who have insured vehicle(s) involved in this accident shall be collectively referred to as the "Insurers"), the Insurers' lawyers/law firms, the Monetary Authority of Singapore and any relevant government agency/authority (such as the police), for the purpose(s) of:
  - (i) processing, handling and/or dealing with my claims including the settlement of the claims and any necessary investigations relating to the claims;
  - (ii) investigating the accident and/or my claims;
  - (iii) carrying out and/or dealing with my instructions or responding to any enquiries by me;
  - (iv) administering my claims (including the mailing of correspondence, statements, invoices, reports or notices to me, which could involve disclosure of certain personal data about me to bring about delivery of the same as well as on the external cover of envelopes/mail packages); and/or
  - (v) complying with applicable law in administering, processing, handling and/or dealing with my claims. (collectively the "Purposes")
- (b) all insurer(s) who have insured vehicle(s) involved in this accident and the Insurers' lawyers/law firms, may/are permitted to collect, use, disclose and/or process my Personal Information for one or more of the above Purposes; and
- (c) my Personal Information may/can be disclosed by any of the Insurers and/or GIA to their third party service providers or agents (including their lawyers/law firms), which may be sited outside of Singapore, for one or more of the above Purposes.
- (d) my Personal Information will also be collected and used to compile claims history for the purpose of fraud detection, investigation and management in present and all future claims.
- (e) the information so collected under (d) above may be shared / disclosed:
  - (i) to all insurers and/or any other third parties that assist in evaluating, investigating, controlling or managing fraud, regulators, law enforcement and government agencies as reasonably required for the purposes stated, or
  - (ii) for complying with requirements under any regulations, laws or court orders.

\_\_\_\_\_  
Policyholder's Signature  
Date & Time:

\_\_\_\_\_  
Driver's Signature  
(If driver is not the policyholder)  
Date & Time:

\_\_\_\_\_  
Reporting Centre Personnel's Signature  
Name:  
NRIC/FIN No.:

# SKETCH PLAN GOING TO NEAK JOHOR CUSTOM

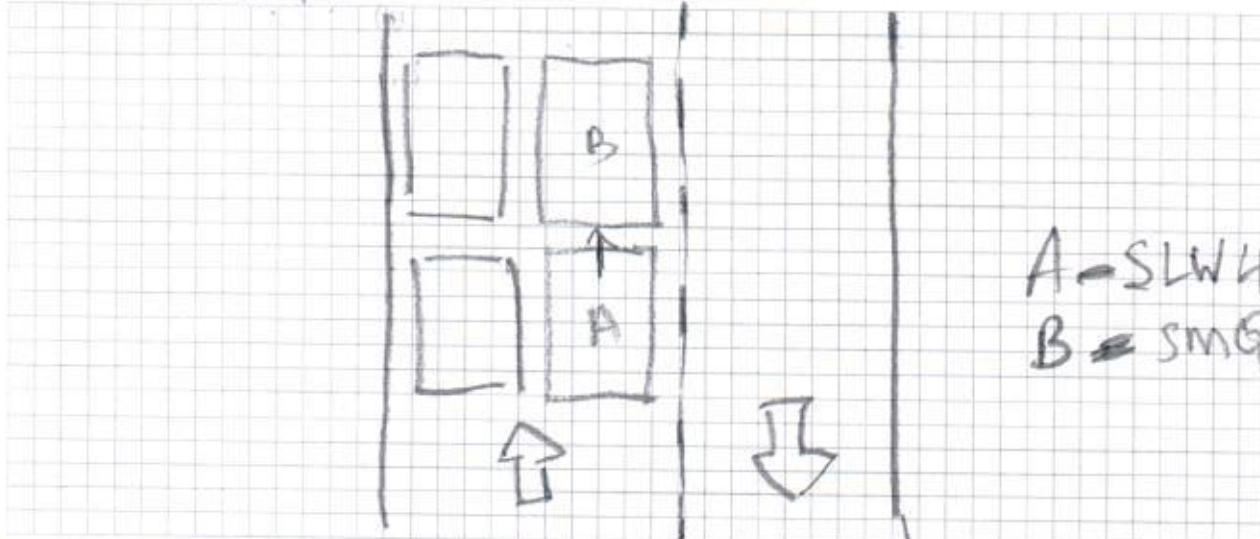

## DESCRIBE CIRCUMSTANCES OF THE ACCIDENT

Vehicle A from johor going to johor custom. Vehicle B was in front of me during the traffic congestion. As there was a lot of vehicles and traffic was very slow, in the early morning around 0320 a.m. Vehicle A was following to closely from behind Vehicle B. At one point, vehicle A did not managed to stop in-time and hit the rear bumper of Vehicle B. It was a very soft hit. ~~It was a minor scratches~~ its a result, vehicle B suffers minor scratches and a slight Dent at the rear bumper. Vehicle A suffers minor scratches and dent at the front bumper. No injuries are reported.

## DECLARATION

I/We declare the foregoing particulars are true in every respect.

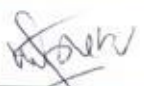
  
Policyholder's Signature  
Date & Time:

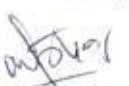
  
Driver's Signature  
(If driver is not the policyholder)  
Date & Time:

 28/5/2019  
Reporting Centre Personnel's Signature  
Name:  
NRIC/FIN No.:



REPUBLIC OF SINGAPORE  
IDENTITY CARD NO. S8305299F



Name

MUHAMMAD AZHAR BIN  
MAT'ODI

محمد ازهر بن مت عودي

Race

BOYANESE

Date of birth

06-02-1983

Sex

M

Country of birth

SINGAPORE

REPUBLIC OF SINGAPORE DRIVING LICENCE



Licence Number

S8305299F

Name

MUHAMMAD AZHAR BIN  
MAT'ODI

Birth Date: 06 Feb 1983

Issue Date: 08 Sep 2005



001366643K

3912977



NRIC No. S8305299F

If found, pls return  
**Juliesa**

Date of issue

14-07-2006

AFT BLK 323A SUMANG WALK #13-043  
SINGAPORE 821323

NRIC No: S8305299F

Date: 08/12/2010

YOU ARE LICENSED TO DRIVE VEHICLES IN THE FOLLOWING CLASSES

CLASS DATE

Class 2B	Motorcycles <= 200 CC	06 Jun 2006
Class 2A	Motorcycles between 201 CC and 400 CC	13 Aug 2007
Class 2	Motorcycles > 400 CC	11 Nov 2003
Class 3	Motor cars <= 3600 kg with <= 7 passengers, exclusive of the driver, and motor tractors/vehicles <= 2500 kg	18 Sep 2005
Class 4	Heavy motor cars and motor tractors > 2500 kg	22 Apr 2014
Class 5	Motor vehicles > 7250 kg not constructed to carry any load	13 Mar 2019

S / No.9000320798

S8305299F



Licence No: S8305299F

NP 428A



中国太平  
CHINA TAIPING

中国太平保险(新加坡)有限公司

CHINA TAIPING INSURANCE (SINGAPORE) PTE. LTD.

Co. Reg. No. 200208384E

MX1F

R SN

AN0214A

Cov.Type: C

MOTOR PRIVATE CAR

**CERTIFICATE OF INSURANCE**

Motor Vehicles (Third-Party Risks and Compensation) Act (Chapter 189)  
Motor Vehicles (Third-Party Risks and Compensation) Rules, 1960  
Road Transport Act, 1987 (Malaysia)  
Motor Vehicles (Third-Party Risks) Rules, 1959 (Malaysia)

ORIGINAL

CERTIFICATE No. DMPCSN3008071901 Engine No : L15B5460365  
ChaNo: GK81200298

1. Index Mark and Registration Number of Vehicle SLW418R AUTOSAFE

2. Name of Policy Holder MUHAMMAD AZHAR BIN MAT'ODI

3. Effective date of the Commencement of insurance for the purposes of the Regulations, Ordinance or Enactment 25 January 2019 Named Drivers Ex Sect. I ..... S\$500.00  
Additional Ex Other than Named Drivers:  
Ex Sect. I - Age <= 25..... S\$3,000.00  
Ex Sect. I - Age >= 26..... S\$500.00  
\* Age as at date of accident  
EX ON WINDSCREEN ..... S\$100.00

4. Date of Expiry of Insurance 24 January 2020

5. Persons or Classes of Persons entitled to drive\*

(a) The Policyholder.

(b) Any other person who is driving on the Policyholder's order or with his permission.

Provided that the person driving is permitted in accordance with the licensing or other laws or regulations to drive the Motor Vehicle or has been so permitted and is not disqualified by order of a Court of Law or by reason of any enactment or regulation in that behalf from driving the Motor Vehicle.

6. Limitations as to use:

Use for social, domestic and pleasure purposes and for the Policyholder's business.  
The policy does not cover use for hire or reward tuition driving test racing pace-making, reliability trial, speed-testing, the carriage of goods other than samples in connection with any trade or business or use for any purpose in connection with the Motor Trade.

Excess whichever is applicable for losses occurring outside Singapore (Constructive Total Loss/Theft) will be doubled.

One time waiver of Excess for the first S\$500 will apply to the Insured and Named Drivers in the event of Own Damage Claim at our Authorised Workshops for each Policy Year.

HIRE PURCHASE CO. : TOKYO CENTURY LEASING (S) PTE LTD

\* Limitations rendered inoperative by Section 8 of the Motor Vehicles (Third-Party Risks and Compensation) Act (Chapter 189) and Section 95 of the Road Transport Act 1987 (Malaysia), are not to be included under these headings.

**I/We hereby Certify** that the policy to which this Certificate relates is issued in accordance with the provisions of the Motor Vehicles (Third-Party Risks and Compensation) Act (Chapter 189) and Part IV of the Road Transport Act, 1987 (Malaysia).

Please see reverse



For CHINA TAIPING INSURANCE (SINGAPORE) PTE. LTD.

Authorised Signatory

Issued By: SC ALLIANCE PTE. LTD.  
Authorised Officer