

SINGAPORE ACCIDENT STATEMENT

IMPORTANT NOTICE

1. Please report correctly the details of the accident to speed up the claims process.
2. This Form must be completed by the Policyholder and/or the Authorised Driver.
3. Information provided must be as truthful and accurate as possible. Any wilful misrepresentation or withholding of material facts may allow insurance companies to repudiate policy liability.
4. The issue and acceptance of this Form by insurance companies is not an admission of policy liability on the part of the insurance companies.
5. **Any false reporting may be referred to the Police for investigation.**
6. This report will be forwarded by the insurers of the GIA Records Management Centre established by the General Insurance Association of Singapore (GIA) for archiving and that copies of this report will, for a fee, be made available upon application by interested parties.
7. By the lodgement of this report to the insurers, you hereby consent to the archiving of this report at the centre and to copies of the report being made available aforesaid.

ACCIDENT STATEMENT

Date Of Report	08/05/2019 19:17
Date Of Accident	02/05/2019 17:25
Exact Location Of Accident	ANCHORVALE COMMUNITY CENTRE
Country/State of Loss	SINGAPORE

DETAILS OF OWN VEHICLE

Vehicle Registration Number	GBD9202E
Insured/Policyholder	
Name Of Registered Owner	JAYDEN FOODS PTE LTD
Co Reg No	201435217M
Email Address	NOEMAIL
Mobile Phone No	
Alternative Phone No	OFFICE-899999999

Vehicle Particulars

Manufacturer	NISSAN
Model	NV350 PANEL VAN 2.5 5MT 5DR EURO V
Exact Purpose for which vehicle was being used at time of accident	WORKING
Are you claiming under your own insurance policy for repair to your vehicle?	NO
If No, Please state action to be taken	THIRD PARTY
Vehicle Category	COMMERCIAL VEHICLE

Insurance Company

Name of Insurance Company	TOKIO MARINE INSURANCE SINGAPORE LTD
Type Of Coverage	COMPREHENSIVE
Fleet Policy	NO
Policy Number	18-MV006395-R02
Cover Note Number	

Driver

Name of Driver	TAN CHOON YEAN
NRIC No	S7110737Z
Date Of Birth	02/04/1971
Occupation	OUTDOOR
Date Of Driving Pass	16/08/1991
Driving Experience	27 YEARS AND 8 MONTHS
Gender	MALE
Mobile Number	(LOCAL) +65-84256611
Fax Number	
Contact Number	OFFICE-84256611
EMail Address	NOEMAIL

Address	BLK 121 YISHUN STREET 11 #06-445
Postcode	760121
Was driver an employee of the Insured's Company	YES
If No, Relationship of the Driver with the Insured	
Vehicle Registration Number of Driver's Own Vehicle	-
	-
	-
Insurance Company of Driver's Own Vehicle	-
	-
	-

General Information of the Accident

Type Of Accident	SIDE SWIPE
Weather Conditions	CLEAR
Road Surface	DRY

Other Information

Was any foreign vehicle involved in this accident?	NO
Number of vehicles (including own vehicle) involved in the accident	2
Was any body injured in the Accident?	NO
Was any injured conveyed to hospital by ambulance?	
Was any other material or property damaged?	YES
I have been approached by unknown person(s) soliciting/offering accident claims assistance.	NO
Number of Passengers (Including Driver)	2
Passenger 1	
	NAME: : -
	GENDER: : MALE

Details of Police Action

Was the accident reported to the police?	NO
If Yes, Please state which Police Station	
Was notice of intended Prosecution given?	NO
If Yes, against whom?	

Circumstances of Accident

REFER TO STATEMENT.

Attachment(s)

Are accident photos available for attachment?	YES
Was there any video captured by Car Camera?	NO
Was there any audio recorded?	NO

DETAILS OF OTHER VEHICLE PROPERTY 1

Vehicle Registration Number	SGV6998H
Vehicle Make/Model/Colour	
Details Of Properties	
Vehicle Category	PRIVATE CAR
Name of Driver	
NRIC/Passport Number	
Contact Number	
Address	
Postcode	
Insurance Company Name	
Nature Of Damage	

No. Of Passenger (Including Driver)

1

SKETCH PLAN

IMPORTANT NOTICE

1. Please report correctly the details of the accident to speed up the claims process.
2. This Form must be completed by the Policyholder and/or the Authorised Driver.
3. Information provided must be as truthful and accurate as possible. Any wilful misrepresentation or withholding of material facts may allow insurance companies to repudiate policy liability.
4. The issue and acceptance of this Form by insurance companies is not an admission of policy liability on the part of the insurance companies.
5. Any false reporting may be referred to the Police for investigation.
6. The report will be forwarded by the Insurers of the GIA Records Management Centre established by the General Insurance Association of Singapore (GIA) for archiving and that copies of this report will for a fee be made available upon application by interested parties.
7. By the lodgment of this report to the insurers, you hereby consent to the archiving of this report at the centre and to copies of the report being made available aforesaid.
8. **Consent under the Personal Data Protection Act (PDPA)**

I understand, acknowledge, agree and consent that:

- (a) My insurer, my workshop and the General Insurance Association of Singapore ("GIA") may/are permitted to collect, use, disclose and/or process my personal data/personal information set out in this [form] and any other personal information provided by me or possessed by my insurer (collectively the "Personal Information") and disclose and transfer such Personal Information to all insurer(s) who have insured vehicle(s) involved in this accident (all insurer(s) who have insured vehicle(s) involved in this accident shall be collectively referred to as the "Insurers"), the Insurers' lawyers/law firms, the Monetary Authority of Singapore and any relevant government agency/authority (such as the police), for the purpose(s) of:
 - (i) processing, handling and/or dealing with my claims including the settlement of the claims and any necessary investigations relating to the claims;
 - (ii) investigating the accident and/or my claims;
 - (iii) carrying out and/or dealing with my instructions or responding to any enquiries by me;
 - (iv) administering my claims (including the mailing of correspondence, statements, invoices, reports or notices to me, which could involve disclosure of certain personal data about me to bring about delivery of the same as well as on the external cover of envelopes/mail packages); and/or
 - (v) complying with applicable law in administering, processing, handling and/or dealing with my claims. (collectively the "Purposes")
- (b) all insurer(s) who have insured vehicle(s) involved in this accident and the Insurers' lawyers/law firms, may/are permitted to collect, use, disclose and/or process my Personal Information for one or more of the above Purposes; and
- (c) my Personal Information may/can be disclosed by any of the Insurers and/or GIA to their third party service providers or agents (including their lawyers/law firms), which may be sited outside of Singapore, for one or more of the above Purposes.
- (d) my Personal Information will also be collected and used to compile claims history for the purpose of fraud detection, investigation and management in present and all future claims.
- (e) the information so collected under (d) above may be shared / disclosed:
 - (i) to all insurers and/or any other third parties that assist in evaluating, investigating, controlling or managing fraud, regulators, law enforcement and government agencies as reasonably required for the purposes stated, or
 - (ii) for complying with requirements under any regulations, laws or court orders.



Policyholder's Signature
Date & Time:

Driver's Signature
(If driver is not the policyholder)
Date & Time:

Reporting Centre Personnel's Signature
Name:
NRIC/FIN No.:

SKETCH PLAN

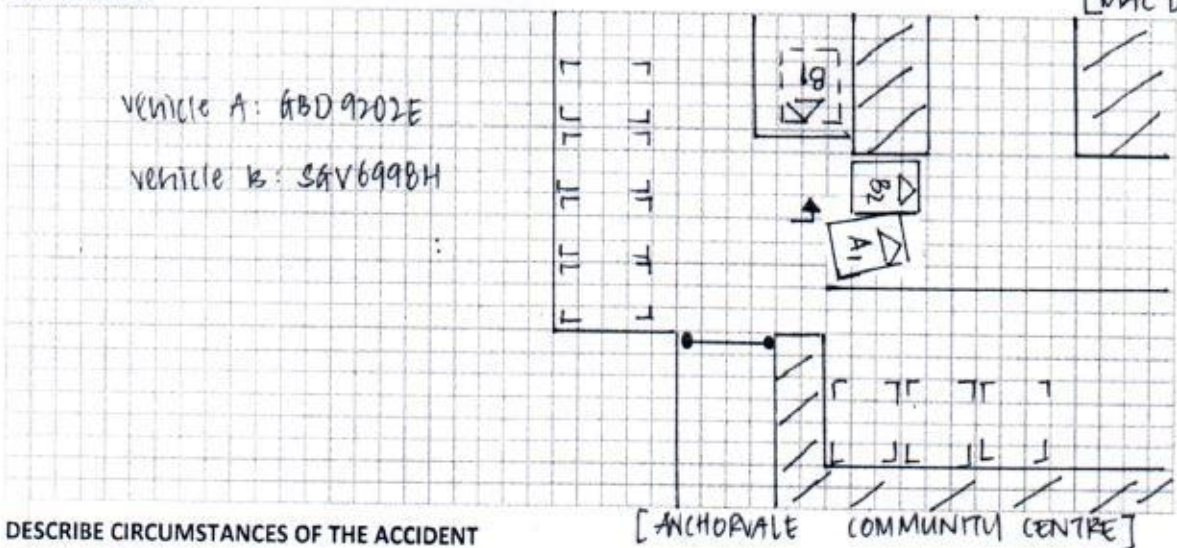

DESCRIBE CIRCUMSTANCES OF THE ACCIDENT

On the stated date & time, I, vehicle 'A', GBD 9202E, had exited the gantry and was on the main road of the stated carpark. I was slowly maneuvering the turn when vehicle 'B', SAV 699BH, tried to overtake and squeeze through my vehicle. In the midst, our vehicles collided. I wish to state that there was a stopline on the path of vehicle 'B'. We had agreed on private settling the matter but the lady driver of vehicle 'B', ignored all my text and calls following which.

DECLARATION

I/We declare the foregoing particulars are true in every respect.



Policyholder's Signature
Date & Time:

Driver's Signature
(If driver is not the policyholder)
Date & Time:

Reporting Centre Personnel's Signature
Name:
NRIC/FIN No.:

ACCIDENT STATEMENT

ACCIDENT DATE: 02/05/2019 (DD/MM/YYYY), TIME: 17:25 (HH:MM)

LOCATION: Anchorvale Community Centre

1. DETAILS OF VEHICLE

- a) VEHICLE NUMBER: GBD9202E
b) INSURANCE COMPANY: Totio Marine
c) POLICY NUMBER: _____
d) POLICY TYPE: (COMPREHENSIVE / THIRD PARTY / THIRD PARTY FIRE & THEFT)
e) MAKE & MODEL: Nissan NV350
f) TYPE: (SALOON / COUPE / MPV / VAN / LORRY / MOTORCYCLE / OTHERS)
g) VEHICLE CATEGORY: (PRIVATE / COMMERCIAL / MOTORCYCLE)
h) PURPOSE OF USING AT ACCIDENT TIME: work purpose
i) ARE YOU CLAIMING UNDER YOUR OWN INSURANCE (YES/NO)
IF NO, PLEASE STATE (THIRD PARTY CLAIM / REPORTING ONLY)

2. INSURED / POLICY HOLDER

- A) NAME: Jayden Foods Pte Ltd (MALE / FEMALE)
b) NRIC/FIN/PASSPORT: _____ CONTACT: _____
c) ADDRESS: _____

* CONTINUE TO 3.d IF DRIVER ALSO POLICY HOLDER

DRIVER

- a) NAME: Tan Choon Yean (MALE / FEMALE)
b) NRIC/FIN/PASSPORT: S71107377 CONTACT: 84256611
c) ADDRESS: 121 Tsiman St 11, #06-445 S(760121)

* d) DATE OF BIRTH: 02/04/1971 (DD/MM/YYYY)

e) OCCUPATION: (INDOOR / OUTDOOR)

f) YEARS OF DRIVING EXPERIENCE: _____

4. WAS DRIVER AN EMPLOYEE OF THE INSURED'S COMPANY? (YES / NO)

IF NO, RELATIONSHIP OF THE DRIVER WITH INSURED: _____

5. a) WEATHER CONDITION: (CLEAR / RAINING / OTHERS)

b) ROAD SURFACE: (DRY / WET / OTHERS)

6. WAS ANYBODY INJURED (YES / NO)

7. a) REPORTED TO POLICE (YES / NO)

IF YES, PLEASE STATE WHICH POLICE STATION: _____

8. THIRD PARTY VEHICLE

- a) VEHICLE NUMBER: CAV6998H MODEL: _____
b) DRIVER'S NAME: _____
c) NRIC/FIN/PASSPORT: _____ CONTACT: _____

THIRD PARTY VEHICLE

- d) VEHICLE NUMBER: _____ MODEL: _____
e) DRIVER'S NAME: _____
f) NRIC/FIN/PASSPORT: _____ CONTACT: _____

* No of passengers
(including driver)
(02)
(male)

* No of passengers
(including driver)
(01) female

* No of passengers
(including driver)
()

email =

fax =

REPUBLIC OF SINGAPORE
IDENTITY CARD NO. S7110737Z



Name

TAN CHOON YEAP

陳俊明

Race

CHINESE

Date of birth

02-04-1971

Sex

M

Country of birth

SINGAPORE



WAS DRIVEN

REPUBLIC OF SINGAPORE DRIVING LICENCE

Licence Number

S7110737Z

Name

TAN CHOON YEAP

Birth Date: 02 Apr 1971

Issue Date: 22 Oct 2008



3427100



RIC No. S7110737Z



Date of Issue

21-10-2003

APT BLK 121 YISHUN STREET 11 #06-445
SINGAPORE 760121

NEIC No: S7110737Z

Date: 22/04/2009

No: 6219080

YOU ARE LICENSED TO DRIVE VEHICLES IN THE FOLLOWING CLASS(ES)

PASS DATE

Class 3 Motor Cars and Motor Tractors the weight of which unladen does not exceed 2500 kilograms

16 Aug 1991

NP 428A



Licence No: S7110737Z

Tokio Marine Insurance Singapore Ltd.

(Company Reg. No.: 192300014M) (GST Reg No.: M2-0000023-4)

20 McCallum Street #09-01 Tokio Marine Centre Singapore 069046

T: (65) 6221 6111 F: (65) 6221 4355 / (65) 6224 0895 E: tmis@tokiomarine.com.sg W: www.tokiomarine.com



TOKIO MARINE
INSURANCE GROUP

FORM MZ300

A member of the
Tokio Marine Group

Certificate of Insurance

MOTOR VEHICLES (THIRD-PARTY RISKS AND COMPENSATION) ACT (CHAPTER 189)
MOTOR VEHICLES (THIRD-PARTY RISKS AND COMPENSATION) RULES, 1960
ROAD TRANSPORT ACT, 1987 (MALAYSIA)
MOTOR VEHICLES (THIRD-PARTY RISKS) RULES, 1959 (MALAYSIA)

Policy No.: 18-MV006395-R02 (Comm Vehicle Carry Own Goods)

1. Index Mark and Registration Number of Vehicle GBD9202E Chassis No.: JN1MC2E26Z0004212
2. Name of Policyholder JAYDEN FOODS PTE LTD
3. Effective date of the Commencement of Insurance for the purposes of the Act 21/07/2018
4. Date of Expiry of Insurance 20/07/2019

5. Persons or Class of Persons entitled to drive*

Any person who is driving on the policyholder's order or with their permission.

* Provided that the Person driving is permitted in accordance with the licensing or other laws or regulations to drive the Motor Vehicle or has been so permitted and is not disqualified by order of a Court of Law or by reason of any enactment or regulation in that behalf from driving the Motor Vehicle. And provided further that the Motor Vehicle is registered under the Road Traffic Act and its registration under the Road Traffic Act has not been cancelled at the time of the accident loss or damage.

6. Limitations as to use*

- 1) Use in connection with the policyholder's business.
- 2) Use for the carriage of passengers (other than for hire or reward) in connection with the Policyholders' business.
- 3) Use for social domestic and pleasure purposes.
- The policy does not cover:-
- 1) Use for hire or reward or for racing, pace-making, reliability trial or speed-testing.
- 2) Use whilst drawing a trailer except the towing of any one disabled mechanically propelled vehicle.

* Limitations rendered inoperative by Section 8 of the Motor Vehicles (Third-Party Risks and Compensation) Act (Chapter 189) and Section 95 of the Road Transport Act, 1987 (Malaysia), are not to be included under these headings.

We hereby certify that the Policy to which this Certificate relates is issued in accordance with the provision of the Motor Vehicles (Third-Party Risks and Compensation) Act (Chapter 189) and Part IV of the Road Transport Act, 1987 (Malaysia).

Please refer to the Policy Schedule for full details, terms and conditions of the insurance.

IMPORTANT NOTICE

This Certificate is not transferable. During its currency, if the insurance is cancelled for whatsoever reason, you must return the Certificate to Tokio Marine Insurance Singapore Ltd. within 7 days thereof or, if the Certificate has been lost destroyed, you must make a statutory declaration to that effect. Failure to comply with this duty is an offence under Motor Vehicle (Third-Party Risks and Compensation) Act (Chapter 189).

ADDITIONAL INFORMATION

Account: 1861DDA

Insurance Plan: Comprehensive Approved Workshop Plan

Limit for total loss or theft: Prevailing Market Value

Policy Excess: Own Damage Claims SGD 1,250

Windscreen Excess SGD 100

Financial Interest: TAN CHONG CREDIT PTE LTD

Tokio Marine Insurance Singapore Ltd.

Authorised Signature

User Name: Intermediaries from TM O

Printed 05/07/2018