

NATIONAL Assessment Centre Services

[wef 1 Jan'05] MHA1903549

Date In: 6/1/9-19.26	Job description	Date & Time Completed	Done by
Ref No: NA/F02 19037964/24	SAS e-filing		
Veh No: 6053563M	E-mail (within 3hrs, AIC 2hrs)		
D.O.A : 6/1/9- 0:25	i-Motor Claim Form		
OD / TP / Reporting Only	i-Motor W/O (Within: OD 2hrs, TP 4hrs)		
	i-Photo Uploaded		
TP Insurer:	Assessment/Survey Report		
	Ass't Report by Fax / Hand to Owner/Wksp		

Preferred Wksp / INC Assign Wksp / QW: () Tel: () Fax: ()

TP Particulars: Vch No: SM EY 1830 INC () / Non-INC ()

Owner / Driver: () Tel: ()

Policy No: () Period: () Cover Type: ()

Confirmed by: () Date: () Time: ()

Insured/Driver Liability: () % [Note-Est. Status (WO): N: 0-20%; P: 21-79% P: 80-100%]

Year of Registration: () Warranty: YES () / NO ()

Excess: (\$) Loading: \$1,000 () / \$2,000 ()

General Remarks: ()

() Walk-In Customer: Customer's information strictly Confidential & Strictly NO refer of repairer.

() Total Loss Case: to e-mail Insurer URGENTLY.

Drive-In () / Towed-In (); Invoice: YES () / NO (); Towing Co: ()

Remarks: (INC hotline: 6788 6616) Date & Time Completed Done by

1) Apply for Transport Allowance () / Courtesy Car ()

2) QC Check / Post Repair Inspection ()

3) Upload Resurvey Photo [Repair Cost > \$3000] ()

Injury: ()

Date/Time	Actions

NA1903549	Invoice Preparation Checklist	Ant (\$) 1st Bill	Ant (\$) Add Bill
Claimant's Particulars:-	1) AR: Accident Reporting (\$30);		
Driver/Owner:	2) DA: Damage Assessment (\$100); INC (\$80)		
Contact No:	3) TF: Towing Fee \$40/\$45		
Damaged Portion:	4) FT: Follow-Through Survey \$120		
QC Checked by (Engr-In-Charge):	5) FT: Follow-Through Survey (Resurvey) \$30		
Auditors' Comments:-	For claiming against INC Only (wef 10 Jan 2005)		
Lat. 1:	6) TR: Re-inspection \$75		
Lat. 2 / 3:	7) N1: Idac DA + SMRT Survey \$160		
	8) NTUC Additional Services:-		
	QD:		
	*N5: Courtesy Car / Tpt Allowance \$5		
	*N6: Repair Co-ordination \$10		
	*N7: Post Repair Inspection \$25		
	*N8: DV / Collect Excess Coordination \$5		
	TP (N11): TP (Non INC) against INC \$20		
	9) N12: Idac Mobile \$0		
	Invoice dated Fee Charged		
	Invoice dated Fee Charged		

SINGAPORE ACCIDENT STATEMENT

IMPORTANT NOTICE

1. Please report correctly the details of the accident to speed up the claims process.
2. This Form must be completed by the Policyholder and/or the Authorised Driver.
3. Information provided must be as truthful and accurate as possible. Any wilful misrepresentation or withholding of material facts may allow insurance companies to repudiate policy liability.
4. The issue and acceptance of this Form by insurance companies is not an admission of policy liability on the part of the insurance companies.
5. **Any false reporting may be referred to the Police for investigation.**
6. This report will be forwarded by the insurers of the GIA Records Management Centre established by the General Insurance Association of Singapore (GIA) for archiving and that copies of this report will, for a fee, be made available upon application by interested parties.
7. By the lodgement of this report to the insurers, you hereby consent to the archiving of this report at the centre and to copies of the report being made available aforesaid.

ACCIDENT STATEMENT

Date Of Report	06/05/2019 19:36
Date Of Accident	06/05/2019 01:25
Exact Location Of Accident	JUNC BAYFRONT AVE & CENTRAL BLVD
Country/State of Loss	SINGAPORE

DETAILS OF OWN VEHICLE

Vehicle Registration Number	GBB3563M
Insured/Policyholder	
Name Of Registered Owner	SIANG HOCK CAR RENTAL PT LTD
Co Reg No	201538271R
Email Address	NOEMAIL
Mobile Phone No	
Alternative Phone No	OFFICE-89999999

Vehicle Particulars

Manufacturer	SSANGYONG
Model	ACTYON SPORTS D/CAB 2.0 MT AIRBAG 2WD
Exact Purpose for which vehicle was being used at time of accident	WORKING
Are you claiming under your own insurance policy for repair to your vehicle?	NO
If No, Please state action to be taken	REPORTING ONLY
Vehicle Category	COMMERCIAL VEHICLE

Insurance Company

Name of Insurance Company	MS FIRST CAPITAL INSURANCE LTD
Type Of Coverage	THIRD PARTY
Fleet Policy	YES
Policy Number	D-19093240MFCV/112
Cover Note Number	

Driver

Name of Driver	AMIN BIN KADIR
NRIC No	S6914361Z
Date Of Birth	24/04/1969
Occupation	OUTDOOR
Date Of Driving Pass	16/10/2002
Driving Experience	16 YEARS AND 6 MONTHS
Gender	MALE
Mobile Number	(LOCAL) +65-91830377
Fax Number	
Contact Number	OFFICE-91830377
Email Address	NOEMAIL

Address	71 YISHUN AVENUE 11 #01-02
Postcode	768858
Was driver an employee of the Insured's Company	NO
If No, Relationship of the Driver with the Insured	OTHER - HIRER
Vehicle Registration Number of Driver's Own Vehicle	-
	-
Insurance Company of Driver's Own Vehicle	-
	-
	-

General Information of the Accident

Type Of Accident	COLLISION - CROSS JUNCTION
Weather Conditions	CLEAR
Road Surface	DRY

Other Information

Was any foreign vehicle involved in this accident?	NO
Number of vehicles (including own vehicle) involved in the accident	2
Was any body injured in the Accident?	NO
Was any injured conveyed to hospital by ambulance?	
Was any other material or property damaged?	YES
I have been approached by unknown person(s) soliciting/offering accident claims assistance.	NO
Number of Passengers (Including Driver)	1

Details of Police Action

Was the accident reported to the police?	NO
If Yes, Please state which Police Station	
Was notice of intended Prosecution given?	NO
If Yes, against whom?	

Circumstances of Accident

REFER TO STATEMENT.

Attachment(s)

Are accident photos available for attachment?	YES
Was there any video captured by Car Camera?	NO
Was there any audio recorded?	NO

DETAILS OF OTHER VEHICLE PROPERTY 1

Vehicle Registration Number	SME4183U
Vehicle Make/Model/Colour	
Details Of Properties	
Vehicle Category	PRIVATE CAR
Name of Driver	
NRIC/Passport Number	
Contact Number	87842639
Address	
Postcode	
Insurance Company Name	
Nature Of Damage	
No. Of Passenger (Including Driver)	

SKETCH PLAN

IMPORTANT NOTICE

1. Please report **correctly** the details of the accident to speed up the claims process.
2. This Form must be **completed by the Policyholder and/or the Authorised Driver**.
3. Information provided must be as **truthful and accurate as possible**. Any wilful misrepresentation or withholding of material facts may allow insurance companies to **repudiate policy liability**.
4. The issue and acceptance of this Form by insurance companies is not an admission of policy liability on the part of the insurance companies.
5. **Any false reporting may be referred to the Police for investigation.**
6. The report will be forwarded by the Insurers of the GIA Records Management Centre established by the General Insurance Association of Singapore (GIA) for archiving and that copies of this report will for a fee be made available upon application by interested parties.
7. By the lodgment of this report to the insurers, you hereby consent to the archiving of this report at the centre and to copies of the report being made available aforesaid.

8. Consent under the Personal Data Protection Act (PDPA)

I understand, acknowledge, agree and consent that:

- (a) My insurer, my workshop and the General Insurance Association of Singapore ("GIA") may/are permitted to collect, use, disclose and/or process my personal data/personal information set out in this [form] and any other personal information provided by me or possessed by my insurer (collectively the "Personal Information") and disclose and transfer such Personal Information to all insurer(s) who have insured vehicle(s) involved in this accident (all insurer(s) who have insured vehicle(s) involved in this accident shall be collectively referred to as the "Insurers"), the Insurers' lawyers/law firms, the Monetary Authority of Singapore and any relevant government agency/authority (such as the police), for the purpose(s) of:
 - (i) processing, handling and/or dealing with my claims including the settlement of the claims and any necessary investigations relating to the claims;
 - (ii) investigating the accident and/or my claims;
 - (iii) carrying out and/or dealing with my instructions or responding to any enquiries by me;
 - (iv) administering my claims (including the mailing of correspondence, statements, invoices, reports or notices to me, which could involve disclosure of certain personal data about me to bring about delivery of the same as well as on the external cover of envelopes/mail packages); and/or
 - (v) complying with applicable law in administering, processing, handling and/or dealing with my claims. (collectively the "Purposes")
- (b) all insurer(s) who have insured vehicle(s) involved in this accident and the Insurers' lawyers/law firms, may/are permitted to collect, use, disclose and/or process my Personal Information for one or more of the above Purposes; and
- (c) my Personal Information may/can be disclosed by any of the Insurers and/or GIA to their third party service providers or agents (including their lawyers/law firms), which may be sited outside of Singapore, for one or more of the above Purposes.
- (d) my Personal Information will also be collected and used to compile claims history for the purpose of fraud detection, investigation and management in present and all future claims.
- (e) the information so collected under (d) above may be shared / disclosed:
 - (i) to all insurers and/or any other third parties that assist in evaluating, investigating, controlling or managing fraud, regulators, law enforcement and government agencies as reasonably required for the purposes stated, or
 - (ii) for complying with requirements under any regulations, laws or court orders.



Policyholder's Signature
Date & Time:

Driver's Signature
(If driver is not the policyholder)
Date & Time:

Reporting Centre Person's Signature
Name:
NRIC/FIN No.:

SKETCH PLAN

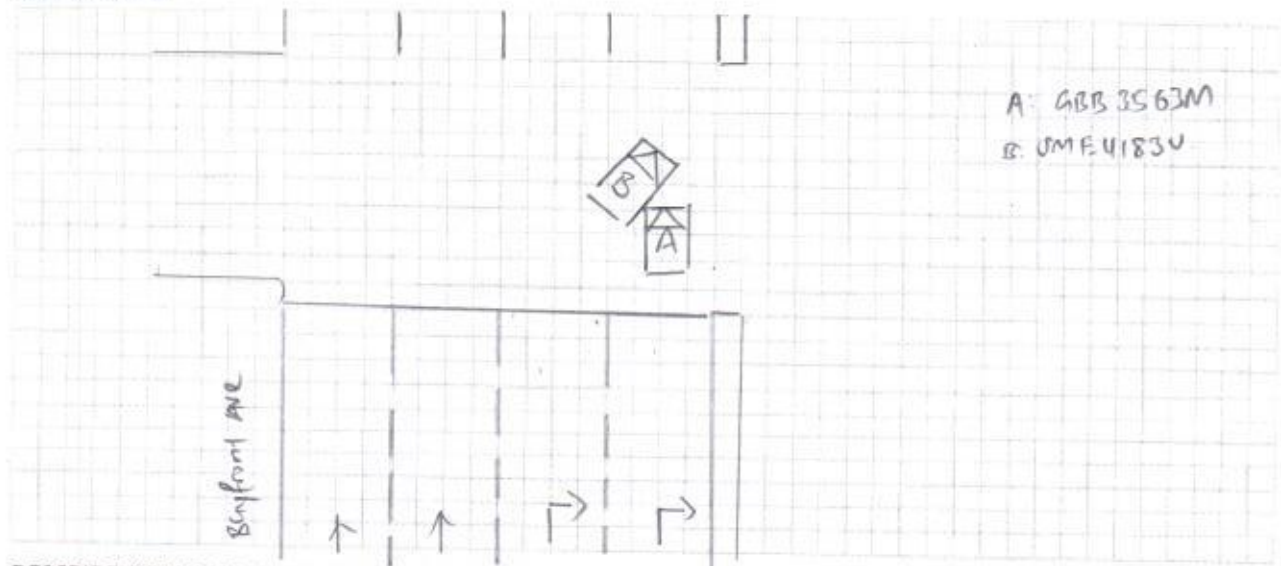

DESCRIBE CIRCUMSTANCES OF THE ACCIDENT

Refer to statement.

DECLARATION

I/We declare the foregoing particulars are true in every respect.

Policyholder's Signature
Date & Time:

Driver's Signature
(If driver is not the policyholder)
Date & Time:

Reporting Centre Personnel's Signature
Name:
NRIC/FIN No.:

ON STATED DATE AND TIME, I WAS TRAVELLING STRAIGHT ALONG THE STATED VENUE, VEHICLE B WAS ON THE 2ND LANE MAKING A RIGHT TURN. AS A RESULT, MY VEHICLE FRONT LEFT PORTION INTACT WITH VEHICLE B RIGHT PORTION.

REPORTING ONLY.

ACCIDENT STATEMENT

ACCIDENT DATE: (06 / 05 / 2019) (DD/MM/YYYY), TIME (01 : 25) (HH:MM)

LOCATION: Junc Bayway Ave & Central Blvd.

1. DETAILS OF VEHICLE

- a) VEHICLE NUMBER: GPB3563M
b) INSURANCE COMPANY: MS FIRST CAPITAL
c) POLICY NO: D-19093240MFCV
d) POLICY TYPE: (COMPREHENSIVE/THIRD PARTY/THIRD PARTY FIRE & THEFT)
e) MAKE/MODEL: SSANGYON (A) ACTYON. D/CAB
f) TYPE: (SALOON/COUPE/MPV/VAN/LORRY/MOTORCYCLE/OTHERS)
g) VEHICLE CATEGORY: (PRIVATE/COMMERCIAL/MOTORCYCLE)
h) PURPOSE OF USING AT TIME OF ACCIDENT: Working
i) ARE YOU CLAIMING UNDER YOUR OWN INSURANCE: (YES/NO) NO
IF NO, PLEASE STATE (THIRD PARTY CLAIM/REPORTING ONLY) 6749200~

2. INSURED / POLICY HOLDER

- A) NAME: SIDANG HOLIC CAR RENTAL PTE LTD. (MALE/FEMALE)
B) NRIC/FIN/PASSPORT: _____ CONTACT: 67492002
C) ADDRESS: _____

*CONTINUE TO 3.D IF DRIVER ALSO POLICY HOLDER

3. DRIVER

- A) NAME: AMIN BIN KADIR (MALE/FEMALE)
B) NRIC/FIN/PASSPORT: SG914361Z CONTACT: 91830377
C) ADDRESS: 71 YISHUN AVENUE 11 #01-02 S (768858)

D) DATE OF BIRTH: (24 / 04 / 1969) (DD/MM/YYYY)

E) OCCUPATION: (INDOOR/OUTDOOR)

F) YEARS OF DRIVING EXPERIENCE: 17 yrs.

4. WAS DRIVER AN EMPLOYEE OF THE INSURED'S COMPANY? (YES/NO)

IF NO, RELATIONSHIP OF THE DRIVER WITH INSURED: Hirer

5.A) WEATHER CONDITION: (CLEAR/ RAINING/OTHERS)

B) ROAD SURFACE: (DRY/WET/OTHERS)

6. WAS ANYBODY INJURED: (YES/NO)

7. REPORTED TO POLICE: (YES/NO)

IF YES PLEASE STATE WHICH POLICE STATION: _____

8. THIRD PARTY VEHICLE:

- A) VEHICLE NO: SME41834 MODEL: _____
B) DRIVER'S NAME: _____
C) NRIC.FIN PASSPORT NO.: _____ CONTACT: 97842639

9. THIRD PARTY VEHICLE:

- A) VEHICLE NO: _____ MODEL: _____
B) DRIVER'S NAME: _____
C) NRIC.FIN PASSPORT NO.: _____ CONTACT: _____

REPUBLIC OF SINGAPORE DRIVING LICENCE

Licence Number **S6914361Z**

Name
AMIN BIN KADIR

Birth Date **24 Apr 1969**

Issue Date **26 Aug 2003**

1600272606A



REPUBLIC OF SINGAPORE

IDENTITY CARD NO. **S6914361Z**



Name
AMIN BIN KADIR

Race
MALAY

Date of birth
24-04-1969

Country/Place of birth
SINGAPORE

Sex
M



YOU ARE LICENSED TO DRIVE VEHICLES IN THE FOLLOWING CLASS/ES

Class 3 **Motor Cars and Motor Tractors the weight of which unladen does not exceed 2500 kilograms**

PASS DATE
16 Oct 2002

NP 42BA

Licence No. **S6914361Z**

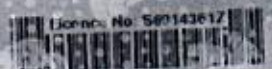
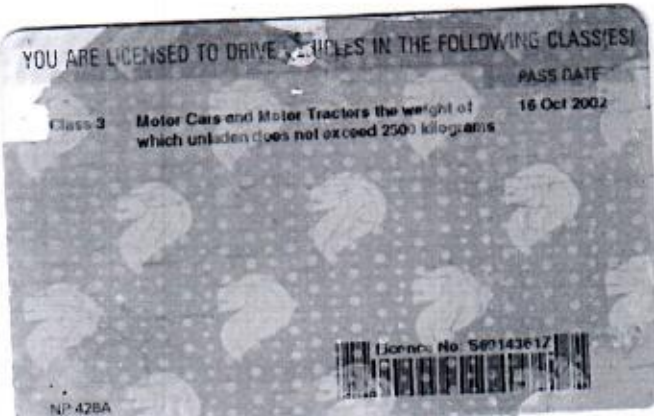

5401923

NRIC No. **S6914361Z**

Date of issue
23-09-2015

Address
**71 YISHUN AVENUE 11
#01-02
SINGAPORE 768858**



CERTIFICATE OF INSURANCE

ORIGINAL

Motor Vehicles (Third-Party Risks and Compensation) Act (Chapter 189)
 Motor Vehicles (Third-Party Risks and Compensation) Rules, 1960
 Road Transport Act, 1987 (Malaysia)
 Motor Vehicles (Third-Party Risks) Rules, 1959 (Malaysia)

Type of Policy. : COMMERCIAL VEHICLE - FLEET
 Type of Cover. : Third Party
 Certificate No. : D-19093240MFCV/112
 Vehicle No / Chassis No : GBB3563M / KPADA1EKS8P053451
 Name of Insured : SIANG HOCK CAR RENTAL PTE LTD
 Period Of Insurance : 01.04.2019 To 31.03.2020
 Insured Estimated Value : 0.00

EXCESS : AS INDICATED BELOW

Authorised Driver*

ANY AUTHORISED DRIVERS

Persons or classes of persons entitled to drive*

- (1) Whilst the vehicle is being used in connection with the Insured's business:-
 (a) Any person provided he is in the Insured's employ and is driving on their order or with their permission.
 (2) Whilst the vehicle is being used for social, domestic or pleasure purposes:-
 (a) Any person who is driving on the Insured's order or with their permission.

For drivers with more than 1 year driving experience and/or not less than 21 years of age

Excess : S\$1,000.00 on All Claims (for Long Term Lease - 1 year or more)
 S\$2,500.00 on All Claims (for Short Term Lease - less than 1 year)
 S\$1,000.00 on All Claims (for Staff)

For drivers with less than 1 year driving experience and/or less than 21 years of age

Excess : S\$3,000.00 on All Claims (for Long Term Lease - 1 year or more)
 S\$4,500.00 on All Claims (for Short Term Lease - less than 1 year)
 S\$2,000.00 on All Claims (for Staff)

* Provided that the person driving is permitted in accordance with the licensing or other laws or regulations to drive the Motor Vehicle or has been so permitted and is not disqualified by order of a Court of Law or by reason of any enactment or regulation in that behalf from driving the Motor Vehicle.

Limitations as to use*

Use in connection with the Insured's business.
 Use for the carriage of passengers (other than for hire or reward) in connection with the Insured's business.
 Use for social, domestic and pleasure purposes.

The Policy does not cover:-

- (1) Use for racing, pace-making, reliability trial or speed-testing.
 (2) Use whilst drawing a trailer except the towing of any one disabled mechanically propelled vehicle.
 (3) Use for the carriage of passengers for hire or reward.

* Limitations rendered inoperative by Section 8 of the Motor Vehicles (Third-Party Risks and Compensation) Act (Chapter 189) and Section 95 of the Road Transport Act, 1987 (Malaysia), are not to be included under these headings.

I/We HEREBY CERTIFY that the Policy to which this Certificate relates is issued in accordance with the provisions of the Motor Vehicles (Third-Party Risks and Compensation) Act (Chapter 189) and Part IV of the Road Transport Act, 1987 (Malaysia)

MS First Capital Insurance Limited
 (Approved Insurers)

LILIA/A0151/MZ301A10

Issued at Singapore on 01.04.2019

 Authorised Signature