

MSME19046873 / SME Motor Pte Ltd - Kaki Bukit  
 ENTRY DATE & TIME: 10/04/2019 16:23  
 SUBMITTED BY: Chia Pei Ying

## SINGAPORE ACCIDENT STATEMENT

**IMPORTANT NOTICE**

1. Please report correctly the details of the accident to speed up the claims process.
2. This Form must be completed by the Policyholder and/or the Authorised Driver.
3. Information provided must be as truthful and accurate as possible. Any wilful misrepresentation or withholding of material facts may allow insurance companies to repudiate policy liability.
4. The issue and acceptance of this Form by insurance companies is not an admission of policy liability on the part of the insurance companies.
5. **Any false reporting may be referred to the Police for investigation.**
6. This report will be forwarded by the insurers of the GIA Records Management Centre established by the General Insurance Association of Singapore (GIA) for archiving and that copies of this report will, for a fee, be made available upon application by interested parties.
7. By the lodgement of this report to the insurers, you hereby consent to the archiving of this report at the centre and to copies of the report being made available aforesaid.

**ACCIDENT STATEMENT**

Date Of Report	10/04/2019 16:23
Date Of Accident	09/04/2019 15:30
Exact Location Of Accident	LORONG CHUAN TWDS SERANGOON GARDEN @ SLIP RD
Country/State of Loss	SINGAPORE

**DETAILS OF OWN VEHICLE**

Vehicle Registration Number	SMF6458M
<b>Insured/Policyholder</b>	
Name Of Registered Owner	LING TECK LENG
NRIC No	S1312316J
Email Address	NOEMAIL
Mobile Phone No	(LOCAL) +65-96660606
Alternative Phone No	OFFICE-96660606

**Vehicle Particulars**

Manufacturer	SUBARU
Model	FORESTER
Exact Purpose for which vehicle was being used at time of accident	
Are you claiming under your own insurance policy for repair to your vehicle?	NO
If No, Please state action to be taken	THIRD PARTY
Vehicle Category	PRIVATE CAR

**Insurance Company**

Name of Insurance Company	AIG ASIA PACIFIC INSURANCE PTE. LTD.
Type Of Coverage	COMPREHENSIVE
Fleet Policy	NO
Policy Number	1800137591
Cover Note Number	

**Driver**

Name of Driver	LING TECK LENG
NRIC No	S1312316J
Date Of Birth	16/03/1958
Occupation	INDOOR
Date Of Driving Pass	31/10/1978
Driving Experience	40 YEARS AND 5 MONTHS
Gender	MALE
Mobile Number	(LOCAL) +65-96660606
Fax Number	
Contact Number	OFFICE-96660606
Email Address	NOEMAIL

Address 44 TAVISTOCK AVENUE  
 Postcode 555147  
 Was driver an employee of the Insured's Company NO  
 If No, Relationship of the Driver with the Insured OWNER  
 Vehicle Registration Number of Driver's Own Vehicle -  
 -  
 -  
 Insurance Company of Driver's Own Vehicle -  
 -  
 -

### General Information of the Accident

Type Of Accident COLLISION - HEAD TO REAR  
 Weather Conditions CLEAR  
 Road Surface DRY

### Other Information

Was any foreign vehicle involved in this accident? NO  
 Number of vehicles (including own vehicle) involved in the accident 2  
 Was any body injured in the Accident? NO  
 Was any injured conveyed to hospital by ambulance? NO  
 Was any other material or property damaged? YES  
 I have been approached by unknown person(s) soliciting/offering accident claims assistance. NO  
 Number of Passengers (Including Driver) 1

### Details of Police Action

Was the accident reported to the police? NO  
 If Yes, Please state which Police Station  
 Was notice of intended Prosecution given? NO  
 If Yes, against whom?

### Circumstances of Accident

ON 09/04/2019 AT ABOUT 3.30PM, MY VEHICLE A (SMF6458M) WAS STATIONARY AT THE SLIP ROAD OF LORONG CHUAN AND SERANGOON GARDEN. OUT OF THE SUDDEN, VEHICLE B (GW4405K) CAME FROM BEHIND AND HIT ONTO THE REAR PORTION OF MY VEHICLE A.

### Attachment(s)

Are accident photos available for attachment? YES  
 Was there any video captured by Car Camera? NO  
 Was there any audio recorded? NO

### DETAILS OF OTHER VEHICLE PROPERTY 1

Vehicle Registration Number GW4405K  
 Vehicle Make/Model/Colour  
 Details Of Properties VEHICLE B  
 Vehicle Category COMMERCIAL VEHICLE  
 Name of Driver  
 NRIC/Passport Number  
 Contact Number 96720898  
 Address  
 Postcode  
 Insurance Company Name  
 Nature Of Damage  
 No. Of Passenger (Including Driver)



## Sketch Plan Pg. 1

## SKETCH PLAN

## IMPORTANT NOTICE

1. Please report correctly the details of the accident to speed up the claims process.
2. This Form must be completed by the Policyholder and/or the Authorised Driver.
3. Information provided must be as truthful and accurate as possible. Any wilful misrepresentation or withholding of material facts may allow insurance companies to regulate policy liability.
4. The issue and acceptance of this Form by insurance companies is not an admission of policy liability on the part of the insurance companies.
5. Any false reporting may be referred to the Police for investigation.
6. The report will be forwarded by the insurers of the GIA Records Management Centre established by the General Insurance Association of Singapore (GIA) for archiving and that copies of this report will for a fee be made available upon application by interested parties.
7. By the lodgment of this report to the insurers, you hereby consent to the archiving of this report at the centre and to copies of the report being made available aforesaid.
8. **Consent under the Personal Data Protection Act (PDPA)**

I understand, acknowledge, agree and consent that:

- (a) My insurer, my workshop and the General Insurance Association of Singapore ("GIA") may/are permitted to collect, use, disclose and/or process my personal data/personal information set out in this form and any other personal information provided by me or possessed by my insurer (collectively the "Personal Information") and disclose and transfer such Personal Information to all insurer(s) who have insured vehicle(s) involved in this accident (all insurer(s) who have insured vehicle(s) involved in this accident shall be collectively referred to as the "Insurers"), the Insurers' lawyers/law firms, the Monetary Authority of Singapore and any relevant government agency/authority (such as the police), for the purpose(s) of:
  - (i) processing, handling and/or dealing with my claims including the settlement of the claims and any necessary investigations relating to the claims;
  - (ii) investigating the accident and/or my claims;
  - (iii) carrying out and/or dealing with my instructions or responding to any enquiries by me;
  - (iv) administering my claims (including the mailing of correspondence, statements, invoices, reports or notices to me, which could involve disclosure of certain personal data about me to bring about delivery of the same as well as on the external cover of envelopes/mail packages); and/or
  - (v) complying with applicable law in administering, processing, handling and/or dealing with my claims (collectively the "Purposes")
- (b) all insurer(s) who have insured vehicle(s) involved in this accident and the Insurers' lawyers/law firms, may/are permitted to collect, use, disclose and/or process my Personal Information for one or more of the above Purposes; and
- (c) my Personal Information may/can be disclosed by any of the Insurers and/or GIA to their third party service providers or agents (including their lawyers/law firms), which may be sited outside of Singapore, for one or more of the above Purposes.
- (d) my Personal Information will also be collected and used to compile claims history for the purpose of fraud detection, investigation and management in present and all future claims.
- (e) the information so collected under (d) above may be shared / disclosed:
  - (i) to all insurers and/or any other third parties that assist in evaluating, investigating, controlling or managing fraud, regulators, law enforcement and government agencies as reasonably required for the purposes stated, or
  - (ii) for complying with requirements under any regulations, laws or court orders.

Policyholder's Signature  
Date & Time:

Driver's Signature  
(If driver is not the policyholder)  
Date & Time:

Reporting Centre Personnel's Signature  
Name:  
NRIC/IN No.:

## Sketch Plan #2 Pg. 1

## SKETCH PLAN

Vehicle A: SMF6458M

B: GW4405K (Serangoon Garden)

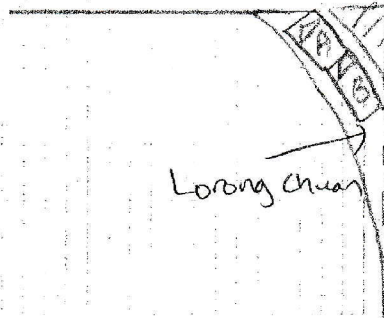

## DESCRIBE CIRCUMSTANCES OF THE ACCIDENT

On 9/4/2019 at about 3.30pm, my vehicle A (SMF6458M) was stationary at the slip road of Lorong Chuan and Serangoon Garden. Out of sudden, vehicle B (GW4405K) came from behind and hit into the rear portion of my vehicle A.

## DECLARATION

I/We declare the foregoing particulars are true in every respect.

*Cylogel*  
 Policyholder's Signature  
 Date & Time:

GSRMC SketchPlanForm VA

*Cylogel*  
 Driver's Signature  
 (If driver is not the policyholder)  
 Date & Time: 10/4/19

12:00pm

10/4/19 f 12-15pm  
 Reporting Centre Personnel's Signature  
 Name:  
 NRIC/FIN No.: