

## SINGAPORE ACCIDENT STATEMENT

### IMPORTANT NOTICE

1. Please report correctly the details of the accident to speed up the claims process.
2. This Form must be completed by the Policyholder and/or the Authorised Driver.
3. Information provided must be as truthful and accurate as possible. Any wilful misrepresentation or withholding of material facts may allow insurance companies to repudiate policy liability.
4. The issue and acceptance of this Form by insurance companies is not an admission of policy liability on the part of the insurance companies.
5. Any false reporting may be referred to the Police for investigation.
6. This report will be forwarded by the insurers of the GIA Records Management Centre established by the General Insurance Association of Singapore (GIA) for archiving and that copies of this report will, for a fee, be made available upon application by interested parties.
7. By the lodgement of this report to the insurers, you hereby consent to the archiving of this report at the centre and to copies of the report being made available aforesaid.

### ACCIDENT STATEMENT

Date Of Report	21/01/2019 17:18
Date Of Accident	18/01/2019 12:30
Exact Location Of Accident	47 JALAN BUROH LOADING/UNLOADING BAY
Country/State of Loss	SINGAPORE

### DETAILS OF OWN VEHICLE

Vehicle Registration Number	YP3807P
<b>Insured/Policyholder</b>	
Name Of Registered Owner	KLEEN-PAK PRODUCTS PTE LTD
Co Reg No	200304438W
Email Address	NOEMAIL
Mobile Phone No	(LOCAL) +65-97370760
Alternative Phone No	OFFICE-97370760

### Vehicle Particulars

Manufacturer	MITSUBISHI
Model	CANTER-3.0 D FEB71ER4SDEC (CBU) (M)
Exact Purpose for which vehicle was being used at time of accident	PARKED
Are you claiming under your own insurance policy for repair to your vehicle?	NO
If No, Please state action to be taken	THIRD PARTY
Vehicle Category	COMMERCIAL VEHICLE

### Insurance Company

Name of Insurance Company	CHINA TAIPING INSURANCE (SINGAPORE) PTE. LTD.
Type Of Coverage	COMPREHENSIVE
Fleet Policy	NO
Policy Number	DMCVSN1824591800
Cover Note Number	

### Driver

Name of Driver	CHELLAKANNA MUTHUKUMAR
Passport No/FIN	G5283954N
Date Of Birth	18/04/1989
Occupation	OUTDOOR
Date Of Driving Pass	20/02/2018
Driving Experience	0 YEAR AND 10 MONTH
Gender	MALE
Mobile Number	(LOCAL) +65-91309062
Fax Number	
Contact Number	
EEmail Address	NOEMAIL

Address	BLK 227 PASIR RIS ST 21 #10-104
Postcode	510227
Was driver an employee of the Insured's Company	YES
If No, Relationship of the Driver with the Insured	
Vehicle Registration Number of Driver's Own Vehicle	-
	-
	-
Insurance Company of Driver's Own Vehicle	-
	-
	-

#### General Information of the Accident

Type Of Accident	COLLIDED INTO PARKED VEHICLE
Weather Conditions	CLEAR
Road Surface	DRY

#### Other Information

Was any foreign vehicle involved in this accident?	NO
Number of vehicles (including own vehicle) involved in the accident	2
Was any body injured in the Accident?	NO
Was any injured conveyed to hospital by ambulance?	
Was any other material or property damaged?	YES
I have been approached by unknown person(s) soliciting/offering accident claims assistance.	NO
Number of Passengers (Including Driver)	1

#### Details of Police Action

Was the accident reported to the police?	NO
If Yes, Please state which Police Station	
Was notice of intended Prosecution given?	NO
If Yes, against whom?	

#### Circumstances of Accident

AS PER ATTACHED SKETCH PLAN

#### Attachment(s)

Are accident photos available for attachment?	YES
Was there any video captured by Car Camera?	NO
Was there any audio recorded?	NO

#### DETAILS OF OTHER VEHICLE PROPERTY 1

Vehicle Registration Number	XB7686E
Vehicle Make/Model/Colour	ISUZU LORRY RED COLOUR
Details Of Properties	
Vehicle Category	COMMERCIAL VEHICLE
Name of Driver	CHOW PHUAN YEN
NRIC/Passport Number	S0205139G
Contact Number	98387386
Address	APT BLK 231 BUKIT BATOK EAST AVE 5 #08-69
Postcode	650231
Insurance Company Name	
Nature Of Damage	
No. Of Passenger (Including Driver)	1

## Sketch Plan Pg. 1

### SKETCH PLAN

#### IMPORTANT NOTICE

1. Please report correctly the details of the accident to speed up the claims process.
2. This Form must be completed by the Policyholder and/or the Authorised Driver.
3. Information provided must be as truthful and accurate as possible. Any wilful misrepresentation or withholding of material facts may allow insurance companies to repudiate policy liability.
4. The issue and acceptance of this Form by insurance companies is not an admission of policy liability on the part of the insurance companies.
5. Any false reporting may be referred to the Police for investigation.
6. The report will be forwarded by the insurers of the GIA Records Management Centre established by the General Insurance Association of Singapore (GIA) for archiving and that copies of this report will for a fee be made available upon application by interested parties.
7. By the lodgment of this report to the insurers, you hereby consent to the archiving of this report at the centre and to copies of the report being made available aforesaid.
8. **Consent under the Personal Data Protection Act (PDPA)**

I understand, acknowledge, agree and consent that:

- (a) My insurer, my workshop and the General Insurance Association of Singapore ("GIA") may/are permitted to collect, use, disclose and/or process my personal data/personal information set out in this [form] and any other personal information provided by me or possessed by my insurer (collectively the "Personal Information") and disclose and transfer such Personal Information to all insurer(s) who have insured vehicle(s) involved in this accident (all insurer(s) who have insured vehicle(s) involved in this accident shall be collectively referred to as the "Insurers"), the Insurers' lawyers/law firms, the Monetary Authority of Singapore and any relevant government agency/authority (such as the police), for the purpose(s) of:
  - (i) processing, handling and/or dealing with my claims including the settlement of the claims and any necessary investigations relating to the claims;
  - (ii) investigating the accident and/or my claims;
  - (iii) carrying out and/or dealing with my instructions or responding to any enquiries by me;
  - (iv) administering my claims (including the mailing of correspondence, statements, invoices, reports or notices to me, which could involve disclosure of certain personal data about me to bring about delivery of the same as well as on the external cover of envelopes/mail packages); and/or
  - (v) complying with applicable law in administering, processing, handling and/or dealing with my claims. (collectively the "Purposes")
- (b) all insurer(s) who have insured vehicle(s) involved in this accident and the Insurers' lawyers/law firms, may/are permitted to collect, use, disclose and/or process my Personal Information for one or more of the above Purposes; and
- (c) my Personal Information may/can be disclosed by any of the Insurers and/or GIA to their third party service providers or agents (including their lawyers/law firms), which may be sited outside of Singapore, for one or more of the above Purposes.
- (d) my Personal Information will also be collected and used to compile claims history for the purpose of fraud detection, investigation and management in present and all future claims.
- (e) the information so collected under (d) above may be shared / disclosed:
  - (i) to all insurers and/or any other third parties that assist in evaluating, investigating, controlling or managing fraud, regulators, law enforcement and government agencies as reasonably required for the purposes stated, or
  - (ii) for complying with requirements under any regulations, laws or court orders.

Sign & chop

Policyholder's Signature

Date & Time: 21/1/19  
12:30 pm



Driver's Signature

(If driver is not the policyholder)

Date & Time: 21/01/19  
11:45 AM



Reporting Centre Personnel's Signature

Name:

NRIC/FIN No.:

SKETCH PLAN

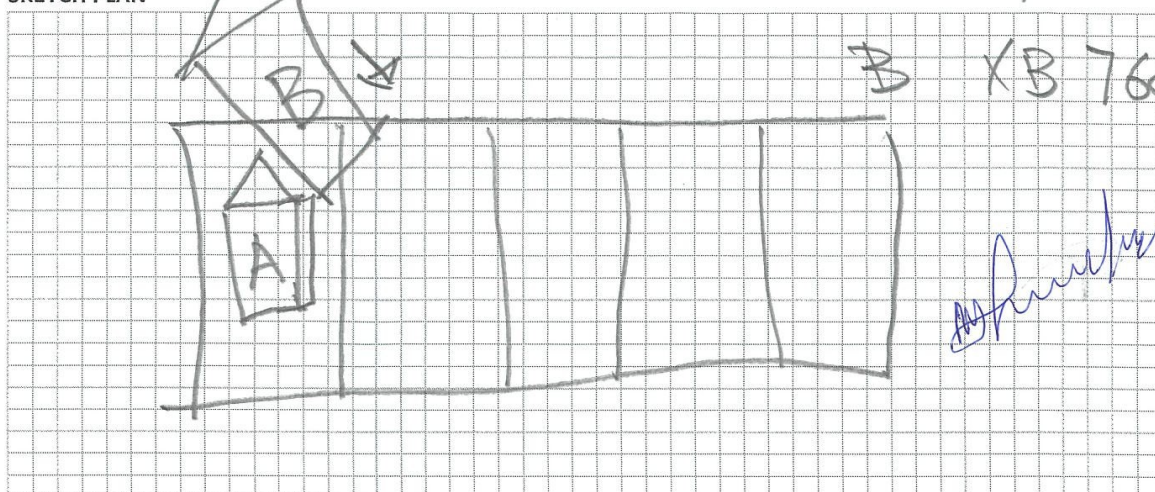

DESCRIBE CIRCUMSTANCES OF THE ACCIDENT

ON 18/01/2019 at about 1230 PM my lorry  
 YP3807P was parked (engine off) at the  
 loading/unloading bay of 47 Jalan Buruh Bay.  
 Suddenly lorry XB7686E<sup>was trying to</sup> reversed into the  
 unloading/loading bay on my right. I noticed  
 it was about to hit my lorry, I pressed  
 my horn, but lorry XB7686E still keep  
 reversing & it hit into my lorry front  
 right portion. I took photos & exchange  
 particulars with the driver.

DECLARATION

I/We declare the foregoing particulars are true in every respect.

Policyholder's Signature  
 Date & Time: 21/1/19  
 12:30 pm

GIARMC SketchPlanForm\_V3



Driver's Signature  
 (If driver is not the policyholder)  
 Date & Time: 21/01/19  
 11:45 AM

Reporting Centre Personnel's Signature  
 Name:  
 NRIC/FIN No.:





中国太平  
CHINA TAIPING

中国太平保险(新加坡)有限公司

CHINA TAIPING INSURANCE (SINGAPORE) PTE. LTD.

Co. Reg. No. 200208384E

ME300/C

N SN

AN0616A

Cov.Type: C

MOTOR COMMERCIAL VEHICLE

### CERTIFICATE OF INSURANCE

Motor Vehicles (Third-Party Risks and Compensation) Act (Chapter 189)  
Motor Vehicles (Third-Party Risks and Compensation) Rules, 1960  
Road Transport Act, 1987 (Malaysia)  
Motor Vehicles (Third-Party Risks) Rules, 1959 (Malaysia)

PLM 317563

ORIGINAL

CERTIFICATE No.

DMCVSN1824591800

Engine No :4P10C25698

ChaNo:FEB71EA20269

1. Index Mark and Registration  
Number of Vehicle

YP3807P

AutoSafe

2. Name of Policy Holder

KLEEN-PAK PRODUCTS PTE LTD

3. Effective date of the Commencement of  
Insurance for the purposes of the Regulations,  
Ordinance or Enactment

11 August 2018

Excess Sect I ..... S\$800.00

EX ON WINDSCREEN ..... S\$100.00

4. Date of Expiry of Insurance

10 August 2019

5. Persons or Classes of Persons entitled to drive\*

Any person who is driving on the Policyholder's order or with their permission.

Provided that the person driving is permitted in accordance with the licensing or other laws or regulations to drive the Motor Vehicle or has been so permitted and is not disqualified by order of a Court of Law or by reason of any enactment or regulation in that behalf from driving the Motor Vehicle.

6. Limitations as to use:

(1) Use in connection with the Policyholder's business.

(2) Use for the carriage of passengers (other than for hire or reward) in connection with the Policyholder's business.

(3) Use for social, domestic or pleasure purposes.

The Policy does not cover.

(1) Use for hire or reward or racing, pace-making, reliability trial or speed testing.

(2) Use whilst drawing a trailer except the towing of any one disabled mechanically propelled vehicle.

HIRE PURCHASE CO. : GOLDBELL FINANCIAL SERVICES PTE. LTD. AS HP

\* Limitations rendered inoperative by Section 8 of the Motor Vehicles (Third-Party Risks and Compensation) Act (Chapter 189) and Section 95 of the Road Transport Act 1987 (Malaysia), are not to be included under these headings.

**I/We hereby Certify** that the policy to which this Certificate relates is issued in accordance with the provisions of the Motor Vehicles (Third-Party Risks and Compensation) Act (Chapter 189) and Part IV of the Road Transport Act, 1987 (Malaysia).

Please see reverse

For CHINA TAIPING INSURANCE (SINGAPORE) PTE. LTD.

Issued By:

Authorised Officer

Authorised Signatory

3 Anson Road #16-00 Springleaf Tower Singapore 079909 Tel: 6389 6111 Fax: 6225 3592 Website: www.sg.cntaiping.com

# DRIVER S PASS N DL Pg. 1

**S PASS**  
Employment of Foreign Manpower Act (Chapter 91A)  
Republic of Singapore

Employer  
**KLEEN-PAK PRODUCTS PTE. LTD.**

Sector: **MANUFACTURING**

Name  
**CHELLAKANNU MUTHUKUMAR**

Occupation  
**DELIVERY DRIVER**

S Pass No.  
**0 36603259**

Date of Application  
**03-10-2017**

Date of Issue  
**22-11-2017**

Date of Expiry  
**01-12-2019**

**L8461943**

**REPUBLIC OF SINGAPORE DRIVING LICENCE**

Licence Number: **G5283954N**

Name: **CHELLAKANNU MUTHUKUMAR**

Birth Date: **18 Apr 1989**

Issue Date: **09 Jan 2016**

Valid Till **27/04/2019**

**002517041A**

*Driver*

**VISIT PASS**  
Immigration Regulations

Name  
**CHELLAKANNU MUTHUKUMAR**

Date of Birth **18-04-1989** Sex **M** Nationality **INDIAN**

FIN **G5283954N** Date of Issue **22-11-2017** Date of Expiry **01-12-2019**

**MULTIPLE JOURNEY VISA ISSUED**

**YOU ARE TO SURRENDER THIS CARD WHEN IT IS CANCELLED OR HAS EXPIRED, OR WHEN A NEW CARD IS ISSUED TO YOU.**

**YOU ARE LICENSED TO DRIVE VEHICLES IN THE FOLLOWING CLASS(ES)**

**EFFECTIVE DATE**

Class	Description	Effective Date
Class 2B	Motorcycles ≤ 200 CC	28 Apr 2014
Class 3	Motor cars ≤ 3000 kg with ≤ 7 passengers, exclusive of the driver, and motor tractors/vehicles ≤ 2500 kg	28 Apr 2014
Class 4	Heavy motor cars and motor tractors > 2500 kg	20 Feb 2018

**S / No. 9000278379**

**G5283954N**

**Licence No: G5283954N**

**NP 428A**

INSURED LORRY



INSURED LORRY CHASSIS NUMBER





INSURED LORRY



INSURED LORRY



INSURED LORRY





## INSURED LORRY





INSURED LORRY



INSURED LORRY



# ACCIDENT SCENE



3RD PARTY LORRY

