

Enquire Transfer Fee

Vehicle Details			
Vehicle No. :	FBF6902C		
Vehicle Type :	P00 - Passenger Motorcycle/Autocycle/Moped		
Vehicle Attachment 1 :	No Attachment		
Vehicle Scheme :	Normal		
Vehicle Make :	YAMAHA		
Vehicle Model :	FZ 16		
Chassis No. :	ME121C079B2012896		
Propellant :	Petrol		
Engine No. :	21C7012904		
Engine Capacity :	153 cc		
Maximum Power Output :	-		
Maximum Laden Weight :	330 kg		
Unladen Weight :	135 kg		
Year Of Manufacture :	2011		
Original Registration Date :	13 Oct 2011		
Lifespan Expiry Date :	-		
COE Category :	D - Motorcycle		
Quota Premium :	\$2,078.00		
COE Expiry Date :	12 Oct 2021		
Road Tax Expiry Date :	12 Oct 2019		
Inspection Due Date :	12 Oct 2019		
Intended Transfer Date :	15 Jan 2019		
CO2 Emission :	-		
CO Emission :	-		
HC Emission :	-		
NOx Emission :	-		
PM Emission :	-		
Late renewal fee(s) will be imposed if road tax / lay up has expired. Please use Enquire Road Tax Payable for fee(s) payable.			
Road tax, including Over Payment (if any), of a vehicle will follow the vehicle to the new registered owner when its ownership is being transferred.			
Amount Payable			
	Amount Before GST (S\$)	GST Amount (S\$)	Amount After GST (S\$)
Transfer Fee :	25.00	-	25.00
Total Amount Payable :			25.00

You may print this page for reference.

OK

Print



BAN HOCK HIN
Co., Pte Ltd

Co.Reg.No: 197000288K

MOTORCYCLE ACCESSORIES | SERVICE CENTRE
MODIFICATIONS | SPRAY PAINTING AND BODY WORK | METAL
WORKS | LEASING & RENTALS | FLEET SALES | INSURANCE SALES

QUOTATION

Customer :

NO. : 33482

AXA INSURANCE SINGAPORE PTE LTD

8 Shenton Way,
#27-01 AXA Tower
Singapore 068811

DATE : 14/01/2019

CLAIM NO. : 11242

POLICY NO. :

AXA INSURANCE SINGAPORE PTE LTD

FROM : RAYMOND

VEHICLE NO. : FBF6902C

MAKE/MODEL : YAM / FZ16

(Page 1 of 3)

S/N	Description	Action	Qty	Unit Price	Amount
1	AXLE WHEEL FRONT P/N: 44885	REPLACE	1.00	\$24.00	24.00
2	BALANCER SET (UNIVERSAL-HEAVY)	REPLACE	1.00	\$52.00	52.00
3	BAR FOOTREST FRONT RH P/N: 40315	REPLACE	1.00	\$16.00	16.00
4	BAR HANDLE (PROTAPER) 22MM	REPLACE	1.00	\$210.00	210.00
5	BEARING P/N: 50211	REPLACE	2.00	\$12.00	24.00
6	BOLT FOOTREST REAR P/N: 44888	REPLACE	1.00	\$5.00	5.00
7	BOX (SWMOTECH) TRAX EVO TOP BOX 38L	REPLACE	1.00	\$910.00	910.00
8	BRACKET UNDER FORK P/N: 52252	REPLACE	1.00	\$268.00	268.00
9	CAP END MUFFLER (BLACK) P/N: 43631	REPLACE	1.00	\$32.00	32.00
10	CLIP FRONT FOOTREST	REPLACE	1.00	\$4.50	4.50
11	COVER OIL ELEMENT P/N: 59799	REPLACE	1.00	\$35.00	35.00
12	COVER TAIL RH (RED)	REPLACE	1.00	\$48.00	48.00
13	COVER TANK RH (RED)	REPLACE	1.00	\$96.00	96.00



Address: No. 6, Defu lane 4, Singapore 539410 | Telephone: +65 6281 6520 | Web: www.bhh.com.sg
Fax: (Main) +65 6281 2830, (Spare Parts) +65 6285 7530, (Insurance/Project) +65 6284 2969, (Accounts) +65 6281 6759

CERT NO.: 2002-1-0383
ISO 9001 : 2015

<u>S/N</u>	<u>Description</u>	<u>Action</u>	<u>Qty</u>	<u>Unit Price</u>	<u>Amount</u>
14	CRANKCASE (CLUTCH SIDE)	REPLACE	1.00	\$96.00	96.00
15	EMBLEM P/N: 50204	REPLACE	1.00	\$8.50	8.50
16	FILTER OIL P/N: 40351	REPLACE	1.00	\$12.00	12.00
17	FORK FRONT ASSY LH (BLACK)	REPLACE	1.00	\$416.00	416.00
18	FORK FRONT ASSY RH (BLACK) P/N: 59801	REPLACE	1.00	\$416.00	416.00
19	GASKET CLUTCH COVER P/N: 52953	REPLACE	1.00	\$13.00	13.00
20	GRAPHIC 3 P/N: 45151	REPLACE	1.00	\$4.50	4.50
21	GRIP TANK (SS) FZ16 (TECHSPEC) P/N: 44874	REPLACE	1.00	\$125.00	125.00
22	HELMET (EVO) RS959 VII	REPLACE	1.00	\$135.00	135.00
23	LABOUR P/N: 06766 - LABOUR QUOTED FOR DISMANTLING AND INSTALLATION OF PARTS.	Supply/Install	1.00	\$420.00	420.00
24	LAMP SIGNAL FRONT RH P/N: 45130	REPLACE	1.00	\$16.00	16.00
25	LEVER KICK STARTER	REPLACE	1.00	\$60.00	60.00
26	LEVER SET (RED)	REPLACE	1.00	\$70.00	70.00
27	MIRROR SET (AFTERMARKET)	REPLACE	1.00	\$65.00	65.00
28	MUDGUARD FRONT (RED) P/N: 55147	REPLACE	1.00	\$55.00	55.00
29	NUT SELF LOCKING	REPLACE	1.00	\$10.00	10.00
30	O-RING (WATER PUMP) P/N: 50377	REPLACE	1.00	\$3.50	3.50
31	O-RING OIL FILTER P/N: 46241	REPLACE	1.00	\$7.00	7.00
32	PANEL 2 P/N: 59798	REPLACE	1.00	\$22.00	22.00
33	PEDAL BRAKE P/N: 45125	REPLACE	1.00	\$26.00	26.00
34	PROTECTOR MUFFLER (SILVER) P/N: 40320	REPLACE	1.00	\$44.00	44.00



CERT NO.: 2002-I-0383
ISO 9001:2015

S/N	Description	Action	Qty	Unit Price	Amount
35	RIM SPORT FRONT (BLACK)	REPLACE	1.00	\$372.00	372.00
36	RUBBER FOOTREST FRONT P/N: 40321	REPLACE	1.00	\$9.00	9.00
37	SCOOP AIR RH (RED)	REPLACE	1.00	\$32.00	32.00
38	SEAL OIL (11X18X6) CRANKCASE COVER - CLUTCH P/N: 24160	REPLACE	2.00	\$6.00	12.00
39	SEAL OIL FRONT RIM	REPLACE	1.00	\$3.00	3.00
40	SENA BLUETOOTH (SMH5-FM)	REPLACE	1.00	\$513.00	513.00
41	SHROUD AIR P/N: 50471	REPLACE	1.00	\$35.00	35.00
42	SLIDER FRONT AXLE (MOTOVATION)	REPLACE	1.00	\$425.00	425.00
43	SPRING RETURN P/N: 45126	REPLACE	1.00	\$6.00	6.00
44	STEERING CONE SET P/N: 33765	REPLACE	1.00	\$53.00	53.00
45	STICKER (YAMAHA) LOGO & WORDING	REPLACE	2.00	\$12.00	24.00
46	STICKER COVER TAIL LH	REPLACE	1.00	\$1.50	1.50
47	TUBE TOOL (WITH LOCK)	REPLACE	1.00	\$45.00	45.00
48	WASHER FRONT RIM	REPLACE	1.00	\$1.50	1.50

SUB TOTAL

\$5,281.00

GST @ 7 %

\$369.67

GRAND TOTAL

\$5,650.67

50% deposit required before ordering of parts.

Validity: 30 days

For & on Behalf of

BAN HOCK HIN CO PTE LTD



RAYMOND

Acknowledge & Accepted By

This quotation is sent via email / LAN-Fax and will bear a computer generated signature.

CERT NO: 2002-1-0383
ISO 9001:2015

SINGAPORE ACCIDENT STATEMENT

IMPORTANT NOTICE

1. Please report correctly the details of the accident to speed up the claims process.
2. This Form must be completed by the Policyholder and/or the Authorised Driver.
3. Information provided must be as truthful and accurate as possible. Any wilful misrepresentation or withholding of material facts may allow insurance companies to repudiate policy liability.
4. The issue and acceptance of this Form by insurance companies is not an admission of policy liability on the part of the insurance companies.
5. Any false reporting may be referred to the Police for investigation.
6. This report will be forwarded by the insurers of the GIA Records Management Centre established by the General Insurance Association of Singapore (GIA) for archiving and that copies of this report will, for a fee, be made available upon application by interested parties.
7. By the lodgement of this report to the insurers, you hereby consent to the archiving of this report at the centre and to copies of the report being made available aforesaid.

ACCIDENT STATEMENT

Date Of Report	09/01/2019 04:14
Date Of Accident	03/01/2019 21:30
Exact Location Of Accident	JUNCTION PUNGGOL FIELD AND PUNGGOL PLACE
Country/State of Loss	SINGAPORE

DETAILS OF OWN VEHICLE

Vehicle Registration Number	FBF6902C
Insured/Policyholder	
Name Of Registered Owner	MUHAMMAD SYAFIQ BIN JUMARI
NRIC No	S8440103Z
Email Address	SYAFIQJUMARI@HOTMAIL.COM
Mobile Phone No	(LOCAL) +65-97874167
Alternative Phone No	OFFICE-97874167

Vehicle Particulars

Manufacturer	YAMAHA
Model	FZ16
Exact Purpose for which vehicle was being used at time of accident	PRIVATE
Are you claiming under your own insurance policy for repair to your vehicle?	NO
If No, Please state action to be taken	THIRD PARTY
Vehicle Category	MOTORCYCLE

Insurance Company

Name of Insurance Company	FWD SINGAPORE PTE. LTD.
Type Of Coverage	COMPREHENSIVE
Fleet Policy	NO
Policy Number	PNMC2018-00004400
Cover Note Number	N.A.

Driver

Name of Driver	MUHAMMAD SYAFIQ BIN JUMARI
NRIC No	S8440103Z
Date Of Birth	19/12/1984
Occupation	INDOOR
Date Of Driving Pass	15/04/2008
Driving Experience	10 YEARS AND 8 MONTHS
Gender	MALE
Mobile Number	(LOCAL) +65-97874167
Fax Number	
Contact Number	OFFICE-97874167
Email Address	SYAFIQJUMARI@HOTMAIL.COM

Address	BLK 232A SUMANG LANE #03-395
Postcode	821232
Was driver an employee of the Insured's Company	NO
If No, Relationship of the Driver with the Insured	OWNER
Vehicle Registration Number of Driver's Own Vehicle	-
	-
	-
Insurance Company of Driver's Own Vehicle	-
	-
	-

General Information of the Accident

Type Of Accident	COLLISION - CROSS JUNCTION
Weather Conditions	CLEAR
Road Surface	DRY

Other Information

Was any foreign vehicle involved in this accident?	NO
Number of vehicles (including own vehicle) involved in the accident	2
Was any body injured in the Accident?	YES
Was any injured conveyed to hospital by ambulance?	YES
Was any other material or property damaged?	YES
I have been approached by unknown person(s) soliciting/offering accident claims assistance.	NO
Number of Passengers (Including Driver)	2
Passenger 1	NAME: : LYE NADIA GENDER: : FEMALE

Details of Police Action

Was the accident reported to the police?	YES
If Yes, Please state which Police Station	
POLICE STATION NAME [OTHER]	TRAFFIC POLICE DIVISION HQ
Was notice of intended Prosecution given?	NO
If Yes, against whom?	

Circumstances of Accident

Refer to Police Report: T/20190107/2097 lodged at Traffic Police Division HQ Brief Details ON THE ABOVE MENTION DATE TIME AND LOCATION ON 03/01/2019 AT ABOUT 2130HRS, I WAS TRAVELLING ALONG PUNGGOL FIELD TOWARDS THE OPPOSITE DIRECTION AFTER THE JUNCTION OF PUNGGOL PLACE. I WAS RIDING IN THE SECOND LANE FROM THE LEFT. I WAS PROCEEDING STRAIGHT, UPON REACHING THE TRAFFIC LIGHT JUNCTION, THE LIGHT WAS GREEN IN MY FAVOUR, I PROCEEDED STRAIGHT. SUDDENLY I SAW UNKNOWN CAR FROM MY OPPOSITE DIRECTION TURNING TO ITS RIGHT, COMING TOWARDS US AND COLLIDED ONTO US. MY WIFE LYE NADIA WAS MY PILLION. BOTH OF US WERE INJURED. I WAS CONVEYED TO SKGH AND MY WIFE WAS CONVEYED TO CGH.

Attachment(s)

Are accident photos available for attachment?	YES
Was there any video captured by Car Camera?	NO
Was there any audio recorded?	NO

DETAILS OF OTHER VEHICLE PROPERTY 1

Vehicle Registration Number	SLX 4238L
Vehicle Make/Model/Colour	
Details Of Properties	
Vehicle Category	NA/UNKNOWN
Name of Driver	NO DETAILS
NRIC/Passport Number	

Contact Number
Address
Postcode
Insurance Company Name
Nature Of Damage
No. Of Passenger (Including Driver)

DETAILS OF INJURED PERSON 1

Name MUHAMMAD SYAFIQ BIN JUMARI
Approximate Age
Injuries Sustain
Injured person in which vehicle? FBF6902C
Were seat belts worn?
Was this injured conveyed to hospital by ambulance? YES
Address
Postcode

DETAILS OF INJURED PERSON 2

Name LYE NADIA
Approximate Age
Injuries Sustain
Injured person in which vehicle? FBF6902C
Were seat belts worn?
Was this injured conveyed to hospital by ambulance? YES
Address
Postcode

Sketch Plan

IMPORTANT NOTICE

- [illegible]

VERIFIED BY ALAC MARS
REPORTING OFFICER
WICHAIRUAD SUDHANCHITUN
NONGKOT PORN

Police Officer's Signature: Date & Time: Officer's Signature (If driver is not the policyholder): Date & Time: Date of Birth of Policyholder: Insurance Policy Number:

Sketch Plan

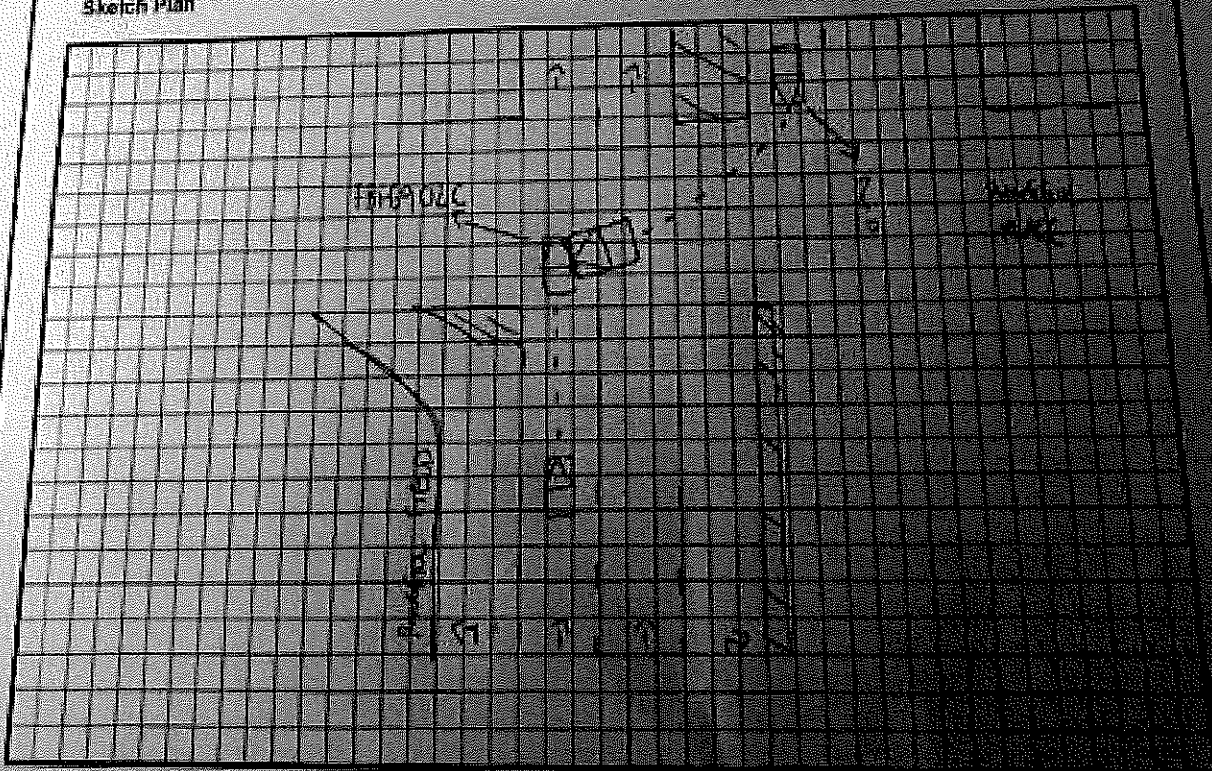

Common Statement

ACCIDENT STATEMENT (2000 characters)

Refer to police report.

Taxi Voucher No.:

DECLARATION

(We declare that the above particulars & information provided above are true in every aspect)

VERIFIED BY AJAX MARS REPORTING OFFICER -
MOHAMMAD SULHANDI BIN MOH AFFANDI

MARS Officer



Registered Owner or Driver's Signature

Job Complete Date/Time

8 January 2019 at 3:20 PM

Date/Time:

8 January 2019 at 3:20 PM

POLICE REPORT



**SINGAPORE
POLICE FORCE**

Police Station Of Origin:
Traffic Police
10 Ubi Avenue 3 SINGAPORE 408866
Tel No: 65470000



1501001070007

1 of 3
Report No: 12011001070007

REPORT OF A TRAFFIC ACCIDENT

Date/Time Report Made:
02/01/2019 14:16

Video Report No.:

Station Diary No.:

Informant's Particulars

Name of Informant:
MUHAMMAD SYAFIQ BIN JUMARI

Address:
APT DLK 232A SUMANG LANE #03-296 MATILDA COURT
SINGAPORE 621232

ID Type / ID No.:
NRIC RD / S84401002

Contact No.:
Home/Office: Mobile: 97874167

Nationality:
SINGAPORE CITIZEN

Email:

Sex: Male Age: 34 Date of Birth: 19/12/1984

Type of Informant:
Rider

Race:
Javanese

Language:
English

Institution / School Name:

Occupation:
ICA

Driving Licence Information:
Class: 2B,3

Date of Expiry:

General Information of the Accident

Type of Accident:	Injury Conveyed By Ambulance	Drink Drive: No	Date/Time of Accident: 02/01/2019 21:30	Type of Location:
-------------------	------------------------------	-----------------	---	-------------------

Location:
Along Road 1
PUNGGOL FIELD

PUNGGOL FIELD X PUNGGOL PLACE

Weather:	Road Surface:	Road Speed Limit:
----------	---------------	-------------------

Traffic Flow:	Traffic Control:	Traffic Volume:
---------------	------------------	-----------------

Type of Collision:	Anyone conveyed by ambulance: Yes
--------------------	-----------------------------------

Details of Vehicle Involved

Vehicle No.	Type	Make	Model	Color	Condition
FBF6902C	Motorcycle	YAMAHA	FZ 18	Red	

Details of Vehicle Insurance

Vehicle No.	Insurance Company	Insurance No.	Policy No.	Policy End Date
FBF6902C	FWD Singapore Pte. Ltd	PNMC2018-00004400	131010018	12/12/2018

POLICE REPORT



SINGAPORE
POLICE FORCE

Police Station Of Origin:
Traffic Police
10 Ubi Avenue 3 SINGAPORE 408655
Tel No: 65470000

Report No. 17901/18

CONTINUATION OF REPORT

Brief Details:

ON THE ABOVE MENTION DATE TIME AND LOCATION

ON 03/01/2018 AT ABOUT 2130HRS, I WAS TRAVELLING ALONG PUNGGOOL FIELD TOWARDS THE OPPOSITE DIRECTION AFTER THE JUNCTION OF PUNGGOOL PLACE. I WAS RIDING IN THE SECOND LANE FROM THE LEFT. I WAS PROCEEDING STRAIGHT. UPON REACHING THE TRAFFIC LIGHT JUNCTION, THE LIGHT WAS GREEN IN MY FAVOUR. I PROCEEDED STRAIGHT. SUDDENLY I SAW UNKNOWN CAR FROM OPPOSITE DIRECTION TURNING TO ITS RIGHT, COMING TOWARDS US AND COLLIDED ONTO US. MY WIFE, LYE KAGIA WAS MY PILLION. BOTH OF US WERE INJURED. I WAS CONVEYED TO BGH AND MY WIFE WAS CONVEYED TO CGH.

300018

POLICE REPORT

SINGAPORE
POLICE FORCE



T200 YRG 107/0007

3 of 3

Report No. T200180107/0007

Station Of Origin:
Public Police
10 Ubi Avenue 3 SINGAPORE 408855
Tel No: 65470000

CONTINUATION OF REPORT

Sketch Plan

Informant is not able to provide sketch plan

IMPORTANT: Please attach a copy of your vehicle's Insurance Certificate to this report. If you don't have the certificate with you now, please fax a copy to 65474885 stating the report number as reference.

Signature Of Officer Recording The Report:
TP /
TAN KOK RAY

Signature Of Informant:

Signature Of Interpreter:
Not applicable

Date/Time:
07/01/2019 14:18

Officer In Charge Of Case:
TP / GIT /

Classification Of Case:
SINGAPORE
POLICE FORCE

Contact No.:

Authentication Stamp
NP168

**GENERAL INSURANCE ASSOCIATION OF SINGAPORE
RECORDS MANAGEMENT CENTRE**

6 Raffles Quay #18-00, Singapore 048580
Phone: +65 6224 0010 Fax: +65 6224 0030
Operating Hours: Monday to Friday 9am to 5pm
GST Registration No: M400017735

Third Party Insurer Enquiry

Our Ref No: GR-19-007372

Date of Request: 14/01/2019

Your Ref No: Online Purchase

Ban Hock Hin Co. Pte Ltd
No. 6 Defu Lane 4
Singapore 539410

Dear Sir/Madam,

Enquiry Date 14/01/2019
Enquiry By Tan Chok Lok
TP Vehicle No. SLX4238L
Accident Date 03/01/2019

Enquiry Result

TP Vehicle No.	Insurer	Period of Insurance	Insurer Tel. No.
SLX4238L	AXA Insurance Pte Ltd	27/03/2018-26/03/2020	6338 7288

Thank You.

The images provided to you are taken from the original reports forwarded to the centre by the members of the General Insurance Association of Singapore and we take no responsibility for their accuracy or contents and shall be under no liability whatsoever for any loss or damage arising out of or in connection with the reports or their images.

This is a computer generated document and requires no signature.

**GENERAL INSURANCE ASSOCIATION OF SINGAPORE
RECORDS MANAGEMENT CENTRE**

6 Raffles Quay #18-00, Singapore 048580
Phone: +65 6224 0010 Fax: +65 6224 0030
Operating Hours: Monday to Friday 9am to 5pm
GST Registration No: M400017735

TAX INVOICE

Our Ref No: GR-19-007372

Date of Request: 14/01/2019

Your Ref No: Online Purchase

Ban Hock Hin Co. Pte Ltd
No. 6 Defu Lane 4
Singapore 539410

Dear Sir/Madam,

Enquiry Date 14/01/2019
Enquiry By Tan Chok Lok
TP Vehicle No. SLX4238L
Accident Date 03/01/2019

DESCRIPTION	AMOUNT (S\$)
TP Insurer Enquiry	1.87
GST Amount	0.13
Total Amount Due (GST Inclusive)	2.00

Thank You.

This is a computer generated document and requires no signature.

For GIARMC Official use:

Date:

☒ GIRO ☐ Cash ☐ Cheque