

## SINGAPORE ACCIDENT STATEMENT

### IMPORTANT NOTICE

1. Please report correctly the details of the accident to speed up the claims process.
2. This Form must be completed by the Policyholder and/or the Authorised Driver.
3. Information provided must be as truthful and accurate as possible. Any wilful misrepresentation or withholding of material facts may allow insurance companies to repudiate policy liability.
4. The issue and acceptance of this Form by insurance companies is not an admission of policy liability on the part of the insurance companies.
5. Any false reporting may be referred to the Police for investigation.
6. This report will be forwarded by the insurers of the GIA Records Management Centre established by the General Insurance Association of Singapore (GIA) for archiving and that copies of this report will, for a fee, be made available upon application by interested parties.
7. By the lodgement of this report to the insurers, you hereby consent to the archiving of this report at the centre and to copies of the report being made available aforesaid.

### ACCIDENT STATEMENT

Date Of Report	14/01/2019 11:17
Date Of Accident	14/01/2019 08:30
Exact Location Of Accident	3B TOH GUAN RD EAST
Country/State of Loss	SINGAPORE

### DETAILS OF OWN VEHICLE

Vehicle Registration Number	GR6066T
<b>Insured/Policyholder</b>	
Name Of Registered Owner	CHIN HWA COURIER SERVICES
Co Reg No	53075545M
Email Address	NOEMAIL
Mobile Phone No	(LOCAL) +65-98587027
Alternative Phone No	OFFICE-98587027

### Vehicle Particulars

Manufacturer	TOYOTA
Model	HIACE DIESEL
Exact Purpose for which vehicle was being used at time of accident	WORKING
Are you claiming under your own insurance policy for repair to your vehicle?	NO
If No, Please state action to be taken	REPORTING ONLY
Vehicle Category	COMMERCIAL VEHICLE

### Insurance Company

Name of Insurance Company	NTUC INCOME INSURANCE CO-OPERATIVE LTD
Type Of Coverage	THIRD PARTY FIRE AND/OR THEFT
Fleet Policy	NO
Policy Number	5088520811-01
Cover Note Number	

### Driver

Name of Driver	LIM CHIN HWA
NRIC No	S1191916B
Date Of Birth	14/11/1956
Occupation	OUTDOOR
Date Of Driving Pass	04/07/1977
Driving Experience	41 YEARS AND 6 MONTHS
Gender	MALE
Mobile Number	(LOCAL) +65-98587027
Fax Number	
Contact Number	OFFICE-98587027
EEmail Address	NOEMAIL

Address	BLK 425 TAMPINES STREET 41 #10-411
Postcode	520425
Was driver an employee of the Insured's Company	NO
If No, Relationship of the Driver with the Insured	OWNER
Vehicle Registration Number of Driver's Own Vehicle	- - -
Insurance Company of Driver's Own Vehicle	- - -

#### General Information of the Accident

Type Of Accident	HIT AND RUN / VANDALISM / DAMAGED WHILST PARKED
Weather Conditions	CLEAR
Road Surface	DRY

#### Other Information

Was any foreign vehicle involved in this accident?	NO
Number of vehicles (including own vehicle) involved in the accident	2
Was any body injured in the Accident?	NO
Was any injured conveyed to hospital by ambulance?	
Was any other material or property damaged?	YES
I have been approached by unknown person(s) soliciting/offering accident claims assistance.	NO
Number of Passengers (Including Driver)	0

#### Details of Police Action

Was the accident reported to the police?	NO
If Yes, Please state which Police Station	
Was notice of intended Prosecution given?	NO
If Yes, against whom?	

#### Circumstances of Accident

ON STATED DATE AND TIME, MY VEHICLE WAS STATIONARY PARKED ALONG THE STATED VENUE. SUDDENLY VEHICLE B REVERSED AND HIT ONTO MY VEHICLE FRONT PORTION.

#### Attachment(s)

Are accident photos available for attachment?	YES
Was there any video captured by Car Camera?	NO
Was there any audio recorded?	NO

#### DETAILS OF OTHER VEHICLE PROPERTY 1

Vehicle Registration Number	UNKNOWN
Vehicle Make/Model/Colour	
Details Of Properties	
Vehicle Category	COMMERCIAL VEHICLE
Name of Driver	
NRIC/Passport Number	
Contact Number	
Address	
Postcode	
Insurance Company Name	
Nature Of Damage	
No. Of Passenger (Including Driver)	1

## Accident Sketch Plan

### SKETCH PLAN

#### IMPORTANT NOTICE

1. Please report correctly the details of the accident to speed up the claims process.
2. This Form must be completed by the Policyholder and/or the Authorised Driver.
3. Information provided must be as truthful and accurate as possible. Any wilful misrepresentation or withholding of material facts may allow insurance companies to repudiate policy liability.
4. The issue and acceptance of this Form by insurance companies is not an admission of policy liability on the part of the insurance companies.
5. Any false reporting may be referred to the Police for investigation.
6. The report will be forwarded by the insurers of the GIA Records Management Centre established by the General Insurance Association of Singapore (GIA) for archiving and that copies of this report will for a fee be made available upon application by interested parties.
7. By the lodgment of this report to the insurers, you hereby consent to the archiving of this report at the centre and to copies of the report being made available aforesaid.
8. **Consent under the Personal Data Protection Act (PDPA)**

I understand, acknowledge, agree and consent that:

- (a) My insurer, my workshop and the General Insurance Association of Singapore ("GIA") may/are permitted to collect, use, disclose and/or process my personal data/personal information set out in this [form] and any other personal information provided by me or possessed by my insurer (collectively the "Personal Information") and disclose and transfer such Personal Information to all insurer(s) who have insured vehicle(s) involved in this accident (all insurer(s) who have insured vehicle(s) involved in this accident shall be collectively referred to as the "Insurers"), the insurers' lawyers/law firms, the Monetary Authority of Singapore and any relevant government agency/authority (such as the police), for the purpose(s) of:
  - (i) processing, handling and/or dealing with my claims including the settlement of the claims and any necessary investigations relating to the claims;
  - (ii) investigating the accident and/or my claims;
  - (iii) carrying out and/or dealing with my instructions or responding to any enquiries by me;
  - (iv) administering my claims (including the mailing of correspondence, statements, invoices, reports or notices to me, which could involve disclosure of certain personal data about me to bring about delivery of the same as well as on the external cover of envelopes/mail packages); and/or
  - (v) complying with applicable law in administering, processing, handling and/or dealing with my claims (collectively the "Purposes")
- (b) all insurer(s) who have insured vehicle(s) involved in this accident and the insurers' lawyers/law firms, may/are permitted to collect, use, disclose and/or process my Personal Information for one or more of the above Purposes; and
- (c) my Personal Information may/can be disclosed by any of the Insurers and/or GIA to their third party service providers or agents (including their lawyers/law firms), which may be sited outside of Singapore, for one or more of the above Purposes.
- (d) my Personal Information will also be collected and used to compile claims history for the purpose of fraud detection, investigation and management in present and all future claims.
- (e) the information so collected under (d) above may be shared / disclosed:
  - (i) to all insurers and/or any other third parties that assist in evaluating, investigating, controlling or managing fraud, regulators, law enforcement and government agencies as reasonably required for the purposes stated, or
  - (ii) for complying with requirements under any regulations, laws or court orders.

金樺  
CHIN HWA COURIER SERVICES  
Bk 3014 Ubi Road 1  
#02-318 Singapore 408702  
HP: 9838 7027

Policyholder's Signature  
Date & Time:

  
Driver's Signature  
(If driver is not the policyholder)  
Date & Time:

  
Reporting Centre Personnel's Signature  
Name:  
NRIC/FIN No.:

## Accident Sketch Plan

### SKETCH PLAN

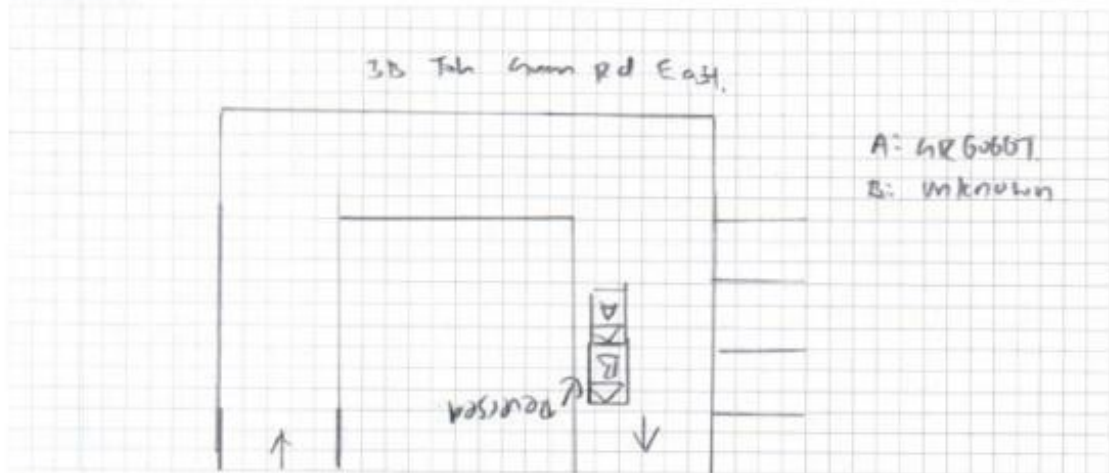

### DESCRIBE CIRCUMSTANCES OF THE ACCIDENT

refer to statement.

### DECLARATION

I/We declare the foregoing particulars are true in every respect.

金樟  
CHIN HWA COURIER SERVICES  
Bk 3014 Ubi Road 1  
Singapore 408702  
HP: 9858 7027

Policyholder's Signature  
Date & Time:

Driver's Signature  
(If driver is not the policyholder)  
Date & Time:

Reporting Centre Personnel's Signature  
Name:  
NRIC/FIN No.:

Accident Photo





Accident Photo



Accident Photo



Accident Photo





Accident Photo



**Accident Photo**



Accident Photo



Accident Photo



Accident Photo





**Accident Photo**



Accident Photo



Accident Photo

