

ASS. REC. BY:

REF: CS/MSL18022259/R1662

Special Instruction:

Surveyor

Rogul

ASSIGNMENT (Office)

Melimen

From (Person):

Christine Wang

of

MSL1

Date/Time:

11/22/18 934am

Estimated Cost:

Bill to:

OD / TP / WS / TP RES / OD RES / EVA / INV / MV / CS

To Inspect Vehicle No:

SL 58056

Insured:

SL 82177

at Workshop m/s

Performance

Tel:

of

303 Alexandra Rd

Policy No:

A29069766MKF

Claim No:

575874

Sum Insured:

Excess:

Make of Veh:

D.O.A.

06/12/18

(Client's Record)

CA / REV / REP. / REV 24 HRS WP

H.O.D. Endorsement:

Date/Time:

11/22/18 1009am

Person Contacted:

Cwline

Vehicle: IN/OUT

Date/Time	Action/Instruction (✓) Estimate
	SL 58056 - X
	SL 82177 - X
13/12/18	@ 15:29 p.m. revised IA to Christine Wang v's owner.

Signature

REF:

65192

ASSIGNMENT

From: Date: Estimated Cost:

OD / TP / WS / TP RES / OD RES / EVA / INV / MV

To inspect Vehicle No: SLL 5805G

at Workshop m/s: PERFORMANCE

of Mark Insured

Policy No.

Claims No.

Sum Insured Excess:

(Client's Record)

Make of Veh

(Policy Condition)

Remark: The veh had commenced its repair at the time of inspection.

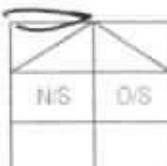

Bal. or Market Value:

IDAC Accident Rpt. Consistent? : Yes or No

GIA / PR Seen Consistent? : Yes or No

Est. Repairs days Res: Yes or No

Lump Sum: % 3 Val: Yes or No

CA / REV / REP. / 24 HRS up

Date: Person Contacted:

Vehicle: IN / OUT

Van No: SLL 5805G Yr Regn: 2017 MAR Type: M. Car / M. Cycle / Bus / Van / Lorry / Taxi / Prime Mover /

Truck / Trailer or

Make: B.M.W X6 DRIVE 35I cc: 2579

Colour: WHITE A/C Insured / Std / NI / NA

Sp. Reading: 20584 T/Radio: Insured / Std / NI / NA

Eng/No:

C.No: WBAKU 220200P55881

Gen. Cond: Good / Fair / Poor / Burnt

Steering: in order / Jammed / Leaked / Burnt or

Brake: in order / Jammed / Leaked / Burnt or

Modi: Nil / S/Rim / STD A/Rim or

Tyre Size: F: 255/50 R19

R:

BS / DUN / EXNOVA / GY / FS / LIZA / MIC / OHTSU / PIP / SUMI /

TOYO / YOKO or

Front

Rear

R/Bal: 6 mm R/Bal: 6 mm

L/Bal: 6 mm L/Bal: 6 mm

D.O.A: 06/11/18 D.O.I: 11/12/18

Survey held at: PERFORMANCE

Des. of Damages: Frt / Rear / O/S / N/S / U/C / Rooftop or

FRONT

The U/C / Chassis frame / Body Structure affected due to collision

Date / Time Action / Instruction

31/01/19 Confirmed P/R \$4,834.10 @ 4 days with Resul (\$2,435.15 Red - 34%)

RECEIVED 31 JAN 2019

Date/Time: File Pass to:

☐

: Preli. Report

11

☐

: Final Report

Date/Time: File Return to:

12

Days Of Repair:

Resurvey No. of Trip:

Survey Fee:

Transportation

1. S + P + M

2. Stress

3. Other

4. ...

TOTAL

Add Fee: ☐ Site Insp: \$

☐ Interview: \$

☐ Tech. Insp: \$

☐ Weekend: \$

Report Format:

Lump Sum / L.B.L: \$

150

10

160

...CLAIM SUBFOLDER...(New Assignment)

CLAIM SUBFOLDER TRACKING							
Case	Notified	Est Submitted	Adj Assigned	Adj Rpt	Adj Submitted	Ins Auth'd	Status
Main	14 Nov 2018		11 Dec 2018 09:34 Assign				New Assignment Cancel Case

Main	Reference	Claim Details	Documents	Show All					
CLAIM SUBFOLDER DETAILS [Created by insurer]									
Insured:	GRAB RENTALS PTE LTD, Co. Reg. No.: 201617200G								
Main Claimant:	WONG NEE SIONG, ID: S1830919Z								
Vehicle Reg. No.:	SLL5805G	Date of Loss:	06/11/2018 14:00 - :59 [20 Months and 5 Days From LTA Reg Date (Man Yr)]						
Claim Type:	TP / 575874	Policy/Cover Note No.:	A29069766MKF (Comprehensive) Coverage: 01/02/2018 - 31/01/2019						
Vehicle Reg. No. (Insured):	SLS8217Y	Policy No. (Claimant):							
		Excess:							
Repairer:	Performance Motors Limited (Alexandra) 303 Alexandra Road, Sime Darby Performance Centre, 159941 Alexandra - Tel: 63190172/63190174								
Handling Insurer:	MSIG Insurance (Singapore) Pte. Ltd. (HQ) - Tel: +65 6827 7888 ... [Handled by Christina Wong - 6543 1311]								
Adjuster:	LKK Auto Consultants Pte Ltd (HQ) - Tel: 6256-3561 ... [Imm.Advice due 12/12/2018]								
Driver/Custodian (Insured):	ANG BOK LEONG (), NRIC: S7171104H, Tel: +6591872414								
Adj Asg. Remarks:	Survey today (11/12/18), Owner leaving car in for survey + repair by 10am. Liability unclear. Contact Person: Caroline / 6319 0174.								
ASSOCIATED MAIL RECEIVED View All Compose Case Mail									
There are no mail for this case.									
ALL ASSOCIATED TASKS View All Search Tasks Create New Task Complete 									
Due Date	Priority	Type	Task Group	Subject	Handler	Assigned By	Completed On	Created On	Done?
No results.									

Shirley Hiew (LKK Auto)

From: Rasul (LKKAuto) <Rasul@lkkauto.com>
Sent: Monday, 28 January 2019 10:18 AM
To: PBSP
Cc: Shirley Hiew (LKK Auto)
Subject: RE: FINAL REPORT / SLL5805G

Hi Caroline,

Finalised amount confirmed

Best Regards,

Rasul | Assessor

LKK Auto Consultants Pte Ltd

Phone: 6256-3561 | email: Rasul@lkkauto.com | fax: 6841-4315

Blk 51, Paya Ubi Industrial Park, Ubi Avenue 1, #02-25 | S(408933)



Rasul
Consultants
Pte Ltd

Save the Earth. Print only when necessary.

From: PBSP [mailto:pml-pbsp@sime-darby.com.sg]
Sent: Tuesday, 15 January, 2019 1:08 PM
To: Rasul (LKKAuto); SUR
Subject: FINAL REPORT / SLL5805G

Dear Sirs

We refer to the above and attached Final Report.

Please confirm COR as follows:

Total Labour : 2,097.00

Total Parts : 2,737.10

Total Labour & Parts : 4,834.10

Repair days: 4

Thank you.

Regards,
Caroline

C/o Performance Motors Limited - Body and Paint

303 Alexandra Road Singapore 159941

DID: 6319 0174 Fax: 6479 4601

"This electronic mail content and any accompanying attachments ("the Message") is intended only for the named addressee ("the Recipient") and may contain information that is confidential, privileged and/or proprietary to the Sime Darby group of companies ("Sime Darby") and/or protected under applicable laws. If you are not the intended Recipient, you are strictly prohibited from using, disseminating, forwarding and/or printing the Message. Please notify the sender immediately by return e-mail and permanently delete

all copies of the Message. Sime Darby disclaims all liability for any error, loss or damage arising from the Message being infected by computer virus or other malicious software. Any views and/or opinions expressed in the Message are solely those of the author's and do not necessarily represent those of Sime Darby's."

Veron Chen (LKKAUTO)

From: PBSP <pml-pbsp@simedarby.com.sg>
Sent: Tuesday, 22 January 2019 6:29 PM
To: Rasul (LKKAUTO); SUR
Subject: Re: FINAL REPORT / SLL5805G
Attachments: SKM_558e19012218260.pdf

Dear Rasul

The HOLDER CAMERA SYSTEM(I-CAM) is a necessary item to be replaced when there's replacement of the front bumper.

Please see attached diagrams.

Kindly confirm COR soonest.

Thank you.

Regards,
Caroline
C/o Performance Motors Limited - Body and Paint
303 Alexandra Road Singapore 159941
DID: 6319 0174 Fax: 6479 4601

From: Rasul (LKKAUTO) <Rasul@lkkauto.com>
Sent: Wednesday, 16 January 2019 10:58:08 AM
To: PBSP; SUR
Subject: RE: FINAL REPORT / SLL5805G

Hi Caroline,

Kindly forward to me the check item damage photos for HOLDER CAMERA SYSTEM(I-CAM). Is this item consistent to accident?

Best Regards,

Rasul | Assessor

LKK Auto Consultants Pte Ltd

Phone: 6256-3561 | email: Rasul@lkkauto.com | fax: 6841-4315

Blk 51, Paya Ubi Industrial Park, Ubi Avenue 1, #02-25 | S(408933)



Auto
Consultants
Pte Ltd

Save the Earth. Print only when necessary.

From: PBSP [mailto:pml-pbsp@simedarby.com.sg]
Sent: Tuesday, 15 January, 2019 1:08 PM
To: Rasul (LKKAUTO); SUR
Subject: FINAL REPORT / SLL5805G

Dear Sirs

We refer to the above and attached Final Report.

Please confirm COR as follows:

Total Labour : 2,097.00

Total Parts : 2,737.10

Total Labour & Parts : 4,834.10

Repair days: 4

Thank you.

Regards,

Caroline

C/o Performance Motors Limited - Body and Paint

303 Alexandra Road Singapore 159941

DID: 6319 0174 Fax: 6479 4601

"This electronic mail content and any accompanying attachments ("the Message") is intended only for the named addressee ("the Recipient") and may contain information that is confidential, privileged and/or proprietary to the Sime Darby group of companies ("Sime Darby") and/or protected under applicable laws. If you are not the intended Recipient, you are strictly prohibited from using, disseminating, forwarding and/or printing the Message. Please notify the sender immediately by return e-mail and permanently delete all copies of the Message. Sime Darby disclaims all liability for any error, loss or damage arising from the Message being infected by computer virus or other malicious software. Any views and/or opinions expressed in the Message are solely those of the author's and do not necessarily represent those of Sime Darby's."

Display of Diagrams - Retrofittings not taken into account - filtered

0P55881 KU22 WA96 LCRI X6 F16 SAC X6 35iX ECE R A 2016/10 51_9709 Trim panel, front



Filter ▾

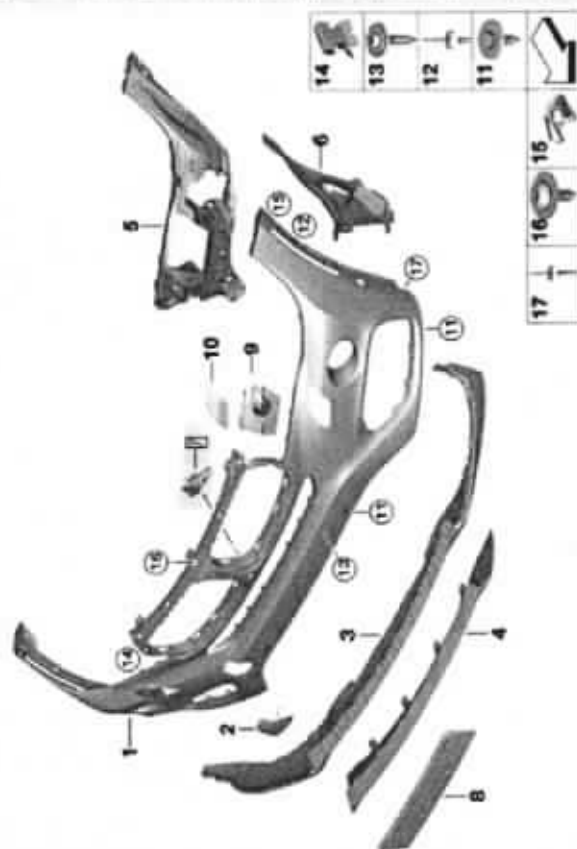

Yes	No	??	Code	Description
<input checked="" type="radio"/>	<input type="radio"/>	<input type="radio"/>	S502A	Headlight cleaning system
<input checked="" type="radio"/>	<input type="radio"/>	<input type="radio"/>	S508A	Park Distance Control (PDC)
<input checked="" type="radio"/>	<input type="radio"/>	<input type="radio"/>	S552A	Adaptive LED headlight
<input checked="" type="radio"/>	<input type="radio"/>	<input type="radio"/>	S5A1A	LED Fog lights
<input type="radio"/>	<input checked="" type="radio"/>	<input type="radio"/>	P5A3A	BMW Night Vision with Dynamic Lig
<input type="radio"/>	<input type="radio"/>	<input checked="" type="radio"/>	S5DLA	Surround View
<input type="radio"/>	<input checked="" type="radio"/>	<input type="radio"/>	S5DPA	Park Assist

Part Number Quantity N

To Parts List New list ▾ ✓ Add

« MG

MG »

« D

D »

Nr	Description	Supplement	Me	Von	Bis	Kat	Ge	Le	Part Number	AE	Z
07	Holder, camera system Necessary for repair	I-CAM	1						51 11 7 352 236		
--	Clamp		1						07 14 7 213 398		
08	Licence plate holder	ECE	1						51 11 7 319 791		

Display of Diagrams - Retrofittings not taken into account - filtered

0P55881 KU22 WA96 LCRI X6 F16 SAC X6 35X ECE R A 2016/10: 51_9709 Trim panel, front



Filter ▾

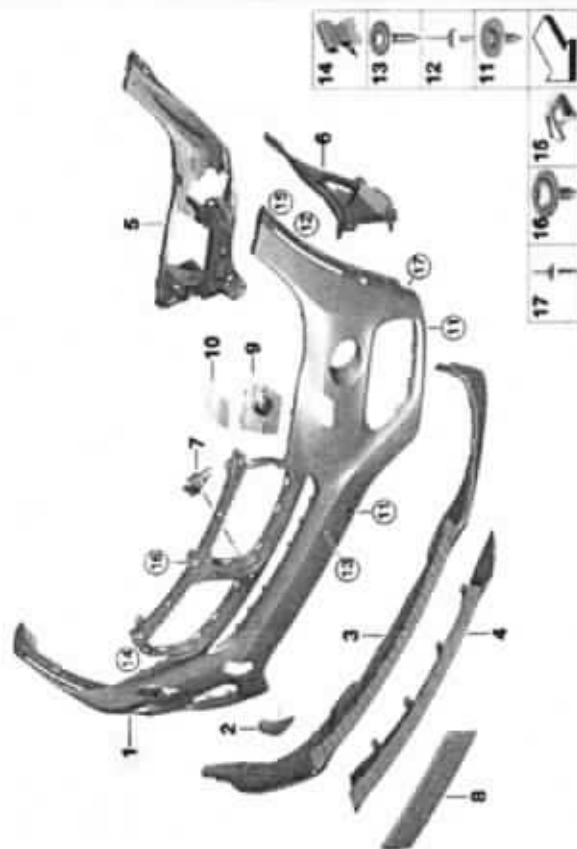

Yes	No	??	Code	Description
<input checked="" type="radio"/>	<input type="radio"/>	<input type="radio"/>	S502A	Headlight cleaning system
<input checked="" type="radio"/>	<input type="radio"/>	<input type="radio"/>	S508A	Park Distance Control (PDC)
<input checked="" type="radio"/>	<input type="radio"/>	<input type="radio"/>	S552A	Adaptive LED headlight
<input checked="" type="radio"/>	<input type="radio"/>	<input type="radio"/>	S5A1A	LED Fog lights
<input type="radio"/>	<input type="radio"/>	<input type="radio"/>	P5A3A	BMW Night Vision with Dynamic Lig
<input checked="" type="radio"/>	<input type="radio"/>	<input type="radio"/>	S5DLA	Surround View
<input type="radio"/>	<input checked="" type="radio"/>	<input type="radio"/>	S5DPA	Park Assist

Part Number Quantity N

To Parts List New list ▾ ✓ Add

« MG » MG » « D » D »

Nr	Description	Supplement	Me	Von	Bis	Kat	Ge	Le	Part Number	AE	Z
01	Panel, bumper, primed, front only in conjunction with	SRA/PDC	1						51 11 7 422 898		
—	Adhesive set K5	SET	1						83 19 2 317 925		
—	Holder, camera system	I-CAM	1						51 11 7 352 236		
—	Clamp		16						07 14 9 241 763		

LKK Auto Consultants Pte Ltd (Co.Reg.No:199607198R)

51 Ubi Ave 1 #01-25, Paya Ubi Industrial Park

Singapore 408933

Tel: 6256-3561 Fax: 6844-8805 Email: sur@lkkauto.com; assignments@lkkauto.com

To: MSIG Insurance (Singapore) Pte. Ltd.
4 Shenton Way
#21-01 SGX Centre 2
Singapore 068807

From: LKK Auto Consultants Pte Ltd
51 Ubi Ave 1 #01-25
Paya Ubi Industrial Park
Singapore 408933

Attn: Christina Wong

Date: 13 Dec 2018

Preliminary Advice

Insured Vehicle No	: SLS8217Y		
TP Vehicle No	: SLL5805G	Accident Date	: 06/11/2018
Make	: BMW X6 XDRIVE	Assignment Date	: 11/12/2018
Date of Inspection	: 11/12/2018	Est. Duration of Repair	: 3 days
Inspection At	: Performance Motors Limited (Alexandra) 303 Alexandra Road, Sime Darby Performance Centre Singapore 159941		

Point of Impact / General Description of Damages

The vehicle sustained impact / damages front n/s portion and parts claimed are consistent to the accident.

Repairer's Estimate (Gross)	:S\$	7,253.25
Revised Amount	:S\$	4,351.40
Check Items (Estimated)	:S\$	2,197.65
Total	:S\$	6,549.05

Lump Sum Repair	:S\$
-----------------	------

Total Loss Consideration

New for Old Value	:S\$
Pre-Accident Value	:S\$
COE / PARF Rebate	:S\$
Salvage Value	:S\$
Margin for Repair	:S\$

Remarks

() The vehicle is economical/not economical for repair.

(X) The above survey was conducted on a 'without prejudice' basis.

SINGAPORE ACCIDENT STATEMENT

IMPORTANT NOTICE

1. Please report correctly the details of the accident to speed up the claims process.
2. This Form must be completed by the Policyholder and/or the Authorised Driver.
3. Information provided must be as truthful and accurate as possible. Any wilful misrepresentation or withholding of material facts may allow insurance companies to repudiate policy liability.
4. The issue and acceptance of this Form by insurance companies is not an admission of policy liability on the part of the insurance companies.
5. Any false reporting may be referred to the Police for investigation.
6. This report will be forwarded by the insurers of the GIA Records Management Centre established by the General Insurance Association of Singapore (GIA) for archiving and that copies of this report will, for a fee, be made available upon application by interested parties.
7. By the lodgement of this report to the insurers, you hereby consent to the archiving of this report at the centre and to copies of the report being made available aforesaid.

ACCIDENT STATEMENT

Date Of Report	07/11/2018 18:30
Date Of Accident	06/11/2018 14:55
Exact Location Of Accident	MEI LING STREET
Country/State of Loss	SINGAPORE

DETAILS OF OWN VEHICLE

Vehicle Registration Number	SLL5805G
Insured/Policyholder	
Name Of Registered Owner	WONG NEE SIONG
NRIC No	S1830919Z
Email Address	SIMONWONG@GUTHRIE.COM.SG
Mobile Phone No	(LOCAL) +65-97630270
Alternative Phone No	OTHERS-97630270

Vehicle Particulars

Manufacturer	BMW
Model	X6 35i
Exact Purpose for which vehicle was being used at time of accident	NORMAL USAGE
Are you claiming under your own insurance policy for repair to your vehicle?	NO
If No, Please state action to be taken	THIRD PARTY
Vehicle Category	PRIVATE CAR

Insurance Company

Name of Insurance Company	AXA INSURANCE PTE LTD
Type Of Coverage	COMPREHENSIVE
Fleet Policy	NO
Policy Number	CN882505
Cover Note Number	

Driver

Name of Driver	WONG NEE SIONG
NRIC No	S1830919Z
Date Of Birth	29/04/1967
Occupation	INDOOR
Date Of Driving Pass	31/10/1992
Driving Experience	26 YEARS AND 0 MONTHS
Gender	MALE
Mobile Number	(LOCAL) +65-97630270
Fax Number	
Contact Number	OTHERS-97630270
Email Address	SIMONWONG@GUTHRIE.COM.SG

Address	BLK 150 MEI LING STREET #02-63
Postcode	141150
Was driver an employee of the Insured's Company	NO
If No, Relationship of the Driver with the Insured	OWNER
Vehicle Registration Number of Driver's Own Vehicle	-
	-
	-
Insurance Company of Driver's Own Vehicle	-
	-
	-

General Information of the Accident

Type Of Accident	COLLISION - HEAD TO REAR
Weather Conditions	CLEAR
Road Surface	DRY

Other Information

Was any foreign vehicle involved in this accident?	NO
Number of vehicles involved in the accident	2
Was any body injured in the Accident?	NO
Was any injured conveyed to hospital by ambulance?	NO
Was any other material or property damaged?	YES
I have been approached by unknown person(s) soliciting/offering accident claims assistance.	NO
Number of Passengers (Including Driver)	4
Passenger 1	NAME: : LIM BEE TING GENDER: : FEMALE
Passenger 2	NAME: : CLAIRE WONG GENDER: : FEMALE
Passenger 3	NAME: : GRACE WONG GENDER: : FEMALE

Details of Police Action

Was the accident reported to the police?	NO
If Yes, Please state which Police Station	
Was notice of intended Prosecution given?	NO
If Yes, against whom?	

Circumstances of Accident

REFER TO ATTACH.

Attachment(s)

Are accident photos available for attachment?	YES
Was there any video captured by Car Camera?	YES
Remarks/ Reasons:	FILE TOO BIG-BURN CD
Was there any audio recorded?	NO

DETAILS OF OTHER VEHICLE PROPERTY 1

Vehicle Registration Number	SLS8217Y
Vehicle Make/Model/Colour	HONDA VEZEL
Details Of Properties	
Vehicle Category	PRIVATE CAR
Name of Driver	ANG BOK LEONG
NRIC/Passport Number	S7171104H

Contact Number	91572414
Address	BLK 540 JURONG WEST AVE 1 #03-1092
Postcode	640540
Insurance Company Name	
Nature Of Damage	FRONT
No. Of Passenger (Including Driver)	1

SKETCH PLAN

IMPORTANT NOTICE

1. Please report correctly the details of the accident to speed up the claims process.
2. This Form must be completed by the Policyholder and/or the Authorised Driver.
3. Information provided must be as truthful and accurate as possible. Any wilful misrepresentation or withholding of material facts may allow insurance companies to repudiate policy liability.
4. The issue and acceptance of this Form by insurance companies is not an admission of policy liability on the part of the insurance companies.
5. Any false reporting may be referred to the Police for investigation.
6. The report will be forwarded by the insurers of the GIA Records Management Centre established by the General Insurance Association of Singapore (GIA) for archiving and that copies of this report will for a fee be made available upon application by interested parties.
7. By the lodgment of this report to the insurers, you hereby consent to the archiving of this report at the centre and to copies of the report being made available aforesaid.
8. **Consent under the Personal Data Protection Act (PDPA)**

I understand, acknowledge, agree and consent that:

- (a) My insurer, my workshop and the General Insurance Association of Singapore ("GIA") may/are permitted to collect, use, disclose and/or process my personal data/personal information set out in this [form] and any other personal information provided by me or possessed by my insurer (collectively the "Personal Information") and disclose and transfer such Personal Information to all insurer(s) who have insured vehicle(s) involved in this accident (all insurer(s) who have insured vehicle(s) involved in this accident shall be collectively referred to as the "Insurers"), the Insurers' lawyers/law firms, the Monetary Authority of Singapore and any relevant government agency/authority (such as the police), for the purpose(s) of:
 - (i) processing, handling and/or dealing with my claims including the settlement of the claims and any necessary investigations relating to the claims;
 - (ii) investigating the accident and/or my claims;
 - (iii) carrying out and/or dealing with my instructions or responding to any enquiries by me;
 - (iv) administering my claims (including the mailing of correspondence, statements, invoices, reports or notices to me, which could involve disclosure of certain personal data about me to bring about delivery of the same as well as on the external cover of envelopes/mail packages); and/or
 - (v) complying with applicable law in administering, processing, handling and/or dealing with my claims (collectively the "Purposes")
- (b) all insurer(s) who have insured vehicle(s) involved in this accident and the insurers' lawyers/law firms, may/are permitted to collect, use, disclose and/or process my Personal Information for one or more of the above Purposes; and
- (c) my Personal Information may/can be disclosed by any of the Insurers and/or GIA to their third party service providers or agents (including their lawyers/law firms), which may be sited outside of Singapore, for one or more of the above Purposes.
- (d) my Personal Information will also be collected and used to compile claims history for the purpose of fraud detection, investigation and management in present and all future claims.
- (e) the information so collected under (d) above may be shared / disclosed:
 - (i) to all insurers and/or any other third parties that assist in evaluating, investigating, controlling or managing fraud, regulators, law enforcement and government agencies as reasonably required for the purposes stated, or
 - (ii) for complying with requirements under any regulations, laws or court orders.

 Policyholder's Signature
 Date & Time:

7/11/18
 1730 hww

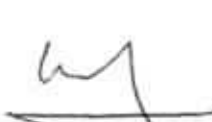
 Driver's Signature
 (If driver is not the policyholder)
 Date & Time:

7/11/18
 1730 hww

 Reporting Centre Personnel's Signature
 Name:
 NRIC/FIN No.:

SKETCH PLAN

ON 6/11/18, 1452 HRS. Both (A) & (B) entered carpark
barrier. (B) reversed and hit front end of (A). Please see
video recording from (A).

(A) : SLL 58056

(B) : SLS 8217 Y

DESCRIBE CIRCUMSTANCES OF THE ACCIDENT

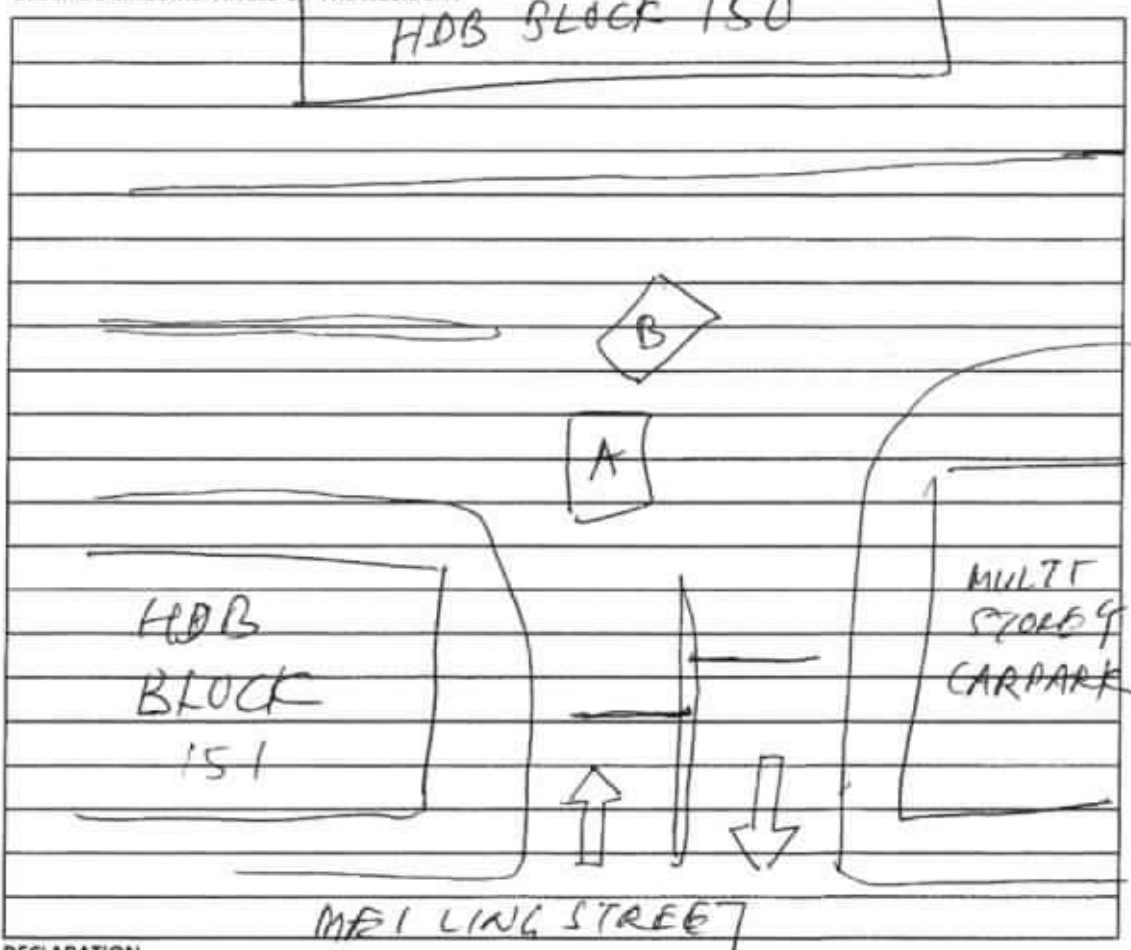

DECLARATION

I/We declare the foregoing particulars are true in every respect.

Policyholder's Signature

Date & Time:

7/11/18
1730 hours

Driver's Signature

(If driver is not the policyholder)

Date & Time:

7/11/18
1730 hours

Reporting Centre Personnel's Signature

Name:

NRIC/FIN No.:

Mon 10/12 @ 10AM

SLL5805G

Tues 11/12 @ 10AM

S&R change to

S&R

BMW Dealer

Performance Motors Limited

A member of the Sime Darby Group

Co. Reg. No. 197401559W GST Reg. No M2-0020081-X



103, Alexandra Road
Sime Darby Performance Centre
Singapore 159941
Tel. 63190100 (Sales & Admin)
63190111 (AfterSales)
Fax. 64747770

280, Kampong Arang Road
East Coast Centre
Singapore 438180
Tel. 63190888 (AfterSales)
Fax. 63449773

315, Alexandra Road
Sime Darby Business Centre
Singapore 159944
Tel. 63190528 (AfterSales)
63190533/530 (Motorrad)
Fax. 64796601 (AfterSales)
64796624 (Motorrad)

GST REG. NO : M2 - 0020081 - X

08 NOV 2018

ESTIMATE

Estimate No. : b1 49042
Date Estimated : 08/11/2018
Prepared By : Han Kwan Yong

Page No. : 1 of 5

- ESTIMATE REPAIR FOR -

Wong Nee Siong
Blk 150 Mei Ling Street
#02-63

Singapore 141150

- ACCOUNT - 40000

Cash Sales - Service
Singapore

REGN. NO.	CHASSIS NO.	REGN. DATE	MODEL	MILEAGE
SLL5805G	0P55881	01/03/2017	X6 xDrive35i	0

DESCRIPTION

VALUE

To replace front bumper & attachments including to knock out
dent area caused by the accident

850 1,275.00

To respray front bumper

934 1,088.00

To check electrical wiring systems at the front section
for proper function including adjustments of headlights.

150 17.00

To supply front emboss number plate.

81 83.00

Sundries.

80 40.00

Total Labour 1: 2,613.00

DESCRIPTION

QTY PRIC

VALUE

BODY NUT

10 0.90

Xm 9.00

BLIND RIVET

4 2.95

Xm 11.80

BLIND RIVET

20 30 2.95

59 88.50

BLIND RIVET

4 1.15

Xm 4.60

CLAMP

20 16 1.60

32 25.60

FRT BUMPER CARRIER

1 529.55

529.55

GRILLE MIDDLE TOP OPEN

1 107.20

107.20

FRT SHOCK ABSORBER

1 87.35

87.35

GRILLE SIDE CLOSED LH

1 93.85

93.85

LICENCE PLATE HOLDER ECE

1 69.25

69.25

FRT BUMPER CLADDING

1 225.75

225.75

FRT BUMPER LH INSERT (NIVI)

1 80.85

80.85

LH HOLDER HEADLIGHT CLEANING

1 21.10

21.10

FRT BUMPER COVER

1 161.25

161.25

LH AIR CHANNEL

1 52.80

52.80

TRIM GRILLE SIDE LH

1 66.15

66.15

HOLDER CAMERA SYSTEM (I-CAM)

1 33.60

33.60

FRT BUMPER PANEL PRIMED (SRA/PDC)

1 1,592.50

1,592.50

LH HEADLIGHT WASHER SYSTEM C

1 57.10

57.10

LH ORNAMENTAL GRILLE BASIC

1 148.20

148.20

RH ORNAMENTAL GRILLE BASIC

1 148.20

148.20

Performance Motors Limited

A member of the Sime Darby Group

Co. Reg. No. 197401559W GST Reg. No M2-0020081-X



303, Alexandra Road
Sime Darby Performance Centre
Singapore 159941
Tel. 63190100 (Sales & Admin)
63190111 (AfterSales)
Fax. 64747770

280, Kembangan Road
East Coast Centre
Singapore 438180
Tel. 63190888 (AfterSales)
Fax. 63449773

315, Alexandra Road
Sime Darby Business Centre
Singapore 159944
Tel. 63190528 (AfterSales)
63190533/330 (Motorrad)
Fax. 64796601 (AfterSales)
64796624 (Motorrad)

GST REG. NO : M2 - 0020081 - X

ESTIMATE

Estimate No. : b1 49042
Date Estimated : 08/11/2018
Prepared By : Han Kwan Yong

Page No. : 2 of 5

REGN. NO.	CHASSIS NO.	REGN. DATE	MODEL	MILEAGE
SLL5805G	0P55881	01/03/2017	X6 xDrive35i	0

DESCRIPTION	QTY	PRIC	VALUE
COOLING AIR DUCT ? x sm	1	316.60	316.60
# LH BRAKE AIR DUCT ? DG	1	55.45	55.45
# LH SPRAY NOZZLE ? x ca	1	183.80	183.80
LH FOG LIGHT LED ? x sm	1	417.15	417.15
(DG/SL) ADHESIVE SET K6	1	53.05	53.05

Total Parts : 4,640.25

LKK Auto Consultants hence notify the Repairer of the following:

- To resurvey before/after spray painting
- To display damaged part(s) during resurvey
- Parts prices are subject to confirmation
- Third party survey is on a "Without Prejudice" basis
- No illegal modification(s) is allowed
- Supplementary item(s) must be resurveyed and is subject to final approval from Insurance Company

Acknowledged by Repairer
Signature:
Date:

Claims OD / 3rd Party / Uninsured losses / Direct Settlement

Regn No. _____ Claim No. _____

Date & Time 11/12/18 @ 1355 Excess S\$ _____

Surveyor's Name Raul Sign _____

Surveyor's Tel 90010068 Authorised Yes / No _____

Authorised Date _____ Time _____

RESURVEY PARTS PHOTO BY SURVEYOR Yes / No PML Yes / No _____

Surveyor's E-mail _____

No. of Working Days Recommend 3 days + 1 day = 4

4 days

Labour 1	:	2,613.00
Parts	:	4,640.25
Labour 2	:	0.00
Excess	:	0.00
Total GST @ 7%	:	507.73
Grand Total	:	7,760.98

** THIS ESTIMATE IS VALID FOR A PERIOD OF 30 DAYS ONLY **

** PRICE FOR PARTS ARE SUBJECTED TO CHANGE WITHOUT PRIOR NOTICE **



303, Alexandra Road
Sime Darby Performance Centre
Singapore 159941
Tel. 63190100 (Sales & Admin)
63190111 (AfterSales)
Fax: 64747770

280, Kembangan Road
East Coast Centre
Singapore 438180
Tel. 63190888 (AfterSales)
Fax: 63449773

319, Alexandra Road
Sime Darby Business Centre
Singapore 159944
Tel. 63190528 (AfterSales)
63190533/530 (Motorrad)
Fax: 64796601 (AfterSales)
64796624 (Motorrad)

GST REG. NO : M2 - 0020081 - X

E S T I M A T E

Estimate No. : **b1 49042**
Date Estimated : **08/11/2018**
Prepared By : **Han Kwan Yong**

Page No. : **3 of 5**

REGN. NO.	CHASSIS NO.	REGN. DATE	MODEL	MILEAGE
SL5805G	0P55881	01/03/2017	X6 xDrive35i	0

Terms & Conditions of Service

- All requests for servicing, repairs, replacements or installations to the Vehicle (collectively, "Repairs") are subject to acceptance by Performance Motors Limited ("PML") and PML shall have the absolute discretion to reject or deny any request for the Repairs.
- The list of the Repairs or quantum of charges for the Repairs printed overleaf are estimates only and PML shall be entitled to carry out additional repairs or replacements ("Additional Works") if, in its absolute discretion, Additional Works are necessary provided that, where the cost of additional Works exceed S\$250, PML shall obtain the customer's prior consent (whether given orally or otherwise) before carrying out the additional Works.
- Subject to clause 2 above and save in the case of manifest error or gross negligence, in the event where PML's estimation of the Repairs recommended for the Vehicle differs from the Customer's own estimation of repairs needed, PML's estimate shall prevail.
- The Vehicle accepted by PML for the Repairs shall remain, at all times, at the Customer's own risk while the Vehicle undergoes the Repairs at PML's premises. PML's visual inspection and record of the physical condition of the Vehicle made prior to the commencement of the Repairs shall be binding and conclusive as between PML and the Customer. The Customer shall ensure that all valuables are removed from the Vehicle prior to delivering it to PML for the Repairs. PML shall not be liable, in any way, for theft, fire, accident, loss of or damage to the Vehicle, its contents or accessories whatsoever.
- The Vehicle may be driven on the road if and when PML, in its absolute discretion, decides that it is necessary for the purposes of carrying out tests in connection with the Repairs. Should any damage occur to the Vehicle in such an instance, PML's liability will be limited to the rectification of damage, free of charge.
- PML's entire liability whether, in respect of faulty workmanship or otherwise, shall be limited to the rectification of any faulty workmanship or other faults, free of charge, such faults being reasonably determined by PML to have been caused by PML in the course of the Repairs. The Customer shall, nevertheless, be responsible for all costs for the disassembly, diagnosis, inspection of the Vehicle etc., at PML's current labour charge-out rate, necessarily incurred for the purpose of determining the cause of the fault(s) if it is found that the fault(s) is or are not caused by PML.
- Except as provided in clause 6 above, PML makes no warranty (whether expressed or implied) in respect of the Repairs and shall not, to the fullest extent permitted by law, be liable under any circumstances for special, consequential or incidental damages including but not limited to the loss of use of or depreciation in value of the Vehicle.
- Unless otherwise agreed by PML in writing, the Customer shall pay the costs of the Repairs owing to PML, in cash, upon the completion of the Repairs and before the Customer collects the Vehicle. In the event any credit is granted by PML at its absolute discretion, and the Customer fails to make payment of the costs of the Repairs (or any part thereof) by the agreed payment date, interest shall be imposed on the sum remaining unpaid at the rate of 1% per month (or part thereof) from the due date of payment until the date all payments are actually received by PML. PML reserves the right, at any time, to suspend or withdraw any credit facility granted to the Customer without assigning any reason whatsoever.
- The Customer shall collect the Vehicle within 48 hours from the date PML notifies the Customer, (whether orally or otherwise), that the Vehicle is ready for collection. In the event that the Customer fails to collect the Vehicle within 48 hours, the Customer shall, in addition to the costs of the Repairs owing to PML, pay all storage charges, at a rate to be determined by PML provided always that the Customer shall not, under any circumstances, hold PML liable for any loss of or damage to the Vehicle, its contents or accessories or for any deterioration in the quality of or damage to the Vehicle arising from such storage. In the event that the Customer fails to collect the Vehicle for more than 14 days, PML shall be entitled, at its absolute discretion, to dispose of the Vehicle & deduct, from the proceeds of disposal, PML's costs in connection with the disposal as well as all other monies owing to PML.
- If PML does not receive any notification of faulty workmanship from the Customer within 7 days from the date the Customer collects the Vehicle from PML, the Customer shall be deemed to have accepted the Repairs as satisfactory.
- If the Vehicle is sent to PML for the Repairs by any person other than the Customer, PML shall be entitled, without need to make any inquiry, to treat such third party as acting for and on the Customer's behalf. PML shall be entitled to rely on this ostensible authority to carry out the repairs in compliance with such third party's instructions and the Customer shall not hold PML liable for any loss or damage suffered by the Customer as a result and shall pay for the costs of the Repairs owing to PML and further indemnify PML against all claims, losses, expenses, damages suffered or incurred by PML arising from PML's reliance on such authority and/or compliance with such instructions.
- PML may, in its absolute discretion and upon the Customer's request, provide a driver to deliver the Vehicle from the Customer to PML's premises or vice versa provided always that the driver shall, during the time of such conveyance of the Vehicle, be deemed to be the servant of the Customer and not that of PML's and the Customer shall not hold PML liable for any accident, loss of or damage to the Vehicle or its contents or accessories while the same is under the custody of the driver.
- These Terms & Conditions of Service including all annexes and attachments hereto contains the entire agreement between PML and the Customer with respect to the Services described in the Repair Order and supersedes all previous agreements and understandings between PML and the Customer relating to the subject matter herein. No amendments or changes to these Terms & Conditions of Service shall be effective unless made in writing and signed by authorized representatives of both PML and the Customer.
- If any term or provision of these Terms & Conditions of Service shall be held to be invalid, illegal or unenforceable, the remaining terms and provisions of these Terms & Conditions of Service not affected by such invalidity, illegality or unenforceability shall remain in force and effect.

Performance Motors Limited

A member of the Sime Darby Group

Co. Reg. No. 197401339W GST Reg. No M2-0020081-X



103, Alexandra Road
Sime Darby Performance Centre
Singapore 159941
Tel. 63190100 (Sales & Admin)
63190111 (AfterSales)
Fax. 64747770

180, Kampong Arang Road
East Coast Centre
Singapore 438140
Tel. 63190888 (AfterSales)
Fax. 63449773

315, Alexandra Road
Sime Darby Business Centre
Singapore 159944
Tel. 63190528 (AfterSales)
63190533/530 (Motorrad)
Fax. 64796601 (AfterSales)
64796624 (Motorrad)

GST REG. NO : M2 - 0020081 - X

E S T I M A T E

Estimate No. : b1 49042
Date Estimated : 08/11/2018
Prepared By : Han Kwan Yong

Page No. : 4 of 5

REGN. NO.	CHASSIS NO.	REGN. DATE	MODEL	MILEAGE
SLL5805G	OP55881	01/03/2017	X6 xDrive35i	0

15. A person not party to these Terms & Conditions of Service shall have no right under any legislation for the enforcement of contractual terms by a third party (whether in force now or to be enacted in the future and as the same may be modified, adapted or supplemented from time to time) to enforce any term in these Terms & Conditions of Service.
16. The laws of the Republic of Singapore shall govern the validity and interpretation of these Terms & Conditions of Service and the Parties submit to the exclusive jurisdiction of the Courts of the Republic of Singapore.
17. The Sime Darby Motors Group companies in Singapore are committed to ensuring that your personal data is protected. The purpose of this document is to explain how we collect information about you, the procedures that we have in place to safeguard your privacy and how you can instruct us if you prefer to limit the use of that information.
- 17.1 The Vendor shall collect and use the Customer's personal data for any of the following purposes, including but not limited to:
- (a) the registration of the Vehicle with the relevant transportation authorities, including but not limited to Land Transport Authority;
 - (b) sharing of the Customer's personal data with the Vendor's principal, its related corporations and contractors, whether within Singapore or overseas, and/or insurance companies, so as to provide the necessary warranties and/or extended warranties for the Vehicle to the Customer;
 - (c) sharing of the Customer's personal data with financial institutions and motor vehicle insurers, on the Customer's behalf, in order for the Customer to obtain financing for the purchase of the Vehicle and the motor insurance on the Vehicle and when necessary, to obtain the loan amounts outstanding from financial institutions, on the Customer's behalf so as to assist the Customer in effecting the Vehicle loan redemptions;
 - (d) servicing of Vehicle and to update the Vendor's after-sales service records. The relevant personal data shall be used by the Vendor, its appointed after-sales service dealers, agents and sub-contractors and/or the Vendor's principal and/or its related corporations whether within or outside Singapore to provide the relevant after-sales service and/or to repair the Vehicle and to communicate with the Customer on any matter relating to the provision of the services in general including to notify the Customer by any means, including by short message services ("SMS") of the next/ subsequent date/mileage for routine service for the Vehicle;
 - (e) administrative, research and analysis purposes to enable it to monitor and improve the services it provides; and
 - (f) organizing events for the Customer, to inform the Customer of such events by any means (including through SMS, multi-media services ("MMS"), phone call, fax, magazines, or brochures) any new products, promotions or services provided by the Vendor in Singapore.
- 17.2 The Vendor shall also disclose the Customer's personal data:
- (a) to its service providers, for example, providers of web hosting or maintenance services, for the purpose of supplying itself with the inter connected servers and/or web site links with the relevant authorities;
 - (b) to its customer service agencies whether within or outside Singapore for administrative, research and analysis purposes to enable it to monitor and improve the services it provides;
 - (c) to the Vendor's service providers and/or the Vendor's principal, its related corporations and contractors whether within or outside Singapore for the purpose of organizing events for the Customer, to inform the Customer of and send to the Customer by any means (including through SMS, MMS, phone call, fax, magazine or brochures) any new products or promotions or services that are provided by the Vendor and/or the Vendor's principal whether within or outside Singapore;
 - (d) to the Vendor's business partners for the purpose of carrying out product promotions;
 - (e) to the Vendor's stakeholders and the Vendor's principal and its/their related corporations and contractors for the purpose of carrying out audits;
 - (f) to the Vendor's principal and/or the Vendor's stakeholders and their respective related corporations and contractors whether within or outside Singapore for the purposes of carrying out audits; and
 - (g) to the Vendor's principal and its related corporations whether located within or outside Singapore for the purpose of responding to any of the Customer's enquiries.
- 17.3 The Vendor shall retain the Customer's personal data either for the period of the business relationship or, for the requisite retention periods as stipulated in any contractual arrangements or under any applicable law, whichever is later.
- 17.4 If the Vendor amends any provision in this clause 17, it will notify the Customer via e-mail and may place notices on the Vendor's web site. The Vendor's email to the Customer shall require the Customer's consent to its change of use of the Customer's personal data. Continued use of the Vendor's services shall signify the Customer's agreement to any such changes.
- 17.5 The personal data the Customer provides may be transferred to the Vendor's principal within or outside Singapore for surveys and research purposes conducted with the objective of enhancing the Customer's satisfaction.
- 17.6 The Customer shall have a right to request a copy of the personal data the Vendor holds about the Customer and information about the ways in which the Customer's personal data has been or may have been used or disclosed within a year before the date the Customer's request. If the Customer wishes to exercise this right, the Customer shall complete the Vendor's prescribed form and/or:
- (a) put his request in writing and indicate whether he would like to have a copy of his personal data or he wishes to have information about the ways in which his personal data is used or disclosed during the past year or both;
 - (b) include proof of his identity and address (e.g. a copy of the Customer's driving licence and a recent credit card bill); and
 - (c) specify the personal data he wants access to, including any account or reference numbers where applicable.

The Vendor shall reply to the Customer as soon as reasonably possible upon its receipt of the Customer's request.



303, Alexandra Road
Sime Darby Performance Centre
Singapore 159941
Tel. 63190100 (Sales & Admin)
63190111 (AfterSales)
Fax. 64747772

280, Tampong Arang Road
East Coast Centre
Singapore 438180
Tel. 63190888 (AfterSales)
Fax. 63448773

115, Alexandra Road
Sime Darby Business Centre
Singapore 159544
Tel. 63190528 (AfterSales)
63190533/536 (Motorrad)
Fax. 64796601 (AfterSales)
64796624 (Motorrad)

GST REG. NO : M2 - 0020081 - X**E S T I M A T E**

Estimate No. : **b1 49042**
Date Estimated : **08/11/2018**
Prepared By : **Han Kwan Yong**

Page No. : **5 of 5**

REGN. NO.	CHASSIS NO.	REGN. DATE	MODEL	MILEAGE
SLL5805G	0P55881	01/03/2017	X6 xDrive35i	0

- 17.7 The Customer shall pay an amount to access his personal data in the manner stated in Clause 17.6(a) above.
- 17.8 The Customer shall have the right to correct any inaccuracies in his personal data free of charge. If the Customer wishes to exercise this right, the Customer shall:
- (a) put his request in writing;
 - (b) provide the Vendor with enough information to identify himself (e.g. the Customer's account number, username, registration details); and
 - (c) specify the information that is incorrect and what it should be replaced with.
- The Vendor shall reply to the Customer as soon as practicable upon its receipt of the Customer's request.
- 17.9 The Customer's access or correction request will not be granted as of right; the Vendor's ability to accede to the Customer's access or correction request is subjected to the prohibitions and exceptions set out or which may be set out in the Singapore Personal Data Protection Act ("PDPA") and its accompanying regulations.
- 17.10 The Customer shall have the right to ask the Vendor to stop collecting, using or disclosing his personal data for any of the abovementioned purposes set out in Clauses 17.1 and 17.2. If the Customer wishes to exercise this right, the Customer shall complete the Vendor's prescribed form and/or:
- (a) put his request in writing by way of an email sent to the Vendor;
 - (b) provide the Vendor with his name, NRIC number, mobile number, email and Vehicle registration number to identify the Customer; and
 - (c) if the Customer's objection is not to direct marketing in general, but to direct marketing by a particular channel (e.g. voice call, SMS, MMS, fax, mailers or email), the Customer has to specify the channel he is withdrawing his consent to.
- 17.11 In the event that the Customer withdraws consent to the collection, use or disclosure of his personal data such that it materially affects this Agreement and it renders the Vendor unable to, or such that it becomes difficult for the Vendor to perform or properly perform or discharge its obligations under this Agreement, at law, under the warranty undertakings, or its role as a responsible dealer of BMW vehicles, the Vendor may at its discretion, be entitled to terminate this Agreement with the Customer.
- 17.12 The obtaining the Customer's consent for the collection, use or disclosure of his personal data under this clause 17 is subject to the exceptions set out or which may be set out in the PDPA.
- 17.13 The Customer shall address all communications pertaining to this Clause 17 to:

The Data Protection Officer
Performance Motors Limited

Address:
Sime Darby Performance Centre
303 Alexandra Road
Singapore 159941

Email address:
dataprotection@pmi.com.sg

Performance Motors Limited

A member of the Time Doty Group
Co. Reg. No. 197401559W, GST Reg. No. M2-0020081-4



SUPPLEMENTARY

Estimate No. : b1 49042
Date Estimated : 08/11/2018
Prepared By : Han Kwan Yong

Page No. :

REPAIR FOR -
Wong Nee Siong
Blk 150 Mei Ling Street
#02-63

- ACCOUNT - 66
MSIG Insurance (S) Pte Ltd
4 Shenton Way
#21-01 SGX Centre 2
Singapore 068807

Singapore 141150

REGN NO	CHASSIS NO	REGN DATE	MODEL	M LEASE
SLL5805G	0P55881	01/03/2017	X6 xDrive35i	0

DESCRIPTION	ORIGINAL PRICE	DISC. %	NETT
-------------	----------------	---------	------

DESCRIPTION	UNIT PRICE	QTY	DISC. %	NETT
# CLAMP *	1.60	10.00		16.00
# LH HEADLIGHT WASHER SYSTEM COVER *	57.10	1.00		57.10

Total Labour :	
Total Parts :	73.10
Total Labour & Parts :	73.10

Auto Consultants hence notify the Repairer of the following:

- To resurvey before/after spray painting
- To display damaged part(s) during resurvey
- Parts prices are subject to confirmation
- Third party survey is on a "Without Prejudice" basis
- No illegal modification(s) is allowed
- Supplementary item(s) must be resurveyed and is subject to final approval from Insurance Company

Acknowledged by Repairer
Signature:
Date:

Performance Motors Limited

A member of the Sino Carby Group
Co. Reg. No. 197401559K GST Reg. No. M2-002001-3



FINAL REPORT

Estimate No. : b1 49042
Date Estimated : 08/11/2018
Prepared By : Han Kwan Yong

Page No. :

REPAIR FOR -
Wong Nee Siong
Blk 150 Mei Ling Street
#02-63

- ACCOUNT - 66
MSIG Insurance (S) Pte Ltd
4 Shenton Way
#21-01 SGX Centre 2
Singapore 068807

Singapore 141150

REGN NO	CHASSIS NO	REGN DATE	MODEL	MILEAGE
SLL5805G	0P55881	01/03/2017	X6 xDrive35i	0
DESCRIPTION	ORIGINAL PRICE	DISC. %	NETT	
To replace front bumper and attachments include knocking out dented areas caused by the accident	850.00		850.00	
To respray front bumper	934.00		934.00	
To check electrical wiring systems at the front section for proper function	150.00		150.00	
To supply front emboss number plate	83.00		83.00	
Sundries	80.00		80.00	

DESCRIPTION	UNIT PRICE	QTY	DISC. %	NETT
BLIND RIVET	2.95	20.00		59.00
# CLAMP *	1.60	10.00		16.00
CLAMP	1.60	10.00		16.00
LICENCE PLATE HOLDER ECE	69.25	1.00		69.25
FRT BUMPER CLADDING	225.75	1.00		225.75
FRT BUMPER COVER	161.25	1.00		161.25
TRIM GRILLE SIDE LH	66.15	1.00		66.15
HOLDER CAMERA SYSTEM (I-CAM)	33.60	1.00		33.60
FRT BUMPER PANEL PRIMED (SRA/PDC)	1,592.50	1.00		1,592.50
# LH HEADLIGHT WASHER SYSTEM COVER *	57.10	1.00		57.10
LH ORNAMENTAL GRILLE BASIC	148.20	1.00		148.20
LH BRAKE AIR DUCT	55.45	1.00		55.45
LH SPRAY NOZZLE	183.80	1.00		183.80
(DG/SL) ADHESIVE SET K6	53.05	1.00		53.05

SUPPLEMENTARY ITEMS

Total Labour :	2,097.00
Total Parts :	2,737.10
Total Labour & Parts :	4,834.10
Deduction for Excess :	0.00
Total Repair Costs less Excess:	4,834.10
GST @7%:	338.39
Grand Total :	5,172.49

...CLAIM SUBFOLDER...(Pending for Survey Report)





















CLAIM SUBFOLDER TRACKING							
Case	Notified	Est Submitted	Adj Assigned	Adj Rpt	Adj Submitted	Ins Auth'd	Status
Main	14 Nov 2018		11 Dec 2018 09:34 Edit Adj Rpt	S\$4,834.10 Edit Estimates	S\$4,834.10 View Rpt		Pending for Survey Report Cancel Case

Main	Reference	Claim Details	Documents	Show All					
CLAIM SUBFOLDER DETAILS [Created by insurer]									
Insured: GRAB RENTALS PTE LTD , Co. Reg. No.: 201617200G									
Main Claimant: WONG NEE SIONG , ID: S1830919Z									
Vehicle Reg. No.: SLL5805G		Date of Loss: 06/11/2018 14:00 - :59 [20 Months and 5 Days From LTA Reg Date (Man Yr)]							
Claim Type: TP / 575874		Policy/Cover Note No.: A29069766MKF (Comprehensive) Coverage: 01/02/2018 - 31/01/2019							
Vehicle Reg. No. (Insured): SLS8217Y		Policy No. (Claimant):							
		Excess:							
Repairer: Performance Motors Limited (Alexandra) 303 Alexandra Road, Sime Darby Performance Centre, 159941 Alexandra - Tel: 63190172/63190174									
Handling Insurer: MSIG Insurance (Singapore) Pte. Ltd. (HQ) - Tel: +65 6827 7888 ... [Handled by Christina Wong - 6643 1311]									
Adjuster: LKK Auto Consultants Pte Ltd (HQ) - Tel: 6256-3561 ... [Handled by MOHD RASUL] ... [Final Rpt due 10/01/2019]									
Driver/Custodian (Insured): ANG BOK LEONG {}, NRIC: S7171104H, Tel: +6591872414									
Adj Asp. Remarks: Survey today (11/12/18), Owner leaving car in for survey + repair by 10am. Liability unclear, Contact Person: Caroline / 6319 0174.									
ASSOCIATED MAIL RECEIVED View All Compose Case Mail									
There are no mail for this case.									
ALL ASSOCIATED TASKS View All Search Tasks Create New Task Complete									
Due Date	Priority	Type	Task Group	Subject	Handler	Assigned By	Completed On	Created On	Done?
No results.									

Claim Documents

***SLL5805G (575874)**
[SLS8217Y]
TP
WONG NEE SIONG
Nov 6 2018 2:00PM
[GRAB RENTALS PTE LTD]
Performance Motors Limited

Upload Documents			Upload Photos			Compose New Letter			View		View in Browser	
Video									1 per page		<input type="checkbox"/>	
No	Finalized On	MSIG Insurance (Singapore) Pte. Ltd. (HQ)						Thumbnail	Print			
1	24/11/18 17:33	Video - Accident by GRAB						1 Load MP4				
Assessment Reports									1 per page		<input type="checkbox"/>	
No	Finalized On	MSIG Insurance (Singapore) Pte. Ltd. (HQ)						Thumbnail	Print			
1	14/11/18 12:43	Accident Statement From: SC - Reg. No: SL58217Y, Claimant: GRAB RENTALS PTE LTD						1 Load HTM				
No	Finalized On	LKK Auto Consultants Pte Ltd (HQ)						Thumbnail	Print			
1	13/12/18 15:29	Adjuster Immediate Advice						1 Load HTM				
Photos/Images									3 per page		<input type="checkbox"/>	
No	Relabel/Reorder	LKK Auto Consultants Pte Ltd (HQ)						Thumbnail	Print			
1	31/01/19 10:17	Odometer Reading						1 Load JPG	<input checked="" type="checkbox"/>			
2	31/01/19 10:17	Chassis Number						1 Load JPG	<input checked="" type="checkbox"/>			
3	31/01/19 10:17	General View						1 Load JPG	<input checked="" type="checkbox"/>			
4	31/01/19 10:17	General View						1 Load JPG	<input checked="" type="checkbox"/>			
5	31/01/19 10:17	General View						1 Load JPG	<input checked="" type="checkbox"/>			
6	31/01/19 10:17	General View						1 Load JPG	<input checked="" type="checkbox"/>			
7	31/01/19 10:17	General View						1 Load JPG	<input checked="" type="checkbox"/>			
8	31/01/19 10:17	General View						1 Load JPG	<input checked="" type="checkbox"/>			
9	31/01/19 10:17	General View						1 Load JPG	<input checked="" type="checkbox"/>			
10	31/01/19 10:17	General View						1 Load JPG	<input checked="" type="checkbox"/>			
11	31/01/19 10:17	General View						1 Load JPG	<input checked="" type="checkbox"/>			
12	31/01/19 10:17	General View						1 Load JPG	<input checked="" type="checkbox"/>			
13	31/01/19 10:17	General View						1 Load JPG	<input checked="" type="checkbox"/>			
14	31/01/19 10:17	General View						1 Load JPG	<input checked="" type="checkbox"/>			
15	31/01/19 10:17	General View						1 Load JPG	<input checked="" type="checkbox"/>			
16	31/01/19 10:17	General View						1 Load JPG	<input checked="" type="checkbox"/>			
17	31/01/19 10:17	General View						1 Load JPG	<input checked="" type="checkbox"/>			
18	31/01/19 10:17	General View						1 Load JPG	<input checked="" type="checkbox"/>			
19	31/01/19 10:17	General View						1 Load JPG	<input checked="" type="checkbox"/>			
20	31/01/19 10:17	General View						1 Load JPG	<input checked="" type="checkbox"/>			
21	31/01/19 10:17	General View						1 Load JPG	<input checked="" type="checkbox"/>			
22	31/01/19 10:17	General View						1 Load JPG	<input checked="" type="checkbox"/>			
23	31/01/19 10:17	General View						1 Load JPG	<input checked="" type="checkbox"/>			
24	31/01/19 10:17	General View						1 Load JPG	<input checked="" type="checkbox"/>			
25	31/01/19 10:17	General View						1 Load JPG	<input checked="" type="checkbox"/>			
26	31/01/19 10:17	General View						1 Load JPG	<input checked="" type="checkbox"/>			
27	31/01/19 10:17	General View						1 Load JPG	<input checked="" type="checkbox"/>			
28	31/01/19 10:17	General View						1 Load JPG	<input checked="" type="checkbox"/>			

Video			1 per page	<input checked="" type="checkbox"/>
No	Finalized On	MSIG Insurance (Singapore) Pte. Ltd. (HQ)	Thumbnail	Print
29	31/01/19 10:17	General View	 Load JPG	<input checked="" type="checkbox"/>
30	31/01/19 10:17	General View	 Load JPG	<input checked="" type="checkbox"/>
31	31/01/19 10:17	General View	 Load JPG	<input checked="" type="checkbox"/>
32	31/01/19 10:17	General View	 Load JPG	<input checked="" type="checkbox"/>
33	31/01/19 10:17	General View	 Load JPG	<input checked="" type="checkbox"/>
34	31/01/19 10:17	General View	 Load JPG	<input checked="" type="checkbox"/>
35	31/01/19 10:17	General View	 Load JPG	<input checked="" type="checkbox"/>
36	31/01/19 10:17	General View	 Load JPG	<input checked="" type="checkbox"/>
37	31/01/19 10:17	General View	 Load JPG	<input checked="" type="checkbox"/>
38	31/01/19 10:17	General View	 Load JPG	<input checked="" type="checkbox"/>
39	31/01/19 10:17	General View	 Load JPG	<input checked="" type="checkbox"/>
40	31/01/19 10:17	Reinspection Photo	 Load JPG	<input checked="" type="checkbox"/>
41	31/01/19 10:17	Reinspection Photo	 Load JPG	<input checked="" type="checkbox"/>
42	31/01/19 10:17	Reinspection Photo	 Load JPG	<input checked="" type="checkbox"/>
43	31/01/19 10:17	Reinspection Photo	 Load JPG	<input checked="" type="checkbox"/>
44	31/01/19 10:17	Reinspection Photo	 Load JPG	<input checked="" type="checkbox"/>
Documentation			1 per page	<input checked="" type="checkbox"/>
No	Finalized On	MSIG Insurance (Singapore) Pte. Ltd. (HQ)	Thumbnail	Print
1	14/11/18 12:43	SLL5805G GIA Rpt From: SC - Reg. No: SLS821TY, Claimant: GRAB RENTALS PTE LTD	 Load PDF	
2	14/11/18 12:44	Email frm TP enquiring on liability Can't do direct settlement, pending for video footage	 Load PDF	
3	14/11/18 14:42	Estimate	 Load PDF	
No	Finalized On	MSIG Insurance (Singapore) Pte. Ltd. (Internal Surveyor)	Thumbnail	Print
1	04/12/18 15:19	Email - Survey Appt	 Load PDF	

Documents Checklist

DOCUMENTS CHECKLIST		Reset	Save	Print
There are no document checklists configured.				
Our Checklist Remarks - LKK Auto Consultants Pte Ltd (HQ) <div style="border: 1px solid black; height: 40px; margin-top: 5px;"></div>				
Show Remarks To: <input type="checkbox"/> Handling Insurer <small>Note: Remarks are private unless you show it to other parties.</small>				

LKK Auto Consultants Pte Ltd (Co.Reg.No:199607198R)

51 Ubi Ave 1 #01-25, Paya Ubi Industrial Park

Singapore 408933

Tel: 6256-3561 Fax: 6844-8805 Email: sur@lkkauto.com; assignments@lkkauto.com

VEHICLE DAMAGE INSPECTION REPORT

Our File No: CS/MSG18022259/R1SBE2

Date: 31/01/2019

REFERENCE

Handling Insurer: MSIG Insurance (Singapore) Pte. Ltd.

Policy No: A29069766MKF

Claimant Vehicle
No: SLL5805G

Insured Vehicle No: SLS8217Y

Date of Loss: 06/11/2018

Nature of Claim: TP

Claim No: 575874

DESCRIPTION & IDENTIFICATION OF VEHICLE

Reg No: SLL5805G

Make & Model: BMW X6 XDRIVE, 3.0 (A)

Engine No: 03319762N55B30A

Reg. Date: 01/03/2017 (Man. Year: 2016)

Chassis No: WBAKU220200P55881

Colour: White

Odometer: 20584 km

Engine Capacity: 2979 cc

Market Value/New Car Price: N/A

Sum Insured (S\$): Market Value/New Car Price

CONDITION OF VEHICLE AT THE TIME OF SURVEY

General Condition: Steering (Serviceable): Yes Footbrake (Serviceable): Yes

Handbrake (Serviceable): Yes Engine Modification: No Pre-accident Condition:

CONDITION OF TYRES

Front Tyre Size: 255/50 R19

Rear Tyre Size: 255/50 R19

Front Left Side: Pirelli 6 mm

Rear Left Side: Pirelli 6 mm

Front Right Side: Pirelli 6 mm

Rear Right Side: Pirelli 6 mm

The above values represent the remaining tyre treads depth

COST OF CLAIMS	Repairer's	Adjuster's	Difference	Diff %
Parts	4,809.65	2,900.10	1,909.55	39.70
Miscellaneous Items	0.00	0.00	0.00	
Labour	2,490.00	1,934.00	556.00	22.33
Paintwork Labour	0.00	0.00	0.00	
Towing	0.00	0.00	0.00	
Gross Total (S\$)	7,299.65	4,834.10	2,465.55	33.78
+ GST 7.00/7.00% (S\$)	510.98	338.39	172.59	33.78
Nett Amount (S\$)	7,810.63	5,172.49	2,638.14	33.78

INSPECTION

Date of Assignment: 11/12/2018

Date Inspected: 11/12/2018 Inspected At:

Performance Motors Limited (Alexandra)
303 Alexandra Road, Sime Darby
Performance Centre
Singapore 159941

Estimated Period of Repair: 4.0 days

Adjuster: MOHD RASUL

Manager: Hiew May Fung

NOTE: This report represents our findings at the time and place of inspection stated herein. Such inspection has been carried out to the best of our knowledge and ability but any other liability under any other circumstances is hereby expressly excluded.

REPAIR DETAILS

Reference

Part Source:	MRM-SG	Version: 1.0 (Last Synchronised: 31 Jan 2019)
Parts:	M1-SUV	BMW X6 XDRIVE 3.0 (A) (Catalogue:Merimen Singapore 1.0)
Labour:	Repairer's	(Price-denominated Standard List)
Print Code:	(Unsubmitted, no print-code for SLL5805G)	
Validity:	These estimates are valid only if they contain the print code (above) on all estimate pages, running page numbers with the END OF ESTIMATES marker on the last estimate page	
Further Info:	Items/values not in reference catalogue are prefixed with an asterisk *.	

Recommended Parts

No.	Qty	Part No.	Particulars	Condition	Repairer's	Amount
1	1		*FRONT EMBOSS NUMBER PLATE	Bent	83.00 FS	*83.00 FS
2	1		*SUNDRIES	Necessary	80.00 FS	*80.00 FS
3	10		*BODY NUT	Not Necessary	9.00 FS	*- FS
4	4		*BLIND RIVET	Not Necessary	11.80 FS	*- FS
5	1		*BLIND RIVET (30PCS)	Necessary-20pcs only	88.50 FS	*59.00 FS
6	4		*BLIND RIVET	Not Necessary	4.60 FS	*- FS
7	20		*CLAMP	Necessary	32.00 FS	*32.00 FS
8	1		*FRT BUMPER CARRIER	Not Necessary	529.55 FS	*- FS
9	1		*GRILLE MIDDLE TOP OPEN	Not Necessary	107.20 FS	*- FS
10	1		*FRT SHOCK ABSORBER	Not Necessary	87.35 FS	*- FS
11	1		*GRILLE SIDE CLOSED LH	Not Necessary	93.85 FS	*- FS
12	1		*LICENCE PLATE HOLDER ECE	Not Necessary	69.25 FS	*69.25 FS
13	1		*FRT BUMPER CLADDING	Not Necessary	225.75 FS	*225.75 FS
14	1		*FRT BUMPER LH INSERT (NIVI)	Not Necessary	80.85 FS	*- FS
15	1		*LH HOLDER HEADLIGHT CLEANING	Not Necessary	21.10 FS	*- FS
16	1		*FRT BUMPER COVER	Scratched / Missing	161.25 FS	*161.25 FS
17	1		*LH AIR CHANNEL	Not Necessary	52.80 FS	*- FS
18	1		*TRIM GRILLE SIDE LH	Scratched	66.15 FS	*66.15 FS
19	1		*HOLDER CAMERA SYSTEM (I-CAM)	Necessary	33.60 FS	*33.60 FS
20	1		*FRT BUMPER PANEL PRIMED (SRA/PDC)	Scratched	1,592.50 FS	*1,592.50 FS
21	1		*LH HEADLIGHT WASHER SYSTEM C	Missing	57.10 FS	*57.10 FS
22	1		*LH ORNAMENTAL GRILLE BASIC	Scratched	148.20 FS	*148.20 FS
23	1		*RH ORNAMENTAL GRILLE BASIC	Serviceable	148.20 FS	*- FS
24	1		*COOLING AIR DUCT	Serviceable	316.60 FS	*- FS
25	1		*LH BRAKE AIR DUCT	Deformed	55.45 FS	*55.45 FS
26	1		*LH SPRAY NOZZLE	Scratched	183.80 FS	*183.80 FS
27	1		*LH FOG LIGHT LED	Serviceable	417.15 FS	*- FS
28	1		*(DG/SL) ADHESIVE SET K6	Necessary	53.05 FS	*53.05 FS

F=Franchise part. S=SpcNett.

Total Parts (\$\$)	4,809.65	2,900.10
---------------------------	-----------------	-----------------

Report was unsubmitted during this print-out.

Recommended Miscellaneous Items

There are no new miscellaneous items selected.

Recommended Labour

No	Particulars	Lab.Type	Repairer's	Amount
Labour Items				
1	TO REPLACE FRONT BUMPER & ATTACHMENTS INCLUDING TO KNOCK OUT DENTED AREA CAUSED BY THE ACCIDENT	New	1,275.00	850.00
2	TO RESPRAY FRONT BUMPER	New	1,038.00	934.00
3	TO CHECK ELECTRICAL WIRING SYSTEMS AT THE FRONT SECTION FOR PROPER FUNCTION INCLUDING ADJUSTMENTS OF HEADLIGHTS	New	177.00	150.00
Gross Labour Cost (S\$)			2,490.00	1,934.00

Report was unsubmitted during this print-out.

< END OF ESTIMATES >