

2/03/2002

ASS. REC. BY:

REF: CS/CTU8021685 / Uvbnz

Special Instruction:

Surveyor:

Maimah

ASSIGNMENT (Office)

From (Person):

Chong Boon Sen

of

CT

Date/Time: 03/12/2018 2.11pm

Estimated Cost:

Bill to:

OD / TP / WS / TP RES / OD RES / EVA / INV / MV / CS

To Inspect Vehicle No:

SLR 6658G

Insured:

ABH 6064K

at Workshop m/s

Abwin Service

Tel:

9751 9996

of

No. 8 Kuli Bukit Ave 4 #07-48

Policy No:

OMCVSN 1822481800

Claim No:

SNM18DVB592102

Sum Insured:

Excess:

D.O.A.

28/11/2018

Make of Veh:

(Client's Record)

CA / REV / REP. / REV 24 HRS 'wp'

07.12.2018 @ 1pm

H.O.D. Endorsement:

Date/Time:

03/12/2018 2.58pm

Person Contacted:

Linda

Vehicle IN / OUT

Date/Time

Action/Instruction (✓) Estimate

SLR 6658G - x

ABH 6064K - x

REF: CIL

Merimen

## ASSIGNMENT

From: Merimen Date: 07/12/2018  
 Estimated Cost: 0  
 OD TP / WS / TP RES / OD RES / EVA / INV / MV  
 To Inspect Vehicle No: SLQ 6658G  
 at Workshop m/s: Abwim Service  
 of 8 Kaki Bukit Ave 4 #07-48  
 Insured: 1.45  
 Policy No.: 1pm  
 Claims No.: 1pm  
 Sum Insured: 1.45  
 (Client's Record)  
 Make of Veh: 1pm

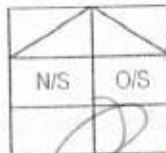

Remark: The veh had commenced its repair at the time of inspection.

Bal. or Market Value: 54  
 IDAC Accident Report: Consistent? Yes or No  
 GLA / PR Seen: Consistent? Yes or No  
 Est. Repairs: 4 days Res.: Yes or No  
 Lum Sum: 20 % 3 Val.: Yes or No

CA / REV / REP. / 24 HRS

Date: 27/12/18 Person Contacted: LTA 46787 Vehicle: IN / OUT

Veh No: SLQ 6658G Yr Regn: 2/6/13  
 Type: M. Car / M. Cycle / Bus / Van / Lorry / Taxi / Prime Mover /  
 Truck / Trailer or CA  
 Make: Volkswagen Toureg C.C. 1390  
 Colour: white A/C: Insured / Std / NI / NA  
 Sp. Reading: 135908 T/Radio: Insured / Std / NI / NA  
 Eng/No: WVG2221T2DW090037  
 C/No: WVG2221T2DW090037  
 Gen. Cond: Good / Fair / Poor / Burnt  
 Steering: In order / Jammed / Leaked / Burnt or  
 Brake: In order / Jammed / Leaked / Burnt or  
 Modi: Nil / S/Rim / STD A/Rim or  
 Tyre Size: F: 225/45R17  
 R: 225/45R17  
 BS / DUN / EXNOVA / GY / FS / LIZA / MIC / OHTSU / PIR / SUMI /  
 TOYO / YOKO or  
 Front: 6 mm Rear: 6 mm  
 R/Bal: 6 mm R/Bal: 6 mm  
 L/Bal: 6 mm L/Bal: 6 mm  
 D.O.A: 28/12/18 D.O.I: 7/12/18  
 Survey held at: Reu  
 Des. of Damages: Frt / Rear / O/S / N/S / U/C / Rooftop or  
 The U/C / Chassis frame / Body Structure affected due to collision.

Date / Time Action / Instruction

4 yrs. bala. Rep 9500 nett 743  
Tailgate 2145

4/1/19 confirmed 2/5 @ 4450 with Linda (Red 9504.86, 6819)

RECEIVED 14 JAN 2019

Date/Time, File Pass to?

☐ : Preli. ReportDays Of Repair: 4

1)

☐ : Final ReportResurvey No. of Trip: 1

Survey Fee:

Date/Time, File Return to?

Transportation

2) 14/1 - typistAdd Fee: ☐ : Site Insp (\$)

) S + RS. St

☐ : Interview (\$)

) Photos

☐ : Tech. Invs (\$)

) Others

☐ : Weekend (\$)

TOTAL

Report Format:

merimen

Lump Sum / I.B.I. (\$)

4450/2220

...CLAIM SUBFOLDER...(New Assignment)

CLAIM SUBFOLDER TRACKING							
Case	Notified	Est Submitted	Adj Assigned	Adj Rpt	Adj Submitted	Ins Auth'd	Status
Main	29 Nov 2018		03 Dec 2018 14:11 Assign				<b>New Assignment</b> <a href="#">Cancel Case</a>

Main	Reference	Claim Details	Documents	Show All
CLAIM SUBFOLDER DETAILS			[Created by insurer]	
Insured:				
Main Claimant:	YEUNG PUI PUI PRISCILLA			
Vehicle Reg. No.:	SLQ6658G	Date of Loss:	28/11/2018 00:00 - :59	
Claim Type:	TP / SNM18D05592C02	Policy/Cover Note No.:	DMCVSN1822481800	
Vehicle Reg. No. (Insured):	GBH6064K	Policy No. (Claimant):		
		Excess:	S\$0.00	
Repairer:	Abwin Service Pte Ltd (HQ) No. 8 Kaki Bukit Avenue 4, #07-48 Premier@Kaki Bukit Gate 2, 415875 Kaki Bukit - Tel: 6713 9400			
Handling Insurer:	China Taiping Insurance (Singapore) Pte. Ltd. (HQ) - Tel: 6389 6111 ... [Handled by <b>Chong Boon Sen</b> ]			
Adjuster:	LKK Auto Consultants Pte Ltd (HQ) - Tel: 6256-3561 ... [Final Rpt due 12/12/2018]			
ASSOCIATED MAIL RECEIVED			View All	Compose Case Mail
There are no mail for this case.				
<div> <div> <div>ALL ASSOCIATED TASKS</div> <div> <div>Due Date</div> <div>Priority</div> <div>Type</div> <div>Task Group</div> <div>Subject</div> <div>Handler</div> </div> <div> <div>View All</div> <div>Search Tasks</div> <div>Create New Task</div> <div>Complete</div> </div> <div> <div>Assigned By</div> <div>Completed On</div> <div>Created On</div> <div>Done?</div> </div> </div> </div>				
No results.				

New Cars

Used Cars

Sell My Car

Directory

Products

Insurance

Articles

Forum



Volkswagen Touran

Price Range

Depreciation

2013

Vehicle Type

Home » Used Cars » Carro » Volkswagen Touran 1.4A TSI

## Resources

Car Buying

Car Selling

Car Ownership

Car Aftermarket

On The Move

Lifestyle

## Volkswagen Touran 1.4A TSI

Overview

Financial

Accessories

Similar

Research

Photos

Map



THE BETTER AUTOMOTIVE EXPERIENCE FOR EVERYBODY

Add to Shortlist

Add to Compare

Add a Note

Report Error

More Actions

Share

## Car Details

<b>Price</b>	<b>\$56,000</b>	
<b>Depreciation</b>	\$9,520 /yr View models with similar depreciation	?
<b>Reg Date</b>	29-Aug-2013 (4yrs 8mths 21days COE left)	
<b>Manufactured</b>	2013	?
<b>Mileage</b>	101,000 km (19.1k /yr)	
<b>Transmission</b>	Auto	
<b>Engine Cap</b>	1,390 cc	
<b>Road Tax</b>	\$620 /yr	?
<b>Power</b>	103.0 kW (138 bhp) View specs of the Volkswagen Touran Sport (2008-2009)	
<b>Curb Weight</b>	1,536 kg	?
<b>Features</b>	138 Bhp, 220 Nm Powerful 1.4 Turbocharged TSI Engine With 7 Speed DSG Gearbox, 6 Airbags, ISOFIX System For Rear Seats, Robust And Functional Car.	
<b>Accessories</b>	Reverse Sensors, Removable Rear Seats, 2 Zone Climatic Aircon System, Auto Headlights.	
<b>Description</b>	Beautiful N Faultless. Schedule A Test Drive Today. Viewing Is Strictly By Appointment Only.	
<b>COE</b>	\$76,223	?
<b>OMV</b>	\$24,994	?
<b>ARF</b>	\$21,992	?
<b>Dereg Value</b>	\$51,418 as of today (change)	?
<b>No. of Owners</b>	2	?
<b>Type of Veh</b>	MPV	
<b>Category</b>	PARF Car, Consignment Car	

## Owner Consignment Car

This car is for sale by direct owner agent. Consignment agents help to handle all documentation on the car.

- » List of owner consignment cars
- » List of consignment agents



## Seller Information

Company

Carro

» dealer's pr  
» 163 vehs :  
available

Compare

New Cars

Used Cars

Sell My Car

Directory

Products

Insurance

Articles

Forum

**FREE** **Car Search REWARDS MEMBERSHIPS**

 Get at least **10% DISCOUNT** on car services from repair, warranty & servicing, grooming to car accessories

[Learn more](#)

Volkswagen Touran

Price Range ▼

Depreciation ▼

2013 ▼

Vehicle Type ▼

[Home](#) » [Used Cars](#) » [Automate](#) » Volkswagen Touran Sport 1.4A TSI Sunroof

## Resources

[Car Buying](#)[Car Selling](#)[Car Ownership](#)[Car Aftermarket](#)[On The Move](#)[Lifestyle](#)

## Car Tyres



## Volkswagen Touran Sport 1.4A TSI Sunroof

[Overview](#)[Financial](#)[Accessories](#)[Similar](#)[Research](#)[Photos](#)[Map](#)[Add to Shortlist](#)[Add to Compare](#)[Add a Note](#)[Report Error](#)[More Actions](#)[Share](#)

## Car Details

**Price** **\$59,900****Depreciation** \$9,830 /yr

View models with similar depreciation

**Reg Date** 24-Jul-2013

(4yrs 7mths 16days COE left)

**Manufactured** 2013**Mileage** 114,556 km (21.3k /yr)**Transmission** Auto**Engine Cap** 1,390 cc**Road Tax** \$620 /yr**Power** 125.0 kW (167 bhp)

View specs of the Volkswagen Touran Sport (2008-2009)

**Curb Weight** 1,567 kg
**Features** 140 Bhp, 220 Nm Powerful 1.4 Turbocharged TSI Engine With 7 Speed DSG Gearbox, 6 Airbags, ISOFIX System For Rear Seats, Robust And Functional Car.

**Accessories** Reverse Sensors, Removable Rear Seats, 2 Zone Climatic Aircon System, Auto Headlights.

**Description** Road Tune To 200Bhp. Park Assist, Engine And Gearbox Overhauled. Water Pump Replaced. All 4 Tyres Replaced 3 Months Ago. Full Service History. Buy With No Worries. Warranty On Engine For The Next 10k KM. Wonderfully Maintained By Owner And Services Routinely For Optimal Condition. High Paper Value. Call Us Now To Arrange Viewing.
**COE** \$73,989**OMV** \$29,868**ARF** \$28,816**Dereg Value** \$54,409 as of today (change)**No. of Owners** 2**Type of Veh** MPV**Category** PARF Car

## Seller Information

<b>Company</b>	<b>Automate</b> » dealer's pr » 9 vehs sol
<b>Address</b>	7 Toh Guan Search cars
<b>Location</b>	Alpha Indust
<b>Office No</b>	69093096
<b>Contact Person(s)</b>	Sam Jenelle Queenie

## Useful Services

 Afraid of lemons?  
this car evaluated

[Compare](#)

> Back to OneMotoring

## Enquire PARF/COE Rebate for Registered Vehicle

<b>Vehicle Owner Particulars</b>	
Owner ID Type:	Singapore NRIC
Owner ID:	5111I
<b>Vehicle Details</b>	
Vehicle No.:	SLQ6658G
Vehicle to be Exported:	No
Intended Deregistration Date:	07 Dec 2018
Vehicle Make:	VOLKSWAGEN
Vehicle Model:	TOURAN 1.4 AT TSI 1T33B4
Primary Colour:	White
Manufacturing Year:	2013
Engine No.:	CTH062494
Chassis No.:	WVGZZZ1TZDW090037
Maximum Power Output:	103.0 kW (138 bhp)
Open Market Value:	\$24,574.00
Original Registration Date:	26 Jun 2013
First Registration Date:	26 Jun 2013
Transfer Count:	1
Actual ARF Paid:	\$21,404.00 <i>po 702</i>
<b>Intended PARF Rebate Details</b>	
PARF Eligibility:	Yes
PARF Eligibility Expiry Date:	25 Jun 2023
PARF Rebate Amount:	\$14,982.00
<b>Intended COE Rebate Details</b>	
COE Expiry Date:	25 Jun 2023
COE Category:	A - Car (1600cc & below)
COE Period(Years):	10
QP Paid:	\$69,903.00
COE Rebate Amount:	\$31,805.00
<b>Total Rebate Amount:</b>	<b>\$46,787.00</b>

The information contained herein is correct as at 07 Dec 2018

OK

## SINGAPORE ACCIDENT STATEMENT

### IMPORTANT NOTICE

1. Please report correctly the details of the accident to speed up the claims process.
2. This Form must be completed by the Policyholder and/or the Authorised Driver.
3. Information provided must be as truthful and accurate as possible. Any wilful misrepresentation or withholding of material facts may allow insurance companies to repudiate policy liability.
4. The issue and acceptance of this Form by insurance companies is not an admission of policy liability on the part of the insurance companies.
5. Any false reporting may be referred to the Police for investigation.
6. This report will be forwarded by the Insurers of the GIA Records Management Centre established by the General Insurance Association of Singapore (GIA) for archiving and that copies of this report will, for a fee, be made available upon application by interested parties.
7. By the lodgement of this report to the insurers, you hereby consent to the archiving of this report at the centre and to copies of the report being made available aforesaid.

### ACCIDENT STATEMENT

Date Of Report	28/11/2018 12:21
Date Of Accident	28/11/2018 09:30
Exact Location Of Accident	BLK 123 DEFU LANE 10
Country/State of Loss	SINGAPORE

### DETAILS OF OWN VEHICLE

Vehicle Registration Number	SLQ6658G
<b>Insured/Policyholder</b>	
Name Of Registered Owner	YEUNG PUI PUI PRISCILLA
NRIC No	S7075111I
Email Address	BOONHUALIM@SINGNET.COM.SG
Mobile Phone No	(LOCAL) +65-96926285
Alternative Phone No	OFFICE-90233570

### Vehicle Particulars

Manufacturer	VOLKSWAGEN
Model	TOURAN-1.4 TSI (A)
Exact Purpose for which vehicle was being used at time of accident	
Are you claiming under your own insurance policy for repair to your vehicle?	NO
If No, Please state action to be taken	THIRD PARTY
Vehicle Category	PRIVATE CAR

### Insurance Company

Name of Insurance Company	NTUC INCOME INSURANCE CO-OPERATIVE LTD
Type Of Coverage	COMPREHENSIVE
Fleet Policy	NO
Policy Number	5094590598
Cover Note Number	

### Driver

Name of Driver	YEUNG PUI PUI PRISCILLA
NRIC No	S7075111I
Date Of Birth	03/10/1970
Occupation	INDOOR
Date Of Driving Pass	24/07/2006
Driving Experience	12 YEARS AND 4 MONTHS
Gender	FEMALE
Mobile Number	(LOCAL) +65-96926285
Fax Number	
Contact Number	OFFICE-90233570
EMail Address	BOONHUALIM@SINGNET.COM.SG

Address	BLK 817A KEAT HONG LINK #07-83
Postcode	661817
Was driver an employee of the Insured's Company	NO
If No, Relationship of the Driver with the Insured	OWNER
Vehicle Registration Number of Driver's Own Vehicle	-
	-
	-
Insurance Company of Driver's Own Vehicle	-
	-
	-

#### General Information of the Accident

Type Of Accident	HIT AND RUN / VANDALISM / DAMAGED WHILST PARKED
Weather Conditions	CLEAR
Road Surface	DRY

#### Other Information

Was any foreign vehicle involved in this accident?	NO
Number of vehicles involved in the accident	
Was any body injured in the Accident?	NO
Was any injured conveyed to hospital by ambulance?	NO
Was any other material or property damaged?	YES
I have been approached by unknown person(s) soliciting/offering accident claims assistance.	NO
Number of Passengers (Including Driver)	1

#### Details of Police Action

Was the accident reported to the police?	NO
If Yes, Please state which Police Station	
Was notice of intended Prosecution given?	NO
If Yes, against whom?	

#### Circumstances of Accident

Refer to attachment.

#### Attachment(s)

Are accident photos available for attachment?	YES
Was there any video captured by Car Camera?	NO
Was there any audio recorded?	NO

#### DETAILS OF OTHER VEHICLE PROPERTY 1

Vehicle Registration Number	GBH6064K
Vehicle Make/Model/Colour	
Details Of Properties	
Vehicle Category	COMMERCIAL VEHICLE
Name of Driver	
NRIC/Passport Number	
Contact Number	
Address	
Postcode	
Insurance Company Name	
Nature Of Damage	
No. Of Passenger (Including Driver)	

**SKETCH PLAN**

**IMPORTANT NOTICE**

1. Please report **correctly** the details of the accident to speed up the claims process.
2. This Form must be **completed by the Policyholder and/or the Authorised Driver**.
3. Information provided must be as **truthful and accurate as possible**. Any wilful misrepresentation or withholding of material facts may allow insurance companies to **repudiate policy liability**.
4. The issue and acceptance of this Form by insurance companies is not an admission of policy liability on the part of the insurance companies.
5. **Any false reporting may be referred to the Police for investigation.**
6. The report will be forwarded by the insurers of the GIA Records Management Centre established by the General Insurance Association of Singapore (GIA) for archiving and that copies of this report will for a fee be made available upon application by interested parties.
7. By the lodgment of this report to the insurers, you hereby consent to the archiving of this report at the centre and to copies of the report being made available aforesaid.
8. **Consent under the Personal Data Protection Act (PDPA)**

I understand, acknowledge, agree and consent that:

- (a) My insurer, my workshop and the General Insurance Association of Singapore ("GIA") may/are permitted to collect, use, disclose and/or process my personal data/personal information set out in this [form] and any other personal information provided by me or possessed by my insurer (collectively the "Personal Information") and disclose and transfer such Personal Information to all insurer(s) who have insured vehicle(s) involved in this accident (all insurer(s) who have insured vehicle(s) involved in this accident shall be collectively referred to as the "Insurers"), the Insurers' lawyers/law firms, the Monetary Authority of Singapore and any relevant government agency/authority (such as the police), for the purpose(s) of :
  - (i) processing, handling and/or dealing with my claims including the settlement of the claims and any necessary investigations relating to the claims;
  - (ii) investigating the accident and/or my claims;
  - (iii) carrying out and/or dealing with my instructions or responding to any enquiries by me;
  - (iv) administering my claims (including the mailing of correspondence, statements, invoices, reports or notices to me, which could involve disclosure of certain personal data about me to bring about delivery of the same as well as on the external cover of envelopes/mail packages); and/or
  - (v) complying with applicable law in administering, processing, handling and/or dealing with my claims.(collectively the "Purposes")
- (b) all insurer(s) who have insured vehicle(s) involved in this accident and the Insurers' lawyers/law firms, may/are permitted to collect, use, disclose and/or process my Personal Information for one or more of the above Purposes; and
- (c) my Personal Information may/can be disclosed by any of the Insurers and/or GIA to their third party service providers or agents(including their lawyers/law firms), which may be sited outside of Singapore, for one or more of the above Purposes.
- (d) my Personal Information will also be collected and used to compile claims history for the purpose of fraud detection, investigation and management in present and all future claims.
- (e) the information so collected under (d) above may be shared / disclosed:
  - (i) to all insurers and/or any other third parties that assist in evaluating, investigating, controlling or managing fraud, regulators, law enforcement and government agencies as reasonably required for the purposes stated, or
  - (ii) for complying with requirements under any regulations, laws or court orders.

\_\_\_\_\_  
Policyholder's Signature  
Date & Time:

\_\_\_\_\_  
Driver's Signature  
(If driver is not the policyholder)  
Date & Time:

\_\_\_\_\_  
Reporting Centre Personnel's Signature  
Name:  
NRIC/FIN No.:



SKETCH PLAN

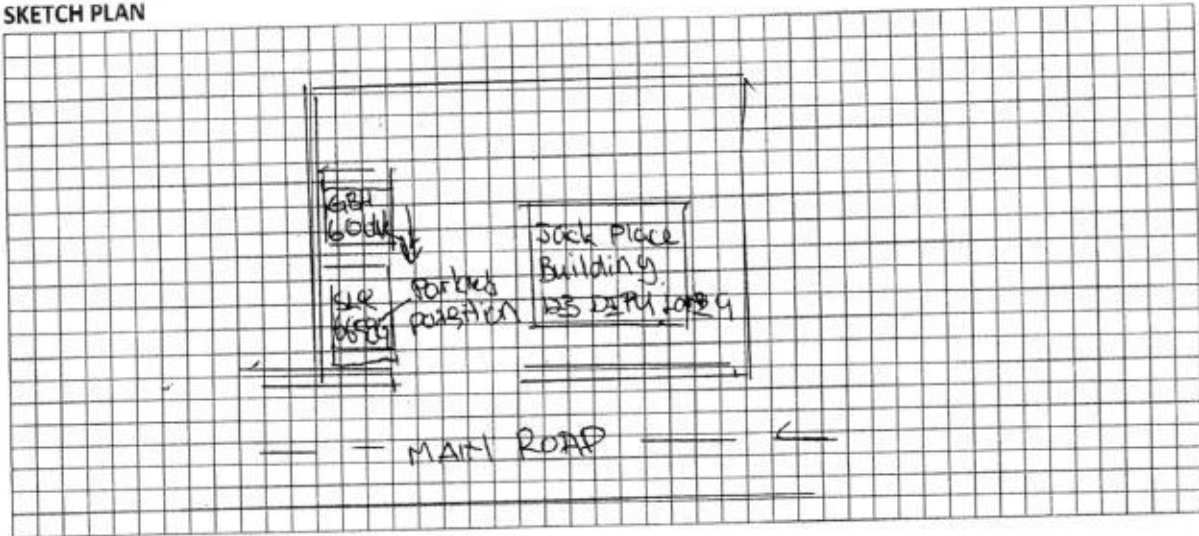

DESCRIBE CIRCUMSTANCES OF THE ACCIDENT

Accident happened at 9.30 am (approx.) at 123 PEFU LANE 9 (Jack Place Building) My vehicle is on parking position as I went in the building to collect my cake as I have order. The heavy went into the car (GEB 6064 K) went into his vehicle and start reverse and hit my car back. This is all I have to say.

DECLARATION

I/We declare the foregoing particulars are true in every respect.

\_\_\_\_\_  
Policyholder's Signature  
Date & Time:

\_\_\_\_\_  
Driver's Signature  
(If driver is not the policyholder)  
Date & Time:



\_\_\_\_\_  
Reporting Centre Personnel's Signature  
Name:  
NRIC/FIN No.:

Please arrange to survey vehicle at  
8 KAKI BUKIT AVENUE 4 - GATE 2  
#07-48 PREMIER @ KAKI BUKIT  
SINGAPORE 415875

Not Allowed  
7/12/18  
The photo of the car  
4/5/18

**ABWIN** 諭輝

Date : 07/12/2018  
TP Vehicle No. : GBH-6064-K  
To : CHINA TAIPING INSURANCE (SINGAPORE) PTE LTD  
Attn : Motor Claim Department

LINDA LIAO  
ABWIN SERVICE PTE LTD  
DID: 67139417  
Fax: 67139415  
HP: 97519596

Owner : YEUNG PUI PUI PRISCILLA  
NTUC INCOME INSURANCE CO-OPERATIVE LTD  
Certificate No. : 5094590598  
Vehicle No. : SLQ-6658-G  
Make & Model : VOLKSWAGEN TOURAN 1.4L AT TSI 1T32B4

Accident Date: 28/11/2018

### ESTIMATED REPAIR COST DETAILS

QTY	DESCRIPTION	REPAIR AMOUNT	SURVEYOR APP.
<u>List Item</u>			
1	TAILGATE 306500	\$2,087.45	—
1	TAILGATE EMBLEM LOGO m/scn	\$135.80	—
1	TAILGATE MOULDING m	\$405.40	—
1	TAILGATE REFLECTOR LH 11	\$285.70	X
1	TAILGATE REFLECTOR RH 11	\$285.70	X
1	TAILGATE EMBLEM "TOURAN" m	\$106.15	—
1	TAILGATE EMBLEM "TSI" m	\$75.05	—
1	REAR NUMBER PLATE TOP GARNISH 11	\$680.90	X
1	REAR BUMPER De/Don	\$1,285.60	—
1	REAR BUMPER REFLECTOR RH 11	\$95.10	X
1	REAR BUMPER REFLECTOR LH 11	\$95.10	X
1	REAR BUMPER RETAINER RH 11	\$65.50	X
1	REAR BUMPER RETAINER LH 11	\$65.50	X
1	REAR BUMPER REINFORCEMENT 11	\$668.65	X
1	REAR BUMPER SPONGE 11	\$105.60	X
1	REAR END PANEL 11	\$956.88	X
1	REAR END PANEL TOP GARNISH 11	\$195.60	X
10	REAR END PANEL TOP GARNISH CLIPS 11	\$50.00	X
1	RH TAILLAMP 11	\$385.60	X
1	LH TAILLAMP 11	\$385.60	X
1	REAR WINDSCREEN WEATHERSTRIP 11	\$235.60	X
	<b>Sub Total</b>	<b>\$8,652.48</b>	
	<b>Discount 5% on Parts</b>	<b>(\$432.62)</b>	
		<b>\$8,219.86</b>	

4096.45

### Special Nett

1	REAR WINDSCREEN INNER SEAL m	\$65.00	40
1	REAR WINDSCREEN SEALANT m	\$65.00	40
1	REAR NUMBER PLATE & CASEING 11	\$65.00	X
10	REAR BUMPER CLIPS m	\$60.00	45

Date : 07/12/2018  
 TP Vehicle No. : GBH-6064-K  
 To : CHINA TAIPING INSURANCE (SINGAPORE) PTE LTD  
 Attn : Motor Claim Department

LINDA LIAO  
 ABWIN SERVICE PTE LTD  
 DID: 67139417  
 Fax: 67139415  
 HP: 97519596

Owner : YEUNG PUI PUI PRISCILLA  
 NTUC INCOME INSURANCE CO-OPERATIVE LTD  
 Certificate No. : 5094590598  
 Vehicle No. : SLQ-6658-G  
 Make & Model : VOLKSWAGEN TOURAN 1.4L AT TSI 1T32B4

Accident Date: 28/11/2018

## ESTIMATED REPAIR COST DETAILS

QTY	DESCRIPTION	REPAIR AMOUNT	SURVEYOR APP.
1	REAR BUMPER REVERSE SENSOR	\$450.00	200
	<b>Sub Total</b>	<b>\$705.00</b>	

## Labour & Misc

TO STRAIGHTEN AND PANEL BEAT ACCIDENT AREAS	\$2,000.00	500
TO SPRAY PAINT ON AFFECTED AREAS	\$1,800.00	600
TO CHECK LIGHTING AND FOCUS TAILLAMP	\$250.00	20
TO APPLY TUFF KOTE ON AFFECTED AREAS	\$250.00	30
TO INSTALL REVERSE SENSOR & CHECK FUNCTIONALITY	\$250.00	50
TO TRANSFER & INSTALL TAILGATE COMPONENTS	\$250.00	60
TO REMOVE AND INSTALL REAR WINDSCREEN	\$250.00	120
<b>Sub Total</b>	<b>\$5,050.00</b>	

**Sub Total** \$13,974.86  
**GST 7%** \$978.24  
**Total** \$14,953.10

UKK Auto Consultants hence notify the Repairer of the following:

- To resurvey before/after spray painting
- To display damaged part(s) during resurvey
- Parts prices are subject to confirmation
- Third party survey is on a "Without Prejudice" basis
- No illegal modification(s) is allowed
- Supplementary item(s) must be resurveyed and is subject to final approval from Insurance Company

Acknowledged by Repairer

Signature:

Date:

## LKK Auto Consultants Pte Ltd (Co. Reg. No. 199607198R)

51 Ubi Ave 1 #01-25, Paya Ubi Industrial Park

Singapore 408933

Tel: 6256-3561 Fax: 6844-8805 Email: sur@lkkauto.com; assignments@lkkauto.com

## VEHICLE DAMAGE INSPECTION REPORT

Our File No: CS/CTI18021685/UVBN2

Date: 14/01/2019

## REFERENCE

Handling Insurer:	China Taiping Insurance (Singapore) Pte. Ltd.	Policy No:	DMCVSN1822481800
Claimant Vehicle No :	SLQ6658G	Insured Vehicle No :	GBH6064K
Date of Loss:	28/11/2018	Nature of Claim:	TP
		Claim No:	SNM18D05592C02

## DESCRIPTION &amp; IDENTIFICATION OF VEHICLE

Reg No:	SLQ6658G	Engine No:	CTH062494
Make & Model:	VOLKSWAGEN TOURAN, 1.4 TSI (A)	Chassis No:	WVGZZZ1TZDW090037
Reg. Date:	26/06/2013 (Man. Year: 2013)	Odometer:	135908 km
Colour:	White		
Engine Capacity:	1390 cc		
Market Value/New Car Price:	N/A		
Sum Insured (\$\$):	Market Value/New Car Price		

## CONDITION OF VEHICLE AT THE TIME OF SURVEY

General Condition:	Steering (Serviceable):	Yes	Footbrake (Serviceable):	Yes
Handbrake (Serviceable):	Yes	Engine Modification:	No	Pre-accident Condition:

## CONDITION OF TYRES

Front Tyre Size:	225/45R17	Rear Tyre Size:	225/45R17
Front Left Side:	Yokohama 6 mm	Rear Left Side:	Yokohama 6 mm
Front Right Side:	Yokohama 6 mm	Rear Right Side:	Yokohama 6 mm

The above values represent the remaining tyre treads depth

## COST OF CLAIMS

	Repairer's	Adjuster's	Difference	Diff %
Parts	8,924.86	4,215.68	4,709.18	52.76
Miscellaneous Items	0.00	0.00	0.00	
Labour	5,050.00	1,380.00	3,670.00	72.67
Paintwork Labour	0.00	0.00	0.00	
Towing	0.00	0.00	0.00	
<b>Calculated Gross Total (\$\$)</b>	<b>13,974.86</b>	<b>5,595.68</b>	<b>8,379.18</b>	<b>59.96</b>
<b>Approved Total (Overridden) (\$\$)</b>		<b>4,450.00</b>		
<b>(\$\$)</b>	13,974.86	4,450.00	9,524.86	68.16
<b>+ GST 7.00/7.00% (\$\$)</b>	978.24	311.50	666.74	68.16
<b>Nett Amount (\$\$)</b>	<b>14,953.10</b>	<b>4,761.50</b>	<b>10,191.60</b>	<b>68.16</b>

## INSPECTION

Date of Assignment:	03/12/2018	
Date Inspected:	07/12/2018	Inspected At:
		Abwin Service Pte Ltd (HQ)
		No. 8 Kaki Bukit Avenue 4, #07-48
		Premier@Kaki Bukit Gate 2
		Singapore 415875

Estimated Period of Repair: 4.0 days

Adjuster: MARCUS CHUA

Manager: VERON CHEN

*NOTE: This report represents our findings at the time and place of inspection stated herein. Such inspection has been carried out to the best of our knowledge and ability but any other liability under any other circumstances is hereby expressly excluded.*

## REPAIR DETAILS

### Reference

<b>Part Source:</b> MRM-SG	Version: 1.0 (Last Synchronised: 14 Jan 2019)
<b>Parts:</b> M1-MPV	VOLKSWAGEN TOURAN 1.4 TSI (A) (Catalogue:Merimen Singapore 1.0)
<b>Labour:</b> Repairer's	(Price-denominated Standard List)
<b>Print Code:</b>	(Unsubmitted, no print-code for SLQ6658G)
<b>Validity:</b>	These estimates are valid only if they contain the print code (above) on all estimate pages, running page numbers with the END OF ESTIMATES marker on the last estimate page
<b>Further Info:</b>	Items/values not in reference catalogue are prefixed with an asterisk *.

### Recommended Parts

No.	Qty	Part No.	Particulars	Condition	Repairer's	Amount
1	1		*TAILGATE	Badly Dented	2,087.45 FL	*2,087.45 FL
2	1		*TAILGATE EMBLEM LOGO	Necessary/Scratched	135.80 FL	*135.80 FL
3	1		*TAILGATE MOULDING	Necessary	405.40 FL	*405.40 FL
4	1		*TAILGATE REFLECTOR LH	Not Necessary	285.70 FL	*- FL
5	1		*TAILGATE REFLECTOR RH	Not Necessary	285.70 FL	*- FL
6	1		*TAILGATE EMBLEM TOURAN	Necessary	106.15 FL	*106.15 FL
7	1		*TAILGATE EMBLEM TSI	Necessary	75.05 FL	*75.05 FL
8	1		*REAR NUMBER PLATE TOP GARNISH	Not Necessary	680.90 FL	*- FL
9	1		*REAR BUMPER	Deformed/Torn	1,285.60 FL	*1,285.60 FL
10	1		*REAR BUMPER REFLECTOR RH	Not Necessary	95.10 FL	*- FL
11	1		*REAR BUMPER REFLECTOR LH	Not Necessary	95.10 FL	*- FL
12	1		*REAR BUMPER RETAINER RH	Not Necessary	65.50 FL	*- FL
13	1		*REAR BUMPER RETAINER LH	Not Necessary	65.50 FL	*- FL
14	1		*REAR BUMPER REINFORCEMENT	Not Necessary	668.65 FL	*- FL
15	1		*REAR BUMPER SPONGE	Not Necessary	105.60 FL	*- FL
16	1		*REAR END PANEL	Repair	956.88 FL	*- FL
17	1		*REAR END PANEL TOP GARNISH	Not Necessary	195.60 FL	*- FL
18	10		*REAR END PANEL TOP GARNISH CLIPS	Not Necessary	50.00 FL	*- FL
19	1		*RH TAILLAMP	Not Necessary	385.60 FL	*- FL
20	1		*LH TAILLAMP	Not Necessary	385.60 FL	*- FL
21	1		*REAR WINDSCREEN WEATHERSTRIP	Not Necessary	235.60 FL	*- FL
22	1		*REAR WINDSCREEN INNER SEAL	Necessary	65.00 FS	*40.00 FS
23	1		*REAR WINDSCREEN SEALANT	Necessary	65.00 FS	*40.00 FS
24	1		*REAR NUMBER PLATE & CASEING	Not Necessary	65.00 FS	*- FS
25	10		*REAR BUMPER CLIPS	Necessary	60.00 FS	*45.00 FS
26	1		*SET REAR BUMPER REVERSE SENSOR	Shorted	450.00 FS	*200.00 FS

F=Franchise part. S=SpcNett. L=ListItemDisc.

<b>Sub Total (\$\$)</b>	<b>9,357.48</b>	<b>4,420.45</b>
<b>- List Item Discount on L Items 5.00/5.00% (\$\$)</b>	<b>432.62</b>	<b>204.77</b>
<b>Total Parts (\$\$)</b>	<b>8,924.86</b>	<b>4,215.68</b>

Report was unsubmitted during this print-out.

## Recommended Miscellaneous Items

There are no new miscellaneous items selected.

## Recommended Labour

No	Particulars	Lab.Type	Repairer's	Amount
<b>Labour Items</b>				
1	TO STRAIGHTEN AND PANEL BEAT ACCIDENT AREAS	New	2,000.00	500.00
2	TO SPRAY PAINT ON AFFECTED AREAS	New	1,800.00	600.00
3	TO CHECK LIGHTING AND FOCUS TAILLAMP	New	250.00	20.00
4	TO APPLY TUFF KOTE ON AFFECTED AREAS	New	250.00	30.00
5	TO INSTALL REVERSE SENSOR & CHECK FUNCTIONALITY	New	250.00	50.00
6	TO TRANSFER & INSTALL TAILGATE COMPONENTS	New	250.00	60.00
7	TO REMOVE AND INSTALL REAR WINDSCREEN	New	250.00	120.00
Gross Labour Cost (S\$)			5,050.00	1,380.00

Report was unsubmitted during this print-out.

< END OF ESTIMATES >