

SINGAPORE ACCIDENT STATEMENT

IMPORTANT NOTICE

1. Please report correctly the details of the accident to speed up the claims process.
2. This Form must be completed by the Policyholder and/or the Authorised Driver.
3. Information provided must be as truthful and accurate as possible. Any wilful misrepresentation or withholding of material facts may allow insurance companies to repudiate policy liability.
4. The issue and acceptance of this Form by insurance companies is not an admission of policy liability on the part of the insurance companies.
5. **Any false reporting may be referred to the Police for investigation.**
6. This report will be forwarded by the insurers of the GIA Records Management Centre established by the General Insurance Association of Singapore (GIA) for archiving and that copies of this report will, for a fee, be made available upon application by interested parties.
7. By the lodgement of this report to the insurers, you hereby consent to the archiving of this report at the centre and to copies of the report being made available aforesaid.

ACCIDENT STATEMENT

Date Of Report	19/11/2018 15:20
Date Of Accident	17/11/2018 13:10
Exact Location Of Accident	X GRANGE RD - ORCHARD LINK
Country/State of Loss	SINGAPORE

DETAILS OF OWN VEHICLE

Vehicle Registration Number	SJQ5888P
-----------------------------	----------

Insured/Policyholder

Name Of Registered Owner	POPULAR RENT A CAR PTE LTD
Co Reg No	199608195Z
Email Address	NOEMAIL
Mobile Phone No	
Alternative Phone No	Office-67428888

Vehicle Particulars

Manufacturer	TOYOTA
Model	ALTIS
Exact Purpose for which vehicle was being used at time of accident	
Are you claiming under your own insurance policy for repair to your vehicle?	NO
If No, Please state action to be taken	THIRD PARTY
Vehicle Category	PRIVATE HIRE

Insurance Company

Name of Insurance Company	AIG ASIA PACIFIC INSURANCE PTE. LTD.
Type Of Coverage	COMPREHENSIVE
Fleet Policy	YES
Policy Number	100743167
Cover Note Number	

Driver

Name of Driver	KURODA YUSUKE
Passport No/FIN	G3002645X
Date Of Birth	07/10/1988
Occupation	INDOOR
Date Of Driving Pass	18/03/2014
Driving Experience	4 YEARS AND 7 MONTHS

Gender	MALE
Mobile Number	(LOCAL) +65-97733591
Fax Number	
Contact Number	
E-Mail Address	NOEMAIL
Address	11 PIONEER SECTOR 1 JURONG S628422
Postcode	
Was driver an employee of the Insured's Company	NO
If No, Relationship of the Driver with the Insured	OTHER - HIRER
Vehicle Registration Number of Driver's Own Vehicle	-
	-
	-
Insurance Company of Driver's Own Vehicle	-
	-
	-

General Information of the Accident

Type Of Accident	SIDE SWIPE
Weather Conditions	CLEAR
Road Surface	DRY

Other Information

Was any foreign vehicle involved in this accident?	NO
Number of vehicles involved in the accident	
Was any body injured in the Accident?	NO
Was any injured conveyed to hospital by ambulance?	
Was any other material or property damaged?	YES
I have been approached by unknown person(s) soliciting/offering accident claims assistance.	NO
Number of Passengers (Including Driver)	1

Details of Police Action

Was the accident reported to the police?	NO
If Yes, Please state which Police Station	
Was notice of intended Prosecution given?	NO
If Yes, against whom?	

Circumstances of Accident

REFER TO ATTACHED REPORT

Attachment(s)

Are accident photos available for attachment?	YES
Was there any video captured by Car Camera?	NO
Was there any audio recorded?	NO

DETAILS OF OTHER VEHICLE PROPERTY 1

Vehicle Registration Number	SHD34L
Vehicle Make/Model/Colour	
Details Of Properties	
Vehicle Category	TAXI
Name of Driver	YEO SWEE KIET
NRIC/Passport Number	S2157840A
Contact Number	NA

Address	NA
Postcode	NA
Insurance Company Name	NA
Nature Of Damage	
No. Of Passenger (Including Driver)	

Accident Photo

SKETCH PLAN

IMPORTANT NOTICE

1. Please report correctly the details of the accident to speed up the claims process.
2. This Form must be completed by the Policyholder and/or the Authorised Driver.
3. Information provided must be as truthful and accurate as possible. Any wilful misrepresentation or withholding of material facts may allow insurance companies to repudiate policy liability.
4. The issue and acceptance of this Form by insurance companies is not an admission of policy liability on the part of the insurance companies.
5. Any false reporting may be referred to the Police for investigation.
6. The report will be forwarded by the insurers of the GIA Records Management Centre established by the General Insurance Association of Singapore (GIA) for archiving and that copies of this report will for a fee be made available upon application by interested parties.
7. By the lodgment of this report to the Insurers, you hereby consent to the archiving of this report at the centre and to copies of the report being made available aforesaid.
8. **Consent under the Personal Data Protection Act (PDPA)**

I understand, acknowledge, agree and consent that:

- (a) My insurer, my workshop and the General Insurance Association of Singapore ("GIA") may/are permitted to collect, use, disclose and/or process my personal data/personal information set out in this [form] and any other personal information provided by me or possessed by my insurer (collectively the "Personal Information") and disclose and transfer such Personal Information to all insurer(s) who have insured vehicle(s) involved in this accident (all insurer(s) who have insured vehicle(s) involved in this accident shall be collectively referred to as the "Insurers"), the Insurers' lawyers/law firms, the Monetary Authority of Singapore and any relevant government agency/authority (such as the police), for the purpose(s) of:
 - (i) processing, handling and/or dealing with my claims including the settlement of the claims and any necessary investigations relating to the claims;
 - (ii) investigating the accident and/or my claims;
 - (iii) carrying out and/or dealing with my instructions or responding to any enquiries by me;
 - (iv) administering my claims (including the mailing of correspondence, statements, invoices, reports or notices to me, which could involve disclosure of certain personal data about me to bring about delivery of the same as well as on the external cover of envelopes/mail packages); and/or
 - (v) complying with applicable law in administering, processing, handling and/or dealing with my claims (collectively the "Purposes")
- (b) all insurer(s) who have insured vehicle(s) involved in this accident and the Insurers' lawyers/law firms, may/are permitted to collect, use, disclose and/or process my Personal Information for one or more of the above Purposes; and
- (c) my Personal Information may/can be disclosed by any of the Insurers and/or GIA to their third party service providers or agents (including their lawyers/law firms), which may be sited outside of Singapore, for one or more of the above Purposes.
- (d) my Personal Information will also be collected and used to compile claims history for the purpose of fraud detection, investigation and management in present and all future claims.
- (e) the information so collected under (d) above may be shared / disclosed:
 - (i) to all insurers and/or any other third parties that assist in evaluating, investigating, controlling or managing fraud, regulators, law enforcement and government agencies as reasonably required for the purposes stated, or
 - (ii) for complying with requirements under any regulations, laws or court orders.

Policyholder's Signature
Date & Time:

Driver's Signature
(If driver is not the policyholder)
Date & Time:

Reporting Centre Personnel's Signature
Name:
NRIC/FIN No.:

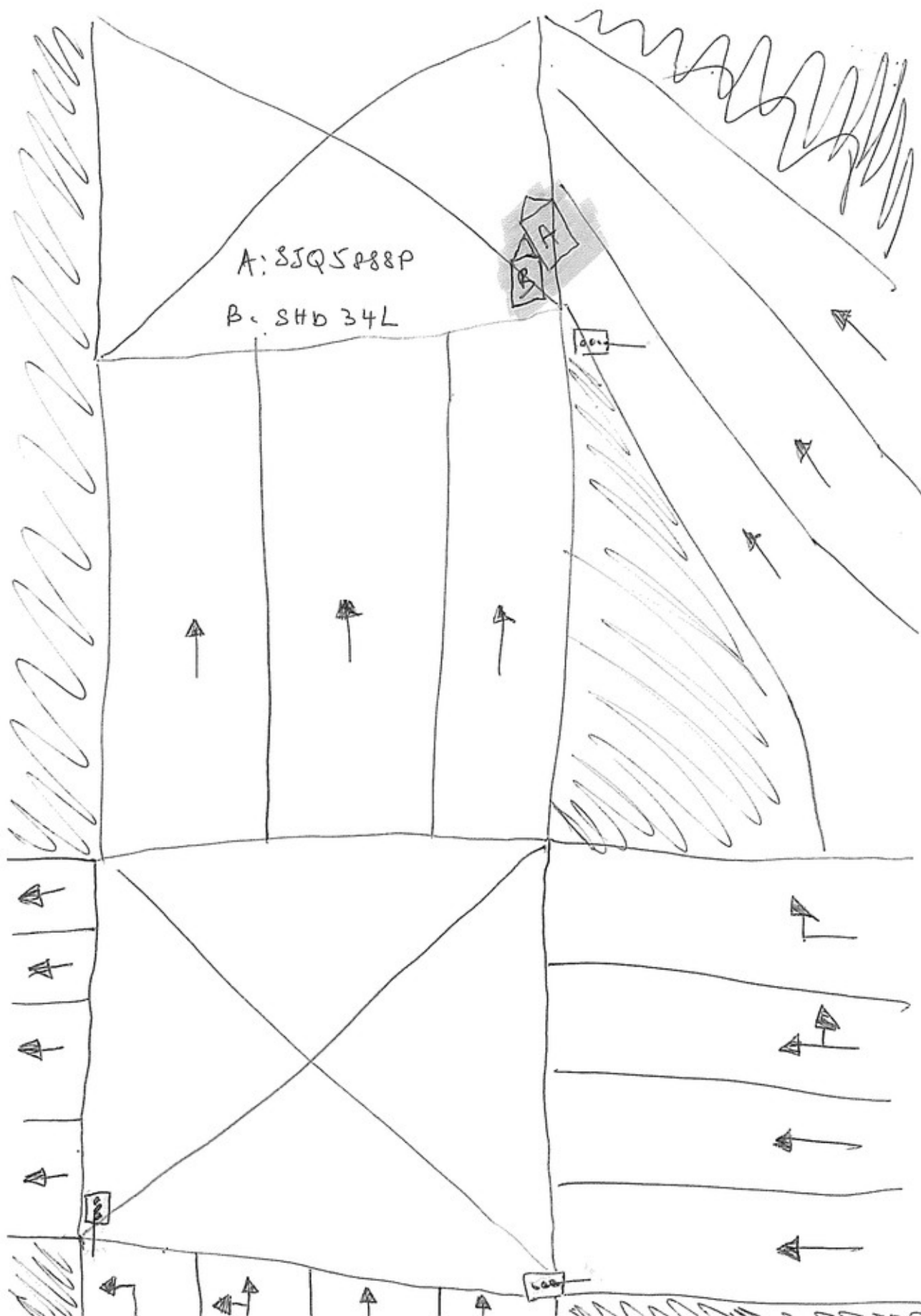

INTERVIEW FORM



AIG Asia Pacific Insurance Pte. Ltd.
AIG Building
78 Shenton Way
#07-16

MOTOR ACCIDENT INTERVIEW FORM

NAME (DRIVER) : KURODA YUSUKE
VEHICLE NUMBER : SJR 5888 P
DATE/TIME OF ACCIDENT : 17 NOV 18 / 1310
PLACE OF ACCIDENT : GRANGE ROAD TO ORCHARD LINK, 7-JUNCTION
THIRD PARTY VEHICLE (IF ANY) : SHD 34 L

WHERE DID YOU START YOUR JOURNEY AND WHERE WAS THE INTENDED
DESTINATION BEFORE THE ACCIDENT?

Potong Pasir -> Takashimaya

DID YOU DRINK ANY ALCOHOLIC DRINKS BEFORE YOU DRIVE ON THE DAY OF
THE ACCIDENT? IF YES, DID THE TRAFFIC POLICE CONDUCT ANY BREATHE-
ANALYSER TEST ON YOU? IF YES, WHAT IS THE RESULT?

No

WHAT IS THE TYPE OF COLLISION AND THE EXTENSIVENESS OF THE DAMAGES
TO ALL VEHICLES INVOLVED?

FROM TO SIDE LT

SJR 5888 P - FRONT / DRIVER DOOR

SHD 34 L - FRONT R/L

WERE YOU OR YOUR PASSENGER/S INJURED? IF INJURED, WHICH HOSPITAL?
WERE YOU TAKEN TO THE TRAFFIC POLICE FOR INVESTIGATION?

No

Name: YUSUKE KURODA

I Affirmed The Above Information Is Given To My Best Knowledge.

REPUBLIC OF SINGAPORE DRIVING LICENCE

License Number: **G3002645X**



Name: **KURODA YUSUKE**

Birth Date: **07 Oct 1988**

Issue Date: **18 Mar 2014**

Valid Till: **17 Mar 2019**

00228255H

EMPLOYMENT PASS

Employment of Foreign Manpower Act (Chapter 91A)

Republic of Singapore

Employer: **AKTIO PACIFIC PTE LTD.**

Name: **KURODA YUSUKE**

Occupation: **BUSINESS DEVELOPMENT MANAGER**

FIN: **G3002645X**

Date of Application: **20-10-2017**

Date of Issue: **06-11-2017**

Date of Expiry: **23-11-2019**



L8426982

NRIC & DL

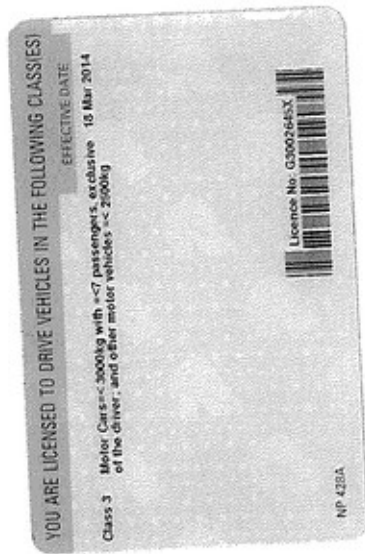

CERT



HOTLINE TEL: (65) 6419-3600
FAX: (65) 6415-3723

CERTIFICATE OF INSURANCE

MOTOR VEHICLES (THIRD-PARTY RISKS AND COMPENSATION) ACT (CHAPTER 189)
MOTOR VEHICLES (THIRD-PARTY RISKS AND COMPENSATION) RULES, 1960
ROAD TRANSPORT ACT, 1987 (MALAYSIA)
MOTOR VEHICLES (THIRD-PARTY RISKS) RULES, 1959 (MALAYSIA)

MZ-400

COMPREHENSIVE COMMERCIAL MOTOR	OWN DAMAGE EXCESS	S\$5,000.00 (1)
CERTIFICATE NO. 999994432/100743167-00000	WINDSCREEN EXCESS	S\$100.00
	(for policies with effect from 1st November 2002)	
	SUM INSURED	S\$1.00
	INSURING WITH COE/PARF	YES

- | | |
|---|----------------------------|
| 1) VEHICLE REGISTRATION NO. | SJQ5888P |
| 2) NAME OF INSURED | Popular Rent A Car Pte Ltd |
| 3) EFFECTIVE DATE OF THE COMMENCEMENT
OF INSURANCE FOR THE PURPOSES OF THE ACT | 1 Aug 2018 |
| 4) DATE OF EXPIRY OF INSURANCE | 31 Jul 2019 |
| 5) PERSON OR CLASSES OF PERSONS ENTITLED TO DRIVE * | |

Any person who is driving on the Insured's order or with their permission.

Provided that the person driving is permitted in accordance with the licensing or other laws or regulations to drive the Motor Vehicle or has been so permitted and is not disqualified by order of a Court of Law or by reason of any enactment or regulation in that behalf from driving the Motor Vehicle.

6) LIMITATION AS TO USE *

- Use for the carriage of passengers or goods in connection with the Insured's business.
Use for social, domestic, pleasure purposes and business purposes of any person whom the vehicle is hired.
The Policy does not cover
- 1) Use for racing, pace-making, reliability trial or speed-testing.
 - 2) Use whilst drawing a trailer except the towing (other than for reward) of any one disabled mechanically propelled vehicle.
 - 3) Use for the carriage of passengers for hire or reward by any person to whom the vehicle is hired.

LOSS OF USE NOT INCLUDED

* NAMED DRIVER N/A

HIRE PURCHASE COMPANY MayBank

* Limitations rendered inoperative by Section 8 of the Motor Vehicles (Third-Party Risks and Compensation) Act (Chapter 189) and Section 95 of the Road Transport Act, 1987 (Malaysia), are not to be included under these headings.

I / We hereby Certify that the policy to which this Certificate relates is issued in accordance with the provisions of the Motor Vehicles (Third-Party Risks and Compensation) Act (Chapter 189) and Part IV of the Road Transport Act, 1987 (Malaysia).

Issued At Singapore 27 Sep 2018

AIG ASIA PACIFIC INSURANCE PTE. LTD.

000064-000
DIRECT CLIENTS 01.4.95
AIG BUILDING
78 SHENTON WAY #07-16
SINGAPORE 079120

Authorized Representative

ORIGINAL

SSPRIUS

LEASE

POPULAR RENT A CAR PTE LTD
501 Guillemard Road Singapore 399840
Tel: 6742 8888 | Fax: 6743 3003
Co Reg No: 199608195Z
GST Reg No: 19-9608195-Z



VEHICLE RENTAL AGREEMENT

No. R13070003

Date: 25 Jul 2013

HIRER'S PARTICULARS

Name : AKTIO PACIFIC PTE LTD
Company Reg No : 199403950C
Gender : -
Address : 11 PIONEER SECTOR 1
JURONG
Singapore 628422
Driving License No : -
Passing Date : -
Date of Birth : -
Res / Office Tel : 6861 6777
Mobile : -
Hirer is driver : No

DRIVER'S PARTICULARS

Name (as in I/C) : ARAI HIROSHI
NRIC/Passport No : G5703969N
Gender : -
Address (Res) : 11 PIONEER SECTOR 1 SG 628
422
Driving Lic. No : G5703969N
Passing Date : -
Date of Birth : -
Res / Office Tel : -
Mobile : -

ADDITIONAL DRIVER'S PARTICULARS

Name (as in I/C) : -
NRIC/Passport No : -
Gender : -
Address (Res) : -
Driving Lic. No : -
Passing Date : -
Date of Birth : -
Res / Office Tel : -
Mobile : -

VEHICLE PARTICULARS

Vehicle No : SJQ5888P
Make & Model : TOYOTA COROLLA ALTIS 1
.6 AUTO
Date & Time Out : 25 Jul 2013 | 11:40
Hire Period Expiry : 01 Dec 2018 | 11:40
CDW (Collision Damage Waiver) : No
Malaysia Usage : -
Excess : 500 | M'sia -

PAYMENT	AMOUNT
Daily	0.00
Weekly	0.00
Monthly: 1 months x 1500.00	1,500.00
CDW	0.00
Delivery/Collection Service	0.00
Others	0.00
SUB TOTAL	1,500.00
GST	0.00
NETT AMOUNT	1,500.00
SECURITY DEPOSIT	0.00

Payment Mode : -
Bank : -
Expiry : -
I.D. : -
Rented out by : JANE HO
Sales ID : S004

IMPORTANT

- Only persons above 23 & below 60 years of age with more than 2 years driving experience, authorised, licensed and signing this agreement may drive the vehicle.
- The hirer shall be liable for excess charges for any late return at the rate shown per hour or per day, inclusive of CDW and/or PAI where applicable.
- Vehicle is strictly for singapore use only, and may not be driven out of Singapore without prior written consent of the company Popular Rent A Car Pte Ltd.
- In case of accident, the hirer shall report to rental office IMMEDIATELY. If there is any bodily injury, a police report must be made within 24 hours.

24-HOUR ROAD SIDE ASSISTANCE 67415828

Acknowledgement

I have read and agree to the terms and conditions of this agreement. If I have presented a charge/credit card for payment, I agree that all amounts payable under this agreement and for parking and traffic infringements may be billed to that account and my signature above will be considered to have been made on the charge/credit card voucher. All information I have given Popular Rent A Car Pte Ltd in connection with this agreement is true.

Hirer's Signature

Main Driver's
Signature

Rented out by
Staff Name: JANE HO

Accident Photo



Accident Photo



Accident Photo



Accident Photo



Accident Photo



Accident Photo



Accident Photo



Accident Photo



Accident Photo



Accident Photo



Accident Photo

