

ASS. REC. BY: Adrian REP: CS3/ASM18010846/Avb-1 post of Instruction:
 From (Person): Chen Kun Huan of ASM Date/Time: 07-11-2018
 Estimated Cost: _____ Bill to: _____
 OD / UN / WS / TP RES / OD RES / EVA / INV / MV / CS
 To Inspect Vehicle No: G8A 3738G Insured: XB 8022P
 at Workshop no: Holland nvd Tel: 9880 0121
 of Blk 1 Kaki Bukit Ave 6 # 02-24
 Policy No: _____ Claim No: S8M0A2UK
 Sum Insured: _____ Excess: _____
 Make of Veh: _____ D.O.A. 05 06 2018
 (Client's Record)
 CA / REV / REP. / REV 24 HRS WP: _____
 Date/Time: 14/06/2018 935am Person Contacted: Roger Vehicle: IN/OUT

Date/Time	Action/Instruction (X) Estimate
	<u>G8A 3738G - X</u>
	<u>XB 8022P - CS / N/A 12007434 / U/L 1</u> <u>14/6/2018</u>
<u>14/6/18</u>	<u>Dismantled</u>
<u>26/6/18</u>	<u>after repair</u>
<u>15/11/18</u>	<u>Submit LS \$ 8350 (Red. 2150, 20%), 12 days</u>

Note: mv: \$ 20K (EST) LTA: 15,000 (EST) NV: \$ 5000

RECEIVED 16 NOV 2018

Reference:

REF:

APR (AXA)

ASSIGNMENT

From: Date: 14/06/2018

Estimated Cost:

OD / TP / WS / TP RES / OD RES / EVA / INV / MV

To inspect Vehicle No:

6BA 3738A

at Workshop no:

Holland Motor

of

Insured:

Policy No:

Claims No:

Sum Insured:

Excess:

(Client's Record)

Make of Veh:

(Policy Condition)

Remark: The veh had commenced its
repair at the time of inspection.

N/S	O/S

Bal. or Market Value:

IDAC Accident Report: Consistent? : Yes or No

GIA / PR Seen: Consistent? : Yes or No

Est. Repairs: days Res: Yes or No

Lump Sum % 3 Val: Yes or No

CA / REV / REP. / 24 HRS

Date: Person Contacted:

Vehicle: IN / OUT

Veh. No: 6BA3738A Yr Regn: 2007 June

Type: ☒ M. Car / ☐ M. Cycle / ☐ Bus / ☐ Van / ☐ Lorry / ☐ Taxi / ☐ Prime Mover /

Truck / Trailer or

Make: Daihatsu Hijet CC: 659

Colour: White A/C: Insured / Std / NI / NA

Sp. Reading: 177800 T/Radio: Insured / Std / NI / NA

Eng. No:

C/No: 5320V0082042

Gen. Cond: ☒ Good / ☐ Fair / ☐ Poor / ☐ BurntSteering: ☒ In order / ☐ Jammed / ☐ Leaked / ☐ Burnt orBrake: ☒ In order / ☐ Jammed / ☐ Leaked / ☐ Burnt orMod: ☒ Nil / ☐ S/Rim / ☐ STD A/Rim or

Tyre Size F: 155R12C

R: 155R12C

BS / DUN / EXNOVA / GY / FS / LIZA / MIC / OHTSU / PIR / SUMI /

TOYO / ☒ YOKO or

Front

Rear

R/Bal: 06 mm R/Bal: 06 mm

L/Bal: 06 mm L/Bal: 06 mm

D.O.A. D.O.A. 14/06/18 @ 11:50am

Survey held at: Holland Motor

Des. of Damages: Frt / Rear ☒ O/S / ☒ N/S / ☐ U/C / ☐ Rooftop or

The U/C / Chassis frame / Body Structure affected due to collision

Date / Time Action / Instruction

TP AXA

COE Expiry: 06/06/22

21/6/18 Submit PRS Report.

Date/Time, File Pass to?

☐

Preli. Report

Days Of Repair:

1)

☐

Final Report

Resurvey No. of Trip:

Date/Time, File Return to?

2)

Add Fee:

☐

Site trip \$

☐

Interview \$

☐

Text review \$

☐

Workshop \$

Report Format:

Lump Sum / LB: \$

Survey Fee:

Transportation:

F...S+R... \$

F...R... \$

F...R... \$

F...R... \$

F...R... \$

100

100



TO CONDUCT PAPER RI

Type

🔗 Question

Message

PLS CONDUCT PAPER RI AND LET US HAVE THE REPORT ASAP.

Reply



VEHICLE CLAIMS SPECIALIST PTE LTD UEN No. 201802773H
6A SHENTON WAY #04-02 to 08 OUE DOWNTOWN GALLERY
SINGAPORE 068815
Email: VCSSG01@GMAIL.COM

60108274

Your Reference: S8M00JUKMC/TE

3019508316 - - -

Our Reference: VCS/GBA 3738G/HM/PD

WITHOUT PREJUDICE

Date: 5th September 2018

AXA INSURANCE PTE LTD

8 Shenton Way
#24-01 AXA Tower
Singapore 068811

BY HAND



Attention: Motor Claims Department

Dear Sirs

ACCIDENT INVOLVING VEHICLES NOS. GBA 3738G AND XB 8022P ALONG JALAN BAHAR ON 5th JUNE 2018 AT ABOUT 1500 HOURS

We represent for **POH MENG ENGINEERING PTE LTD**, the owner of motor vehicle **GBA 3738G**.

We are instructed by **POH MENG ENGINEERING PTE LTD**, to claim damages against your insured in connection with a road traffic accident on 5th June 2018 at about 1500 hours along Jalan Bahar involving our customer's vehicle registration number GBA 3738G and vehicle registration number XB 8022P driven by your insured at the material time.

We are instructed that the accident was caused by your insured's negligent driving and/or management of your insured's vehicle. As a result of the accident, our customer's vehicle was damaged and our client has been put to loss and expenses, particulars of which are as follows:

(a)	Repair Cost	\$ 10,500.00
(b)	Loss of Use (\$100 x 15 days)	\$ 1,500.00
(c)	Survey Fee	\$ 500.00
(d)	LTA / GIA search fee	\$ 37.00
(e)	Incidentals	\$ 100.00
(f)	Costs and disbursements	\$ 900.00
TOTAL		<u>\$S 13,537.00</u>





VEHICLE CLAIMS SPECIALIST PTE LTD UEN No. 201802773H

6A SHENTON WAY #04-02 to 08 OUE DOWNTOWN GALLERY

SINGAPORE 068815

Email: VCSSG01@GMAIL.COM

Page 2

Your Reference: S8M00JUKMC/TE

Our Reference: VCS/GBA 3738G/HM/PD

Date: 5th September 2018

A copy each of the supporting documents is enclosed:

- (a) Accident report / Police report of our client;
- (b) Repair Bill from Halland Motor Pte Ltd;
- (c) LTA search of your insured vehicle;
- (d) Invoice and Survey Report, inclusive of colour copy photographs of our client's damaged vehicle

Please note that you should send us an acknowledgement of receipt of this letter within 14 days of your receipt of this letter, failing which our client will have no alternative but to refer the matter to solicitors commence legal proceedings against your insured without further notice to you or your insured. As we aware, your costs in this case will escalate.

Please also note that if your insured has a counterclaim against our client arising out of the accident, you are also required to send us a letter giving full particulars of the counterclaim together with all relevant supporting documents within 8 weeks of your receipt of this letter.

Yours faithfully



Encs

Enquire Vehicle & Owner Information (Vehicle No. XB8022P As At 05 Jun 2018 / 15:00:00)

Law Firm Search Details

Search Reason: Insurance claim in relation to traffic accident

Law Firm Case No.: GBA3738G/HM/PD

Current Owner Details

Owner ID Type: Company

Owner ID: 198103195N

Owner Name: UBTS PTE LTD

Registered Address Type: Private Residential (Condo Apt or House) / Shopping / Office Complexes

Registered Block/House No.: 12

Registered Street Name: TANJONG PENJURU CRESCENT

Registered Unit No.: -

Registered Building Name: -

Registered Postal Code: 608975

Current Vehicle Details

Vehicle No.: XB8022P

Make Description/Model: SCANIA / P124LA4X2NA

Insurance Company Name: AXA INSURANCE PTE LTD



Thank you

Hariram Gopalakrishnan has successfully logged out.

Your last login date and time was 11 Jun 2018, 15:14:12.

To return to ONE.MOTORING, please click [here](#)

For security reasons, please **CLEAR YOUR CACHE** after each session.

Session Transaction History

S/No.	Asset Type	Asset ID	Asset Owner ID	Transaction Type	Transaction Amount (\$)	Log Date/Time
1	Vehicle	XB8022P	-	18.19 Enquire Veh Owner Info (Others) by Law Firm	7.49	11 Jun 2018 / 15:15:23

> Back to OneMotoring

Enquire PARF/COE Rebate for Registered Vehicle

Vehicle Owner Particulars	
Owner ID Type:	Company
Owner ID:	2127W
Vehicle Details	
Vehicle No.:	GBA3738G
Vehicle to be Exported:	Yes
Intended Deregistration Date:	14 Nov 2018
Vehicle Make:	DAIHATSU
Vehicle Model:	HIJET 660 M
Primary Colour:	White
Manufacturing Year:	2007
Engine No.:	EF0067107
Chassis No.:	5320V0082042
Maximum Power Output:	-
Open Market Value:	\$12,985.00
Original Registration Date:	07 Jun 2007
First Registration Date:	07 Jun 2007
Transfer Count:	1
Actual ARF Paid:	\$650.00
Intended PARF Rebate Details	
PARF Eligibility:	No
PARF Eligibility Expiry Date:	-
PARF Rebate Amount:	\$0.00
Intended COE Rebate Details	
COE Expiry Date:	06 Jun 2022
COE Category:	C - Goods Vehicle & Bus
COE Period(Years):	5
PQP Paid:	\$18,757.00
COE Rebate Amount:	\$13,363.00
Total Rebate Amount:	\$13,363.00
Message	
Please note that all future COE renewals for this vehicle can only be for a 5-year period, subject to the statutory lifespan (if applicable) of the vehicle.	

The information contained herein is correct as at 14 Nov 2018

OK

OTR: 1.05/6/18

PARF: NIL

$$\begin{aligned} \text{COE} &= \text{OP} \times \frac{621}{5 \times 1000} \\ &= 18757 \times \frac{621}{5000} \\ &= 15005.6 \end{aligned}$$

$$\begin{aligned} \text{TRA} &= \text{PARF} + \text{COE} \\ &= 15005.6 \end{aligned}$$

$$\therefore \text{TRA} = 15005$$

MV: 20K

PV: 15K

Nett: 5K

1. This report is a summary of the details of the accident to speed up the claims process.
 2. This form must be completed by the Policyholder and/or the Authorised Driver.
 3. Information provided must be as truthful and accurate as possible. Any wilful misrepresentation or withholding of material facts may allow insurance companies to equate to policy ability.
 4. The content or explanation of this form by insurance companies is not an admission of policy liability on the part of the insurance companies.
 5. Any false reporting may be referred to the Police for investigation.
 6. This report will be forwarded by the insurers of the GIA Records Management Centre established by the General Insurance Association of Singapore (GIA) for archiving and that copies of this report will, for a fee, be made available upon application by interested parties.
 7. By the submission of this report to the insurers, you hereby consent to the archiving of this report at the centre and to copies of the report being made available afterwards.

ACCIDENT STATEMENT

Date Of Report 06/06/2018 10:15
 Date Of Accident 05/06/2018 15:00
 Exact Location Of Accident JALAN BAHAR
 Country/State Of Loss SINGAPORE

DETAILS OF OWN VEHICLE

Vehicle Registration Number GBA3738G
 Insured/Policyholder
 Name Of Registered Owner POH MENG ENGINEERING PTE LTD
 Co Reg No 199702127W
 Email Address NOEMAIL
 Mobile Phone No
 Alternative Phone No OFFICE-64574373

Vehicle Particulars

Manufacturer DAIHATSU
 Model HIJET
 Exact Purpose for which vehicle was being used at time of accident COMMERCIAL USE

Are you claiming under your own insurance policy for repair to your vehicle? NO

If No, Please state action to be taken THIRD PARTY

Vehicle Category COMMERCIAL VEHICLE

Insurance Company

Name of Insurance Company ALLIED WORLD ASSURANCE COMPANY, LTD
 Type Of Coverage COMPREHENSIVE
 Fleet Policy NO
 Policy Number BVFCSB0012711802
 Cover Note Number

Driver

Name of Driver ABIMANYU AMBIKAPATHI
 Passport No/FIN G5063311Q
 Date Of Birth 16/05/1988
 Occupation OUTDOOR
 Date Of Driving Pass 27/01/2015
 Driving Experience 3 YEARS AND 4 MONTHS
 Gender MALE
 Mobile Number (LOCAL) +65-88227216
 Fax Number
 Contact Number
 Email Address NOEMAIL

Was driver an employee of the Insured's Company YES
 Relationship of the Driver with the Insured
 Vehicle Registration Number of Driver's Own Vehicle

Insurance Company of Driver's Own Vehicle

General Information of the Accident

Type Of Accident COLLIDED INTO PARKED VEHICLE
 Weather Conditions CLEAR
 Road Surface DRY

Other Information

Was any foreign vehicle involved in this accident? NO
 Number of vehicles involved in the accident 2
 Was any body injured in the Accident? NO
 Was any injured conveyed to hospital by ambulance? NO
 Was any other material or property damaged? YES
 Have been approached by unknown person(s) soliciting offering accident claims assistance. NO
 Number of Passengers (Including Driver) 1

Details of Police Action

Was the accident reported to the police? NO
 If Yes, Please state which Police Station
 Was notice of intended Prosecution given? NO
 If Yes, against whom?

Circumstances of Accident

THE INCIDENT TOOK PLACE ON THE ABOVEMENTIONED LOCATION. AFTER SECURING MY VEHICLE. I THEN LEFT TO DO MY WORK. LATER ON I WAS INFORMED BY THE SITE SUPERVISOR THAT A TRAILER WITHOUT DRIVER INSIDE MOVED TOWARD MY PARKED VEHICLE DIRECTION AND THUS COLLIDED ONTO MY VEHICLE FRONT AND RIGHT SIDE. WHICH RESULTED TO SUSTAIN DAMAGED. THE SITE SUPERVISOR NAME IS MR JAMAL Hp No:84626760

Attachment(s)

Are accident photos available for attachment? YES
 Was there any video captured by Car Camera? NO
 Was there any audio recorded? NO

DETAILS OF OTHER VEHICLE PROPERTY 1

Vehicle Registration Number XB8022P
 Vehicle Make/Model/Colour
 Details Of Properties
 Vehicle Category COMMERCIAL VEHICLE
 Name of Driver
 NRIC/Passport Number
 Contact Number
 Address
 Postcode
 Insurance Company Name
 Nature Of Damage
 No. Of Passenger (Including Driver)

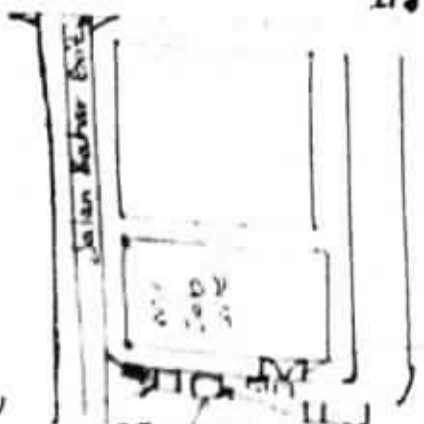

PIE



Turns →

DESCRIBE CIRCUMSTANCES OF THE ACCIDENT

Ref
E. P. Ho

A large rectangular area with horizontal lines, intended for a detailed description of the accident circumstances. A circular stamp of 'HO WING ENGINEERING PTE. LTD.' is visible on the left side of this area.

DECLARATION

I/We declare that the above particulars are true in every respect.



Policyholder's Signature
Date & Time:

Driver's Signature
(if driver is not the policyholder)
Date & Time:

06 JUN 2018

IDAC KAKI BUKIT (VAQ)

23 KAKI BUKIT AVE 4
KAKI BUKIT
67410007 FOM 67410006
KAKI BUKIT AVE 4

SKETCH PLAN



IMPORTANT NOTICE

1. Please report correctly the details of the accident to speed up the claims process.
2. This form must be completed by the Policyholder and/or the Authorised Driver.
3. Information provided must be truthful and accurate as possible. Any wilful misrepresentation or withholding of material facts may result in the insurer's right to repudiate policy liability.
4. The issuance and completion of this form by insurance companies is not an admission of policy liability on the part of the insurer.
5. Any false reporting may be referred to the Police for investigation.
6. The report will be forwarded by the insurers of the GIA Records Management Centre established by the General Insurance Association of Singapore (GIA) for archiving and that copies of this report will for a fee be made available upon application by interested parties.
7. By the lodging of this report to the insurers, you hereby consent to the archiving of this report at the centre and to copies of the report being made available elsewhere.
8. Consent under the Personal Data Protection Act (PDPA)

I understand, acknowledge, agree and consent that

 - (a) My insurer, my workshop and the General Insurance Association of Singapore ("GIA") may/are permitted to collect, use, disclose and/or process my personal data/personal information set out in this [form] and any other personal information provided to me or possessed by my insurer (collectively the "Personal Information") and disclose and transfer such Personal Information to all insurer(s) who have insured vehicle(s) involved in this accident (all insurer(s) who have insured vehicle(s) involved in this accident shall be collectively referred to as the "Insurers"), the Insurers' lawyers/law firms, the Monetary Authority of Singapore and any relevant government agency/authority (such as the police), for the purpose(s)
 - (i) processing, handling and/or dealing with my claims including the settlement of the claims and any necessary investigations relating to the claims;
 - (ii) investigating the accident and/or my claims;
 - (iii) carrying out and/or dealing with my instructions or responding to any enquiries by me;
 - (iv) administering my claims (including the mailing of correspondence, statements, invoices, reports or notices to me, which could involve disclosure of certain personal data about me to bring about delivery of the same as well as on the external cover of envelopes/mail packages); and/or
 - (v) complying with applicable law in administering, processing, handling and/or dealing with my claims (collectively the "Purposes")
 - (b) all insurer(s) who have insured vehicle(s) involved in this accident and the Insurers' lawyers/law firms, may/are permitted to collect, use, disclose and/or process my Personal Information for one or more of the above Purposes; and
 - (c) my Personal Information may/can be disclosed by any of the Insurers and/or GIA to their third party service providers or agents (including their lawyers/law firms), which may be sited outside of Singapore, for one or more of the above Purposes.
 - (d) my Personal Information will also be collected and used to compile claims history for the purpose of fraud detection, investigation and management in present and all future claims.
 - (e) the information so collected under (d) above may be shared / disclosed:
 - (i) to all insurers and/or any other third parties that assist in evaluating, investigating, controlling or managing fraud, regulators, law enforcement and government agencies as reasonably required for the purposes stated, or
 - (ii) for complying with requirements under any regulations, laws or court orders.



06 JUN 2018

Policyholder's Signature
Date & Time

Driver's Signature
(If driver is not the policyholder)
Date & Time

IDAC KAKI BUKIT (VAC)

23 Kaki Bukit Ave 4

Reporting Centre, Singapore 416983

Name:
Tel: 67416697 Fax: 67492308

Email: vacko@sinonet.com.sg

REPORT OF A TRAFFIC ACCIDENT

Date/Time Report Made:
05/06/2018 20:57

Video Report No.:
T/20180606/2173

Station Diary No.:

Informant's Particulars

Name of Informant: ABIMANYU AMBIKAPATHI		Address: APT BLK 940 JURONG WEST ST 91 #11-441 HDB JURONG WEST SINGAPORE 640940	
ID Type / ID No.: FIN NO / G50633110		Contact No.: Home/Office: Mobile: 88227216	
Nationality: INDIAN		Email:	
Sex: Male	Age: 30	Date of Birth: 16/05/1988	Type of Informant: Driver
Race: Indian		Language: English	Institution / School Name:
Occupation: Other assistant engineers		Driving Licence Information: Class: 2B,3 Date of Expiry:	

General Information of the Accident

Type of Accident: Non-Injury Others	Drink Drive: No	Date/Time of Accident: 05/06/2018 15:00	Type of Location: CONSTRUCTION SITE
Location: Along Road 1 JALAN BAHAR			
NEAR CONSTRUCTION SITE			
Weather: Clear	Road Surface:	Road Speed Limit:	
Traffic Flow: Two Way	Traffic Control: Not Controlled	Traffic Volume: Light	
Type of Collision: Moving Vehicle Against - Parked Vehicle			Anyone conveyed by ambulance: No

Details of Vehicle Involved

Vehicle No.	Type	Make	Model	Color	Condition	No of Passenger
GBA3738G	Van	DAIHATSU	HIJET 660 MM	White	Slightly Damaged	0
XB8022P	Trailer	SCANIA	P124LA4X2 NA	Red	Slightly Damaged	0

Details of Person Involved

Any Pedestrian Involved: No	
No. of Pedestrians Injured: NIL	Use of Pedestrian Crossing: NA

Degree of Injury	NIL
------------------	-----



**SINGAPORE
POLICE FORCE**



T/20180606/2211

Police Station Of Origin:
Traffic Police Division HQ
10 Ubi Avenue 3 SINGAPORE 408865
Tel No: 65470000

3 of 4

Report No. T/20180606/2211

CONTINUATION OF REPORT

Brief Details.

On 05/06/2018 at about 1500hrs, I parallel parked my company van GBA3738G beside the construction site. No one was in the van. Subsequently, one of the trailer XB8022P which was near the company van rolled to the van and hit the front of the vehicle. The van front bumper and side of the van sustained a crack. The driver of the trailer came to us and we exchanged particulars and he informed us to claim insurance. No one was injured during the whole incident.

This is the first time such an incident happened.

I am lodging this report as instructed by my company for insurance claim purposes.



**SINGAPORE
POLICE FORCE**

Police Station Of Origin
Traffic Police Division HQ
1000A Avenue 5 SINGAPORE 408865
Tel No: 65475000



T/20180606/2211

4 of 4

Report No. T/20180606/2211

CONTINUATION OF REPORT

Sketch Plan

Informant is not able to provide sketch plan

IMPORTANT: Please attach a copy of your vehicle's Insurance Certificate to this report. If you don't have the certificate with you now, please fax a copy to 65474885 stating the report number as reference.

Signature Of Officer Recording The Report:

TP

ZENG Z CONG

Signature Of Informant:

Signature Of Interpreter:

*Not applicable

Date/Time:

06/06/2018 20:57

Officer In Charge Of Case:

TP GIA

Staff Sgt TANG SIEW PING

Contact No.: 65476430

Classification Of Case:

SINGAPORE
POLICE FORCE

Authentication Stamp

12-58

Chie
16/18

HALLAND MOTOR SERVICE

No.1 Kaki Bukit Ave 6 #02-24 AutoBay, Singapore 417883

TEL / FAX : 67472580

Vehicle No : GBA 3738G Date: 10-Sep-18
Accident Date : 5-Jun-18
Name : POH MENG ENGINEERING PTE LTD
Address : C/o: Halland Motor Service
No. 1 Kaki Bukit Ave 6 #02-24
AutoBay, Singapore 417883

Description

Amount (\$\$)

Lump Sum Repair Costs

\$ 10,500.00

Singapore Dollars: Ten Thousand and Five Hundred Only.

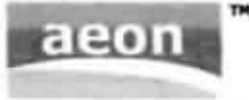

INVOICE

TO : POH MENG ENGINEERING PTE LTD
C/O: HALLAND MOTOR SERVICE
AUTO BAY @KAKI BUKIT
NO. 1 KAKI BUKIT AVE 6 #02-24
SINGAPORE 417883

Invoice No.: 618/HM680
Date: 30-Jun-2018

PARTICULARS

Vehicle Registration No.: GBA 3738 G
Date of Loss: 05-Jun-2018
Date of Assessment: 11-Jun-2018

SERVICES

FEES

1. Assessment with report Photographs -
Including films, developing, storage and Transport. \$500.00

TOTAL \$500.00

SINGAPORE DOLLARS FIVE HUNDRED ONLY

We would appreciate your cheque crossed and made payable to:
"AEON AUTO CONSULTANTS LLP" with our invoice no. written on the back of the cheque.

AEON AUTO CONSULTANTS LLP



AEON AUTO CONSULTANTS LLP

50 Chin Swee Road #09-04 Thong Chai Building Singapore 169874
Telephone +65 97687958 Facsimile +65 68264112 Email amas@aeonac.com
Reg. No. LL0701273L (registered with limited liability)

AUTOMOBILE ASSESSMENT REPORT

TO: POH MENG ENGINEERING PTE LTD
C/O: HALLAND MOTOR SERVICE
AUTO BAY @KAKI BUKIT
NO. 1 KAKI BUKIT AVE 6 #02-24
SINGAPORE 417883

Our Reference: 618/HM680
Date: 30-Jun-2018

ASSESSMENT OF VEHICLE NO. GBA 3738 G

DATE OF LOSS: 05-Jun-2018

We have carried out a physical assessment at HALLAND MOTOR SERVICE,
Auto Bay @Kaki Bukit No. 1 Kaki Bukit Ave 6 #02-24, Singapore 417883, according to your instruction
on 11-Jun-2018 and are pleased to submit our report herewith.

1. VEHICLE PARTICULARS

Registration No.: GBA 3738 G
Make & Model: DAIHATSU HIJET 660 M
Year of Registration: 2007
Engine Capacity: 659
Chassis No.: S320V0082042
Engine No.: EF0067107
Colour: WHITE
Mileage (km): 177800

2. VEHICLE CONDITION

Body Paint: GOOD
Steering: SERVICEABLE
Foot Brake: SERVICEABLE
Parking Brake: SERVICEABLE
Modification: NIL

3. TYRE PARTICULARS & CONDITION

Front
RH Make/Size/Thread: YOKOHAMA 195R14C – 70%
LH Make/Size/Thread: YOKOHAMA 195R14C – 70%

Rear
RH Make/Size/Thread: YOKOHAMA 195R14C – 70%
LH Make/Size/Thread: YOKOHAMA 195R14C – 70%

4. DESCRIPTION OF DAMAGE

At the time of the inspection, the vehicle sustained damages to the L/R portion.

5. REMARKS

Market Value: Na
Salvage Value: Na
Repair Limit: Na

Estimated Amount: \$15,778.84
Adjusted Amount: \$14,313.10
Lump Sum: \$10,500.00
Estimated Repair Days: 12 days

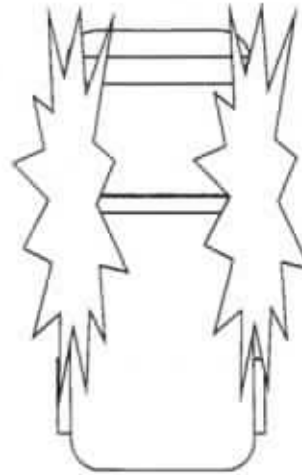

Pursuant to your instruction, we have **NOT AUTHORISED** repair.

The assessment was conducted on a "Without Prejudice" basis.

If we are not notified of anything to the contrary within **14 days** from the date hereof, this report shall be treated as correct.

Disclaimer

This report is intended for the exclusive use of the addressee solely in relation to the loss occurrence in which the assessed vehicle is involved. No liability or responsibility whatsoever shall be held by Aeon Auto Consultants LLP for any reliance on this report by any third party.

GBA 3738 G

PARTS (LIST ITEMS)

Qty	Description	Condition	Workshop's Estimate	Our Assessment
1	FRONT BONNET	Bent	464.05	✓ 464.05
1	FRONT BONNET 'LOGO' EMBLEM	Necessary	20.45	✓ 20.45
2	FRONT BONNET HINGES L/R	Bent	53.50	+ 53.50
1	FRONT BONNET MECHANISM LOCK	Bent	49.50	+ 49.50
1	FRONT BONNET RUBBER GUIDE STOPPER	Bent	5.95	+ 5.95
1	FRONT BONNET WEATHER STRIP	Cut	26.20	+ 26.20
2	FRONT HEADLAMP L/R	Cracked	624.00	✓ 624.00
4	FRONT HEADLAMP CLIPS	Necessary	26.00	26.00
1	FRONT BUMPER	Cracked	880.65	✓ 880.65
1	FRONT BUMPER REINFORCEMENT	Bent	278.45	✓ 278.45
2	FRONT BUMPER SIDE RETAINER L/R	Bent	90.70	✓ 90.70
2	FRONT FENDER L/R	Bent	712.60	✓ 712.60
2	FRONT FENDER INNER SHIELD L/R	Cracked	90.70	+ 90.70
1	FRONT RH SUPPORT PANEL	Bent	261.40	+ 261.40
1	FRONT LOWER SUPPORT PANEL	Repair	150.20	+ -
1	HORN	Reuse	43.55	+ -
1	RADIATOR	Reuse	480.65	+ -
2	FRONT DOOR R/L	Bent	1,221.30	✓ 1,221.30
1	FRONT DOOR MIRROR LH	Cracked	281.70	✓ 281.70
2	FRONT DOOR INNER TRIM BOARD L/R	Cracked	662.75	+ 662.75
2	FRONT DOOR MECHANISM LOCK L/R	Bent	285.60	✓ 285.60
4	FRONT DOOR RUBBER GUIDE STOPPER L/R	Bent	42.20	+ 42.20
2	FRONT DOOR WINDOW OUTER MOULDING L/R	Necessary	78.60	+ 78.60
2	FRONT DOOR CHECKER L/R	Bent	56.80	+ 56.80
2	FRONT DOOR WEATHER STRIP L/R	Cut	147.60	✓ 147.60
1	CENTER DOOR PILLAR LH	Bent	352.20	✓ 352.20
1	ROCKER PANEL LH	Repair	241.90	+ -
1	PETROL LID COVER RH	Repair	124.80	+ -
1	PETROL LID MECHANISM LOCK RH	Repair	48.00	+ -
2	REAR SLIDING DOOR L/R	Bent	1,394.60	✓ 1,394.60
2	REAR SLIDING DOOR ELECTRONIC LOCK L/R	Bent	292.00	✓ 292.00
2	REAR SLIDING DOOR GUARD (FEMALE) L/R	Bent	136.20	+ 136.20
2	REAR SLIDING DOOR GUARD (MALE) L/R	Bent	118.80	+ 118.80
2	REAR SLIDING DOOR INNER TRIM BOARD L/R	Cracked	418.20	+ 418.20
2	REAR SLIDING DOOR OUTER HANDLE L/R	Cracked	133.30	+ 133.30
2	REAR SLIDING DOOR REGULATOR L/R	Bent	323.65	+ 323.65
2	REAR SLIDING DOOR ROLLER GUIDE (CENTER) L/R	Bent	36.20	✓ 36.20
2	REAR SLIDING DOOR ROLLER GUIDE (LOWER) L/R	Bent	57.20	28.60 57.20
2	REAR SLIDING DOOR ROLLER GUIDE (UPPER) L/R	Bent	48.20	+ 48.20
2	REAR SLIDING DOOR WEATHER STRIP L/R	Cut	168.80	✓ 168.80
2	REAR SLIDING DOOR WINDOW OUTER MOULDING L/R	Necessary	158.00	79 158.00
1	REAR SLIDING DOOR WINDOW GLASS RH	Cracked	423.80	✓ 423.80
1	REAR BUMPER	Cracked	623.25	+ 623.25
2	REAR BUMPER SIDE RETAINER L/R	Bent	40.90	+ 40.90
			12,175.10	11,086.00
Less 15% discount			1,826.27	1,662.90
Parts Total:			10,348.84	9,423.10

GBA 3738 G

SPECIAL NETT ITEMS

1	FRONT BUMPER CLIPS - SET	Necessary	30.00	✓	30.00
2	FRONT DOOR 'COMPANY DETAIL' STICKER L/R	Necessary	100.00	30	100.00
2	FRONT FENDER INNER SHIELD CLIPS L/R - SETS	Necessary	60.00	x	60.00
2	FRONT DOOR INNER TRIM BOARD CLIPS L/R - SETS	Necessary	60.00	x	60.00
2	REAR SLIDING DOOR 'COMPANY' STICKER L/R	Necessary	600.00	400	600.00
2	REAR SLIDING DOOR INNER TRIM BOARD CLIPS L/R - SET	Necessary	60.00	✓	60.00
1	REAR RH SLIDING DOOR GLASS SEALANT	Necessary	60.00	40	60.00
1	REAR BUMPER CLIPS - SET	Necessary	30.00	x	30.00
Special Nett Total :			1,000.00		1,000.00

LABOUR

S/N	Description	Workshop's Estimate	Our Assessment
1	To provide towing charge.	50.00	✓ 50.00
2	To remove, reinstall electrical wiring harness, check lighting and resetting headlamp focussing.	120.00	30 100.00
3	To remove, reinstall top trim upholstery, cushion seat, trim garnish, trim liner carpet.	140.00	80 120.00
4	To remove, install L/R front door glass, regulator gear, motor, railing, channel, trim board, mechanism lock and handle.	300.00	160 260.00
5	To transfer L/R rear sliding door glass, regulator gear, motor, railing, channel, trim board, mechanism lock and handle.	300.00	160 260.00
6	To re-spray painting on the change bodyparts, repair portion, and where consistent to the accident.	1,600.00	1300 1,400.00
7	To provide labour, workmanship to change the above damaged bodyparts, repair, re-construct and re-align body structure, body alignments and damaged consistent to the accident.	1,800.00	1400 1,600.00
8	To apply anti-rust chemical on repaired and replaced panel.	120.00	60 100.00
Labour Total :		4,430.00	3,890.00
TOTAL (PARTS & LABOUR) \$		15,778.84	14,313.10

The workshop has agreed to undertake the repair on a Lump Sum basis.

The final adjusted Lump Sum contract amount is

\$10,500.00

(SINGAPORE DOLLARS TEN THOUSAND FIVE HUNDRED ONLY)



Amas Ong
Automobile Assessor

total: 10457.05
4/c 8350
12 Days

AUTO BAY @KAKI BUKIT
NO. 1 KAKI BUKIT AVE 6 #02-24
SINGAPORE 417921
TEL/FAX: 6747 2580 H/P: 9880 0121

Our Reference:	600E HIJET/GBA3738A
Date:	30-Jun-2018
Vehicle Num:	GBA 3738 G
Make/Model:	DAIHATSU HIJET 660 M
Chassis No.:	S320V0082042
Engine No.:	EF0067107
Accident Date:	05-Jun-2018

[illegible]



Your Ref: S8M00JUK

Date: 15th Nov 2018

Our Ref: CS3/ASM18010846/Avbe2-1

M/s AXA Insurance Pte Ltd

8 Shenton Way #24-01
AXA Tower
Singapore 068811
(The Motor Claims Department)

Attn : Chan Kian Chuan

Dear Sir / Madam,

**EVALUATION REPORT (PAPER SURVEY) OF ACCIDENT VEHICLE NO: GBA 3738G
INSURED VEHICLE: XB 8022P
ACCIDENT DATE: 05/06/2018**

We thank you for your instruction on 07/11/2018.

We acknowledge receipt of the following documents:-

- a) Automobile Inspection Report of GBA 3738G from M/s Aeon Auto Consultants LLP.
- b) Singapore Accident Statement and Police Report of Vehicles GBA 3738G.
- c) Final Repair Bill of from Halland Motor Service.
- d) Colour damaged vehicle photographs of GBA 3738G.

Pre-Repair Inspection Date : 14/06/2018 at M/s Halland Motor Service, No.1 Kaki Bukit Ave 6 #02-24, Singapore 417883.

Based on the documents received from you, we have evaluated the damages of the vehicle and have the following comments:-

1. Information Recorded: -

Registration Number	: GBA 3738G
Make & Model	: Daihatsu Hijet 660 M
Year of Registration	: 2007
Chassis Number	: S320V0082042
Engine Capacity	: 659 cc

2. We recommend that the repairs of the entire damage require about 12 (Twelve) working days to complete.
3. We hereby provide our recommendations on the cost of repair to the damaged vehicle as stated in the following page.



LKK Auto Consultants Pte Ltd

51 Ubi Ave 1 #01-25 Paya Ubi Industrial Park, Singapore 408933

TEL: 6256 3561 FAX: 6256 4315

Reg. No: 199607198R GST Reg. No. 19-9607198-R

Page No.:1 of 3

ADJUSTMENT ON REPAIR COST FOR VEHICLE NO. GBA 3738G

Qty	Description of Parts	Condition	Estimate By Workshop (\$)	Our Adjusted (\$)
	<u>REPLACEMENT OF PARTS</u>			
1	FRONT BONNET	BENT	464.05	464.05
1	FRONT BONNET 'LOGO' EMBLEM	NECESSARY	20.45	20.45
2	FRONT BONNET HINGES L/R	NOT NECESSARY	53.50	-
1	FRONT BONNET MECHANISM LOCK	NOT NECESSARY	49.50	-
1	FRONT BONNET RUBBER GUIDE STOPPER	NOT NECESSARY	5.95	-
1	FRONT BONNET WEATHERSTRIP	NOT NECESSARY	26.20	-
2	FRONT HEADLAMP L/R	CRACKED	624.00	624.00
4	FRONT HEADLAMP CLIPS	NECESSARY	26.00	26.00
1	FRONT BUMPER	CRACKED	880.65	880.65
1	FRONT BUMPER REINFORCEMENT	BENT	278.45	278.45
2	FRONT BUMPER SIDE RETAINER L/R	BENT	90.70	90.70
2	FRONT FENDER L/R	BENT	712.60	712.60
2	FRONT FENDER INNER SHIELD L/R	NOT NECESSARY	90.70	-
1	FRONT RH SUPPORT PANEL	TO REPAIR SEE LABOUR	261.40	-
1	FRONT LOWER SUPPORT PANEL	TO REPAIR SEE LABOUR	150.20	-
1	HORN	NOT NECESSARY	43.55	-
1	RADIATOR	NOT NECESSARY	480.65	-
2	FRONT DOOR R/L	BENT	1,221.30	1,221.30
1	FRONT DOOR MIRROR LH	CUT	281.70	281.70
2	FRONT DOOR INNER TRIM BOARD L/R	NOT NECESSARY	662.75	-
2	FRONT DOOR MECHANISM LOCK L/R	BENT	285.60	285.60
4	FRONT DOOR RUBBER GUIDE STOPPER L/R	NOT NECESSARY	42.20	-
2	FRONT DOOR WINDOW OUTER MOULDING L/R	NOT NECESSARY	78.60	-
2	FRONT DOOR CHECKER L/R	NOT NECESSARY	56.80	-
2	FRONT DOOR WEATHER STRIP L/R	CUT	147.60	147.60
1	CENTER DOOR PILLAR LH	BENT	352.20	352.20
1	ROCKER PANEL LH	TO REPAIR SEE LABOUR	241.90	-
1	PETROL LID COVER RH	NOT NECESSARY	124.80	-
1	PETROL LID MECHANISM LOCK RH	NOT NECESSARY	48.00	-

Report Ref No. CS3/ASM18010846/Avbe2-1



LKK Auto Consultants Pte Ltd

51 Ubi Ave 1 #01-25 Paya Ubi Industrial Park, Singapore 408933

TEL: 6256 3561 FAX: 6256 4315

Reg. No: 199607196R GST Reg. No. 19-9607196-R

Page No.:2 of 3

Qty	Description of Parts	Condition	Estimate By Workshop (\$)	Our Adjusted (\$)
2	REAR SLIDING DOOR L/R	BENT	1,394.60	1,394.60
2	REAR SLIDING DOOR ELECTRONIC LOCK L/R	BENT	292.00	292.00
2	REAR SLIDING DOOR GUARD (FEMALE) L/R	NOT NECESSARY	136.20	-
2	REAR SLIDING DOOR GUARD (MALE) L/R	NOT NECESSARY	118.80	-
2	REAR SLIDING DOOR INNER TRIM BOARD L/R	NOT NECESSARY	418.20	-
2	REAR SLIDING DOOR OUTER HANDLE L/R	NOT NECESSARY	133.30	-
2	REAR SLIDING DOOR REGULATOR L/R	NOT NECESSARY	323.65	-
2	REAR SLIDING DOOR ROLLER GUIDE (CENTER) L/R	BENT	36.20	36.20
2	REAR SLIDING DOOR ROLLER (LOWER) L/R	N/S NOT NECESSARY / O/S BENT	57.20	28.60
2	REAR SLIDING DOOR ROLLER GUIDE (UPPER) L/R	NOT NECESSARY	48.20	-
2	REAR SLIDING DOOR WEATHER STRIP L/R	CUT	168.80	168.80
2	REAR SLIDING DOOR WINDOW OUTER MOULDING L/R	N/S NOT NECESSARY / O/S NECESSARY	158.00	79.00
1	REAR SLIDING DOOR WINDOW GLASS RH	CRACKED	423.80	423.80
1	REAR BUMPER	TO REPAIR SEE LABOUR	623.25	-
2	REAR BUMPER SIDE RETAINER L/R	NOT NECESSARY	40.90	-
	LESS 15% DISCOUNT		-1,826.27	-1,171.25
			10,348.83	6,637.05
	SPECIAL NETT ITEMS			
1	SET FRONT BUMPER CLIPS (SN)	NECESSARY	30.00	30.00
2	FRONT DOOR 'COMPANY DETAIL' STICKER L/R (SN)	NECESSARY	100.00	30.00
2	SETS FRONT FENDER INNER SHIELD CLIPS L/R (SN)	NOT NECESSARY	60.00	-
2	SETS FRONT DOOR INNER TRIMBOARD CLIPS L/R (SN)	NOT NECESSARY	60.00	-
2	REAR SLIDING DOOR 'COMPANY' STICKER L/R (SN)	NECESSARY	600.00	400.00
2	SET REAR SLIDING DOOR INNER TRIM BOARD CLIPS L/R (SN)	NECESSARY	60.00	60.00
1	REAR RH SLIDING DOOR GLASS SEALANT (SN)	NECESSARY	60.00	40.00
1	SET REAR BUMPER CLIPS (SN)	NOT NECESSARY	30.00	-
			1,000.00	560.00

Report Ref No. CS3/ASM18010846/Avbe2-1

**LKK Auto Consultants Pte Ltd**

51 Ubi Ave 1 #01-25 Paya Ubi Industrial Park, Singapore 408933

TEL: 6256 3561 FAX: 6256 4315

Reg. No: 199607198R GST Reg. No. 19-9607198-R

Page No.:3 of 3

Qty	Description of Parts	Condition	Estimate By Workshop (\$)	Our Adjusted (\$)
	LABOUR			
	TO PROVIDE TOWING CHARGE.		50.00	50.00
	TO REMOVE, REINSTALL ELECTRICAL WIRING HARNESS, CHECK LIGHTING AND RESETTING HEADLAMP FOCUSING.		120.00	30.00
	TO REMOVE, REINSTALL TOP TRIM UPHOLSTERY, CUSH ON SEAT, TRIM GARNISH, TRIM LINER CARPET.		140.00	80.00
	TO REMOVE, INSTALL L/R FRONT DOOR GLASS, REGULATOR GEAR, MOTOR, RAILING, CHANNEL, TRIM BOARD, MECHANISM LOCK AND HANDLE.		300.00	160.00
	TO TRANSFER L/R REAR SLIDING DOOR GLASS, REGULATOR GEAR, MOTOR, RAILING, CHANNEL, TRIM BOARD, MECHANISM LOCK AND HANDLE.		300.00	160.00
	TO RE-SPRAY PAINTING ON THE CHANGE BODYPARTS, REPAIR PORTION, AND WHERE CONSISTENT TO THE ACCIDENT.		1,600.00	1,300.00
	TO PROVIDE LABOUR, WORKMANSHIP TO CHANGE THE ABOVE DAMAGED BODYPARTS, REPAIR, RE-CONSTRUCT AND RE-ALIGN BODY STRUCTURE, BODY ALIGNMENTS AND DAMAGED CONSISTENT TO THE ACCIDENT. INCLUSIVE OF THE REPAIR OF FRONT RH SUPPORT PANEL, FRONT LOWER SUPPORT PANEL, ROCKER PANEL LH AND REAR BUMPER.		1,800.00	1,400.00
	TO APPLY ANTI-RUST CHEMICAL ON REPAIRED AND REPLACED PANEL.		120.00	60.00
			4,430.00	3,240.00
GRAND TOTAL			15,778.83	10,437.05
RECOMMENDED COST OF LUMP SUM REPAIRS (TO ITS PRE-ACCIDENT CONDITION)				8,350.00

Report Ref No. CS3/ASM18010846/Avbe2-1

MARKET VALUE: \$20,000.00(EST)-LTA REIMBURSEMENT VALUE: \$15,000.00=NETT VALUE: \$5,000.00

ADRIAN LING WAI PING

B.Eng,AMSOE,AMIRTE,AMSAE-A,M.MATAI

Licensed Appraiser

DISCLAIMER OF LIABILITY TO THIRD PARTIES:- This Report is made solely for the use and benefit of the Client named on the front page of this Report.

No liability of responsibility whatsoever, in contract or tort, is accepted to any third party who may rely on the Report wholly or in part. Any third party acting or relying on this Report, in whole or in part, does so at his or her own risk.