

## SINGAPORE ACCIDENT STATEMENT

### IMPORTANT NOTICE

1. Please report correctly the details of the accident to speed up the claims process.
2. This Form must be completed by the Policyholder and/or the Authorised Driver.
3. Information provided must be as truthful and accurate as possible. Any wilful misrepresentation or withholding of material facts may allow insurance companies to repudiate policy liability.
4. The issue and acceptance of this Form by insurance companies is not an admission of policy liability on the part of the insurance companies.
5. **Any false reporting may be referred to the Police for investigation.**
6. This report will be forwarded by the insurers of the GIA Records Management Centre established by the General Insurance Association of Singapore (GIA) for archiving and that copies of this report will, for a fee, be made available upon application by interested parties.
7. By the lodgement of this report to the insurers, you hereby consent to the archiving of this report at the centre and to copies of the report being made available aforesaid.

### ACCIDENT STATEMENT

Date Of Report	29/10/2018 11:46
Date Of Accident	27/10/2018 14:45
Exact Location Of Accident	PIE TWDS CHANGI PAYA LEBAR RD EXIT
Country/State of Loss	SINGAPORE

### DETAILS OF OWN VEHICLE

Vehicle Registration Number	SGF4343U
<b>Insured/Policyholder</b>	
Name Of Registered Owner	SYAFIE BIN ADAM
NRIC No	S8136747G
Email Address	NOEMAIL
Mobile Phone No	(LOCAL) +65-90682642
Alternative Phone No	OFFICE-90682642

### Vehicle Particulars

Manufacturer	MERCEDES-BENZ
Model	E 200CGI
Exact Purpose for which vehicle was being used at time of accident	PRIVATE USE
Are you claiming under your own insurance policy for repair to your vehicle?	NO
If No, Please state action to be taken	THIRD PARTY
Vehicle Category	PRIVATE CAR

### Insurance Company

Name of Insurance Company	NTUC INCOME INSURANCE CO-OPERATIVE LTD
Type Of Coverage	COMPREHENSIVE
Fleet Policy	NO
Policy Number	5099365488
Cover Note Number	-

### Driver

Name of Driver	JUNAIDAH BINTE JAMALI
NRIC No	S8107557C
Date Of Birth	16/02/1981
Occupation	INDOOR
Date Of Driving Pass	11/10/2017
Driving Experience	1 YEAR AND 0 MONTHS
Gender	FEMALE
Mobile Number	(LOCAL) +65-90218657
Fax Number	
Contact Number	
EEmail Address	NOEMAIL

Address	BLK 607 SENJA RD #04-06
Postcode	670607
Was driver an employee of the Insured's Company	NO
If No, Relationship of the Driver with the Insured	SPOUSE
Vehicle Registration Number of Driver's Own Vehicle	-
	-
	-
Insurance Company of Driver's Own Vehicle	-
	-
	-

#### General Information of the Accident

Type Of Accident	SIDE SWIPE
Weather Conditions	CLEAR
Road Surface	DRY

#### Other Information

Was any foreign vehicle involved in this accident?	NO
Number of vehicles involved in the accident	
Was any body injured in the Accident?	NO
Was any injured conveyed to hospital by ambulance?	NO
Was any other material or property damaged?	YES
I have been approached by unknown person(s) soliciting/offering accident claims assistance.	NO
Number of Passengers (Including Driver)	3
Passenger 1	NAME: : JUMILAH BINTE JAMALI GENDER: : FEMALE
Passenger 2	NAME: : MOHD BAMBANG HARRYO BIROWO GENDER: : MALE

#### Details of Police Action

Was the accident reported to the police?	NO
If Yes, Please state which Police Station	
Was notice of intended Prosecution given?	NO
If Yes, against whom?	

#### Circumstances of Accident

PLEASE REFER TO ATTACHED STATEMENT.

#### Attachment(s)

Are accident photos available for attachment?	YES
Was there any video captured by Car Camera?	NO
Was there any audio recorded?	NO

#### DETAILS OF OTHER VEHICLE PROPERTY 1

Vehicle Registration Number	XD5283L
Vehicle Make/Model/Colour	
Details Of Properties	
Vehicle Category	COMMERCIAL VEHICLE
Name of Driver	CHIN SOON MIN
NRIC/Passport Number	F8460414M
Contact Number	82395808
Address	
Postcode	
Insurance Company Name	

Nature Of Damage  
No. Of Passenger (Including Driver)

## Accident Sketch Plan

### SKETCH PLAN

#### IMPORTANT NOTICE

1. Please report correctly the details of the accident to speed up the claims process.
2. This Form must be completed by the Policyholder and/or the Authorised Driver.
3. Information provided must be as truthful and accurate as possible. Any wilful misrepresentation or withholding of material facts may allow insurance companies to reassess policy liability.
4. The issue and acceptance of this Form by insurance companies is not an admission of policy liability on the part of the insurance companies.
5. Any false reporting may be referred to the Police for investigation.
6. The report will be forwarded by the Insurers of the GIA Records Management Centre established by the General Insurance Association of Singapore (GIA) for archiving and that copies of this report will for a fee be made available upon application by interested parties.
7. By the lodgment of this report to the insurers, you hereby consent to the archiving of this report at the centre and to copies of the report being made available aforesaid.
8. Consent under the Personal Data Protection Act (PDPA)

I understand, acknowledge, agree and consent that:

- (a) My insurer, my workshop and the General Insurance Association of Singapore ("GIA") may/are permitted to collect, use, disclose and/or process my personal data/personal information set out in this form and any other personal information provided by me or possessed by my insurer (collectively the "Personal Information") and disclose and transfer such Personal Information to all insurer(s) who have insured vehicle(s) involved in this accident (all insurer(s) who have insured vehicle(s) involved in this accident shall be collectively referred to as the "Insurers"), the Insurers' lawyers/law firms, the Monetary Authority of Singapore and any relevant government agency/authority (such as the police), for the purpose(s) of:
  - (i) processing, handling and/or dealing with my claims including the settlement of the claims and any necessary investigations relating to the claims;
  - (ii) investigating the accident and/or my claims;
  - (iii) carrying out and/or dealing with my instructions or responding to any enquiries by me;
  - (iv) administering my claims (including the mailing of correspondence, statements, invoices, reports or notices to me, which could involve disclosure of certain personal data about me to bring about delivery of the same as well as on the external cover of envelopes/mail packages); and/or
  - (v) complying with applicable law in administering, processing, handling and/or dealing with my claims (collectively the "Purposes")
- (b) all insurer(s) who have insured vehicle(s) involved in this accident and the Insurers' lawyers/law firms, may/are permitted to collect, use, disclose and/or process my Personal Information for one or more of the above Purposes; and
- (c) my Personal Information may/can be disclosed by any of the Insurers and/or GIA to their third party service providers or agents (including their lawyers/law firms), which may be sited outside of Singapore, for one or more of the above Purposes.
- (d) my Personal Information will also be collected and used to compile claims history for the purpose of fraud detection, investigation and management in present and all future claims.
- (e) the information so collected under (d) above may be shared / disclosed:
  - (i) to all insurers and/or any other third parties that assist in evaluating, investigating, controlling or managing fraud, regulators, law enforcement and government agencies as reasonably required for the purposes stated, or
  - (ii) for complying with requirements under any regulations, laws or court orders.

  
\_\_\_\_\_  
Policyholder's Signature  
Date & Time:

  
\_\_\_\_\_  
Driver's Signature  
(If driver is not the policyholder)  
Date & Time:

  
\_\_\_\_\_  
Reporting Centre Personnel's Signature  
Name:  
NRIC/FIN No.:



## Accident Sketch Plan

### SKETCH PLAN

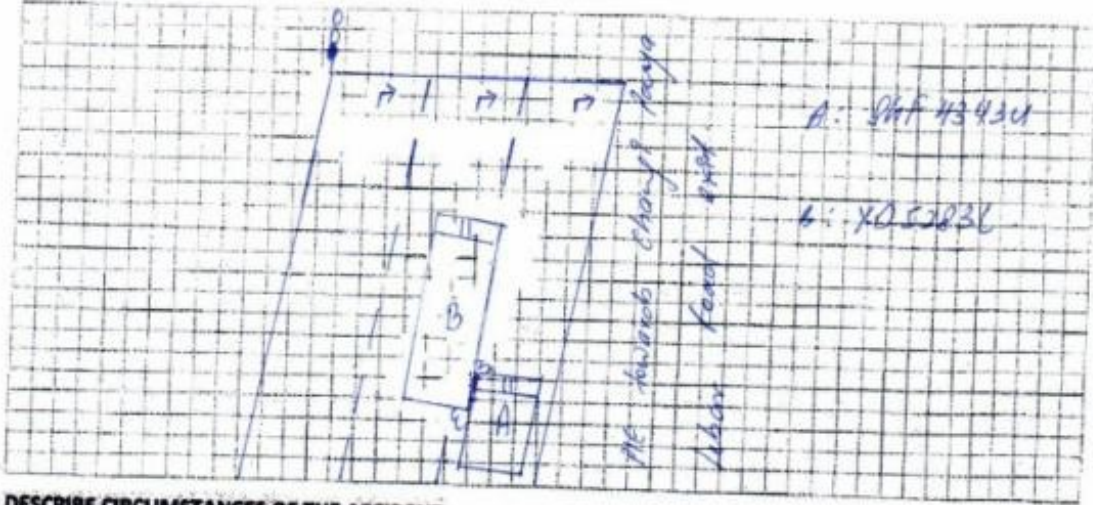

**DESCRIBE CIRCUMSTANCES OF THE ACCIDENT**

I was travelling straight along Rte towards Changi  
Jaya Lebar Road Exit. I was stationary as the  
traffic light was red. When the traffic light turn  
green, the vehicles in front of me moved off. I notice  
that vehicle (B) who was travelling on the lane  
to my left had his signal on with the intention  
to cut into my lane. Hence I continue to stay stationary  
and give way to vehicle (B). When vehicle (B) was  
about to complete the change of lane, I saw that his  
was too close. It happened too fast, hence I was unable  
to sound my horn and he collided onto me.

## DECLARATION

I/We declare the foregoing particulars are true in every respect.

Policyholder's Signature \_\_\_\_\_

**Date & Time:**

2008年12月12日 星期六

Driver's Signature: \_\_\_\_\_

(If driver is not the policyholder)

Date &amp; Time:

Reporting Centre Personnel's Signature

Name: \_\_\_\_\_

NRIC/FIN No.:

Accident Photo





Accident Photo



Accident Photo





Accident Photo



Accident Photo



**Accident Photo**



Accident Photo





Accident Photo



Accident Photo



Accident Photo



Accident Photo





Accident Photo



Accident Photo



Accident Photo



Accident Photo





Accident Photo

