

SINGAPORE ACCIDENT STATEMENT

IMPORTANT NOTICE

1. Please report correctly the details of the accident to speed up the claims process.
2. This Form must be completed by the Policyholder and/or the Authorised Driver.
3. Information provided must be as truthful and accurate as possible. Any wilful misrepresentation or withholding of material facts may allow insurance companies to repudiate policy liability.
4. The issue and acceptance of this Form by insurance companies is not an admission of policy liability on the part of the insurance companies.
5. **Any false reporting may be referred to the Police for investigation.**
6. This report will be forwarded by the insurers of the GIA Records Management Centre established by the General Insurance Association of Singapore (GIA) for archiving and that copies of this report will, for a fee, be made available upon application by interested parties.
7. By the lodgement of this report to the insurers, you hereby consent to the archiving of this report at the centre and to copies of the report being made available aforesaid.

ACCIDENT STATEMENT

Date Of Report	08/10/2018 13:59
Date Of Accident	08/10/2018 09:20
Exact Location Of Accident	BLK 58 LENGKOK BAHRU CARPARK
Country/State of Loss	SINGAPORE

DETAILS OF OWN VEHICLE

Vehicle Registration Number	EM9399M
Insured/Policyholder	
Name Of Registered Owner	KOH MELVIN KENNY
NRIC No	S8010648C
Email Address	SPANKME4270@ICLAND.COM
Mobile Phone No	(LOCAL) +65-91914270
Alternative Phone No	OTHERS-91914270

Vehicle Particulars

Manufacturer	VOLKSWAGEN
Model	JETTA-1.4 (A)
Exact Purpose for which vehicle was being used at time of accident	PTE USE
Are you claiming under your own insurance policy for repair to your vehicle?	NO
If No, Please state action to be taken	THIRD PARTY
Vehicle Category	PRIVATE CAR

Insurance Company

Name of Insurance Company	CHINA TAIPING INSURANCE (SINGAPORE) PTE. LTD.
Type Of Coverage	COMPREHENSIVE
Fleet Policy	NO
Policy Number	DMPCSN3009521800
Cover Note Number	26/03/2018 - 01/02/2019

Driver

Name of Driver	KOH MELVIN KENNY
NRIC No	S8010648C
Date Of Birth	27/04/1980
Occupation	INDOOR
Date Of Driving Pass	10/10/2003
Driving Experience	14 YEARS AND 11 MONTHS
Gender	MALE
Mobile Number	(LOCAL) +65-91914270
Fax Number	
Contact Number	OTHERS-91914270
Email Address	SPANKME4270@ICLAND.COM

Address	BLK 316D PUNGGOL WAY #06-685
Postcode	824316
Was driver an employee of the Insured's Company	NO
If No, Relationship of the Driver with the Insured	OWNER
Vehicle Registration Number of Driver's Own Vehicle	-
	-
	-
Insurance Company of Driver's Own Vehicle	-
	-
	-

General Information of the Accident

Type Of Accident	SIDE SWIPE
Weather Conditions	CLEAR
Road Surface	DRY

Other Information

Was any foreign vehicle involved in this accident?	NO
Number of vehicles involved in the accident	2
Was any body injured in the Accident?	NO
Was any injured conveyed to hospital by ambulance?	NO
Was any other material or property damaged?	YES
I have been approached by unknown person(s) soliciting/offering accident claims assistance.	NO
Number of Passengers (Including Driver)	1

Details of Police Action

Was the accident reported to the police?	NO
If Yes, Please state which Police Station	
Was notice of intended Prosecution given?	NO
If Yes, against whom?	

Circumstances of Accident

REFER TO STATEMENT

Attachment(s)

Are accident photos available for attachment?	YES
Was there any video captured by Car Camera?	NO
Was there any audio recorded?	NO

DETAILS OF OTHER VEHICLE PROPERTY 1

Vehicle Registration Number	SHB1802R
Vehicle Make/Model/Colour	TOYOTA PRIUS
Details Of Properties	
Vehicle Category	TAXI
Name of Driver	NG
NRIC/Passport Number	
Contact Number	88184099
Address	
Postcode	
Insurance Company Name	
Nature Of Damage	
No. Of Passenger (Including Driver)	

Sketch Plan

SKETCH PLAN

VEHICLE NO.: EM9399M
INSURER : CHINATAI PING
DATE & TIME: 8/10/18 9:20am

IMPORTANT NOTICE

1. Please report correctly the details of the accident to speed up the claims process.
2. This Form must be completed by the Policyholder and/or the Authorised Driver.
3. Information provided must be as truthful and accurate as possible. Any wilful misrepresentation or withholding of material facts may allow insurance companies to repudiate policy liability.
4. The issue and acceptance of this Form by insurance companies is not an admission of policy liability on the part of the insurance companies.
5. Any false reporting may be referred to the Police for investigation.
6. The report will be forwarded by the insurers of the GIA Records Management Centre established by the General Insurance Association of Singapore (GIA) for archiving and that copies of this report will for a fee be made available upon application by interested parties.
7. By the lodgment of this report to the insurers, you hereby consent to the archiving of this report at the centre and to copies of the report being made available aforesaid.
8. **Consent under the Personal Data Protection Act (PDPA)**

I understand, acknowledge, agree and consent that:

- (a) My insurer, my workshop and the General Insurance Association of Singapore ("GIA") may/are permitted to collect, use, disclose and/or process my personal data/personal information set out in this [form] and any other personal information provided by me or possessed by my insurer (collectively the "Personal Information") and disclose and transfer such Personal Information to all insurer(s) who have insured vehicle(s) involved in this accident (all insurer(s) who have insured vehicle(s) involved in this accident shall be collectively referred to as the "Insurers"), the Insurers' lawyers/law firms, the Monetary Authority of Singapore and any relevant government agency/authority (such as the police), for the purpose(s) of:
 - (i) processing, handling and/or dealing with my claims including the settlement of the claims and any necessary investigations relating to the claims;
 - (ii) investigating the accident and/or my claims;
 - (iii) carrying out and/or dealing with my instructions or responding to any enquiries by me;
 - (iv) administering my claims (including the mailing of correspondence, statements, invoices, reports or notices to me, which could involve disclosure of certain personal data about me to bring about delivery of the same as well as on the external cover of envelopes/mail packages); and/or
 - (v) complying with applicable law in administering, processing, handling and/or dealing with my claims.(collectively the "Purposes")
- (b) all Insurer(s) who have insured vehicle(s) involved in this accident and the Insurers' lawyers/law firms, may/are permitted to collect, use, disclose and/or process my Personal Information for one or more of the above Purposes; and
- (c) my Personal Information may/can be disclosed by any of the Insurers and/or GIA to their third party service providers or agents(including their lawyers/law firms), which may be sited outside of Singapore, for one or more of the above Purposes.
- (d) my Personal Information will also be collected and used to compile claims history for the purpose of fraud detection, investigation and management in present and all future claims.
- (e) the information so collected under (d) above may be shared / disclosed:
 - (i) to all insurers and/or any other third parties that assist in evaluating, investigating, controlling or managing fraud, regulators, law enforcement and government agencies as reasonably required for the purposes stated, or
 - (ii) for complying with requirements under any regulations, laws or court orders.

Policyholder's Signature

Date & Time:

8 Oct 1:30pm

Driver's Signature

(If driver is not the policyholder)

Date & Time:

Reporting Centre Personnel's Signature

Name:

NRIC/FIN No.:

Angela (AME) 8810118

Sketch Plan #2

SKETCH PLAN

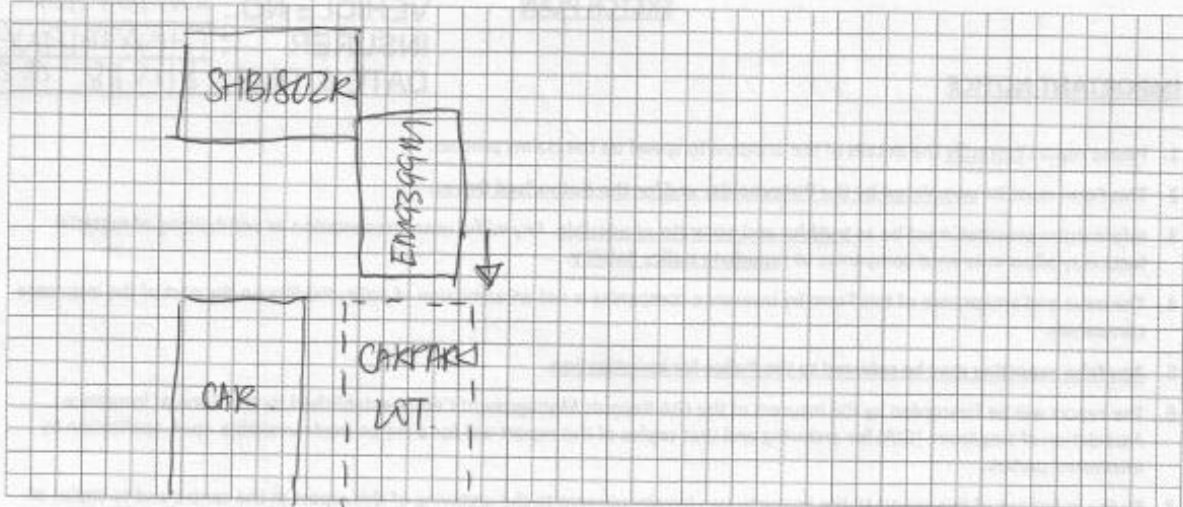

DESCRIBE CIRCUMSTANCES OF THE ACCIDENT

I WAS REVERSING INTO CARPARK LOT AS INDICATED ABOVE WHEN VEH NO. SHB1802R COLLIDED INTO MY FRONT LEFT BUMPER WITH HIS RIGHT FRONT BUMPER.

Vehicle No: EM 9399M (China)

Date & Time: 08/10/2018 @ 0920 (clear day)

Note : Please note that your insurer may have 14days Time Frame for you to submit an Own Damage Claim under your own comprehensive policy. Please check with your policy for more information.

DECLARATION

I/We declare the foregoing particulars are true in every respect.

Policyholder's Signature

Date & Time:

8 Oct 2018 / 1:30 PM

Driver's Signature

(Driver is not the policyholder)

Date & Time:

Reporting Centre Personnel's Signature

Name:

NRIC/FIN No.:

(AMK)

GIARMC SketchPlanForm_V3

() Claim Own Policy () Claim Third Party () Reporting Only
() Claim OD/TP at other workshop (BAK HONG)

Sketch Plan #3

REPUBLIC OF SINGAPORE
IDENTITY CARD NO. S8010648C



Name
KOH MELVIN KENNY

Race
CHINESE

Date of birth
27-04-1980

Sex
M

Country of birth
SINGAPORE

S8010648C

REPUBLIC OF SINGAPORE DRIVING LICENCE

Licence Number: **S8010648C**

Name
KOH MELVIN KENNY

Birth Date: **27 Apr 1980**

Valid Date: **10 Oct 2003**

 000910700H

4742558



MNC No: **S8010648C**



Date of issue

YOU ARE LICENSED TO DRIVE VEHICLES IN THE FOLLOWING CLASSES

PASS DATE

Class 3 Motor Cars and Motor Tractors the weight of which unladen does not exceed 2500 kilograms

Licence No: **S8010648C**

NP 428A

Accident Photo



Accident Photo



Accident Photo



Accident Photo



Accident Photo



Accident Photo



SCENE PHOTO



SCENE PHOTO

