

Surveyor: NAZ REF: INDEPENDENT C9/TIB18018606/NVb82

ASSIGNMENT

From: _____ Date: _____
 Estimated Cost: _____
OD / TP / WS / TP RES / OD RES / EVA / INV / MV
 To Inspect Vehicle No: _____
 at Workshop m/s _____
 of _____
 Insured: _____
 Policy No. _____
 Claims No. _____
 Sum Insured: _____ Excess: _____
 (Client's Record)
 Make of Veh: _____

(Policy Condition)
 Remark: The veh had commenced its
 repair at the time of inspection.

N/S	O/S

Bal. or Market Value: _____
 IDAC Accident Rpt: _____ Consistent? : Yes or No
 GIA / PR Seen: _____ Consistent? : Yes or No
 Est. Repairs: 1 days Res.: Yes or No
 Lum Sum: _____ % 3 Val.: Yes or No
 CA / REV / REP. / 24 HRS
 Date: _____ Person Contacted: _____ Vehicle: IN / OUT

Veh No: TIB 1188T Yr Regn: 12 APR 2002
 Type: M.Car / M.Cycle / Bus / Van / Lorry / Taxi / Prime Mover /
 Truck / Trailer or _____
 Make: MERCEDES BENZ 0405G AUTO C.C. 11,967
 Colour: MULTI-COLOURED A/C: Insured / Std / NI / NA
 Sp. Reading: 195,392 T/Radio: Insured / Std / NI / NA
 Eng/No: _____
 C/No: W6B61232321098988
 Gen. Cond: Good / Fair / Poor / Burnt
 Steering: Inorder / Jammed / Leaked / Burnt or
 Brake: Inorder / Jammed / Leaked / Burnt or
 Modi: Nil / S/Rim / STD A/Rim or
 Tyre Size: F: 275/70 R22.5
 R: _____
 BS / DUN / EXNOVA / GY / FS / LIZA / MIC / OHTSU / PIR / SUMI /
TOYO / YOKO or GY (F), FIKINZA (R)
 Front _____ Rear _____
 R/Bal. 7 mm R/Bal. 7/7 mm
 L/Bal. 7 mm L/Bal. 7/7 mm
 D.O.A. 8/10/18 D.O.I. 12/10/18
 Survey held at SMART WOODLAND
 Des. of Damages: Frt / Rear / O/S / N/S / U/C / Rooftop or
REAR O/S
 The U/C / Chassis frame / Body Structure affected due to collision.

Date / Time	Action / Instruction
	<u>TIB 1188T - C9/NA/14009320/Kg3c3</u>
<u>23/10/18</u>	<u>LS \$ 1200 confirmed by email (Recd 5:06:50, 30/9)</u>

RECEIVED 23 OCT 2018

Date/Time, File Pass to? ☐ : Preli. Report
☐ : Final Report
 1) _____
 Date/Time, File Return to? _____
 2) 23/10 - typst
 Report Format: TP
 Lump Sum / I.B.I: (\$) 1200/2
 Days Of Repair: 1
 Resurvey No. of Trip: 1
 Survey Fee: _____
 Transportation: _____
 Add Fee: ☐ : Site Insp (\$) ☐ : S + RS, SI
☐ : Interview (\$) ☐ : Photos
☐ : Tech. Invs (\$) ☐ : Others
☐ : Weekend (\$) ☐ :
 TOTAL 222

SINGAPORE ACCIDENT STATEMENT

IMPORTANT NOTICE

1. Please report correctly the details of the accident to speed up the claims process.
2. This Form must be completed by the Policyholder and/or the Authorised Driver.
3. Information provided must be as truthful and accurate as possible. Any wilful misrepresentation or withholding of material facts may allow insurance companies to repudiate policy liability.
4. The issue and acceptance of this Form by insurance companies is not an admission of policy liability on the part of the insurance companies.
5. **Any false reporting may be referred to the Police for investigation.**
6. This report will be forwarded by the insurers of the GIA Records Management Centre established by the General Insurance Association of Singapore (GIA) for archiving and that copies of this report will, for a fee, be made available upon application by interested parties.
7. By the lodgement of this report to the insurers, you hereby consent to the archiving of this report at the centre and to copies of the report being made available aforesaid.

ACCIDENT STATEMENT

Date Of Report	09/10/2018 17:11
Date Of Accident	08/10/2018 08:25
Exact Location Of Accident	WOODLANDS TRAIN CHECKPOINT
Country/State of Loss	SINGAPORE

DETAILS OF OWN VEHICLE

Vehicle Registration Number	TIB1188T
Insured/Policyholder	
Name Of Registered Owner	SMRT BUSES LTD
Co Reg No	198202292D
Email Address	NOEMAIL
Mobile Phone No	
Alternative Phone No	OFFICE-800000000

Vehicle Particulars

Manufacturer	MERCEDES-BENZ
Model	BUS

Exact Purpose for which vehicle was being used at time of accident

Are you claiming under your own insurance policy for repair to your vehicle? NO

If No, Please state action to be taken THIRD PARTY

Vehicle Category BUS

Insurance Company

Name of Insurance Company	MS FIRST CAPITAL INSURANCE LTD
Type Of Coverage	THIRD PARTY
Fleet Policy	YES
Policy Number	D18090224MFBP
Cover Note Number	

Driver

Name of Driver	MUHAMMAD AMRAN BIN ABDULLAH
Passport No/FIN	F7948973P
Date Of Birth	07/04/1964
Occupation	OUTDOOR
Date Of Driving Pass	07/07/2004
Driving Experience	14 YEARS AND 3 MONTHS
Gender	MALE
Mobile Number	(LOCAL) +65-800000000
Fax Number	
Contact Number	
Email Address	NOEMAIL

Address NIL
 Postcode
 Was driver an employee of the Insured's Company YES
 If No, Relationship of the Driver with the Insured
 Vehicle Registration Number of Driver's Own Vehicle -
 Vehicle -
 Insurance Company of Driver's Own Vehicle -

General Information of the Accident

Type Of Accident COLLISION - CHANGE/CROSS LANE
 Weather Conditions CLEAR
 Road Surface DRY

Other Information

Was any foreign vehicle involved in this accident? NO
 Number of vehicles involved in the accident
 Was any body injured in the Accident? NO
 Was any injured conveyed to hospital by ambulance? NO
 Was any other material or property damaged? YES
 I have been approached by unknown person(s) soliciting/offering accident claims assistance. NO
 Number of Passengers (Including Driver) 28

Details of Police Action

Was the accident reported to the police? NO
 If Yes, Please state which Police Station
 Was notice of intended Prosecution given? NO
 If Yes, against whom?

Circumstances of Accident

I was at above mentioned location, bus was stationary queuing to enter bus stop due to another bus was in the bus stop. A transcab SHC9952C taxi hit against bus right rear bumper. No injuries reported.

Attachment(s)

Are accident photos available for attachment? NOT AVAILABLE DUE TO CIRCUMSTANCES OF ACCIDENT
 Was there any video captured by Car Camera? NO
 Was there any audio recorded? NO

DETAILS OF OTHER VEHICLE PROPERTY 1

Vehicle Registration Number SHC9952C
 Vehicle Make/Model/Colour
 Details Of Properties
 Vehicle Category TAXI
 Name of Driver UNKNOWN
 NRIC/Passport Number
 Contact Number
 Address
 Postcode
 Insurance Company Name
 Nature Of Damage
 No. Of Passenger (Including Driver)

Sketch Plan Pg. 2

SKETCH PLAN

Refer to Sketch 1

DESCRIBE CIRCUMSTANCES OF THE ACCIDENT

Refer to Report

DECLARATION •

I/We declare the foregoing particulars are true in every respect.

Policyholder's Signature
Date & Time:

Driver's Signature
(If driver is not the policyholder)
Date & Time:

Reporting Centre Personnel's Signature
Name:
NRIC/FIN No.:

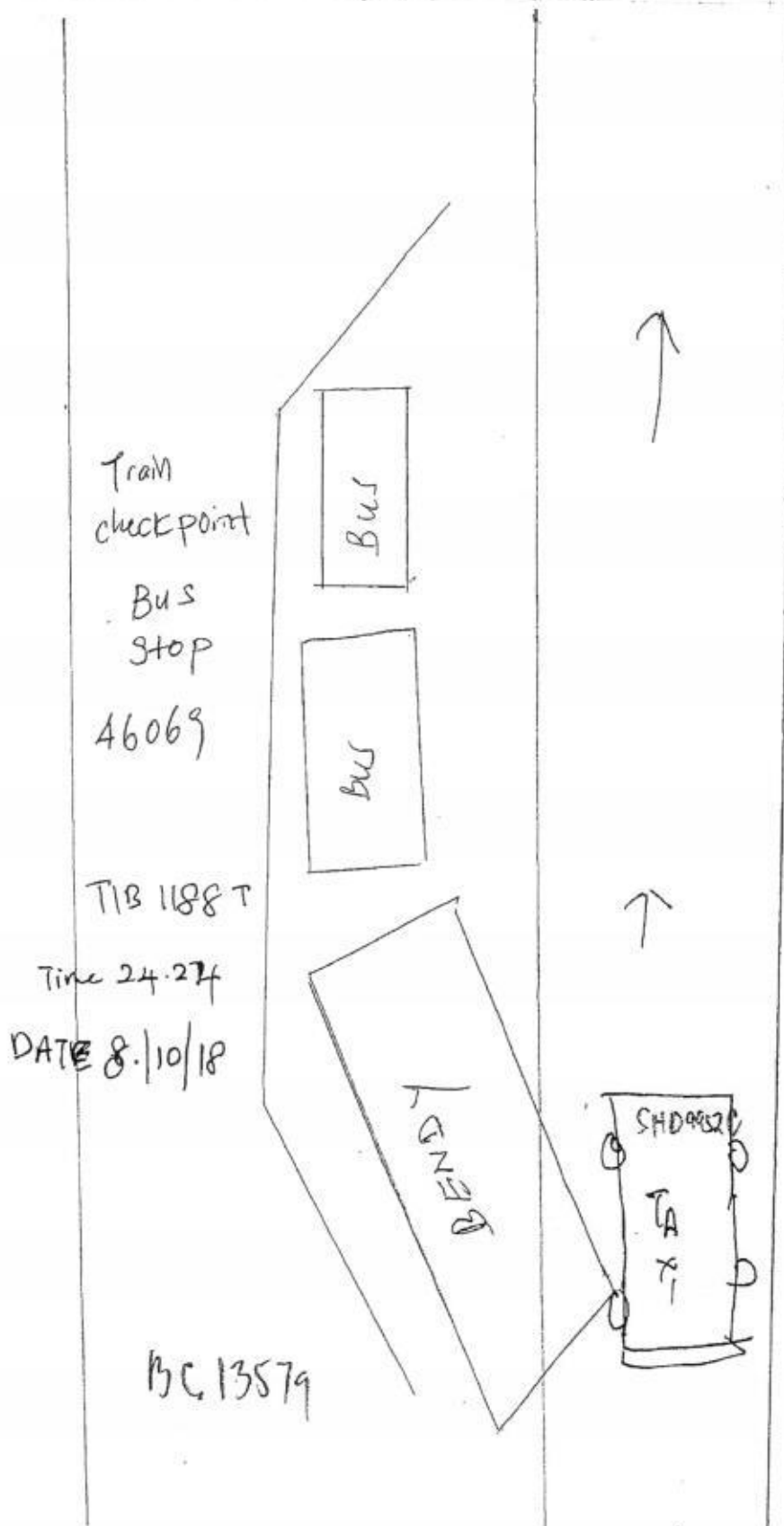

[> Back to OneMotoring](#)**Enquire PARF/COE Rebate for Registered Vehicle**

Vehicle Owner Particulars	
Owner ID Type:	Company
Owner ID:	2292D
Vehicle Details	
Vehicle No.:	TIB1188T
Vehicle to be Exported:	No
Intended Deregistration Date:	15 Oct 2018
Vehicle Make:	MERCEDES BENZ
Vehicle Model:	O4O5G AUTO
Primary Colour:	Multi-Colour
Manufacturing Year:	2000
Engine No.:	44797720082195
Chassis No.:	WEB61232321098988
Maximum Power Output:	-
Open Market Value:	\$356,179.00
Original Registration Date:	12 Apr 2002
First Registration Date:	12 Apr 2002
Transfer Count:	0
Actual ARF Paid:	\$17,809.00
Intended PARF Rebate Details	
PARF Eligibility:	No
PARF Eligibility Expiry Date:	-
PARF Rebate Amount:	\$0.00
Intended COE Rebate Details	
COE Rebate Amount:	\$0.00
Total Rebate Amount:	\$0.00

The information contained herein is correct as at 15 Oct 2018

OK



SMRT Accident Vehicle Repair Estimates

SMRT Automotive Service Pte Ltd
80 Woodlands Industrial Park E4, Singapore 757705
FAX Number : 63685592
Estimator Telephone Number : 68662623
Accident Reporting Number : 68662672

Date Generated : 11/10/2018

User ID : GohKK2

Section D - Details of Repair Estimates

Part 1 - Labour Works

Job Scope	Quotation from AR	Adjusted by Surveyor, if applicable
TO REMOVE & INSTALL ALL ABOVE ITEMS AND REPAIR OTHERS DAMAGED AFFECTED AREAS	\$795.00	530
Total Labour	\$795.00	

Part 2 - Spray Painting & Panel Beating Related Works

Job Scope	Quotation from ARC	Adjusted by Surveyor, if applicable
PROVIDE LABOUR AND MATERIAL TO PUTTY AND RESPRAY ABOVE REPAIR ITEMS	\$446.00	300
Total Spray Painting & Panel Beating	\$446.00	

Part 3 - Other Costs - Accident and Accident Repair Related Expense

Job Scope	Quotation from ARC	Adjusted by Surveyor, if applicable
Total Other Costs		

Part 4 - Spare Parts / Material Usage

Part Number	Portion	Stock Number	Part Name	Quantity	List Price (\$)	Discount (%)	Final Price (\$)	Estimator Approved	Surveyor Approved
			REAR BUMPER END RH	1.00	\$485.50	10.00	\$436.95	Replace	CRA
Total					\$485.50		\$436.95		

Added Spare Parts / Material Usage After Surveyor Signed off

Part Number	Portion	Stock Number	Part Name	Quantity	List Price \$	Discount (%)	Final Price (\$)	ARC Check	Surveyor Check
Total									

1736.50

NAZ LKK
12/10/18 1000
LIS
1 DAY
AFTER REPAIR PHOTOS

[Signature]
15/10/18

LKK Auto Consultants hence notify the Repairer of the following:

- To resurvey before/after spray painting
- To display damaged part(s) during resurvey
- Parts prices are subject to confirmation
- Third party survey is on a "Without Prejudice" basis
- No illegal modification(s) is allowed
- Supplementary item(s) must be resurveyed and is subject to final approval from Insurance Company

Acknowledged by Repairer

Signature:

Date:



SMRT Accident Vehicle Repair Estimates

SMRT Automotive Services Pte Ltd
60 Woodlands Industrial Park E4, Singapore 757705
FAX Number : 63665592
Estimator Telephone Number : 68662623
Accident Reporting Number : 68662672



Date Generated : 22/10/2018

User ID : CatherineLee

Section A - Accident Details

Registration Number	TIB1188T
Case Reference Number	BUS/10/18/7004
Registration Date	12/04/2002
Company Type	SMRT Buses Ltd
Make	MERCEDES
Model	MERCEDES 0405G
Name of Driver	Muhammad Amran Bin Abdullah
Type of Accident	Side Swipe
Accident Date and Time	08/10/2018 8:24 AM
Accident Reported Date and Time	08/10/2018 1:45 AM
Is Surveyor Required?	Yes
Survey by	
Vehicle is Towed Back?	No
Towed Back Date and Time	
Replacement Vehicle Issued?	No
Job Card Number	24098276
Special Instruction to ARC, if any	TP: SHD9952C (AXA)
Prepared Date and Time	11/10/2018 11:05 AM
Chassis Number	
Mileage	
Work Shop	
Repair Completion Date and Time	

Section B - Summary of Repair Estimates

Summary of Repair Estimates		
	Quotation from ARC	Adjusted by Surveyor, if applicable
Total Labour Cost	\$795.00	\$530.00
Total Spray Cost	\$446.00	\$300.00
Total Spare Part Cost	\$349.56	\$349.56
Total Other Cost	\$0.00	\$0.00
TOTAL COST	\$1,590.56	\$1,179.56
Lump Sum Total	\$1,600.00	\$1,200.00
Number of Repair Days	2.0	1.0
Prepared / Adjusted By	Kek Khoo Goh	NAZ
ARC / Surveyor Sign Off Date	11/10/2018 11:09 AM	21/10/2018 8:56 AM
Signature		
Remarks		

Section C - Quotation and Accident Invoice Details

Quotation Number		Invoice Number	
Quotation Date		Invoice Date	
Invoice Amount		Prepared Date	



SMRT Accident Vehicle Repair Estimates

SMRT Automotive Services Pte Ltd
60 Woodlands Industrial Park E4, Singapore 757705
FAX Number : 63685592
Estimator Telephone Number : 68662623
Accident Reporting Number : 68662672

Date Generated : 22/10/2018

User ID : CatherineLee

Section D - Details of Repair Estimates

Part 1 - Labour Works

Job Scope	Quotation from AR	Adjusted by Surveyor, if applicable
TO REMOVE & INSTALL ALL ABOVE ITEMS AND REPAIR OTHERS DAMAGED AFFECTED AREAS.	\$795.00	\$530.00
Total Labour	\$795.00	\$530.00

Part 2 - Spray Painting & Panel Beating Related Works

Job Scope	Quotation from ARC	Adjusted by Surveyor, if applicable
PROVIDE LABOUR AND MATERIAL TO PUTTY AND RESPRAY ABOVE REPAIR ITEMS	\$446.00	\$300.00
Total Spray Painting & Panel Beating	\$446.00	\$300.00

Part 3 - Other Costs - Accident and Accident Repair Related Expense

Job Scope	Quotation from ARC	Adjusted by Surveyor, if applicable
Total Other Costs		

Part 4 - Spare Parts / Material Usage

Part Number	Portion	Stock Number	Part Name	Quantity	List Price (\$)	Discount (%)	Final Price (\$)	Estimator Approved	Surveyor Approved
			REAR BUMPER END RH	1.00	\$485.50	10.00	\$436.95	Replace	Replace
Total					\$485.50		\$436.95		

Added Spare Parts / Material Usage After Surveyor Signed off

Part Number	Portion	Stock Number	Part Name	Quantity	List Price \$	Discount (%)	Final Price (\$)	ARC Check	Surveyor Check
Total									

Veron Chen (LKKAUTO)

From: Veron Chen (LKKAUTO)
Sent: Tuesday, 23 October 2018 8:56 AM
To: 'Catherine Lee Sau Chan (Auto Svcs/Ext Biz Svcs/AR & SC/ARC (Buses)/AR(Buses))'; Naz (LKKAUTO); SUR
Cc: Koo Yew Chung (Auto Svcs/Ext Biz Svcs/AR & SC); AutoSvs-ARC (Bus); Bryan Ang (LKKAUTO)
Subject: RE: Finalisation - TIB1188T (BUS/10/18/7004) - AXA

Dear Catherine,

WITHOUT PREJUDICE

Amount confirm \$1,200/- @ 1 working day under Lum Sum repair.

Best Regards,

Veron Chen | Case Handler

LKK Auto Consultants Pte Ltd

Phone: 6256-3561 | email :sur@lkkauto.com | fax: 6256-4315

Blk 51, Paya Ubi Industrial Park, Ubi Avenue 1, #02-25 | S(408933)

From: Catherine Lee Sau Chan (Auto Svcs/Ext Biz Svcs/AR & SC/ARC (Buses)/AR(Buses)) <catherineleesc@smrt.com.sg>
Sent: Monday, 22 October 2018 6:35 PM
To: Naz (LKKAUTO) <Naz@lkkauto.com>; SUR <sur@lkkauto.com>
Cc: Koo Yew Chung (Auto Svcs/Ext Biz Svcs/AR & SC) <YewChung@smrt.com.sg>; AutoSvs-ARC (Bus) <AutoSvs-ARCBUS@smrt.com.sg>; Bryan Ang (LKKAUTO) <bryanang@lkkauto.com>
Subject: Finalisation - TIB1188T (BUS/10/18/7004) - AXA

Hi Naz,

Attached herewith our copy of the bus repair estimate for the case.

Our finalised amount is \$1,200/- @ 1 working day under LUMP SUM repair. Attached after repair photos for your perusal.

Please confirm the COR by return email ASAP.

Thank you

Best Regards
Catherine Lee
SMRT Automotive Services Pte Ltd
(Accident Repair Centre)
DID: 6866 2669 Fax: 6368 5592
catherineleesc@smrt.com.sg



Moving People, Enhancing Lives



LKK Auto Consultants Pte Ltd

51 Ubi Ave 1 #01-25 Paya Ubi Industrial Park, Singapore 408933

TEL: 6256 3561 FAX: 6256 4315

Reg. No: 199607198R GST Reg. No. 19-9607198-R

Affiliated to Federation Internationale Des Experts En Automobile				
SMRT BUSES LTD		Ref : CS/TIB18018606/Nvbs2		
6 ANG MO KIO STREET 62 SINGAPORE 569140		Date : 24-10-2018		
		Code : TIB2		
1. Policy Particulars :- THIRD PARTY CLAIM				
	Insured Veh.	Veh. Inspected	TIB 1188T	
	Policy No.	Coverage (\$)	0.00	
	Claim No. BUS/10/18/7004	Excess (\$)	0.00	
	Assign From	Assign Date	12/10/2018	
2. Vehicle Particulars & Condition				
	Make & Model	MERCEDES BENZ O405G AUTO	c.c	11967
	Engine No.	HIDDEN	Year of Reg.	2002
	Chassis No.	WEB61232321098988	Colour	MULTI-COLOURED
	Odometer	195392	Steering	IN ORDER
	Brakes	IN ORDER	Modification	STANDARD ALLOY RIM
	General	FAIR		
3. Conditions of Tyres				
		Size	Make	Balance
	R/H Front Tyre	275/70 R22.5	GOODYEAR	7 mm
	L/H Front Tyre	275/70 R22.5	GOODYEAR	7 mm
	R/H Rear Tyre	275/70 R22.5 (D)	FIRENZA	7/7 mm
	L/H Rear Tyre	275/70 R22.5 (D)	FIRENZA	7/7 mm
4. Description of Damages				
	THE VEHICLE SUSTAINED DAMAGES AT THE REAR O/S PORTION.			
5. General Information				
	Accident Date	08/10/2018	Inspection Date	12/10/2018
	Survey held at	SMRT AUTOMOTIVE SERVICES PTE LTD 60 WOODLANDS INDUSTRIAL PARK E4 SINGAPORE 757705		
5a. Remarks				
	A)THE INSPECTION WAS CONDUCTED ON A"WITHOUT PREJUDICE" BASIS. B)IN ACCORDANCE TO YOUR INSTRUCTIONS, WE HAVE NOT AUTHORISED REPAIRS.			
5b. Estimate Days of Repair				
	ESTIMATED NORMAL PERIOD FOR REPAIR:		1 Working Days	

**LKK Auto Consultants Pte Ltd**

51 Ubi Ave 1 #01-25 Paya Ubi Industrial Park, Singapore 408933

TEL: 6256 3561 FAX: 6256 4315

Reg. No: 199607198R GST Reg. No. 19-9607198-R

Page No.:1 of 1

ADJUSTMENT ON REPAIR COST FOR VEHICLE NO. TIB 1188T

Qty	Description of Parts	Condition	Estimate By Workshop (\$)	Our Adjusted (\$)
1	<u>REPLACEMENT OF PARTS</u>	CRACKED		
	REAR BUMPER END RH		485.50	485.50
	LESS 10% DISCOUNT		-	-48.55
			485.50	436.95
	<u>LABOUR</u>			
	TO REMOVE & INSTALL ALL ABOVE ITEMS AND REPAIR OTHERS DAMAGED AFFECTED AREAS.		795.00	530.00
	PROVIDE LABOUR AND MATERIAL TO PUTTY AND RESPRAY ABOVE REPAIR ITEMS.		446.00	300.00
			1,241.00	830.00
GRAND TOTAL			1,726.50	1,266.95
RECOMMENDED COST OF LUMP SUM REPAIRS (TO ITS PRE-ACCIDENT CONDITION)				1,200.00

Report Ref No. CS/TIB18018606/Nvbs2

MUHAMMAD NAZRIL BIN ABDULLAH

Automotive Assessor

K.K.LAU CPT(RET)

BEng(Hons),B.Bus,MBA,PEng,PE,
MInstAEA,MASME,MIRTE

REGD Auto Consultant-SAE, Licensed Appraiser

DISCLAIMER OF LIABILITY TO THIRD PARTIES:- This Report is made solely for the use and benefit of the Client named on the front page of this Report.

No liability of responsibility whatsoever, in contract or tort, is accepted to any third party who may rely on the Report wholly or in part. Any third party acting or relying on this Report, in whole or in part, does so at his or her own risk.