

SINGAPORE ACCIDENT STATEMENT

IMPORTANT NOTICE

1. Please report correctly the details of the accident to speed up the claims process.
2. This Form must be completed by the Policyholder and/or the Authorised Driver.
3. Information provided must be as truthful and accurate as possible. Any wilful misrepresentation or withholding of material facts may allow insurance companies to repudiate policy liability.
4. The issue and acceptance of this Form by insurance companies is not an admission of policy liability on the part of the insurance companies.
5. **Any false reporting may be referred to the Police for investigation.**
6. This report will be forwarded by the insurers of the GIA Records Management Centre established by the General Insurance Association of Singapore (GIA) for archiving and that copies of this report will, for a fee, be made available upon application by interested parties.
7. By the lodgement of this report to the insurers, you hereby consent to the archiving of this report at the centre and to copies of the report being made available aforesaid.

ACCIDENT STATEMENT

Date Of Report	13/10/2018 11:58
Date Of Accident	10/10/2018 15:15
Exact Location Of Accident	BLK 302 UBI AVE 1 OPEN SPACE CARPARK
Country/State of Loss	SINGAPORE

DETAILS OF OWN VEHICLE

Vehicle Registration Number	GBC3912J
Insured/Policyholder	
Name Of Registered Owner	M/S DESIGN 2000 LANDSCAPE SERVICES
Co Reg No	52845024K
Email Address	NOEMAIL
Mobile Phone No	(LOCAL) +65-96884508
Alternative Phone No	OFFICE-96884508

Vehicle Particulars

Manufacturer	ISUZU
Model	NHR85AUE4AC
Exact Purpose for which vehicle was being used at time of accident	WORKING
Are you claiming under your own insurance policy for repair to your vehicle?	NO
If No, Please state action to be taken	REPORTING ONLY
Vehicle Category	COMMERCIAL VEHICLE

Insurance Company

Name of Insurance Company	CHINA TAIPING INSURANCE (SINGAPORE) PTE. LTD.
Type Of Coverage	COMPREHENSIVE
Fleet Policy	NO
Policy Number	DMCVSN3025621800
Cover Note Number	

Driver

Name of Driver	LEE TONG SIONG
NRIC No	S1522419C
Date Of Birth	20/01/1962
Occupation	OUTDOOR
Date Of Driving Pass	01/10/1984
Driving Experience	34 YEARS AND 0 MONTHS
Gender	MALE
Mobile Number	(LOCAL) +65-96884508
Fax Number	
Contact Number	OFFICE-96884508
Email Address	NOEMAIL

Address	BLK 352 UBI AVENUE 1 #09-987
Postcode	400352
Was driver an employee of the Insured's Company	NO
If No, Relationship of the Driver with the Insured	OWNER
Vehicle Registration Number of Driver's Own Vehicle	-
	-
	-
Insurance Company of Driver's Own Vehicle	-
	-
	-

General Information of the Accident

Type Of Accident	COLLISION - HEAD TO REAR
Weather Conditions	CLEAR
Road Surface	DRY

Other Information

Was any foreign vehicle involved in this accident?	NO
Number of vehicles involved in the accident	2
Was any body injured in the Accident?	NO
Was any injured conveyed to hospital by ambulance?	
Was any other material or property damaged?	YES
I have been approached by unknown person(s) soliciting/offering accident claims assistance.	NO
Number of Passengers (Including Driver)	3
Passenger 1	NAME: : - GENDER: : MALE
Passenger 2	NAME: : - GENDER: : MALE

Details of Police Action

Was the accident reported to the police?	NO
If Yes, Please state which Police Station	
Was notice of intended Prosecution given?	NO
If Yes, against whom?	

Circumstances of Accident

ON STATED DATE AND TIME, MY VEHICLE WAS STATIONARY STOPPED ALONG BLK 302 UBI AVE 1 OPEN SPACE CARPARK AS WAITING FOR AN EMPTY CARPARK LOT. A VEHICLE CAME OUT OF LOT NO 17. I CHECK MY BLIND SPOT BEFORE I CAN REVERSED MY VEHICLE. AS I REVERSED MY VEHICLE, I DID NOT NOTICED THAT VEHICLE B WAS TOO CLOSE TO MY VEHICLE. AS A RESULT, MY VEHICLE SLIGHTLY GRAZED ONTO VEHICLE B FRONT PORTION.

Attachment(s)

Are accident photos available for attachment?	YES
Was there any video captured by Car Camera?	NO
Was there any audio recorded?	NO

DETAILS OF OTHER VEHICLE PROPERTY 1

Vehicle Registration Number	ET8989E
Vehicle Make/Model/Colour	
Details Of Properties	
Vehicle Category	PRIVATE CAR
Name of Driver	TAY LIAN GEOK
NRIC/Passport Number	S1581503E
Contact Number	

Address

Postcode

Insurance Company Name

Nature Of Damage

No. Of Passenger (Including Driver) 1

Accident Sketch Plan

SKETCH PLAN

IMPORTANT NOTICE

1. Please report correctly the details of the accident to speed up the claims process.
2. This Form must be completed by the Policyholder and/or the Authorised Driver.
3. Information provided must be as truthful and accurate as possible. Any wilful misrepresentation or withholding of material facts may allow insurance companies to repudiate policy liability.
4. The issue and acceptance of this Form by insurance companies is not an admission of policy liability on the part of the insurance companies.
5. Any false reporting may be referred to the Police for investigation.
6. The report will be forwarded by the insurers of the GIA Records Management Centre established by the General Insurance Association of Singapore (GIA) for archiving and that copies of this report will for a fee be made available upon application by interested parties.
7. By the lodgment of this report to the insurers, you hereby consent to the archiving of this report at the centre and to copies of the report being made available aforesaid.
8. **Consent under the Personal Data Protection Act (PDPA)**

I understand, acknowledge, agree and consent that:

- (a) My insurer, my workshop and the General Insurance Association of Singapore ("GIA") may/are permitted to collect, use, disclose and/or process my personal data/personal information set out in this [form] and any other personal information provided by me or possessed by my insurer (collectively the "Personal Information") and disclose and transfer such Personal Information to all insurer(s) who have insured vehicle(s) involved in this accident (all insurer(s) who have insured vehicle(s) involved in this accident shall be collectively referred to as the "Insurers"), the Insurers' lawyers/law firms, the Monetary Authority of Singapore and any relevant government agency/authority (such as the police), for the purpose(s) of:
 - (i) processing, handling and/or dealing with my claims including the settlement of the claims and any necessary investigations relating to the claims;
 - (ii) investigating the accident and/or my claims;
 - (iii) carrying out and/or dealing with my instructions or responding to any enquiries by me;
 - (iv) administering my claims (including the mailing of correspondence, statements, invoices, reports or notices to me, which could involve disclosure of certain personal data about me to bring about delivery of the same as well as on the external cover of envelopes/mail packages); and/or
 - (v) complying with applicable law in administering, processing, handling and/or dealing with my claims (collectively the "Purposes")
- (b) all insurer(s) who have insured vehicle(s) involved in this accident and the Insurers' lawyers/law firms, may/are permitted to collect, use, disclose and/or process my Personal Information for one or more of the above Purposes; and
- (c) my Personal Information may/can be disclosed by any of the Insurers and/or GIA to their third party service providers or agents (including their lawyers/law firms), which may be sited outside of Singapore, for one or more of the above Purposes.
- (d) my Personal Information will also be collected and used to compile claims history for the purpose of fraud detection, investigation and management in present and all future claims.
- (e) the information so collected under (d) above may be shared / disclosed:
 - (i) to all insurers and/or any other third parties that assist in evaluating, investigating, controlling or managing fraud, regulators, law enforcement and government agencies as reasonably required for the purposes stated, or
 - (ii) for complying with requirements under any regulations, laws or court orders.

Policyholder's Signature
Date & Time:

Driver's Signature
(If driver is not the policyholder)
Date & Time:

Reporting Centre Personnel's Signature
Name:
NRIC/FIN No.:

Accident Sketch Plan

SKETCH PLAN

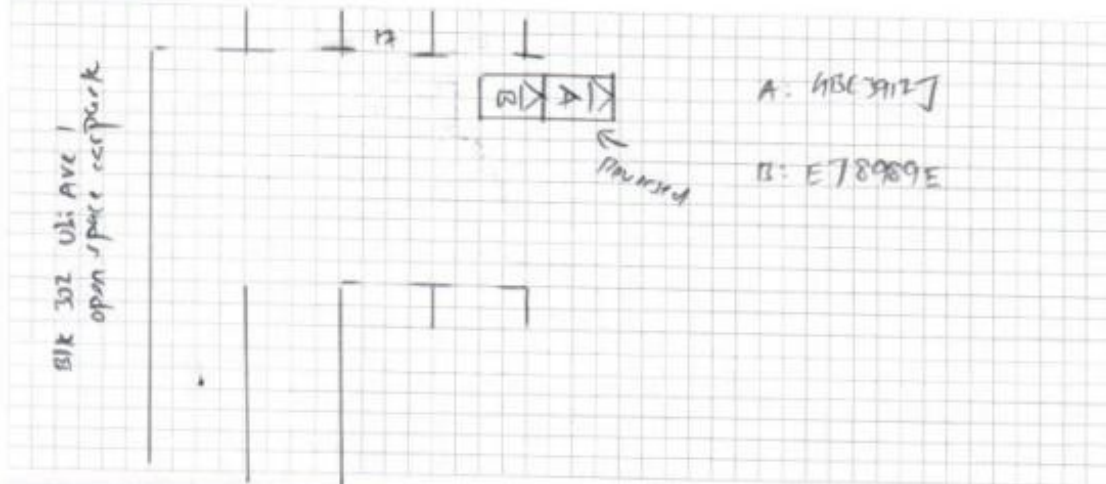

DESCRIBE CIRCUMSTANCES OF THE ACCIDENT

Refer to statement.

DECLARATION

I/We declare the foregoing particulars are true in every respect.

Policyholder's Signature
Date & Time:

Driver's Signature
(if driver is not the policyholder)
Date & Time:

Reporting Centre Personnel's Signature
Name:
NRIC/FIN No.:

©2014 ACC SketchPlanform 9.3

INFORMATION RESOURCES

WHILST EVERY ENDEAVOR IS MADE TO ENSURE THAT INFORMATION PROVIDED IS UPDATED AND CORRECT, THE AUTHORITY DISCLAIMS ANY LIABILITY FOR ANY DAMAGE OR LOSS THAT MAY BE CAUSED AS A RESULT OF ANY ERROR OR OMISSION.

Business Profile (Business) of DESIGN 2000 LANDSCAPE SERVICES (52845024K)

Date: 06/05/2016

The Following Are The Brief Particulars of :

Name of Business	DESIGN 2000 LANDSCAPE SERVICES
Former Name(s) if any	
Date of Change of Name	
Registration No.	52845024K
Registration Date	12/05/1997
Commencement Date	07/05/1997
Status of Business	Live
Status Date	12/05/1997
Renewal Date	22/04/2015
Expiry Date	12/05/2017
Renewal via GIRO	YES
Constitution of Business	Sole-Proprietor
Principal Place of Business	222 BALESTIER ROAD SINGAPORE (329686)
Date of Change of Address	

Principal Activities

Activities (I)	ACTIVITIES OF HOUSEHOLDS NEC (97009)
Description	
Activities (II)	LANDSCAPE CARE AND MAINTENANCE SERVICE ACTIVITIES (81300)
Description	

Particulars of Authorised Representative(s)

Name	ID	Nationality	Address	Address Source	Date of Appointment
------	----	-------------	---------	----------------	---------------------

Existing Sole-Proprietor(s) / Partner(s)

Name	ID	Nationality/Place of Incorporation/Origin	Address	Address Source	Date of Entry Position
------	----	--	---------	----------------	---------------------------

INFORMATION RESOURCES

WHILST EVERY ENDEAVOR IS MADE TO ENSURE THAT INFORMATION PROVIDED IS UPDATED AND CORRECT. THE AUTHORITY DISCLAIMS ANY LIABILITY FOR ANY DAMAGE OR LOSS THAT MAY BE CAUSED AS A RESULT OF ANY ERROR OR OMISSION.

Business Profile (Business) of DESIGN 2000 LANDSCAPE SERVICES (52845024K)

Date: 06/05/2016

Existing Sole-Proprietor(s) / Partner(s)

Name	ID	Nationality/Place of Incorporation/Origin	Address	Address Source	Date of Entry Position
LEE TONG SIONG	S1522419C	SINGAPORE CITIZEN	352 UBI AVENUE 1 #09-987 SINGAPORE (400352)	OSCARS	07/05/1997 Owner

Withdrawn Partner(s)

Name	ID	Nationality/Place of Incorporation/Origin	Address	Address Source	Date of Entry Position	Date of Withdrawal
------	----	--	---------	-------------------	---------------------------	-----------------------

Abbreviation

OSCARS - One Stop change of Address Reporting Service by Immigration & Checkpoint Authority.

PLEASE NOTE THE INFORMATION HEREIN CONTAINED IS EXTRACTED FROM FORMS/TRANSACTIONS FILED WITH THE AUTHORITY

FOR REGISTRAR OF COMPANIES AND BUSINESS NAMES
SINGAPORE

RECEIPT NO. : ACRA160506102935

DATE : 06/05/2016

This is computer generated. Hence no signature required.

Accident Photo



Accident Photo



Accident Photo



Accident Photo



Accident Photo



Accident Photo



Accident Photo



Accident Photo



Accident Photo

