

# ALAN'S UNITED AUTO PTE. LTD.

Block 7, Sin Ming Industrial Estate, #01-76, Singapore 575642.

Tel: 6453 8686 (3 Lines) Fax: 6459 6550

Company Reg. No.: 201113667N

GST Reg. No.: 201113667N

Vehicle Insured : YM 8764L  
Accident Date : 19-Sep-2018

Our Ref : 218156 (AXA) / CHAN

No. : 05851

Date : 21-Sep-2018

PAGE : 1

SINGAPORE ENGINEERING SERVICES PTE LTD  
32 ANG MO KIO IND. PARK 2  
#05-03, SING INDUSTRIAL COMPLEX  
Singapore 569510

## ESTIMATED COST OF REPAIR FOR ISUZU NNR85UH4A YN286Y

|            |                                     |             |          |
|------------|-------------------------------------|-------------|----------|
| 1 pc       | Front o/s door                      |             | 1,760.00 |
| 1 pc       | Front o/s door rubber               |             | 275.00   |
| 1 pc       | Front o/s door inner lock           |             | 245.00   |
| 1 pc       | Front o/s door outer handle         |             | 155.00   |
| 1 pc       | Front o/s door glass regulator gear |             | 340.00   |
| 1 pc       | Front o/s door outer moulding       |             | 127.00   |
| 1 pc       | Front o/s door lower garnish        |             | 182.00   |
| 2 pcs      | Front o/s door hinge                | @ S\$188.00 | 376.00   |
| 1 pc       | Front o/s door checker              |             | 122.00   |
| 1 pc       | Front o/s door protector            |             | 95.00    |
|            |                                     |             | -----    |
|            |                                     |             | 3,677.00 |
| Less 15% : |                                     |             | 551.55   |
|            |                                     |             | -----    |

|   |                             |           |
|---|-----------------------------|-----------|
| 1 pc  | Front o/s door company logo | 3,125.45  |
|   |                             | 180.00 sn |
| To putty and spray replaced parts   |                             | 500.00    |
| To remove, cut-out damaged parts, panel beating, welding, align, refix and to renew above parts |                             | 400.00    |

Total : S\$ 4,205.45

Singapore Dollars Four Thousand Two Hundred and Five and Cents Forty Five Only

## SINGAPORE ACCIDENT STATEMENT

### IMPORTANT NOTICE

1. Please report correctly the details of the accident to speed up the claims process.
2. This Form must be completed by the Policyholder and/or the Authorised Driver.
3. Information provided must be as truthful and accurate as possible. Any wilful misrepresentation or withholding of material facts may allow insurance companies to repudiate policy ability.
4. The issue and acceptance of this Form by insurance companies is not an admission of policy liability on the part of the insurance companies.
5. **Any false reporting may be referred to the Police for investigation.**
6. This report will be forwarded by the insurers of the GIA Records Management Centre established by the General Insurance Association of Singapore (GIA) for archiving and that copies of this report will, for a fee, be made available upon application by interested parties.
7. By the lodgement of this report to the insurers, you hereby consent to the archiving of this report at the centre and to copies of the report being made available aforesaid.

### ACCIDENT STATEMENT

|                            |   |
|----------------------------|---|
| Date Of Report             | 20/09/2018 15:38                              |
| Date Of Accident           | 19/09/2018 11:50                              |
| Exact Location Of Accident | SING INDUSTRIAL COMPLEX LOADING/UNLOADING BAY |
| Country/State of Loss      | SINGAPORE                                     |

### DETAILS OF OWN VEHICLE

|                             |        |
|-----------------------------|--------|
| Vehicle Registration Number | YN286Y |
|-----------------------------|--------|

### Insured/Policyholder

|                          |  |
|--------------------------|--|
| Name Of Registered Owner | SINGAPORE ENGINEERING SERVICES PTE LTD |
| Co Reg No                | 201009393C                             |
| Email Address            | SRI@SESHUB.COM                         |
| Mobile Phone No          |  |
| Alternative Phone No     | OFFICE-64845711                        |

### Vehicle Particulars

|  |                     |
|--|---------------------|
| Manufacturer   | ISUZU               |
| Model  | NNR85UH4A-3.0 D (M) |
| Exact Purpose for which vehicle was being used at time of accident           | PARKED              |
| Are you claiming under your own insurance policy for repair to your vehicle? | NO                  |
| If No, Please state action to be taken                                       | THIRD PARTY         |
| Vehicle Category   | COMMERCIAL VEHICLE  |

### Insurance Company

|                           |                          |
|---------------------------|--------------------------|
| Name of Insurance Company | ERGO INSURANCE PTE. LTD. |
| Type Of Coverage          | COMPREHENSIVE            |
| Fleet Policy              | NO                       |
| Policy Number             | DMCV18S008107            |
| Cover Note Number         |                          |

### Driver

|                      |                                 |
|----------------------|---------------------------------|
| Name of Driver       | CHANDRA SEKAR SHANMUGA SUNDARAM |
| Passport No/FIN      | G5050591Q                       |
| Date Of Birth        | 03/12/1987                      |
| Occupation           | OUTDOOR                         |
| Date Of Driving Pass | 17/10/2012                      |
| Driving Experience   | 5 YEARS AND 11 MONTHS           |
| Gender               | MALE                            |
| Mobile Number        | (LOCAL) +65-91528465            |
| Fax Number           |                                 |
| Contact Number       |                                 |
| Email Address        | NOEMAIL                         |

|   |  |
|---|--|
| Address   | C/O 32 ANG MO KIO IND. PARK 2, #05-03<br>SING INDUSTRIAL COMPLEX |
| Postcode  | 569510   |
| Was driver an employee of the Insured's Company     | YES  |
| If No, Relationship of the Driver with the Insured  |  |
| Vehicle Registration Number of Driver's Own Vehicle | -  |
|   | -  |
|   | -  |
| Insurance Company of Driver's Own Vehicle           | -  |
|   | -  |
|   | -  |

#### General Information of the Accident

|                    |   |
|--------------------|---|
| Type Of Accident   | HIT AND RUN / VANDALISM / DAMAGED WHILST PARKED |
| Weather Conditions | CLEAR   |
| Road Surface       | DRY   |

#### Other Information

|   |     |
|---|-----|
| Was any foreign vehicle involved in this accident?  | NO  |
| Number of vehicles involved in the accident   |     |
| Was any body injured in the Accident?   | NO  |
| Was any injured conveyed to hospital by ambulance?  |     |
| Was any other material or property damaged?   | YES |
| I have been approached by unknown person(s) soliciting/offering accident claims assistance. | NO  |
| Number of Passengers (Including Driver)   | 1   |

#### Details of Police Action

|   |    |
|---|----|
| Was the accident reported to the police?  | NO |
| If Yes, Please state which Police Station |    |
| Was notice of intended Prosecution given? | NO |
| If Yes, against whom?                     |    |

#### Circumstances of Accident

I PARKED MY LORRY IN THE LOADING/UNLOADING BAY AND OPENED THE DOOR PREPARING TO ALIGHT. VEH. B, YM8764L WHICH WAS PARKED ON THE RIGHT SIDE OF MY LORRY STARTED TO MOVE OFF. SUDDENLY, I FELT AN IMPACT & UPON CHECKING I REALISED THAT THE BACK DOOR OF VEH. B HAD SWING OUT & HIT THE FRONT RIGHT DOOR OF MY LORRY. THE DRIVER OF VEH. B HAD FORGOTTEN TO CLOSE & LOCK THE DOOR BEFORE DRIVING OUT THE LORRY.

#### Attachment(s)

|   |     |
|---|-----|
| Are accident photos available for attachment? | YES |
| Was there any video captured by Car Camera?   | NO  |
| Was there any audio recorded?                 | NO  |

#### DETAILS OF OTHER VEHICLE PROPERTY 1

|                                     |                               |
|-------------------------------------|-------------------------------|
| Vehicle Registration Number         | YM8764L                       |
| Vehicle Make/Model/Colour           | mitsubishi fuso, white colour |
| Details Of Properties               |                               |
| Vehicle Category                    | COMMERCIAL VEHICLE            |
| Name of Driver                      | GAGAN DEEP SINGH              |
| NRIC/Passport Number                | G3089497P                     |
| Contact Number                      | 90846571                      |
| Address                             |                               |
| Postcode                            |                               |
| Insurance Company Name              |                               |
| Nature Of Damage                    |                               |
| No. Of Passenger (Including Driver) |                               |

**SKETCH PLAN**

**IMPORTANT NOTICE**

1. Please report correctly the details of the accident to speed up the claims process.
2. This Form must be completed by the Policyholder and/or the Authorised Driver.
3. Information provided must be as truthful and accurate as possible. Any wilful misrepresentation or withholding of material facts may allow insurance companies to repudiate policy liability.
4. The issue and acceptance of this Form by insurance companies is not an admission of policy liability on the part of the insurance companies.
5. Any false reporting may be referred to the Police for investigation.
6. The report will be forwarded by the insurers of the GIA Records Management Centre established by the General Insurance Association of Singapore (GIA) for archiving and that copies of this report will for a fee be made available upon application by interested parties.
7. By the lodgment of this report to the insurers, you hereby consent to the archiving of this report at the centre and to copies of the report being made available aforesaid.
8. **Consent under the Personal Data Protection Act (PDPA)**

I understand, acknowledge, agree and consent that:

- (a) My insurer, my workshop and the General Insurance Association of Singapore ("GIA") may/are permitted to collect, use, disclose and/or process my personal data/personal information set out in this [form] and any other personal information provided by me or possessed by my insurer (collectively the "Personal Information") and disclose and transfer such Personal Information to all insurer(s) who have insured vehicle(s) involved in this accident (all insurer(s) who have insured vehicle(s) involved in this accident shall be collectively referred to as the "Insurers"), the Insurers' lawyers/law firms, the Monetary Authority of Singapore and any relevant government agency/authority (such as the police), for the purpose(s) of :
  - (i) processing, handling and/or dealing with my claims including the settlement of the claims and any necessary investigations relating to the claims;
  - (ii) investigating the accident and/or my claims;
  - (iii) carrying out and/or dealing with my instructions or responding to any enquiries by me;
  - (iv) administering my claims (including the mailing of correspondence, statements, invoices, reports or notices to me, which could involve disclosure of certain personal data about me to bring about delivery of the same as well as on the external cover of envelopes/mail packages); and/or
  - (v) complying with applicable law in administering, processing, handling and/or dealing with my claims.(collectively the "Purposes")
- (b) all insurer(s) who have insured vehicle(s) involved in this accident and the Insurers' lawyers/law firms, may/are permitted to collect, use, disclose and/or process my Personal Information for one or more of the above Purposes; and
- (c) my Personal Information may/can be disclosed by any of the Insurers and/or GIA to their third party service providers or agents(including their lawyers/law firms), which may be sited outside of Singapore, for one or more of the above Purposes.
- (d) my Personal Information will also be collected and used to compile claims history for the purpose of fraud detection, investigation and management in present and all future claims.
- (e) the information so collected under (d) above may be shared / disclosed:
  - (i) to all insurers and/or any other third parties that assist in evaluating, investigating, controlling or managing fraud, regulators, law enforcement and government agencies as reasonably required for the purposes stated, or
  - (ii) for complying with requirements under any regulations, laws or court orders.



Policyholder's Signature  
Date & Time:

Driver's Signature  
(If driver is not the policyholder)  
Date & Time:

20/07/18  
02.55pm

Reporting Centre Personnel's Signature  
Name:  
NRIC/FIN No.:

James Chen

SKETCH PLAN

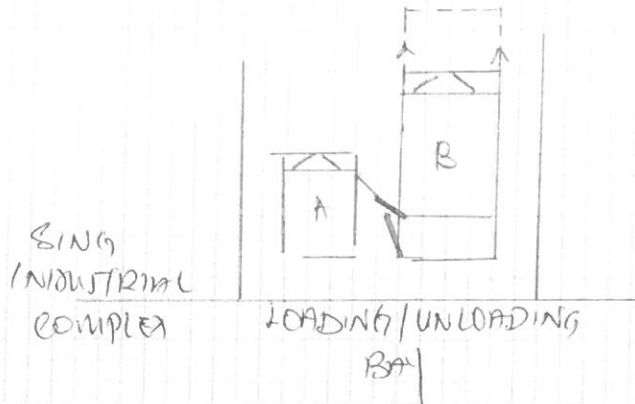

DESCRIBE CIRCUMSTANCES OF THE ACCIDENT

I PARKED MY LORRY IN THE LOADING/UNLOADING BAY AND OPENED THE DOOR PREPARING TO ALIGHT. VEH. B, YN 8764L WHICH WAS PARKED ON THE RIGHT SIDE OF MY LORRY STARTED TO MOVE OFF. SUDDENLY I FELT AN IMPACT & UPON CHECKING, I REACHED THAT THE BACK DOOR OF VEH. B HAD SWING OUT & HIT THE FRONT RIGHT DOOR OF MY LORRY. THE DRIVER OF VEH. B HAD FORGOTTEN TO CLOSE & LOCK THE DOOR BEFORE DRIVING OUT THE LORRY.

DECLARATION

I/We declare the foregoing particulars are true in every respect.

Policyholder's Signature  
Date & Time:

Driver's Signature  
(If driver is not the policyholder)  
Date & Time: 20/09/18  
02.57pm

Reporting Centre Personnel's Signature  
Name: James Chan  
NRIC/FIN No.:

**CERTIFICATE OF INSURANCE**  
 MOTOR VEHICLES (THIRD-PARTY RISKS AND COMPENSATION) ACT (CHAPTER 189)  
 MOTOR VEHICLES (THIRD-PARTY RISKS AND COMPENSATION) RULES, 1960  
 ROAD TRANSPORT ACT, 1987 (MALAYSIA)  
 MOTOR VEHICLES (THIRD-PARTY RISKS) RULES, 1959 (MALAYSIA)

|  |  |
|--|--|
| <b>CERTIFICATE NO. DMCV18S008107</b>   | <b>C18074387</b>                               |
| Type of CI: Commercial Vehicle   |  |
| Cover: Comprehensive   | S2545 ACHIEVERS CAPITAL LLP                    |
| 1) Registration No. of Vehicle:  | YN286Y   |
| 2) Name of Policyholder:   | SINGAPORE ENGINEERING SERVICES PRIVATE LIMITED |
| 3) Commencement Date of Insurance:   | 26/05/2018                                     |
| 4) Expiry Date of Insurance:   | 25/05/2019                                     |
| 5) Persons or Classes of Persons entitled to drive   |  |
| 1) Any person who is driving on the Policyholder's order or permission   |  |
| Excess (Section 1) : S\$800.00   |  |
| Windscreen - Below 10 tons : S\$100.00   |  |
| Windscreen -10 tons & above : S\$200.00  |  |
| Young & Inexp Drivers(Section 1) : S\$2,500.00   |  |
| 6) Name of Finance Company/Hire Purchase Owner: NA   |  |
| 7) Provided that the person driving is permitted in accordance with the licensing or other laws or regulations to drive the Motor Vehicle or has been so permitted and is not disqualified by order of a Court of Law or by reason of any enactment or regulation in that behalf from driving the Motor Vehicle. |  |
| And provided further that the Motor Vehicle is registered under the Road Traffic Act and its registration under the Road Traffic Act has not been cancelled at the time of the accident loss or damage.  |  |
| 8) Limitations as to Use   |  |
| (1) Use in connection with the Policyholder's business   |  |
| (2) Use for carriage of passengers (other than for hire or reward) in connection with the Policyholder's business  |  |
| (3) Use for social domestic and pleasure purposes  |  |
| This Policy does not cover   |  |
| (1) Use for hire or reward, racing, pace-making, reliability trial or speed-testing  |  |
| (2) Use whilst drawing a trailer except the towing of any one disabled mechanically propelled vehicle  |  |
| Limitations rendered inoperative by Section 8 of the Motor Vehicles (Third-Party Risks and Compensation) Act (Chapter 189) and Section 95 of the Road Transport Act, 1987 (Malaysia), are not to be included under these headings (for Items 7 & 8).   |  |

WE HEREBY CERTIFY that the Policy to which this Certificate relates is issued in accordance with the provisions of the Motor Vehicles (Third-Party Risks and Compensation) Act (Chapter 189) and Part IV of the Road Transport Act, 1987 (Malaysia).

For and on behalf of  
 ERGO Insurance Pte. Ltd.  
 (Approved Insurer)

AUTHORIZED SIGNATURE

# Annex A

Transaction ref 20110428103028401833

The owner and vehicle particulars for Vehicle No. YN286Y as at 28 Apr 2011 are as follows:

|  |  |
|--|--|
| 1. Name                                  | : SINGAPORE ENGINEERING SERVICES PRIVATE LIMITED |
| 2. Identification No. Type               | : Company  |
| 3. Identification No.                    | : 201009393C                                     |
| 4. Place Of Passport Issue               | : -  |
| 5. Vehicle No.                           | : YN286Y   |
| 6. Previous Vehicle No.                  | : -  |
| 7. Effective Date of Ownership           | : 28 Apr 2011                                    |
| 8. Original Registration Date            | : 26 May 2009                                    |
| 9. First Registration Date               | : 26 May 2009                                    |
| 10. Vehicle Type                         | : B31 - Goods (Open) Lorry (Metal Body)/Pickup   |
| 11. Vehicle Scheme                       | : Normal   |
| 12. Attachment 1                         | : With Hood                                      |
| 13. Attachment 2                         | : -  |
| 14. Attachment 3                         | : -  |
| 15. Vehicle Make                         | : ISUZU  |
| 16. Vehicle Model                        | : NNR85UH4A                                      |
| 17. Year of Manufacture                  | : 2008   |
| 18. Primary Colour                       | : White  |
| 19. Secondary Colour                     | : -  |
| 20. Passenger Capacity                   | : 2  |
| 21. Chassis/Trailer Chassis No.          | : JAANNR85H97100725 / -                          |
| 22. Propellant                           | : Diesel   |
| 23. Engine No./Motor No.                 | : 4JJ1757361 / -                                 |
| 24. Engine Capacity(cc)/Power Rating(kw) | : 2999 / -                                       |
| 25. Unladen Weight(kg)                   | : 2500   |

**Annex A**

Transaction ref 20110428103028401833

The owner and vehicle particulars for Vehicle No. YN286Y as at 28 Apr 2011 are as follows:

|  |   |
|--|---|
| 26. Maximum Laden Weight(kg)               | : 5000  |
| 27. Open Market Value                      | : \$33,032.00   |
| 28. PARF Eligibility                       | : No  |
| 29. PARF Eligibility Expiry Date           | : -   |
| 30. Minimum PARF Benefit                   | : \$0.00  |
| 31. No. of Transfers                       | : 1   |
| 32. IU Label No.                           | : 1510746712  |
| 33. COE No.                                | : 2009050105000225C   |
| 34. COE Expiry Date                        | : 25 May 2019   |
| 35. COE Category                           | : C - Goods Vehicle & Bus   |
| 36. Quota Premium/Prevailing Quota Premium | : \$7,302.00 / -  |
| 37. Actual Quota Premium/PQP Paid          | : \$7,302.00  |
| 38. Actual ARF Paid                        | : \$1,652.00  |
| 39. Vehicle Lifespan Expiry Date           | : 25 May 2029   |
| 40. Road Tax Amount                        | : -   |
| 41. Road Tax Start Date                    | : -   |
| 42. Road Tax End Date                      | : -   |
| 43. Remarks                                | : To renew the COE, the Prevailing Quota Premium payable is that of Category C. |