

# NATIONAL Assessment Centre Services.

[wef 1 Jan'05] **MNA/18/1815**

Date In: <b>11/1/18-11:04</b>	Job description	Date & Time Completed	Done by
Ref No: <b>NA/6A2B016386/24</b>	SAS e-filing		
Veh No: <b>YP4367K</b>	E-mail (within 8hrs, AIC 2hrs)		
D.O.A : <b>7/1/18-14:30</b>	i-Motor Claim Form		
OD : <b>TP</b> Reporting Only	i-Motor W/O (Within: OD 2hrs, TP 4hrs)		
	i-Photo Uploaded		
TP Insurer:	Assessment/Survey Report		
	Ass't Report by Fax / Hand to Owner/Wksp		

Preferred Wksp / INC Assign Wksp / QW: ( ) Tel: ( ) Fax: ( )

TP Particulars: Vch No: **SE6600L** INC ( ) / Non-INC ( )

Owner / Driver: ( ) Tel: ( )

Policy No: ( ) Period: ( ) Cover Type: ( )

Confirmed by: ( ) Date: ( ) Time: ( )

Insured/Driver Liability: ( ) % [Note-Est. Status (WO): N: 0-20%; P: 21-79% P: 80-100%]

Year of Registration: ( ) Warranty: YES ( ) / NO ( )

Excess: (\$ ) Loading: \$1,000 ( ) / \$2,000 ( )

## General Remarks:

( ) Walk-In Customer : Customer's information strictly Confidential & Strictly NO refer of repairer.

( ) Total Loss Case : to e-mail Insurer URGENTLY.

Drive-In ( ) / Towed-In ( ) ; Invoice: YES ( ) / NO ( ) ; Towing Co: ( )

Remarks: (INC hotline: 6788 6616)	Date & Time Completed	Done by
1) Apply for Transport Allowance ( ) / Courtesy Car ( )		
2) QC Check / Post Repair Inspection ( )		
3) Upload Resurvey Photo [Repair Cost > \$3000] ( )		

Injury : \_\_\_\_\_

Date/Time	Actions

<b>NA 1805811</b>	<b>Invoice Preparation Checklist</b>		Amf (\$) 1st Bill	Amf (\$) Add Bill
Claimant's Particulars:-	1) AR: Accident Reporting (\$30);			
Driver/Owner:	2) DA: Damage Assessment (\$100); INC (\$80)			
Contact No:	3) TF: Towing Fee \$40/\$45			
Damaged Portion:	4) FT: Follow-Through Survey \$120			
	5) FT: Follow-Through Survey (Resurvey) \$30			
	For claiming against INC Only (wef 10 Jan 2005)			
	6) TR: Re-inspection \$75			
	7) N1: Idac DA + SMRT Survey \$160			
	8) NTUC Additional Services:-			
	OD*			
	*N5: Courtesy Car / Tpt Allowance \$5			
	*N6: Repair Co-ordination \$10			
	*N7: Post Repair Inspection \$25			
	*N8: DV / Collect Excess Coordination \$5			
	TP (N11): TP (Non INC) against INC \$20			
	9) N12: Idac Mobile 30			
Auditors' Comments:-	Invoice dated	Fee Charged		
	Invoice dated	Fee Charged		



## SINGAPORE ACCIDENT STATEMENT

### IMPORTANT NOTICE

1. Please report correctly the details of the accident to speed up the claims process.
2. This Form must be completed by the Policyholder and/or the Authorised Driver.
3. Information provided must be as truthful and accurate as possible. Any wilful misrepresentation or withholding of material facts may allow insurance companies to repudiate policy ability.
4. The issue and acceptance of this Form by insurance companies is not an admission of policy liability on the part of the insurance companies.
5. **Any false reporting may be referred to the Police for investigation.**
6. This report will be forwarded by the insurers of the GIA Records Management Centre established by the General Insurance Association of Singapore (GIA) for archiving and that copies of this report will, for a fee, be made available upon application by interested parties.
7. By the lodgement of this report to the insurers, you hereby consent to the archiving of this report at the centre and to copies of the report being made available aforesaid.

### ACCIDENT STATEMENT

Date Of Report	11/09/2018 19:04
Date Of Accident	07/09/2018 14:30
Exact Location Of Accident	BLK 101 YISHUN AVE 5 OPEN SPACE CARPARK
Country/State of Loss	SINGAPORE

### DETAILS OF OWN VEHICLE

Vehicle Registration Number	YP4367K
<b>Insured/Policyholder</b>	
Name Of Registered Owner	UNI-TAT ICE & MARKETING PTE LTD
Co Reg No	199406736C
Email Address	NOEMAIL
Mobile Phone No	
Alternative Phone No	OFFICE-89999999

### Vehicle Particulars

Manufacturer	HINO
Model	HINO XZU700R-HKFMS3
Exact Purpose for which vehicle was being used at time of accident	COMMERCIAL USE
Are you claiming under your own insurance policy for repair to your vehicle?	NO
If No, Please state action to be taken	THIRD PARTY
Vehicle Category	COMMERCIAL VEHICLE

### Insurance Company

Name of Insurance Company	GREAT AMERICAN INSURANCE COMPANY
Type Of Coverage	COMPREHENSIVE
Fleet Policy	NO
Policy Number	MOMVC000001994-01-000
Cover Note Number	

### Driver

Name of Driver	HE JINGZHI
Passport No/FIN	G2994187X
Date Of Birth	15/07/1989
Occupation	OUTDOOR
Date Of Driving Pass	28/11/2017
Driving Experience	0 YEAR AND 9 MONTH
Gender	MALE
Mobile Number	(LOCAL) +65-96657706
Fax Number	
Contact Number	OFFICE-96657706
Email Address	NOEMAIL

Address	51 UBI AVENUE 1 #01-26 PAYA UBI INDUSTRIAL PARK
Postcode	408933
Was driver an employee of the Insured's Company	YES
If No, Relationship of the Driver with the Insured	
Vehicle Registration Number of Driver's Own Vehicle	-
	-
	-
Insurance Company of Driver's Own Vehicle	-
	-
	-

#### General Information of the Accident

Type Of Accident	SIDE SWIPE
Weather Conditions	CLEAR
Road Surface	WET

#### Other Information

Was any foreign vehicle involved in this accident?	NO
Number of vehicles involved in the accident	2
Was any body injured in the Accident?	NO
Was any injured conveyed to hospital by ambulance?	
Was any other material or property damaged?	YES
I have been approached by unknown person(s) soliciting/offering accident claims assistance.	NO
Number of Passengers (Including Driver)	1

#### Details of Police Action

Was the accident reported to the police?	NO
If Yes, Please state which Police Station	
Was notice of intended Prosecution given?	NO
If Yes, against whom?	

#### Circumstances of Accident

REFER TO STATEMENT.

#### Attachment(s)

Are accident photos available for attachment?	YES
Was there any video captured by Car Camera?	NO
Was there any audio recorded?	NO

#### DETAILS OF OTHER VEHICLE PROPERTY 1

Vehicle Registration Number	SE6606L
Vehicle Make/Model/Colour	
Details Of Properties	
Vehicle Category	PRIVATE CAR
Name of Driver	
NRIC/Passport Number	
Contact Number	
Address	
Postcode	
Insurance Company Name	
Nature Of Damage	
No. Of Passenger (Including Driver)	



## SKETCH PLAN

### IMPORTANT NOTICE

1. Please report correctly the details of the accident to speed up the claims process.
2. This Form must be completed by the Policyholder and/or the Authorised Driver.
3. Information provided must be as truthful and accurate as possible. Any wilful misrepresentation or withholding of material facts may allow insurance companies to repudiate policy liability.
4. The issue and acceptance of this Form by insurance companies is not an admission of policy liability on the part of the insurance companies.
5. Any false reporting may be referred to the Police for investigation.
6. The report will be forwarded by the Insurers of the GIA Records Management Centre established by the General Insurance Association of Singapore (GIA) for archiving and that copies of this report will for a fee be made available upon application by interested parties.
7. By the lodgment of this report to the insurers, you hereby consent to the archiving of this report at the centre and to copies of the report being made available aforesaid.
8. Consent under the Personal Data Protection Act (PDPA)

I understand, acknowledge, agree and consent that:

- (a) My insurer, my workshop and the General Insurance Association of Singapore ("GIA") may/are permitted to collect, use, disclose and/or process my personal data/personal information set out in this [form] and any other personal information provided by me or possessed by my insurer (collectively the "Personal Information") and disclose and transfer such Personal Information to all insurer(s) who have insured vehicle(s) involved in this accident (all insurer(s) who have insured vehicle(s) involved in this accident shall be collectively referred to as the "Insurers"), the insurers' lawyers/law firms, the Monetary Authority of Singapore and any relevant government agency/authority (such as the police), for the purpose(s) of:
  - (i) processing, handling and/or dealing with my claims including the settlement of the claims and any necessary investigations relating to the claims;
  - (ii) investigating the accident and/or my claims;
  - (iii) carrying out and/or dealing with my instructions or responding to any enquiries by me;
  - (iv) administering my claims (including the mailing of correspondence, statements, invoices, reports or notices to me, which could involve disclosure of certain personal data about me to bring about delivery of the same as well as on the external cover of envelopes/mail packages); and/or
  - (v) complying with applicable law in administering, processing, handling and/or dealing with my claims. (collectively the "Purposes")
- (b) all insurer(s) who have insured vehicle(s) involved in this accident and the insurers' lawyers/law firms, may/are permitted to collect, use, disclose and/or process my Personal Information for one or more of the above Purposes; and
- (c) my Personal Information may/can be disclosed by any of the Insurers and/or GIA to their third party service providers or agents (including their lawyers/law firms), which may be sited outside of Singapore, for one or more of the above Purposes.
- (d) my Personal Information will also be collected and used to compile claims history for the purpose of fraud detection, investigation and management in present and all future claims.
- (e) the information so collected under (d) above may be shared / disclosed:
  - (i) to all Insurers and/or any other third parties that assist in evaluating, investigating, controlling or managing fraud, regulators, law enforcement and government agencies as reasonably required for the purposes stated, or
  - (ii) for complying with requirements under any regulations, laws or court orders.

Policyholder's Signature  
Date & Time:

Driver's Signature  
(If driver is not the policyholder)  
Date & Time:

Reporting Centre Personnel's Signature  
Name:  
NRIC/FIN No.:

# SKETCH PLAN

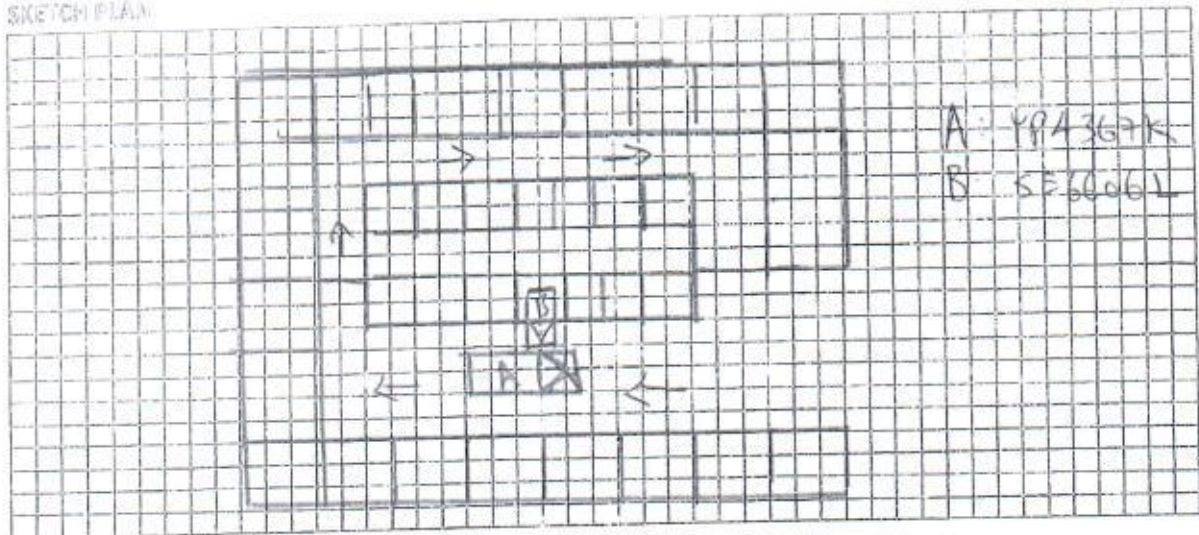

## DESCRIBE CIRCUMSTANCES OF THE ACCIDENT

My car was inside the open space carpark of Yishun Ave S Blk 101. As there is a major event going on, half of the carpark was occupied with tables & chairs. Therefore all of the vehicle that wants to exit the carpark has to go Anti-clockwise in order to exit the carpark. while I was leaving and passing by vehicle B, vehicle B suddenly drive forward and hit onto my vehicle left position.

## DECLARATION

I/We declare the foregoing particulars are true in every respect.

Policyholder's Signature  
Date & Time:

Driver's Signature  
(If driver is not the policyholder)  
Date & Time:

Reporting Centre Personnel's Signature  
Name:  
NRIC/FIN No.:



## SINGAPORE ACCIDENT STATEMENT

## IMPORTANT NOTICE

- ❖ Complete and submit this form to the individual insurance authorised reporting centre.
- ❖ Please report correctly on the details of the accident to speed up the claim process.
- ❖ This form must be filled up by the policy holder and/or authorised driver.
- ❖ Information provided must be as fruitful and accurate as possible. Any wilful misrepresentation or withholding of material facts may allow insurance companies to repudiate policy liability.
- ❖ The issue and acceptance of this form by insurance companies is not an admission of policy liability on the part of the insurance companies.
- ❖ Any false reporting may be referred to the traffic police department for investigation.

## ACCIDENT DETAILS

Date of accident	07/09/18	(DD/MM/YY)
Time of accident	1430	(HH:MM)
Exact location of accident	Yishun Ave S Blk 101	

## DETAILS OF VEHICLE

Vehicle registration number	YP 4367K		
Vehicle make and model	Hino 300		
Type of vehicle	Saloon <input type="checkbox"/>	MPV <input type="checkbox"/>	CRV <input type="checkbox"/> Van <input type="checkbox"/>
	Lorry <input checked="" type="checkbox"/>	Bus <input type="checkbox"/>	Motorcycle <input type="checkbox"/> Others: _____
Vehicle category	Private <input type="checkbox"/>	Commercial <input checked="" type="checkbox"/>	Motorcycle <input type="checkbox"/>
Purpose of using at said time			
Are you claiming under your own insurance company?	Yes <input type="checkbox"/>	No <input checked="" type="checkbox"/>	If no, please select: Third part claim <input checked="" type="checkbox"/> Reporting only <input type="checkbox"/>

## INSURANCE INFORMATION

Insurance company	Great American Insurance		
Policy number	MUMVC00001994 - 01 - 000		
Type of policy	Comprehensive <input checked="" type="checkbox"/>	Third party fire & theft <input type="checkbox"/>	TP only <input type="checkbox"/>

## INSURED / POLICY HOLDER

Name	Uni-Tat Inc & Marketing PTE LTD	Male <input type="checkbox"/>	Female <input type="checkbox"/>
NRIC / Fin / Passport number			
Contact			
Address			

## DRIVER

SAME AS INSURED ABOVE ☐ (SKIP TO D.O.B)

Name	He Jingzhi	Male <input type="checkbox"/>	Female <input type="checkbox"/>
NRIC / Fin / Passport number	G2994187X		
Contact	96657706		
Address	S1 Poyan Ln Industrial Park Ubi Ave 1 #01-39 S(408934)		
Email address			
Date of birth	15/07/1989		
Occupation	Indoor <input type="checkbox"/>	Outdoor <input checked="" type="checkbox"/>	
Driving date pass	28/11/2017		



### GENERAL INFORMATION OF THE ACCIDENT

Was driver an employee of the insured's company?	Yes <input checked="" type="checkbox"/> No <input type="checkbox"/>
Accident captured by camera?	Yes <input type="checkbox"/> No <input checked="" type="checkbox"/>
Weather condition	Clear <input checked="" type="checkbox"/> Raining <input type="checkbox"/> Others: _____
Road surface	Dry <input type="checkbox"/> Wet <input checked="" type="checkbox"/>
No of passenger	_____ (Inclusive of driver)

### PASSENGER 1

Name	_____
Gender	Male <input type="checkbox"/> Female <input type="checkbox"/>

### PASSENGER 2

Name	_____
Gender	Male <input type="checkbox"/> Female <input type="checkbox"/>

### PASSENGER 3

Name	_____
Gender	Male <input type="checkbox"/> Female <input type="checkbox"/>

### PASSENGER 4

Name	_____
Gender	Male <input type="checkbox"/> Female <input type="checkbox"/>

### PASSENGER 5

Name	_____
Gender	Male <input type="checkbox"/> Female <input type="checkbox"/>

### PASSENGER 6

Name	_____
Gender	Male <input type="checkbox"/> Female <input type="checkbox"/>

### OTHER INFORMATION

Was anybody injured?	Yes <input type="checkbox"/> No <input checked="" type="checkbox"/>
Was other vehicle damaged?	Yes <input checked="" type="checkbox"/> No <input type="checkbox"/>

### DETAILS OF POLICE ACTION

Reported to police?	Yes <input type="checkbox"/> No <input checked="" type="checkbox"/> If yes, please state which police station.
Police station name	_____

### WITNESS 1

Name	_____
------	-------

### WITNESS 2

Name	_____
------	-------



THIRD PARTY VEHICLE 1	
Vehicle registration number	SE6606L
Vehicle make model	
Name	
NRIC / Fin / Passport number	
Contact	

THIRD PARTY VEHICLE 2	
Vehicle registration number	
Vehicle make model	
Name	
NRIC / Fin / Passport number	
Contact	

THIRD PARTY VEHICLE 3	
Vehicle registration number	
Vehicle make model	
Name	
NRIC / Fin / Passport number	
Contact	

THIRD PARTY VEHICLE 4	
Vehicle registration number	
Vehicle make model	
Name	
NRIC / Fin / Passport number	
Contact	

THIRD PARTY VEHICLE 5	
Vehicle registration number	
Vehicle make model	
Name	
NRIC / Fin / Passport number	
Contact	

THIRD PARTY VEHICLE 6	
Vehicle registration number	
Vehicle make model	
Name	
NRIC / Fin / Passport number	
Contact	

THIRD PARTY VEHICLE 7	
Vehicle registration number	
Vehicle make model	
Name	
NRIC / Fin / Passport number	
Contact	



INJURED PERSON 1	
Name	
Injuries sustained	
Which vehicle person in?	
Were seat belts worn?	Yes <input type="checkbox"/> No <input type="checkbox"/>
Was injured conveyed to hospital by ambulance?	Yes <input type="checkbox"/> No <input type="checkbox"/>

INJURED PERSON 2	
Name	
Injuries sustained	
Which vehicle person in?	
Were seat belts worn?	Yes <input type="checkbox"/> No <input type="checkbox"/>
Was injured conveyed to hospital by ambulance?	Yes <input type="checkbox"/> No <input type="checkbox"/>

INJURED PERSON 3	
Name	
Injuries sustained	
Which vehicle person in?	
Were seat belts worn?	Yes <input type="checkbox"/> No <input type="checkbox"/>
Was injured conveyed to hospital by ambulance?	Yes <input type="checkbox"/> No <input type="checkbox"/>

INJURED PERSON 4	
Name	
Injuries sustained	
Which vehicle person in?	
Were seat belts worn?	Yes <input type="checkbox"/> No <input type="checkbox"/>
Was injured conveyed to hospital by ambulance?	Yes <input type="checkbox"/> No <input type="checkbox"/>

INJURED PERSON 5	
Name	
Injuries sustained	
Which vehicle person in?	
Were seat belts worn?	Yes <input type="checkbox"/> No <input type="checkbox"/>
Was injured conveyed to hospital by ambulance?	Yes <input type="checkbox"/> No <input type="checkbox"/>

INJURED PERSON 6	
Name	
Injuries sustained	
Which vehicle person in?	
Were seat belts worn?	Yes <input type="checkbox"/> No <input type="checkbox"/>
Was injured conveyed to hospital by ambulance?	Yes <input type="checkbox"/> No <input type="checkbox"/>



**WORK PERMIT**  
Employment of Foreign Manpower Act (Chapter 91A)  
Republic of Singapore

Employer:  
**URI-TAT ICE & MARKETING PTE LTD**

Sector: **MANUFACTURING**

Name:  
**HE JINGZHI**

Occupation:  
**DRIVER**

Work Permit No:  
**0 77505015**

Date of Application:  
**09-05-2017**

Date of Issue:  
**07-06-2017**

Date of Expiry:  
**10-05-2019**

**18028722**

**REPUBLIC OF SINGAPORE DRIVING LICENCE**

**G2994187X**

**HE JINGZHI**

Birth Date: **15 Jul 1969**

Issue Date: **14 Sep 2017**

Valid Till: **13/09/2022**

**002723638H**

**VISIT PASS**  
Immigration Regulations

Name:  
**HE JINGZHI**

Date of Birth: **15-07-1969** Sex: **M** Nationality: **CHINESE**

FW: **G2994187X** Date of Issue: **07-06-2017** Date of Expiry: **10-05-2019**

**MULTIPLE JOURNEY VISA ISSUED**

**YOU ARE TO SURRENDER THIS CARD WHEN IT IS CANCELLED OR HAS EXPIRED, OR WHEN A NEW CARD IS ISSUED TO YOU.**

**YOU ARE LICENSED TO DRIVE VEHICLES IN THE FOLLOWING CLASS(ES)**

**EFFECTIVE DATE**

**C** Class 2 Motor cars  $\leq 3500$  kg with  $\leq 7$  passengers, exclusive of the driver, and motor scooters/mopeds  $\leq 250$  kg **18 Nov 2017**

**G2994187X**

**S / No 9000303928**

**NP 428A**

**Licence No: G2994187X**



## CERTIFICATE OF INSURANCE

Motor Vehicles (Third Party Risks and Compensation) Act (Chapter 189) - Motor Vehicles (Third Party Risks and Compensation) Rules, 1987  
(Road Transport Act, 1987) (Malaysia) Motor Vehicles (Third Party Risks) Rules, 1959 (Malaysia)

### Policy Details

Certificate Number	MOMVC000001994-01-000	Cover	Commercial Vehicle (Comprehensive)
Policyholder Name	Uni-Tal Ice & Marketing Pte Ltd	Chassis Number	JHHTCS3H70K003142
NCD Entitlement	20% Fleet Discount	Engine Number	N04CUS28549
Hire Purchase	DBS BANK LTD	Registration Number	YP4367K
Period of Insurance	From 14/10/2017 (00:00) To 13/10/2018 (23:59) (Both Dates Inclusive)		

### Persons or Classes of Persons entitled to Drive

a) Any person who is driving on the Policyholder's order or with their permission  
Provided that the person driving is permitted in accordance with the licensing or other laws or regulations to drive the Motor or so has been Vehicle permitted and is not disqualified by order of a Court of Law or by reason of any enactment or regulation in that behalf from driving the Motor Vehicle

### Limitations as to Use

- a) Use in connection with Policyholder's business  
b) Use for carriage of passengers (other than for hire and reward) in connection with the Policyholder's business

This Policy does not cover:

- a) Use for Hire and Reward  
b) Use for racing, pace making, reliability trial or speed testing

\* Limitations rendered inoperative by Section 8 of the Motor Vehicles (Third Party Risks and Compensation) Act, (Chapter 189) and Section 95 of the Road Transport Act, 1987 (Malaysia), are not to be included under these headings

Excess (Section 1) : SGD 800.00  
Excess (Section 2) : N/A  
Windscreen Excess : SGD 100.00  
ADDITIONAL EXCESS : Please refer overleaf

### Driver Details

Named Driver 01 : Any driver driving on the policyholder's order or permission

Name of intermediary : Tan Insurance Brokers Pte Ltd

Date of Issue : 29/09/2017

I/We hereby certify that the policy to which this Certificate relates is issued in accordance with the provision of the Motor Vehicles (Third Party Risks and Compensation) Act (Chapter 189) and Part IV of the Road Transport Act, 1987 (Malaysia)

Signed for and on behalf of  
Great American Insurance Company



Authorized Signatory

hich

陳保險經紀私營有限公司  
TAN INSURANCE BROKERS PTE LTD  
3A/5A Alwal Street, Chenn Leonn Building  
Singapore 199806  
www.lib.com.sg  
Tel: (65) 6742 6766 Fax: (65) 6742 6669