

ASS. REC. BY:

REF:

CS/MSH18011845/Gg b n2

Special Instructions:

Surveyor

ASSIGNMENT (Office)

Merimen

From (Person):

Christina Wong

of

MSLH

Date/Time: 28062018 406pm

Estimated Cost:

Bill to:

OD / TP WS / TP RES / OD RES / EVA / INV / MV / CS

To Inspect Vehicle No:

SLB 1106U

Insured:

SW 3487B

at Workshop m/s

Performance

Tel:

6319 0174

8/21/4600

of

303 Alexandra Rd

Policy No:

B29040294mcy

Claim No:

562694

Sum Insured:

Excess:

Make of Veh:

D.O.A.

25062018

(Client's Record)

CA / REV / REP. / REV 24 HRS 'wpi

H.O.D. Endorsement

Date/Time:

28062018

436pm

Person Contacted:

Caroline

Vehicle IN/OUT

Date/Time

Action/Instruction (✓) Estimate

SLB 1106U - X

SW 3487B - X

30/7/18 @ 2:43pm revised to Christina Wong on Merimen.

04/11/19 @ 3:09pm confirmed with Caroline final fig \$5866.60, 5 days by email.

(red \$4792.75, 45%)

16/1/19

Already clarified with XGR & Caroline, the repair days should be 5 days, instead of 2 days.

ASSIGNMENT

From: _____ Date: _____
 Estimated Cost: _____
 OD / TP / WS / TP RES / OD RES / EVA / INV / MV
 To Inspect Vehicle No: _____
 at Workshop m/s **Performance Motor**
 of _____
 Insured: **Inthiran**
 Policy No. **Keith 96161510**
 Claims No. _____
 Sum Insured: _____ Excess: _____
 (Client's Record)
 Make of Veh: _____

N/S	O/S

(Policy Condition)
 Remark: The veh had commenced its repair at the time of inspection.
 Bal. or Market Value: _____
 IDAC Accident Rpt: _____ Consistent? : Yes or No
 GIA / PR Seen: _____ Consistent? : Yes or No
 Est. Repairs: **5** days Res.: Yes or No
 Lum Sum: _____ % 3 Val.: Yes or No
 CA / REV / REP. / 24 HRS
 Date: _____ Person Contacted: _____ Vehicle: IN / OUT

Veh No: **SLB1106U** Yr Regn: **18 Aug 2016**
 Type: M Car / M.Cycle / Bus / Van / Lorry / Taxi / Prime Mover /
 Truck / Trailer or _____
 Make: **BMW 640i** C.C. **2979**
 Colour: **Black** A/C: Insured / Std / NI / NA
 Sp. Reading: **26271** T/Radio: Insured / Std / NI / NA
 Eng/No: _____
 C/No: **WBA6D02050D989320**
 Gen. Cond: Good / Fair / Poor / Burnt
 Steering: In order / Jammed / Leaked / Burnt or
 Brake: In order / Jammed / Leaked / Burnt or
 Modi: Nil / S/Rim / STD A Rim or
 Tyre Size: F: **245/40 R19**
 R: **11**
 BS / DUN / EXNOVA / GY / FS / LIZA / MIC / OHTSU / PIR / SUMI /
 TOYO / YOKO or _____
 Front _____ Rear _____
 R/Bal. **6** mm R/Bal. **6** mm
 L/Bal. **6** mm L/Bal. **6** mm
 D.O.A. _____ D.O.I. **27-07-18**
 Survey held at **W/S** **11:30 AM**
 Des. of Damages: Front / Rear / O/S / N/S / U/C / Rooftop or
 The U/C / Chassis frame / Body Structure affected due to collision.

Date / Time	Action / Instruction
	\$5866.6

RECEIVED 11 JAN 2019

4/1/2019

Date/Time: File Pass to? ☐ : Preli. Report ☐ : Final Report
 1) **11/1** **twist**
 Date/Time: File Return to? _____
 2) _____
 Report Format: **NER-TP**
 Lump Sum / I.B.I. (\$) **5866.60**
 Days Of Repair: **5**
 Resurvey No. of Trip: **1**
 Add Fee: ☐ Site Insp (\$) ☐ Interview (\$) ☐ Tech. Invs (\$) ☐ Weekend (\$) ☐ Survey Fee: ☐ Transportation: ☐ Photos: ☐ Others: ☐
 TOTAL **210**

Note: This document has not been finalised.

LKK Auto Consultants Pte Ltd (Co.Reg.No:199607198R)

51 Ubi Ave 1 #01-25, Paya Ubi Industrial Park

Singapore 408933

Tel: 6256-3561 Fax: 6844-8805 Email: sur@lkkauto.com; assignments@lkkauto.com

To: MSIG Insurance (Singapore) Pte. Ltd.
4 Shenton Way
#21-01 SGX Centre 2
Singapore 068807

From: LKK Auto Consultants Pte Ltd
51 Ubi Ave 1 #01-25
Paya Ubi Industrial Park
Singapore 408933

Attn: Christina Wong

Date: 30 Jul 2018

Preliminary Advice

Insured Vehicle No	: SLV3487B		
TP Vehicle No	: SLB1106U	Accident Date	: 25/06/2018
Make	: BMW 640I	Assignment Date	: 28/06/2018
Date of Inspection	: 27/07/2018	Est. Duration of Repair	: 3.00
Inspection At	: PERFORMANCE MOTORS LIMITED (ALEXANDRA) 303 ALEXANDRA ROAD, SIME DARBY PERFORMANCE CENTRE SINGAPORE 159941		

Point of Impact / General Description of Damages

The vehicle sustained impact / damages front portion and parts claimed are consistent to the accident.

Repairer's Estimate (Gross)	:S\$	10,658.85
Revised Amount	:S\$	4,554.15
Check Items (Estimated)	:S\$	2,450.70
Total	:S\$	7,004.85

Lump Sum Repair	:S\$	
-----------------	------	--

Total Loss Consideration

New for Old Value	:S\$	
Pre-Accident Value	:S\$	
COE / PARF Rebate	:S\$	
Salvage Value	:S\$	
Margin for Repair	:S\$	

Remarks

- () The vehicle is economical/not economical for repair.
- (X) The above survey was conducted on a 'without prejudice' basis.

...CLAIM SUBFOLDER...(New Assignment)

CLAIM SUBFOLDER TRACKING

Case	Notified	Est Submitted	Adj Assigned	Adj Rpt	Adj Submitted	Ins Auth'd	Status
Main	27 Jun 2018		28 Jun 2018 16:04 Assign				New Assignment Cancel Case

Main	Reference	Claim Details	Documents	Show All					
CLAIM SUBFOLDER DETAILS		[Created by insurer]							
Insured:	PERFORMANCE MOTORS LTD, Co. Reg. No.: 197401559W								
Main Claimant:	NG KIM LENG, ID: S1266655A								
Vehicle Reg. No.:	SLB1106U	Date of Loss:	25/06/2018 14:00 - :59 [22 Months and 7 Days From LTA Reg Date (Man Yr)]						
Claim Type:	TP / 562694	Policy/Cover Note No.:	B29040254MCY (Comprehensive) Coverage: 01/10/2017 - 30/09/2018						
Vehicle Reg. No. (Insured):	SLV3487B	Policy No. (Claimant):							
		Excess:	S\$500.00						
Repairer:	Performance Motors Limited (Alexandra) 303 Alexandra Road, Sime Darby Performance Centre, 159941 Alexandra - Tel: 63190172/63190174								
Handling Insurer:	MSIG Insurance (Singapore) Pte. Ltd. (HQ) - Tel: +65 6827 7888 ... [Handled by Christina Wong - 6643 1311]								
Adjuster:	LKK Auto Consultants Pte Ltd (HQ) - Tel: 6256-3561 ... [Imm.Advice due 29/06/2018]								
Driver/Custodian (Insured):	GLEN AW YONG WEI REN (), NRIC: S8525204F, Tel: +6591690055								
Adj Asg. Remarks:	Liability is down. TP agree to use LKK as the SJE. W/s contact details: Caroline 6319 0174.								
ASSOCIATED MAIL RECEIVED		View All Compose Case Mail							
There are no mail for this case.									
ALL ASSOCIATED TASKS		View All Search Tasks Create New Task Complete							
Due Date	Priority	Type	Task Group	Subject	Handler	Assigned By	Completed On	Created On	Done?
No results.									

Shiau Chan (LKKAUTO)

From: Shiau Chan (LKKAUTO)
Sent: Friday, 4 January 2019 3:09 PM
To: PBSP; Guo Qiang (LKKAUTO); Inthiran Thurasamy
Cc: SUR
Subject: RE: URGENT REMINDER: FINAL REPORT / SLB1106U

Dear Caroline,

WITHOUT PREJUDICE

Confirm final fig \$5,866.60 before GST and 3 repair days.

Kindly send the relevant documents to MSIG insurance company.

Best Regards,

Shiau Chan (Ms) | Case Handler

LKK Auto Consultants Pte Ltd

Phone: 6256-3561 | email: siewsc@lkkauto.com | fax: 6256-4315

Blk 51, Paya Ubi Industrial Park, Ubi Avenue 1, #02-25 | S(408933)

From: PBSP <pml-pbsp@simedarby.com.sg>
Sent: Monday, 24 December 2018 5:23 PM
To: Guo Qiang (LKKAUTO) <GuoQiang@lkkauto.com>; Inthiran Thurasamy <inthiran.thurasamy@simedarby.com.sg>
Cc: Shiau Chan (LKKAUTO) <siewsc@lkkauto.com>
Subject: Re: URGENT REMINDER: FINAL REPORT / SLB1106U

Dear Inthiran

Please assist to provide the diagram to surveyor soonest.

Thank you.

Regards,
Caroline
C/o Performance Motors Limited - Body and Paint
303 Alexandra Road Singapore 159941
DID: 6319 0174 Fax: 6479 4601

From: Guo Qiang (LKKAUTO) <GuoQiang@lkkauto.com>
Sent: Monday, 24 December 2018 11:43:16 AM
To: PBSP
Cc: Shiau Chan (LKKAUTO)
Subject: RE: URGENT REMINDER: FINAL REPORT / SLB1106U

Dear Caroline,

Inthiran did not send me diagram for supplement 'frt air duct' yet, because photograph did not show clearly.

Regards,
Guo Qiang

> Back to OneMotoring

Enquire PARF/COE Rebate for Registered Vehicle

Vehicle Owner Particulars	
Owner ID Type:	Singapore NRIC
Owner ID:	6655A
Vehicle Details	
Vehicle No.:	SLB1106U
Vehicle to be Exported:	No
Intended De-registration Date:	30 Jul 2018
Vehicle Make:	B.M.W.
Vehicle Model:	640I GRAN COUPE M SPORT SR LED NAV HUD
Primary Colour:	Black
Manufacturing Year:	2016
Engine No.:	05139607N55B30A
Chassis No.:	WBA6D02050D989320
Maximum Power Output:	235.0 kW (315 bhp)
Open Market Value:	\$68,691.00
Original Registration Date:	18 Aug 2016
First Registration Date:	18 Aug 2016
Transfer Count:	0
Actual ARF Paid:	\$95,644.00
Intended PARF Rebate Details	
PARF Eligibility:	Yes
PARF Eligibility Expiry Date:	17 Aug 2026
PARF Rebate Amount:	\$71,733.00
Intended COE Rebate Details	
COE Expiry Date:	17 Aug 2026
COE Category:	B - Car above 1600cc or 97kW (130bhp)
COE Period(Years):	10
QP Paid:	\$56,089.00
COE Rebate Amount:	\$45,142.00
Total Rebate Amount:	\$116,875.00

The information contained herein is correct as at 30 Jul 2018

OK

SINGAPORE ACCIDENT STATEMENT

IMPORTANT NOTICE

1. Please report correctly the details of the accident to speed up the claims process.
2. This Form must be completed by the Policyholder and/or the Authorised Driver.
3. Information provided must be as truthful and accurate as possible. Any wilful misrepresentation or withholding of material facts may allow insurance companies to repudiate policy ability.
4. The issue and acceptance of this Form by insurance companies is not an admission of policy liability on the part of the insurance companies.
5. **Any false reporting may be referred to the Police for investigation.**
6. This report will be forwarded by the insurers of the GIA Records Management Centre established by the General Insurance Association of Singapore (GIA) for archiving and that copies of this report will, for a fee, be made available upon application by interested parties.
7. By the lodgement of this report to the insurers, you hereby consent to the archiving of this report at the centre and to copies of the report being made available aforesaid.

ACCIDENT STATEMENT

Date Of Report	26/06/2018 13:48
Date Of Accident	25/06/2018 14:00
Exact Location Of Accident	JEM BASEMENT CARPARK (JURONG EAST)
Country/State of Loss	SINGAPORE

DETAILS OF OWN VEHICLE

Vehicle Registration Number	SLB1106U
Insured/Policyholder	
Name Of Registered Owner	NG KIM LENG
NRIC No	S1266655A
Email Address	NOEMAIL
Mobile Phone No	(LOCAL) +65-97432067
Alternative Phone No	OFFICE-97432067

Vehicle Particulars

Manufacturer	BMW
Model	640
Exact Purpose for which vehicle was being used at time of accident	NORMAL USAGE
Are you claiming under your own insurance policy for repair to your vehicle?	NO
If No, Please state action to be taken	THIRD PARTY
Vehicle Category	PRIVATE CAR

Insurance Company

Name of Insurance Company	LIBERTY INSURANCE PTE LTD
Type Of Coverage	COMPREHENSIVE
Fleet Policy	NO
Policy Number	
Cover Note Number	

Driver

Name of Driver	NG KIM LENG
NRIC No	S1266655A
Date Of Birth	13/01/1957
Occupation	INDOOR
Date Of Driving Pass	12/05/1977
Driving Experience	41 YEARS AND 1 MONTH
Gender	MALE
Mobile Number	(LOCAL) +65-97432067
Fax Number	
Contact Number	OFFICE-97432067
Email Address	NOEMAIL

Address	33 WEST COAST RISE #10-23
Postcode	127476
Was driver an employee of the Insured's Company	NO
If No, Relationship of the Driver with the Insured	OWNER
Vehicle Registration Number of Driver's Own Vehicle	-
	-
	-
Insurance Company of Driver's Own Vehicle	-
	-
	-

General Information of the Accident

Type Of Accident	COLLISION - HEAD TO REAR
Weather Conditions	CLEAR
Road Surface	DRY

Other Information

Was any foreign vehicle involved in this accident?	NO
Number of vehicles involved in the accident	
Was any body injured in the Accident?	NO
Was any injured conveyed to hospital by ambulance?	
Was any other material or property damaged?	YES
I have been approached by unknown person(s) soliciting/offering accident claims assistance.	NO
Number of Passengers (Including Driver)	1

Details of Police Action

Was the accident reported to the police?	NO
If Yes, Please state which Police Station	
Was notice of intended Prosecution given?	NO
If Yes, against whom?	

Circumstances of Accident

REFER TO ATTACH.

Attachment(s)

Are accident photos available for attachment?	YES
Was there any video captured by Car Camera?	YES
Was there any audio recorded?	NO

DETAILS OF OTHER VEHICLE PROPERTY 1

Vehicle Registration Number	SLV3487B
Vehicle Make/Model/Colour	BMW 7 SERIES / WHITE
Details Of Properties	
Vehicle Category	PRIVATE CAR
Name of Driver	AW YONG WEI REN GLEN
NRIC/Passport Number	S8525204F
Contact Number	91690055
Address	63008385
Postcode	
Insurance Company Name	MSIG INSURANCE (SINGAPORE) PTE. LTD.
Nature Of Damage	REAR
No. Of Passenger (Including Driver)	

Sketch Plan Pg. 1

SKETCH PLAN

IMPORTANT NOTICE

1. Please report **correctly** the details of the accident to speed up the claims process.
2. This Form must be **completed by the Policyholder and/or the Authorised Driver**.
3. Information provided must be as **truthful and accurate as possible**. Any wilful misrepresentation or withholding of material facts may allow insurance companies to **repudiate policy liability**.
4. The issue and acceptance of this Form by insurance companies is not an admission of policy liability on the part of the insurance companies.
5. **Any false reporting may be referred to the Police for investigation.**
6. The report will be forwarded by the insurers of the GIA Records Management Centre established by the General Insurance Association of Singapore (GIA) for archiving and that copies of this report will for a fee be made available upon application by interested parties.
7. By the lodgment of this report to the insurers, you hereby consent to the archiving of this report at the centre and to copies of the report being made available aforesaid.
8. **Consent under the Personal Data Protection Act (PDPA)**

I understand, acknowledge, agree and consent that:

- (a) My insurer, my workshop and the General Insurance Association of Singapore ("GIA") may/are permitted to collect, use, disclose and/or process my personal data/personal information set out in this form and any other personal information provided by me or possessed by my insurer (collectively the "Personal Information") and disclose and transfer such Personal Information to all insurer(s) who have insured vehicle(s) involved in this accident (all insurer(s) who have insured vehicle(s) involved in this accident shall be collectively referred to as the "Insurers"), the Insurers' lawyers/law firms, the Monetary Authority of Singapore and any relevant government agency/authority (such as the police), for the purpose(s) of:
- (i) processing, handling and/or dealing with my claims including the settlement of the claims and any necessary investigations relating to the claims;
 - (ii) investigating the accident and/or my claims;
 - (iii) carrying out and/or dealing with my instructions or responding to any enquiries by me;
 - (iv) administering my claims (including the mailing of correspondence, statements, invoices, reports or notices to me, which could involve disclosure of certain personal data about me to bring about delivery of the same as well as on the external cover of envelopes/mail packages); and/or
 - (v) complying with applicable law in administering, processing, handling and/or dealing with my claims (collectively the "Purposes")
- (b) all insurer(s) who have insured vehicle(s) involved in this accident and the Insurers' lawyers/law firms, may/are permitted to collect, use, disclose and/or process my Personal Information for one or more of the above Purposes; and
- (c) my Personal Information may/can be disclosed by any of the Insurers and/or GIA to their third party service providers or agents (including their lawyers/law firms), which may be sited outside of Singapore, for one or more of the above Purposes.
- (d) my Personal Information will also be collected and used to compile claims history for the purpose of fraud detection, investigation and management in present and all future claims.
- (e) the information so collected under (d) above may be shared / disclosed:
- (i) to all insurers and/or any other third parties that assist in evaluating, investigating, controlling or managing fraud, regulators, law enforcement and government agencies as reasonably required for the purposes stated, or
 - (ii) for complying with requirements under any regulations, laws or court orders.

Policyholder's Signature
Date & Time:

Driver's Signature
(If driver is not the policyholder)
Date & Time:

Reporting Centre Personnel's Signature
Name: Inthira A. Thurasamy
NRIC/FIN No.: 302 454 984 000
Singapore 159941

Sketch Plan Pg. 2

SKETCH PLAN

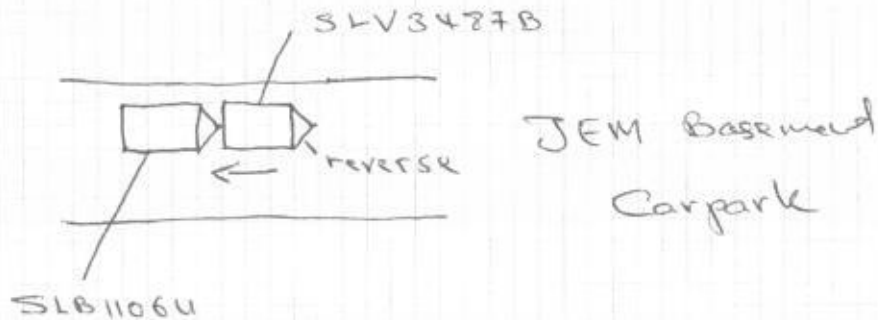

DESCRIBE CIRCUMSTANCES OF THE ACCIDENT

ON 25th JUNE 2018 AT ABOUT 13:55 I WAS WAITING TO ENTER BASEMENT CARPARK OF JEM (JURONG EAST). SLV3487B WAS IN FRONT OF MY VEHICLE. THE DRIVER MADE A SUDDEN REVERSE AND HIT MY VEHICLE. (SEE ATTACH IN VEHICLE CAMERA VIDEO).

DECLARATION

I/We declare the foregoing particulars are true in every respect.

[Signature] 25/6/18

Policyholder's Signature
Date & Time:

Driver's Signature
(If driver is not the policyholder)
Date & Time:

[Signature]
Reporting Centre Personnel's Signature
Name: Singapore 159941
NRIC/FIN No:

SINGAPORE ACCIDENT STATEMENT

IMPORTANT NOTICE

1. Please report correctly the details of the accident to speed up the claims process.
2. This Form must be completed by the Policyholder and/or the Authorised Driver.
3. Information provided must be as truthful and accurate as possible. Any wilful misrepresentation or withholding of material facts may allow insurance companies to repudiate policy ability.
4. The issue and acceptance of this Form by insurance companies is not an admission of policy liability on the part of the insurance companies.
5. **Any false reporting may be referred to the Police for investigation.**
6. This report will be forwarded by the insurers of the GIA Records Management Centre established by the General Insurance Association of Singapore (GIA) for archiving and that copies of this report will, for a fee, be made available upon application by interested parties.
7. By the lodgement of this report to the insurers, you hereby consent to the archiving of this report at the centre and to copies of the report being made available aforesaid.

ACCIDENT STATEMENT

Date Of Report	26/06/2018 13:48
Date Of Accident	25/06/2018 14:00
Exact Location Of Accident	JEM BASEMENT CARPARK (JURONG EAST)
Country/State of Loss	SINGAPORE

DETAILS OF OWN VEHICLE

Vehicle Registration Number	SLB1106U
Insured/Policyholder	
Name Of Registered Owner	NG KIM LENG
NRIC No	S1266655A
Email Address	NOEMAIL
Mobile Phone No	(LOCAL) +65-97432067
Alternative Phone No	OFFICE-97432067

Vehicle Particulars

Manufacturer	BMW
Model	640
Exact Purpose for which vehicle was being used at time of accident	NORMAL USAGE
Are you claiming under your own insurance policy for repair to your vehicle?	NO
If No, Please state action to be taken	THIRD PARTY
Vehicle Category	PRIVATE CAR

Insurance Company

Name of Insurance Company	LIBERTY INSURANCE PTE LTD
Type Of Coverage	COMPREHENSIVE
Fleet Policy	NO
Policy Number	
Cover Note Number	

Driver

Name of Driver	NG KIM LENG
NRIC No	S1266655A
Date Of Birth	13/01/1957
Occupation	INDOOR
Date Of Driving Pass	12/05/1977
Driving Experience	41 YEARS AND 1 MONTH
Gender	MALE
Mobile Number	(LOCAL) +65-97432067
Fax Number	
Contact Number	OFFICE-97432067
Email Address	NOEMAIL

Address	33 WEST COAST RISE #10-23
Postcode	127476
Was driver an employee of the Insured's Company	NO
If No, Relationship of the Driver with the Insured	OWNER
Vehicle Registration Number of Driver's Own Vehicle	-
	-
Insurance Company of Driver's Own Vehicle	-
	-
	-

General Information of the Accident

Type Of Accident	COLLISION - HEAD TO REAR
Weather Conditions	CLEAR
Road Surface	DRY

Other Information

Was any foreign vehicle involved in this accident?	NO
Number of vehicles involved in the accident	
Was any body injured in the Accident?	NO
Was any injured conveyed to hospital by ambulance?	
Was any other material or property damaged?	YES
I have been approached by unknown person(s) soliciting/offering accident claims assistance.	NO
Number of Passengers (Including Driver)	1

Details of Police Action

Was the accident reported to the police?	NO
If Yes, Please state which Police Station	
Was notice of intended Prosecution given?	NO
If Yes, against whom?	

Circumstances of Accident

REFER TO ATTACH.

Attachment(s)

Are accident photos available for attachment?	YES
Was there any video captured by Car Camera?	YES
Was there any audio recorded?	NO

DETAILS OF OTHER VEHICLE PROPERTY 1

Vehicle Registration Number	SLV3487B
Vehicle Make/Model/Colour	BMW 7 SERIES / WHITE
Details Of Properties	
Vehicle Category	PRIVATE CAR
Name of Driver	AW YONG WEI REN GLEN
NRIC/Passport Number	S8525204F
Contact Number	91690055
Address	63008385
Postcode	
Insurance Company Name	MSIG INSURANCE (SINGAPORE) PTE. LTD.
Nature Of Damage	REAR
No. Of Passenger (Including Driver)	

SKETCH PLAN

IMPORTANT NOTICE



1. Please report correctly the details of the accident to speed up the claims process.
2. This Form must be completed by the Policyholder and/or the Authorised Driver.
3. Information provided must be as truthful and accurate as possible. Any wilful misrepresentation or withholding of material facts may allow insurance companies to repudiate policy liability.
4. The issue and acceptance of this Form by insurance companies is not an admission of policy liability on the part of the insurance companies.
5. Any false reporting may be referred to the Police for investigation.
6. The report will be forwarded by the insurers of the GIA Records Management Centre established by the General Insurance Association of Singapore (GIA) for archiving and that copies of this report will for a fee be made available upon application by interested parties.
7. By the lodgment of this report to the insurers, you hereby consent to the archiving of this report at the centre and to copies of the report being made available aforesaid.
8. **Consent under the Personal Data Protection Act (PDPA)**

I understand, acknowledge, agree and consent that:

- (a) My insurer, my workshop and the General Insurance Association of Singapore ("GIA") may/are permitted to collect, use, disclose and/or process my personal data/personal information set out in this [form] and any other personal information provided by me or possessed by my insurer (collectively the "Personal Information") and disclose and transfer such Personal Information to all insurer(s) who have insured vehicle(s) involved in this accident (all insurer(s) who have insured vehicle(s) involved in this accident shall be collectively referred to as the "Insurers"), the Insurers' lawyers/law firms, the Monetary Authority of Singapore and any relevant government agency/authority (such as the police), for the purpose(s) of:
 - (i) processing, handling and/or dealing with my claims including the settlement of the claims and any necessary investigations relating to the claims;
 - (ii) investigating the accident and/or my claims;
 - (iii) carrying out and/or dealing with my instructions or responding to any enquiries by me;
 - (iv) administering my claims (including the mailing of correspondence, statements, invoices, reports or notices to me, which could involve disclosure of certain personal data about me to bring about delivery of the same as well as on the external cover of envelopes/mail packages); and/or
 - (v) complying with applicable law in administering, processing, handling and/or dealing with my claims (collectively the "Purposes")
- (b) all insurer(s) who have insured vehicle(s) involved in this accident and the Insurers' lawyers/law firms, may/are permitted to collect, use, disclose and/or process my Personal Information for one or more of the above Purposes; and
- (c) my Personal Information may/can be disclosed by any of the Insurers and/or GIA to their third party service providers or agents (including their lawyers/law firms), which may be sited outside of Singapore, for one or more of the above Purposes.
- (d) my Personal Information will also be collected and used to compile claims history for the purpose of fraud detection, investigation and management in present and all future claims.
- (e) the information so collected under (d) above may be shared / disclosed:
 - (i) to all insurers and/or any other third parties that assist in evaluating, investigating, controlling or managing fraud, regulators, law enforcement and government agencies as reasonably required for the purposes stated, or
 - (ii) for complying with requirements under any regulations, laws or court orders.

Policyholder's Signature
Date & Time:

Driver's Signature
(If driver is not the policyholder)
Date & Time:

Reporting Centre Personnel's Signature
Name: 
NRIC/FIN No.: 

Sketch Plan Pg. 2

SKETCH PLAN

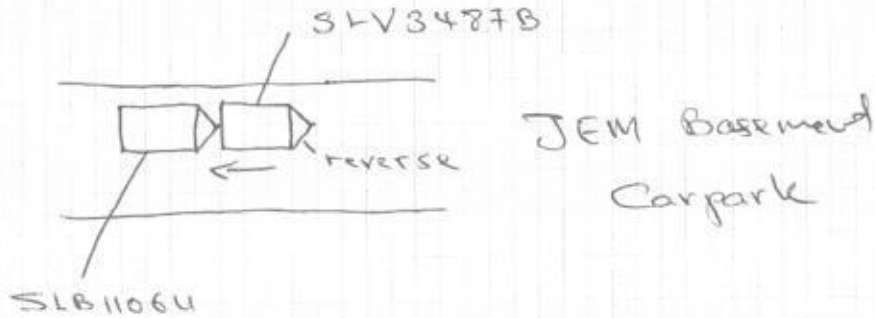

DESCRIBE CIRCUMSTANCES OF THE ACCIDENT

ON 25TH JUNE 2018 AT ABOUT 13.55 I WAS WAITING TO ENTER BASEMENT CARPARK OF JEM (JURONG EAST). SLV3487B WAS IN FRONT OF MY VEHICLE. THE DRIVER MADE A SUDDEN REVERSE AND HIT MY VEHICLE. (SEE ATTACH IN VEHICLE CAMERA VIDEO).

DECLARATION

I/We declare the foregoing particulars are true in every respect.

[Signature] 25/6/18

Policyholder's Signature
Date & Time:

Driver's Signature
(If driver is not the policyholder)
Date & Time:

[Signature]
Reporting Centre Personnel's Signature
Name: Singapore 159241
NRIC/FIN No.:

Performance Motors Limited

A member of the Sime Darby Group
Co. Reg. NO. 197401559W GST Reg. No M2-0020081-X

303, Alexandra Road
Sime Darby Performance Centre
Singapore 159941
Tel. 63190100 (Sales & Admin)
63190111 (AfterSales)
Fax. 64747770

280, Kampong Arang Road
East Coast Centre
Singapore 438180
Tel. 63190888 (AfterSales)
Fax. 63449773

315, Alexandra Road
Sime Darby Business Centre
Singapore 159944
Tel. 63190528 (AfterSales)
63190533/530 (Motorrad)
Fax. 64796601 (AfterSales)
64796624 (Motorrad)



Survey & repair
27.07 @ 10 am

GST REG. NO : M2 - 0020081 - X

ESTIMATE

27 JUN 2018

Estimate No. : b1 47456
Date Estimated : 27/06/2018
Prepared By : Inthiran A/L Thurasamy

Page No. : 1 of 5

- ESTIMATE REPAIR FOR -

Ng Kim Leng
33 West Coast Rise
#10-23

Singapore 127476

- ACCOUNT - 66
MSIG Insurance (S) Pte Ltd
4 Shenton Way
#21-01 SGX Centre 2
Singapore 068807

REGN. NO.	CHASSIS NO.	REGN. DATE	MODEL	MILEAGE
SLB1106U	D989320	18/08/2016	640i GC	0

DESCRIPTION

To replace front bumper, bumper support, air duct (inner support) and attachments including knock out dent area cause by accident.

2.5 Days. 3400 2125
850 4,250.00

Painting front bumper.

934 1,038.00

To supply front emboss number plate.

XNN

83.00

To check electrical wiring systems at the front section for proper function including adjustments of headlights.

150 177.00

To replace air con condenser and air con hose including to vacuum system, top up freon gas and check for leak.
(For all models except for 7 series).

NNX 1,003.00

Sundries.

80 40 80.00

Total Labour 1: 6,631.00

DESCRIPTION

DESCRIPTION	QTY	PRIC	VALUE
Set of mount	1	33.85	33.85
FRT BUMPER CARRIER	1	745.95	745.95
GRILLE AIR INTAKE CENTER (M)	1	93.35	93.35
IMPACT ABSORBER TOP (M)	1	83.20	83.20
FRT PANEL BUMPER PRIMED (M/SRA/PDC)	1	1,816.10	1,816.10
FRT LH GRILLE (LOW)	1	173.50	173.50
FRT RH GRILLE (LOW)	1	173.50	173.50
BMW EMBLEM	1	69.50	69.50
FRT AIR DUCT (front support)	1	293.50	293.50
AIR DUCT FRT BOTTOM (M)	1	51.50	51.50
DECOUPLING RING PDC TORQUE CONVERTE	4	5.05	20.20
BUMPER PDC SENSOR (SCHWARZ)	2	236.85	473.70

Total Parts : 4,027.85

Performance Motors Limited

A member of the Sime Darby Group
Co. Reg. No. 197401559W GST Reg. No M2-0020081-X



303, Alexandra Road
Sime Darby Performance Centre
Singapore 159941
Tel. 63190100 (Sales & Admin)
63190111 (AfterSales)
Fax. 64747770

280, Kampong Arang Road
East Coast Centre
Singapore 438180
Tel. 63190888 (AfterSales)
Fax. 63449773

315, Alexandra Road
Sime Darby Business Centre
Singapore 159944
Tel. 63190528 (AfterSales)
63190533/530 (Motorrad)
Fax. 64796601 (AfterSales)
64796624 (Motorrad)

GST REG. NO : M2 - 0020081 - X

ESTIMATE

Estimate No. : b1 47456
Date Estimated : 27/06/2018
Prepared By : Inthiran A/L Thurasamy

Page No. : 2 of 5

REGN. NO.	CHASSIS NO.	REGN. DATE	MODEL	MILEAGE
SLB1106U	D989320	18/08/2016	640i GC	0

3 Days.

before paint photos.

Euo Qian - 82880282

27/7/18.

- Ask Auto Consultants hence notify the Repairer of the following:
- To resurvey before/after spray painting
 - To display damaged part(s) during resurvey
 - Parts prices are subject to confirmation
 - Third party survey is on a "Without Prejudice" basis
 - No illegal modification(s) is allowed
 - Supplementary item(s) must be resurveyed and is subject to final approval from Insurance Company

Acknowledged by Repairer

Signature:

Date:

Labour 1	:	6,631.00
Parts	:	4,027.85
Labour 2	:	0.00
Excess	:	0.00
Total GST @ 7%	:	746.12
Grand Total	:	11,404.97

** THIS ESTIMATE IS VALID FOR A PERIOD OF 30 DAYS ONLY **

** PRICE FOR PARTS ARE SUBJECTED TO CHANGE WITHOUT PRIOR NOTICE **

16658.85

Performance Motors Limited

A member of the Sime Darby Group
Co. Reg. No. 197401559W, GST Reg. No. M2-0020081-X



FINAL REPORT

Estimate No. : b1 47456
Date Estimated : 27/06/2018
Prepared By : Inthiran A/L Thurasamy

Page No. :

REPAIR FOR -
Ng Kim Leng
33 West Coast Rise
#10-23

- ACCOUNT - 66
MSIG Insurance (S) Pte Ltd
4 Shenton Way
#21-01 SGX Centre 2
Singapore 068807

Singapore 127476

REGN NO	CHASSIS NO	REGN DATE	MODEL	MILEAGE
SLB1106U	D989320	18/08/2016	640i GC	0

DESCRIPTION	ORIGINAL PRICE	DISC. %	NETT
* To replace front bumper and attachments, air duct(inner support) and include knocking out dented areas caused by the accident	3400.00		3,400.00
To spray paint front bumper	934.00		934.00
To check electrical wiring systems at the front section for proper function including adjustments of headlights	150.00		150.00
Sundries.	80.00		80.00

2125

DESCRIPTION	UNIT PRICE	QTY	DISC. %	NETT
FRT PANEL BUMPER PRIMED (M/SRA/PDC/	1,816.10	1.00		1,816.10
FRT LH GRILLE (LOW)	173.50	1.00		173.50
FRT RH GRILLE (LOW)	173.50	1.00		173.50
BMW EMBLEM	69.50	1.00		69.50
# FRT AIR DUCT *	293.50	1.00		293.50
AIR DUCT FRT BOTTOM (M)	51.50	1.00		51.50

SUPPLEMENTARY ITEMS

Total Labour :	4,564.00
Total Parts :	2,577.60
Total Labour & Parts :	7,141.60
Deduction for Excess :	0.00
Total Repair Costs less Excess:	7,141.60
GST @7%:	499.91
Grand Total :	7,641.51

5866.6

Performance Motors Limited

A member of the Sime Darby Group
Co. Reg. No. 197401559W. GST Reg. No. M2-0020081-X



SUPPLEMENTARY

Estimate No. : b1 47456
Date Estimated : 27/06/2018
Prepared By : Inthiran A/L Thurasamy

Page No. :

REPAIR FOR -
Ng Kim Leng
33 West Coast Rise
#10-23

- ACCOUNT - 66
MSIG Insurance (S) Pte Ltd
4 Shenton Way
#21-01 SGX Centre 2
Singapore 068807

Singapore 127476

REGN NO	CHASSIS NO	REGN DATE	MODEL	MILEAGE
SLB1106U	D989320	18/08/2016	640i GC	0

DESCRIPTION	ORIGINAL PRICE	DISC. %	NETT
-------------	----------------	---------	------

DESCRIPTION	UNIT PRICE	QTY	DISC. %	NETT
# FRT AIR DUCT * <i>Repeated.</i>	293.50	1.00		293.50

Total Labour :	
Total Parts :	293.50
Total Labour & Parts :	293.50

Display of Diagrams - Retrofittings not taken into account - filtered D989320 6D02 M416 LCEZ 6' F06 Gran Coupé LCI Gran Coupé 640i ECER A 2016/05: 51_8392 Air ducts



Filter ▼

Yes	No	??	Code	
<input type="radio"/>	<input checked="" type="radio"/>	<input type="radio"/>	S1CBA	CO2 equipment
<input type="radio"/>	<input checked="" type="radio"/>	<input type="radio"/>	S6UKA	Night Vision with person recog
<input checked="" type="radio"/>	<input type="radio"/>	<input type="radio"/>	S715A	M Aerodynamics package
<input checked="" type="radio"/>	<input type="radio"/>	<input type="radio"/>	S823A	Hot-climate version

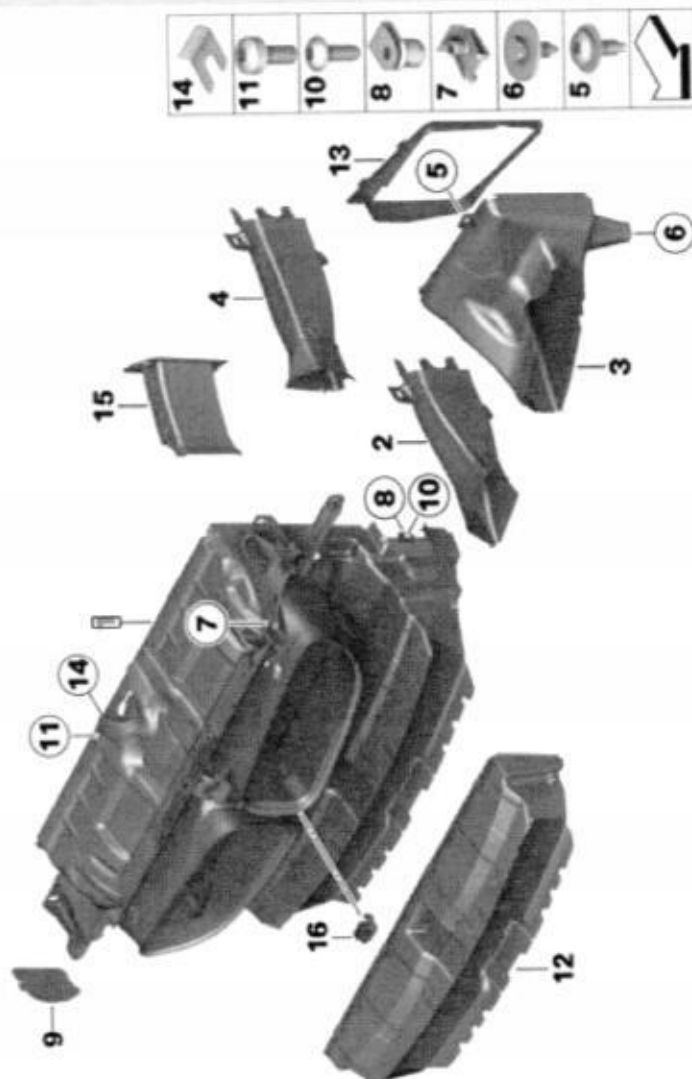

442505

To Parts List



New list



Add

Nr	Description	Supplement	Me	Von	Bis	Kat	Ge	Le
01	Air duct		1					

Display of Diagrams - Keirotings not taken into account - filter
 D989320 6D02 M416 LCEZ 6' F06 Gran Coupé LCI Gran Coupé 640i ECE R A 2016/05: 5

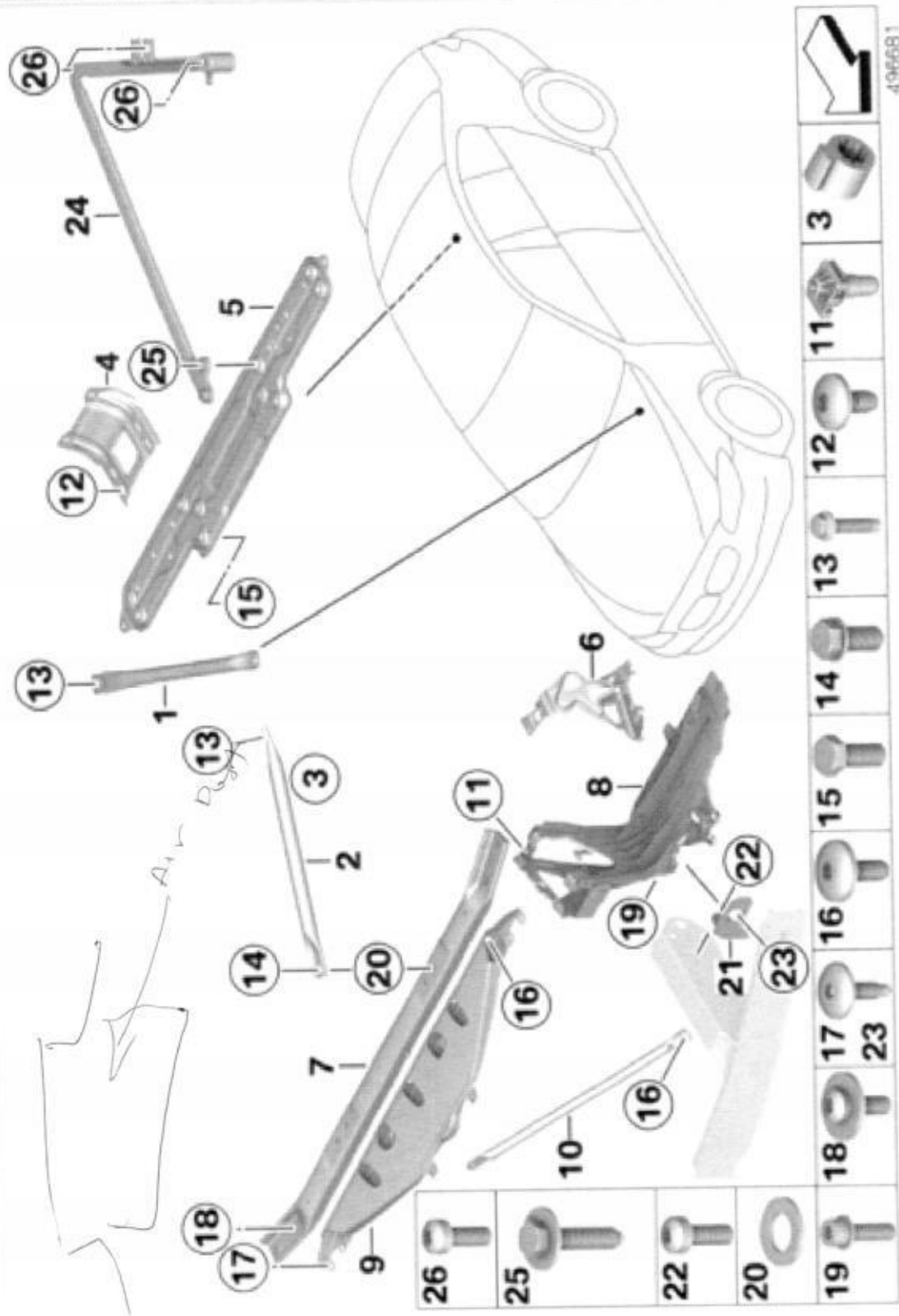

496681

LKK Auto Consultants Pte Ltd (Co.Reg.No:199607198R)

51 Ubi Ave 1 #01-25, Paya Ubi Industrial Park
Singapore 408933

Tel: 6256-3561 Fax: 6844-8805 Email: sur@lkkauto.com; assignments@lkkauto.com

VEHICLE DAMAGE INSPECTION REPORT

Our File No: CS/MSG180011845/GQBN2
Date: 16/01/2019

REFERENCE

Handling Insurer:	MSIG Insurance (Singapore) Pte. Ltd.	Policy No:	B29040254MCY
Claimant Vehicle No :	SLB1106U	Insured Vehicle No :	SLV3487B
Date of Loss:	25/06/2018	Nature of Claim:	TP
		Claim No:	562694

DESCRIPTION & IDENTIFICATION OF VEHICLE

Reg No:	SLB1106U	Engine No:	05139607N55B30A
Make & Model:	BMW 640I, 3.0 Gran Coupe (F13) (A)	Chassis No:	WBA6D02050D989320
Reg. Date:	18/08/2016 (Man. Year: 2016)	Odometer:	26271 km
Colour:	Black		
Engine Capacity:	2979 cc		
Market Value/New Car Price:	N/A		
Sum Insured (S\$):	Market Value/New Car Price		

CONDITION OF VEHICLE AT THE TIME OF SURVEY

General Condition:	Steering (Serviceable):	Yes	Footbrake (Serviceable):	Yes
Handbrake (Serviceable):	Yes	Engine Modification:	No	Pre-accident Condition:

CONDITION OF TYRES

Front Tyre Size:	245/40 R19	Rear Tyre Size:	245/40 R19
Front Left Side:	Michelin 6 mm	Rear Left Side:	Michelin 6 mm
Front Right Side:	Michelin 6 mm	Rear Right Side:	Michelin 6 mm

The above values represent the remaining tyre treads depth

COST OF CLAIMS

	Repairer's	Adjuster's	Difference	Diff %
Parts	4,484.35	2,657.60	1,826.75	40.74
Miscellaneous Items	0.00	0.00	0.00	
Labour	6,468.00	3,209.00	3,259.00	50.39
Paintwork Labour	0.00	0.00	0.00	
Towing	0.00	0.00	0.00	
Gross Total (S\$)	10,952.35	5,866.60	5,085.75	46.44
+ GST 7.00/7.00% (S\$)	766.66	410.66	356.00	46.44
Nett Amount (S\$)	11,719.01	6,277.26	5,441.75	46.44

INSPECTION

Date of Assignment:	28/06/2018	
Date Inspected:	27/07/2018	Inspected At:
		Performance Motors Limited (Alexandra) 303 Alexandra Road, Sime Darby Performance Centre Singapore 159941

Estimated Period of Repair: 5.0 days

Adjuster: XING GUO QIANG

Manager: SHIAU CHAN

NOTE: This report represents our findings at the time and place of inspection stated herein. Such inspection has been carried out to the best of our knowledge and ability but any other liability under any other circumstances is hereby expressly excluded.

REPAIR DETAILS

Reference

Part Source:	(Last Synchronised: 16 Jan 2019)	
Parts:	N/A	BMW 640i 3.0 Gran Coupe (F13) (A) (Model not available in database)
Labour:	Repairer's	(Price-denominated Standard List)
Print Code:	(Unsubmitted, no print-code for SLB1106U)	
Validity:	These estimates are valid only if they contain the print code (above) on all estimate pages, running page numbers with the END OF ESTIMATES marker on the last estimate page	
Further Info:	Items/values not in reference catalogue are prefixed with an asterisk *.	

Recommended Parts

No.	Qty	Part No.	Particulars	Condition	Repairer's	Amount
1	1		*SET OF MOUNT	Not Necessary	33.85 FS	*- FS
2	1		*FRT BUMPER CARRIER	Not Necessary	745.95 FS	*- FS
3	1		*GRILLE AIR INTAKE CENTER (M)	Not Necessary	93.35 FS	*- FS
4	1		*IMPACT ABSORBER TOP (M)	Not Necessary	83.20 FS	*- FS
5	1		*FRT PANEL BUMPER PRIMER (M/SRA/PDC)	Deformed	1,816.10 FS	*1,816.10 FS
6	1		*FRT LH GRILLE (LOW)	Cracked	173.50 FS	*173.50 FS
7	1		*FRT RH GRILLE (LOW)	Cracked	173.50 FS	*173.50 FS
8	1		*BMW EMBLEM	Necessary	69.50 FS	*69.50 FS
9	1		*FRT AIR DUCT (FRONT SUPPORT)	Cracked	293.50 FS	*293.50 FS
10	1		*AIR DUCT FRT BOTTOM (M)	Deformed	51.50 FS	*51.50 FS
11	4		*DECOUPLING RING PDC TORQUE CONVERTE	Not Necessary	20.20 FS	*- FS
12	2		*BUMPER PDC SENSOR (SCHWARZ)	Not Necessary	473.70 FS	*- FS
13	1		*SUNDRIES	Necessary	80.00 FS	*80.00 FS
14	1		*FRONT EMBOSS NUMBER PLATE	Not Necessary	83.00 FS	*- FS
15	1		*FRT AIR DUCT	Repeated	293.50 FS	*- FS
F=Franchise part. S=SpcNett.						
					Total Parts (\$\$)	4,484.35 2,657.60

Report was unsubmitted during this print-out.

Recommended Miscellaneous Items

There are no new miscellaneous items selected.

Recommended Labour

No	Particulars	Lab.Type	Repairer's	Amount
Labour Items				
1	TO REPLACE FRONT BUMPER,BUMPER SUPPORT,AIR DUCT (INNER SUPPORT) AND ATTACHMENTS INCLUDING KNOCK OUT DENT AREA CAUSED BY ACCIDENT	New	4,250.00	2,125.00
2	PAINTING FRONT BUMPER	New	1,038.00	934.00
3	TO CHECK ELECTRICAL WIRING SYSTEMS AT THE FRONT SECTION FOR PROPER FUNCTION INCLUDING ADJUSTMENTS OF HEADLIGHTS	New	177.00	150.00
4	TO REPLACE AIR CON CONDENSER AND AIR CON HOSE INCLUDING TO VACUUM SYSTEM,TOP UP FREON GAS AND CHECK FOR LEAK.)FOR ALL MODELS EXCEPT FOR 7 SERIES)	New	1,003.00	-
Gross Labour Cost (S\$)			6,468.00	3,209.00

Report was unsubmitted during this print-out.

< END OF ESTIMATES >