

SINGAPORE ACCIDENT STATEMENT

IMPORTANT NOTICE

1. Please report correctly the details of the accident to speed up the claims process.
2. This Form must be completed by the Policyholder and/or the Authorised Driver.
3. Information provided must be as truthful and accurate as possible. Any wilful misrepresentation or withholding of material facts may allow insurance companies to repudiate policy ability.
4. The issue and acceptance of this Form by insurance companies is not an admission of policy liability on the part of the insurance companies.
5. **Any false reporting may be referred to the Police for investigation.**
6. This report will be forwarded by the insurers of the GIA Records Management Centre established by the General Insurance Association of Singapore (GIA) for archiving and that copies of this report will, for a fee, be made available upon application by interested parties.
7. By the lodgement of this report to the insurers, you hereby consent to the archiving of this report at the centre and to copies of the report being made available aforesaid.

ACCIDENT STATEMENT

Date Of Report	11/06/2018 13:18
Date Of Accident	09/06/2018 19:30
Exact Location Of Accident	JUNCTION WOODLAND AVE 1 & WOODLAND AVE 4
Country/State of Loss	SINGAPORE

DETAILS OF OWN VEHICLE

Vehicle Registration Number	SLQ8586S
Insured/Policyholder	
Name Of Registered Owner	KOO E CHOONG
NRIC No	S7223258E
Email Address	ECHOONGKOO@GMAIL.COM
Mobile Phone No	(LOCAL) +65-90489848
Alternative Phone No	OTHERS-90489848

Vehicle Particulars

Manufacturer	KIA
Model	SORENTO-2.2 D CRDI (A)
Exact Purpose for which vehicle was being used at time of accident	SENDING FAMILY HOME
Are you claiming under your own insurance policy for repair to your vehicle?	NO
If No, Please state action to be taken	THIRD PARTY
Vehicle Category	PRIVATE CAR

Insurance Company

Name of Insurance Company	AIG ASIA PACIFIC INSURANCE PTE. LTD.
Type Of Coverage	COMPREHENSIVE
Fleet Policy	NO
Policy Number	1700030001
Cover Note Number	

Driver

Name of Driver	KOO E CHOONG
NRIC No	S7223258E
Date Of Birth	12/03/1972
Occupation	INDOOR
Date Of Driving Pass	13/05/1993
Driving Experience	25 YEARS AND 0 MONTHS
Gender	MALE
Mobile Number	(LOCAL) +65-90489848
Fax Number	
Contact Number	OTHERS-90489848
EMail Address	ECHOONGKOO@GMAIL.COM

Address	BLK 316A ANG MO KIO STREET 31 #22-313
Postcode	562316
Was driver an employee of the Insured's Company	NO
If No, Relationship of the Driver with the Insured	OWNER
Vehicle Registration Number of Driver's Own Vehicle	-
	-
	-
Insurance Company of Driver's Own Vehicle	-
	-
	-

General Information of the Accident

Type Of Accident	COLLISION - HEAD TO REAR
Weather Conditions	CLEAR
Road Surface	DRY

Other Information

Was any foreign vehicle involved in this accident?	NO
Number of vehicles involved in the accident	
Was any body injured in the Accident?	YES
Was any injured conveyed to hospital by ambulance?	NO
Was any other material or property damaged?	YES
I have been approached by unknown person(s) soliciting/offering accident claims assistance.	NO
Number of Passengers (Including Driver)	4
Passenger 1	NAME: : LEE PUAY PUAY GENDER: : FEMALE
Passenger 2	NAME: : HAROLD KOO YU JIE GENDER: : MALE
Passenger 3	NAME: : WARREN KOO JIA JUN GENDER: : MALE

Details of Police Action

Was the accident reported to the police?	NO
If Yes, Please state which Police Station	
Was notice of intended Prosecution given?	NO
If Yes, against whom?	

Circumstances of Accident

REFER TO ATTACHMENT

Attachment(s)

Are accident photos available for attachment?	YES
Was there any video captured by Car Camera?	YES
Was there any audio recorded?	NO

DETAILS OF OTHER VEHICLE PROPERTY 1

Vehicle Registration Number	SHB2249G
Vehicle Make/Model/Colour	HYUNDAI I40
Details Of Properties	
Vehicle Category	PRIVATE CAR
Name of Driver	TAN POH ANN
NRIC/Passport Number	S1316210G
Contact Number	92327947

Address
Postcode
Insurance Company Name
Nature Of Damage
No. Of Passenger (Including Driver)

DETAILS OF INJURED PERSON 1

Name HAROLD KOO YU JIE
Approximate Age
Injuries Sustain HEADACHE & VOMITTING
Injured person in which vehicle? SLQ8586S
Were seat belts worn? YES
Was this injured conveyed to hospital by ambulance? NO

Address
Postcode

DETAILS OF INJURED PERSON 2

Name LEE PUAY PUAY
Approximate Age
Injuries Sustain ARM BRUISE
Injured person in which vehicle? SLQ8586S
Were seat belts worn? YES
Was this injured conveyed to hospital by ambulance? NO

Address
Postcode

SKETCH PLAN

IMPORTANT NOTICE

1. Please report correctly the details of the accident to speed up the claims process.
2. This Form must be completed by the Policyholder and/or the Authorised Driver.
3. Information provided must be as truthful and accurate as possible. Any wilful misrepresentation or withholding of material facts may allow insurance companies to repudiate policy liability.
4. The issue and acceptance of this Form by insurance companies is not an admission of policy liability on the part of the insurance companies.
5. Any false reporting may be referred to the Police for investigation.
6. The report will be forwarded by the insurers of the GIA Records Management Centre established by the General Insurance Association of Singapore (GIA) for archiving and that copies of this report will for a fee be made available upon application by interested parties.
7. By the lodgment of this report to the insurers, you hereby consent to the archiving of this report at the centre and to copies of the report being made available aforesaid.
8. **Consent under the Personal Data Protection Act (PDPA)**

I understand, acknowledge, agree and consent that:

- (a) My insurer, my workshop and the General Insurance Association of Singapore ("GIA") may/are permitted to collect, use, disclose and/or process my personal data/personal information set out in this [form] and any other personal information provided by me or possessed by my insurer (collectively the "Personal Information") and disclose and transfer such Personal Information to all insurer(s) who have insured vehicle(s) involved in this accident (all insurer(s) who have insured vehicle(s) involved in this accident shall be collectively referred to as the "Insurers"), the Insurers' lawyers/law firms, the Monetary Authority of Singapore and any relevant government agency/authority (such as the police), for the purpose(s) of:
 - (i) processing, handling and/or dealing with my claims including the settlement of the claims and any necessary investigations relating to the claims;
 - (ii) investigating the accident and/or my claims;
 - (iii) carrying out and/or dealing with my instructions or responding to any enquiries by me;
 - (iv) administering my claims (including the mailing of correspondence, statements, invoices, reports or notices to me, which could involve disclosure of certain personal data about me to bring about delivery of the same as well as on the external cover of envelopes/mail packages); and/or
 - (v) complying with applicable law in administering, processing, handling and/or dealing with my claims.(collectively the "Purposes")
- (b) all insurer(s) who have insured vehicle(s) involved in this accident and the Insurers' lawyers/law firms, may/are permitted to collect, use, disclose and/or process my Personal Information for one or more of the above Purposes; and
- (c) my Personal Information may/can be disclosed by any of the Insurers and/or GIA to their third party service providers or agents(including their lawyers/law firms), which may be sited outside of Singapore, for one or more of the above Purposes.
- (d) my Personal Information will also be collected and used to compile claims history for the purpose of fraud detection, investigation and management in present and all future claims.
- (e) the information so collected under (d) above may be shared / disclosed:
 - (i) to all insurers and/or any other third parties that assist in evaluating, investigating, controlling or managing fraud, regulators, law enforcement and government agencies as reasonably required for the purposes stated, or
 - (ii) for complying with requirements under any regulations, laws or court orders.



Policyholder's Signature

Date & Time:

11/6/18

10am



Driver's Signature

(If driver is not the policyholder)

Date & Time:

11/6/18

10am



Reporting Centre Personnel's Signature

Name:

NRIC/FIN No.:

SKETCH PLAN

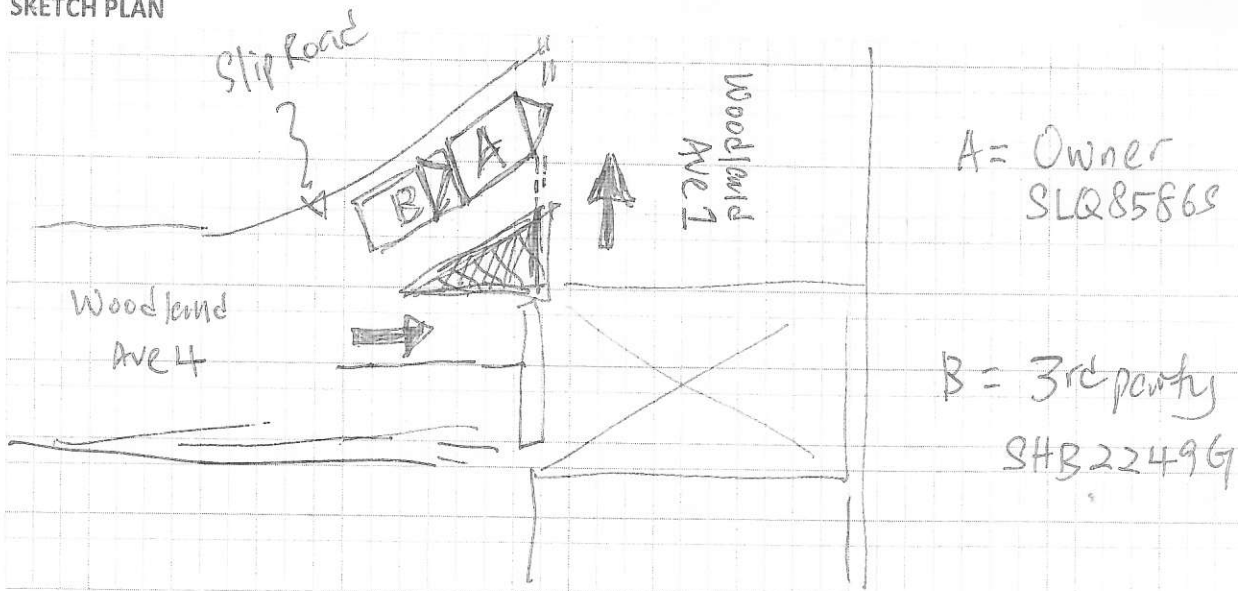

DESCRIBE CIRCUMSTANCES OF THE ACCIDENT

I was driving along Woodland Ave 4 and going into Slip Road joining into Woodland Ave 1. I stop my car before the double dotted line because there was a car ~~coming~~ driving along Woodland Ave 1. Suddenly, the taxi - SHB22496 hit the back of my car.

DECLARATION

I/We declare the foregoing particulars are true in every respect.

Policyholder's Signature

Date & Time:

11/6/18
10 am

Driver's Signature

(If driver is not the policyholder)

Date & Time:

11/6/18
10 am

Reporting Centre Personnel's Signature

Name:

NRIC/FIN No.: