

ASS. REC. BY:

REF: CS/CTI/8010462/Kvd3ⁿ² Special Instruction:

Surveyor: Kenneth

ASSIGNMENT (Office)

From (Person): Elaine Cheong

of CTI

Date/Time: 8/6/18 @ 8:57am

Estimated Cost:

Bill to:

OD ☒ TP WS / TP RES / OD RES / EVA / INV / MV / CS

To Inspect Vehicle No: SLX 6099H

Insured: GBB 8985X

at Workshop m/s MBM Wheelpower

Tel: 6262 8888

of 160 Sin Ming Drive # 66-02

Policy No: DMCVSN3043961700

Claim No: SNM18D0285702

Sum Insured:

Excess:

Make of Veh:

D.O.A. 05/06/2018

(Client's Record)

CA / REV / REP. / REV 24 HRS / up

H.O.D. Endorsement:

Date/Time: 9:18am @ 8/6/18

Person Contacted:

Joseph

Vehicle ☒ IN ☐ OUT

Date/Time

Action/Instruction (✓) Estimate

SLX 6099H-X

GBB 8985H-X

16/7 11pm 83850 email & confirm (Ref 8382.50, 67%)

REF: CTI

ASSIGNMENT

From:

Date:

8/6/18

Estimated Cost:

OD TP / WS / TP RES / OD RES / EVA / INV / MV

To inspect Vehicle No:

SLX 6099

at Workshop n/s

MBM Wheelpower

of 160 Sin Ming Drive # 06-02

Insured:

Policy No:

Claims No:

Sum Insured:

Excess:

(Client's Record)

Make of Veh:

Joseph

(Policy Condition)

Remark: The veh had commenced its
repair at the time of inspection.

Bal. or Market Value:

IDAC Accident Rpt:

Consistent? : Yes or No

GIA / PR Seen:

Consistent? : Yes or No

Est. Repairs:

days

Res: Yes or No

Lum Sum:

1-B1 %

3 Val: Yes or No

CA / REV / REP. / 24 HRS 'up'

Vehicle: IN / OUT

Date:

Person Contacted:

Veh No:

SLX 6099H

Yr Regn:

08/15

Type: M Car / M Cycle / Bus / Van / Lorry / Taxi / Prime Mover /

Truck / Trailer or

Make:

Ty 1 Harre

C.C.

1986

Colour:

M-Black

A/C:

Insured / Std / NI / NA

Sp. Reading

49016

T/Radio: Insured / Std / NI / NA

Eng/No:

C/No:

Z Su 60 0048435

Gen. Cond: Good / Fair / Poor / Burnt

Steering: In order / Jammed / Leaked / Burnt or

Brake: In order / Jammed / Leaked / Burnt or

Mod: Nil / Std A/Rim or

Tyre Size:

F:

235/55R19

R:

BS / DUN / EXNOVA / GY / FS / LIZA / MIC / OHTSU / PIR / SUMI /

TOYO / YOKO or

Roadstone

Front

Rear

R/Bal.

9 mm

R/Bal.

9 mm

L/Bal.

9 mm

L/Bal.

9 mm

D.O.A.

1/118

D.O.I.

8/6/18

Survey held at

Des. of Damages: Frt / Rear / O/S / N/S / U/C / Rooftop or

Rear ds

The U/C / Chassis frame / Body Structure affected due to collision.

Date / Time

Action / Instruction

11/6 File pass to Corham

RECEIVED 18 JUL 2018

Date/Time File Pass to?

☐

Preli. Report

1)

☐

Final Report

Date/Time File Return to?

2)

17/7 - typist

Days Of Repair:

5

Resurvey No. of Trip:

1

Survey Fee:

Transportation

) \$ + RS. \$

) Photos

) Others

Report Format :

merimen

Lump Sum / I.B.I. (\$)

4050/-

Add Fee:

☐

Site Insp (\$)

☐

Interview (\$)

☐

Tech. Invs (\$)

☐

Weekend (\$)

TOTAL

220



LKK Auto Consultants Pte Ltd

51 Ubi Ave 1 #01-25 Paya Ubi Industrial Park, Singapore 408933

TEL: 6256 3561 FAX: 6256 4315

Reg. No: 199607198R GST Reg. No. 19-9607198-R

Affiliated to Federation Internationale Des Experts En Automobile			
CHINA TAIPING INSURANCE (S) PTE LTD		Ref : CS/CTI18010462/Kvd3	
3 ANSON ROAD #16-00 SPRINGLEAF TOWERS SINGAPORE 079909		Date : 08-06-2018	
		Code : CTI	
1. Policy Particulars :- THIRD PARTY CLAIM			
Insured Veh.	GBB 8985X	Veh. Inspected	SLX 6099H
Policy No.	DMCVSN3043961700	Coverage (\$)	0.00
Claim No.	SNM18D02857C02	Excess (\$)	0.00
Assign From	MERIMEN (ELAINE CHEONG)	Assign Date	08/06/2018
2. Vehicle Particulars & Condition			
Make & Model		c.c	0
Engine No.	HIDDEN	Year of Reg.	
Chassis No.		Colour	
Odometer	-	Steering	
Brakes		Modification	
General			
3. Conditions of Tyres			
	Size	Make	Balance
R/H Front Tyre			mm
L/H Front Tyre			mm
R/H Rear Tyre			mm
L/H Rear Tyre			mm
4. Description of Damages			
5. General Information			
Accident Date	05/06/2018	Inspection Date	08/06/2018
Survey held at	MBM WHEELPOWER PTE LTD 176 SIN MING DRIVE #01-15 SIN MING AUTOCARE SINGAPORE 575721		
5a. Remarks			
A) THE INSPECTION WAS CONDUCTED ON A "WITHOUT PREJUDICE" BASIS. B) IN ACCORDANCE TO YOUR INSTRUCTIONS, WE HAVE NOT AUTHORISED REPAIRS.			

...CLAIM SUBFOLDER...(New Assignment)

CLAIM SUBFOLDER TRACKING

Case	Notified	Est Submitted	Adj Assigned	Adj Rpt	Adj Submitted	Ins Auth'd	Status
Main	06 Jun 2018		08 Jun 2018 08:57 Assign				New Assignment Cancel Case

Main

Reference

Claim Details

Documents

[Show All](#)

CLAIM SUBFOLDER DETAILS

[Created by insurer]

Insured:			
Main Claimant:	GOH SHENG YONG JARVIS, ID: S7931470F		
Vehicle Reg. No.:	SLX6099H	Date of Loss:	05/06/2018 18:00 - :59
Claim Type:	TP / SNM18D02857C02	Policy/Cover Note No.:	DMCVSN3043961700
Vehicle Reg. No. (Insured):	GBB8985X	Policy No. (Claimant):	5099768327
		Excess:	S\$450.00
Repairer:	MBM Wheelpower Pte Ltd (HQ) 160 Sin Ming Drive #06-02, Sin Ming AutoCity, 575722 Sin Ming - Tel: 6262 8888		
Handling Insurer:	China Taiping Insurance (Singapore) Pte. Ltd. (HQ) - Tel: 6389 6111 ... [Handled by Elaine Cheong]		
Claimant's Insurer:	NTUC Income Insurance Co-operative Ltd (HQ) - Tel:		
Adjuster:	LKK Auto Consultants Pte Ltd (HQ) - Tel: 6256-3561 ... [Final Rpt due 20/06/2018]		
Adj Asg. Remarks:	PRS: SURVEYOR - KENNETH KONG		

ASSOCIATED MAIL RECEIVED

[View All](#)[Compose Case Mail](#)

There are no mail for this case.

ALL ASSOCIATED TASKS

[View All](#)[Search Tasks](#)[Create New Task](#)[Complete](#)

Due Date	Priority	Type	Task Group	Subject	Handler	Assigned By	Completed On	Created On	Done?
----------	----------	------	------------	---------	---------	-------------	--------------	------------	-------

No results.

> Back to OneMotoring

Enquire PARF/COE Rebate for Registered Vehicle

Vehicle Owner Particulars	
Owner ID Type:	Singapore NRIC
Owner ID:	1470F
Vehicle Details	
Vehicle No.:	SLX6099H
Vehicle to be Exported:	No
Intended De-registration Date:	30 Jun 2018
Vehicle Make:	TOYOTA
Vehicle Model:	HARRIER 2.0 ELEGANCE AT ABS D/AIRBAG 2WD
Primary Colour:	Black
Manufacturing Year:	2015
Engine No.:	3ZRB581750
Chassis No.:	ZSU600048435
Maximum Power Output:	111.0 kW (148 bhp)
Open Market Value:	\$24,656.00
Original Registration Date:	06 Aug 2015
First Registration Date:	06 Aug 2015
Transfer Count:	1
Actual ARF Paid:	\$21,519.00
Intended PARF Rebate Details	
PARF Eligibility:	Yes
PARF Eligibility Expiry Date:	05 Aug 2025
PARF Rebate Amount:	\$16,139.00
Intended COE Rebate Details	
COE Expiry Date:	05 Aug 2025
COE Category:	B - Car above 1600cc or 97kW (130bhp)
COE Period(Years):	10
QP Paid:	\$65,501.00
COE Rebate Amount:	\$46,484.00
Total Rebate Amount:	\$62,623.00

The information contained herein is correct as at 06 Jun 2018

OK

SINGAPORE ACCIDENT STATEMENT

IMPORTANT NOTICE

1. Please report correctly the details of the accident to speed up the claims process.
2. This Form must be completed by the Policyholder and/or the Authorised Driver.
3. Information provided must be as truthful and accurate as possible. Any wilful misrepresentation or withholding of material facts may allow insurance companies to repudiate policy ability.
4. The issue and acceptance of this Form by insurance companies is not an admission of policy liability on the part of the insurance companies.
5. **Any false reporting may be referred to the Police for investigation.**
6. This report will be forwarded by the insurers of the GIA Records Management Centre established by the General Insurance Association of Singapore (GIA) for archiving and that copies of this report will, for a fee, be made available upon application by interested parties.
7. By the lodgement of this report to the insurers, you hereby consent to the archiving of this report at the centre and to copies of the report being made available aforesaid.

ACCIDENT STATEMENT

Date Of Report	06/06/2018 14:59
Date Of Accident	05/06/2018 18:10
Exact Location Of Accident	JURONG TOWN HALL RD
Country/State of Loss	SINGAPORE

DETAILS OF OWN VEHICLE

Vehicle Registration Number	SLX6099H
Insured/Policyholder	
Name Of Registered Owner	GOH SHENG YONG JARVIS
NRIC No	S7931470F
Email Address	JGSY07@GMAIL.COM
Mobile Phone No	(LOCAL) +65-90214850
Alternative Phone No	OFFICE-90214850

Vehicle Particulars

Manufacturer	TOYOTA
Model	HARRIER-2.0 ELEGANCE (A)
Exact Purpose for which vehicle was being used at time of accident	
Are you claiming under your own insurance policy for repair to your vehicle?	NO
If No, Please state action to be taken	THIRD PARTY
Vehicle Category	PRIVATE CAR

Insurance Company

Name of Insurance Company	NTUC INCOME INSURANCE CO-OPERATIVE LTD
Type Of Coverage	COMPREHENSIVE
Fleet Policy	NO
Policy Number	5099768327
Cover Note Number	

Driver

Name of Driver	GOH SHENG YONG JARVIS
NRIC No	S7931470F
Date Of Birth	09/10/1979
Occupation	INDOOR
Date Of Driving Pass	08/06/2001
Driving Experience	16 YEARS AND 11 MONTHS
Gender	MALE
Mobile Number	(LOCAL) +65-90214850
Fax Number	
Contact Number	OFFICE-90214850
Email Address	JGSY07@GMAIL.COM

Address	285D TOH GUAN ROAD #17-72
Postcode	604285
Was driver an employee of the Insured's Company	NO
If No, Relationship of the Driver with the Insured	OWNER
Vehicle Registration Number of Driver's Own Vehicle	-
	-
Insurance Company of Driver's Own Vehicle	-
	-

General Information of the Accident

Type Of Accident	CHAIN COLLISION
Weather Conditions	CLEAR
Road Surface	DRY

Other Information

Was any foreign vehicle involved in this accident?	NO
Number of vehicles involved in the accident	3
Was any body injured in the Accident?	NO
Was any injured conveyed to hospital by ambulance?	
Was any other material or property damaged?	YES
I have been approached by unknown person(s) soliciting/offering accident claims assistance.	NO
Number of Passengers (Including Driver)	1

Details of Police Action

Was the accident reported to the police?	NO
If Yes, Please state which Police Station	
Was notice of intended Prosecution given?	NO
If Yes, against whom?	

Circumstances of Accident

REFER SKETCH PLAN

Attachment(s)

Are accident photos available for attachment?	YES
Was there any video captured by Car Camera?	YES
Remarks/ Reasons:	LARGE FILE SIZE
Was there any audio recorded?	NO

DETAILS OF OTHER VEHICLE PROPERTY 1

Vehicle Registration Number	GBB8985X
Vehicle Make/Model/Colour	NISSAN NV200
Details Of Properties	VEH. B
Vehicle Category	GOODS VEHICLE
Name of Driver	SEENIVASAN SIVAGURU
NRIC/Passport Number	
Contact Number	
Address	
Postcode	
Insurance Company Name	
Nature Of Damage	FRONT & REAR PORTION
No. Of Passenger (Including Driver)	

DETAILS OF OTHER VEHICLE PROPERTY 2

Vehicle Registration Number	YP5237X
Vehicle Make/Model/Colour	LORRY
Details Of Properties	VEH. C
Vehicle Category	GOODS VEHICLE
Name of Driver	
NRIC/Passport Number	
Contact Number	
Address	
Postcode	
Insurance Company Name	
Nature Of Damage	
No. Of Passenger (Including Driver)	

SKETCH PLAN

IMPORTANT NOTICE

1. Please report correctly the details of the accident to speed up the claims process.
2. This Form must be completed by the Policyholder and/or the Authorised Driver.
3. Information provided must be as truthful and accurate as possible. Any wilful misrepresentation or withholding of material facts may allow Insurance companies to repudiate policy liability.
4. The issue and acceptance of this Form by insurance companies is not an admission of policy liability on the part of the insurance companies.
5. Any false reporting may be referred to the Police for investigation.
6. The report will be forwarded by the insurers of the GIA Records Management Centre established by the General Insurance Association of Singapore (GIA) for archiving and that copies of this report will for a fee be made available upon application by interested parties.
7. By the lodgment of this report to the insurers, you hereby consent to the archiving of this report at the centre and to copies of the report being made available aforesaid.
8. Consent under the Personal Data Protection Act (PDPA)

I understand, acknowledge, agree and consent that:

- (a) My insurer, my workshop and the General Insurance Association of Singapore ("GIA") may/are permitted to collect, use, disclose and/or process my personal data/personal information set out in this [form] and any other personal information provided by me or possessed by my insurer (collectively the "Personal Information") and disclose and transfer such Personal Information to all insurer(s) who have insured vehicle(s) involved in this accident (all insurer(s) who have insured vehicle(s) involved in this accident shall be collectively referred to as the "Insurers"), the Insurers' lawyers/law firms, the Monetary Authority of Singapore and any relevant government agency/authority (such as the police), for the purpose(s) of:
 - (i) processing, handling and/or dealing with my claims including the settlement of the claims and any necessary investigations relating to the claims;
 - (ii) investigating the accident and/or my claims;
 - (iii) carrying out and/or dealing with my instructions or responding to any enquiries by me;
 - (iv) administering my claims (including the mailing of correspondence, statements, invoices, reports or notices to me, which could involve disclosure of certain personal data about me to bring about delivery of the same as well as on the external cover of envelopes/mail packages); and/or
 - (v) complying with applicable law in administering, processing, handling and/or dealing with my claims (collectively the "Purposes")
- (b) all insurer(s) who have insured vehicle(s) involved in this accident and the insurers' lawyers/law firms, may/are permitted to collect, use, disclose and/or process my Personal Information for one or more of the above Purposes; and
- (c) my Personal Information may/can be disclosed by any of the insurers and/or GIA to their third party service providers or agents (including their lawyers/law firms), which may be sited outside of Singapore, for one or more of the above Purposes.
- (d) my Personal Information will also be collected and used to compile claims history for the purpose of fraud detection, investigation and management in present and all future claims.
- (e) the information so collected under (d) above may be shared / disclosed:
 - (i) to all insurers and/or any other third parties that assist in evaluating, investigating, controlling or managing fraud, regulators, law enforcement and government agencies as reasonably required for the purposes stated, or
 - (ii) for complying with requirements under any regulations, laws or court orders.

 Policyholder's Signature
 Date & Time:

Driver's Signature
 (If driver is not the policyholder)
 Date & Time:

 Joseph Tan
 Claims Advisor
 8686 5188
 Reporting Centre Personnel's Signature
 Name:
 NRIC/FIN No.:

SKETCH PLAN

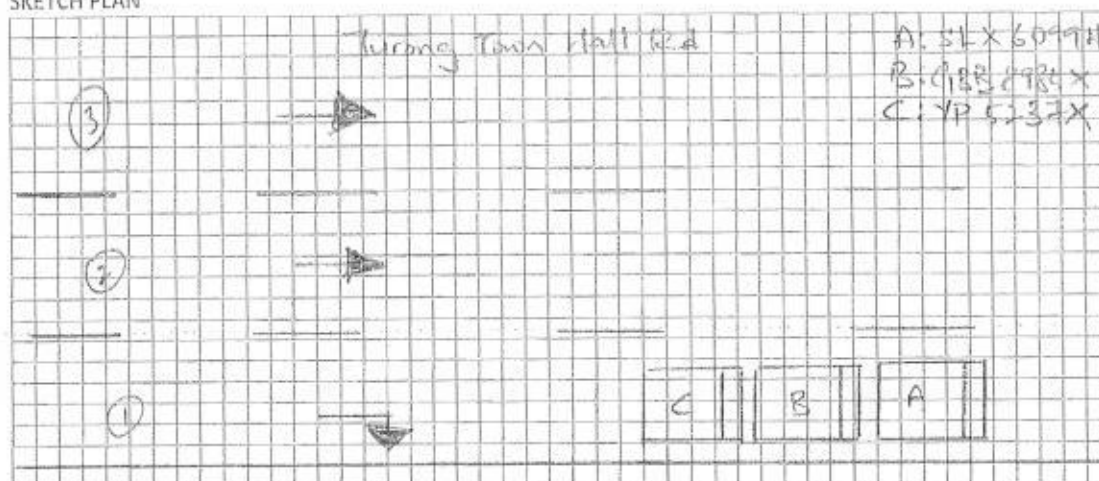

DESCRIBE CIRCUMSTANCES OF THE ACCIDENT

On 5th June, 6:12pm I was driving along Jurong Town Hall Road after exiting AYE. I came to a stop at the traffic light and was waiting at the traffic light (red light) to turn right onto Jurong East St. 11.

I was at the most right lane and suddenly I heard a bump and almost immediately there was a bump to my car.

My car surge forward but I did not bump into any cars in front.

I stopped the car and took photos as well as exchanged contacts & particulars with the driver behind driving a van.

He was hit by a lorry behind him.

I have in car cameras front & back as well.

You had been advised by workshop that in the event that you wish to claim against your own policy (OD claim), there is a **Fourteen (14) days clause** whereby the claim must be made within the stipulated timeframe from the day of occurrence.

Reporting Only

Claim OD

☒ Claim TP

Claim OD / TP at other workshop

DECLARATION

I/We declare the foregoing particulars are true in every respect.

Policyholder's Signature
Date & Time:

Driver's Signature
(If driver is not the policyholder)
Date & Time:

Reporting Centre Personnel's Signature
Name:
NRIC/FIN No.:

MBM WHEELPOWER PTE LTD

Your Ref: GBB8985X

Our Ref: SLX6099H

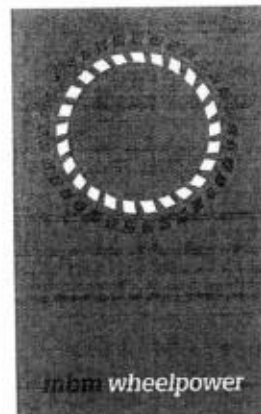

To: CHINA TAIPING

CC

Email

Fax

Not authorized
1.B.1
Per my B4 param
5-12/11
61 Imp @ 3950k

Date: 6/6/2018
From: Joseph
Fax: 62509015
Contact: 86865188
Make / Model: TOYOTA HARRIER ELEGANCE 2.0
Chassis No.: ZSU600048435
Engine No.: 3ZRB581750
Year of Make: 2015
Accident Date: 5/6/2018

ESTIMATE FOR VEHICLE NO.: SLX6099H

DESCRIPTION

TAILGATE GLASS MOULDING *122.40*
TAILGATE *1960.*
TAILGATE CENTRE MOULDING OUTER
REAR TOYOTA LOGO *50.80*
TAILGATE "HARRIER" EMBLEM *75.30*
TAILGATE REVERSE LAMP RH
TAILGATE REVERSE LAMP LH
TAILGATE WEATHERSTRIP
TAILGATE HINGES @ \$150.00
TAILGATE LOCK *559.20*
TAILGATE INNER TRIM BOARD
TAILGATE INNER TRIM CLIPS @ \$5.50
REAR BUMPER *1246.70*
REAR BUMPER CLIPS @ \$5.00
REAR BUMPER REINFORCEMENT
REAR BUMPER SPONGE
REAR BUMPER SIDE RETAINER RH *98.60*
REAR BUMPER SIDE RETAINER LH
REAR BUMPER LOWER COVER *396.90*
REVERSE SENSOR @ \$210.00
END PANEL
END PANEL TOP GARNISH

QTY		List Price	
1	\$	<i>250.00</i>	✓
1	\$	<i>1,980.00</i>	✓
1	\$	<i>420.00</i>	✗
1	\$	<i>100.00</i>	✓
1	\$	<i>95.00</i>	✓
1	\$	<i>620.00</i>	✗
1	\$	<i>620.00</i>	✗
1	\$	<i>420.00</i>	✗
2	\$	<i>300.00</i>	✗
1	\$	<i>650.00</i>	✓
1	\$	<i>920.00</i>	✗
10	\$	<i>55.00</i>	✗
1	\$	<i>1,510.00</i>	✓
10	\$	<i>50.00</i>	✓
1	\$	<i>420.00</i>	✗
1	\$	<i>260.00</i>	✗
1	\$	<i>145.00</i>	✓
1	\$	<i>145.00</i>	✗
1	\$	<i>780.00</i>	✓
2	\$	<i>420.00</i>	✗
1	\$	<i>910.00</i>	✗
1	\$	<i>480.00</i>	✗
TOTAL:		\$ 11,550.00	
LESS 25%:		\$ (2,887.50)	
PARTS TOTAL:		\$ 8,662.50	

SPECIAL NETT

ANTIRUST COATING

\$ *na* 120.00 *300*

REAR BUMPER TOP PROTECTOR

\$ *na* 260.00 *—*

REAR BUMPER LED REFLECTOR RH

\$ *na* 380.00 *X*

REAR BUMPER LED REFLECTOR LH

\$ *na* 380.00 *X***LABOUR**

TO REMOVE, REFIT & REPAIR AFFECTED DAMAGED PARTS. TO HEAT, WELD & CUT-OUT THE REAR END PANEL. INCLUDING TO STRAIGHTEN, KNOCK-OUT OF THE SAME, ETC

\$ *To confirm* 1,200.00 *500*

TO REMOVE & REFIT INNER LININGS & GARNISHES TO FACILITATE REPAIR

\$ 100.00 *600*

TO DISMANTLE & TRANSFER TAILGATE FITTINGS & MECHANISM TO NEW SHELL

\$ 120.00 *600*

TO CHECK AND RECONNECT ALL NECESSARY WIRINGS

\$ 120.00 *200*

TO REMOVE & REPLACE BUMPER SENSORS

\$ 100.00 *500*

TO SPRAY PAINT ON THE AFFECTED AREA

\$ 1,000.00 *600*

Total: \$ 12,442.50

7% GST: \$ 870.98

Grand Total: \$ 13,313.48**LKK Auto Consultants** hence notify the Repairer of the following:

- To resurvey before/after spray painting
- To display damaged part(s) during resurvey
- Parts prices are subject to confirmation
- Third party survey is on a "Without Prejudice" basis
- No illegal modification(s) is allowed
- Supplementary item(s) must be resurveyed and is subject to final approval from Insurance Company

Acknowledged by Repairer

Signature:

Date:

LKK Auto Consultants Pte Ltd (Co.Reg.No:199607198R)

51 Ubi Ave 1 #01-25, Paya Ubi Industrial Park

Singapore 408933

Tel: 6256-3561 Fax: 6844-8805 Email: sur@lkkauto.com;assignments@lkkauto.com

VEHICLE DAMAGE INSPECTION REPORT

Our File No: CS/CTI18010462/KVD3N2

Date: 20/07/2018

REFERENCE

Handling Insurer:	China Taiping Insurance (Singapore) Pte. Ltd.	Policy No:	DMCVSN3043961700
Claimant Vehicle No :	SLX6099H	Insured Vehicle No :	GBB8985X
Date of Loss:	05/06/2018	Nature of Claim:	TP
		Claim No:	SNM18D02857C02

DESCRIPTION & IDENTIFICATION OF VEHICLE

Reg No:	SLX6099H	Engine No:	3ZRB581750
Make & Model:	TOYOTA HARRIER, 2.0 Elegance (A)	Chassis No:	ZSU600048435
Reg. Date:	06/08/2015 (Man. Year: 2015)	Odometer:	49016 km
Colour:	Metallic Black		
Engine Capacity:	1986 cc		
Market Value/New Car Price:	N/A		
Sum Insured (S\$):	Market Value/New Car Price		

CONDITION OF VEHICLE AT THE TIME OF SURVEY

General Condition:	Steering (Serviceable):	Yes	Footbrake (Serviceable):	Yes
Handbrake (Serviceable):	Yes	Engine Modification:	No	Pre-accident Condition:

CONDITION OF TYRES

Front Tyre Size:	235/55R19	Rear Tyre Size:	235/55R19
Front Left Side:	Roadstone 9 mm	Rear Left Side:	Roadstone 9 mm
Front Right Side:	Roadstone 9 mm	Rear Right Side:	Roadstone 9 mm

The above values represent the remaining tyre treads depth

COST OF CLAIMS

	Repairer's	Adjuster's	Difference	Diff %
Parts	9,682.50	3,680.30	6,002.20	61.99
Miscellaneous Items	0.00	0.00	0.00	
Labour	2,760.00	1,380.00	1,380.00	50.00
Paintwork Labour	0.00	0.00	0.00	
Towing	0.00	0.00	0.00	
Calculated Gross Total (S\$)	12,442.50	5,060.30	7,382.20	59.33
Approved Total (Overridden) (S\$)		4,050.00		
(S\$)	12,442.50	4,050.00	8,392.50	67.45
+ GST 7.00/7.00% (S\$)	870.98	283.50	587.48	67.45
Nett Amount (S\$)	13,313.48	4,333.50	8,979.98	67.45

INSPECTION

Date of Assignment:	08/06/2018	
Date Inspected:	08/06/2018 Inspected At:	MBM Wheelpower Pte Ltd (HQ) 160 Sin Ming Drive #06-02, Sin Ming AutoCity Singapore 575722

Estimated Period of Repair: 5.0 days

Adjuster: KENNETH KONG

Manager: VERON CHEN

NOTE: This report represents our findings at the time and place of inspection stated herein. Such inspection has been carried out to the best of our knowledge and ability but any other liability under any other circumstances is hereby expressly excluded.

REPAIR DETAILS

Reference

Part Source: MRM-SG	Version: 1.0 (Last Synchronised: 20 Jul 2018)
Parts: M1-SUV	TOYOTA HARRIER 2.0 Elegance (A) (Catalogue:Merimen Singapore 1.0)
Labour: Repairer's	(Price-denominated Standard List)
Print Code: (Unsubmitted, no print-code for SLX6099H)	
Validity:	These estimates are valid only if they contain the print code (above) on all estimate pages, running page numbers with the END OF ESTIMATES marker on the last estimate page
Further Info:	Items/values not in reference catalogue are prefixed with an asterisk *

Recommended Parts

No.	Qty	Part No.	Particulars	Condition	Repairer's	Amount
1	1		*TAILGATE GLASS MOULDING	Necessary	250.00 FL	*122.40 FL
2	1		*TAILGATE	Bent	1,980.00 FL	*1,960.00 FL
3	1		*TAILGATE CENTRE MOULDING OUTER	Serviceable	420.00 FL	*- FL
4	1		*REAR TOYOTA LOGO	Necessary	100.00 FL	*50.80 FL
5	1		*TAILGATE HARRIER EMBLEM	Necessary	95.00 FL	*75.30 FL
6	1		*TAILGATE REVERSE LAMP RH	Serviceable	620.00 FL	*- FL
7	1		*TAILGATE REVERSE LAMP LH	Serviceable	620.00 FL	*- FL
8	1		*TAILGATE WEATHERSTRIP	Serviceable	420.00 FL	*- FL
9	2		*TAILGATE HINGES	Repair	300.00 FL	*- FL
10	1		*TAILGATE LOCK	Dented	650.00 FL	*559.70 FL
11	1		*TAILGATE INNER TRIM BOARD	Serviceable	920.00 FL	*- FL
12	10		*TAILGATE INNER TRIM CLIPS	Not Necessary	55.00 FL	*- FL
13	1		*REAR BUMPER	Buckled	1,510.00 FL	*1,246.70 FL
14	10		*REAR BUMPER CLIPS	Necessary	50.00 FL	*50.00 FL
15	1		*REAR BUMPER REINFORCEMENT	Repair	420.00 FL	*- FL
16	1		*REAR BUMPER SPONGE	Serviceable	260.00 FL	*- FL
17	1		*REAR BUMPER SIDE RETAINER RH	Distorted	145.00 FL	*98.60 FL
18	1		*REAR BUMPER SIDE RETAINER LH	Serviceable	145.00 FL	*- FL
19	1		*REAR BUMPER LOWER COVER	Bent	780.00 FL	*396.90 FL
20	2		*REVERSE SENSOR	Serviceable	420.00 FL	*- FL
21	1		*END PANEL	Repair	910.00 FL	*- FL
22	1		*END PANEL TOP GARNISH	Serviceable	480.00 FL	*- FL
23	1		*REAR BUMPER TOP PROTECTOR	Necessary	260.00 FS	*260.00 FS
24	1		*REAR BUMPER LED REFLECTOR RH	Serviceable	380.00 FS	*- FS
25	1		*REAR BUMPER LED REFLECTOR LH	Serviceable	380.00 FS	*- FS

F=Franchise part. S=SpcNett. L=ListItemDisc.

Sub Total (\$\$)	12,570.00	4,820.40
- List Item Discount on L Items 25.00/25.00% (\$\$)	2,887.50	1,140.10
Total Parts (\$\$)	9,682.50	3,680.30

Report was unsubmitted during this print-out.

Recommended Miscellaneous Items

There are no new miscellaneous items selected.

Recommended Labour

No	Particulars	Lab.Type	Repairer's	Amount
Labour Items				
1	ANTIRUST COATING	New	120.00	30.00
2	TO REMOVE,REFIT & REPAIR AFFECTED DAMAGED PARTS.TO HEAT,WELD & CUT-OUT THE REAR END PANEL INCLUDING TO STRAIGHTEN,KNOCK-OUT OF THE SAME,ETC	New	1,200.00	500.00
3	TO REMOVE & REFIT INNER LININGS & GARNISHES TO FACILITATE REPAIR	New	100.00	60.00
4	TO DISMANTLE & TRANSFER TAILGATE FITTINGS & MECHANISM TO NEW SHELL	New	120.00	60.00
5	TO CHECK AND RECONNECT ALL NECESSARY WIRINGS	New	120.00	20.00
6	TO REMOVE & REPLACE BUMPER SENSORS	New	100.00	50.00
7	TO SPRAY PAINT ON THE AFFECTED AREA	New	1,000.00	660.00
Gross Labour Cost (S\$)			2,760.00	1,380.00

Report was unsubmitted during this print-out.

< END OF ESTIMATES >