

REF:

NS/INC18010377 / Svb02

ANALYSIS

From:

Date:

Estimated Cost:

OD / TP / WS / TP RES / OD RES / EVA / INV / MV

To Inspect Vehicle No:

at Workshop (this)

at

Insured

Policy No:

Claims No

Sum Insured:

Excess:

(Client's Record)

Make of Veh:

(Policy Condition)

Remark: The veh had commenced its
repair at the time of inspection.

Bal. or Market Value:

IDAC Accident Report:

Consistent? Yes or No

GIA / FR Seen:

Consistent? Yes or No

Est. Repairs:

days Res: Yes or No

Lump Sum:

3 Val: Yes or No

CA / REV / REP. / 24 HRS

Vehicle: IN / OUT

Date:

Person Contacted:

Date / Time

Action / Instruction

SHB 5795 - NS/INC12024716 / Rlvn
YN 7167L - X

DIN: 21212

TAX / 05/18 / 2120
Lkk.
NTUC.

>6/6/18 LS \$10,000 - confirmed by email (Ref 16,975.64, 6370)

YN 7167L.

RECEIVED 27 JUN 2018

Date/Time: File Pass to:

☐

Preli. Report

At:

☐

Final Report

Date/Time: File Return to:

By:

27/6 - typist

Report Format:

Lump Sum / I.B. Fee:

TP

LS \$10,000p

Days Of Repair:

10

Resurvey No. of Trip:

2

Add Fee:

☐

Site Insp. 15

☐

Interview 15

☐

Tech. Insp. 15

☐

Mech. Insp. 15

Survey Fee:

Transportation:

2.5450 14

1.7400 13

1.7400 13

1.7400 13

1.7400 13

1.7400 13

160
35

195



National Assessment Centre Services

51 Ubi Ave 1 #01-25 Paya Ubi Industrial Park, Singapore 408933

TEL: 6841 0055 FAX: 6841 6315

Reg. No: 52983356E GST Reg. No. 20-0405911-H



NTUC INCOME INSURANCE CO-OPERATIVE LTD Ref: NS/INC18010377/Svb

73 BRAS BASAH ROAD

#05-01 NTUC TRADE UNION HOUSESINGAPORE Date: 07-06-2018
189556



Code: INC4

1. Policy Particulars :- THIRD PARTY CLAIM

| | | | |
|--------------|---------------|----------------|------------|
| Insured Veh. | YN 7167L | Veh. Inspected | SHB 579S |
| Policy No. | 5078934812-02 | Coverage (\$) | 0.00 |
| Claim No. | | Excess (\$) | 0.00 |
| Assign From | | Assign Date | 30/05/2018 |

2. Vehicle Particulars & Condition

| | | | |
|--------------|--------|--------------|---|
| Make & Model | | c.c | 0 |
| Engine No. | HIDDEN | Year of Reg. | |
| Chassis No. | | Colour | |
| Odometer | - | Steering | |
| Brakes | | Modification | |
| General | | | |

3. Conditions of Tyres

| | Size | Make | Balance |
|----------------|------|------|---------|
| R/H Front Tyre | | | mm |
| L/H Front Tyre | | | mm |
| R/H Rear Tyre | | | mm |
| L/H Rear Tyre | | | mm |

4. Description of Damages

| |
|--|
| |
|--|

5. General Information

| | | | |
|----------------|--|-----------------|------------|
| Accident Date | 26/05/2018 | Inspection Date | 30/05/2018 |
| Survey held at | SMRT AUTOMOTIVE SERVICES PTE LTD 60 WOODLANDS INDUSTRIAL PARK E4 SINGAPORE 757705 | | |

5a. Remarks

| |
|--|
| A)THE INSPECTION WAS CONDUCTED ON A"WITHOUT PREJUDICE" BASIS. B)IN ACCORDANCE TO YOUR INSTRUCTIONS, WE HAVE NOT AUTHORISED REPAIRS. |
|--|

Veron Chen (LKKAUTO)

From: mtreg <mtreg@income.com.sg>
Sent: Wednesday, 27 June 2018 9:58 AM
To: Veron Chen (LKKAUTO)
Subject: REQUEST FOR CLAIM NUMBER

Hi,

All claims created

With Regards

Samsia

Senior Admin Assistant, Motor Insurance

www.income.com.sg



From: Veron Chen (LKKAUTO) [mailto:veronchen@lkkauto.com]
Sent: Wednesday, June 27, 2018 9:46 AM
To: mtreg <mtreg@income.com.sg>
Subject: REQUEST FOR CLAIM NUMBER

Dear Sir/Madam,

Kindly provides us the claim number.

| Income Reference | Claimant (Owner / Taxi Company) | Claimant Vehicle No. | Income Vehicle No. |
|------------------|---------------------------------|----------------------|--------------------|
| MT/0996191-003 | SMRT TAXIS PTE LTD | SHB 579S | YN 7167L |
| MT/0999681-002 | COMFORT TRANSPOTATION PTE LTD | SHD 4348E | SKZ 8051H |

| D.O.A | Time of Accident | Estimate | Tentative repair cost |
|-----------|------------------|-------------|-----------------------|
| 26/5/2018 | 15:55 | \$26,975.64 | \$10,000.00 |
| 22/6/2018 | 10:25 | \$7,822.14 | \$2,800.00 |

Best Regards,

Veron Chen | Case Handler

LKK Auto Consultants Pte Ltd

Phone: 6256-3561 | email :sur@lkkauto.com | fax: 6256-4315

Blk 51, Paya Ubi Industrial Park, Ubi Avenue 1, #02-25 | S(408933)

Disclaimer

This e-mail contains privileged or confidential information which is intended only for the use of the recipient(s) named above. If you have received this message in error, please notify the sender immediately and delete all copies of it. Thank you.

eBaoTech

GeneralClaim

Hello, NAC_PAYA_UBI_800601

[Change Language](#)[Change Password](#)[Log Out](#)[My Desktop](#)[Notice of Loss](#)

Policy Query

Policy No. Date of Accident
Vehicle No. (For Motor)

| Select | Policy No. | Policyholder Name | Policyholder NRIC | Product | Cover Type | Vehicle No. | Insured Object | Commence Date | Expiry Date |
|----------------------------------|---------------|-------------------------|-------------------|---------|---------------|-------------|----------------|---------------|-------------|
| <input checked="" type="radio"/> | 5078934812-02 | JADIA LOGISTICS PTE LTD | 200701602H | GFT | Comprehensive | YN7167L | YN7167L | 01/04/2018 | |

Veron Chen (LKKAuto)

From: Yeo Poh Suan (Auto Svcs/Ext Biz Svcs/AR & SC/ARC) <YeoPohsuan@smrt.com.sg>
Sent: Wednesday, 27 June 2018 9:01 AM
To: Sathya Sai (LKK Auto)
Cc: SUR; CS A Team
Subject: RE: Regarding vehicle SHB579S finalisation.

Hi

Amount confirmed as per your recommendation, thanks.

Regards
Poh Suan

From: Sathya Sai (LKK Auto) [mailto:SathyaSai@lkkauto.com]
Sent: Tuesday, 26 June 2018 11:20 AM
To: Yeo Poh Suan (Auto Svcs/Ext Biz Svcs/AR & SC/ARC)
Cc: SUR; CS A Team
Subject: RE: Regarding vehicle SHB579S finalisation.

Good Day,

Please refer to attachment for finalisation.

Thank you

Best Regards,
Sathya Sai | Assistant Automotive Assessor
LKK Auto Consultants
Phone: 9807 2012 | Email: SathyaSai@lkkauto.com | fax: 6256-4315
Blk 51, Paya Ubi Industrial Park, Ubi Avenue 1, #02-25 | S(408933)

From: Yeo Poh Suan (Auto Svcs/Ext Biz Svcs/AR & SC/ARC) [mailto:YeoPohsuan@smrt.com.sg]
Sent: Monday, 25 June, 2018 3:03 PM
To: Sathya Sai (LKK Auto)
Cc: SUR; CS A Team
Subject: RE: Regarding vehicle SHB579S finalisation.

Hi Sathya,

The supplement part was added wrongly, I had amended the estimate and please finalize with me accordingly. The repair cost is Lump Sum \$10,000.00 (10 days).

Thanks & Regards
Poh Suan

From: Sathya Sai (LKK Auto) [mailto:SathyaSai@lkkauto.com]
Sent: Monday, 25 June 2018 12:09 PM
To: Yeo Poh Suan (Auto Svcs/Ext Biz Svcs/AR & SC/ARC)
Subject: Regarding vehicle SHB579S finalisation.

Good Day Poh Suan,

Regarding the finalization for vehicle bearing SHB579S, there seem to be a mistake in your finalization as the item 'rear door regulator motor LH' was not been given in the supplementary list but have been included in the finalization calculation. Attached is the finalization I've done according to the amendment made in the list. Please check and let me know if we can proceed with the COR as stated ;
Lump sum repair of \$9850 @ 10 days

Thank you

Best Regards,

Sathya Sai | Assistant Automotive Assessor

LKK Auto Consultants

Phone: 9807 2012 | Email: SathyaSai@lkkauto.com | fax: 6256-4315
Blk 51, Paya Ubi Industrial Park, Ubi Avenue 1, #02-25 | S(408933)

Veron Chen (LKKAuto)

From: Sathya Sai (LKK Auto)
Sent: Tuesday, 26 June 2018 11:20 AM
To: Yeo Poh Suan (Auto Svcs/Ext Biz Svcs/AR & SC/ARC)
Cc: SUR; CS A Team
Subject: RE: Regarding vehicle SHB579S finalisation.
Attachments: SHB 579S ESTIMATE REPLY.pdf

Good Day,

Please refer to attachment for finalisation.

Thank you

Best Regards,

Sathya Sai | Assistant Automotive Assessor

LKK Auto Consultants

Phone: 9807 2012 | Email: SathyaSai@lkkauto.com | fax: 6256-4315
Blk 51, Paya Ubi Industrial Park, Ubi Avenue 1, #02-25 | S(408933)

From: Yeo Poh Suan (Auto Svcs/Ext Biz Svcs/AR & SC/ARC) [mailto:YeoPohsuan@smrt.com.sg]
Sent: Monday, 25 June, 2018 3:03 PM
To: Sathya Sai (LKK Auto)
Cc: SUR; CS A Team
Subject: RE: Regarding vehicle SHB579S finalisation.

Hi Sathya,

The supplement part was added wrongly, I had amended the estimate and please finalize with me accordingly. The repair cost is Lump Sum \$10,000.00 (10 days).

Thanks & Regards
Poh Suan

From: Sathya Sai (LKK Auto) [mailto:SathyaSai@lkkauto.com]
Sent: Monday, 25 June 2018 12:09 PM
To: Yeo Poh Suan (Auto Svcs/Ext Biz Svcs/AR & SC/ARC)
Subject: Regarding vehicle SHB579S finalisation.

Good Day Poh Suan,

Regarding the finalization for vehicle bearing SHB579S, there seem to be a mistake in your finalization as the item 'rear door regulator motor LH' was not been given in the supplementary list but have been included in the finalization calculation. Attached is the finalization I've done according to the amendment made in the list. Please check and let me know if we can proceed with the COR as stated ;
Lump sum repair of \$9850 @ 10 days

Thank you

Best Regards,

Sathya Sai | Assistant Automotive Assessor

LKK Auto Consultants

Phone: 9807 2012 | Email: SathyaSai@lkkauto.com | fax: 6256-4315

SINGAPORE ACCIDENT STATEMENT

IMPORTANT NOTICE

1. Please report correctly the details of the accident to speed up the claims process.
2. This Form must be completed by the Policyholder and/or the Authorised Driver.
3. Information provided must be as truthful and accurate as possible. Any wilful misrepresentation or withholding of material facts may allow insurance companies to repudiate policy ability.
4. The issue and acceptance of this Form by insurance companies is not an admission of policy liability on the part of the insurance companies.
5. Any false reporting may be referred to the Police for investigation.
6. This report will be forwarded by the insurers of the GIA Records Management Centre established by the General Insurance Association of Singapore (GIA) for archiving and that copies of this report will, for a fee, be made available upon application by interested parties.
7. By the lodgement of this report to the insurers, you hereby consent to the archiving of this report at the centre and to copies of the report being made available aforesaid.

ACCIDENT STATEMENT

| | |
|----------------------------|---|
| Date Of Report | 28/05/2018 11:22 |
| Date Of Accident | 26/05/2018 15:55 |
| Exact Location Of Accident | STILL ROAD AT JUNCTION OF JOO CHIAT PLACE |
| Country/State of Loss | SINGAPORE |

DETAILS OF OWN VEHICLE

| | |
|-----------------------------|--------------------|
| Vehicle Registration Number | SHB579S |
| Insured/Policyholder | |
| Name Of Registered Owner | SMRT TAXIS PTE LTD |
| Co Reg No | 198905369K |
| Email Address | NOEMAIL |
| Mobile Phone No | |
| Alternative Phone No | OFFICE-80000000 |

Vehicle Particulars

| | |
|--|--------------------|
| Manufacturer | TOYOTA |
| Model | PRIUS TAXI-1.8 (A) |
| Exact Purpose for which vehicle was being used at time of accident | HIRE AND REWARD |
| Are you claiming under your own insurance policy for repair to your vehicle? | NO |
| If No, Please state action to be taken | THIRD PARTY |
| Vehicle Category | TAXI |

Insurance Company

| | |
|---------------------------|--------------------------------|
| Name of Insurance Company | MS FIRST CAPITAL INSURANCE LTD |
| Type Of Coverage | THIRD PARTY FIRE AND/OR THEFT |
| Fleet Policy | YES |
| Policy Number | D-18090213MFSH |
| Cover Note Number | |

Driver

| | |
|----------------------|-----------------------|
| Name of Driver | WEE TIONG |
| NRIC No | S1788489A |
| Date Of Birth | 14/10/1967 |
| Occupation | OUTDOOR |
| Date Of Driving Pass | 03/05/1990 |
| Driving Experience | 28 YEARS AND 0 MONTHS |
| Gender | MALE |
| Mobile Number | (LOCAL) +65-80000000 |
| Fax Number | |
| Contact Number | |
| EMail Address | NOEMAIL |

| | |
|---|---------------|
| Address | 613 |
| Postcode | |
| Was driver an employee of the Insured's Company | NO |
| If No, Relationship of the Driver with the Insured | OTHER - HIRER |
| Vehicle Registration Number of Driver's Own Vehicle | - |
| | - |
| Insurance Company of Driver's Own Vehicle | - |
| | - |

General Information of the Accident

| | |
|--------------------|------------|
| Type Of Accident | SIDE SWIPE |
| Weather Conditions | RAINING |
| Road Surface | WET |

Other Information

| | |
|---|-------------------------------------|
| Was any foreign vehicle involved in this accident? | NO |
| Number of vehicles involved in the accident | |
| Was any body injured in the Accident? | NO |
| Was any injured conveyed to hospital by ambulance? | NO |
| Was any other material or property damaged? | YES |
| I have been approached by unknown person(s) soliciting/offering accident claims assistance. | NO |
| Number of Passengers (Including Driver) | 2 |
| Passenger 1 | NAME: : UNKNOWN GENDER: : FEMALE |

Details of Police Action

| | |
|---|----|
| Was the accident reported to the police? | NO |
| If Yes, Please state which Police Station | |
| Was notice of intended Prosecution given? | NO |
| If Yes, against whom? | |

Circumstances of Accident

I WAS STATIONARY ALONG STILL ROAD WITH A PASSENGER ON BOARD DUE TO RED TRAFFIC LIGHT. SUDDENLY, I FELT AN IMPACT FROM THE REAR LEFT PORTION OF MY TAXI AND THE GREAT IMPACT PUSHED MY TAXI FORWARD OUT OF THE STOP LINE. THE VEHICLE YN7167L FROM BEHIND HAD COLLIDED ONTO MY STATIONARY TAXI. THERE WAS ANOTHER VEHICLE SJX212K WHICH ON MY LEFT ALSO HIT BY THE VEHICLE YN7167L.

Attachment(s)

| | |
|---|-----|
| Are accident photos available for attachment? | YES |
| Was there any video captured by Car Camera? | NO |
| Was there any audio recorded? | NO |

DETAILS OF OTHER VEHICLE PROPERTY 1

| | |
|-----------------------------|--------------------------|
| Vehicle Registration Number | YN7167L |
| Vehicle Make/Model/Colour | |
| Details Of Properties | |
| Vehicle Category | COMMERCIAL VEHICLE |
| Name of Driver | SAMSUDIN BIN MOHD YASSIN |
| NRIC/Passport Number | S1668928I |
| Contact Number | |
| Address | |
| Postcode | |
| Insurance Company Name | |

Nature Of Damage

No. Of Passenger (Including Driver)

DETAILS OF OTHER VEHICLE PROPERTY 2

Vehicle Registration Number SJX212K

Vehicle Make/Model/Colour

Details Of Properties

Vehicle Category PRIVATE CAR

Name of Driver CHEW LAY HWEE

NRIC/Passport Number S1425332G

Contact Number

Address

Postcode

Insurance Company Name

Nature Of Damage

No. Of Passenger (Including Driver)

SKETCH PLAN

IMPORTANT NOTICE

1. Please report correctly the details of the accident to speed up the claims process.
2. This Form must be completed by the Policyholder and/or the Authorised Driver.
3. Information provided must be as truthful and accurate as possible. Any wilful misrepresentation or withholding of material facts may allow insurance companies to repudiate policy liability.
4. The issue and acceptance of this Form by insurance companies is not an admission of policy liability on the part of the insurance companies.
5. Any false reporting may be referred to the Police for investigation.
6. The report will be forwarded by the insurers of the GIA Records Management Centre established by the General Insurance Association of Singapore (GIA) for archiving and that copies of this report will for a fee be made available upon application by interested parties.
7. By the lodgment of this report to the insurers, you hereby consent to the archiving of this report at the centre and to copies of the report being made available aforesaid.
8. **Consent under the Personal Data Protection Act (PDPA)**

I understand, acknowledge, agree and consent that:

- (a) My insurer, my workshop and the General Insurance Association of Singapore ("GIA") may/are permitted to collect, use, disclose and/or process my personal data/personal information set out in this [form] and any other personal information provided by me or possessed by my insurer (collectively the "Personal Information") and disclose and transfer such Personal Information to all insurer(s) who have insured vehicle(s) involved in this accident (all insurer(s) who have insured vehicle(s) involved in this accident shall be collectively referred to as the "Insurers"), the Insurers' lawyers/law firms, the Monetary Authority of Singapore and any relevant government agency/authority (such as the police), for the purpose(s) of:
 - (i) processing, handling and/or dealing with my claims including the settlement of the claims and any necessary investigations relating to the claims;
 - (ii) investigating the accident and/or my claims;
 - (iii) carrying out and/or dealing with my instructions or responding to any enquiries by me;
 - (iv) administering my claims (including the mailing of correspondence, statements, invoices, reports or notices to me, which could involve disclosure of certain personal data about me to bring about delivery of the same as well as on the external cover of envelopes/mail packages); and/or
 - (v) complying with applicable law in administering, processing, handling and/or dealing with my claims (collectively the "Purposes")
- (b) all insurer(s) who have insured vehicle(s) involved in this accident and the Insurers' lawyers/law firms, may/are permitted to collect, use, disclose and/or process my Personal Information for one or more of the above Purposes; and
- (c) my Personal Information may/can be disclosed by any of the Insurers and/or GIA to their third party service providers or agents (including their lawyers/law firms), which may be sited outside of Singapore, for one or more of the above Purposes.
- (d) my Personal Information will also be collected and used to compile claims history for the purpose of fraud detection, investigation and management in present and all future claims.
- (e) the information so collected under (d) above may be shared / disclosed:
 - (i) to all insurers and/or any other third parties that assist in evaluating, investigating, controlling or managing fraud, regulators, law enforcement and government agencies as reasonably required for the purposes stated, or
 - (ii) for complying with requirements under any regulations, laws or court orders.



Alv 28/5/20

Policyholder's Signature
Date & Time:

Driver's Signature
(If driver is not the policyholder)
Date & Time:

Reporting Centre Personnel's Signature
Name:
NRIC/FIN No.:

SKETCH PLAN

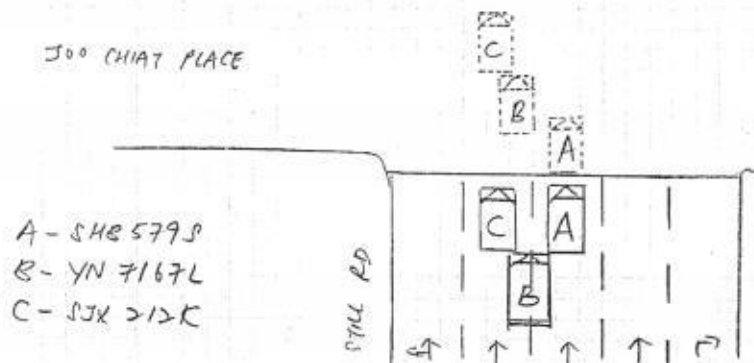

DESCRIBE CIRCUMSTANCES OF THE ACCIDENT

This image shows a single sheet of white paper with horizontal blue or grey ruling lines. The lines are evenly spaced and run across the width of the page. There is no handwriting or other markings on the paper.

DECLARATION

I/We declare the foregoing particulars are true in every respect.



Policyholder's Signature
Date & Time:

Driver's Signature
(If driver is not the policyholder)
Date & Time:

Reporting Centre Personnel's Signature
Name:
NRIC/FIN No.:

[> Back to OneMotoring](#)**Enquire PARF/COE Rebate for Registered Vehicle****Vehicle Owner Particulars**

Owner ID Type: Company

Owner ID: 5369K

Vehicle Details

Vehicle No.: SHB579S

Vehicle to be Exported: No

Intended De-registration Date: 07 Jun 2018

Vehicle Make: TOYOTA

Vehicle Model: PRIUS TAXI (SMRT)

Primary Colour: Maroon

Manufacturing Year: 2014

Engine No.: 2ZR6222298

Chassis No.: JTDKN36U005753276

Maximum Power Output: 100.0 kW (134 bhp)

Open Market Value: \$32,920.00

Original Registration Date: 10 Dec 2014

First Registration Date: 10 Dec 2014

Transfer Count: 0

Actual ARF Paid: \$8,088.00

Intended PARF Rebate Details

PARF Eligibility: Yes

PARF Eligibility Expiry Date: 09 Dec 2022

PARF Rebate Amount: \$6,066.00

Intended COE Rebate Details

COE Expiry Date: 09 Dec 2022

COE Category: A - Car up to 1600cc & 97kW (130bhp)

COE Period(Years): 8

PQP Paid: \$51,668.00

COE Rebate Amount: \$29,097.00

Total Rebate Amount: \$35,163.00**Message**

Please note that the 8-year COE for this vehicle cannot be further renewed. The vehicle must be de-registered upon COE expiry or when the vehicle reaches its statutory lifespan (if applicable), whichever is earlier.

The information contained herein is correct as at 07 Jun 2018

OK

SMRT Accident Vehicle Repair Estimates

NTUC

Section A - To be completed by claims Advisor/Duty officer at Accident Reporting Centre

Reg. No : SHB579S
 Ref. No : TAX/05/18/2120
 Reg. Date : 10/12/2014
 Vehicle Type : TAXI
 Make : TOYOTA PRIUS
 Model : PRIUS
 Name of Driver : WEE TIONG
 Type of Accident : SIDE SWIPE
 Date / Time of Accident : 26/05/2018 03:55:00 PM
 Accident Reported Date / Time : 28/05/2018 12:00:00 AM
 Surveyor is Required? : Yes
 Survey by :
 Vehicle is Towed Back? : Yes
 Towed Back Date/Time : 26/05/2018
 Replacement Vehicle issued? : No
 Accident Repair Job Card No : 000024096309
 Special Instruction to ARC, if any :
 TOWED \$90 / YN7167L
 Prepared Date : 28/05/2018 11:53:43 AM



 8/6/18
 Sebastian
 30/5/18

- Long Sun Repair.
 - Question Mark Item
 Photo
 - Photo After Paint

LKK Auto Consultants hence notify
 the Repairer of the following:
 • To resurvey before/after spray painting
 • To display damaged part(s) during resurvey
 • Parts prices are subject to confirmation
 • Third party survey is on a "Without Prejudice" basis
 • No illegal modification(s) is allowed
 • Supplementary item(s) must be resurveyed and
 is subject to final approval from Insurance Company

Acknowledged by Repairer

Signature:

Date:

Section B - To be Completed by Service Advisor, Accident Repair Centre

Chassis No : JTDKN36U005753276

Mileage :

0

Work Shop :

Repair Completed Date / Time :

Summary of Repair Estimates

| | Quotation from ARC | Adjusted by Surveyor, if applicable |
|--------------------------------|------------------------|-------------------------------------|
| Total Labour Charges : | 1,690.00 | 0.00 |
| Total Spray Painting Charges : | 3,312.00 | 0.00 |
| Total Material Charges : | 9,509.99 | 9,509.99 |
| Other Charges : | 1,651.00 | 0.00 |
| TOTAL : | 16,162.99 | 0.00 |
| Lum Sum Total : | 16,150.00 | 0.00 |
| No. of Repair Days : | 10.00 | 0.00 |
| Prepared / Adjusted By : | | 8 days |
| Arc / Surveyor Sign Off Date : | 28/05/2018 02:45:22 PM | 01/01/1900 12:00:00 AM |



Prepared / Adjusted Date :

Remarks :

Prepared Date : 28/05/2018 02:45:14 PM

Section C - To be Completed by Admin Assistant, Accident Repair Centre, Upon Completion of Repair

Quotation No :

Invoice No :

Quotation Date :

Invoice Date :

Invoice Amount :

Prepared Date :

Section D - Details of Repair Estimates**Part 1 - Labour Works**

| Job Scope | Quotation from ARC | Adjusted by Surveyor, if applicable |
|---------------------------|--------------------|-------------------------------------|
| TO REPAIR LH REAR PORTION | 1,690.00 | 0.00 1000 |
| Total Labour | 1,690.00 | 0.00 |

Part 2 - Spray Painting & Panel Beating Related Works

| Job Scope | Quotation from ARC | Adjusted by Surveyor, if applicable |
|---|--------------------|-------------------------------------|
| TO RESPRAY REAR DOOR LH | 378.00 | 0.00 200 |
| TO RESPRAY DOOR HANDLE | 180.00 | 0.00 50 |
| TO RESPRAY ROCKER PANEL MOULDING | 180.00 | 0.00 X |
| TO RESPRAY REAR FENDER LH | 378.00 | 0.00 200 |
| TO RESPRAY REAR LH WHEEL HOUSE | 180.00 | 0.00 100 |
| TO RESPRAY LH RAIL ROOF SIDE | 180.00 | 0.00 100 |
| TO RESPRAY FUEL LID COVER | 180.00 | 0.00 50 |
| TO RESPRAY TROUGH BACK DOOR LH | 180.00 | 0.00 50 |
| TO REPSRAY REAR BUMPER | 378.00 | 0.00 200 |
| TO RESPRAY REAR PANEL | 180.00 | 0.00 100 |
| TO RESPRAY TAIL GATE | 378.00 | 0.00 X |
| TO RESPRAY TAILGATE OUTSIDE GARNISH | 180.00 | 0.00 100 |
| TO RESPRAY REAR SPOILER | 180.00 | 0.00 X |
| TO RESPRAY RIM | 180.00 | 0.00 X |
| Total Spray Painting & Panel Beating | 3,312.00 | 0.00 |

Part 3 - Other Costs - Accident and Accident Repair Related Expenses

| Job Scope | Quotation from ARC | Adjusted by Surveyor, if applicable |
|---|--------------------|-------------------------------------|
| TOWING CHARGE | 126.00 | 0.00 X |
| TO CHECK WIRING AND SYSTEM FUNCTION | 80.00 | 0.00 30 |
| TO APPLY RUST-PROOFING ON AFFECTED AREA | 200.00 | 0.00 50 |
| TO REMOVE & REFIT REAR QUARTER GLASS LH | 120.00 | 0.00 30 |
| TO PROVIDE LABOUR & MATERIAL FOR SOLAR FILM (NET) | 125.00 | 0.00 ✓ |
| TO TRANSFER DOOR MECHANISM | 120.00 | 0.00 60 |
| TO TEST AND REFIX REVERSE SENSOR SYSTEM | 120.00 | 0.00 30 |
| TO TRANSFER REAR TAILGATE MECHANISM | 120.00 | 0.00 X |
| TO REMOVE AND REFIX REAR WINDSCREEN | 120.00 | 0.00 X |
| TO DO WHEEL ALIGNMENT / TYRE BALANCING | 120.00 | 0.00 60 |
| TO INSPECT RR LIGHTING, MECHANISMS & WATER TEST RR LIGHTING FOR LEAKAGE | 120.00 | 0.00 30 |
| TO REMOVE AND INSTALL LUGGAGE COMPARTMENT TRIM TO FACILITATE REPAIR. | 120.00 | 0.00 30 |
| TO REPLACE SUNDRY PARTS | 100.00 | 0.00 X |
| TO WASH AND VACUUM | 60.00 | 0.00 X |
| Total Other Costs | 1,651.00 | 0.00 |

Part 4 - Spare Parts / Material Usage

| Part Number | Portion | Stock No | Part Name | Qty | List Price (\$) | Discount (%) | Final Price (\$) | ARC Recommendation | Surveyor Approved | Photos Attached |
|----------------|---------|----------|--------------------------------------|-----|-----------------|--------------|------------------|--------------------|-------------------|-----------------|
| 67004-47080 | | 6505487 | DOOR RR/LH | 1 | 954.50 | 25.00 | 715.87 | Replace | Replace ✓ OT | No |
| | | | PIXEL STICKER | 2 | 60.00 | 0.00 | 120.00 | Replace | Replace ✓ NEC | No |
| 69211-74020 | | | DOOR OUTER HANDLE RR/LH | 1 | 69.80 | 25.00 | 52.35 | Replace | Replace ✓ JM | No |
| 85720-47130 | | | DOOR REGULATOR MOTOR REAR LH | 1 | 768.90 | 10.00 | 692.01 | Replace | Replace ? | No |
| 69802-52070 | | | DOOR REGULATOR SUB-ASSY, FRT/REAR LH | 1 | 224.80 | 25.00 | 168.60 | Replace | Replace ? | No |
| 62332-47030-BO | | | WEATHERSTRIP LHR DR, OPENING | 1 | 229.70 | 25.00 | 172.27 | Replace | Replace ✓ NEC | No |
| 67872-47030 | | | DOOR WEATHER STRIP RR/LH | 1 | 171.20 | 25.00 | 128.40 | Replace | Replace ✓ NEC | No |
| 75852-47900 | | | MOULDING BODY, LH | 1 | 673.60 | 25.00 | 505.20 | Replace | Replace | No |
| 61602-47091 | | 6505476 | FENDER RR/LH | 1 | 766.80 | 25.00 | 575.10 | Replace | Replace ✓ OT | No |
| | COMMON | | SMRT LOGO | 1 | 7.80 | 0.00 | 7.80 | Replace | Replace ✓ | No NEC |
| | | | STICKER DECAL 6555 8888 | 1 | 21.60 | 0.00 | 21.60 | Replace | Replace ✓ | No NEC |
| 65638-47021 | | 6505477 | FENDER LINER RR/LH | 1 | 141.30 | 25.00 | 105.97 | Replace | Replace ✓ | No Defect. |
| 52592-47021 | | | BUMPER SEAL, RR LH | 1 | 88.90 | 25.00 | 66.67 | Replace | Replace ✓ MS | No |
| 65632-47041 | | | SILL MEMBER PLATE RR/LH | 1 | 57.50 | 25.00 | 43.12 | Replace | Replace | No |
| 62720-47031 | | | QUARTER GLASS RR/LH | 1 | 168.10 | 25.00 | 126.07 | Replace | Replace ✓ | No NEC |
| | COMMON | | SEALANT W/SCREEN | 1 | 37.00 | 0.00 | 37.00 | Replace | Replace ✓ | No NEC |
| 62940-16060 | | | DUCT ASSY, QUARTER | 1 | 70.40 | 25.00 | 52.80 | Replace | Replace ✓ | No MS |
| 61606-47020 | | | WHEEL HOUSE, OUTER LH REAR | 1 | 326.10 | 25.00 | 244.57 | Replace | Replace R | No |
| 61608-47061 | | | PANEL SUB-ASSY, QTR WHEEL HOUSE | 1 | 588.40 | 25.00 | 441.30 | Replace | Replace R | No |
| 61738-47020 | | | REINFORCEMENT, ROOF SIDE INNER LH | 1 | 60.30 | 25.00 | 45.22 | Replace | Replace R | No |
| 6162647020 | | | EXTENSION, QUARTER PANEL REAR LH | 1 | 108.50 | 10.00 | 97.65 | Replace | Replace ? | No |
| 61624-47010 | | | EXTENSION, QUARTER PANEL FRONT LH | 1 | 83.50 | 25.00 | 62.62 | Replace | Replace ? | No |
| 61744-47010 | | | REINFORCEMENT, BACK DOOR SIDE LH | 1 | 89.50 | 25.00 | 67.12 | Replace | Replace ? | No |
| 61732-47030 | | | PANEL, ROOF SIDE, INNER LH | 1 | 134.80 | 25.00 | 101.10 | Replace | Replace ? | No |
| 61714-47020 | | | REINFORCE, ROOF SIDE OUTER LH | 1 | 91.90 | 10.00 | 82.71 | Replace | Replace ? | No |
| 61712-47020 | | | PANEL, ROOF SIDE OUTER LH | 1 | 134.80 | 25.00 | 101.10 | Replace | Replace ? | No |
| 61218-47010 | | | RAIL, ROOF SIDE LH | 1 | 273.60 | 25.00 | 205.20 | Replace | Replace ? | No |

| Part Number | Portion | Stock No | Part Name | Qty | List Price (\$) | Discount (%) | Final Price (\$) | ARC Recommended | Surveyor Approved | Photos Attached |
|----------------|---------|----------|-----------------------------------|-----|-----------------|--------------|------------------|-----------------|-------------------|-----------------|
| 77300-52030 | | | CAP ASSY, FUEL TANK | 1 | 68.10 | 25.00 | 51.07 | Replace | Replace ✓ Defon. | No |
| 77350-47030 | | | LID ASSY, FUEL | 1 | 102.00 | 25.00 | 76.50 | Replace | Replace ✓ Defon. | No |
| 77035-47090 | | | CABLE SUB-ASSY, FUEL LID | 1 | 63.90 | 25.00 | 47.92 | Replace | Replace ? | No |
| 77201-47250 | | | PIPE SUB-ASSY, FUEL NECK | 1 | 230.80 | 25.00 | 173.10 | Replace | Replace ? | No |
| 77377-75010 | | | RETAINER, FUEL LID CABLE | 1 | 5.90 | 25.00 | 4.42 | Replace | Replace ? | No |
| 61622-47030 | | | TROUGH, BACK DOOR LH | 1 | 110.90 | 10.00 | 99.81 | Replace | Replace ✓ Defon. | No |
| 52563-47010 | | | TAIL LAMP BRACKET, LH | 1 | 30.70 | 25.00 | 23.02 | Replace | Replace ✓ NEC | No |
| 81561-47170 | | 6505461 | TAIL LAMP LH | 1 | 548.40 | 10.00 | 493.56 | Replace | Replace ✓ CRK. | No |
| 52159-47905 | | 6505548 | BUMPER REAR | 1 | 458.60 | 25.00 | 343.95 | Replace | Replace ✓ CRK. | No |
| 52023-12240 | | 6505547 | BUMPER REINFORCEMENT REAR | 1 | 205.70 | 25.00 | 154.27 | Replace | Replace ? | No |
| 52016-47030 | | | ARM SUB-ASSY, RR BUMPER LH | 1 | 139.60 | 25.00 | 104.70 | Replace | Replace ? | No |
| 52015-47050 | | | ARM SUB-ASSY, RR BUMPER RH | 1 | 139.60 | 25.00 | 104.70 | Replace | Replace ? | No |
| | | | SENSOR REVERSE | 1 | 180.00 | 0.00 | 180.00 | Replace | Replace ? | No |
| 52576-47020 | | 6505550 | BUMPER SIDE RETAINER RR/LH | 1 | 94.80 | 25.00 | 71.10 | Replace | Replace ✓ CRK. | No |
| 52575-47020 | | 6505549 | BUMPER SIDE RETAINER RR/RH | 1 | 94.80 | 25.00 | 71.10 | Replace | Replace ? | No |
| 76088-47020 | | 6505617 | BUMPER LIP COVER RR/LH | 1 | 72.20 | 25.00 | 54.15 | Replace | Replace ✓ Defon. | No |
| 76087-47020 | | 6505618 | BUMPER LIP COVER RR/RH | 1 | 118.10 | 25.00 | 88.57 | Replace | Replace X | No |
| 76891-47020 | | 6505619 | BUMPER LIP REAR | 1 | 228.90 | 25.00 | 171.67 | Replace | Replace ✓ Defon. | No |
| 58307-47060 | | 6505522 | END PANEL | 1 | 602.10 | 25.00 | 451.57 | Replace | Replace R | No |
| | COMMON | 4006314 | SEALANT SIKAFLEX | 1 | 37.00 | 0.00 | 37.00 | Replace | Replace ✓ NEC | No |
| 67005-47241 | | | TAILGATE ASY | 1 | 1,007.90 | 25.00 | 755.92 | Replace | Replace X | No |
| 76801-47070-B0 | | | TAILGATE OUTSIDE GARNISH | 1 | 504.90 | 25.00 | 378.67 | Replace | Replace R | No |
| 75374-47051 | | | NAME PLATE (HYBRID) | 1 | 51.90 | 25.00 | 38.92 | Replace | Replace | No |
| 75442-47030 | | | NAME PLATE (PRIUS) | 1 | 60.80 | 25.00 | 45.60 | Replace | Replace | No |
| 75443-47030 | | | NAME PLATE (TOYOTA) | 1 | 51.90 | 25.00 | 38.92 | Replace | Replace | No |
| | COMMON | | SMRT LOGO | 1 | 7.80 | 0.00 | 7.80 | Replace | Replace | No |
| | | | STICKER DECAL 6555 8888 | 1 | 21.60 | 0.00 | 21.60 | Replace | Replace | No |
| 75310-47020 | | 6505639 | EMBLEM REAR | 1 | 60.30 | 25.00 | 45.22 | Replace | Replace | No |
| 75573-47080 | | | TAIL GATE DOOR GLASS MOULDING, RH | 1 | 29.40 | 25.00 | 22.05 | Replace | Replace X | No |

| Part Number | Portion | Stock No | Part Name | Qty | List Price (\$) | Discount (%) | Final Price (\$) | ARC Recommendation | Surveyor Approved | Photos Attached |
|------------------------------------|---------|----------|-----------------------------------|-----|-----------------|--------------|------------------|--------------------|-------------------|-----------------|
| 75574-47020 | | | TAIL GATE DOOR GLASS MOULDING, LH | 1 | 29.40 | 25.00 | 22.05 | Replace | Replace X | No |
| | COMMON | | SEALANT W/SCREEN | 2 | 37.00 | 0.00 | 74.00 | Replace | Replace X | No |
| 75575-47030 | | | MOULDING BACK WINDOW, LOWER NO.1 | 1 | 29.40 | 25.00 | 22.05 | Replace | Replace X | No |
| | COMMON | | SEALANT W/SCREEN | 1 | 37.00 | 0.00 | 37.00 | Replace | Replace X | No |
| 76085-47910 | | 6505620 | SPOILER REAR | 1 | 953.70 | 25.00 | 715.27 | Replace | Replace X | No |
| 68810-47010 | | | TAILGATE DOOR HINGE LH/RH | 2 | 58.30 | 25.00 | 87.45 | Replace | Replace X | No |
| 68960-0W532 | | | TAILGATE DOOR STAY LH | 1 | 241.50 | 25.00 | 181.12 | Replace | Replace X | No |
| 68950-0W542 | | | TAILGATE DOOR STAY RH | 1 | 241.50 | 25.00 | 181.12 | Replace | Replace X | No |
| 42611-47140 | | 6505658 | WHEEL, DISC | 1 | 1,490.20 | 25.00 | 1,117.65 | Replace | Replace X | No |
| | | 6503707 | TYRE | 1 | 126.74 | 0.00 | 126.74 | Replace | Replace X | No |
| TOTAL MATERIALS | | | | | | | 11,760.88 | 11,760.75 | | |
| TOTAL MATERIALS(Discounted) | | | | | | | 9,509.99 | 9,509.99 | | |

Added Spare Parts / Material Usage After Surveyor Signed off

| Part Number | Portion | Part Name | Qty | List Price (\$) | Discount (%) | Final Price (\$) | ARC Check | Surveyor Check | LT Check |
|--------------------------------------|---------|-----------|-----|-----------------|--------------|------------------|-----------|----------------|----------|
| TOTAL SUPPLEMENTARY MATERIALS | | | | | | | | | |



SMRT Automotive Service Pte Ltd

60 Woodlands Industrial Park E4, Singapore 757705

FAX Number : 63685592

Estimator Telephone Number : 68662623

Accident Reporting Number : 68662672

8-6-18 / 09:54

8-6-18 / 13:54

SMRT Accident Vehicle Repair Estimates

30-5-18 / 13:54

Section A - To be completed by claims Advisor/Duty officer at Accident Reporting Centre

Reg. No : SHB579S
Ref. No : TAX/05/18/2120
Reg. Date : 10/12/2014
Vehicle Type : TAXI
Make : TOYOTA PRIUS
Model : PRIUS
Name of Driver : WEE TIONG
Type of Accident : SIDE SWIPE
Date / Time of Accident : 26/05/2018 03:55:00 PM
Accident Reported Date / Time : 28/05/2018 12:00:00 AM
Surveyor is Required? : Yes
Survey by : Sebastian
Vehicle is Towed Back? : Yes
Towed Back Date/Time : 26/05/2018
Replacement Vehicle issued? : No
Accident Repair Job Card No : 000024096309
Special Instruction to ARC, if any :

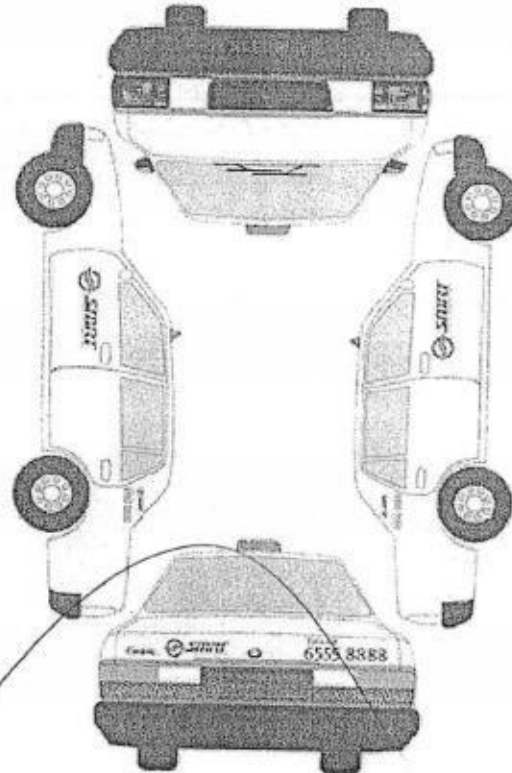

TOWED \$90 / YN7167L NTUC HS
BEFORE PAINT PHOTO AND AFTER REPAIR PHOTO, FOR CHECK ITEM AND REPLACE ITEM PLEASE CALL
SURVEYOR SEBASTIAN (LKK) & Email : sebastianyeang @lkkauto.com HP: 90036121
LUMP SUM REPAIR

Prepared Date : 28/05/2018 11:53:43 AM

Shure .

Recording Camera

☐ ☒

Radio Antenna

☐ ☒1st witness

Date 30-5-18

2nd witness

Date

271801

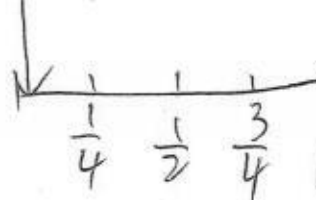

12/6/18 14:37 QC Reject

Fuel Tank 401s Adjust

13/6/18 1030 pass

Vehicle Return Date:

Vehicle Return Time:

12-6-2018 12:10

SMRT staff sign:

271832

Supplementary
& Refund to the Supplementary part 1154

Section B - To be Completed by Service Advisor, Accident Repair Centre

Chassis No : JTDKN36U005753276

Mileage : 0

Work Shop :

Repair Completed Date / Time :

Summary of Repair Estimates

| | Quotation from ARC | Adjusted by Surveyor, if applicable |
|------------------------------|------------------------------|-------------------------------------|
| Total Labour Charges | : 1,690.00 | 1,400.00 |
| Total Spray Painting Charges | : 3,312.00 | 1,150.00 |
| Total Material Charges | : 11,566.63 | 9,499.21 |
| Other Charges | : 1,525.00 | -2,049.21 |
| TOTAL | : 18,093.63 26,975.64 | 10,000.00 |
| Lump Sum Total | : 0.00 | 0.00 |
| No. of Repair Days | : 12.00 | 10.00 ✓ |
| Prepared / Adjusted By | : | SEBASTIAN (LKK) |
| Arc / Surveyor Sing Off Date | : 28/05/2018 02:45:22 PM | 30/05/2018 01:54:24 PM |

Prepared / Adjusted Date :

Remarks :

Prepared Date : 28/05/2018 02:45:14 PM

Section C - To be Completed by Admin Assistant, Accident Repair Centre, Upon Completion of Repair

Quotation No : QN-1806-0404

Invoice No :

Quotation Date : 19/6

Invoice Date :

Invoice Amount :

Prepared Date :

9499.21 ✓
+ 1400.00 ✓
+ 1595.00 ✓

12494.21 ✓
- 202

9995.36 ✓

45 \$10,000/- ✓

confirmed.

Section D - Details of Repair Estimates

Part 1 - Labour Works

| Job Scope | Quotation from ARC | Adjusted by Surveyor, if applicable |
|---------------------------|--------------------|-------------------------------------|
| TO REPAIR LH REAR PORTION | 1,690.00 | 1,400.00 ✓ |
| Total Labour | 1,690.00 | 1,400.00 |

Part 2 - Spray Painting & Panel Beating Related Works

| Job Scope | Quotation from ARC | Adjusted by Surveyor, if applicable |
|---|--------------------|-------------------------------------|
| TO RESPRAY REAR DOOR LH | 378.00 | 200.00 ✓ |
| TO RESPRAY DOOR HANDLE | 180.00 | 50.00 ✓ |
| TO RESPRAY ROCKER PANEL MOULDING | 180.00 | 0.00 |
| TO RESPRAY REAR FENDER LH | 378.00 | 200.00 ✓ |
| TO RESPRAY REAR LH WHEEL HOUSE | 180.00 | 100.00 ✓ |
| TO RESPRAY LH RAIL ROOF SIDE | 180.00 | 100.00 ✓ |
| TO RESPRAY FUEL LID COVER | 180.00 | 50.00 ✓ |
| TO RESPRAY TROUGH BACK DOOR LH | 180.00 | 50.00 ✓ |
| TO REPSRAY REAR BUMPER | 378.00 | 200.00 ✓ |
| TO RESPRAY REAR PANEL | 180.00 | 100.00 ✓ |
| TO RESPRAY TAIL GATE | 378.00 | 0.00 |
| TO RESPRAY TAILGATE OUTSIDE GARNISH | 180.00 | 100.00 ✓ |
| TO RESPRAY REAR SPOILER | 180.00 | 0.00 |
| TO RESPRAY RIM | 180.00 | 0.00 |
| Total Spray Painting & Panel Beating | 3,312.00 | 1,150.00 ✓ |

Part 3 - Other Costs - Accident and Accident Repair Related Expenses

| Job Scope | Quotation from ARC | Adjusted by Surveyor, if applicable |
|---|--------------------|-------------------------------------|
| TO CHECK WIRING AND SYSTEM FUNCTION | 80.00 | 30.00 ✓ |
| TO APPLY RUST-PROOFING ON AFFECTED AREA | 200.00 | 50.00 ✓ |
| TO REMOVE & REFIT REAR QUARTER GLASS LH | 120.00 | 30.00 ✓ |
| TO PROVIDE LABOUR & MATERIAL FOR SOLAR FILM (NET) | 125.00 | 125.00 ✓ NGL |
| TO TRANSFER DOOR MECHANISM | 120.00 | 60.00 ✓ |
| TO TEST AND REFIX REVERSE SENSOR SYSTEM | 120.00 | 30.00 ✓ |
| TO TRANSFER REAR TAILGATE MECHANISM | 120.00 | 0.00 |
| TO REMOVE AND REFIX REAR WINDSCREEN | 120.00 | 0.00 |
| TO DO WHEEL ALIGNMENT / TYRE BALANCING | 120.00 | 60.00 ✓ |
| TO INSPECT RR LIGHTING, MECHANISMS & WATER TEST RR LIGHTING FOR LEAKAGE | 120.00 | 30.00 ✓ |
| TO REMOVE AND INSTALL LUGGAGE COMPARTMENT TRIM TO FACILITATE REPAIR. | 120.00 | 30.00 ✓ |
| TO REPLACE SUNDRY PARTS | 100.00 | 0.00 |
| TO WASH AND VACUUM | 60.00 | 0.00 |
| Lump Sum Adjustment by Surveyor | 0.00 | -2,494.21 |
| Total Other Costs | 1,525.00 | -2,049.21 |

Part 4 - Spare Parts / Material Usage

| Part Number | Portion | Stock No | Part Name | Qty | List Price (\$) | Discount (%) | Final Price (\$) | ARC Recommendation | Surveyor Approved | Photos Attached | |
|----------------|---------|----------|--------------------------------------|-----|----------------------|--------------|------------------|--------------------|-------------------|-----------------|--------|
| 67004-47080 | | 6505487 | DOOR RR/LH | 1 | 954.50 | 25.00 | 715.87 | Replace | Replace | No | DT |
| | | | PIXEL STICKER | 2 | 60.00 ¹²⁰ | 0.00 | 120.00 | Replace | Replace | No | NEC |
| 69211-74020 | | | DOOR OUTER HANDLE RR/LH | 1 | 69.80 | 25.00 | 52.35 | Replace | Replace | No | Jm |
| 85720-47130 | | | DOOR REGULATOR MOTOR REAR LH | 1 | 768.90 | 10.00 | 692.01 | Replace | Check | No | NN |
| 69802-52070 | | | DOOR REGULATOR SUB-ASSY, FRT/REAR LH | 1 | 224.80 | 25.00 | 168.60 | Replace | Replace | No | DT |
| 62332-47030-BO | | | WEATHERSTRIP LHR DR, OPENING | 1 | 229.70 | 25.00 | 172.27 | Replace | Replace | No | NEC |
| 67872-47030 | | | DOOR WEATHER STRIP RR/LH | 1 | 171.20 | 25.00 | 128.40 | Replace | Replace | No | NEC |
| 75852-47900 | | | MOULDING BODY, LH | 0 | 673.60 | 25.00 | 0.00 | Replace | Not given | No | NN |
| 61602-47091 | | 6505476 | FENDER RR/LH | 1 | 766.80 | 25.00 | 575.10 | Replace | Replace | No | DT |
| | COMMO N | | SMRT LOGO | 1 | 7.80 | 0.00 | 7.80 | Replace | Replace | No | NEC |
| | | | STICKER DECAL 6555 8888 | 1 | 21.60 | 0.00 | 21.60 | Replace | Replace | No | NEC |
| 65638-47021 | | 6505477 | FENDER LINER RR/LH | 1 | 141.30 | 25.00 | 105.97 | Replace | Replace | No | Deform |
| 52592-47021 | | | BUMPER SEAL, RR LH | 1 | 88.90 | 25.00 | 66.67 | Replace | Replace | No | MS |
| 65632-47041 | | | SILL MEMBER PLATE RR/LH | 1 | 57.50 | 25.00 | 43.13 | Replace | Check | No | NN |
| 62720-47031 | | | QUARTER GLASS RR/LH | 1 | 168.10 | 25.00 | 126.07 | Replace | Replace | No | NEC |
| | COMMO N | | SEALANT W/SCREEN | 1 | 37.00 | 0.00 | 37.00 | Replace | Replace | No | NEC |
| 62940-16060 | | | DUCT ASSY, QUARTER | 1 | 70.40 | 25.00 | 52.80 | Replace | Replace | No | MS |
| 61606-47020 | | | WHEEL HOUSE, OUTER LH REAR | 1 | 326.10 | 100.00 | 0.00 | Replace | Repair | No | R |
| 61608-47061 | | | PANEL SUB-ASSY, QTR WHEEL HOUSE | 1 | 588.40 | 100.00 | 0.00 | Replace | Repair | No | R |
| 61738-47020 | | | REINFORCEMENT, ROOF SIDE INNER LH | 1 | 60.30 | 100.00 | 0.00 | Replace | Repair | No | R |
| 6162647020 | | | EXTENSION, QUARTER PANEL REAR LH | 1 | 108.50 | 10.00 | 97.65 | Replace | Check | No | X |
| 61624-47010 | | | EXTENSION, QUARTER PANEL FRONT LH | 1 | 83.50 | 25.00 | 62.63 | Replace | Check | No | X |
| 61744-47010 | | | REINFORCEMENT, BACK DOOR SIDE LH | 1 | 89.50 | 25.00 | 67.13 | Replace | Check | No | X |
| 61732-47030 | | | PANEL, ROOF SIDE, INNER LH | 1 | 134.80 | 25.00 | 101.10 | Replace | Check | No | X |
| 61714-47020 | | | REINFORCE, ROOF SIDE OUTER LH | 1 | 91.90 | 10.00 | 82.71 | Replace | Check | No | X |
| 61712-47020 | | | PANEL, ROOF SIDE OUTER LH | 1 | 134.80 | 25.00 | 101.10 | Replace | Check | No | X |
| 61218-47010 | | | RAIL, ROOF SIDE LH | 1 | 273.60 | 25.00 | 205.20 | Replace | Check | No | X |
| 77300-52030 | | | CAP ASSY, FUEL TANK | 1 | 68.10 | 25.00 | 51.07 | Replace | Replace | No | Deform |

6531.40

| Part Number | Portion | Stock No | Part Name | Qty | List Price (\$) | Discount (%) | Final Price (\$) | ARC Recommendation | Surveyor Approved | Photos Attached | |
|----------------|---------|----------|-----------------------------------|-----|-----------------|--------------|------------------|--------------------|-------------------|-----------------|--------|
| 77350-47030 | | | LID ASSY, FUEL | 1 | 102.00 | 25.00 | 76.50 | Replace | Replace | No ✓ | Deform |
| 77035-47090 | | | CABLE SUB-ASSY, FUEL LID | 1 | 63.90 | 25.00 | 47.93 | Replace | Replace S | No ✓ | } DMG |
| 77201-47250 | | | PIPE SUB-ASSY, FUEL NECK | 1 | 230.80 | 25.00 | 173.10 | Replace | Replace S | No ✓ | |
| 77377-75010 | | | RETAINER, FUEL LID CABLE | 1 | 5.90 | 25.00 | 4.43 | Replace | Replace S | No ✓ | |
| 61622-47030 | | | TROUGH, BACK DOOR LH | 1 | 110.90 | 10.00 | 99.81 | Replace | Replace | No ✓ | Deform |
| 52563-47010 | | | TAIL LAMP BRACKET, LH | 1 | 30.70 | 25.00 | 23.02 | Replace | Replace | No ✓ | NEC |
| 81561-47170 | | 6505461 | TAIL LAMP LH | 1 | 548.40 | 10.00 | 493.56 | Replace | Replace | No ✓ | } CRK |
| 52159-47905 | | 6505548 | BUMPER REAR | 1 | 458.60 | 25.00 | 343.95 | Replace | Replace | No ✓ | |
| 52023-12240 | | 6505547 | BUMPER REINFORCEMENT REAR | 1 | 205.70 | 25.00 | 154.28 | Replace | Check | No X | } NN |
| 52016-47030 | | | ARM SUB-ASSY, RR BUMPER LH | 1 | 139.60 | 25.00 | 104.70 | Replace | Check | No X | |
| 52015-47050 | | | ARM SUB-ASSY, RR BUMPER RH | 1 | 139.60 | 25.00 | 104.70 | Replace | Check | No X | |
| | | | SENSOR REVERSE | 1 | 180.00 | 0.00 | 180.00 | Replace | Check | No X | } CRK |
| 52576-47020 | | 6505550 | BUMPER SIDE RETAINER RR/LH | 1 | 94.80 | 25.00 | 71.10 | Replace | Replace | No ✓ | |
| 52575-47020 | | 6505549 | BUMPER SIDE RETAINER RR/RH | 1 | 94.80 | 25.00 | 71.10 | Replace | Check | No X | NN |
| 76088-47020 | | 6505617 | BUMPER LIP COVER RR/LH | 1 | 72.20 | 25.00 | 54.15 | Replace | Replace | No ✓ | Deform |
| 76087-47020 | | 6505618 | BUMPER LIP COVER RR/RH | 0 | 118.10 | 25.00 | 0.00 | Replace | Not given | No X | NN |
| 76891-47020 | | 6505619 | BUMPER LIP REAR | 1 | 228.90 | 25.00 | 171.67 | Replace | Replace | No ✓ | Deform |
| 58307-47060 | | 6505522 | END PANEL | 1 | 602.10 | 100.00 | 0.00 | Replace | Repair | No R | } NEC |
| | COMMO N | 4006314 | SEALANT SIKAFLEX | 1 | 37.00 | 0.00 | 37.00 | Replace | Replace | No ✓ | |
| 67005-47241 | | | TAILGATE ASY | 0 | 1,007.90 | 25.00 | 0.00 | Replace | Not given | No X | NN |
| 76801-47070-B0 | | | TAILGATE OUTSIDE GARNISH | 1 | 504.90 | 100.00 | 0.00 | Replace | Repair | No R | } NEC |
| 75374-47051 | | | NAME PLATE (HYBRID) | 1 | 51.90 | 25.00 | 38.92 | Replace | Replace | No ✓ | |
| 75442-47030 | | | NAME PLATE (PRIUS) | 1 | 60.80 | 25.00 | 45.60 | Replace | Replace | No ✓ | |
| 75443-47030 | | | NAME PLATE (TOYOTA) | 1 | 51.90 | 25.00 | 38.92 | Replace | Replace | No ✓ | |
| | COMMO N | | SMRT LOGO | 1 | 7.80 | 0.00 | 7.80 | Replace | Replace | No ✓ | |
| | | | STICKER DECAL 6555 8888 | 1 | 21.60 | 0.00 | 21.60 | Replace | Replace | No ✓ | } NN |
| 75310-47020 | | 6505639 | EMBLEM REAR | 1 | 60.30 | 25.00 | 45.22 | Replace | Replace | No ✓ | |
| 75573-47080 | | | TAIL GATE DOOR GLASS MOULDING, RH | 0 | 29.40 | 25.00 | 0.00 | Replace | Not given | No X | |
| 75574-47020 | | | TAIL GATE DOOR GLASS MOULDING, LH | 0 | 29.40 | 25.00 | 0.00 | Replace | Not given | No X | } NN |
| | COMMO N | | SEALANT W/SCREEN | 0 | 37.00 | 0.00 | 0.00 | Replace | Not given | No X | |

5326.90

| Part Number | Portion | Stock No | Part Name | Qty | List Price (\$) | Discount (%) | Final Price (\$) | ARC Recommendation | Surveyor Approved | Photos Attached |
|-----------------------------|---------|----------|----------------------------------|-----|-----------------|--------------|------------------|--------------------|-------------------|-----------------|
| 75575-47030 | | | MOULDING BACK WINDOW, LOWER NO.1 | 0 | 29.40 | 25.00 | 0.00 | Replace | Not given | No X |
| | COMMON | | SEALANT W/SCREEN | 0 | 37.00 | 0.00 | 0.00 | Replace | Not given | No X |
| 76085-47910 | | 6505620 | SPOILER REAR | 0 | 953.70 | 25.00 | 0.00 | Replace | Not given | No X |
| 68810-47010 | | | TAILGATE DOOR HINGE LH/RH | 0 | 58.30 | 25.00 | 0.00 | Replace | Not given | No X |
| 68960-0W532 | | | TAILGATE DOOR STAY LH | 0 | 241.50 | 25.00 | 0.00 | Replace | Not given | No X |
| 68950-0W542 | | | TAILGATE DOOR STAY RH | 0 | 241.50 | 25.00 | 0.00 | Replace | Not given | No X |
| 42611-47140 | | 6505658 | WHEEL, DISC | 1 | 1,490.20 | 25.00 | 1,117.65 | Replace | Replace S | No / |
| | | 6503707 | TYRE | 1 | 126.74 | 0.00 | 126.74 | Replace | Replace S | No / |
| 64740-47031B2 | | | PANEL ASSY, DECK LH | 1 | 307.00 | 25.00 | 230.25 | Replace | Replace S | No / |
| 64997-47020 | | | BOX, DECK FLOOR, LH | 1 | 196.80 | 25.00 | 147.60 | Replace | Replace S | No / |
| 58418-47070B0 | | | BOX, DECK FLOOR, COVER LH | 1 | 230.10 | 25.00 | 172.57 | Replace | Replace S | No / |
| 64993-47020 | | | BOX, DECK FLOOR, RR | 1 | 649.70 | 25.00 | 487.27 | Replace | Replace S | No / |
| 67750-47071C0 | | | TAILGATE, BOARD ASSY | 1 | 246.90 | 25.00 | 185.17 | Replace | Replace S | No / |
| 67881-47022 | | | TAILGATE DOOR WEATHER STRIP | 1 | 353.40 | 25.00 | 265.05 | Replace | Replace S | No / |
| 42101-12171 | | 6505481 | REAR CROSS MEMBER | 1 | 2,621.50 | 25.00 | 1,966.12 | Replace | Replace S | No / |
| 48725-47030 | | | BUSH, RR CROSS MEMBER | 2 | 148.50 | 25.00 | 222.75 | Replace | Replace S | No / |
| 42450-47040 | | | WHEEL HUB REAR | 1 | 489.40 | 25.00 | 367.05 | Replace | Replace S | No / |
| 77291-47030 | | | SHIELD, FUEL TANK FILLER PIPE | 1 | 20.20 | 25.00 | 15.15 | Replace | Replace S | No / |
| TOTAL MATERIALS | | | | | 8590.34 | | | 11,566.71 | 9,499.21 | |
| TOTAL MATERIALS(Discounted) | | | | | | | | 11,566.63 | 9,499.21 | |

Added Spare Parts / Material Usage After Surveyor Signed off

| Part Number | Portion | Part Name | Qty | List Price (\$) | Discount (%) | Final Price (\$) | ARC Check | Surveyor Check | LT Check |
|-------------------------------|---------|-------------------------------|-----|-----------------|--------------|------------------|-----------|----------------|----------|
| 64740-47031B2 | | PANEL ASSY, DECK LH | 1 | 307.00 | 25.00 | 230.25 | Replace | Replace | No |
| 64997-47020 | | BOX, DECK FLOOR, LH | 1 | 196.80 | 25.00 | 147.60 | Replace | Replace | No |
| 58418-47070B0 | | BOX, DECK FLOOR, COVER LH | 1 | 230.10 | 25.00 | 172.57 | Replace | Replace | No |
| 64993-47020 | | BOX, DECK FLOOR, RR | 1 | 649.70 | 25.00 | 487.27 | Replace | Replace | No |
| 67750-47071C0 | | TAILGATE, BOARD ASSY | 1 | 246.90 | 25.00 | 185.17 | Replace | Replace | No |
| 67881-47022 | | TAILGATE DOOR WEATHER STRIP | 1 | 353.40 | 25.00 | 265.05 | Replace | Replace | No |
| 42101-12171 | | REAR CROSS MEMBER | 1 | 2,621.50 | 25.00 | 1,966.12 | Replace | Replace | No |
| 48725-47030 | | BUSH, RR CROSS MEMBER | 2 | 148.50 | 25.00 | 222.75 | Replace | Replace | No |
| 42450-47040 | | WHEEL HUB REAR | 1 | 489.40 | 25.00 | 367.05 | Replace | Replace | No |
| 77291-47030 | | SHIELD, FUEL TANK FILLER PIPE | 1 | 20.20 | 25.00 | 15.15 | Replace | Replace | No |
| TOTAL SUPPLEMENTARY MATERIALS | | | | | | 4,058.98 | | | |



Thatcham escribe

National Assessment Centre Services

51 Ubi Ave 1 #01-25 Paya Ubi Industrial Park, Singapore 408933

TEL: 6841 0055 FAX: 6841 6315

Reg. No: 52983356E GST Reg. No. 20-0405911-H



| | | | |
|--|--|---|------------|
| NTUC INCOME INSURANCE CO-OPERATIVE LTD | | Ref: NS/INC18010377/Svbn2 | |
| 73 BRAS BASAH ROAD | |  | |
| #05-01 NTUC TRADE UNION HOUSESINGAPORE 189556 | | | |
| | | Date: 02-07-2018 | |
| | | Code: INC4 | |
| 1. Policy Particulars :- THIRD PARTY CLAIM | | | |
| Insured Veh. | YN 7167L | Veh. Inspected | SHB 579S |
| Policy No. | 5078934812-02 | Coverage (\$) | 0.00 |
| Claim No. | MT/0996191-003 | Excess (\$) | 0.00 |
| Assign From | | Assign Date | 30/05/2018 |
| 2. Vehicle Particulars & Condition | | | |
| Make & Model | TOYOTA PRIUS | c.c | 1798 |
| Engine No. | HIDDEN | Year of Reg. | 2014 |
| Chassis No. | JTDKN36U005753276 | Colour | MAROON |
| Odometer | 271801 | Steering | IN ORDER |
| Brakes | IN ORDER | Modification | NIL |
| General | FAIR | | |
| 3. Conditions of Tyres | | | |
| | Size | Make | Balance |
| R/H Front Tyre | 195/65 R15 | FALKEN | 6 mm |
| L/H Front Tyre | 195/65 R15 | FALKEN | 6 mm |
| R/H Rear Tyre | 195/65 R15 | FALKEN | 6 mm |
| L/H Rear Tyre | 195/65 R15 | FALKEN | 6 mm |
| 4. Description of Damages | | | |
| THE VEHICLE SUSTAINED DAMAGES AT THE N/S REAR PORTION. | | | |
| DAMAGES SEE DETAILS. | | | |
| 5. General Information | | | |
| Accident Date | 26/05/2018 | Inspection Date | 30/05/2018 |
| Survey held at | SMRT AUTOMOTIVE SERVICES PTE LTD 60 WOODLANDS INDUSTRIAL PARK E4 SINGAPORE 757705 | | |
| 5a. Remarks | | | |
| A)THE INSPECTION WAS CONDUCTED ON A"WITHOUT PREJUDICE" BASIS. B)IN ACCORDANCE TO YOUR INSTRUCTIONS, WE HAVE NOT AUTHORISED REPAIRS. | | | |
| 5b. Estimate Days of Repair | | | |
| ESTIMATED NORMAL PERIOD FOR REPAIR: | | 10 Working Days | |



National Assessment Centre Services

51 Ubi Ave 1 #01-25 Paya Ubi Industrial Park, Singapore 408933

TEL: 6841 0055 FAX: 6841 6315

Reg. No: 52983356E GST Reg. No. 20-0405911-H



Page No.: 1 of 3

ADJUSTMENT ON REPAIR COST FOR VEHICLE NO. SHB 579S

| Qty | Description of Parts | Condition | Estimate By Workshop (\$) | Our Adjusted (\$) |
|-----------------------------|--|-----------|---------------------------|-------------------|
| REPLACEMENT OF PARTS | | | | |
| 1 | DOOR RR/LH (DISC 25%) | DENTED | 954.50 | 715.87 |
| 1 | DOOR OUTER HANDLE RR/LH (DISC 25%) | JAMMED | 69.80 | 52.35 |
| 1 | DOOR REGULATOR SUB-ASSY,FRT/REAR LH (DISC 25%) | DENTED | 224.80 | 168.60 |
| 1 | WEATHERSTRIP LHR DR.OPENING (DISC 25%) | NECESSARY | 229.70 | 172.27 |
| 1 | DOOR WEATHERSTRIP RR/LH (DISC 25%) | NECESSARY | 171.20 | 128.40 |
| 1 | FENDER RR/LH (DISC 25%) | DENTED | 766.80 | 575.10 |
| 1 | FENDER LINER RR/LH (DISC 25%) | DEFORMED | 141.30 | 105.97 |
| 1 | BUMPER SEAL,RR LH (DISC 25%) | MISSING | 88.90 | 66.67 |
| 1 | QUARTER GLASS RR/LH (DISC 25%) | NECESSARY | 168.10 | 126.07 |
| 1 | DUCT ASSY,QUARTER (DISC 25%) | MISSING | 70.40 | 52.80 |
| 1 | CAP ASSY,FUEL TANK (DISC 25%) | DEFORMED | 68.10 | 51.07 |
| 1 | LID ASSY,FUEL (DISC 25%) | DEFORMED | 102.00 | 76.50 |
| 1 | CABLE SUB-ASSY,FUEL LID (DISC 25%) | DAMAGED | 63.90 | 47.93 |
| 1 | PIPE SUB-ASSY FUEL NECK (DISC 25%) | DAMAGED | 230.80 | 173.10 |
| 1 | RETAINER,FUEL LID CABLE (DISC 25%) | DAMAGED | 5.90 | 4.43 |
| 1 | TAIL LAMP BRACKET,LH (DISC 25%) | NECESSARY | 30.70 | 23.02 |
| 1 | BUMPER REAR (DISC 25%) | CRACKED | 458.60 | 343.95 |
| 1 | BUMPER SIDE RETAINER RR/LH (DISC 25%) | CRACKED | 94.80 | 71.10 |
| 1 | BUMPER LIP COVER RR/LH (DISC 25%) | DEFORMED | 72.20 | 54.15 |
| 1 | BUMPER LIP REAR (DISC 25%) | DEFORMED | 228.90 | 171.67 |
| 1 | NAME PLATE (HYBRID) (DISC 25%) | NECESSARY | 51.90 | 38.92 |
| 1 | NAME PLATE (PRIUS) (DISC 25%) | NECESSARY | 60.80 | 45.60 |
| 1 | NAME PLATE (TOYOTA) (DISC 25%) | NECESSARY | 51.90 | 38.92 |
| 1 | EMBLEM REAR (DISC 25%) | NECESSARY | 60.30 | 45.22 |
| 1 | WHEEL,DISC (DISC 25%) | DENTED | 1,490.20 | 1,117.65 |
| 1 | PANEL ASSY,DECK LH (DISC 25%) | DENTED | 307.00 | 230.25 |
| 1 | BOX,DECK FLOOR,LH (DISC 25%) | CRACKED | 196.80 | 147.60 |
| 1 | BOX,DECK FLOOR,COVER LH (DISC 25%) | CRACKED | 230.10 | 172.57 |
| 1 | BOX,DECK FLOOR,RR (DISC 25%) | CRACKED | 649.70 | 487.27 |
| 1 | TAILGATE,BOARD ASSY (DISC 25%) | DEFORMED | 246.90 | 185.17 |

Report Ref No. NS/INC18010377/Svbn2

**National Assessment Centre Services**

51 Ubi Ave 1 #01-25 Paya Ubi Industrial Park, Singapore 408933

TEL: 6841 0055 FAX: 6841 6315

Reg. No: 52983356E GST Reg. No. 20-0405911-H



Page No.:2 of 3

| Qty | Description of Parts | Condition | Estimate By Workshop (\$) | Our Adjusted (\$) |
|-----|--|---------------|---------------------------|-------------------|
| 1 | TAILGATE DOOR WEATHER STRIP (DISC 25%) | CUT | 353.40 | 265.05 |
| 1 | REAR CROSS MEMBER (DISC 25%) | BENT | 2,621.50 | 1,966.12 |
| 2 | BUSH,RR CROSS MEMBER \$148.50 (DISC 25%) | NECESSARY | 297.00 | 222.75 |
| 1 | WHEEL HUB REAR (DISC 25%) | DAMAGED | 489.40 | 367.05 |
| 1 | SHIELD,FUEL TANK FILLER PIPE (DISC 25%) | DEFORMED | 20.20 | 15.15 |
| 1 | TROUGH,BACK DOOR LH (DISC 10%) | DEFORMED | 110.90 | 99.81 |
| 1 | TAIL LAMP LH (DISC 10%) | CRACKED | 548.40 | 493.56 |
| 1 | SOLAR FILM (SN) | NECESSARY | 125.00 | 125.00 |
| 2 | PIXEL STICKER @\$60.00 (SN) | NECESSARY | 120.00 | 120.00 |
| 1 | SMRT LOGO (SN) | NECESSARY | 7.80 | 7.80 |
| 1 | STICKER DECAL 65558888 (SN) | NECESSARY | 21.60 | 21.60 |
| 1 | SEALANT W/SCREEN (SN) | NECESSARY | 37.00 | 37.00 |
| 1 | SEALANT SIKAFLEX (SN) | NECESSARY | 37.00 | 37.00 |
| 1 | SMRT LOGO (SN) | NECESSARY | 7.80 | 7.80 |
| 1 | STICKER DECAL 65558888 (SN) | NECESSARY | 21.60 | 21.60 |
| 1 | TYRE (SN) | CUT | 126.74 | 126.74 |
| 1 | MOULDING BODY,LH | NOT NECESSARY | 673.60 | - |
| 1 | SILL MEMBER PLATE RR/LH | NOT NECESSARY | 57.50 | - |
| 1 | EXTENSION QUARTER PANEL REAR LH | NOT NECESSARY | 108.50 | - |
| 1 | EXTENSION QUARTER PANEL FRONT LH | NOT NECESSARY | 83.50 | - |
| 1 | REINFORCEMENT,BACK DOOR SIDE LH | NOT NECESSARY | 89.50 | - |
| 1 | PANEL ROOF SIDE,INNER LH | NOT NECESSARY | 134.80 | - |
| 1 | REINFORCE,ROOF SIDE OUTER LH | NOT NECESSARY | 91.90 | - |
| 1 | PANEL ROOF SIDE,OUTER LH | NOT NECESSARY | 134.80 | - |
| 1 | RAIL,ROOF SIDE LH | NOT NECESSARY | 273.60 | - |
| 1 | BUMPER REINFORCEMENT REAR | NOT NECESSARY | 205.70 | - |
| 1 | ARM SUB-ASSY,RR BUMPER LH | NOT NECESSARY | 139.60 | - |
| 1 | ARM SUB-ASSY,RR BUMPER RH | NOT NECESSARY | 139.60 | - |
| 1 | SENSOR REVERSE | NOT NECESSARY | 180.00 | - |
| 1 | BUMPER SIDE RETAINER RR/RH | NOT NECESSARY | 94.80 | - |
| 1 | BUMPER LIP COVER RR/RH | NOT NECESSARY | 118.10 | - |
| 1 | TAILGATE ASY | NOT NECESSARY | 1,007.90 | - |
| 1 | TAILGATE DOOR GLASS MOULDING,RH | NOT NECESSARY | 29.40 | - |

Report Ref No. NS/INC18010377/Svbn2



National Assessment Centre Services

51 Ubi Ave 1 #01-25 Paya Ubi Industrial Park, Singapore 408933

TEL: 6841 0055 FAX: 6841 6315

Reg. No: 52983356E GST Reg. No. 20-0405911-H



Page No.:3 of 3

| Qty | Description of Parts | Condition | Estimate By Workshop (\$) | Our Adjusted (\$) |
|-----|---|---------------|---------------------------|-------------------|
| 1 | TAILGATE DOOR GLASS MOULDING,LH | NOT NECESSARY | 29.40 | - |
| 1 | SEALANT W/SCREEN | NOT NECESSARY | 37.00 | - |
| 1 | MOULDING BACK WINDOW,LOWER NO 1 | NOT NECESSARY | 29.40 | - |
| 1 | SEALANT W/SCREEN | NOT NECESSARY | 37.00 | - |
| 1 | SPOILER REAR | NOT NECESSARY | 953.70 | - |
| 1 | TAILGATE DOOR HINGE LH/RH | NOT NECESSARY | 58.30 | - |
| 1 | TAILGATE DOOR STAY LH | NOT NECESSARY | 241.50 | - |
| 1 | TAILGATE DOOR STAY RH | NOT NECESSARY | 241.50 | - |
| 1 | DOOR REGULATOR MOTOR REAR LH | NOT NECESSARY | 768.90 | - |
| 1 | WHEEL HOUSE OUTER LH REAR | TO REPAIR | 326.10 | - |
| 1 | PANEL SUB-ASSY QTR WHEEL HOUSE | TO REPAIR | 588.40 | - |
| 1 | REINFORCEMENT,ROOR SIDE INNER LH | TO REPAIR | 60.30 | - |
| 1 | END PANEL | TO REPAIR | 602.10 | - |
| 1 | TAILGATE OUTSIDE GARNISH | TO REPAIR | 504.90 | - |
| | | | 20,573.64 | 9,624.22 |
| | LABOUR | | | |
| | TO WASH AND VACUUM. | NOT NECESSARY | 60.00 | - |
| | THATCHAM STANDARD REPAIR TIME ON BODY WORKS. | | 2,730.00 | 1,670.00 |
| | THATCHAM TTS STANDARD SPRAY PAINTING COST AND LABOUR. | | 3,512.00 | 1,200.00 |
| | TO REPLACE SUNDRY PARTS. | | 100.00 | - |
| | | | 6,402.00 | 2,870.00 |
| | GRAND TOTAL | | 26,975.64 | 12,494.22 |
| | RECOMMENDED COST OF LUMP SUM REPAIRS (TO ITS PRE-ACCIDENT CONDITION) (CONFIRMED) | | | 10,000.00 |

Report Ref No. NS/INC18010377/Svbn2

YEANG WAI KEEN

Automotive Assessor

K.K.LAU CPT(RET)

BEng(Hons),B.Bus,MBA,PEng,PE,
MinstAEA,MASME,MIRTE

REGD Auto Consultant-SAE, Licensed Appraiser

DISCLAIMER OF LIABILITY TO THIRD PARTIES:- This Report is made solely for the use and benefit of the Client named on the front page of this Report.
No liability of responsibility whatsoever, in contract or tort, is accepted to any third party who may rely on the Report wholly or in part. Any third party acting or relying on this Report, in whole or in part, does so at his or her own risk.