

CASE OWNER

CC<sup>3</sup> / CTI1800LKK  
IDAC

Surveyor:

DOI:

Date / Time:

Registered in Merimen:

Pre-assign / CCU / FTE



Insured Vehicle No.:

Name of Insured:

Insured Tel No.:

Excess Sec II :SS

Is driver the owner?

( YES / NO )

Nature of Accident:

If NO, Driver Name / Age:

Driver Tel No.:

(V/L: YES / NO)

Claim No.:

Policy No.:

Make / Model:

Place of Accident:

OI GIA REPORT: YES / NO ; TP GIA REPORT: YES / NO

Insured Liability: % Final ? Yes / No



INSRS:

WSP:

Tel:

Liability:

RMKS:



INSRS:

WSP:

Tel:

Liability:

RMKS:



INSRS:

WSP:

Tel:

Liability:

RMKS:



INSRS:

WSP:

Tel:

Liability:

RMKS:

Date/ Time

STAGE

DATE / PIC

Non-Reporting Itr (1st):

Non-Reporting Itr (2nd):

Non-Reporting Itr (Final):

Notification Itr (if non-pickup):

Call OI:

After call Itr to OI:

Documentation Check List: Handler Typist

Notification Itr (if non-pickup)

After call Itr to OI:

Authorisation To Act:

Release Voucher:

Final Repair Bill:

Car Rental Invoice:

Towing Invoice:

LTA / GIA:

Medical Bill:

PIR:

Mandate/Reject Instruction:

LOD

Payment Breakdown Form:

Post-Repair Photos:

Others:

PRELIMINARY ADVICE

Date/Time:

Sent By:

FINALIZATION

Date/Time:

Confirm with:

Confirm by:

Repair Cost:

SS

G.850.00 ( 5

days)

Reduction:

11

%

Email

Call

FINAL SETTLEMENT

Date/Time:

Confirm with:

Email

Call

Final Liability:

%

(Agreed / Assessed) BOLA S/N No.:

If NO or B 28, Ass. Lia:

Repair Cost:

SS

Loss of Rental (LOR):

SS

( \$ x days)

Loss of Use (LOU):

SS

( \$ x days)

Loss of Income (LOI):

SS

( \$ x days)

LOR only ☐ LOU only ☐LOR + LOU ☐LOR + LOI ☐

(Tick only one)

GIA/LTA Search:

SS

Medical:

SS

Disbursement:

SS

Legal Cost:

SS

Total:

SS

Global Sum SS:

FINAL PAYMENT

Date/Time:

Confirm with:

Email

Call

Payee 1:

SS

Name 1:

Payee 2: (Strike if N.A.):

SS

Name 2:

Payee 3: (Strike if N.A.):

SS

Name 3:

1) Claim status: N- / Rejec / Private Settle

2) Report Format:

3) Survey fee:

\$350





# LKK Auto Consultants Pte Ltd

51 Ubi Ave 1 #01-25 Paya Ubi Industrial Park, Singapore 408933

TEL: 6256 3561 FAX: 6256 4315

Reg. No: 199607198R GST Reg. No. 19-9607198-R

Affiliated to Federation Internationale Des Experts En Automobile				
CHINA TAIPING INSURANCE (S) PTE LTD			Ref : CC3/CTI18009135/Sub3	
3 ANSON ROAD #16-00 SPRINGLEAF TOWERS SINGAPORE 079909			Date : 21-05-2018	
			Code : CTI	
<b>1. Policy Particulars :- THIRD PARTY CLAIM</b>				
Insured Veh.	YN 3424X	Veh. Inspected	TIB 1169Z	
Policy No.		Coverage (\$)	0.00	
Claim No.		Excess (\$)	0.00	
Assign From		Assign Date	21/05/2018	
<b>2. Vehicle Particulars &amp; Condition</b>				
Make & Model		c.c	0	
Engine No.	HIDDEN	Year of Reg.		
Chassis No.		Colour		
Odometer	-	Steering		
Brakes		Modification		
General				
<b>3. Conditions of Tyres</b>				
	Size	Make	Balance	
R/H Front Tyre			mm	
L/H Front Tyre			mm	
R/H Rear Tyre			mm	
L/H Rear Tyre			mm	
<b>4. Description of Damages</b>				
<b>5. General Information</b>				
Accident Date	12/05/2018	Inspection Date	16/05/2018	
Survey held at	SMRT AUTOMOTIVE SERVICES PTE LTD 60 WOODLANDS INDUSTRIAL PARK E4 SINGAPORE 757705			
<b>5a. Remarks</b>				
A) THE INSPECTION WAS CONDUCTED ON A "WITHOUT PREJUDICE" BASIS. B) IN ACCORDANCE TO YOUR INSTRUCTIONS, WE HAVE NOT AUTHORISED REPAIRS.				



Auto  
Consultants  
Pte Ltd

Company Registration No. 199607198R

51 UBI AVE 1, #02-25 PAYA UBI INDUSTRIAL PARK, SINGAPORE 408933 TEL: (065) 62563561 FAX: (065) 62563313

Your ref: To Be Advised  
Our ref: CC3/CTI18009135/Sub3

Date: 21.05.2018

The Motor Claims Department  
M/s CHINA TAIPING INSURANCE (S) PTE LTD

Dear Sir/Madam,

**PRELIMINARY ADVICE OF VEHICLE NO.**

**TIB1169Z**

We refer to the above matter.

Please be informed that we had conducted the inspection of the above mentioned vehicle on 16.05.2018 at the premises of M/s SMRT Automotive Services Pte Ltd and have the following to report:-

Workshop Estimate Amount	: S\$	8,433.44
Revised Estimate Amount	: S\$	7,637.44
"Check" Items Amount	: S\$	-
Market Value	: S\$	-
LTA Reimbursement Value	: S\$	-
Nett Value	: S\$	-

**Description of Damage:**

The vehicle sustained damages at the  
N/S Portion



**Comments/Present Status:**

Damages Consistent

Estimated normal period for repairs: 5 days

Yours faithfully,

SEBASTIAN YEANG  
Licensed Appraiser

## SMRT Accident Vehicle Repair Estimates

### Section A - To be completed by claims Advisor/Duty officer at Accident Reporting Centre

Reg. No : TIB1169Z  
 Ref. No : BUS/05/18/1014  
 Reg. Date : 02/08/2001  
 Vehicle Type : BUS -17M  
 Make : MB0405G 17M (MERCEDES)  
 Model : MERCEDES 0405G  
 Name of Driver : Che Wanliang  
 Type of Accident : SIDE SWIPE  
 Date / Time of Accident : 12/05/2018 06:30:00 AM  
 Accident Reported Date / Time : 14/05/2018 12:00:00 AM  
 Surveyor is Required? : Yes  
 Survey by : China Tai Ping  
 Vehicle is Towed Back? : No  
 Towed Back Date/Time :  
 Replacement Vehicle issued? : No  
 Accident Repair Job Card No : 000024096090  
 Special Instruction to ARC,if any :  
 TIB1169Z - LEFT CENTRE PORTION  
 YN3424X (TP) - INSURED WITH CHINA  
 Prepared Date : 15/05/2018 10:26:39 AM

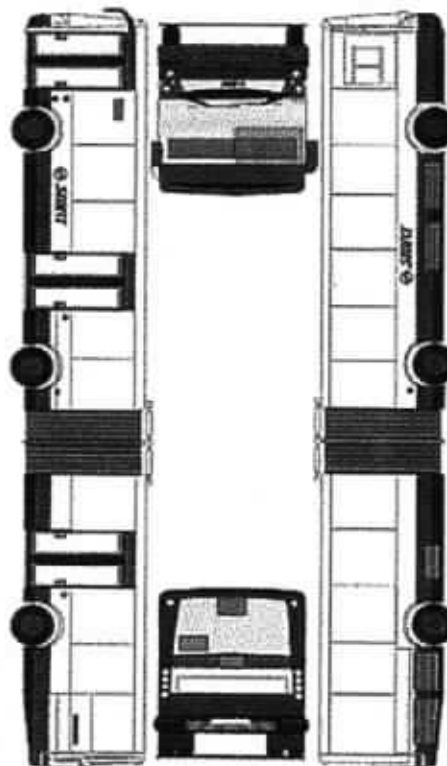

Finalized

- Ng2

**Section B - To be Completed by Service Advisor, Accident Repair Centre**

Chassis No : WEB61232321098319

Mileage : 0

Work Shop :

Repair Completed Date / Time : 01/01/2000

**Summary of Repair Estimates**

	Quotation from ARC	Adjusted by Surveyor, if applicable
Total Labour Charges	: 3,180.00	2,650.00
Total Spray Painting Charges	: 1,466.00	1,200.00
Total Material Charges	: 3,021.95	3,021.95
Other Charges	: 0.00	0.00
<b>TOTAL</b>	<b>: 7,667.95</b>	<b>6,871.95</b>
<b>Lump Sum Total</b>	<b>: 7,650.00</b>	<b>6,850.00</b>
No. of Repair Days	: 6.00	5.00
Prepared / Adjusted By	: Sunny Tan Ah Leong	SEBASTIAN LKK
Arc / Surveyor Sign Off Date	: 16/05/2018 10:15:23 AM	25/06/2018 08:32:14 AM



Prepared / Adjusted Date :

Remarks :

Prepared Date : 16/05/2018 09:08:16 AM

**Section C - To be Completed by Admin Assistant, Accident Repair Centre, Upon Completion of Repair**

Quotation No :	Invoice No :
Quotation Date :	Invoice Date :
Invoice Amount :	Prepared Date :

**Section D - Details of Repair Estimates****Part 1 - Labour Works**

Job Scope	Quotation from ARC	Adjusted by Surveyor, if applicable
TO REMOVE & INSTALL ALL ABOVE ITEMS AND REPAIR OTHERS DAMAGED AFFECTED AREAS.	3,180.00	2,650.00 ✓
<b>Total Labour</b>	<b>3,180.00</b>	<b>2,650.00</b>

**Part 2 - Spray Painting & Panel Beating Related Works**

Job Scope	Quotation from ARC	Adjusted by Surveyor, if applicable
PROVIDE LABOUR AND MATERIAL TO PUTTY AND RESPRAY ABOVE REPAIR ITEMS	1,466.00	1,200.00 ✓
<b>Total Spray Painting &amp; Panel Beating</b>	<b>1,466.00</b>	<b>1,200.00</b>

**Part 3 - Other Costs - Accident and Accident Repair Related Expenses**

Job Scope	Quotation from ARC	Adjusted by Surveyor, if applicable
<b>Total Other Costs</b>		

**Part 4 - Spare Parts / Material Usage**

Part Number	Portion	Stock No	Part Name	Qty	List Price (\$)	Discount (%)	Final Price (\$)	ARC Recommendation	Surveyor Approved	Photos Attached
4515724002	COMMO N	6008141	SIDE GLASS#2 1295X1480X5	1	1,975.80	10.00	1,778.22	Replace	Replace	No / CRK
	COMMO N	6008143	SIDE WINDOW GLASS	1	1,140.26	10.00	1,026.23	Replace	Replace	No / NEK
	COMMO N	4006314	SEALANT SIKAFLEX	16	37.00	0.00	592.00	Replace	Replace	No / NEK
		4006315	ACTIVATOR	2	80.00	0.00	160.00	Replace	Replace	No / NEK
	COMMO N	4006313	PRIMER	2	80.00	0.00	160.00	Replace	Replace	No / NEK
4879739696	VE	6004577	SIGNAL LIGHT	1	62.21	10.00	55.99	Replace	Replace	No / CRK
		4	60KM/H STICKER	1	5.00	0.00	5.00	Replace	Replace	No / NEK
<b>TOTAL MATERIALS</b>							<b>3,777.44</b>	<b>3,777.44</b>		
<b>TOTAL MATERIALS(Discounted)</b>							<b>3,021.95</b>	<b>3,021.95</b>		

**Added Spare Parts / Material Usage After Surveyor Signed off**

Part Number	Portion	Part Name	Qty	List Price (\$)	Discount (%)	Final Price (\$)	ARC Check	Surveyor Check	LT Check
<b>TOTAL SUPPLEMENTARY MATERIALS</b>									

PARTS \$3,777.44  
 LESS 2% LIS \$30.22  
 LABOUR \$2,650  
 SPRAY \$1,200  
 TOTAL \$6,871.95  
 LIS TOTAL \$6,850.00

CONFIRMED LUMP SUM TOTAL \$6,850.00 / 5 DAYS

NAZ CRK  
 7/1



## SMRT Accident Vehicle Repair Estimates

### Section A - To be completed by claims Advisor/Duty officer at Accident Reporting Centre

Reg. No : TIB1169Z  
Ref. No : BUS/05/18/1014  
Reg. Date : 02/08/2001  
Vehicle Type : BUS -17M  
Make : MB0405G 17M (MERCEDES)  
BENDY  
Model : MERCEDES 0405G  
Name of Driver : Che Wanliang  
Type of Accident : SIDE SWIPE  
Date / Time of Accident : 12/05/2018 06:30:00 AM  
Accident Reported Date / Time : 14/05/2018 12:00:00 AM  
Surveyor is Required? : Yes  
Survey by : China Tai Ping  
Vehicle is Towed Back? : No  
Towed Back Date/Time :  
Replacement Vehicle issued? : No  
Accident Repair Job Card No : 000024096090  
Special Instruction to ARC,if any :  
TIB1169Z - LEFT CENTRE PORTION  
YN3424X (TP) - INSURED WITH CHINA  
Prepared Date : 15/05/2018 10:26:39 AM

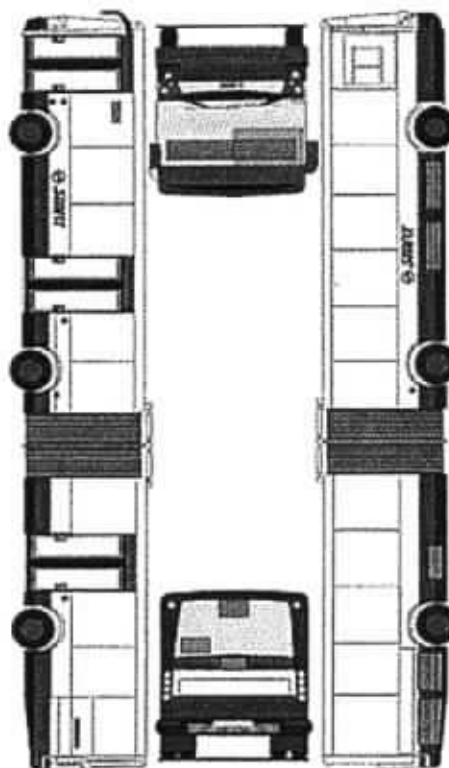

**Section B - To be Completed by Service Advisor, Accident Repair Centre**

Chassis No : WEB61232321098319

Mileage : 0

Work Shop :

Repair Completed Date / Time : 01/01/2000

**Summary of Repair Estimates**

	Quotation from ARC	Adjusted by Surveyor, if applicable
Total Labour Charges	: 3,180.00	2,650.00
Total Spray Painting Charges	: 1,466.00	1,200.00
Total Material Charges	: 3,021.95	3,021.95
Other Charges	: 0.00	0.00
<b>TOTAL</b>	<b>: 7,667.95</b>	<b>6,871.95</b>
<b>Lump Sum Total</b>	<b>: 7,650.00</b>	<b>6,850.00</b>
No. of Repair Days	: 6.00	5.00
Prepared / Adjusted By	: Sunny Tan Ah Leong	SEBASTIAN LKK
Arc / Surveyor Sign Off Date	: 16/05/2018 10:15:23 AM	25/06/2018 08:32:14 AM



Prepared / Adjusted Date :

Remarks :

Prepared Date : 16/05/2018 09:08:16 AM

**Section C - To be Completed by Admin Assistant, Accident Repair Centre, Upon Completion of Repair**

Quotation No :	Invoice No :
Quotation Date :	Invoice Date :
Invoice Amount :	Prepared Date :

**Section D - Details of Repair Estimates****Part 1 - Labour Works**

Job Scope	Quotation from ARC	Adjusted by Surveyor, if applicable
TO REMOVE & INSTALL ALL ABOVE ITEMS AND REPAIR OTHERS DAMAGED AFFECTED AREAS.	3,180.00	2,650.00
<b>Total Labour</b>	<b>3,180.00</b>	<b>2,650.00</b>

**Part 2 - Spray Painting & Panel Beating Related Works**

Job Scope	Quotation from ARC	Adjusted by Surveyor, if applicable
PROVIDE LABOUR AND MATERIAL TO PUTTY AND RESPRAY ABOVE REPAIR ITEMS	1,466.00	1,200.00
<b>Total Spray Painting &amp; Panel Beating</b>	<b>1,466.00</b>	<b>1,200.00</b>

**Part 3 - Other Costs - Accident and Accident Repair Related Expenses**

Job Scope	Quotation from ARC	Adjusted by Surveyor, if applicable
<b>Total Other Costs</b>		

**Part 4 - Spare Parts / Material Usage**

Part Number	Portion	Stock No	Part Name	Qty	List Price (\$)	Discount (%)	Final Price (\$)	ARC Recommended	Surveyor Approved	Photos Attached
4515724002	COMMO N	6008141	SIDE GLASS#2 1295X1480X5	1	1,975.80	10.00	1,778.22	Replace	Replace	No
	COMMO N	6008143	SIDE WINDOW GLASS	1	1,140.26	10.00	1,026.23	Replace	Replace	No
	COMMO N	4006314	SEALANT SIKAFLEX	16	37.00	0.00	592.00	Replace	Replace	No
		4006315	ACTIVATOR	2	80.00	0.00	160.00	Replace	Replace	No
	COMMO N	4006313	PRIMER	2	80.00	0.00	160.00	Replace	Replace	No
4879739696	VE	6004577	SIGNAL LIGHT	1	62.21	10.00	55.99	Replace	Replace	No
		4	60KM/H STICKER	1	5.00	0.00	5.00	Replace	Replace	No
<b>TOTAL MATERIALS</b>							<b>3,777.44</b>	<b>3,777.44</b>		
<b>TOTAL MATERIALS(Discounted)</b>							<b>3,021.95</b>	<b>3,021.95</b>		

**Added Spare Parts / Material Usage After Surveyor Signed off**

Part Number	Portion	Part Name	Qty	List Price (\$)	Discount (%)	Final Price (\$)	ARC Check	Surveyor Check	LT Check
<b>TOTAL SUPPLEMENTARY MATERIALS</b>									

PARTS AFTER 10% . \$3,777.44  
 PARTS AFTER 20% LUMP SUM \$3,021.95  
 LABOUR \$3,850  
 TOTAL \$6,871.95  
 LUMP SUM TOTAL \$6,850

CONFIRMED LUMP SUM REPAIR \$6,850/5 DAYS

## SMRT Accident Vehicle Repair Estimates

### Section A - To be completed by claims Advisor/Duty officer at Accident Reporting Centre

Reg. No : TIB1169Z  
 Ref. No : BUS/05/18/1014  
 Reg. Date : 15/05/2018  
 Vehicle Type : BUS -17M  
 Make : MB0405G 17M (MERCEDES)  
 BENDY  
 Model : MERCEDES 0405G  
 Name of Driver : Che Wanliang  
 Type of Accident : SIDE SWIPE  
 Date / Time of Accident : 12/05/2018 06:30:00 AM  
 Accident Reported Date / Time : 14/05/2018 12:00:00 AM  
 Surveyor is Required? : Yes  
 Survey by : China Tai Ping  
 Vehicle is Towed Back? : No  
 Towed Back Date/Time :  
 Replacement Vehicle issued? : No  
 Accident Repair Job Card No :  
 Special Instruction to ARC, if any :  
 TIB1169Z - LEFT CENTRE PORTION  
 YN3424X (TP) - INSURED WITH CHINA  
 Prepared Date : 15/05/2018 10:26:39 AM

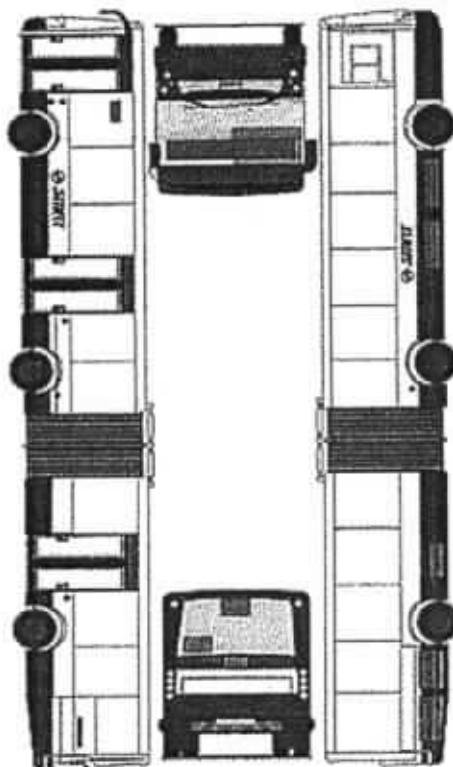

Sebastian.  
 16/5/18.

- Lump Sum Repair.  
 - Photo After Paint.

#### LKK Auto Consultants hence notify the Repairer of the following:

- To resurvey before/after spray painting
- To display damaged part(s) during resurvey
- Parts prices are subject to confirmation
- Third party survey is on a "Without Prejudice" basis
- No illegal modification(s) is allowed
- Supplementary item(s) must be resurveyed and is subject to final approval from Insurance Company

Acknowledged by Repairer

Signature:

Date:

Chassis No : Mileage : 0  
Work Shop : Repair Completed Date / Time :

**Summary of Repair Estimates**

	Quotation from ARC	Adjusted by Surveyor, if applicable
Total Labour Charges :	3,180.00	0.00
Total Spray Painting Charges :	1,466.00	0.00
Total Material Charges :	3,787.44	3,787.44
Other Charges :	0.00	0.00
<b>TOTAL :</b>	<b>8,433.44</b>	<b>0.00</b>
<b>Lum Sum Total :</b>	<b>8,450.00</b>	<b>0.00</b>
No. of Repair Days :	6.00	0.00 5 days
Prepared / Adjusted By :	Sunny Tan Ah Leong	
Arc / Surveyor Sign Off Date :	16/05/2018 10:15:23 AM	01/01/1900 12:00:00 AM



Prepared / Adjusted Date :

Remarks :

Prepared Date : 16/05/2018 09:08:16 AM

**Section C - To be Completed by Admin Assistant, Accident Repair Centre, Upon Completion of Repair**

Quotation No :	Invoice No :
Quotation Date :	Invoice Date :
Invoice Amount :	Prepared Date :

Part 1 - Labour Works

Job Scope	Quotation from ARC	Adjusted by Surveyor, if applicable
TO REMOVE & INSTALL ALL ABOVE ITEMS AND REPAIR OTHERS DAMAGED AFFECTED AREAS.	3,180.00	<del>0.00</del> 2650
Total Labour	3,180.00	0.00

Part 2 - Spray Painting & Panel Beating Related Works

Job Scope	Quotation from ARC	Adjusted by Surveyor, if applicable
PROVIDE LABOUR AND MATERIAL TO PUTTY AND RESPRAY ABOVE REPAIR ITEMS	1,466.00	<del>0.00</del> 1200
Total Spray Painting & Panel Beating	1,466.00	0.00

Part 3 - Other Costs - Accident and Accident Repair Related Expenses

Job Scope	Quotation from ARC	Adjusted by Surveyor, if applicable
Total Other Costs		

Part 4 - Spare Parts / Material Usage

Part Number	Portion	Stock No	Part Name	Qty	List Price (\$)	Discount (%)	Final Price (\$)	ARC Recommended	Surveyor Approved	Photos Attached
1515724012	COMMO N	6008141	SIDE GLASS#2 1295X1480X5	1	1,975.80	10.00	1,778.22	Replace	Replace ✓	No <del>CHK</del>
	COMMO N	6008143	SIDE WINDOW GLASS	1	1,140.26	10.00	1,026.23	Replace	Replace ✓	No
	COMMO N	4006314	SEALANT SIKAFLEX	16	37.00	0.00	592.00	Replace	Replace ✓	No <del>NEC</del>
		4006315	ACTIVATOR	2	80.00	0.00	160.00	Replace	Replace ✓	No
	COMMO N	4006313	PRIMER	2	80.00	0.00	160.00	Replace	Replace ✓	No
87973986	VE	6004577	SIGNAL LIGHT	1	62.21	10.00	55.99	Replace	Replace ✓	No <del>CHK</del>
		4	60KM/H STICKER	1	15.00	0.00	15.00	Replace	Replace ✓	No <del>NEC</del>
TOTAL MATERIALS							3,787.44	3,787.44		
TOTAL MATERIALS(Discounted)							3,787.44	3,787.44		

Added Spare Parts / Material Usage After Surveyor Signed off

Part Number	Portion	Part Name	Qty	List Price (\$)	Discount (%)	Final Price (\$)	ARC Check	Surveyor Check	LT Check
TOTAL SUPPLEMENTARY MATERIALS									

PARTS LESS 10%      \$3,787.44  
LABOUR                \$3,850  
TOTAL                   \$7,637.44  
LUMP SUM



## SMRT Accident Vehicle Repair Estimates

### Section A - To be completed by claims Advisor/Duty officer at Accident Reporting Centre

Reg. No : TIB1169Z  
 Ref. No : BUS/05/18/1014  
 Reg. Date : 02/08/2001  
 Vehicle Type : BUS -17M  
 Make : MB0405G 17M (MERCEDES)  
 Model : MERCEDES 0405G  
 Name of Driver : Che Wanliang  
 Type of Accident : SIDE SWIPE  
 Date / Time of Accident : 12/05/2018 06:30:00 AM  
 Accident Reported Date / Time : 14/05/2018 12:00:00 AM  
 Surveyor is Required? : Yes  
 Survey by : China Tai Ping  
 Vehicle is Towed Back? : No  
 Towed Back Date/Time :  
 Replacement Vehicle issued? : No  
 Accident Repair Job Card No : 000024096090  
 Special Instruction to ARC,if any :  
 TIB1169Z - LEFT CENTRE PORTION  
 YN3424X (TP) - INSURED WITH CHINA  
 Prepared Date : 15/05/2018 10:26:39 AM

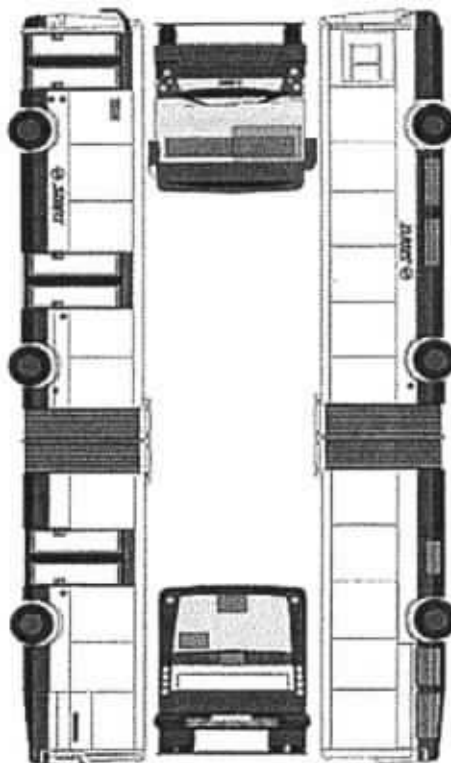

**Section B - To be Completed by Service Advisor, Accident Repair Centre**

Chassis No : WEB61232321098319

Mileage

0

Work Shop :

Repair Completed Date / Time :

01/01/2000

**Summary of Repair Estimates**

	Quotation from ARC	Adjusted by Surveyor, if applicable
Total Labour Charges	: 3,180.00	2,650.00
Total Spray Painting Charges	: 1,466.00	1,200.00
Total Material Charges	: 3,021.95	3,021.95
Other Charges	: 0.00	0.00
<b>TOTAL</b>	<b>: 7,667.95</b>	<b>6,871.95</b>
<b>Lump Sum Total</b>	<b>: 7,650.00</b>	<b>6,850.00</b>
No. of Repair Days	: 6.00	5.00
Prepared / Adjusted By	: Sunny Tan Ah Leong	SEBASTIAN LKK
Arc / Surveyor Sign Off Date	: 16/05/2018 10:15:23 AM	25/06/2018 08:32:14 AM



Prepared / Adjusted Date :

Remarks :

Prepared Date : 16/05/2018 09:08:16 AM

**Section C - To be Completed by Admin Assistant, Accident Repair Centre, Upon Completion of Repair**

Quotation No :

Invoice No :

Quotation Date :

Invoice Date :

Invoice Amount :

Prepared Date :

**Section D - Details of Repair Estimates**

**Part 1 - Labour Works**

Job Scope	Quotation from ARC	Adjusted by Surveyor, if applicable
TO REMOVE & INSTALL ALL ABOVE ITEMS AND REPAIR OTHERS DAMAGED AFFECTED AREAS.	3,180.00	2,650.00
<b>Total Labour</b>	<b>3,180.00</b>	<b>2,650.00</b>

**Part 2 - Spray Painting & Panel Beating Related Works**

Job Scope	Quotation from ARC	Adjusted by Surveyor, if applicable
PROVIDE LABOUR AND MATERIAL TO PUTTY AND RESPRAY ABOVE REPAIR ITEMS	1,466.00	1,200.00
<b>Total Spray Painting &amp; Panel Beating</b>	<b>1,466.00</b>	<b>1,200.00</b>

**Part 3 - Other Costs - Accident and Accident Repair Related Expenses**

Job Scope	Quotation from ARC	Adjusted by Surveyor, if applicable
<b>Total Other Costs</b>		

Part 4 - Spare Parts / Material Usage

Part Number	Portion	Stock No	Part Name	Qty	List Price (\$)	Discount (%)	Final Price (\$)	ARC Recommendation	Surveyor Approved	Photos Attached
4515724002	COMMON	6008141	SIDE GLASS#2 1295X1480X5	1	1,975.80	10.00	1,778.22	Replace	Replace	No
	COMMON	6008143	SIDE WINDOW GLASS	1	1,140.26	10.00	1,026.23	Replace	Replace	No
	COMMON	4006314	SEALANT SIKAFLEX	16	37.00	0.00	592.00	Replace	Replace	No
		4006315	ACTIVATOR	2	80.00	0.00	160.00	Replace	Replace	No
	COMMON	4006313	PRIMER	2	80.00	0.00	160.00	Replace	Replace	No
4879739696	VE	6004577	SIGNAL LIGHT	1	62.21	10.00	55.99	Replace	Replace	No
		4	60KM/H STICKER	1	5.00	0.00	5.00	Replace	Replace	No
TOTAL MATERIALS							3,777.44	3,777.44		
TOTAL MATERIALS(Discounted)							3,021.95	3,021.95		

Added Spare Parts / Material Usage After Surveyor Signed off

Part Number	Portion	Part Name	Qty	List Price (\$)	Discount (%)	Final Price (\$)	ARC Check	Surveyor Check	LT Check
TOTAL SUPPLEMENTARY MATERIALS									

## SMRT Accident Vehicle Repair Estimates

### Section A - To be completed by claims Advisor/Duty officer at Accident Reporting Centre

Reg. No : TIB1169Z  
 Ref. No : BUS/05/18/1014  
 Reg. Date : 15/05/2018  
 Vehicle Type : BUS -17M  
 Make : MB0405G 17M (MERCEDES)  
 Model : MERCEDES 0405G  
 Name of Driver : Che Wanliang  
 Type of Accident : SIDE SWIPE  
 Date / Time of Accident : 12/05/2018 06:30:00 AM  
 Accident Reported Date / Time : 14/05/2018 12:00:00 AM  
 Surveyor is Required? : Yes  
 Survey by : China Tai Ping  
 Vehicle is Towed Back? : No  
 Towed Back Date/Time :  
 Replacement Vehicle issued? : No  
 Accident Repair Job Card No :  
 Special Instruction to ARC,if any :  
 TIB1169Z - LEFT CENTRE PORTION  
 YN3424X (TP) - INSURED WITH CHINA  
 Prepared Date : 15/05/2018 10:26:39 AM

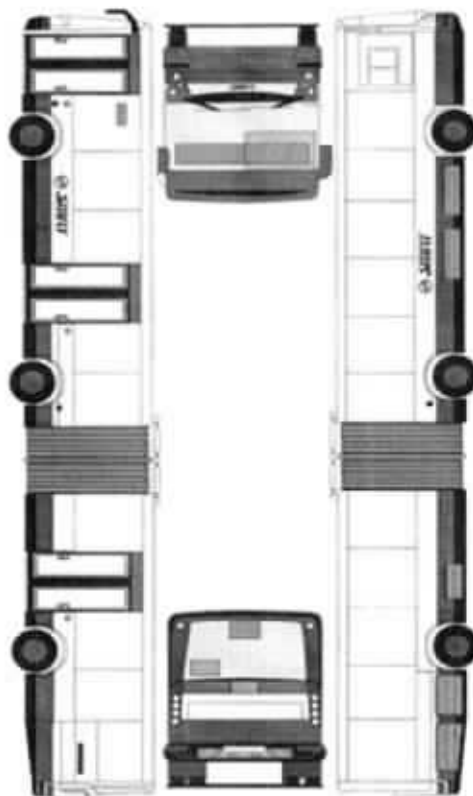

Sebastian  
 16/5/18

- Long Sun Repair  
 - Photo After Paint

LKK Auto Consultants hence notify the Repairer of the following:

- To resurvey before/after spray painting
- To display damaged part(s) during resurvey
- Parts prices are subject to confirmation
- Third party survey is on a "Without Prejudice" basis
- No illegal modification(s) is allowed
- Supplementary item(s) must be resurveyed and is subject to final approval from Insurance Company

Acknowledged by Repairer

Signature:

Date:

**Section B - To be Completed by Service Advisor, Accident Repair Centre**

Chassis No : Mileage : 0  
Work Shop : Repair Completed Date / Time :

**Summary of Repair Estimates**

	Quotation from ARC	Adjusted by Surveyor, if applicable
Total Labour Charges :	3,180.00	0.00
Total Spray Painting Charges :	1,466.00	0.00
Total Material Charges :	3,787.44	3,787.44
Other Charges :	0.00	0.00
<b>TOTAL :</b>	<b>8,433.44</b>	<b>0.00</b>
<b>Lum Sum Total :</b>	<b>8,450.00</b>	<b>0.00</b>
No. of Repair Days :	6.00	0.00
Prepared / Adjusted By :	Sunny Tan Ah Leong	<i>Shay</i>
Arc / Surveyor Sing Off Date :	16/05/2018 10:15:23 AM	01/01/1900 12:00:00 AM



Prepared / Adjusted Date :

Remarks :

Prepared Date : 16/05/2018 09:08:16 AM

**Section C - To be Completed by Admin Assistant, Accident Repair Centre, Upon Completion of Repair**

Quotation No :	Invoice No :
Quotation Date :	Invoice Date :
Invoice Amount :	Prepared Date :

Section D - Details of Repair Estimates

Part 1 - Labour Works

Job Scope	Quotation from ARC	Adjusted by Surveyor, if applicable
TO REMOVE & INSTALL ALL ABOVE ITEMS AND REPAIR OTHERS DAMAGED AFFECTED AREAS.	3,180.00	0.00 2650
<b>Total Labour</b>	<b>3,180.00</b>	<b>0.00</b>

Part 2 - Spray Painting & Panel Beating Related Works

Job Scope	Quotation from ARC	Adjusted by Surveyor, if applicable
PROVIDE LABOUR AND MATERIAL TO PUTTY AND RESPRAY ABOVE REPAIR ITEMS	1,466.00	0.00 1200
<b>Total Spray Painting &amp; Panel Beating</b>	<b>1,466.00</b>	<b>0.00</b>

Part 3 - Other Costs - Accident and Accident Repair Related Expenses

Job Scope	Quotation from ARC	Adjusted by Surveyor, if applicable
<b>Total Other Costs</b>		

Part 4 - Spare Parts / Material Usage

Part Number	Portion	Stock No	Part Name	Qty	List Price (\$)	Discount (%)	Final Price (\$)	ARC Recommendation	Surveyor Approved	Photos Attached
51572402	COMMON	6008141	SIDE GLASS#2 1295X1480X5	1	1,975.80	10.00	1,778.22	Replace	Replace ✓	No <i>CHK</i>
	COMMON	6008143	SIDE WINDOW GLASS	1	1,140.26	10.00	1,026.23	Replace	Replace ✓	No
	COMMON	4006314	SEALANT SIKAFLEX	16	37.00	0.00	592.00	Replace	Replace ✓	No <i>NEC</i>
		4006315	ACTIVATOR	2	80.00	0.00	160.00	Replace	Replace ✓	No
	COMMON	4006313	PRIMER	2	80.00	0.00	160.00	Replace	Replace ✓	No
87973966	VE	6004577	SIGNAL LIGHT	1	62.21	10.00	55.99	Replace	Replace ✓	No <i>CHK</i>
		4	60KM/H STICKER	1	15.00	0.00	15.00	Replace	Replace ✓	No <i>NEC</i>
TOTAL MATERIALS							3,787.44	3,787.44		
TOTAL MATERIALS(Discounted)							3,787.44	3,787.44		

Added Spare Parts / Material Usage After Surveyor Signed off

Part Number	Portion	Part Name	Qty	List Price (\$)	Discount (%)	Final Price (\$)	ARC Check	Surveyor Check	LT Check
TOTAL SUPPLEMENTARY MATERIALS									





Auto  
Consultants  
Pte Ltd

51 UBI AVE 1, #01-25 PAYA UBI INDUSTRIAL PARK, SINGAPORE 408933 TEL : (065) 62563561 FAX : (065) 62564315

**Our Ref: CC3/CTI18009135/Shb3**

04 DECEMBER 2018

**M/s QUN HAN CONSTRUCTION PTE LTD**  
2 JALAN GAJUS  
SINGAPORE 438490  
ATTN: THE MANAGEMENT

**By Post and By Email**

Dear Sir/Madam,

**ACCIDENT INVOLVING YN 3424X AND TIB 1169Z ON 12/05/2018**

We refer to the above accident where we are acting for China Taiping Insurance (Singapore) Pte Ltd to resolve the claim against you and/or your authorized driver under the Auto Insurance policy taken up with them.

Kindly note that we have reviewed this matter and would like to advise that you and/or your authorized driver may not be absolved from blame for this accident.

If you have evidence/information to prove that we should not settle the third party claim, kindly let us have them in writing within the next 10 days i.e. by **14/12/2018**, after we shall proceed with negotiation with Third Party claimant on the **without prejudice basis** and any settlement should not bind any claims whatsoever by you/your driver against the other party's insurer arising from this particular accident.

Please call us if you have further queries.

Yours faithfully,

  
Vic Alpeh  
DID: 6841 2096  
FAX: 6741 4108  
Email: [vicalpeh@lkkauto.com](mailto:vicalpeh@lkkauto.com)

c.c. *China Taiping Insurance (Singapore) Pte Ltd*  
*(Motor Claims Dept)*  
[gfautomobile@singnet.com.sg](mailto:gfautomobile@singnet.com.sg)  
*(Email)*

**Vic (LKKAUTO)**

---

**From:** Vic (LKKAUTO)  
**Sent:** Tuesday, 4 December, 2018 3:25 PM  
**To:** gfautomobile@singnet.com.sg  
**Cc:** Admin A; Vic (LKKAUTO)  
**Subject:** Your Ref: YN 3424X\_ACCIDENT INVOLVING YN 3424X AND TIB 1169Z ON 12/05/2018



31 UBI AVE 1, #01-25 PAYA UBI INDUSTRIAL PARK, SINGAPORE 408933 TEL : (065) 62563561 FAX : (065) 62564315

**Our Ref: CC3/CTI18009135/Shb3**

04 DECEMBER 2018

**M/s QUN HAN CONSTRUCTION PTE LTD**  
2 JALAN GAJUS  
SINGAPORE 438490  
ATTN: THE MANAGEMENT

**By Post and By Email**

Dear Sir/Madam,

**ACCIDENT INVOLVING YN 3424X AND TIB 1169Z ON 12/05/2018**

We refer to the above accident where we are acting for China Taiping Insurance (Singapore) Pte Ltd to resolve the claim against you and/or your authorized driver under the Auto Insurance policy taken up with them.

Kindly note that we have reviewed this matter and would like to advise that you and/or your authorized driver may not be absolved from blame for this accident.

If you have evidence/information to prove that we should not settle the third party claim, kindly let us have them in writing within the next 10 days i.e. by **14/12/2018**, after we shall proceed with negotiation with Third Party claimant on the **without prejudice basis** and any settlement should not bind any claims whatsoever by you/your driver against the other party's insurer arising from this particular accident.

Please call us if you have further queries.

Best Regards,

**Vic Alpeh** | Case Handler

**LKK Auto Consultants Pte Ltd**

Phone: 6841-2096 | email: [vicalpeh@lkkauto.com](mailto:vicalpeh@lkkauto.com) | fax: 6741-4108

Blk 51, Paya Ubi Industrial Park, Ubi Avenue 1, #02-25 | S(408933)



*Save the Earth. Print only when necessary.*

This e-mail contain confidential and privileged material, and are for the sole use of the intended recipient. Use or distribution by an unintended recipient is prohibited, and may be a violation of law. If you believe that you received this e-mail in error, please do not read this e-mail or any attached items. Please delete the e-mail and all attachments, including any copies thereof, and inform the sender that you have deleted the e-mail, all attachments and any copies thereof. Thank you.

## Shu Pei (LKKAUTO)

---

**From:** Lucas Lee <luucas.lee@sg.cntaiping.com>  
**Sent:** Tuesday, 22 May 2018 9:01 AM  
**To:** Shu Pei (LKKAUTO)  
**Subject:** RE: Direct Settlement - Accident Involving YN3424X (OI : CTI - SNM18D02409C02) and TIB1169Z (TP : LKK REF - CC3/CTI18009135/Sub3) on 12.05.2018  
**Attachments:** LeeSZ\_SNM18D02409C01-YN3424X-LKKDirectSettlementAccidentLtr\_CLCR95.810.pdf; MCCA18062330-YN3424X.pdf

Dear Sirs,

Kindly refer to the above attachment.

Case Handler: Chong Boon Sen

**Lucas Lee**  
Claims Department (Motor)  
**China Taiping Insurance (Singapore) Pte. Ltd.**  
3 Anson Road #16-00 Springleaf Tower Singapore 079909  
Direct (65) 6389 6181  
Fax (65) 6222 7175  
Email: [luucas.lee@sg.cntaiping.com](mailto:luucas.lee@sg.cntaiping.com)  
Website: [www.sg.cntaiping.com](http://www.sg.cntaiping.com)



*Disclaimer:*

*This message is confidential; its contents do not constitute a commitment by China Taiping Insurance (Singapore) Pte. Ltd. except where provided for in a written agreement between you and China Taiping Insurance (Singapore) Pte. Ltd. Any unauthorized disclosure, use or dissemination, either in whole or partial, is prohibited. If you are not the intended recipient of the message, please notify the sender immediately.*

---

**From:** Shu Pei (LKKAUTO) [mailto:shupeil@lkkauto.com]  
**Sent:** Monday, 21 May, 2018 8:37 PM  
**To:** Claims Dept of CTI  
**Cc:** Lucas Lee; Chong Boon Sen; Admin A; Thin Thin (LKKAUTO)  
**Subject:** Direct Settlement - Accident Involving YN3424X (OI : CTI - TBA) and TIB1169Z (TP : LKK REF - CC3/CTI18009135/Sub3) on 12.05.2018

**WITHOUT PREJUDICE**

Dear Boon Sen,

We refer to the above matter.

This is a TP direct settlement case. We had inspected TP vehicle TIB 1169Z at M/s SMRT Automotive Services Pte Ltd.

Meanwhile, kindly let us have a copy of your insured's GIA report for our necessary action.

Enclosed for your perusal is:

- TP's GIA report
- Estimated cost of repair
- Preliminary advice

Our case handler in-charge is Thin Thin and she can be contacted at DID: 6841 2360.

Thank You.

Best Regards,

Shu Pei | Admin

LKK Auto Consultants Pte Ltd

Phone: 6366-0055 | email: [shupeil@lkkauto.com](mailto:shupeil@lkkauto.com) | fax: 6741-4108

Blk 51, Paya Ubi Industrial Park, Ubi Avenue 1, #02-25 | S(408933)

---

This email has been scanned by the Symantec Email Security.cloud service.  
For more information please visit <http://www.symanteccloud.com>

---



中国太平  
CHINA TAIPING

中国太平保险(新加坡)有限公司  
CHINA TAIPING INSURANCE (SINGAPORE) PTE. LTD

3 Anson Road #16-08 Springleaf Tower Singapore 079908  
Tel: 6389 6111 Fax: 6222 1033  
Website: www.cti.com.sg  
Co. Reg. No. 200008384E

Our Reference: **SNM18D02409/C01/4**

Date : **22 MAY 2018**

via Ordinary & Registered Mail

**QUN HAN CONSTRUCTION PTE LTD  
2 JALAN GAJUS**

**SINGAPORE 438490**

Dear Sir / Madam

**ACCIDENT INVOLVING YN3424X AND TIB1169Z ON 12 MAY 2018  
ALONG JUNCTION OF ROAD 1 & ROAD 2 SENOKO SOUTH ROAD TOWARD SENOKO DRIVE**

We refer to the abovementioned accident.

Please be advised that the third party vehicle, **TIB1169Z**, is filing a third party property claim against your vehicle.

We have appointed **LKK Auto Consultants Pte Ltd**, to administer the said claim on our behalf and they will contact you for more information about the accident.

Kindly render your assistance and co-operation accordingly.

Yours truly,

Claims Department

*(This is a computer generated letter and no signature is required.)*

CC : LKK Auto Consultants Pte Ltd

Attn : THIN THIN

Ref : CC3/CTI18009135/SUB3

Contact No : 68412360

via Email : THINTHIN@LKKAUTO.COM

CC : Agent - (AN0478A) - INSURE HUB PTE LTD

F01/LKKDS-2013

## Khanchna (LKK Auto)

**From:** Claims Dept of CTI <claimsdept@sg.cntaiping.com>  
**Sent:** Tuesday, 6 August 2019 6:19 PM  
**To:** Khanchna (LKK Auto); Admin A  
**Cc:** Alfred Toh; Chee So Chow; Hsiao Tong (LKKAuto)  
**Subject:** SEEK INSTRUCTION/APPROVAL TO REJECT TP CLAIM (ACCIDENT INVOLVING YN 3424X (CTI: SNM18D02409C02 ) & TIB 1169Z (TP) ON 12/05/2018)  
**Attachments:** YN3424X DV.pdf; PIR.pdf

LKK Ref: CC3/CTI18009135/Skb3  
CTPIS Ref: SNM18D02409C02/4(cbs)

Dear Khanchna

We refer to your email of even date pertaining to the above matter.

Please proceed to reject the third party property claim based on the information received.

p.s *Boon Sen is currently Outstation*

Best Regards

Alfred Toh  
Senior Executive  
Claims Department  
China Taiping Insurance (Singapore) Pte. Ltd.  
3 Anson Road #XX-00 Springleaf Tower Singapore 079909  
DID : (65) 6389 6183  
FAX: (65) 6224 7478  
W: [www.sg.cntaiping.com](http://www.sg.cntaiping.com) | FB: [www.facebook.com/chinataipingsg/](https://www.facebook.com/chinataipingsg/) | WeChat: 太平獅城 Taiping SG

*Disclaimer: This e-mail and any files transmitted with it is intended only for the named recipients and may contain confidential information. Any unauthorized disclosure, use or dissemination of this message, either in whole or partial, is prohibited. If you are not the intended recipient, please notify the sender immediately. Please delete the e-mail and any copies of it thereafter.*

**From:** Khanchna (LKK Auto) [mailto:khanchna@lkkauto.com]  
**Sent:** Tuesday, 6 August, 2019 5:30 PM  
**To:** Claims Dept of CTI <claimsdept@sg.cntaiping.com>; Alfred Toh <alfred.toh@sg.cntaiping.com>  
**Cc:** Admin A <admin-a@lkkauto.com>  
**Subject:** SEEK INSTRUCTION/APPROVAL TO REJECT TP CLAIM (ACCIDENT INVOLVING YN 3424X (CTI: SNM18D02409C02 ) & TIB 1169Z (TP) ON 12/05/2018)

Your Ref: SNM18D02409C02  
Our Ref: CC3/CTI18009135/Skb3

Dear Sir/Madam,

The above matter refers.

## **Khanchna (LKK Auto)**

---

**From:** Khanchna (LKK Auto)  
**Sent:** Tuesday, 6 August 2019 5:30 PM  
**To:** 'claimsdept@sg.cntaiping.com'; Alfred Toh  
**Cc:** Admin A  
**Subject:** SEEK INSTRUCTION/APPROVAL TO REJECT TP CLAIM (ACCIDENT INVOLVING YN 3424X (CTI: SNM18D02409C02 ) & TIB 1169Z (TP) ON 12/05/2018)  
**Attachments:** YN3424X DV.pdf; PIR.pdf

Tracking:	Recipient	Delivery
	'claimsdept@sg.cntaiping.com'	
	Alfred Toh	
	Admin A	
	olivialau@lkkauto.com	Delivered: 6/8/2019 5:30 PM
	Meikwan@lkkauto.com	Delivered: 6/8/2019 5:30 PM
	shupei@lkkauto.com	Delivered: 6/8/2019 5:30 PM

Your Ref: SNM18D02409C02  
Our Ref: CC3/CTI18009135/Skb3

Dear Sir/Madam,

The above matter refers.

Kindly be informed that we was informed from our Insured's workshop that our Insured's counter claim against Third party was successful (as attached).

Based on the documents at hand, we opine that the liability is down against the Third party as the police investigation result (as attached) is against Third party under S.65(b) RTA for inconsiderate driving.

As such, we intend to reject the Third party's claim against our Insured.

Appreciate your approval/instruction.

Thank you.

Best Regards,  
**Khanchna** | Case Handler  
**LKK Auto Consultants Pte Ltd**  
DID: 6841 2360 | email: [Khanchna@lkkauto.com](mailto:Khanchna@lkkauto.com) | Fax: 6741-4108  
Blk 51, Paya Ubi Industrial Park, Ubi Avenue 1, #02-25 | S(408933)





**SINGAPORE  
POLICE FORCE**

Traffic Police  
10 Ubi Avenue 3  
Singapore 408865  
Tel +65 6547 0000  
Fax +65 6547 6259  
www.police.gov.sg

Our Ref : TP/IP/28049/2018  
Date : 8 June, 2018

MUTHAIAH GANESAN  
421 TAGORE INDUSTRIAL AVE  
#03-20 TAGORE 8  
SINGAPORE 787805

Dear Sir/Madam

**ACCIDENT INVOLVING TIB1169Z AND YN3424X ON 12/05/2018 AT 0620 HRS, ALONG  
SENOKO SOUTH ROAD X SENOKO DRIVE**

I refer to the above accident.

2. Please be informed that we have completed our investigations which shows that the driver of TIB1169Z had committed an offence of Inconsiderate Driving under Section 65(b) of the Road Traffic Act Chapter 276. Action has been initiated against the said driver for the said offence.
3. If you have any queries, please contact the Investigation Officer, PHUA TIAK YEE ESMOND at telephone 65472077.

Yours faithfully

  
Juremah Ahmad SSI(2)  
For Head, Traffic Investigation  
Traffic Police  
Singapore Police Force

## Khanchna (LKK Auto)

---

**From:** Tan Lee Gek (Auto Svcs/Claims & IA/Claims & IA/Taxis) <LeeGek@smrt.com.sg>  
**Sent:** Thursday, 8 August 2019 5:23 PM  
**To:** Karen Chan Siau Chin (Auto Svcs/Claims & IA/Claims & IA/Buses)  
**Cc:** Khanchna (LKK Auto)  
**Subject:** REJECT TP CLAIM - ACCIDENT INVOLVING YN 3424X (CTI) & TIB 1169Z (TP) ON 12/05/2018  
**Attachments:** PIR.pdf

Dear Karen,

Ref: BUS/05/18/1014

Fya, please.

Regards

Tan Lee Gek (DID: 6866 2647)  
Claims Department  
SMRT Automotive Services Pte Ltd



---

**From:** Khanchna (LKK Auto) [mailto:khanchna@lkkauto.com]  
**Sent:** 08/08/2019 10:12  
**To:** Tan Lee Gek (Auto Svcs/Claims & IA/Claims & IA/Taxis)  
**Cc:** Admin A  
**Subject:** REJECT TP CLAIM - ACCIDENT INVOLVING YN 3424X (CTI) & TIB 1169Z (TP) ON 12/05/2018

Our Ref: CC3/CTI18009135/Skb3

Your Ref: TIB1169Z

Dear Sir/Madam,

The above matter refers.

Kindly be informed that the police investigation result (as attached) is against your client under S.65(b) RTA for Inconsiderate driving.

As such, we have our principal's instruction to deny liability and to reject your client's claims.

Thank you.

Kindly note that this negotiation between parties on this matter is purely on a without prejudice basis with the sole intention of resolving the matter amicably without parties resorting to legal proceedings. No admission of liability, whatsoever, should be deemed / inferred from this negotiation of terms/settlement.

In the event of new evidence being discovered or subsequently produced by either party that will materially affect/influence on the issues of liability/damages, either party is not bound, thereafter, by the negotiation terms/settlement.

Best Regards,

**Khanchna** | Case Handler

**LKK Auto Consultants Pte Ltd**

DID: **6841 2360** | email: [Khanchna@lkkauto.com](mailto:Khanchna@lkkauto.com) | Fax: 6741-4108

Blk 51, Paya Ubi Industrial Park, Ubi Avenue 1, #02-25 | S(408933)



# LKK Auto Consultants Pte Ltd

51 Ubi Ave 1 #01-25 Paya Ubi Industrial Park, Singapore 408933

TEL: 6256 3561 FAX: 6256 4315

Reg. No: 199607198R GST Reg. No. 19-9607198-R

Affiliated to Federation Internationale Des Experts En Automobile

CHINA TAIPING INSURANCE (S) PTE LTD

Ref : CC3/CTI18009135/Skb3q2

3 ANSON ROAD #16-00  
SPRINGLEAF TOWERS SINGAPORE 079909

Date : 17-12-2019



Code : CTI

## 1. Policy Particulars :- THIRD PARTY CLAIM

Insured Veh.	YN 3424X	Veh. Inspected	TIB 1169Z
Policy No.	DMCVSN3083721700	Coverage (\$)	0.00
Claim No.	SNM18D02409/C01/4	Excess (\$)	0.00
Assign From		Assign Date	16/05/2018

## 2. Vehicle Particulars & Condition

Make & Model	MERCEDES BENZ 0405G	c.c	11967
Engine No.	HIDDEN	Year of Reg.	2000
Chassis No.	WEB61232321098319	Colour	MULTI COLOUR
Odometer	61271	Steering	IN ORDER
Brakes	IN ORDER	Modification	NIL
General	FAIR		

## 3. Conditions of Tyres

	Size	Make	Balance
R/H Front Tyre	275/70 R22.5	FIRENZA	6 mm
L/H Front Tyre	275/70 R22.5	FIRENZA	6 mm
R/H Rear Tyre	275/70 R22.5	FIRENZA	6 mm
L/H Rear Tyre	275/70 R22.5	FIRENZA	6 mm

## 4. Description of Damages

THE VEHICLE SUSTAINED DAMAGES AT THE O/S BODY. DAMAGES SEE DETAILS.
--

## 5. General Information

Accident Date	12/05/2018	Inspection Date	16/05/2018
Survey held at	SMRT AUTOMOTIVE SERVICES PTE LTD 60 WOODLANDS INDUSTRIAL PARK E4 SINGAPORE 757705		

## 5a. Remarks

A) THE INSPECTION WAS CONDUCTED ON A "WITHOUT PREJUDICE" BASIS. B) IN ACCORDANCE TO YOUR INSTRUCTIONS, WE HAVE NOT AUTHORISED REPAIRS.
---

## 5b. Estimate Days of Repair

ESTIMATED NORMAL PERIOD FOR REPAIR:	5 Working Days
-------------------------------------	----------------

**LKK Auto Consultants Pte Ltd**

51 Ubi Ave 1 #01-25 Paya Ubi Industrial Park, Singapore 408933

TEL: 6256 3561 FAX: 6256 4315

Reg. No: 199607196R GST Reg. No. 19-9607198-R

Page No.:1 of 1

**ADJUSTMENT ON REPAIR COST FOR VEHICLE NO. TIB 1169Z**

Qty	Description of Parts	Condition	Estimate By Workshop (\$)	Our Adjusted (\$)
<b>REPLACEMENT OF PARTS</b>				
1	SIDE GLASS#2 1295X1480X5	CRACKED	1,975.80	1,975.80
1	SIDE WINDOW GLASS	NECESSARY	1,140.26	1,140.26
1	SIGNAL LIGHT	CRACKED	62.21	62.21
	LESS 10% DISCOUNT		-	-317.83
			3,178.27	2,860.44
<b>SPECIAL NETT ITEMS</b>				
16	SEALANT SIKAFLEX @\$37.00 (SN)	NECESSARY	592.00	592.00
2	ACTIVATOR @\$80.00 (SN)	NECESSARY	160.00	160.00
2	PRIMER @\$80.00 (SN)	NECESSARY	160.00	160.00
1	60KM/H STICKER (SN)	NECESSARY	5.00	5.00
			917.00	917.00
<b>LABOUR</b>				
	TO REMOVE & INSTALL ALL ABOVE ITEMS AND REPAIR OTHERS DAMAGED AFFECTED AREAS.		3,180.00	2,650.00
	PROVIDE LABOUR AND MATERIAL TO PUTTY AND RESPRAY ABOVE REPAIR ITEMS.		1,466.00	1,200.00
			4,646.00	3,850.00
<b>GRAND TOTAL</b>			<b>8,741.27</b>	<b>7,627.44</b>
<b>RECOMMENDED COST OF LUMP SUM REPAIRS (TO ITS PRE-ACCIDENT CONDITION)</b>				<b>6,850.00</b>

Report Ref No. CC3/CTI18009135/Skb3q2

**YEANG WAI KEEN**

Automotive Assessor

**HO LEONG CHUAN**

Automotive Assessor

DISCLAIMER OF LIABILITY TO THIRD PARTIES:- This Report is made solely for the use and benefit of the Client named on the front page of this Report.

No liability of responsibility whatsoever, in contract or tort, is accepted to any third party who may rely on the Report wholly or in part. Any third party acting or relying on this Report, in whole or in part, does so at his or her own risk.