

ASS. REC. BY:

REF:

CS/msg 18008716/D33b

n2

Special Instruction:

Surveyor

Bryan

ASSIGNMENT (Office)

From (Person): Farel Foo

of

MSIG

Date/Time: 14/5/2018 10:10am

Estimated Cost:

Bill to:

OD / ~~D~~ / WS / TP RES / OD RES / EVA / INV / MV / CS

To Inspect Vehicle No:

SJJ5655G

Insured:

YN 4939X

at Workshop m/s

Chew Goon Motor

Tel:

of

Bk 10, Amk Ind park #01-15/16 & 17 Auto point

Policy No:

28925026MKC

Claim No:

Sum Insured:

Excess:

Make of Veh:

D.O.A.

9/5/18

(Client's Record)

CA / REV / REP. / REV 24 HRS

WP

H.O.D. Endorsement:

Date/Time:

Person Contacted:

Vehicle IN / OUT

Date/Time

Action/Instruction () Estimate

SJJ 5655G - X

YN 4939 - X

15/05/18

@ 14:56 revised to Farel Foo Wengao via meimer.

04/06/18

C45,120.03 - \$2,800/-) = Reduction - 45%

REF:

ASSIGNMENT

From: _____ Date: _____
 Estimated Cost: _____
 OD / TP / WS / TP RES / OD RES / EVA / INV / MV

To inspect Vehicle No: _____
 at Workshop no: _____
 at: _____
 Insured: _____
 Policy No: _____
 Claims No: _____
 Sum Insured: _____ Excess: _____
 (Client's Record)
 Make of Veh: _____

(Policy Condition)

Remark: The veh had commenced its
 repair at the time of inspection.



Bal. or Market Value: _____
 IDAC Accident Report: _____ Consistent? : Yes or No
 GIA / PR Seen: _____ Consistent? : Yes or No
 Est. Repairs: 4 days Rep: Yes or No
 Lum Sum: 20 % 3 Val: Yes or No

CA / REV / REP. / 24 HRS

Date: _____ Person Contacted: _____

Vehicle: IN / OUT

Vehicle: 855 5655G Yt Regn: 2008 Sept
 Type: ☒ M/Cycle / Bus / Van / Lorry / Taxi / Prime Mover /
 Truck / Trailer or

Make: Toyota Allion C.G. 1496
 Colour: Silver A/C: Insured / Std / NI / NA
 Sp. Reading: 76156 T/Ratio: Insured / Std / NI / NA

Eng/No: 1N7C990051
 G/No: H2T2603022372

Gen. Cond: ☒ Good / Fair / Poor / BurntSteering: ☒ Insurer / Jammed / Leaked / Burnt orBrake: ☒ Insurer / Jammed / Leaked / Burnt orModi: Nil / ☒ Rim / STD A/Rim or

Tyre Size: F: 195/70 R14
 R: — " —

BS / DUN / EXNOVA / GY / FS / LIZA / MIC / OHTSU / PIR / SUMI /
 TOYO / YOKO or Michelin

Front	Rear
R/Bal: 5' mm	R/Bal: 5' mm
L/Bal: 5' mm	L/Bal: 5' mm
D.O.A: 09/05/2018	D.O.I: 14/05/2018

Survey held at: 14 Chew Goon AMC

Des. of Damages: Frt / Rear / O/S / NIS / UIC / Rooftop or

Front o/s

The UIC / Chassis frame / Body Structure affected due to collision

Date / Time: _____ Action / Instruction:

MSG YN 4939X

MV 11K

LTA 7.5K

HL 3.5K - PARP plus body. + 4 mths.

01/06/18

finger +15 2800/- - it + days of yr

Date/Time: File Pass to?

04/06/18

By: Typst

Date/Time: File Return to?



Preli. Report



Final Report

Days Of Repair: 4

Resurvey No. of Trip: 1

Survey Fee:

Transportation:

Add Fee:



Site Insp: \$



Interv: \$



Tech. Insp: \$



Workshop: \$

Report Format:

Lump Sum / L.B.F. \$ 2,800/- 4/5

150
10

160

LKK Auto Consultants Pte Ltd (Co.Reg.No:199607198R)

51 Ubi Ave 1 #01-25, Paya Ubi Industrial Park

Singapore 408933

Tel: 6256-3561 Fax: 6844-8805 Email: sur@lkkauto.com; assignments@lkkauto.com

To: MSIG Insurance (Singapore) Pte. Ltd.
4 Shenton Way
#21-01 SGX Centre 2
Singapore 068807

From: LKK Auto Consultants Pte Ltd
51 Ubi Ave 1 #01-25
Paya Ubi Industrial Park
Singapore 408933

Attn: Fievel Foo Wen Yao

Date: 15 May 2018

Preliminary Advice

Insured Vehicle No	: YN4939X	Accident Date	: 09/05/2018
TP Vehicle No	: SJJ5655G	Assignment Date	: 14/05/2018
Make	: TOYOTA ALLION	Est. Duration of Repair	: 4 days
Date of Inspection	: 14/05/2018		
Inspection At	: Chew Goon Motor (AMK) Blk 10 Ang Mo Kio Industrial Park 2A, #01-15/16 & 17, AMK Autopoint Singapore 568047		

Point of Impact / General Description of Damages

The vehicle sustained impact / damages front o/s portion and parts claimed are consistent to the accident.

Repairer's Estimate (Gross)	:S\$	5,120.03
Revised Amount	:S\$	3,502.77
Check Items (Estimated)	:S\$	0.00
Total	:S\$	3,502.77

Lump Sum Repair :S\$

Total Loss Consideration

New for Old Value	:S\$
Pre-Accident Value	:S\$
COE / PARF Rebate	:S\$
Salvage Value	:S\$
Margin for Repair	:S\$

Remarks

- () The vehicle is economical/not economical for repair.
- (X) The above survey was conducted on a 'without prejudice' basis.

...CLAIM SUBFOLDER...(New Assignment)

CLAIM SUBFOLDER TRACKING

Case	Notified	Est Submitted	Adj Assigned	Adj Rpt	Adj Submitted	Ins Auth'd	Status
Main	11 May 2018		14 May 2018 10:10 Assign				New Assignment Cancel Case

Main	Reference	Claim Details	Documents	Show All
----------------------	---------------------------	-------------------------------	---------------------------	--------------------------

CLAIM SUBFOLDER DETAILS [\[Created by insurer\]](#)

Insured:	JIA SENG TRADING PTE. LTD., Co. Reg. No.: 200800861K		
Main Claimant:	NG LIANG CHYE, ID: S1131130Z		
Vehicle Reg. No.:	SJJ5655G	Date of Loss:	09/05/2018 00:00 - :59 [115 Months and 21 Days From LTA Reg Date (Man Yr)]
Claim Type:	TP	Policy/Cover Note No.:	28925626MKC (Comprehensive) Coverage: 01/04/2018 - 31/03/2019
Vehicle Reg. No. (Insured):	YN4939X	Policy No. (Claimant):	
		Excess:	
Repairer:	Chew Goon Motor (AMK) Blk 10 Ang Mo Kio Industrial Park 2A, #01-15/16 & 17, AMK Autopoint, 568047 Ang Mo Kio - Tel: 64841626		
Handling Insurer:	MSIG Insurance (Singapore) Pte. Ltd. (HQ) - Tel: +65 6827 7888 ... [Handled by Fievel Foo Wen Yao - 6643 1316]		
Adjuster:	LKK Auto Consultants Pte Ltd (HQ) - Tel: 6256-3561 ... [Imm.Advice due 15/05/2018]		
Adj Asg. Remarks:	OI not yet reported Survey agree on SJE - LKK Workshop contact no , 68481626		

ASSOCIATED MAIL RECEIVED [View All](#) [Compose Case Mail](#)

There are no mail for this case.

ALL ASSOCIATED TASKS [View All](#) [Search Tasks](#) [Create New Task](#) [Complete](#)

Due Date	Priority	Type	Task Group	Subject	Handler	Assigned By	Completed On	Created On	Done?
No results.									

avoid 1pm - 2pm.

Bryan.

Enquire PARF/COE Rebate for Registered Vehicle

Vehicle Owner Particulars	
Owner ID Type:	Singapore NRIC
Owner ID:	1130Z
Vehicle Details	
Vehicle No.:	SJJ5655G
Vehicle to be Exported:	No
Intended De-registration Date:	09 May 2018
Vehicle Make:	TOYOTA
Vehicle Model:	ALLION 1.5 A
Primary Colour:	Silver
Manufacturing Year:	2008
Engine No.:	1NZC990051
Chassis No.:	NZT2603022372
Maximum Power Output:	81.0 kW (108 bhp)
Open Market Value:	\$14,075.00
Original Registration Date:	18 Sep 2008
First Registration Date:	18 Sep 2008
Transfer Count:	0
Actual ARF Paid:	\$14,075.00
Intended PARF Rebate Details	
PARF Eligibility:	Yes
PARF Eligibility Expiry Date:	17 Sep 2018
PARF Rebate Amount:	\$7,037.00
Intended COE Rebate Details	
COE Expiry Date:	17 Sep 2018
COE Category:	A - Car (1600cc & below)
COE Period(Years):	10
QP Paid:	\$14,100.00
COE Rebate Amount:	\$501.00
Total Rebate Amount:	\$7,538.00

The information contained herein is correct as at 09 May 2018

OK

(S)

SINGAPORE ACCIDENT STATEMENT

IMPORTANT NOTICE

1. Please report correctly the details of the accident to speed up the claims process.
2. This Form must be completed by the Policyholder and/or the Authorised Driver.
3. Information provided must be as truthful and accurate as possible. Any wilful misrepresentation or withholding of material facts may allow insurance companies to repudiate policy ability.
4. The issue and acceptance of this Form by insurance companies is not an admission of policy liability on the part of the insurance companies.
5. Any false reporting may be referred to the Police for investigation.
6. This report will be forwarded by the insurers of the GIA Records Management Centre established by the General Insurance Association of Singapore (GIA) for archiving and that copies of this report will, for a fee, be made available upon application by interested parties.
7. By the lodgement of this report to the insurers, you hereby consent to the archiving of this report at the centre and to copies of the report being made available aforesaid.

ACCIDENT STATEMENT

Date Of Report	09/05/2018 15:52
Date Of Accident	09/05/2018 13:45
Exact Location Of Accident	BLK 603 ANG MO KIO AVE 5 OPEN CAR PARK LOT 59
Country/State of Loss	SINGAPORE

DETAILS OF OWN VEHICLE

Vehicle Registration Number	SJJ5655G
Insured/Policyholder	
Name Of Registered Owner	NG LIANG CHYE
NRIC No	S1131130Z
Email Address	NOEMAIL
Mobile Phone No	(LOCAL) +65-97505436
Alternative Phone No	OTHERS-97505436

Vehicle Particulars

Manufacturer	TOYOTA
Model	ALLION 1.5 A
Exact Purpose for which vehicle was being used at time of accident	PRIVATE
Are you claiming under your own insurance policy for repair to your vehicle?	NO
If No, Please state action to be taken	THIRD PARTY
Vehicle Category	PRIVATE CAR

Insurance Company

Name of Insurance Company	NTUC INCOME INSURANCE CO-OPERATIVE LTD
Type Of Coverage	COMPREHENSIVE
Fleet Policy	NO
Policy Number	5031671169-09
Cover Note Number	

Driver

Name of Driver	NG LIANG CHYE
NRIC No	S1131130Z
Date Of Birth	20/04/1955
Occupation	INDOOR
Date Of Driving Pass	23/10/1980
Driving Experience	37 YEARS AND 6 MONTHS
Gender	MALE
Mobile Number	(LOCAL) +65-97505436
Fax Number	
Contact Number	OTHERS-97505436
Email Address	NOEMAIL

Address	BLK 603 ANG MO KIO AVENUE 5 #07-2665
Postcode	560603
Was driver an employee of the Insured's Company	NO
If No, Relationship of the Driver with the Insured	OWNER
Vehicle Registration Number of Driver's Own Vehicle	-
	-
	-
Insurance Company of Driver's Own Vehicle	-
	-
	-

General Information of the Accident

Type Of Accident	COLLIDED INTO PARKED VEHICLE
Weather Conditions	CLEAR
Road Surface	DRY

Other Information

Was any foreign vehicle involved in this accident?	NO
Number of vehicles involved in the accident	
Was any body injured in the Accident?	NO
Was any injured conveyed to hospital by ambulance?	NO
Was any other material or property damaged?	YES
I have been approached by unknown person(s) soliciting/offering accident claims assistance.	NO
Number of Passengers (Including Driver)	1

Details of Police Action

Was the accident reported to the police?	NO
If Yes, Please state which Police Station	
Was notice of intended Prosecution given?	NO
If Yes, against whom?	

Circumstances of Accident

MY VEHICLE A (SJJ5655G) WAS PARKED IN PARKING LOT 59, AT AROUND 1345HRS MR TOH INFORM ME MY CAR WAS HIT BY VEHICLE B (YN4939X).

Attachment(s)

Are accident photos available for attachment?	YES
Was there any video captured by Car Camera?	NO
Was there any audio recorded?	NO

Details of Witness 1

Name	TOH CHIN TIONG
Phone Number	84979940
Email Address	

DETAILS OF OTHER VEHICLE PROPERTY 1

Vehicle Registration Number	YN4939X
Vehicle Make/Model/Colour	
Details Of Properties	
Vehicle Category	COMMERCIAL VEHICLE
Name of Driver	THAM LEE MENG
NRIC/Passport Number	S8515024C
Contact Number	92228103
Address	
Postcode	
Insurance Company Name	

Nature Of Damage

No. Of Passenger (Including Driver)

Sketch Plan

SKETCH PLAN

IMPORTANT NOTICE

1. Please report **correctly** the details of the accident to speed up the claims process.
2. This Form must be **completed by the Policyholder and/or the Authorised Driver**.
3. Information provided must be as **truthful and accurate as possible**. Any wilful misrepresentation or withholding of material facts may allow insurance companies to **repudiate policy liability**.
4. The issue and acceptance of this Form by insurance companies is not an admission of policy liability on the part of the insurance companies.
5. **Any false reporting may be referred to the Police for investigation.**
6. The report will be forwarded by the insurers of the GIA Records Management Centre established by the General Insurance Association of Singapore (GIA) for archiving and that copies of this report will for a fee be made available upon application by interested parties.
7. By the lodgment of this report to the insurers, you hereby consent to the archiving of this report at the centre and to copies of the report being made available aforesaid.

8. Consent under the Personal Data Protection Act (PDPA)

I understand, acknowledge, agree and consent that:

- (a) My insurer, my workshop and the General Insurance Association of Singapore ("GIA") may/are permitted to collect, use, disclose and/or process my personal data/personal information set out in this [form] and any other personal information provided by me or possessed by my insurer (collectively the "Personal Information") and disclose and transfer such Personal Information to all insurer(s) who have insured vehicle(s) involved in this accident (all insurer(s) who have insured vehicle(s) involved in this accident shall be collectively referred to as the "Insurers"), the Insurers' lawyers/law firms, the Monetary Authority of Singapore and any relevant government agency/authority (such as the police), for the purpose(s) of:
 - (i) processing, handling and/or dealing with my claims including the settlement of the claims and any necessary investigations relating to the claims;
 - (ii) investigating the accident and/or my claims;
 - (iii) carrying out and/or dealing with my instructions or responding to any enquiries by me;
 - (iv) administering my claims (including the mailing of correspondence, statements, invoices, reports or notices to me, which could involve disclosure of certain personal data about me to bring about delivery of the same as well as on the external cover of envelopes/mail packages); and/or
 - (v) complying with applicable law in administering, processing, handling and/or dealing with my claims (collectively the "Purposes")
- (b) all insurer(s) who have insured vehicle(s) involved in this accident and the Insurers' lawyers/law firms, may/are permitted to collect, use, disclose and/or process my Personal Information for one or more of the above Purposes; and
- (c) my Personal Information may/can be disclosed by any of the Insurers and/or GIA to their third party service providers or agents (including their lawyers/law firms), which may be sited outside of Singapore, for one or more of the above Purposes
- (d) my Personal Information will also be collected and used to compile claims history for the purpose of fraud detection, investigation and management in present and all future claims.
- (e) the information so collected under (d) above may be shared / disclosed:
 - (i) to all insurers and/or any other third parties that assist in evaluating, investigating, controlling or managing fraud, regulators, law enforcement and government agencies as reasonably required for the purposes stated, or
 - (ii) for complying with requirements under any regulations, laws or court orders.

Policyholder's Signature
Date & Time:

Driver's Signature
(If driver is not the policyholder)
Date & Time:

Reporting Centre Personnel's Signature
Name:
NRIC/FIN No.:

Sketch Plan #2

SKETCH PLAN

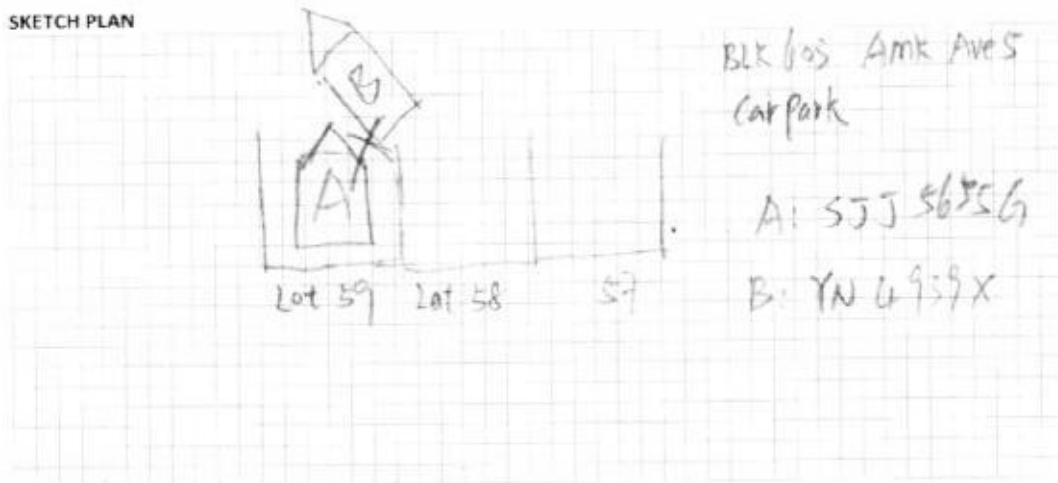

DESCRIBE CIRCUMSTANCES OF THE ACCIDENT

My vehicle A SJJ 5655G was parked in parking lot 59, at around 1.45pm.
The info from me my car was hit by lot B YN 6939X.

DECLARATION

I/We declare the foregoing particulars are true in every respect.

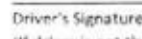

Policyholder's Signature
Date & Time:

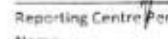
Driver's Signature
(If driver is not the policyholder)
Date & Time:

Reporting Centre Personnel's Signature
Name:
NRIC/FIN No.:

STANDARD FORM 100-100

REPUBLIC OF SINGAPORE
IDENTITY CARD NO. S1131130Z



NG LIANG CHYE

Race
CHINESE

Date of Birth
20-04-1955

Country of Birth
SINGAPORE

Sex
M

3011968

REPUBLIC OF SINGAPORE DRIVING LICENCE

Licence Number: S1131130Z

Name: NG LIANG CHYE

Birth Date: 20 Apr 1955

Issue Date: 09 Mar 2004



001156342B

3011968



NRIC No: S1131130Z

Blood Group: O- Date of issue: 03-03-1998

APT BLK 603 ANG MO KIO AVENUE 5 #07-2665 SINGAPORE 560003

NRIC No: S1131130Z Date: 02/03/2017

YOU ARE LICENSED TO DRIVE VEHICLES IN THE FOLLOWING CLASSIES

	PASS DATE
Class 3 Motor Cars and Motor Tractors the weight of which unladen does not exceed 2500 kilograms	19 Jun 1975
Class 4 Heavy Motor Cars and Motor Tractors the weight of which unladen exceeds 2500 kilograms	23 Oct 1980

NP 428A

Licence No: S1131130Z

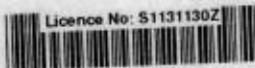

Certificate of Insurance

MOTOR VEHICLES (THIRD PARTY RISKS AND COMPENSATION) ACT (CHAPTER 189)
MOTOR VEHICLES (THIRD PARTY RISKS AND COMPENSATION) RULES, 1960
ROAD TRANSPORT ACT, 1987 (MALAYSIA)
MOTOR VEHICLES (THIRD PARTY RISKS) RULES, 1959 (MALAYSIA)

Certificate Number: 5031671169-09

Cover : drivo CLASSIC

- | | |
|---|-----------------|
| 1. Index mark and Registration Number of Vehicle | : SJJ5655G |
| Chassis Number | : NZT2603022372 |
| 2. Name of Policyholder | : NG LIANG CHYE |
| 3. Effective Date of Insurance | : 18 Sep 2017 |
| 4. Expiry Date of Insurance | : 17 Sep 2018 |
| 5. Persons or Classes of Persons entitled to drive# | |
| (a) The Policyholder. | |
| (b) Any other person who is driving on the Policyholder's order or with his/her permission. | |
| Provided that the person driving is permitted in accordance with the licensing or other laws or regulations to drive the Motor Vehicle or has been so permitted and is not disqualified by order of a Court of Law or by reason of any enactment or regulation in that behalf from driving the Motor Vehicle. | |
| 6. Limitations as to Use# | |
| (a) Use for social domestic and pleasure purposes and in connection with the Policyholder's business or profession. | |

This Policy does not cover

- (a) Use for hire or reward.
- (b) Use for racing, pace-making, reliability trial or speed-testing.
- (c) Use for the carriage of goods (other than samples) in connection with any trade or business.
- (d) Use for any purpose in connection with the Motor Trade.

Limitations rendered inoperative by Section 8 of the Motor Vehicle (Third Party Risks and Compensation) Act (Chapter 189) and Section 95 of the Road Transport Act, 1987 (Malaysia), are not to be included under these headings.

EXCESS (SECTION 1)	: S\$600
EXCESS (SECTION 2)	: N/A
WINDSCREEN EXCESS	: S\$100
ADDITIONAL EXCESS	: N/A
UNNAMED DRIVER EXCESS	: PLEASE REFER OVERLEAF
REPAIR AT OWNER'S PREFERRED WORKSHOP	: NO
INSURE WITH COE	: YES
NCD PROTECTION	: YES (FREE)
TRANSPORT ALLOWANCE	: NO
EXCESS WAIVER	: NO
PRIMARY DRIVER	: NG LIANG CHYE
NAMED DRIVER (1)	: N/A
NAMED DRIVER (2)	: N/A
HIRE PURCHASE COMPANY	: GE MONEY PTE LTD
SUM INSURED	: MARKET VALUE OF INSURED VEHICLE AT TIME OF LOSS

I/We hereby Certify that the Policy to which this Certificate relates is issued in accordance with the provisions of the Motor Vehicles (Third Party Risks and Compensation) Act (Chapter 189) and Part IV of the Road Transport Act, 1987 (Malaysia)

Agency : JIN-SHI (HOLDINGS) PTE LTD (00000614399)
Date of Issue : 08 Sep 2017 15:29 hrs
Reprint : 08 Sep 2017 15:30 hrs

For NTUC INCOME INSURANCE CO-OPERATIVE LIMITED



Countersigned By:

Authorised Officer



Chief Executive

趙源摩哆 Chew Goon Motor

Blk 10, Ang Mo Kio Industrial Park 2A, Avenue 5
#01-15, 16, 17 & #03-05, AMK Autopoint Singapore 568047
Tel: 6484 1626 (24Hrs) Fax: 6484 0465
Business Reg. No: 221880/00C GST Reg. No: MX-0486007-AO

MSIG Insurance (S) Pte Ltd

To: _____

Policy No: _____ Third Party

Date: _____ 10.05.2018

Accident Date : 09.05.2018

Specialised in Car Painting, Welding,
Panel-Beating and Insurance Claim.

ESTIMATE

承接汽车烧焊喷漆及
代理各种车辆赔偿

数量 Quantity	货名 DESCRIPTION	单价 Unit Price	银 Amount 额 \$ cts.
Estimate Cost of Repair to "Toyota Allion" Reg. No. SJJ5655G Claiming Against Your Insured Veh. No. YN4939X			
1pc	Front Bumper <i>torn</i>		659.00 ✓
10pcs	Front Bumper Clips <i>hlc</i>		38.00 ✓
1pc	Front Bumper Bracket RH <i>3VL</i>		53.40 X
1pc	Front Bumper Sponge <i>torn</i>		91.40 ✓
1pc	Front Bumper Reinforcement <i>1st</i>		374.00 ✓
1pc	Front Bumper Corner Retainer RH <i>3VL</i>		63.90 X
1pc	Front Bumper Fog Lamp Cover <i>cnt</i>		62.00 ✓
1pc	Front Bumper Center Air Grille <i>defmed</i>		189.00 ✓
1pc	Front Bumper Lower Cover <i>3VL</i>		121.30 X
1pc	Headlamp Assy RH <i>cnt</i>		760.00 ✓
1pc	Headlamp Panel RH <i>ren</i>		297.00 X
1pc	Front Fender Shield RH <i>torn</i>		225.00 ✓
10pcs	Front Fender Shield Clips <i>hlc</i>		38.00 ✓
1pc	Air Con Condenser Air Guide RH <i>3VL</i>		64.40 X
1pc	Grille <i>mounting brace</i>		434.00 ✓
1pc	Grille Emblem <i>hlc</i>		61.30 ✓
1pc	Wiper Tank <i>defmed</i>		72.00 ✓
1pc	Front Wheel Bearing RH <i>NN</i>		143.00 X
	Less 25%		3,746.70
			936.68
			2,810.03
1pc	Wheel Rim <i>NN</i>		280.00 SNX
	To Conduct Front Electrical Check, Locking System, Adjust, Focus Headlamp etc		30.00 20/-
	To Apply Rust Proofing / Reseal Tuff Coating Treatment to Respray / Replaced / Repair Panel		40.00 30/-
	To Dismantle / Replace Wheel Bearing		80.00 NN
	To Conduct Computerize Wheel Alignment Test		80.00 NN
	Labour Charge - Panel Beating, Repairing Of O/S Chassis Member, Inner Panel, Front O/S Fender Etc. Cnt, Weld Headlamp Panel and Parts Replacement		800.00 600/-
	To Respray Affected Areas (Bumper, Fender, Support Panel, Reinforcement, Headlamp Panel)		1,000.00 600/-
		Total :	5,120.03

LKK Auto Consultants has notified the Repairer of the following:

- To resurvey before/after spray painting
- To display damaged part(s) during resurvey
- Parts prices are subject to confirmation
- Third party survey is on a "Without Prejudice" basis
- No illegal modification(s) is allowed
- Supplementary item(s) must be resurveyed and is subject to final approval from Insurance Company

Acknowledged by Repairer
Signature: _____
Date: _____

3 003.70
2252.77

14/05/2018 @ 1530h

Not Author
2/5/2018

4 days
LKK check

1250/-

3502.77
215 2800/-

LKK Auto Consultants Pte Ltd (Co.Reg.No:199607198R)

51 Ubi Ave 1 #01-25, Paya Ubi Industrial Park

Singapore 408933

Tel: 6256-3561 Fax: 6844-8805 Email: sur@lkkauto.com;assignments@lkkauto.com

VEHICLE DAMAGE INSPECTION REPORT

Our File No: CS/MSG18008716/DS3BN2

Date: 05/06/2018

REFERENCE

Handling Insurer:	MSIG Insurance (Singapore) Pte. Ltd.	Policy No:	28925626MKC
Claimant Vehicle No :	SJJ5655G	Insured Vehicle No :	YN4939X
Date of Loss:	09/05/2018	Nature of Claim:	TP
		Claim No:	558191

DESCRIPTION & IDENTIFICATION OF VEHICLE

Reg No:	SJJ5655G	Engine No:	1NZC990051
Make & Model:	TOYOTA ALLION, 1.5 (A)	Chassis No:	NZT2603022372
Reg. Date:	18/09/2008 (Man. Year: 2008)	Odometer:	76156 km
Colour:	Silver		
Engine Capacity:	1496 cc		
Market Value/New Car Price:	N/A		
Sum Insured (S\$):	Market Value/New Car Price		

CONDITION OF VEHICLE AT THE TIME OF SURVEY

General Condition:	Steering (Serviceable):	Yes	Footbrake (Serviceable):	Yes
Handbrake (Serviceable):	Yes	Engine Modification:	No	Pre-accident Condition:

CONDITION OF TYRES

Front Tyre Size:	195/70R14	Rear Tyre Size:	195/70R14
Front Left Side:	Michelin 5 mm	Rear Left Side:	Michelin 5 mm
Front Right Side:	Michelin 5 mm	Rear Right Side:	Michelin 5 mm

The above values represent the remaining tyre treads depth

COST OF CLAIMS

	Repairer's	Adjuster's	Difference	Diff %
Parts	3,090.02	2,252.77	837.25	27.10
Miscellaneous Items	0.00	0.00	0.00	
Labour	2,030.00	1,250.00	780.00	38.42
Paintwork Labour	0.00	0.00	0.00	
Towing	0.00	0.00	0.00	
Calculated Gross Total (S\$)	5,120.02	3,502.77	1,617.25	31.59
Approved Total (Overridden) (S\$)		2,800.00		
(S\$)	5,120.02	2,800.00	2,320.02	45.31
+ GST 7.00/7.00% (S\$)	358.40	196.00	162.40	45.31
Nett Amount (S\$)	5,478.42	2,996.00	2,482.42	45.31

INSPECTION

Date of Assignment:	14/05/2018	
Date Inspected:	14/05/2018 Inspected At:	Chew Goon Motor (AMK) Blk 10 Ang Mo Kio Industrial Park 2A, #01-15/16 & 17, AMK Autopoint Singapore 568047
Estimated Period of Repair:	4.0 days	

Adjuster: BRYAN TANI

Manager: Hiew May Fung

NOTE: This report represents our findings at the time and place of inspection stated herein. Such inspection has been carried out to the best of our

knowledge and ability but any other liability under any other circumstances is hereby expressly excluded.

REPAIR DETAILS

Reference

Part Source: MRM-SG	Version: 1.0 (Last Synchronised: 05 Jun 2018)
Parts: 143	TOYOTA ALLION 1.5 (A) (Catalogue:Merimen Singapore 1.0)
Labour: Repairer's	(Price-denominated Standard List)
Print Code: (Unsubmitted, no print-code for SJJ5655G)	
Validity:	These estimates are valid only if they contain the print code (above) on all estimate pages, running page numbers with the END OF ESTIMATES marker on the last estimate page
Further Info:	Items/values not in reference catalogue are prefixed with an asterisk *

Recommended Parts

No.	Qty	Part No.	Particulars	Condition	Repairer's	Amount
1	1		*FRONT BUMPER	Torn	659.00 FL	*659.00 FL
2	10		*FRONT BUMPER CLIPS	Necessary	38.00 FL	*38.00 FL
3	1		*FRONT BUMPER BRACKET RH	Serviceable	53.40 FL	*- FL
4	1		*FRONT BUMPER SPONGE	Torn	91.40 FL	*91.40 FL
5	1		*FRONT BUMPER REINFORCEMENT	Bent	374.00 FL	*374.00 FL
6	1		*FRONT BUMPER CORNER RETAINER RH	Serviceable	63.90 FL	*- FL
7	1		*FRONT BUMPER FOG LAMP COVER	Cut	62.00 FL	*62.00 FL
8	1		*FRONT BUMPER CENTER AIR GRILLE	Deformed	189.00 FL	*189.00 FL
9	1		*FRONT BUMPER LOWER COVER	Serviceable	121.30 FL	*- FL
10	1		*HEADLAMP ASSY RH	Cut	760.00 FL	*760.00 FL
11	1		*HEADLAMP PANEL RH	Repair	297.00 FL	*- FL
12	1		*FRONT FENDER SHIELD RH	Torn	225.00 FL	*225.00 FL
13	10		*FRONT FENDER SHIELD CLIPS	Necessary	38.00 FL	*38.00 FL
14	1		*AIR CON CONDENSER AIR GUIDE RH	Serviceable	64.40 FL	*- FL
15	1		*GRILLE	Mounting Cracked	434.00 FL	*434.00 FL
16	1		*GRILLE EMBLEM	Necessary	61.30 FL	*61.30 FL
17	1		*WIPER TANK	Deformed	72.00 FL	*72.00 FL
18	1		*FRONT WHEEL BEARING RH	Not Necessary	143.00 FL	*- FL
19	1		*WHEEL RIM	Not Necessary	280.00 FS	*- FS

F=Franchise part. S=SpcNett. L=ListItemDisc.

Sub Total (S\$)	4,026.70	3,003.70
- List Item Discount on L Items 25.00/25.00% (S\$)	936.68	750.93
Total Parts (S\$)	3,090.02	2,252.77

Report was unsubmitted during this print-out.

Recommended Miscellaneous Items

There are no new miscellaneous items selected.

Recommended Labour

No	Particulars	Lab.Type	Repairer's	Amount
Labour Items				
1	TO CONDUCT FRONT ELECTRICAL CHECK, LOCKING SYSTEM, ADJUST, FOCUS HEADLAMP ETC	New	30.00	20.00
2	TO APPLY RUST PROOFING/RESEAL TUFF COATING TREATMENT TO RESPRAY/REPLACED/REPAIR PANEL	New	40.00	30.00
3	TO DISMANTLE/REPLACE WHEEL BEARING	New	80.00	-
4	TO CONDUCT COMPUTERIZE WHEEL ALIGNMENT TEST	New	80.00	-
5	LABOUR CHARGE-PANEL BEATING, REPAIRING OF O/S CHASSIS MEMBER, INNER PANEL, FRONT O/S FENDER ETC. CUT, WELD HEADLAMP PANEL AND PARTS REPLACEMENT	New	800.00	600.00
6	TO RESPRAY AFFECTED AREAS	New	1,000.00	600.00
Gross Labour Cost (\$\$)			2,030.00	1,250.00

Report was unsubmitted during this print-out.

< END OF ESTIMATES >