

SINGAPORE ACCIDENT STATEMENT

IMPORTANT NOTICE

1. Please report correctly the details of the accident to speed up the claims process.
2. This Form must be completed by the Policyholder and/or the Authorised Driver.
3. Information provided must be as truthful and accurate as possible. Any wilful misrepresentation or withholding of material facts may allow insurance companies to repudiate policy ability.
4. The issue and acceptance of this Form by insurance companies is not an admission of policy liability on the part of the insurance companies.
5. **Any false reporting may be referred to the Police for investigation.**
6. This report will be forwarded by the insurers of the GIA Records Management Centre established by the General Insurance Association of Singapore (GIA) for archiving and that copies of this report will, for a fee, be made available upon application by interested parties.
7. By the lodgement of this report to the insurers, you hereby consent to the archiving of this report at the centre and to copies of the report being made available aforesaid.

ACCIDENT STATEMENT

| | |
|----------------------------|--|
| Date Of Report | 19/04/2018 16:28 |
| Date Of Accident | 14/04/2018 11:00 |
| Exact Location Of Accident | ALONG WEST COAST WAY (AFTER WEST COAST PARK JUNCTI |
| Country/State of Loss | SINGAPORE |

DETAILS OF OWN VEHICLE

| | |
|-----------------------------|------------------------------------|
| Vehicle Registration Number | SJW1712H |
| Insured/Policyholder | |
| Name Of Registered Owner | GLOBAL METAL INTERNATIONAL PTE LTD |
| Co Reg No | 200208244Z |
| Email Address | NOEMAIL |
| Mobile Phone No | |
| Alternative Phone No | OFFICE-65771810 |

Vehicle Particulars

| | |
|--|----------------|
| Manufacturer | HONDA |
| Model | ODYSSEY |
| Exact Purpose for which vehicle was being used at time of accident | |
| Are you claiming under your own insurance policy for repair to your vehicle? | NO |
| If No, Please state action to be taken | REPORTING ONLY |
| Vehicle Category | PRIVATE CAR |

Insurance Company

| | |
|---------------------------|-----------------------|
| Name of Insurance Company | AXA INSURANCE PTE LTD |
| Type Of Coverage | COMPREHENSIVE |
| Fleet Policy | NO |
| Policy Number | GA164378 |
| Cover Note Number | |

Driver

| | |
|----------------------|------------------------|
| Name of Driver | POERNOMO KURNIAWAN SOO |
| NRIC No | S7755822E |
| Date Of Birth | 30/04/1977 |
| Occupation | INDOOR |
| Date Of Driving Pass | 23/04/2013 |
| Driving Experience | 4 YEARS AND 11 MONTHS |
| Gender | MALE |
| Mobile Number | (LOCAL) +65-91698508 |
| Fax Number | |
| Contact Number | |
| EEmail Address | NOEMAIL |

| | |
|---|----------------------------|
| Address | 39G WEST COAST PARK #04-25 |
| Postcode | 127718 |
| Was driver an employee of the Insured's Company | NO |
| If No, Relationship of the Driver with the Insured | OTHER - - |
| Vehicle Registration Number of Driver's Own Vehicle | - |
| | - |
| | - |
| Insurance Company of Driver's Own Vehicle | - |
| | - |
| | - |

General Information of the Accident

| | |
|--------------------|--------------------------|
| Type Of Accident | COLLISION - HEAD TO REAR |
| Weather Conditions | CLEAR |
| Road Surface | DRY |

Other Information

| | |
|---|-----|
| Was any foreign vehicle involved in this accident? | NO |
| Number of vehicles involved in the accident | |
| Was any body injured in the Accident? | NO |
| Was any injured conveyed to hospital by ambulance? | NO |
| Was any other material or property damaged? | YES |
| I have been approached by unknown person(s) soliciting/offering accident claims assistance. | NO |
| Number of Passengers (Including Driver) | 1 |

Details of Police Action

| | |
|---|----|
| Was the accident reported to the police? | NO |
| If Yes, Please state which Police Station | |
| Was notice of intended Prosecution given? | NO |
| If Yes, against whom? | |

Circumstances of Accident

ON 14/04/2018, I WAS TRAVELLING ALONG WEST COAST PARK. WHEN I REACH THE JUNCTION OF WEST COAST WAY, I SLOWED DOWN MY VEHICLE. VEHICLE B (SLM3920P) WAS IN FRONT OF MY VEHICLE. WE STOPPED AWHILE TO WAIT FOR THE TRAFFIC TO CLEAR. WHEN THE TRAFFIC IS CLEAR, VEHICLE B START TO DRIVE SLOWLY AND TURNED LEFT WHILE I INTEND TO TURN RIGHT. SUDDENLY, VEHICLE B JAM HIS BRAKE. I COULDN'T STOP IN TIME AND COLLIDED ONTO VEHICLE B.

Attachment(s)

| | |
|---|-----|
| Are accident photos available for attachment? | YES |
| Was there any video captured by Car Camera? | NO |
| Was there any audio recorded? | NO |

DETAILS OF OTHER VEHICLE PROPERTY 1

| | |
|-------------------------------------|-------------|
| Vehicle Registration Number | SLM3920P |
| Vehicle Make/Model/Colour | |
| Details Of Properties | VEHICLE B |
| Vehicle Category | PRIVATE CAR |
| Name of Driver | |
| NRIC/Passport Number | |
| Contact Number | |
| Address | |
| Postcode | |
| Insurance Company Name | |
| Nature Of Damage | |
| No. Of Passenger (Including Driver) | |

SKETCH PLAN

IMPORTANT NOTICE

1. Please report correctly the details of the accident to speed up the claims process.
2. This Form must be completed by the Policyholder and/or the Authorised Driver.
3. Information provided must be as truthful and accurate as possible. Any wilful misrepresentation or withholding of material facts may allow insurance companies to repudiate policy liability.
4. The issue and acceptance of this Form by insurance companies is not an admission of policy liability on the part of the insurance companies.
5. Any false reporting may be referred to the Police for investigation.
6. The report will be forwarded by the insurers of the GIA Records Management Centre established by the General Insurance Association of Singapore (GIA) for archiving and that copies of this report will for a fee be made available upon application by interested parties.
7. By the lodgment of this report to the insurers, you hereby consent to the archiving of this report at the centre and to copies of the report being made available aforesaid.
8. Consent under the Personal Data Protection Act (PDPA)

I understand, acknowledge, agree and consent that:

- (a) My insurer, my workshop and the General Insurance Association of Singapore ("GIA") may/are permitted to collect, use, disclose and/or process my personal data/personal information set out in this (form) and any other personal information provided by me or possessed by my insurer (collectively the "Personal Information") and disclose and transfer such Personal Information to all insurer(s) who have insured vehicle(s) involved in this accident (all insurer(s) who have insured vehicle(s) involved in this accident shall be collectively referred to as the "Insurers"), the Insurers' lawyers/law firms, the Monetary Authority of Singapore and any relevant government agency/authority (such as the police), for the purpose(s) of :
 - (i) processing, handling and/or dealing with my claims including the settlement of the claims and any necessary investigations relating to the claims;
 - (ii) investigating the accident and/or my claims;
 - (iii) carrying out and/or dealing with my instructions or responding to any enquiries by me;
 - (iv) administering my claims (including the mailing of correspondence, statements, invoices, reports or notices to me, which could involve disclosure of certain personal data about me to bring about delivery of the same as well as on the external cover of envelopes/mail packages); and/or
 - (v) complying with applicable law in administering, processing, handling and/or dealing with my claims.(collectively the "Purposes")
- (b) all insurer(s) who have insured vehicle(s) involved in this accident and the Insurers' lawyers/law firms, may/are permitted to collect, use, disclose and/or process my Personal Information for one or more of the above Purposes; and
- (c) my Personal Information may/can be disclosed by any of the Insurers and/or GIA to their third party service providers or agents(including their lawyers/law firms), which may be sited outside of Singapore, for one or more of the above Purposes.
- (d) my Personal Information will also be collected and used to compile claims history for the purpose of fraud detection, investigation and management in present and all future claims.
- (e) the information so collected under (d) above may be shared / disclosed:
 - (i) to all insurers and/or any other third parties that assist in evaluating, investigating, controlling or managing fraud, regulators, law enforcement and government agencies as reasonably required for the purposes stated, or
 - (ii) for complying with requirements under any regulations, laws or court orders.

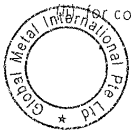

Policyholder's Signature
Date & Time:

Driver's Signature
(If driver is not the policyholder)
Date & Time:

Reporting Centre Personnel's Signature
Name:
NRIC/FIN No.:

19/4/18

Sketch Plan #2 Pg. 1

PLAN

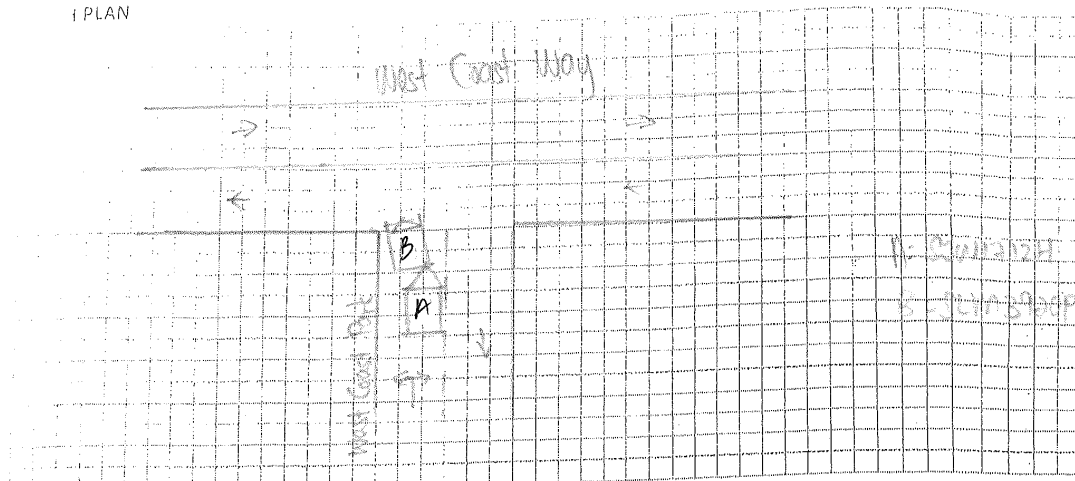

DESCRIBE CIRCUMSTANCES OF THE ACCIDENT

On 14/4/2018, I was travelling along West Coast Park.

When I reach the junction of West Coast Way, I slowed down my vehicle. Vehicle B (SLM3909) was in front of my vehicle. We stopped awhile to wait for the traffic clear. When the traffic is clear, vehicle B start to drive slowly and turn left while I'm intended to turn right. Suddenly, vehicle B, jammed his brake. I could not stop in time and collided onto vehicle B.

DECLARATION

I hereby declare the foregoing particulars are true in every respect.



Driver's Signature
Date & Time:

Driver's Signature
(If driver is not the policyholder)
Date & Time:

18/4/2018 6:40 PM
Reporting Centre Personnel's Signature
Name:
NRIC/FIN No.:

LETTER OF UNDERTAKING

I/We, Global Metal International Pte Ltd, the owner of vehicle no. SJW 1712 H

My/Our Insurance is under M/s AXA Insurance Singapore Pte Ltd, I/we shall decide whether to claim under my/our Policy or against the Third Party and if the former shall submit such a claim to M/s AXA Insurance Singapore Pte Ltd with all relevant facts and documents within 14(fourteen) days of occurrence or discovery of damage.

My/Our Third Party claim is handle by my/our preferred workshop, Free son Autodrive

Signed and Acknowledge by:



.....
Nric no. and signature of policyholder



.....
Company Stamp

.....
Date

Driving License

REPUBLIC OF INDONESIA

IDENTITY CARD NO. **S7755822E**

POERNOMO KURNIAWAN SOO

Name

Race **CHINESE**

Date of birth **30-04-1977**

Country/Place of birth **INDONESIA**

Sex **M**





9457910



NRIC No. **S7755822E**



Nationality **INDONESIAN**

Date of issue **05-09-2017**

Address **39G WEST COAST PARK #04-25 SINGAPORE 127718**

REPUBLIC OF INDONESIA

LICENCE

Licence Number **G555024Q**

Name **POERNOMO KURNIAWAN SOO**

Birth Date **30 Apr 1977**

Issue Date **23 Apr 2013**

Valid Till **22 Apr 2018**





YOU ARE LICENSED TO DRIVE VEHICLES IN (THE FOLLOWING CLASSES)

EFFECTIVE DATE

Class 3 Motor Cars \leq 3000kg with \leq 7 passengers, exclusive of the driver, and other motor vehicles \leq 7500kg

23 Apr 2013



NP 428A

INSURANCE

16/04 2018 MON 17:11 FAX

001/001

Fax 67023577

Henry



redefining / Insurance

Accident 16/4/2018
Yat:

AXA Insurance Pte Ltd
1800 830 4888 (Within Singapore)
(65) 6880 4888 (International)
(65) 6880 4740
customer.care@axa.com.sg
www.axa.com.sg

account number
04154

Certificate of Insurance

-Motor Vehicles (Third Party Risks and Compensation) Act, (Chapter 180)- Motor Vehicles (Third Party Risks and Compensation) Rules, 1960-Road Transport Act, 1987 (Malaysia)
-Motor Vehicles (Third Party Risks) Rules, 1960 (Malaysia)

Policy details

| | | | |
|-----------------------------|--|--------------------|------------------|
| Policyholder name | GLOBAL METAL INTERNATIONAL PTE. LTD. | Certificate number | GA181378 / 1 |
| Cover | Comprehensive | Chassis number | JHMR006503C20227 |
| Plan name | Essential | Engine number | K24Z213D2233 |
| NCD applicable | 10% | | |
| Vehicle registration number | SJW3712H | | |
| Period of Insurance | from 09/03/2018 to 07/03/2019 (both dates inclusive) | | |
| Finance loan company | CCBC BANK LIMITED | | |

Persons or classes of persons entitled to drive*

- (a) Any Named Driver as stated in the Policy:
1. PDERNOMO KURNIAWAN 300
(b) Any person who is driving on the Policyholder's order or with their permission

Provided that the person driving is permitted in accordance with the licensing or other laws or regulations to drive the Motor Vehicle or has been so permitted and is not disqualified by order of a Court of Law or by reason of any enactment or regulation in that behalf from driving the Motor Vehicle.

Limitation as to use*

Use only for social, domestic and pleasure purposes and for the Policyholder's business.
The policy does not cover - use for hire or reward, racing, pace-making, reliability trial, speed testing, the carriage of goods other than samples in connection with any trade or business or use for any purpose in connection with motor trade or when the Motor Car, whether stationary, in use or otherwise, is in or on a racing track, circuit, route, course or any other roads by whatever name called that are typically used for racing, pace-making or such similar purposes.
* Limitations rendered inoperative by Section 4 of the Motor Vehicles (Third Party Risks and Compensation) Act, (Chapter 180) and Section 95 of the Road Transport Act, 1987 (Malaysia), are not to be included under these headings.

EXCESS Basic Own Damage Excess
Windscreen Excess

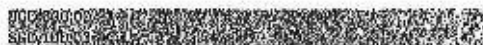

- An Additional Excess is applicable as follows:
1. \$5,500 for unnamed Authorized Driver
2. \$5,500 for declared Young and inexperienced Driver
3. \$13,000 for undeclared Young and inexperienced Drivers. This additional excess is reduced to \$82,500 if you have chosen AXA Premium Workshops.

Additional clauses & endorsements to your policy

N/A

(We hereby certify that the policy to which this Certificate relates is issued in accordance with the provision of the Motor Vehicles (Third Party Risks and Compensation) Act, (Chapter 180) and Part IV of the Road Transport Act, 1987 (Malaysia).

AXA Insurance Pte Ltd

Authorized signature

Important note

Policyholders are warned that on the sale of a motor vehicle they must surrender the Certificate of Insurance and the Policy to the insurance company. If the Certificate of Insurance has been lost, or destroyed a Statutory Declaration to the effect, must be made. Failure to comply with this obligation is an offence under the Motor Vehicle (Third Party Risks and Compensation) Act (Cap. 180).
The Premium Waiver Clause requires the premium to be paid in full within a specific period following which there would be no liability under the policy, renewal certificate, endorsement etc.

AXA Insurance Pte Ltd (189803812M)
8 Shenton Way, #24-01, AXA Tower,
Singapore 068611
Customer Centre, #B1-01

1 of 3

PASSPORT

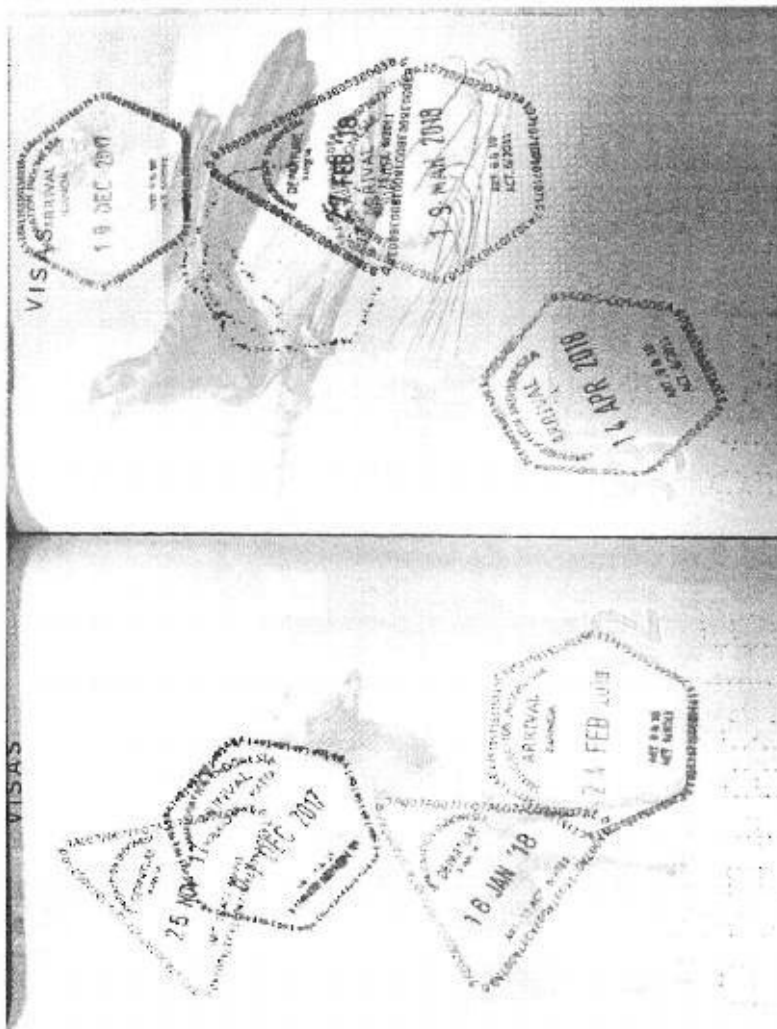

6500

[illegible]

PER 11/1/89

[illegible][illegible]

Accident Photo



Accident Photo



Accident Photo



Accident Photo



Accident Photo



Accident Photo

