



ASS. REC. BY:

REF: CS/FCI18004229/Urd3

Special Instruction:

Surveyor: Marcus

ASSIGNMENT (Office)

From (Person): Kelvin Tan

of FCI

Date/Time: 5/3/18 3:40pm

Estimated Cost:

Bill to:

OD/TP/WS/TP RES/OD RES/EVA/INV/MV/CS

To Inspect Vehicle No: SLM 977X

Insured: SHA 3896L

at Workshop m/s

Pegasus Engineering

Tel: 68581846

of S1 Defu Lane 10

Policy No:

Claim No: D18001778 MFSH

Sum Insured:

Excess:

Make of Veh:  
(Client's Record)

D.O.A. 01/03/2018

06/03/18

CA / REV / REP. / REV 24 HRS

lwp?

H.O.D. Endorsement:

Date/Time: 3:40pm 5/3/18

Person Contacted:

William

Vehicle IN/OUT

Date/Time	Action/Instruction (✓) Estimate
	SLM 977X-X
	SHA 3896L-X

Mercury

MI

06/03/18

SLM 977X

317

Estimated Cost

01 TP NS TP RES/CD RES/EVA/INV/MV

Vehicle/Vendor No

SLM 977X

Engine/Model

Pegelsus

Year

51 Defu Lane 10

Make

Model

Damage

Sum Insured

Excess

Claims Record

Make of car

Policy Condition

Remark: The van had commenced its repair at the time of inspection

<input checked="" type="checkbox"/>	NS	OS
<input checked="" type="checkbox"/>		

Est. of Market Value

Can Accident Report

Consistent? Yes or No

Can Cash

Consistent? Yes or No

Est. Repair

9

days

Est

Yes or No

Sum Insured

20

%

Est

Yes or No

Can REV / REP / 24 HRS

1wp

Date

Person Contacted

Vehicle IN/OUT

Date

Action/Inspection

LT A 51238

21/3/18 Confirmed d/s of \$700 with million.

Red: \$7588.88, 47%

SLM 977X

317

Track To

(A)

Year

Toyota Vios

1496

Color

silver

Co-Insurance

55829

Engine

Model

MHFB29F3602008936

Can Cash

Can Cash

Can Cash

Can Cash

Year

195/50R16

Can Cash

Can Cash

Year

Year

Year

Year

Surveyed

Can Cash

Can Cash

Can Cash

RECEIVED 2-2 MAR 2018

Can Cash

☐

Final Report

Can Cash

☒

Final Report

Can Cash

Year

Add Fee

Year

Year

Year

Year

Can Cash

TP

Can Cash

\$700

Days Of Repair

9

Resurvey No. of Time

-

Can Cash

Can Cash

Can Cash

Can Cash

Can Cash

Can Cash

6x15=90

170+90

50

135

135

135

135

135

135

135

135

135

135

135

135

**MOTOR SURVEY ASSIGNMENT**

<b>Date</b>	02-03-2018	<b>Our Ref No.</b> D18001778MFSH
<b>Accident Date</b>	01-03-2018	<b>Claim Type.</b> Third Party
<b>Insured Vehicle</b>	SHA3896L	<b>Third Party Vehicle.</b> SLM977X
<b>Survey Location</b>	51 DEFU LANE 10	
<b>Contact Person.</b>	ALVIN LOW	
<b>Contact No.</b>	68581846/ 0	<b>Fax No.</b> 64876070
<b>Survey Type</b>	DIRECT SETTLEMENT: QUANTUM TO BE AGREED (EST. COR - \$17,429.10)	
<b>Appointed Surveyor</b>	LKK AUTO CONSULTANTS PTE LTD	
<b>Contact Person</b>	NA	<b>Fax No.</b> 68416315
<b>Contact Number.</b>	NA	

**FOR DIRECT SETTLEMENT**

Please submit to us the Tax Invoice together with letter of claim for Rental OR Loss of use (based on NIMA Benchmark rates) together with your survey report.

**THIRD PARTY SURVEY REQUEST**

<b>Cc : Workshop</b>	PEGASUS ENGINEERING & TRADING PTE LTD	<b>Attention.</b> NIL
<b>Cc : TP Solicitor</b>	NA	<b>TP Solicitor Fax No.</b> NA
<b>Officer Incharge</b>	KARENT	

**IMPORTANT NOTE**

Kindly submit the survey report via CWS within 14 days for survey assignment and 7 days for re-inspection.  
This is a computer generated letter, no signature required.



## LKK Auto Consultants Pte Ltd

51 Ubi Ave 1 #01-25 Paya Ubi Industrial Park, Singapore 408933

TEL: 6256 3561 FAX: 6256 4315

Reg. No: 199607198R GST Reg. No. 19-9607198-R

Affiliated to Federation Internationale Des Experts En Automobile			
FIRST CAPITAL INSURANCE LTD		Ref : CS/FCI18004229/Urd3	
36 ROBINSON ROAD #16-01 CITY HOUSESINGAPORE 068877		Date : 05-03-2018	
		Code : FCI2	
<b>1. Policy Particulars :- THIRD PARTY CLAIM</b>			
Insured Veh.	SHA 3896L	Veh. Inspected	SLM 977X
Policy No.		Coverage (\$)	0.00
Claim No.	D18001778MFSH	Excess (\$)	0.00
Assign From	CWS (KAREN TAN)	Assign Date	05/03/2018
<b>2. Vehicle Particulars &amp; Condition</b>			
Make & Model		c.c	0
Engine No.	HIDDEN	Year of Reg.	
Chassis No.		Colour	
Odometer	-	Steering	
Brakes		Modification	
General			
<b>3. Conditions of Tyres</b>			
	Size	Make	Balance
R/H Front Tyre			mm
L/H Front Tyre			mm
R/H Rear Tyre			mm
L/H Rear Tyre			mm
<b>4. Description of Damages</b>			
<b>5. General Information</b>			
Accident Date	01/03/2018	Inspection Date	
Survey held at	PEGASUS ENGINEERING & TRADING PTE LTD 51 DEFU LANE 10 SINGAPORE 539216		
<b>5a. Remarks</b>			
A)THE INSPECTION WAS CONDUCTED ON A"WITHOUT PREJUDICE" BASIS. B)IN ACCORDANCE TO YOUR INSTRUCTIONS, WE HAVE NOT AUTHORISED REPAIRS.			

## Janice Lee (LKKAuto)

---

**From:** Janice Lee (LKKAuto)  
**Sent:** Thursday, March 08, 2018 3:26 PM  
**To:** 'Claim Workflow System'; assignments  
**Cc:** KARENTAN@MSFIRSTCAPITAL.COM.SG; SUR  
**Subject:** RE: SURVEY ASSESSMENT - D18001778MFSH/1  
**Attachments:** SLM 977X.pdf

Dear Sir/ Madam,

Enclosed preliminary revised for **SLM 977X**

Thank you.

Best Regards,

**Jannice Lee (Ms)** | Case Handler

**LKK Auto Consultants Pte Ltd**

Phone: 6256-3561 | email: [janicelee@lkkauto.com](mailto:janicelee@lkkauto.com) | fax: 6256-4315

Blk 51, Paya Ubi Industrial Park, Ubi Avenue 1, #02-25 | S(408933)

---

**From:** Admin-D (LKKAuto)  
**Sent:** Monday, March 05, 2018 3:44 PM  
**To:** 'Claim Workflow System' <[cwsmotorclaims@msfirstcapital.com.sg](mailto:cwsmotorclaims@msfirstcapital.com.sg)>; assignments <[assignments@lkkauto.com](mailto:assignments@lkkauto.com)>  
**Cc:** KARENTAN@MSFIRSTCAPITAL.COM.SG; SUR <[sur@lkkauto.com](mailto:sur@lkkauto.com)>  
**Subject:** RE: SURVEY ASSESSMENT - D18001778MFSH/1

Dear Sir/Mdm,

Thank you for the assignment.

BEST REGARDS,

**G.Nivitha** | Admin

**LKK Auto Consultants Pte Ltd**

Phone: 6841-1972 | email: [assignments@lkkauto.com](mailto:assignments@lkkauto.com) | fax: 6256-4315

Blk 51, Paya Ubi Industrial Park, Ubi Avenue 1, #02-25 | S(408933)

**From:** Claim Workflow System [<mailto:cwsmotorclaims@msfirstcapital.com.sg>]  
**Sent:** Monday, 5 March 2018 3:40 PM  
**To:** [ASSIGNMENTS@LKKAUTO.COM](mailto:ASSIGNMENTS@LKKAUTO.COM)  
**Cc:** [CWSMOTORCLAIMS@MSFIRSTCAPITAL.COM.SG](mailto:CWSMOTORCLAIMS@MSFIRSTCAPITAL.COM.SG); [KARENTAN@MSFIRSTCAPITAL.COM.SG](mailto:KARENTAN@MSFIRSTCAPITAL.COM.SG)  
**Subject:** PRI: SURVEY ASSESSMENT - D18001778MFSH/1

Dear Sir/Mdm,

We refer to the above reference.

Please find attached the necessary documents for survey.

Kindly submit your report via CWS within the next 14 days.

## SINGAPORE ACCIDENT STATEMENT

### IMPORTANT NOTICE

1. Please report correctly the details of the accident to speed up the claims process.
2. This Form must be completed by the Policyholder and/or the Authorised Driver.
3. Information provided must be as truthful and accurate as possible. Any wilful misrepresentation or withholding of material facts may allow insurance companies to repudiate policy ability.
4. The issue and acceptance of this Form by insurance companies is not an admission of policy liability on the part of the insurance companies.
5. Any false reporting may be referred to the Police for investigation.
6. This report will be forwarded by the insurers of the GIA Records Management Centre established by the General Insurance Association of Singapore (GIA) for archiving and that copies of this report will, for a fee, be made available upon application by interested parties.
7. By the lodgement of this report to the insurers, you hereby consent to the archiving of this report at the centre and to copies of the report being made available aforesaid.

### ACCIDENT STATEMENT

Date Of Report	01/03/2018 14:54
Date Of Accident	01/03/2018 09:45
Exact Location Of Accident	MARINA BOULEVARD
Country/State of Loss	SINGAPORE

### DETAILS OF OWN VEHICLE

Vehicle Registration Number	SLM977X
<b>Insured/Policyholder</b>	
Name Of Registered Owner	GRAB RENTALS PTE LTD
Co Reg No	201617200G
Email Address	NOEMAIL
Mobile Phone No	
Alternative Phone No	OFFICE-98235866

### Vehicle Particulars

Manufacturer	TOYOTA
Model	VIOS-1.5 E (A)
Exact Purpose for which vehicle was being used at time of accident	HIRE AND REWARD
Are you claiming under your own insurance policy for repair to your vehicle?	NO
If No, Please state action to be taken	THIRD PARTY
Vehicle Category	PRIVATE HIRE

### Insurance Company

Name of Insurance Company	MSIG INSURANCE (SINGAPORE) PTE. LTD.
Type Of Coverage	COMPREHENSIVE
Fleet Policy	YES
Policy Number	A29069766MKF
Cover Note Number	

### Driver

Name of Driver	GOH SAN HWEE
NRIC No	S1470498A
Date Of Birth	21/07/1961
Occupation	OUTDOOR
Date Of Driving Pass	16/12/1981
Driving Experience	36 YEARS AND 2 MONTHS
Gender	MALE
Mobile Number	(LOCAL) +65-98758184
Fax Number	
Contact Number	
EMail Address	JOHNWEE0721@GMAIL.COM

Address	BLOCK 2 HOUGANG AVENUE 3 #06-276
Postcode	530002
Was driver an employee of the Insured's Company	NO
If No, Relationship of the Driver with the Insured	OTHER - HIRER
Vehicle Registration Number of Driver's Own Vehicle	-
	-
	-
Insurance Company of Driver's Own Vehicle	-
	-
	-

#### General Information of the Accident

Type Of Accident	CHAIN COLLISION
Weather Conditions	CLEAR
Road Surface	DRY

#### Other Information

Was any foreign vehicle involved in this accident?	NO
Number of vehicles involved in the accident	
Was any body injured in the Accident?	NO
Was any injured conveyed to hospital by ambulance?	
Was any other material or property damaged?	YES
I have been approached by unknown person(s) soliciting/offering accident claims assistance.	NO
Number of Passengers (Including Driver)	2
Passenger 1	NAME: : UNKNOWN GENDER: : MALE

#### Details of Police Action

Was the accident reported to the police?	NO
If Yes, Please state which Police Station	
Was notice of intended Prosecution given?	NO
If Yes, against whom?	

#### Circumstances of Accident

On 03.01.2018 at about 0945 hours, I was driving my vehicle (A: SLM977X) along 2nd lane of Marina Boulevard. The traffic was massive, vehicles ahead stopped and I followed suit. Out of sudden, I felt an impact which vehicle (B: SHA3896L) hit onto the rear portion of my vehicle. After the impact, my vehicle was pushed forward and hit onto the rear portion of vehicle (C: SLM2237B) which ahead of me. After alighted, I realized that it was a chain collision involved total of 3 vehicles. No one was injured at the scene. Vehicle A: 1 passenger onboard Vehicle B: 1 passenger onboard Vehicle C: unaware passenger onboard

#### Attachment(s)

Are accident photos available for attachment?	YES
Was there any video captured by Car Camera?	NO
Was there any audio recorded?	NO

#### DETAILS OF OTHER VEHICLE PROPERTY 1

Vehicle Registration Number	SHA3896L
Vehicle Make/Model/Colour	
Details Of Properties	
Vehicle Category	TAXI
Name of Driver	
NRIC/Passport Number	
Contact Number	96713095
Address	
Postcode	

Insurance Company Name

Nature Of Damage

No. Of Passenger (Including Driver)

#### DETAILS OF OTHER VEHICLE PROPERTY 2

Vehicle Registration Number

SLM2237B

Vehicle Make/Model/Colour

Details Of Properties

Vehicle Category

PRIVATE HIRE

Name of Driver

NRIC/Passport Number

Contact Number

97331818

Address

Postcode

Insurance Company Name

Nature Of Damage

No. Of Passenger (Including Driver)



# **SKETCH PLAN**

## **IMPORTANT NOTICE**

1. Please report correctly the details of the accident to speed up the claims process.
2. This Form must be completed by the Policyholder and/or the Authorised Driver.
3. Information provided must be as truthful and accurate as possible. Any wilful misrepresentation or withholding of material facts may allow insurance companies to repudiate policy liability.
4. The issue and acceptance of this Form by insurance companies is not an admission of policy liability on the part of the insurance companies.
5. Any false reporting may be referred to the Police for investigation.
6. The report will be forwarded by the insurers of the GIA Records Management Centre established by the General Insurance Association of Singapore (GIA) for archiving and that copies of this report will for a fee be made available upon application by interested parties.
7. By the lodgment of this report to the insurers, you hereby consent to the archiving of this report at the centre and to copies of the report being made available aforesaid.

## **8. Consent under the Personal Data Protection Act (PDPA)**

I understand, acknowledge, agree and consent that:

- (a) My insurer, my workshop and the General Insurance Association of Singapore ("GIA") may/are permitted to collect, use, disclose and/or process my personal data/personal information set out in this [form] and any other personal information provided by me or possessed by my insurer (collectively the "Personal Information") and disclose and transfer such Personal Information to all insurer(s) who have insured vehicle(s) involved in this accident (all insurer(s) who have insured vehicle(s) involved in this accident shall be collectively referred to as the "Insurers"), the Insurers' lawyers/law firms, the Monetary Authority of Singapore and any relevant government agency/authority (such as the police), for the purpose(s) of:
  - (i) processing, handling and/or dealing with my claims including the settlement of the claims and any necessary investigations relating to the claims;
  - (ii) investigating the accident and/or my claims;
  - (iii) carrying out and/or dealing with my instructions or responding to any enquiries by me;
  - (iv) administering my claims (including the mailing of correspondence, statements, invoices, reports or notices to me, which could involve disclosure of certain personal data about me to bring about delivery of the same as well as on the external cover of envelopes/mail packages); and/or
  - (v) complying with applicable law in administering, processing, handling and/or dealing with my claims (collectively the "Purposes")
- (b) all insurer(s) who have insured vehicle(s) involved in this accident and the Insurers' lawyers/law firms, may/are permitted to collect, use, disclose and/or process my Personal Information for one or more of the above Purposes; and
- (c) my Personal Information may/can be disclosed by any of the insurers and/or GIA to their third party service providers or agents (including their lawyers/law firms), which may be sited outside of Singapore, for one or more of the above Purposes.
- (d) my Personal Information will also be collected and used to compile claims history for the purpose of fraud detection, investigation and management in present and all future claims.
- (e) the information so collected under (d) above may be shared / disclosed:
  - (i) to all insurers and/or any other third parties that assist in evaluating, investigating, controlling or managing fraud, regulators, law enforcement and government agencies as reasonably required for the purposes stated, or
  - (ii) for complying with requirements under any regulations, laws or court orders.

Policyholder's Signature  
Date & Time:

Driver's Signature  
(If driver is not the policyholder)  
Date & Time: 01/03/2019 @  
1030hrs

Reporting Centre Personnel's Signature  
Name: Tan Ai Lan  
NRIC/FIN No.: S7236742A

SKETCH PLAN

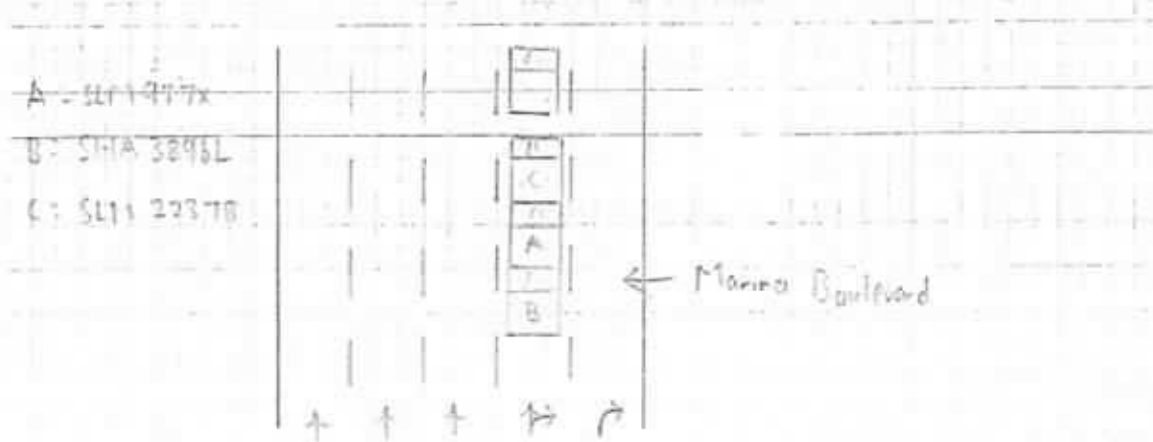

DESCRIBE CIRCUMSTANCES OF THE ACCIDENT

Refer to GIA Report

DECLARATION

I/We declare the foregoing particulars are true in every respect.

Policyholder's Signature  
Date & Time:

Driver's Signature  
(If driver is not the policyholder)  
Date & Time: 01.03.2018 @

Reporting Centre Personnel's Signature  
Name: Tan A' Lan  
NRIC/FIN No.: S7236742A

1030hrs

## \* Enquire PARF/COE Rebate for Registered Vehicle

Vehicle Owner Particulars	
Owner ID Type:	Company
Owner ID:	7200G
Vehicle Details	
Vehicle No.:	SLM977X
Vehicle to be Exported:	Yes
Intended De-registration Date:	01 Mar 2018
Vehicle Make:	TOYOTA
Vehicle Model:	VIOS 1.5E CVT
Primary Colour:	Silver
Manufacturing Year:	2017
Engine No.:	2NRX134835
Chassis No.:	MHFB29F3602008136
Maximum Power Output:	79.0 kW (105 bhp)
Open Market Value:	\$12,946.00
Original Registration Date:	21 Mar 2017
First Registration Date:	21 Mar 2017
Transfer Count:	0
Actual ARF Paid:	\$7,946.00
Intended PARF Rebate Details	
PARF Eligibility:	Yes
PARF Eligibility Expiry Date:	20 Mar 2027
PARF Rebate Amount:	\$5,959.00
Intended COE Rebate Details	
COE Expiry Date:	20 Mar 2027
COE Category:	A - Car up to 1600cc & 97kW (130bhp)
COE Period(Years):	10
QP Paid:	\$50,101.00
COE Rebate Amount:	\$40,080.00
<b>Total Rebate Amount:</b>	<b>\$46,039.00</b>

The information contained herein is correct as at 01 Mar 2018

OK

Enquire PARF/COE Rebate for Registered Vehicle

Vehicle Owner Particulars	
Owner ID Type:	Company
Owner ID:	7200G
Vehicle Details	
Vehicle No.:	SLM977X
Vehicle to be Exported:	No
Intended De-registration Date:	06 Mar 2018
Vehicle Make:	TOYOTA
Vehicle Model:	VIOS 1.5E CVT
Primary Colour:	Silver
Manufacturing Year:	2017
Engine No.:	2NRX134835
Chassis No.:	MHFB29F3602008136
Maximum Power Output:	79.0 kW (105 bhp)
Open Market Value:	\$12,946.00
Original Registration Date:	21 Mar 2017
First Registration Date:	21 Mar 2017
Transfer Count:	0
Actual ARF Paid:	\$7,946.00
Intended PARF Rebate Details	
PARF Eligibility:	Yes
PARF Eligibility Expiry Date:	20 Mar 2027
PARF Rebate Amount:	\$5,959.00
Intended COE Rebate Details	
COE Expiry Date:	20 Mar 2027
COE Category:	A - Car up to 1600cc & 97kW (130bhp)
COE Period(Years):	10
QP Paid:	\$50,101.00
COE Rebate Amount:	\$45,279.00
Total Rebate Amount:	\$51,238.00

The information contained herein is correct as at 06 Mar 2018

OK

# PEGASUS ENGINEERING & TRADING PTE LTD

GST / ROC COMPANY NO : 201101753C

## Quotation

**From :**

**PEGASUS ENGINEERING & TRADING PTE LTD**  
C/O 51 DEFU LANE 10  
539216

Officer in Charge : ALVIN LOW WAI LUN  
Tel :  
Email :

**Customer :**

**GRAB RENTALS PTE LTD**  
18 SIN MING LANE  
#01-08 MIDVIEW CITY  
SINGAPORE 573960

Attn : *U/S \$8700*  
Tel : *06-03 @ 1040*  
Fax : *U/S*

*not Arthur Link*  
*U/S*  
*she phd. Atty.*  
*8/3/18*  
*9dy.*

Quotation No : QO18/03-1007	Quotation Date : 01/03/2018	Terms : 30 DAYS
Vehicle No : SLM977X	Chassis No : MHFB29F3602008136	Third Party Insurer :
Model : VIOS		Date of Accident :
Remarks : TP INSURER: FIRST CAPITAL, INSURED'S VEH NO: SHA3896L, DATE OF ACCIDENT: 01.03.2018		

ITEM	DESCRIPTION	QTY	UNIT PRICE	AMOUNT (SGD)	
1	BOOTLID	1 <i>DS/Bue</i>	762.4700	762.47	✓
2	BOOTLID LOCK	1 <i>Tuy</i>	90.4000	90.40	✓
3	BOOTLID LOCK STRIKER	1 <i>11</i>	18.5000	18.50	X
4	BOOTLID WEATHERSTRIP	1 <i>Tuy</i>	188.0000	188.00	✓
5	BOOTLID VIOS BADGE	1 <i>rec</i>	44.1000	44.10	✓
6	BOOTLID E BADGE	1 <i>rec</i>	34.4000	34.40	✓
7	BOOTLID OUTER GARNISH	1 <i>R</i>	164.7000	164.70	X
8	BOOTLID CENTER LOGO BADGE	1 <i>rec</i>	59.8000	59.80	✓
9	BOOTLID INNER TRIM COVER CLIPS	4 <i>11</i>	4.3000	17.20	X
10	BOOTLID HINGE	2 <i>DS/Bue</i>	79.8000	159.60	W
11	BOOTLID LOCK CABLE CLIPS	3 <i>11</i>	4.3000	12.90	X
12	REAR LICENCE PLATE LAMP	2 <i>11</i>	48.5000	97.00	X
13	REAR END PANEL	1 <i>30d/10</i>	694.7000	694.70	✓
14	REAR END PANEL INNER TRIM	1 <i>TW/1</i>	234.3000	234.30	✓
15	REAR BUMPER	1 <i>DJ</i>	504.9000	504.90	✓
16	REAR BUMPER REINFORCEMENT	1 <i>DJ</i>	323.2000	323.20	✓
17	REAR BUMPER SIDE RETAINER	2 <i>rec</i>	116.3000	232.60	✓
18	REAR BUMPER SIDE HOLDER	2 <i>rec</i>	22.3000	44.60	✓
19	REAR BUMPER CLIPS	10 <i>rec</i>	4.3000	43.00	✓
20	REAR BUMPER REFLECTOR	2 <i>MS/ine</i>	130.5000	261.00	1/p
21	REAR BUMPER END SPLASHIED COVER	2 <i>11</i>	89.8000	179.60	X
22	REAR LAMP	2 <i>ene</i>	375.8000	751.60	✓
23	REAR LAMP CLIP HOLDER	4 <i>11</i>	22.3000	89.20	X

C/F 0.00

# PEGASUS ENGINEERING & TRADING PTE LTD

GST / ROC COMPANY NO : 201101753C

## Quotation

<b>From :</b> <b>PEGASUS ENGINEERING &amp; TRADING PTE LTD</b> C/O 51 DEFU LANE 10 539216 Officer in Charge : ALVIN LOW WAI LUN Tel : Email :	<b>Customer :</b> <b>GRAB RENTALS PTE LTD</b> 18 SIN MING LANE #01-08 MIDVIEW CITY SINGAPORE 573960 Attn : Tel : Fax :
---	---

<b>Quotation No :</b> QO18/03-1007	<b>Quotation Date :</b> 01/03/2018	<b>Terms :</b> 30 DAYS
<b>Vehicle No :</b> SLM977X	<b>Chassis No :</b> MHFB29F3602008136	<b>Third Party Insurer :</b>
<b>Model :</b> VIOS	<b>Date of Accident :</b>	
<b>Remarks :</b> TP INSURER: FIRST CAPITAL, INSURED'S VEH NO: SHA3896L, DATE OF ACCIDENT: 01.03.2018		

ITEM	DESCRIPTION	QTY	UNIT PRICE	AMOUNT (SGD)
				B/F 0.00
24	REAR LAMP PANEL	2	694.7000	1,389.40 X
25	REAR LUGGAGE FLOOR PANEL	1 <i>complete</i>	787.6000	787.60 L
26	REAR LUGGAGE FLOOR PANEL INSULATOR FOAM	2	108.2000	216.40 H
27	SPARE TYRE CLAMP	1	29.8000	29.80 X
28	SPARE TYRE CARDBOARD	1	145.0000	145.00 —
29	REAR EXHAUST BOX	1	638.8000	638.80 X
30	REAR EXHAUST BOX HEAT SHIELD	1	46.6000	46.60 X
31	REAR EXHAUST BOX MOUNT	2	78.9000	157.80 X
32	REAR FENDER INNER TRIM	2	58.1000	116.20 X
33	REAR FENDER INNER TRIM CLIPS	10	4.3000	43.00 X
34	BONNET	1	757.3000	757.30 —
35	BONNET INSULATOR CLIPS	6	4.3000	25.80 —
36	BONNET LOCK	1	128.9000	128.90 —
37	FRONT BUMPER	1	427.0000	427.00 —
38	FRONT BUMPER REINFORCEMENT	1	379.2000	379.20 —
39	FRONT BUMPER AIR GUIDE TOP	2	77.0000	154.00 X
40	FRONT BUMPER AIR GUIDE BOTTOM	2	59.7000	119.40 X
41	FRONT BUMPER AIR GUIDE CLIPS	6	4.3000	25.80 —
42	FRONT BUMPER CENTER AIR GRILLE	1	276.2000	276.20 —
43	FRONT BUMPER CENTER AIR GRILLE TOW COVER	1	52.4000	52.40 X
44	FRONT BUMPER CHROME GARNISH	2	66.8000	133.60 —
45	FRONT BUMPER OUTER GARNISH	1	87.8000	87.80 X

C/F 0.00

# PEGASUS ENGINEERING & TRADING PTE LTD

GST / ROC COMPANY NO : 201101753C

## Quotation

<b>From :</b> <b>PEGASUS ENGINEERING &amp; TRADING PTE LTD</b> C/O 51 DEFU LANE 10 539216  Officer in Charge : ALVIN LOW WAI LUN Tel : Email :	<b>Customer :</b> <b>GRAB RENTALS PTE LTD</b> 18 SIN MING LANE #01-08 MIDVIEW CITY SINGAPORE 573960  Attn : Tel : Fax :
---	---

<b>Quotation No :</b> QO18/03-1007	<b>Quotation Date :</b> 01/03/2018	<b>Terms :</b> 30 DAYS
<b>Vehicle No :</b> SLM977X	<b>Chassis No :</b> MHFB29F3602008136	<b>Third Party Insurer :</b>
<b>Model :</b> VIOS	<b>Date of Accident :</b>	
<b>Remarks :</b> TP INSURER: FIRST CAPITAL, INSURED'S VEH NO: SHA3896L, DATE OF ACCIDENT: 01.03.2018		

ITEM	DESCRIPTION	QTY	UNIT PRICE	AMOUNT (SGD)
			B/F	0.00
46	FRONT BUMPER EMBLEM BADGE	1	97.4000	97.40
47	FRONT BUMPER CLIPS	8	4.3000	34.40
48	FRONT BUMPER SIDE RETAINER	2	588.1000	1,176.20
49	HEAD LAMP	2	65.7000	131.40
50	LESS 25% ITEM (1-49)	1	-3,146.2900	-3,146.29
51	REAR LICENCE PLATE	1	80.0000	80.00
52	REAR BUMPER PARKING SENSOR	1	400.0000	400.00
53	REAR LUGGAGE FLOOR INSULATOR	1	250.0000	250.00
54	TO CHECK ELECTRICAL LIGHTING CONCERNED.	1	60.0000	60.00
55	TO RUST-PROOFING OF THE AFFECTED AREAS.	1	280.0000	280.00
56	TO REINSTALL OF REAR BUMPER PARKING SENSOR.	1	120.0000	120.00
57	TO REMOVE AND REFIT INTERIOR FITTINGS, TRIMMINGS, GARNISH AND OTHER, TO ENABLE REPAIR.	1	180.0000	180.00
58	TO TRANSFER OF BOOTLID FITTINGS, ATTACHMENTS AND PERFORM WATER SEEPAGE TEST.	1	150.0000	150.00
59	TO DROP REAR EXHAUST BOX AND RENEW THE SAME.	1	150.0000	150.00
60	TO PLACE VEHICLE ON JIG BENCH TO OBTAIN CROSS AND PARALLEL MEASUREMENT AND CORRECT TO MANUFACTURER SPECIFICATION WITH HYDRAULIC PNEUMATIC JACK.	1	800.0000	800.00
61	TO DROP PETROL TANK, HOSES TO FACILITATE BODYWORK REPAIR, FINAL CHECKING AND TESTING.	1	180.0000	180.00
62	PANEL BEATING, KNOCKING AND STRAIGHTEN THE NECESSARY PORTION, REMOVE AND RENEWAL OF PARTS, ADJUST AND REALIGN THE SAME.	1	2,600.0000	2,600.00
63	PUTTY AND SPRAY PAINTING OF THE AFFECTED PORTION.	1	1,600.0000	1,600.00

C/F 0.00

Page 3 of 4

4160

# PEGASUS ENGINEERING & TRADING PTE LTD

GST / ROC COMPANY NO : 201101753C

## Quotation

<b>From :</b> PEGASUS ENGINEERING & TRADING PTE LTD C/O 51 DEFU LANE 10 539216 Officer in Charge : ALVIN LOW WAI LUN Tel : Email :	<b>Customer :</b> GRAB RENTALS PTE LTD 18 SIN MING LANE #01-08 MIDVIEW CITY SINGAPORE 573960 Attn : Tel : Fax :
--	--

<b>Quotation No :</b> QO18/03-1007	<b>Quotation Date :</b> 01/03/2018	<b>Terms :</b> 30 DAYS
<b>Vehicle No :</b> SLM977X	<b>Chassis No :</b> MHFB29F3602008136	<b>Third Party Insurer :</b>
<b>Model :</b> VIOS		<b>Date of Accident :</b>
<b>Remarks :</b> TP INSURER: FIRST CAPITAL, INSURED'S VEH NO: SHA3896L, DATE OF ACCIDENT: 01.03.2018		

ITEM	DESCRIPTION	QTY	UNIT PRICE	AMOUNT (SGD)
			B/F	0.00



<b>Sub Total</b>	16,288.88
<b>GST(7.00%)</b>	1,140.22
<b>Total (SGD)</b>	17,429.10

Please conduct the survey at  
Pegasus Engineering @ Tan Lim Motor Pte Ltd c/o 51 Defu Lane 10 Singapore 539216





# LKK Auto Consultants Pte Ltd

51 Ubi Ave 1 #01-25 Paya Ubi Industrial Park, Singapore 408933

TEL: 6256 3581 FAX: 6256 4315

Reg. No: 199607198R GST Reg. No. 19-9607198-R

Affiliated to Federation Internationale Des Experts En Automobile

FIRST CAPITAL INSURANCE LTD

Ref : CS/FCI18004229/Urd3q2

36 ROBINSON ROAD  
#16-01 CITY HOUSESINGAPORE 068877

Date : 26-03-2018



Code : FCI2

## 1. Policy Particulars :- THIRD PARTY CLAIM

Insured Veh.	SHA 3896L	Veh. Inspected	SLM 977X
Policy No.	D-18088936MFSH	Coverage (\$)	0.00
Claim No.	D18001778MFSH	Excess (\$)	0.00
Assign From	KAREN TAN	Assign Date	05/03/2018

## 2. Vehicle Particulars & Condition

Make & Model	TOYOTA VIOS (A)	c.c	1496
Engine No.	HIDDEN	Year of Reg.	2017
Chassis No.	MHFB29F3602008136	Colour	SILVER
Odometer	55829	Steering	IN ORDER
Brakes	IN ORDER	Modification	SPORTS RIM
General	GOOD		

## 3. Conditions of Tyres

	Size	Make	Balance
R/H Front Tyre	195/50 R16	BRIDGESTONE	7 mm
L/H Front Tyre	195/50 R16	BRIDGESTONE	7 mm
R/H Rear Tyre	195/50 R16	BRIDGESTONE	7 mm
L/H Rear Tyre	195/50 R16	BRIDGESTONE	7 mm

## 4. Description of Damages

THE VEHICLE SUSTAINED DAMAGES AT THE REAR & FRONT PORTION. DAMAGES SEE DETAILS.
--

## 5. General Information

Accident Date	01/03/2018	Inspection Date	06/03/2018
Survey held at	PEGASUS ENGINEERING & TRADING PTE LTD 51 DEFU LANE 10 SINGAPORE 539216		

## 5a. Remarks

A)THE INSPECTION WAS CONDUCTED ON A"WITHOUT PREJUDICE" BASIS. B)IN ACCORDANCE TO YOUR INSTRUCTIONS, WE HAVE NOT AUTHORISED REPAIRS.
--

## 5b. Estimate Days of Repair

ESTIMATED NORMAL PERIOD FOR REPAIR:	9 Working Days
-------------------------------------	----------------



# LKK Auto Consultants Pte Ltd

51 Ubi Ave 1 #01-25 Paya Ubi Industrial Park, Singapore 408933

TEL: 6256 3561 FAX: 6256 4315

Reg. No: 199607198R GST Reg. No. 19-9607198-R

Page No.:1 of 3

## ADJUSTMENT ON REPAIR COST FOR VEHICLE NO. SLM 977X

Qty	Description of Parts	Condition	Estimate By Workshop (\$)	Our Adjusted (\$)
	<b><u>REPLACEMENT OF PARTS</u></b>			
1	BOOTLID	DENTED / BUCKLED	762.47	762.47
1	BOOTLID LOCK	TWISTED	90.40	90.40
1	BOOTLID LOCK STRIKER	NOT NECESSARY	18.50	-
1	BOOTLID WEATHERSTRIP	TWISTED	188.00	188.00
1	BOOTLID VIOS BADGE	NECESSARY	44.10	44.10
1	BOOTLID E BADGE	NECESSARY	34.40	34.40
1	BOOTLID OUTER GARNISH	TO REPAIR SEE LABOUR	164.70	-
1	BOOTLID CENTER LOGO BADGE	NECESSARY	59.80	59.80
4	BOOTLID INNER TRIM COVER CLIPS @\$4.30	NOT NECESSARY	17.20	-
2	BOOTLID HINGE @\$79.80	N/S BENT	159.60	79.80
3	BOOTLID LOCK CABLE CLIPS @\$4.30	NOT NECESSARY	12.90	-
2	REAR LICENCE PLATE LAMP @\$48.50	NOT NECESSARY	97.00	-
1	REAR END PANEL	BADLY DENTED	694.70	694.70
1	REAR END PANEL INNER TRIM	TWISTED	234.30	234.30
1	REAR BUMPER	DISTORTED	504.90	504.90
1	REAR BUMPER REINFORCEMENT	DISTORTED	323.20	323.20
2	REAR BUMPER SIDE RETAINER @\$116.30	BENT	232.60	232.60
2	REAR BUMPER SIDE HOLDER @\$22.30	BENT	44.60	44.60
10	REAR BUMPER CLIPS @\$4.30	NECESSARY	43.00	43.00
2	REAR BUMPER REFLECTOR @\$130.50	N/S CRACKED	261.00	130.50
2	REAR BUMPER END SPLASHIED COVER @\$89.80	NOT NECESSARY	179.60	-
2	REAR LAMP @\$375.80	CRACKED	751.60	751.60
4	REAR LAMP CLIP HOLDER @\$22.30	NOT NECESSARY	89.20	-
2	REAR LAMP PANEL @\$694.70	TO REPAIR SEE LABOUR	1,389.40	-
1	REAR LUGGAGE FLOOR PANEL	CRUMPLED / BUCKLED	787.60	787.60
2	REAR LUGGAGE FLOOR PANEL INSULATOR FOAM @\$108.20	N/S TORN	216.40	108.20
1	SPARE TYRE CLAMP	NOT NECESSARY	29.80	-

Report Ref No. CS/FCI18004229/Urd3q2



# LKK Auto Consultants Pte Ltd

51 Ubi Ave 1 #01-25 Paya Ubi Industrial Park, Singapore 408933

TEL: 6256 3561 FAX: 6256 4315

Reg. No: 199607198R GST Reg. No. 19-9607198-R

Page No.:2 of 3

Qty	Description of Parts	Condition	Estimate By Workshop (\$)	Our Adjusted (\$)
1	SPARE TYRE CARDBOARD	TORN	145.00	145.00
1	REAR EXHAUST BOX	TO REPAIR SEE LABOUR	638.80	-
1	REAR EXHAUST BOX HEAT SHIELD	NOT NECESSARY	46.60	-
2	REAR EXHAUST BOX MOUNT @\$78.90	NOT NECESSARY	157.80	-
2	REAR FENDER INNER TRIM @\$58.10	NOT NECESSARY	116.20	-
10	REAR FENDER INNER TRIM CLIPS @\$4.30	NOT NECESSARY	43.00	-
1	BONNET	DENTED / BENT	757.30	757.30
6	BONNET INSULATOR CLIPS @\$4.30	NECESSARY	25.80	25.80
1	BONNET LOCK	TWISTED	128.90	128.90
1	FRONT BUMPER	TORN	427.00	427.00
1	FRONT BUMPER REINFORCEMENT	DENTED / BENT	379.20	379.20
2	FRONT BUMPER AIR GUIDE TOP @\$77.00	NOT NECESSARY	154.00	-
2	FRONT BUMPER AIR GUIDE BOTTOM @\$59.70	NOT NECESSARY	119.40	-
6	FRONT BUMPER AIR GUIDE CLIPS @\$4.30	NECESSARY	25.80	25.80
1	FRONT BUMPER CENTER AIR GRILLE	TWISTED	276.20	276.20
1	FRONT BUMPER CENTER AIR GRILLE TOW COVER	NOT NECESSARY	52.40	-
2	FRONT BUMPER CHROME GARNISH @\$66.80	NECESSARY	133.60	133.60
1	FRONT BUMPER OUTER GARNISH	NOT NECESSARY	87.80	-
1	FRONT BUMPER EMBLEM BADGE	NECESSARY	97.40	97.40
8	FRONT BUMPER CLIPS @\$4.30	NECESSARY	34.40	34.40
2	FRONT BUMPER SIDE RETAINER 65.70	BENT	131.40	131.40
2	HEAD LAMP @\$588.10	BENT	1,176.20	1,176.20
	LESS 25% DISCOUNT		-3,146.29	-2,213.09
			9,438.88	6,639.28
	<b><u>SPECIAL NETT ITEMS</u></b>			
1	REAR LICENCE PLATE (SN)	BENT	80.00	40.00
1	REAR BUMPER PARKING SENSOR (SN)	SHORTED	400.00	200.00
1	REAR LUGGAGE FLOOR INSULATOR (SN)	NECESSARY	250.00	120.00
			730.00	360.00
	<b><u>LABOUR</u></b>			
	TO CHECK ELECTRICAL LIGHTING CONCERNED.		60.00	30.00
	TO RUST-PROOFING ON THE AFFECTED AREAS.		280.00	120.00

Report Ref No. CS/FCI18004229/Urd3q2



# LKK Auto Consultants Pte Ltd

51 Ubi Ave 1 #01-25 Paya Ubi Industrial Park, Singapore 408933

TEL: 6256 3561 FAX: 6256 4315

Reg. No: 199607198R GST Reg. No. 19-9607198-R

Page No.:3 of 3

Qty	Description of Parts	Condition	Estimate By Workshop (\$)	Our Adjusted (\$)
	TO REINSTALL OF REAR BUMPER PARKING SENSOR .		120.00	50.00
	TO REMOVE AND REFIT INTERIOR FITTINGS ,TRIMMINGS ,GARNISH AND OTHER ,TO ENABLE REPAIR.		180.00	80.00
	TO TRANSFER OF BOOTLID FITTINGS ,ATTACHMENTS AND PERFORM WATER SEEPAGE TEST.		150.00	60.00
	TO DROP REAR EXHAUST BOX AND RENEW THE SAME.	NOT NECESSARY	150.00	-
	TO PLACE VEHICLE ON JIG BENCH TO OBTAIN CROSS AND PANELLEL MEASUREMENT AND CORRECT TO MANUFACTURER SPECIFICATION WITH HYDRAULIC PNEUMATIC JACK.	NOT NECESSARY	800.00	-
	TO DROP PETROL TANK ,HOSES TO FACILITATE BODYWORK REPAIR,FINAL CHECKING AND TESTING.		180.00	60.00
	PANEL BEATING ,KNOCKING AND STRAIGHTEN THE NECESSARY PORTION ,REMOVE AND RENEWAL OF PARTS ,ADJUST AND REALIGN THE SAME.INCLUSIVE OF THE REPAIR OF BOOTLID OUTER GARNISH,REAR LAMP PANEL AND REAR EXHAUST BOX .		2,600.00	2,000.00
	PUTTY AND SPRAY PAINTING OF THE AFFECTED PORTION.		1,600.00	1,500.00
			6,120.00	3,900.00
<b>GRAND TOTAL</b>			<b>16,288.88</b>	<b>10,899.28</b>
<b>RECOMMENDED COST OF LUMP SUM REPAIRS (TO ITS PRE-ACCIDENT CONDITION)</b>				<b>8,700.00</b>

Report Ref No. CS/FCI18004229/Urd3q2

CHUA KANG SENG

Licensed Appraiser

**DISCLAIMER OF LIABILITY TO THIRD PARTIES:-** This Report is made solely for the use and benefit of the Client named on the front page of this Report.

No liability of responsibility whatsoever, in contract or tort, is accepted to any third party who may rely on the Report wholly or in part. Any third party acting or relying on this Report, in whole or in part, does so at his or her own risk.