

ASS. REF. BY:

REF: CS/MSG18003922 / Kt b02 Special Instruction:

Surveyor:

ASSIGNMENT (Office)

mefimen

From (Person): Catherine Thia

of

MSLH

Date/Time: 27/02/2018 5:26pm

Estimated Cost:

Bill to:

OD / ~~TP~~ / WS / TP RES / OD RES / EVA / INV / MV / CS

To Inspect Vehicle No:

SLF 5830P

Insured:

FBE 9076P

at Workshop m/s

Esteem Performance

Tel:

of

385 Sim Ming Dhr

Policy No:

MSD/VMS/17-366281-CA

Claim No:

MSC/V/18-000297

Sum Insured:

Excess:

Make of Veh:

D.O.A.

27/02/2018

(Client's Record)

CA / REV / REP. / REV 24 HRS WPI

H.O.D. Endorsement:

Date/Time:

28-02-2018 12:11pm

Person Contacted:

Carmen

Vehicle IN / ~~OUT~~

Date/Time

Action/Instruction (✓) Estimate

SLF 5830P - X

FBE 9076P - NA / MSG18003574 / Kt

D.O.A.: 27/02/18

29/3 L1 Rep @ 1800 Ca final by end (Pld: 2513-56.61%)

MSIG

ASSIGNMENT

Date 02/03/18

Ver No SLF5830P Reg 08 16

Estimated Cost

Type ☒ Car ☐ M/Cycle ☐ Bus/Van ☐ Lorry ☐ Taxi ☐ Home MotorOD ☒ WS ☐ TP RES ☐ OD RES ☐ EVA ☐ INV ☐ MY

To inspect vehicle No

SLF5830P

at Workshop this

Esteem Performance

Blk 5033, AMK Ind Prk 2 # 01-259

Insured

Policy No

Claims No

Sum Insured

Excess

Claims Record

Make of Vehicle

(Policy Condition)

Remark: The veh had commenced its repair at the time of inspection

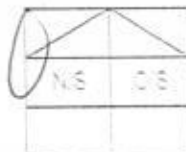

Est. or Market Value

DAC Accident Report

Consistent? Yes or No

O/A PR Seen

Consistent? Yes or No

Est. Repairs

03

Res. Yes or No

Cum Sum

20/1/18

3 Yr. Yes or No

CA / REV / REP / 24 HRS 'wp'

Date

Person Contacted

Vehicle IN / OUT

Make

Toy Prius A Hybrid 1788

Colour

M. P. White

Se Reading

129631

Eng No

Chassis

JTDKB31F-U 40353 1618

Gen Cond ☒ Good ☐ Fair ☐ Poor ☐ BurntSteering, In order ☒ Jammed ☐ Leaked ☐ Burnt orBrake In order ☒ Jammed ☐ Leaked ☐ Burnt orMod N/A ☒ SR ☐ STD ☐ R/R or

Tyre Size

= Yoko 195/65R15

= Agenc 19

BS / DUN / EXNOVA / GH / FS / LIZA / MID / OHTSU / PRI / SUN

TOYO / YOKO or

Front

Rear

R/Ba

9

R/Ba

5

L/Ba

9

L/Ba

5

D.O.A

22/2/18

D.O

2/3/18

Survey held at

Des of Damages: Fr / Rear / O/S / N/S / U/C / Roof/hood

MS PR body

The U/C / Chassis/frame / Body Structure referred to as to do so

Date Time Action / Instruction

5/3 Mr pass to Carline

29/3/2018

RECEIVED 02 APR 2018

Date Time File Pass to

29/3 Typist



Prel. Report

Final Report

Days Of Repair

3

Resurvey No. of Trip

1

Survey Fee

200

Transport

10

Total

210

Report Format

0

TP 1600

Add Fee

Site Fee

Fuel Fee

Tool Fee

Rep Fee



LKK Auto Consultants Pte Ltd

51 Ubi Ave 1 #01-25 Paya Ubi Industrial Park, Singapore 408933

TEL: 6256 3561 FAX: 6256 4315

Reg. No: 199607198R GST Reg. No. 19-9607198-R

Affiliated to Federation Internationale Des Experts En Automobile				
MSIG INSURANCE (SINGAPORE) PTE LTD		Ref : CS/MSG18003922/Ktb		
16 RAFFLES QUAY #24-01 HONG LEONG BLDG SINGAPORE 048581		Date : 28-02-2018		
		Code : MSG		
1. Policy Particulars :- THIRD PARTY CLAIM				
Insured Veh.	FBE 9096P	Veh. Inspected	SLF 5830P	
Policy No.	MSD/VMS/17-366281-CA	Coverage (\$)	0.00	
Claim No.	MSC/V/18-000297	Excess (\$)	0.00	
Assign From	MERIMEN (CATHERINE THIA)	Assign Date	27/02/2018	
2. Vehicle Particulars & Condition				
Make & Model	c.c		0	
Engine No.	HIDDEN	Year of Reg.		
Chassis No.		Colour		
Odometer	-	Steering		
Brakes		Modification		
General				
3. Conditions of Tyres				
	Size	Make	Balance	
R/H Front Tyre			mm	
L/H Front Tyre			mm	
R/H Rear Tyre			mm	
L/H Rear Tyre			mm	
4. Description of Damages				
5. General Information				
Accident Date	22/02/2018	Inspection Date		
Survey held at	385 SIN MING DRIVE			
Repairer	ESTEEM PERFORMANCE PTE LTD			
5a. Remarks				
A)THE INSPECTION WAS CONDUCTED ON A"WITHOUT PREJUDICE" BASIS. B)IN ACCORDANCE TO YOUR INSTRUCTIONS, WE HAVE NOT AUTHORISED REPAIRS.				

...CLAIM SUBFOLDER...(New Assignment)

CLAIM SUBFOLDER TRACKING

Case	Notified	Est Submitted	Adj Assigned	Adj Rpt	Adj Submitted	Ins Auth'd	Status
Main	26 Feb 2018		27 Feb 2018 17:26 Assign				New Assignment Cancel Case

Main	Reference	Claim Details	Documents	Show All
CLAIM SUBFOLDER DETAILS		[Created by insurer]		
Insured:	PALLIMATTATHIL SAIDUMUHAMMED HABEEB R, ID: G6009490Q, Tel: +6585220602, Email: HABEEB BRAHMANPS@GMAIL.COM			
Main Claimant:	GRAB RENTALS PTE LTD, Co. Reg. No.: 201617200G			
Vehicle Reg. No.:	SLF5830P	Date of Loss:	22/02/2018 18:00 - :59	
Claim Type:	TP / MSC/V/18-000297	Policy/Cover Note No.:	MSD/VMS/17-366281-CA (TP, Fire & Theft) Coverage: 14/06/2017 - 13/06/2018	
Vehicle Reg. No. (Insured):	FBE9096P	Policy No. (Claimant):		
		Excess:		
Repairer:	Esteem Performance Pte Ltd - Sin Ming (HQ) 385 Sin Ming Drive, 575718 Sin Ming - Tel:			
Handling Insurer:	MSIG Insurance (Singapore) Pte. Ltd. (HQ) - Tel: +65 6827 7888 ... [Handled by Catherine Thia Shi Yi - 6594 2545]			
Adjuster:	LKK Auto Consultants Pte Ltd (HQ) - Tel: 6256-3561 ... [Imm.Advice due 28/02/2018]			
Driver/Custodian (Insured):	PALLIMATTATHIL SAIDUMUHAMMED HABEEB R (34 / Male), NRIC: G6009490Q, Tel: +6585220602			
ASSOCIATED MAIL RECEIVED		View All Compose Case Mail		
There are no mail for this case.				
<div> <div> <div>ALL ASSOCIATED TASKS</div> <div> <div>Due Date</div> <div>Priority</div> <div>Type</div> <div>Task Group</div> <div>Subject</div> <div>Handler</div> <div>Assigned By</div> <div>Completed On</div> <div>Created On</div> <div>Done?</div> </div> </div> <div> View All Search Tasks Create New Task Complete </div> </div>				
No results.				

28/02/2018 @ 12:11 pm
Carmen veh not in

SINGAPORE ACCIDENT STATEMENT

IMPORTANT NOTICE

1. Please report correctly the details of the accident to speed up the claims process.
2. This Form must be completed by the Policyholder and/or the Authorised Driver.
3. Information provided must be as truthful and accurate as possible. Any wilful misrepresentation or withholding of material facts may allow insurance companies to repudiate policy ability.
4. The issue and acceptance of this Form by insurance companies is not an admission of policy liability on the part of the insurance companies.
5. **Any false reporting may be referred to the Police for investigation.**
6. This report will be forwarded by the insurers of the GIA Records Management Centre established by the General Insurance Association of Singapore (GIA) for archiving and that copies of this report will, for a fee, be made available upon application by interested parties.
7. By the lodgement of this report to the insurers, you hereby consent to the archiving of this report at the centre and to copies of the report being made available aforesaid.

ACCIDENT STATEMENT

Date Of Report	23/02/2018 17:21
Date Of Accident	22/02/2018 17:50
Exact Location Of Accident	WOODLANDS ROAD AFTER JUNCTION 10
Country/State of Loss	SINGAPORE

DETAILS OF OWN VEHICLE

Vehicle Registration Number	SLF5830P
Insured/Policyholder	
Name Of Registered Owner	GRAB RENTALS PTE LTD
Co Reg No	201617200G
Email Address	NOEMAIL
Mobile Phone No	
Alternative Phone No	OFFICE-90777736

Vehicle Particulars

Manufacturer	TOYOTA
Model	PRIUS-1.8 HYBRID CVT (A)

Exact Purpose for which vehicle was being used at time of accident

Are you claiming under your own insurance policy for repair to your vehicle? NO

If No, Please state action to be taken THIRD PARTY

Vehicle Category PRIVATE HIRE

Insurance Company

Name of Insurance Company	MSIG INSURANCE (SINGAPORE) PTE. LTD.
Type Of Coverage	COMPREHENSIVE
Fleet Policy	YES
Policy Number	A29069766MKF
Cover Note Number	

Driver

Name of Driver	JACK SEOW KOON BENG
NRIC No	S1703234H
Date Of Birth	01/11/1965
Occupation	OUTDOOR
Date Of Driving Pass	03/01/1986
Driving Experience	32 YEARS AND 1 MONTH
Gender	MALE
Mobile Number	(LOCAL) +65-93870711
Fax Number	
Contact Number	
Email Address	NOEMAIL

Address	BLK 471 JURONG WEST STREET 41 #08-497
Postcode	640471
Was driver an employee of the Insured's Company	NO
If No, Relationship of the Driver with the Insured	OTHER - HIRER
Vehicle Registration Number of Driver's Own Vehicle	-
	-
	-
Insurance Company of Driver's Own Vehicle	-
	-
	-

General Information of the Accident

Type Of Accident	SIDE SWIPE
Weather Conditions	CLEAR
Road Surface	DRY

Other Information

Was any foreign vehicle involved in this accident?	NO
Number of vehicles involved in the accident	
Was any body injured in the Accident?	NO
Was any injured conveyed to hospital by ambulance?	NO
Was any other material or property damaged?	YES
I have been approached by unknown person(s) soliciting/offering accident claims assistance.	NO
Number of Passengers (Including Driver)	2
Passenger 1	NAME: : UNKNOWN GENDER: : FEMALE

Details of Police Action

Was the accident reported to the police?	NO
If Yes, Please state which Police Station	
Was notice of intended Prosecution given?	NO
If Yes, against whom?	

Circumstances of Accident

REFER AS ATTACHED.

Attachment(s)

Are accident photos available for attachment?	YES
Was there any video captured by Car Camera?	NO
Was there any audio recorded?	NO

Details of Witness 1

Name	STEVEN
Phone Number	90491234
Email Address	

DETAILS OF OTHER VEHICLE PROPERTY 1

Vehicle Registration Number	FBE9096P
Vehicle Make/Model/Colour	
Details Of Properties	
Vehicle Category	MOTORCYCLE
Name of Driver	
NRIC/Passport Number	
Contact Number	85220602
Address	

Sketch Plan Pg. 2

SKETCH PLAN

IMPORTANT NOTICE

1. Please report correctly the details of the accident to speed up the claims process.
2. This Form must be completed by the Policyholder and/or the Authorised Driver.
3. Information provided must be as truthful and accurate as possible. Any wilful misrepresentation or withholding of material facts may allow Insurance companies to repudiate policy liability.
4. The issue and acceptance of this Form by Insurance companies is not an admission of policy liability on the part of the Insurance companies.
5. Any false reporting may be referred to the Police for investigation.
6. The report will be forwarded by the Insurers of the GIA Records Management Centre established by the General Insurance Association of Singapore (GIA) for archiving and that copies of this report will for a fee be made available upon application by Interested parties.
7. By the lodgment of this report to the Insurers, you hereby consent to the archiving of this report at the centre and to copies of the report being made available aforesaid.
8. Consent under the Personal Data Protection Act (PDPA)

I understand, acknowledge, agree and consent that:

- (a) My insurer, my workshop and the General Insurance Association of Singapore ("GIA") may/are permitted to collect, use, disclose and/or process my personal data/personal information set out in this [form] and any other personal information provided by me or possessed by my Insurer (collectively the "Personal Information") and disclose and transfer such Personal Information to all Insurer(s) who have insured vehicle(s) involved in this accident (all Insurer(s) who have insured vehicle(s) involved in this accident shall be collectively referred to as the "Insurers"), the Insurers' lawyers/law firms, the Monetary Authority of Singapore and any relevant government agency/authority (such as the police), for the purpose(s) of:
 - (i) processing, handling and/or dealing with my claims including the settlement of the claims and any necessary investigations relating to the claims;
 - (ii) investigating the accident and/or my claims;
 - (iii) carrying out and/or dealing with my instructions or responding to any enquiries by me;
 - (iv) administering my claims (including the mailing of correspondence, statements, invoices, reports or notices to me, which could involve disclosure of certain personal data about me to bring about delivery of the same as well as on the external cover of envelopes/mail packages); and/or
 - (v) complying with applicable law in administering, processing, handling and/or dealing with my claims (collectively the "Purposes")
- (b) all Insurer(s) who have insured vehicle(s) involved in this accident and the Insurers' lawyers/law firms, may/are permitted to collect, use, disclose and/or process my Personal Information for one or more of the above Purposes; and
- (c) my Personal Information may/can be disclosed by any of the Insurers and/or GIA to their third party service providers or agents (including their lawyers/law firms), which may be sited outside of Singapore, for one or more of the above Purposes.
- (d) my Personal Information will also be collected and used to compile claims history for the purpose of fraud detection, investigation and management in present and all future claims.
- (e) the information so collected under (d) above may be shared / disclosed:
 - (i) to all Insurers and/or any other third parties that assist in evaluating, investigating, controlling or managing fraud, regulators, law enforcement and government agencies as reasonably required for the purposes stated, or
 - (ii) for complying with requirements under any regulations, laws or court orders.

Policyholder's Signature
Date & Time:

Driver's Signature
(If driver is not the policyholder)
Date & Time: 23/12/18 11:40

Reporting Centre Personnel's Signature
Name:
NRIC/FIN No.:

Sketch Plan Pg. 1

SKETCH PLAN

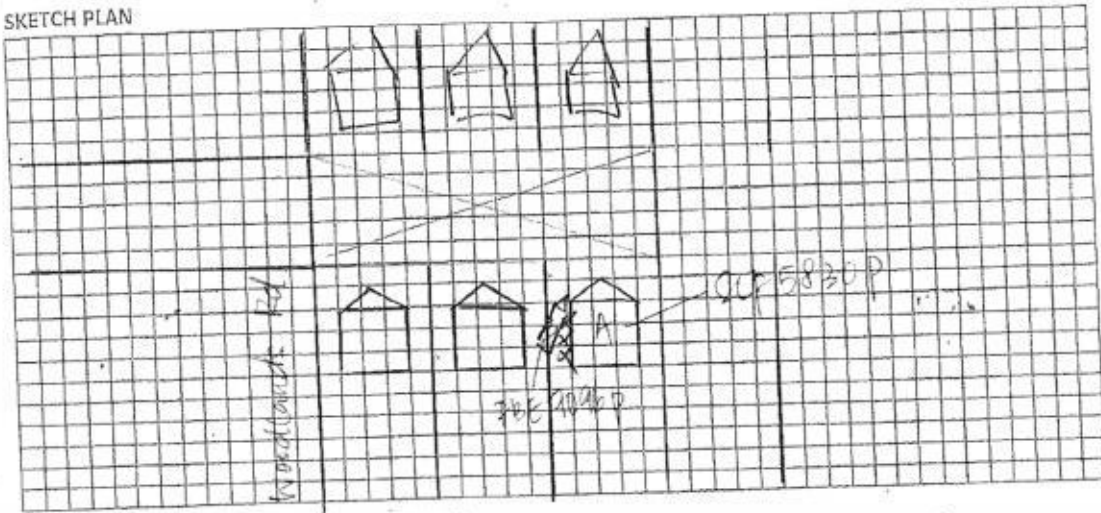

DESCRIBE CIRCUMSTANCES OF THE ACCIDENT

I was driving along Woodlands Rd on 22/02/18 @ 17:50.

When I was stopped my vehicle due to traffic jam in front of me, all of sudden the motorcycle make a jam brake then flow down and scratched onto my vehicle LH portion.

DECLARATION

I/We declare the foregoing particulars are true in every respect.

Policyholder's Signature
Date & Time:

GIARMC SketchPlanForm_V3

Driver's Signature
(If driver is not the policyholder)
Date & Time:

23/02/18 @ 11:40

Reporting Centre Personnel's Signature
Name:
NRIC/FIN No.:

2

assign
(-1P) LKK
K7418434



ESTEEM PERFORMANCE PTE LTD

Blk 5033 Ang Mo Kio, Ind Park 2 #01-251/ 259, 569536.
Tel: +65-6484 1221 Fax: +65-6484 7829 Website: www.esteemperf.com.sg

Repair Estimates

SLF 5830 P

Parts	(a) Cost / List Price Items	\$	3,391.41
	Plus/Less 25%	\$	847.85
	Total of Cost / List	\$	2,543.56
	(b) Nett Price Items		
	Less		
	Total of Nett Item		
	(c) Special Nett Items		
Total Parts Cost		\$	2,543.56
Labour		\$	1,570.00
Total		\$	4,113.56

Not Authorized
Resurvey by pain

LKK Auto Consultants hence notify the Repairer of the following:

- To resurvey before/after spray painting
- To display damaged part(s) during resurvey
- Parts prices are subject to confirmation
- Third party survey is on a "Without Prejudice" basis
- No illegal modification(s) is allowed
- Supplementary item(s) must be resurveyed and is subject to final approval from Insurance Company

Acknowledged by Repairer:
Signature: _____
Date: _____

The above total will be subjected to 7% G.S.T.

Name of Surveyor : Theresa
Company : LKK
Survey conducted on : 21/3/18 at _____

Remarks By Surveyor

- (a) The repair of this vehicle is ~~authorized~~ / is not authorized until further notice.
- (b) Recommended Days of Repair : 03 day(s)
- (c) Resurvey : Required / Not Required
- (d) Excess : \$ _____
- (e) Signature of surveyor : Le Date: 21/3/18

Theresa
21/3/18



**ESTEEM
PERFORMANCE**

ESTEEM PERFORMANCE PTE LTD

Blk 5033 Ang Mo Kio, Ind Park 2 #01-251/ 259, 569536.

Tel: +65-6484 1221 Fax: +65-6484 7829 Website: www.esteemperf.com.sg

Spare Parts

Vehicle No. :
Make & Model :
Chassis No. :

SLF 5830 P

TOYOTA PRIUS

JTDKB3FU403531618

Submit By :
Year Manufacture :
Engine No. :

Carmen Lim

2016

Cost / List

S/No.	Part Description	Qty	Unit Price	Price	Disposition by Surveyor
1	LH front fender <i>R</i>	1	\$868.70		X
2	LH front fender undershield <i>Sn</i>	1	\$176.50		X
3	LH front fender undershield clip <i>nn</i>	10	\$25.00		X
4	LHF fender wording "HYBRID" <i>nn</i>	1	\$45.17		✓
5	LH front door <i>Red/wing</i>	1	\$1,226.70		✓
6	LH front door hinge top <i>R</i>	1	\$78.34		X
7	LH front door hinge bottom <i>R</i>	1	\$78.34		X
8	LH front door weatherstrip <i>Sn</i>	1	\$198.49		X
9	LHF door glass outer moulding <i>Sn</i>	1	\$122.95		X
10	LHF door outer handle <i>Sn</i>	1	\$375.60		X
11	RH front hub cab <i>Sn</i>	1	\$195.62		✓
12					
13					
14					
15					
16					
17					
18					
19					
20					
21					
22					
23					

Note: If any of the quoted parts are recommended to be repaired, then an additional labour charge will be charged accordingly under supplementary.

Blk 5033 Ang Mo Kio Industrial Park 2 #01-259 Singapore 569536 Tel: 64841221 Fax: 64847829

Company Reg No. 200005485N / GST No. 20-0005485-N

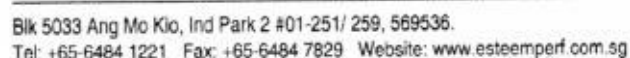

Vehicle No. : SLF 5830 P Submit By : Carmen Lim
Make & Model : TOYOTA PRIUS Year of Manufacture : 2016

Note: The above estimate of repair is based on visual assessment of the external affected areas. Any additional damages observed during the course of repair will be quote accordingly as a supplementary.

LKK Auto Consultants Pte Ltd (Co.Reg.No:199607198R)

51 Ubi Ave 1 #01-25, Paya Ubi Industrial Park

Singapore 408933

Tel: 6256-3561 Fax: 6844-8805 Email: sur@lkkauto.com; assignments@lkkauto.com

VEHICLE DAMAGE INSPECTION REPORT

Our File No: CS/MSG18003922/KTBN2

Date: 04/04/2018

REFERENCE

Handling Insurer:	MSIG Insurance (Singapore) Pte. Ltd.	Policy No:	MSD/VMS/17-366281-CA	
Claimant Vehicle No :	SLF5830P	Insured Vehicle No :	FBE9096P	
Date of Loss:	22/02/2018	Nature of Claim:	TP	Claim No: MSC/V/18-000297

DESCRIPTION & IDENTIFICATION OF VEHICLE

Reg No:	SLF5830P	Engine No:	2ZRR930523
Make & Model:	TOYOTA PRIUS, 1.8 HYBRID CVT (A)	Chassis No:	JTDKB3FU403531618
Reg. Date:	31/08/2016 (Man. Year: 2016)	Odometer:	129631 km
Colour:	Metallic Pearl White		
Engine Capacity:	1798 cc		
Market Value/New Car Price:	N/A		
Sum Insured (\$\$):	Market Value/New Car Price		

CONDITION OF VEHICLE AT THE TIME OF SURVEY

General Condition:	Steering (Serviceable):	Yes	Footbrake (Serviceable):	Yes
Handbrake (Serviceable):	Yes	Engine Modification:	No	Pre-accident Condition:

CONDITION OF TYRES

Front Tyre Size:	195/65 R15	Rear Tyre Size:	195/65 R15
Front Left Side:	Yokohama 9 mm	Rear Left Side:	AGENDA 5 mm
Front Right Side:	Yokohama 9 mm	Rear Right Side:	AGENDA 5 mm

The above values represent the remaining tyre treads depth

COST OF CLAIMS

	Repairer's	Adjuster's	Difference	Diff %
Parts	2,543.56	1,100.62	1,442.94	56.73
Miscellaneous Items	0.00	0.00	0.00	
Labour	1,570.00	910.00	660.00	42.04
Paintwork Labour	0.00	0.00	0.00	
Towing	0.00	0.00	0.00	
Calculated Gross Total (\$\$)	4,113.56	2,010.62	2,102.94	51.12
Approved Total (Overridden) (\$\$)		1,600.00		
(\$\$)	4,113.56	1,600.00	2,513.56	61.10
+ GST 7.00/7.00% (\$\$)	287.95	112.00	175.95	61.10
Nett Amount (\$\$)	4,401.51	1,712.00	2,689.51	61.10

INSPECTION

Date of Assignment:	27/02/2018	
Date Inspected:	02/03/2018	Inspected At: Esteem Performance Pte Ltd - Sin Ming (HQ) 385 Sin Ming Drive Singapore 575718

Estimated Period of Repair: 3.0 days

Adjuster: KENNETH KONG

Manager: DENISE TAY KWEE CHENG

NOTE: This report represents our findings at the time and place of inspection stated herein. Such inspection has been carried out to the best of our knowledge and ability but any other liability under any other circumstances is hereby expressly excluded.

REPAIR DETAILS

Reference

Part Source: MRM-SG	Version: 1.0 (Last Synchronised: 04 Apr 2018)
Parts: 144	TOYOTA PRIUS 1.8 HYBRID CVT (A) (Catalogue:Merimen Singapore 1.0)
Labour: Repairer's	(Price-denominated Standard List)
Print Code:	(Unsubmitted, no print-code for SLF5830P)
Validity:	These estimates are valid only if they contain the print code (above) on all estimate pages, running page numbers with the END OF ESTIMATES marker on the last estimate page
Further Info:	Items/values not in reference catalogue are prefixed with an asterisk *.

Recommended Parts

No.	Qty	Part No.	Particulars	Condition	Repairer's	Amount
1	1		*LH FRONT FENDER	Repair	868.70 FL	*- FL
2	1		*LH FRONT FENDER UNDERSHIELD	Serviceable	176.50 FL	*- FL
3	10		*LH FRONT FENDER UNDERSHIELD CLIP	Not Necessary	25.00 FL	*- FL
4	1		*LHF FENDER WORDING HYBRID	Necessary	45.17 FL	*45.17 FL
5	1		*LH FRONT DOOR	Dented/Warped	1,226.70 FL	*1,226.70 FL
6	1		*LH FRONT DOOR HINGE TOP	Repair	78.34 FL	*- FL
7	1		*LH FRONT DOOR HINGE BOTTOM	Repair	78.34 FL	*- FL
8	1		*LH FRONT DOOR WEATHERSTRIP	Serviceable	198.49 FL	*- FL
9	1		*LHF DOOR GLASS OUTER MOULDING	Serviceable	122.95 FL	*- FL
10	1		*LHF DOOR OUTER HANDLE	Serviceable	375.60 FL	*- FL
11	1		*RH FRONT HUB CAB	Scratched	195.62 FL	*195.62 FL

F=Franchise part. L=ListItemDisc.

Sub Total (\$\$)	3,391.41	1,467.49
- List Item Discount on L Items 25.00/25.00% (\$\$)	847.85	366.87
Total Parts (\$\$)	2,543.56	1,100.62

Report was unsubmitted during this print-out.

Recommended Miscellaneous Items

There are no new miscellaneous items selected.

Recommended Labour

No	Particulars	Lab.Type	Repairer's	Amount
Labour Items				
1	TO RENEW DAMAGED PARTS & KNOCK OUT ACCIDENT REPAIR AREA (LH FRONT FENDER,LHF DOOR)	New	600.00	400.00
2	TO PUTTY,RESPRAY PAINT FOR AFFECTED ACCIDENT REPAIR AREA (LH FRONT FENDER,LHF DOOR)	New	600.00	400.00
3	TO CHECK WIRING	New	50.00	20.00
4	TO REMOVE & REFIT DOOR TRIM,DOOR GLASS,WINDOW REGULATOR,DOOR LOCK TO ASSIST WORK LOAD	New	150.00	60.00
5	TO TUFF COAT	New	50.00	30.00
6	TO DO WHEEL ALIGNMENT	New	120.00	-
Gross Labour Cost (\$\$)			1,570.00	910.00

Report was unsubmitted during this print-out.

< END OF ESTIMATES >