

BMW Dealer

Performance Motors LimitedA member of the Sime Darby Group
Co. Reg. No. 197401559W GST Reg. No M2-0020081-X303, Alexandra Road
Sime Darby Performance Centre
Singapore 159941
Tel. 63190100 (Sales & Admin)
63190111 (AfterSales)
Fax. 64747770280, Kampong Arang Road
East Coast Centre
Singapore 438180
Tel. 63190888 (AfterSales)
Fax. 63449773315, Alexandra Road
Sime Darby Business Centre
Singapore 159944
Tel. 63190528 (AfterSales)
63190533/530 (Motorrad)
Fax. 64796601 (AfterSales)
64796624 (Motorrad)

GST REG. NO : M2 - 0020081 - X

E S T I M A T E

17 FEB 2018

Estimate No. : b1 45934
Date Estimated : 14/02/2018
Prepared By : Inthiran A/L Thurasamy

Page No. : 1 of 2

- ESTIMATE REPAIR FOR -
Loh Chye Ling (Luo CaiLing)
119 Pemimpin Place

Singapore 576116

- ACCOUNT - 40000
Cash Sales - Service
Singapore

REGN. NO.	CHASSIS NO.	REGN. DATE	MODEL	MILEAGE
SJM8771T	P836666	27/11/2015	216d G TOURER	0

DESCRIPTIONVALUE

To replace rear right door, attachment, repair front right door, rear right fender and rear bumper.

4,250.00

Painting front right door, rear right door, rear right fender and rear bumper.

3,693.00

To check electrical wiring systems for proper function

177.00

To transfer lock mechanism from old to new door including conduct checks on new door power window system for proper function. (1 door).

531.00

To supply and install rear left or right window glass solar film.

425.00

To carry out body cavity preservation. (Per panel).

118.00

Sundries.

150.00

Total Labour 1: 9,344.00

DESCRIPTIONQTYPRICVALUE

ALLOY RIM 7.5X17 DOUBLE SPK 385

1

759.55

759.55

RR RH DOOR

1

1,103.65

1,103.65

RH FIXED DOOR WINDOW

1

127.30

127.30

REAR DOOR EDGE PROTECTION

1

153.30

153.30

Total Parts : 2,143.80

Performance Motors Limited

A member of the Sime Darby Group

Co. Reg. No. 197401559W GST Reg. No M2-0020081-x



303, Alexandra Road
Sime Darby Performance Centre
Singapore 159941
Tel. 63190100 (Sales & Admin)
63190111 (AfterSales)
Fax. 64747770

280, Kampong Arang Road
East Coast Centre
Singapore 438180
Tel. 63190888 (AfterSales)
Fax. 63449773

315, Alexandra Road
Sime Darby Business Centre
Singapore 159944
Tel. 63190528 (AfterSales)
63190533/530 (Motorrad)
Fax. 64796601 (AfterSales)
64796624 (Motorrad)

GST REG. NO : M2 - 0020081 - X

E S T I M A T E

Estimate No. : b1 45934
Date Estimated : 14/02/2018
Prepared By : Inthiran A/L Thurasamy

Page No. : 2 of 2

REGN. NO.	CHASSIS NO.	REGN. DATE	MODEL	MILEAGE
SJM8771T	P836666	27/11/2015	216d G TOURER	0

Labour 1	:	9,344.00
Parts	:	2,143.80
Labour 2	:	0.00
Excess	:	0.00
Total GST @ 7%	:	804.15
Grand Total	:	<u>12,291.95</u>

** THIS ESTIMATE IS VALID FOR A PERIOD OF 30 DAYS ONLY**

** PRICE FOR PARTS ARE SUBJECTED TO CHANGE WITHOUT PRIOR NOTICE **

SINGAPORE ACCIDENT STATEMENT

IMPORTANT NOTICE

1. Please report correctly the details of the accident to speed up the claims process.
2. This Form must be completed by the Policyholder and/or the Authorised Driver.
3. Information provided must be as truthful and accurate as possible. Any wilful misrepresentation or withholding of material facts may allow insurance companies to repudiate policy ability.
4. The issue and acceptance of this Form by insurance companies is not an admission of policy liability on the part of the insurance companies.
5. Any false reporting may be referred to the Police for investigation.
6. This report will be forwarded by the insurers of the GIA Records Management Centre established by the General Insurance Association of Singapore (GIA) for archiving and that copies of this report will, for a fee, be made available upon application by interested parties.
7. By the lodgement of this report to the insurers, you hereby consent to the archiving of this report at the centre and to copies of the report being made available aforesaid.

ACCIDENT STATEMENT

Date Of Report	12/02/2018 17:48
Date Of Accident	11/02/2018 18:45
Exact Location Of Accident	ALONG PEMIMPIN PLACE
Country/State of Loss	SINGAPORE

DETAILS OF OWN VEHICLE

Vehicle Registration Number	SJM8771T
Insured/Policyholder	
Name Of Registered Owner	LOH CHYE LING
NRIC No	S7242105A
Email Address	LOHCHYELING@YAHOO.COM
Mobile Phone No	(LOCAL) +65-96811235
Alternative Phone No	OTHERS-96811235

Vehicle Particulars

Manufacturer	BMW
Model	-

Exact Purpose for which vehicle was being used at time of accident

Are you claiming under your own insurance policy for repair to your vehicle? NO

If No, Please state action to be taken THIRD PARTY

Vehicle Category PRIVATE CAR

Insurance Company

Name of Insurance Company	SOMPO INSURANCE SINGAPORE PTE. LTD.
Type Of Coverage	COMPREHENSIVE
Fleet Policy	NO
Policy Number	D17MTPV01014371
Cover Note Number	

Driver

Name of Driver	LOH CHYE LING
NRIC No	S7242105A
Date Of Birth	07/11/1972
Occupation	INDOOR
Date Of Driving Pass	27/09/1997
Driving Experience	20 YEARS AND 4 MONTHS
Gender	FEMALE
Mobile Number	(LOCAL) +65-96811235
Fax Number	
Contact Number	OTHERS-96811235
Email Address	LOHCHYELING@YAHOO.COM

Address	119 PEMIMPIN PLACE
Postcode	576116
Was driver an employee of the Insured's Company	NO
If No, Relationship of the Driver with the Insured	OWNER
Vehicle Registration Number of Driver's Own Vehicle	-
	-
	-
Insurance Company of Driver's Own Vehicle	-
	-
	-

General Information of the Accident

Type Of Accident	SIDE SWIPE
Weather Conditions	CLEAR
Road Surface	DRY

Other Information

Was any foreign vehicle involved in this accident?	NO
Number of vehicles involved in the accident	
Was any body injured in the Accident?	NO
Was any injured conveyed to hospital by ambulance?	
Was any other material or property damaged?	YES
I have been approached by unknown person(s) soliciting/offering accident claims assistance.	NO
Number of Passengers (Including Driver)	1

Details of Police Action

Was the accident reported to the police?	NO
If Yes, Please state which Police Station	
Was notice of intended Prosecution given?	NO
If Yes, against whom?	

Circumstances of Accident

REFER TO SKETCH PLAN

Attachment(s)

Are accident photos available for attachment?	YES
Was there any video captured by Car Camera?	NO
Was there any audio recorded?	NO

DETAILS OF OTHER VEHICLE PROPERTY 1

Vehicle Registration Number	SKD2T
Vehicle Make/Model/Colour	
Details Of Properties	
Vehicle Category	PRIVATE CAR
Name of Driver	LOW YEN FONG
NRIC/Passport Number	S7640265E
Contact Number	90069001
Address	
Postcode	
Insurance Company Name	
Nature Of Damage	
No. Of Passenger (Including Driver)	

Accident Sketch Plan

SKETCH PLAN

IMPORTANT NOTICE

1. Please report correctly the details of the accident to speed up the claims process.
2. This Form must be completed by the Policyholder and/or the Authorized Driver.
3. Information provided must be as truthful and accurate as possible. Any willful misrepresentation or withholding of material facts may allow insurance companies to repudiate policy liability.
4. The issue and acceptance of this form by insurance companies is not an admission of policy liability on the part of the insurance companies.
5. Any false reporting may be referred to the Police for investigation.
6. The report will be forwarded by the insurers to the General Insurance Association of Singapore (GIA) Records Management Centre established by the General Insurance Association of Singapore (GIA) for archiving and that copies of this report will for a fee be made available upon application by interested parties.
7. By the lodging of this report to the insurers, you hereby consent to the archiving of this report at the centre and to copies of the report being made available aforesaid.
8. **Consent under the Personal Data Protection Act (PDPA)**

I understand, acknowledge, agree and consent that:

- (a) My insurer, my workshop and the General Insurance Association of Singapore ("GIA") may/are permitted to collect, use, disclose and/or process my personal data/personal information set out in this (form) and any other personal information provided by me or possessed by my insurer (collectively the "Personal Information") and disclose and transfer such Personal Information to all insurer(s) who have insured vehicle(s) involved in this accident (all insurer(s) who have insured vehicle(s) involved in this accident shall be collectively referred to as the "Insurers"), the Insurers' lawyers/law firms, the Monetary Authority of Singapore and any relevant government agency/authority (such as the police), for the purpose(s) of:
 - (i) processing, handling and/or dealing with my claims including the settlement of the claims and any necessary investigations relating to the claims;
 - (ii) investigating the accident and/or my claims;
 - (iii) carrying out and/or dealing with my instructions or responding to any enquiries by me;
 - (iv) administering my claims (including the mailing of correspondence, statements, invoices, reports or notices to me, which could involve disclosure of certain personal data about me to bring about delivery of the same as well as on the external cover of envelopes/mail packages); and/or
 - (v) complying with applicable law in administering, processing, handling and/or dealing with my claims (collectively the "Purposes");
- (b) all insurer(s) who have insured vehicle(s) involved in this accident and the Insurers' lawyers/law firms, may/are permitted to collect, use, disclose and/or process my Personal Information for one or more of the above Purposes; and
- (c) my Personal Information may/can be disclosed by any of the Insurers and/or GIA to their third party service providers or agents (including their lawyers/law firms), which may be sited outside of Singapore, for one or more of the above Purposes;
- (d) my Personal Information will also be collected and used to compile claims history for the purpose of fraud detection, investigation and management in present and all future claims;
- (e) the information so collected under (d) above may be shared / disclosed:
 - (i) to all Insurers and/or any other third parties that assist in evaluating, investigating, controlling or managing fraud;
 - (ii) to regulators, law enforcement and government agencies as reasonably required for the purposes stated; or
 - (iii) for complying with requirements under any regulations, laws or court orders.

CITY AUTO PTE LTD
Blk B, Sun Ming Road
#01-568/569, Sun Ming Ind Est
Singapore 755643
Tel: 6453 7523 Fax: 6453 7554
(Claims Section)

Policyholder's Signature

Date & Time: 12 Feb 18

5:22 pm

Driver's Signature

(if driver is not the policyholder)

Date & Time: 12 Feb 18

5:22 pm

Receiving Centre Personnel's Signature

Name

NRIC/IN No.

Accident Sketch Plan

SKETCH PLAN

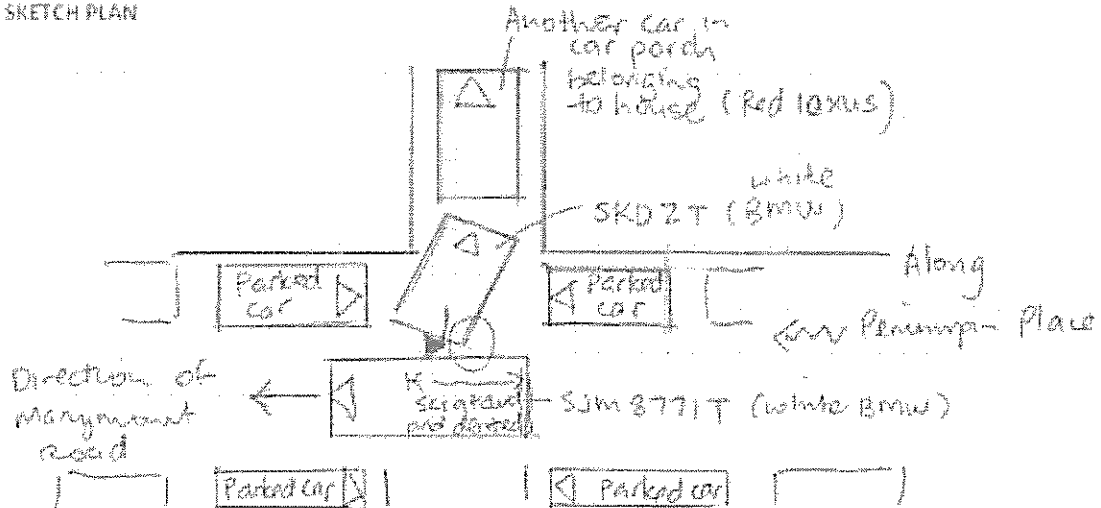

DESCRIBE CIRCUMSTANCES OF THE ACCIDENT

On 11 Feb 2018 at about 6:45 pm, I was driving motor car no SJM 877T along estate road Peninpin Place in the direction of Marymount Road when suddenly, motor car SKD 2T parked out from house no. 164 Peninpin Place and collided with and scratched the right side of my motor car.
My motor car was scratched and slightly dented from the right front door below the door handle all the way to the rear bumper. The corner left of the rear bumper of motor car no SKD 2T was scratched, and the driver of motor car no SKD 2T was Low Yen Fong (S7640265 E).
As there are parked cars along both sides of estate, I was driving slowly and even slowed down for a domestic helper who was walking along the road, before the collision happened.

DECLARATION

I/we declare the foregoing particulars are true in every respect.

Policyholder's Signature
Date & Time: 12 Feb 2018
5:22 pm

Driver's Signature
Date & Time: 12 Feb 2018
5:22 pm

CITY AUTO PTE LTD
614, 8 Sin Ming Road
Singapore 575843
Tel: 6453 1234 Fax: 6453 7944
(Claims Section)

Reporting Centre Personnel's Signature
Name
BAC/FIN No.

REPUBLIC OF SINGAPORE
IDENTITY CARD NO. S7242105A



Name



LOH CHYE LING
(LUO CAILING)

罗彩玲

Race

CHINESE

Date of Birth

07-11-1972

Sex

F

Country of Birth

SINGAPORE



1346832



NRIC No S7242105A



Blood Group Date of issue

O+

28-07-1994

119 PEMIMPIN PLACE
SINGAPORE 576116

NRIC No: S7242105A

Date: 21/01/2012

No: 6907897

Certificate of Insurance

MOTOR VEHICLES (THIRD-PARTY RISKS AND COMPENSATION) ACT (CHAPTER 189)
MOTOR VEHICLES (THIRD-PARTY RISKS AND COMPENSATION) RULES, 1960

ROAD TRANSPORT ACT, 1987 (MALAYSIA)
MOTOR VEHICLES (THIRD-PARTY RISKS) RULES, 1959 (MALAYSIA)

Cert No./Policy No. : D17MTPV01014371
Insured : LOH CHYE LING
Motor Car (Registration No.) : SJM8771T
Cover : Comprehensive - ExcelDrive PRESTIGE
Policy Commencement Date : 27 NOVEMBER 2017 00:00
Policy Expiry Date : 26 NOVEMBER 2018 23:59
Maximum Liability (Section I) : Market value at time of loss
Excess* : \$500 - Section I
(Waived up to \$1,000 if accident repair is done at ExcelDrive Workshops for the first claim per policy year)
Voluntary Excess* : N.A
Windscreen Excess* : \$S100.00 - Waived if Repair at ExcelDrive Workshop
Loss of Use : Per Policy Schedule
* Subject to GST wherever applicable

Persons or Classes of Persons entitled to drive*

1. The Insured.
2. Any other person who is driving on the Insured's order or with his permission.
3. In the event of the death of the insured,
 - a. any member of the insured's family, or a paid driver who has been driving the Motor Car during the life of the insured and permission to drive had not been withdrawn prior to the death of the insured and
 - b. any other person who has been given permission to drive the Motor Car prior to the death and such permission had not been withdrawn by the Insured.

Provided that the person driving is permitted in accordance with the licensing or other laws or regulations to drive the Motor Car or has been so permitted and is not disqualified by order of a Court of Law or by reason of any enactment or regulation in that behalf from driving the Motor Car. And provided further that the Motor Car is registered under the Road Traffic Act (Chapter 276) and its registration