

22/03/2002

ASS. REC. BY:

REF:

CS/ICS18002906/4902

Special Instruction:

Surveyor:

Martin

ASSIGNMENT (Office)

From (Person):

Corrie Tan

of

ICS

Date/Time:

13.022018 9:51am

Estimated Cost:

Bill to:

OD / TP / WS / TP RES / OD RES / EVA / INV / MV / CS

To Inspect Vehicle No:

SJD 2722Y

Insured:

SJB 1351Y

at Workshop m/s

Trans Tumkars

Tel:

6395 8784

of

E Ubi Close

Policy No:

Claim No:

Sum Insured:

Excess:

Make of Veh:

D.O.A.

06.022018

(Client's Record)

CA / REV / REP. / REV 24 HRS 'wp'

14.022018 @ 4pm

H.O.D. Endorsement:

Date/Time:

13.022018 10:05am

Person Contacted:

Jess

Vehicle IN / OUT

Date/Time	Action/Instruction ( ✓ ) Estimate
	SJD 2722Y - X
	SJB 1351Y - CS/CT16022230 / T16m2
	DCA: 17.11.16

ICS

ASSIGNMENT

From: \_\_\_\_\_ Date: 14/02/18

Estimated Cost: \_\_\_\_\_

OD / TP / WS / TP RES / OD RES / EVA / INV / MV

To inspect Vehicle No: SJD2722Y

at Workshop: Trans Eurokars

or: 5 ubi close

Insured: \_\_\_\_\_

Policy No: \_\_\_\_\_

Claims No: \_\_\_\_\_

Sum Insured: \_\_\_\_\_

Excess: \_\_\_\_\_

Client's Record: \_\_\_\_\_

Make of Ver: \_\_\_\_\_

4pm  
JESS

(Policy Condition)

Remark: The veh had commenced its repair at the time of inspection.

NS	OS

Sal or Market Value: \_\_\_\_\_

DAO Accident Report: \_\_\_\_\_ Consistent? : Yes or No

G/A / PP / Seen: \_\_\_\_\_ Consistent? : Yes or No

Est. Repairs: 3 days Pass: Yes or No

Lum Sum: 131 \$ 3 Val: Yes or No

CA / REV / REP / 24 HRS 'wp'

Date: \_\_\_\_\_ Person Contacted: \_\_\_\_\_

Vehicle IN / OUT

Vehicle: SJD2722Y

3 16

Type: Motor / M/Cycle / Bus / Van / Lorry / Taxi / Prime Mover

Truck / Trailer: 4 /

Make: mazda 3

1496

Colour: black

CC / Seating: 37708

Eng No: \_\_\_\_\_

Chassis: \_\_\_\_\_

JM6BM.42A860329083

Gen. Cond: Good / Fair / Poor / Burnt

Steering: In / Out / Jammed / Leaked / Burnt

Brake: In / Out / Jammed / Leaked / Burnt

Mod: Nil / STD A / Rim /

Tyre Size: \_\_\_\_\_

225/45ZR18

BS / DUN / EXNOVA / GY / FS / LIZA / MIC / CHTSU / RIR / SUMI

TOYO / YOKO or

FALKEN

Front: \_\_\_\_\_

Rear: \_\_\_\_\_

R/Sa: \_\_\_\_\_

R/Sa: \_\_\_\_\_

L/Sa: \_\_\_\_\_

L/Sa: \_\_\_\_\_

D/OA: \_\_\_\_\_

D/OA: \_\_\_\_\_

Surveyed at: \_\_\_\_\_

Des of Damages: Frt / Rear / O/S / N/S / U/O / Roof/Top

O/S R/L

The U/O / Chassis frame / Body Structure affected due to collision

Date Time Action / Instruction

15/5/18 Submit preli. report.  
46/5/18 vehicle hasn't send in for repair

RECEIVED 1-6 MAY 2018

Date Time File Pass to:

☒ Preli. Report  
☐ Final Report

Days Of Repair:

Resurvey No. of Trip:

Survey Fee:

Date Time File Return to:

1

Add Fee:

☐ Site Fee \$  
☐ Test Fee \$  
☐ Tech Fee \$  
☐ Rep Fee \$

Site Fee \$

Test Fee \$

Tech Fee \$

Rep Fee \$

Report Format:

Lum Sum: 131 \$

250
10
260



## LKK Auto Consultants Pte Ltd

51 Ubi Ave 1 #01-25 Paya Ubi Industrial Park, Singapore 408933

TEL: 6256 3561 FAX: 6256 4315

Reg. No: 199607198R GST Reg. No. 19-9607198-R

Affiliated to Federation Internationale Des Experts En Automobile

ECICS LTD

Ref : CS/ICS18002906/Uqb

7 TEMASEK BOULEVARD  
#10-01 SUNTEC TOWER ONE  
SINGAPORE 038987

Date : 13-02-2018



Code : ICS

### 1. Policy Particulars :- THIRD PARTY CLAIM

Insured Veh.	SJQ 1351Y	Veh. Inspected	SJD 2722Y
Policy No.		Coverage (\$)	0.00
Claim No.		Excess (\$)	0.00
Assign From	CARRIE TAN	Assign Date	13/02/2018

### 2. Vehicle Particulars & Condition

Make & Model	c.c	0
Engine No.	HIDDEN	Year of Reg.
Chassis No.		Colour
Odometer	-	Steering
Brakes		Modification
General		

### 3. Conditions of Tyres

	Size	Make	Balance
R/H Front Tyre			mm
L/H Front Tyre			mm
R/H Rear Tyre			mm
L/H Rear Tyre			mm

### 4. Description of Damages

--

### 5. General Information

Accident Date	06/02/2018	Inspection Date	14/02/2018
Survey held at	TRANS EUROKARS PTE LTD NO 5 UBI CLOSE SINGAPORE 408605		

### 5a. Remarks

A)THE INSPECTION WAS CONDUCTED ON A"WITHOUT PREJUDICE" BASIS. B)IN ACCORDANCE TO YOUR INSTRUCTIONS, WE HAVE NOT AUTHORISED REPAIRS.
--

**Catherine Chong (LKK Auto)**

---

**From:** ECICS Claims <claims@ecics.com.sg>  
**Sent:** Tuesday, 13 February, 2018 9:51 AM  
**To:** jess.francis@eurokars.com.sg; ECICS Claims  
**Cc:** kevin.lee@eurokars.com.sg; eric.pau@eurokars.com.sg;  
ronald.yap@eurokars.com.sg; assignments@lkkauto.com  
**Subject:** RE: ECICS - SJQ1351Y / Tepl - SJD2722Y / Doa 06.02.2018 / \*\* req for survey.

Without Prejudice

Dear Jess,

Noted with thanks.

Dear LKK,

Please assist on TP PRI survey for SJD2722Y.

Thank you.

Regards,  
Carrie Tan  
Claims Division  
DID: +65 63030308  
FAX: +65 6338 9267

ECICS Limited  
7 Temasek Boulevard, #10-01 Suntec Tower One, Singapore 038987

**WITH IMMEDIATE EFFECT FOR ALL PRE-REPAIR INSPECTION/SURVEY, please email to [motorsurvey@ecics.com.sg](mailto:motorsurvey@ecics.com.sg) directly.**

*\*\*Please bear with us should we take longer to response as we are currently experiencing a high volume of claims. Thank you for your kind patience and understanding.\*\**

---

**From:** jess.francis@eurokars.com.sg [mailto:jess.francis@eurokars.com.sg]  
**Sent:** Monday, 12 February, 2018 6:37 PM  
**To:** ECICS Claims  
**Cc:** kevin.lee@eurokars.com.sg; eric.pau@eurokars.com.sg; ronald.yap@eurokars.com.sg  
**Subject:** ECICS - SJQ1351Y / Tepl - SJD2722Y / Doa 06.02.2018 / \*\* req for survey.

Hi All,

Kindly arrange the survey to our client's car as soon as possible.

Regards.

Jess Francis Carlos  
Insurance Claims Executive  
Trans Eurokars Pte Ltd

5 Ubi Close  
Singapore 408605  
Tel no.: 63958784

**From:** mazdacanon@mazda.com.sg [mailto:transeurokars@eurokars.com.sg]

**Sent:** Monday, 12 February 2018 6:35 PM

**To:** Jess Francis <jess.francis@eurokars.com.sg>

**Subject:** Attached Image



This message may contain privileged and confidential information and is only intended for use by the addressee. No representation, warranty, guarantee or undertaking expressed or implied is made by ECICS Limited; as to the fairness, accuracy or completeness of any information, projections or opinions contained in this message. Any unauthorized disclosure, use or dissemination either in whole or in part is prohibited. If you are not the addressee indicated in his message (or responsible for delivery of the message to such person), you may not copy or deliver this message to anyone. In such case, you should destroy this message and kindly notify the sender by reply email. Opinions contained herein are the personal opinions of the sender and do not necessarily represent the views of ECICS Limited.

## Enquire PARF/COE Rebate for Registered Vehicle

Vehicle Owner Particulars	
Owner ID Type:	Singapore NRIC
Owner ID:	3707J
Vehicle Details	
Vehicle No.:	SJD2722Y
Vehicle to be Exported:	No
Intended De-registration Date:	15 Feb 2018
Vehicle Make:	MAZDA
Vehicle Model:	MAZDA3 4-DOOR SEDAN 1.5L SP.6EAT
Primary Colour:	Black
Manufacturing Year:	2015
Engine No.:	P520338187
Chassis No.:	JM6BM42A8G0329093
Maximum Power Output:	88.0 kW (118 bhp)
Open Market Value:	\$17,812.00
Original Registration Date:	31 Mar 2016
First Registration Date:	31 Mar 2016
Transfer Count:	0
Actual ARF Paid:	\$12,812.00
Intended PARF Rebate Details	
PARF Eligibility:	Yes
PARF Eligibility Expiry Date:	30 Mar 2026
PARF Rebate Amount:	\$9,609.00
Intended COE Rebate Details	
COE Expiry Date:	30 Mar 2026
COE Category:	A - Car up to 1600cc & 97kW (130bhp)
COE Period(Years):	10
QP Paid:	\$45,504.00
COE Rebate Amount:	\$36,965.00
<b>Total Rebate Amount:</b>	<b>\$46,574.00</b>

The information contained herein is correct as at 15 Feb 2018

## SINGAPORE ACCIDENT STATEMENT

### IMPORTANT NOTICE

1. Please report correctly the details of the accident to speed up the claims process.
2. This Form must be completed by the Policyholder and/or the Authorised Driver.
3. Information provided must be as truthful and accurate as possible. Any wilful misrepresentation or withholding of material facts may allow insurance companies to repudiate policy ability.
4. The issue and acceptance of this Form by insurance companies is not an admission of policy liability on the part of the insurance companies.
5. Any false reporting may be referred to the Police for investigation.
6. This report will be forwarded by the insurers of the GIA Records Management Centre established by the General Insurance Association of Singapore (GIA) for archiving and that copies of this report will, for a fee, be made available upon application by interested parties.
7. By the lodgement of this report to the insurers, you hereby consent to the archiving of this report at the centre and to copies of the report being made available aforesaid.

### ACCIDENT STATEMENT

Date Of Report	06/02/2018 14:17
Date Of Accident	06/02/2018 11:30
Exact Location Of Accident	KPE TUNNEL TOWARDS CITY
Country/State of Loss	SINGAPORE

### DETAILS OF OWN VEHICLE

Vehicle Registration Number	SJD2722Y
<b>Insured/Policyholder</b>	
Name Of Registered Owner	WON KUM MENG
NRIC No	S1103707J
Email Address	NOEMAIL
Mobile Phone No	(LOCAL) +65-98478447
Alternative Phone No	OTHERS-98478447

### Vehicle Particulars

Manufacturer	MAZDA
Model	MAZDA 3
Exact Purpose for which vehicle was being used at time of accident	PRIVATE USE
Are you claiming under your own insurance policy for repair to your vehicle?	NO
If No, Please state action to be taken	THIRD PARTY
Vehicle Category	PRIVATE CAR

### Insurance Company

Name of Insurance Company	AIG ASIA PACIFIC INSURANCE PTE. LTD.
Type Of Coverage	COMPREHENSIVE
Fleet Policy	NO
Policy Number	
Cover Note Number	

### Driver

Name of Driver	CLARKE WILFRED WAN TECK LEONG
NRIC No	S7424280D
Date Of Birth	31/07/1974
Occupation	INDOOR
Date Of Driving Pass	25/02/1994
Driving Experience	23 YEARS AND 11 MONTHS
Gender	MALE
Mobile Number	(LOCAL) +65-96777707
Fax Number	
Contact Number	
Email Address	667CLARKE@GMAIL.COM

Address	58 PUNGGOL WALK #06-14
Postcode	8287833
Was driver an employee of the Insured's Company	NO
If No, Relationship of the Driver with the Insured	FRIEND
Vehicle Registration Number of Driver's Own Vehicle	-
	-
Insurance Company of Driver's Own Vehicle	-
	-

#### General Information of the Accident

Type Of Accident	SIDE SWIPE
Weather Conditions	CLEAR
Road Surface	DRY

#### Other Information

Was any foreign vehicle involved in this accident?	NO
Number of vehicles involved in the accident	
Was any body injured in the Accident?	NO
Was any injured conveyed to hospital by ambulance?	NO
Was any other material or property damaged?	YES
I have been approached by unknown person(s) soliciting/offering accident claims assistance.	NO
Number of Passengers (Including Driver)	1

#### Details of Police Action

Was the accident reported to the police?	NO
If Yes, Please state which Police Station	
Was notice of intended Prosecution given?	NO
If Yes, against whom?	

#### Circumstances of Accident

REFER TO SKETCH PLAN & STATEMENT

#### Attachment(s)

Are accident photos available for attachment?	YES
Was there any video captured by Car Camera?	NO
Was there any audio recorded?	NO

#### DETAILS OF OTHER VEHICLE PROPERTY 1

Vehicle Registration Number	SJQ1351Y
Vehicle Make/Model/Colour	
Details Of Properties	
Vehicle Category	PRIVATE CAR
Name of Driver	
NRIC/Passport Number	
Contact Number	
Address	
Postcode	
Insurance Company Name	ECICS LIMITED
Nature Of Damage	
No. Of Passenger (Including Driver)	



SKETCH PLANIMPORTANT NOTICE

1. Please report correctly the details of the accident to speed up the claims process.
2. This form must be completed by the Polichholder and/or the Authorised Driver.
3. Information provided must be as truthful and accurate as possible. Any wilful misrepresentation or withholding of material facts any allow insurance companies to repudiate policy liability.
4. The issue and acceptance of this Form by insurance companies is not an admission of policy liability on the part of the insurance companies.
5. Any false reporting may be referred to the Police for investigation.
6. The report will be forwarded by the Insurers of the GIA Records Management Centre established by the General Insurance Association of Singapore (GIA) for archiving and that copies of this report will for a fee be made available upon application by interested parties.
7. By the lodgement of this report to the insurers, you hereby consent to the archiving of this report at the centre and copies of the report being made available aforesaid.
8. Consent under the Personal Data Protection Act (PDPA)

I understand, acknowledge, agree and consent that:

(a) My insurer, my workshop and the General Insurance Association of Singapore ("GIA") may/are permitted to collect, use, disclose and/or process my personal data/personal information set out in this [form] and any other personal information provided by me or possessed by my insurer (collectively the "Personal Information") and disclose and transfer such personal information to all insurer(s) who have insured vehicle(s) involving in this accident (all insurer(s) who have insured vehicle(s) involved in this accident shall be collectively referred to as the "Insurers"), the Insurers' lawyer/law firms, the Monetary Authority of Singapore and any relevant government agency/authority (such as the police), for the purpose(s) of:

- (i) processing, handling and/or dealing with my claims including the settlement of the claims and any necessary investigations relating to the claims;
  - (ii) investigating the accident and/or my claims;
  - (iii) carrying out and/or dealing with my instructions or responding to any enquiries by me;
  - (iv) administering my claims (including the mailing of correspondence, statements, invoices, reports or notices to me, which could involve disclosure of certain personal data about me to bring about delivery of the same as well as on the external cover of envelopes/mail packages); and/or
  - (v) complying with applicable law in administering, processing, handling and/or dealing with my claims.
- (collectively the "Purposes")

- (b) all insurer(s) who have insured vehicle(s) involved in this accident and the Insurers' lawyer/law firm, may/are permitted to collect, use, disclose and/or process my Personal Information for one or more of the above Purposes; and
- (c) my Personal Information may/can be disclosed by any of the Insurers and/or GIA to their third party service providers or agents (including their lawyer/law firms), which may be sited outside of Singapore, for one or more of the above Purposes.

Policyholder's Signature / Date & Time      Driver's Signature (If driver is not the policy holder) / Date & Time      Witnessed by Reporting Centre Personnel

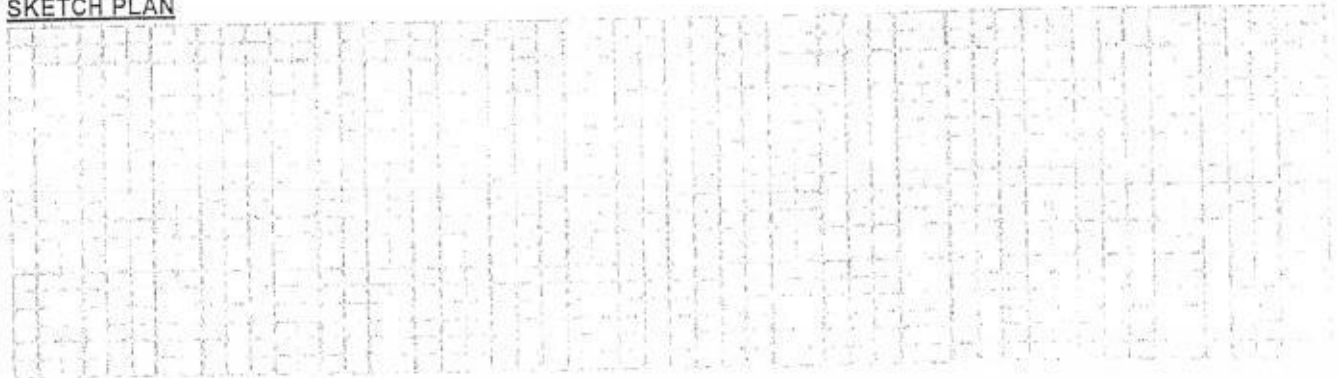
SKETCH PLAN



## DESCRIBE CIRCUMSTANCES OF THE ACCIDENT

I WAS DRIVING ON THE LANE BEFORE HEADING INTO THE KPC TUNNEL, S501351 Y WAS SEEN COMING VERY FAST FROM THE REAR & HE WAS VERY CLOSE TO MY BACK, I SWITCHED LANE IN THE TUNNEL FROM LANE 1 TO LANE 5, HE THEN OVERTOOK ME FROM MY RIGHT & CUT ABRUPTLY INTO MY LANE TRAIL SCRAPING MY RIGHT BENDER, BUMPER & SPAY ~~HEAD~~ KIMS

## Declaration

I/We declare the foregoing particulars are true in every respect.

Policyholder's Signature / Date & Time Driver's Signature (if driver is not the policy holder) / Date & Time Witnessed by Reporting Centre Personnel



TRANS EUROKARS PTE LTD  
NO:5 UBI CLOSE, SINGAPORE 408605  
ESTIMATE COST OF REPAIRS



DOA - 16/02/2018 VS CJD13574

<b>ECICS LIMITED</b> 7 Temasek Boulevard #10-01 Suntec Tower One Singapore 038987. <b>ATTN. :</b> MOTOR CLAIMS <b>FAX :</b>		<b>NAME :</b> Mr Won Kum Meng <b>ADDRESS :</b> No. 56 Punggol Walk #05-14 Singapore 828833 <b>TEL :</b> 97340497	<b>WIP :</b> 61668 <b>EXCESS :</b> <b>DATE :</b> 8-Feb-18
<b>VEH NO :</b>	<b>SJD2722Y</b>	<b>DATE IN :</b>	<b>CONTACT PERSON :</b> JESS 6395 7874
<b>CHASSIS NO :</b>	JM6BM42A8G0329093	<b>MILEAGE :</b>	<b>TYPE OF CLAIM :</b> THIRD PARTY CLAIM
<b>MODEL :</b>	MAZDA3 1.5L	<b>DATE REG.:</b> 31-Mar-16	<b>POLICY NO. :</b>

**NATURE OF WORKS**

**Parts Description**

NO	QTY		REVISED	PRICES
1	1	MGJG9-32-110E	11X	\$ 772.20
2	1	MGHT2-32-280	11X	\$ 142.20
3	2	MT060-26-169A	11X	\$ 12.60
4	1	MB45A-33-021	11X	\$ 383.40
5	1	MKD45-33-261B	11X	\$ 30.30
6	1	MB45A-33-04X	11X	\$ 541.70
7	1	MD651-33-042A	11X	\$ 14.20
8	1	MB60S-34-300E	11X	\$ 433.00
9	1	MBHS2-34-700A	11X	\$ 343.60
10	1	MKD35-34-380C	11X	\$ 91.90
11	1	MB45A-34-38XA	11X	\$ 53.10
12	1	MB45A-34-015A	11X	\$ 34.50
13	1	MB45G-34-111A	11X	\$ 44.10
14	1	MB45A-34-0A3A	11X	\$ 28.00
<b>TOTAL PARTS</b>				\$ 2,924.80
<b>LESS 10%</b>				\$ 292.48
<b>TOTAL PARTS COST</b>				\$ 2,632.32

**Labour Description**

1		TO REPAIR FRONT BUMPER, RHS FRONT FENDER AND ALL AREAS AFFECTED BY THE ACCIDENT.	660	330	\$ 1,320.00
2	MZ-SP-SFRT07	TO RESPRAY FRONT BUMPER AND FRONT FENDER.	630	1260	\$ 1,890.00
3	MZ-BR-AXNSUP	TO REPLACE AXLE AND SUSPENSION MECHANISM.		11X	\$ 660.00
4		TO REPLACE STEERING RACK.		11X	\$ 1,320.00

5	MZ-BR-ELECTR	TO CHECK ELECTRICAL SYSTEM FOR PROPER FUNCTIONING.	120	\$ 250.00
6	MZ-BR-REPROG	TO REPROGRAMME AFTER THE ACCIDENT REPAIR WORKS.	150	\$ 350.00
7	MZ-BR-SUNDRI	SUNDRIES.	71 X	NETT \$ 100.00

TOTAL LABOUR	\$ -	\$ 5,890.00
TOTAL PARTS	\$ -	\$ 2,632.32
TOTAL	\$ -	\$ 8,522.32
LESS EXCESS	\$ -	\$ -
TOTAL AFTER EXCESS	\$ -	
GST 7%	\$ -	\$ -
GRAND TOTAL	\$ -	\$ -

**REMARKS:**

THIS IS ONLY AN ESTIMATE FROM VISUAL INSPECTION AND SHOULD THERE BE MORE DAMAGES FOUND DURING THE PROCESS OF REPAIRING, YOU WILL BE INFORMED BEFORE THE REPAIRS ARE BEING CARRIED OUT. TAKE NOTE THAT SHOULD YOU DECIDE NOT TO PROCEED WITH THE REPAIRS, A **QUOTATION FEE OF \$400** WILL BE APPLIED ACCORDINGLY FOR MAN-HOURS INVOLVED IN SOURCING FOR PARTS PRICE AS WELL AS LABOUR CHARGES.

**TRANS EUROKARS PTE LTD**

\_\_\_\_\_  
Authorized Signature

Not Authorized  
Tel: 62583561  
14/2/18  
Take photo after repair  
3 days.

LKK Auto Consultants hence notify the Repairer of the following:

- To resurvey before/after spray painting
- To display damaged part(s) during resurvey
- Parts prices are subject to confirmation
- Third party survey is on a "Without Prejudice" basis
- No illegal modification(s) is allowed
- Supplementary item(s) must be resurveyed and is subject to final approval from Insurance Company

Acknowledged by Repairer

Signature:

Date:

## LKK Auto Consultants Pte Ltd (Co.Reg.No:199607198R)

51 Ubi Ave 1 #01-25, Paya Ubi Industrial Park

Singapore 408933

Tel: 6256-3561 Fax: 6844-8805 Email: sur@lkkauto.com; assignments@lkkauto.com

## VEHICLE DAMAGE INSPECTION REPORT

Our File No: CS/ICS18002906/UQBN2

Date: 16/05/2018

## REFERENCE

Handling Insurer:	ECICS Limited	Policy No:	
Claimant Vehicle No :	SJD2722Y	Insured Vehicle No :	SJQ1351Y
Date of Loss:	06/02/2018	Nature of Claim:	TP
		Claim No:	N/A

## DESCRIPTION &amp; IDENTIFICATION OF VEHICLE

Reg No:	SJD2722Y	Engine No:	P520338187
Make & Model:	MAZDA 3, 1.5 (A)	Chassis No:	JM6BM42A8G0329093
Reg. Date:	31/03/2016 (Man. Year: 2015)	Odometer:	37708 km
Colour:	Black		
Engine Capacity:	1496 cc		
Market Value/New Car Price:	N/A		
Sum Insured (S\$):	Market Value/New Car Price		

## CONDITION OF VEHICLE AT THE TIME OF SURVEY

General Condition:	Steering (Serviceable):	Yes	Footbrake (Serviceable):	Yes
Handbrake (Serviceable):	Yes	Engine Modification:	No	Pre-accident Condition:

## CONDITION OF TYRES

Front Tyre Size:	225/45ZR18	Rear Tyre Size:	225/45ZR18
Front Left Side:	Falken 6 mm	Rear Left Side:	Falken 6 mm
Front Right Side:	Falken 6 mm	Rear Right Side:	Falken 6 mm

The above values represent the remaining tyre treads depth

COST OF CLAIMS	Repairer's	Adjuster's	Difference	Diff %
Parts	2,732.32	0.00	2,732.32	100.00
Miscellaneous Items	0.00	0.00	0.00	
Labour	5,790.00	1,860.00	3,930.00	67.88
Paintwork Labour	0.00	0.00	0.00	
Towing	0.00	0.00	0.00	
<b>Gross Total (S\$)</b>	<b>8,522.32</b>	<b>1,860.00</b>	<b>6,662.32</b>	<b>78.17</b>
<b>+ GST 7.00/7.00% (S\$)</b>	<b>596.56</b>	<b>130.20</b>	<b>466.36</b>	<b>78.17</b>
<b>Nett Amount (S\$)</b>	<b>9,118.88</b>	<b>1,990.20</b>	<b>7,128.68</b>	<b>78.17</b>

## INSPECTION

Date of Assignment:	13/02/2018		
Date Inspected:	14/02/2018	Inspected At:	Trans Eurokars Pte Ltd (HQ) 5 Ubi Close Singapore 408605

Estimated Period of Repair: 3.0 days

Adjuster: MARCUS CHUA

Manager: SHIAU CHAN

NOTE: This report represents our findings at the time and place of inspection stated herein. Such inspection has been carried out to the best of our knowledge and ability but any other liability under any other circumstances is hereby expressly excluded.

THE VEHICLE HAS NOT SEND IN FOR REPAIRS.  
(REPAIR COST NOT CONCLUDE)

## REPAIR DETAILS

## Reference

<b>Part Source:</b> MRM-SG	Version: 1.0 (Last Synchronised: 16 May 2018)
<b>Parts:</b> 144	MAZDA 3 1.5 (A) (Catalogue:Merimen Singapore 1.0)
<b>Labour:</b> Repairer's	(Price-denominated Standard List)
<b>Print Code:</b> (Unsubmitted, no print-code for SJD2722Y)	
<b>Validity:</b>	These estimates are valid only if they contain the print code (above) on all estimate pages, running page numbers with the END OF ESTIMATES marker on the last estimate page
<b>Further Info:</b>	Items/values not in reference catalogue are prefixed with an asterisk *

## Recommended Parts

No.	Qty	Part No.	Particulars	Condition	Repairer's	Amount
1	1		*STEERING RACK	Not Necessary	772.20 FL	*-FL
2	1		*RHS TIE ROD END	Not Necessary	142.20 FL	*-FL
3	2		*PIN,TIE ROD END	Not Necessary	12.60 FL	*-FL
4	1		*RHS FRONT WHEEL KNUCKLE	Not Necessary	383.40 FL	*-FL
5	1		*COVER (RHS),DUST	Not Necessary	30.30 FL	*-FL
6	1		*RHS FRONT WHEEL BEARING	Not Necessary	541.70 FL	*-FL
7	1		*NUT,WHEEL BEARING	Not Necessary	14.20 FL	*-FL
8	1		*RHS FRONT LOWER ARM	Not Necessary	433.00 FL	*-FL
9	1		*RHS FRONT ABSORBER	Not Necessary	343.60 FL	*-FL
10	1		*RUBBER MOUNT UPPER,ABSORBER	Not Necessary	91.90 FL	*-FL
11	1		*BEARING (ABSORBER)	Not Necessary	53.10 FL	*-FL
12	1		*DUSH COVER (ABSORBER)	Not Necessary	34.50 FL	*-FL
13	1		*BUMP STOP (ABSORBER)	Not Necessary	44.10 FL	*-FL
14	1		*RUBBER MOUNT LOWER,ABSORBER	Not Necessary	28.00 FL	*-FL
15	1		*SUNDRIES	Not Necessary	100.00 FS	*-FS

F=Franchise part. S=SpcNett. L=ListItemDisc.

<b>Sub Total (\$\$)</b>	<b>3,024.80</b>	<b>0.00</b>
<b>- List Item Discount on L Items 10.00/10.00% (\$\$)</b>	<b>292.48</b>	<b>0.00</b>
<b>Total Parts (\$\$)</b>	<b>2,732.32</b>	<b>0.00</b>

Report was unsubmitted during this print-out.



## Recommended Miscellaneous Items

There are no new miscellaneous items selected.

## Recommended Labour

No	Particulars	Lab.Type	Repairer's	Amount
<b>Labour Items</b>				
1	TO REPAIR FRONT BUMPER,RHS FRONT FENDER AND ALL AREAS AFFECTED BY THE ACCIDENT	New	1,320.00	330.00
2	TO RESPRAY FRONT BUMPER AND FRONT FENDER	New	1,890.00	1,260.00
3	TO REPLACE AXLE AND SUSPENSION MECHANISM	New	660.00	-
4	TO REPLACE STEERING RACK	New	1,320.00	-
5	TO CHECK ELECTRICAL SYSTEM FOR PROPER FUNCTIONING	New	250.00	120.00
6	TO REPROGRAMME AFTER THE ACCIDENT REPAIR WORKS	New	350.00	150.00
Gross Labour Cost (\$\$)			5,790.00	1,860.00

Report was unsubmitted during this print-out.

< END OF ESTIMATES >